

blink Mini Pan Tilt Camera



Blink Mini Pan Tilt Camera User Guide

[Home](#) » [blink](#) » Blink Mini Pan Tilt Camera User Guide 

Contents

- [1 Blink Mini Pan Tilt Camera](#)
- [2 Product Using Instructions](#)
- [3 Specifications](#)
- [4 FAQs](#)
- [5 Documents / Resources](#)
 - [5.1 References](#)
- [6 Related Posts](#)

blink

Blink Mini Pan Tilt Camera



Product Using Instructions

1. If you already have a Mini, unplug the USB cable from the camera and uninstall it from its base.

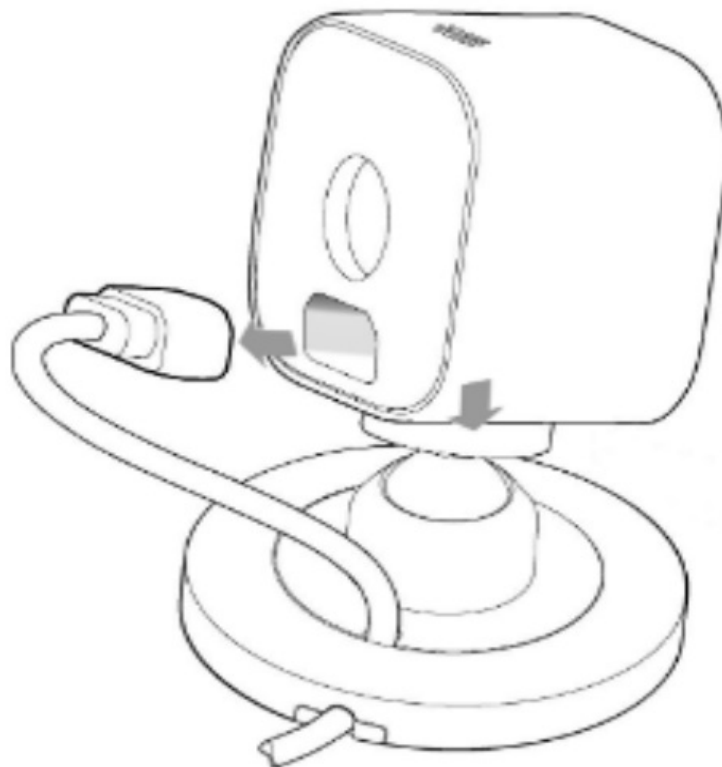

- **Diagram:** Illustration of a Mini camera with a USB cable being unplugged from the camera.
2. Connect the micro-USB connector cable from your Pan-Tilt Mount into the back of your Mini camera.

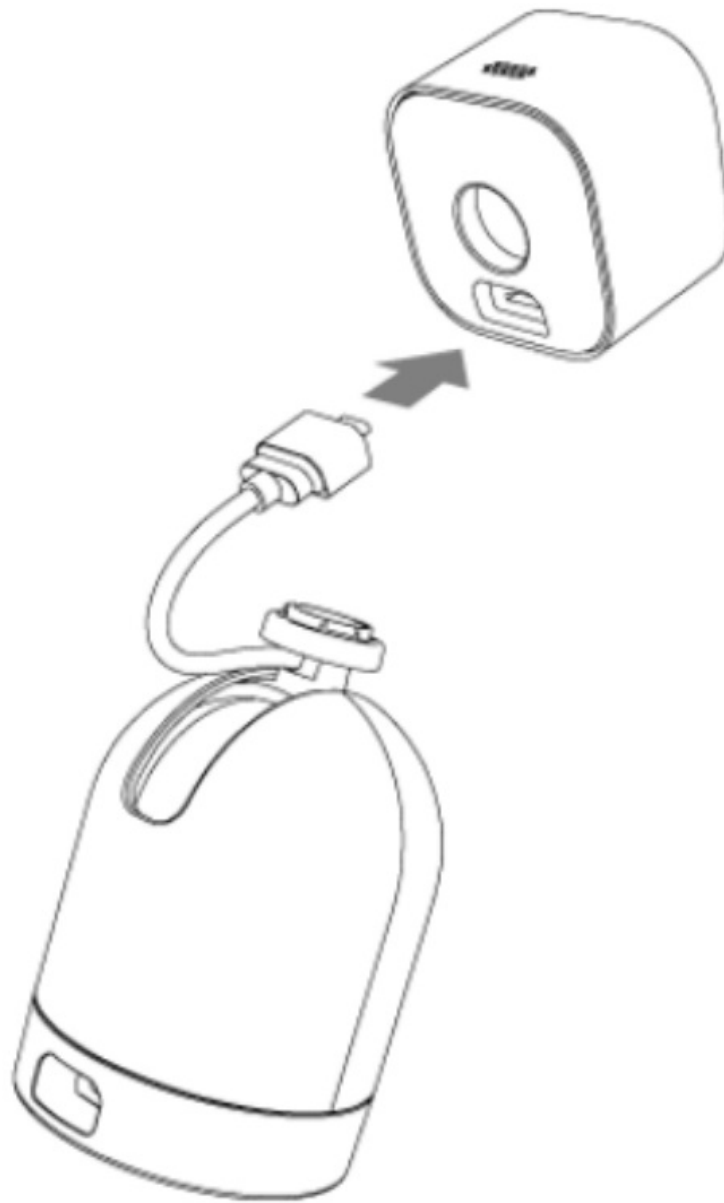

- **Diagram:** Illustration showing the micro-USB connector cable being plugged into the back of the Mini camera.

3. Snap your Mini camera onto your Pan-Tilt Mount, ensuring the micro-USB ports on your Pan-Tilt Mount and Mini camera are vertically aligned. When attaching your Mini camera, you will need to hold your Pan-Tilt Mount steadily in place, in order to securely snap your camera on it.

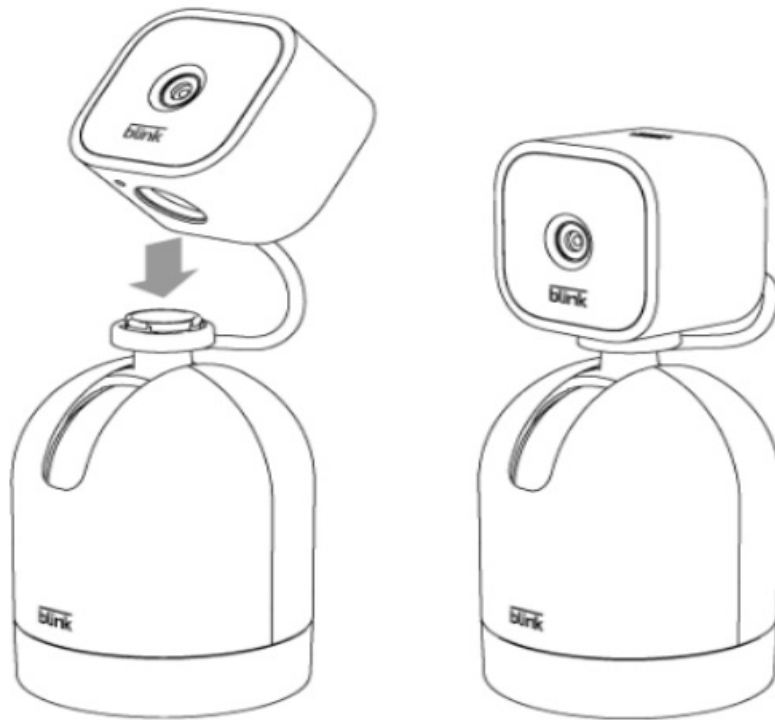

- **Diagram:** Illustration showing the Mini camera being snapped onto the Pan-Tilt Mount.

4. Plug in the micro-USB cable that came with your Mini camera into your Pan-Tilt Mount. Then plug the other end into a power outlet.

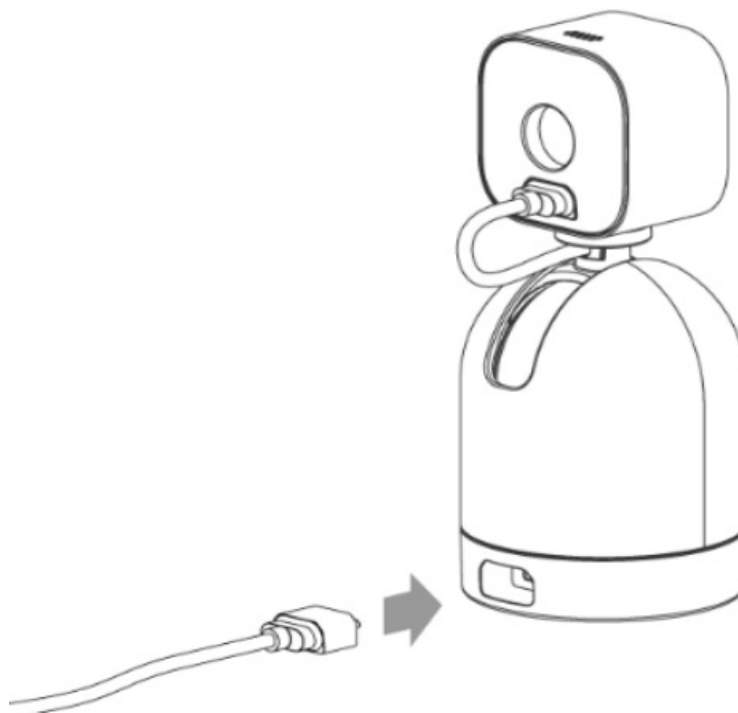

- **Note:** The flat side of the USB cord must face downward while the rounded side faces upward, to ensure the cable is properly connected.
- **Diagram:** Illustration showing the micro-USB cable being plugged into the Pan-Tilt Mount and the power outlet.

5. Once the Pan-Tilt mount is connected to the Mini, it automatically calibrates based on its current position. A notification will display in your Blink app when the Pan-Tilt mount is added to your Mini camera.

- **Note:** If you experience any issues during the calibration, refer to the [Recalibrate your Pan-Tilt Mount](#) section of [Troubleshoot the Pan-Tilt Mount](#).

6. Tap OK.

Specifications

Feature	Description
Camera Type	Blink Mini Pan-Tilt
Connection Type	Micro-USB
Power Source	USB Power Outlet
Calibration	Automatic upon connection

FAQs

- **Q: What should I do if my Pan-Tilt Mount doesn't calibrate automatically?**
 - **A:** If the Pan-Tilt Mount does not calibrate automatically, refer to the [Recalibrate your Pan-Tilt Mount section of Troubleshoot the Pan-Tilt Mount](#).
- **Q: How do I know if the USB cable is connected correctly?**
 - **A:** Ensure the flat side of the USB cord faces downward while the rounded side faces upward to ensure proper connection.
- **Q: Can I use the Pan-Tilt Mount with any Blink Mini camera?**
 - **A:** Yes, the Pan-Tilt Mount is designed to be compatible with all Blink Mini cameras.
- **Q: What should I do if my camera does not snap onto the Pan-Tilt Mount securely?**
 - **A:** Make sure the micro-USB ports on your Pan-Tilt Mount and Mini camera are vertically aligned and hold the Pan-Tilt Mount steadily in place while snapping the camera on.

Documents / Resources

	Blink Mini Pan Tilt Camera [pdf] User Guide Mini Pan Tilt Camera, Pan Tilt Camera, Tilt Camera, Camera
---	---

References

- [User Manual](#)

[Manuals+](#), [Privacy Policy](#)

This website is an independent publication and is neither affiliated with nor endorsed by any of the trademark owners. The "Bluetooth®" word mark and logos are registered trademarks owned by Bluetooth SIG, Inc. The "Wi-Fi®" word mark and logos are registered trademarks owned by the Wi-Fi Alliance. Any use of these marks on this website does not imply any affiliation with or endorsement.