

● **BLAUPUNKT**
VT100BK
Vertical
Turntable With
Bluetooth In Out



BLAUPUNKT VT100BK Vertical Turntable With Bluetooth In Out Owner's Manual

[Home](#) » [Blaupunkt](#) » BLAUPUNKT VT100BK Vertical Turntable With Bluetooth In Out Owner's Manual 

Contents

- 1 [BLAUPUNKT VT100BK Vertical Turntable With Bluetooth In Out](#)
- 2 [Product Usage Instructions](#)
- 3 [Important Safety Instructions](#)
- 4 [SAFETY INSTRUCTIONS](#)
- 5 [Control locations](#)
- 6 [General Notes](#)
- 7 [Bluetooth playback operation](#)
- 8 [Troubleshooting](#)
- 9 [Specification](#)
- 10 [Power adaptor information](#)
- 11 [Frequently Asked Questions](#)
- 12 [Documents / Resources](#)
 - 12.1 [References](#)



BLAUPUNKT VT100BK Vertical Turntable With Bluetooth In Out



Specifications:

- **Model:** VT100BK/VT100SL
- **Type:** Vertical Turntable
- **Connectivity:** Bluetooth In-Out

Product Usage Instructions

Important Safety Instructions:

Before operating the VT100BK/VT100SL Vertical Turntable with Bluetooth In-Out, please read and follow these important safety instructions:

Read and Retain Instructions:

Read all safety and operating instructions carefully and keep them for future reference.

Placement:

Avoid placing the turntable in areas exposed to direct sunlight, heat sources, moisture, dust, or vibration. Keep it away from naked flames, candles, or humid environments.

Power Connection:

Ensure the power adaptor is correctly connected before turning on the device. Use a USB stick directly or a USB-extension cable that is not longer than 25 cm.

Do Not Open:

Do not attempt to open the casing of the unit or remove any screws as there are no user-serviceable parts inside. Refer all servicing to qualified personnel.

Operating Instructions:

Operate the product only as instructed in the manual to ensure safety and optimal performance.

Grounding and Power Sources:

Operate the turntable only from the specified power source indicated by the marking near the power cord entry. Ensure proper grounding and polarization for safety.

Important Safety Instructions



RISK OF ELECTRIC SHOCK DO NOT OPEN

Caution:

To reduce the risk of electric shock, do not remove cover (or back). No user-serviceable parts inside. Refer servicing to qualified service personnel.

Explanation of Graphical Symbols:



The lightning flash within an equilateral triangle is intended to alert you to the presence of uninsulated dangerous voltage within the product's enclosure that may be of sufficient magnitude to constitute an electric shock to a person or persons.



The exclamation point within an equilateral triangle is intended to alert you to the presence of important operating and maintenance (servicing) instructions in the literature accompanying the product.

To achieve the utmost in enjoyment and performance, and in order to become familiar with its features, please read this manual carefully before attempting to operate this product. This will assure you years of trouble free performance and listening pleasure.

Important Notes

- This safety and operating instruction should be retained for future reference.
- The apparatus should not be exposed to dripping or splashing or placed in a humid atmosphere such as a bathroom.
- Do not install the product in the following areas:
 - Places exposed to direct sunlight or close to radiators.
 - On top of other stereo equipment that radiate too much heat.
 - Blocking ventilation or in a dusty area.
 - Areas where there is constant vibration.
 - Humid or moist places.
- Do not place near candles or other naked flames.
- Operate the product only as instructed in this manual.
- Before turning on the power for the first time, make sure the power adaptor is properly connected.
- Plug-in the USB stick directly or use an USB-extension cable which is not longer than 25 cm.

For safety reasons, do not remove any covers or attempt to gain access to the inside of the product. Refer any servicing to qualified personnel.

Do not attempt to remove any screws, or open the casing of the unit; there are no user serviceable parts inside. Refer all servicing to qualified service personnel.

SAFETY INSTRUCTIONS

1. **Read Instructions** – All the safety and operating instructions must be read before the product is operated.
2. **Retain Instructions** – The safety and operating instructions should be kept with the product for future reference.
3. **Heed warnings** – All warnings on the product and in the operating instructions should be adhered to.
4. **Follow instructions** – All operating and users' instructions should be followed.
5. **Installation** – Install in accordance with the manufacturer's instructions.
6. **Power sources** – This product should be operated only from the type of power source indicated by the marking adjacent to the power cord entry. If you are not sure of the type of power supply to your home, consult your product dealer or local power company.
7. **Grounding or polarization** – the product is not required to be grounded. Ensure that the plug is fully inserted into the wall outlet or extension cord receptacle to prevent blade or pin exposure. Some versions of the product are equipped with a power cord fitted with a polarized alternating line plug (a plug having one blade wider than the other). This plug will fit onto the power outlet only one way. This is a safety feature. If you are unable to insert the plug fully into the outlet, try reversing the plug. If the plug should still fail to fit, contact your electrician to replace your obsolete outlet.

Do not defeat the safety purpose of the polarized plug. When using an extension power-supply cord or a power-supply cord other than that supplied with the appliance, it should be fitted with the appropriate molded plugs and carry safety approval appropriate to the country of use.
8. **Power cord protection** – Power-supply cords should be routed so that they are not likely to be walked on, kinked or pinched by items placed on or against them, paying particular attention to cords from plugs, receptacles and the point where they exit from the product.
9. **Overloading** – Do not overload wall outlets, extension cords, or multiple sockets, as this can result in a risk of fire or electric shock.
10. **Ventilation** – The product must be properly ventilated. Do not place the product on a bed, sofa, or other similar surface.

Do not cover the product with any items such as tablecloths, newspapers, etc.
11. **Heat** – The product should be situated away from heat sources such as radiators, heat registers, stoves, or other products, including amplifiers that produce heat. No naked flame sources, such as lighted candles, should be placed on the apparatus.
12. **Water and moisture** – To reduce the risk of fire or electric shock, do not expose the product to rain, dripping, splashing or excessive moisture such as in a sauna or bathroom. Do not use this product near water, for example, near a bathtub, washbowl, kitchen sink, laundry tub, in a wet basement or near a swimming pool (or similar).
13. **Object and Liquid Entry** – Never push objects of any kind into this product through openings, as they may touch dangerous voltage points or short-circuit parts that could result in a fire or electric shock. Never spill liquid of any kind on the product. Do not place any object containing liquid on top of the product.
14. **Cleaning** – Unplug the product from the wall outlet before cleaning. Dust in the woofer may be cleaned with a dry cloth.

If you wish to use an aerosol cleaning spray, do not spray directly on the cabinet; spray onto the cloth. Be careful not to damage the drive units.
15. **Attachments** – Do not use attachments not recommended by the product manufacturer, as they may cause hazards.

16. **Accessories** – Do not place this product on an unstable cart, stand, tripod, bracket or table. The product may fall, causing serious injury to a child or adult, and serious damage to the product. Use only with a cart, stand, tripod, bracket or table recommended by the manufacturer or sold with the product. Any mounting of the product should follow the manufacturer's instructions and should use a mounting accessory recommended by the manufacturer.
17. **Moving the product** – A product and cart combination should be moved with care. Quick stops, excessive force and uneven surfaces may cause the product and cart combination to overturn.
18. **Unused periods** – The power cord of the appliance should be unplugged from the outlet during lightning storms or when the apparatus is left unused for a long period of time.
19. **Servicing** – Do not attempt to service this product yourself, as opening or removing covers may expose you to dangerous voltage or other hazards. Refer all servicing to qualified service personnel.
20. Please remove the power plug from the main power source or wall power source when not in use. When plugged in to a power source, the system is in standby mode, so the power is not entirely cut off.
21. **Replacement parts** – When replacement parts are required, ensure that the service technician has used replacement parts specified by the manufacturer or have the same characteristics as the original part. Unauthorized substitutions may result in fire, electric shock or other hazards.
22. **Mains fuses** – For continued protection against fire hazard, use fuses only of the correct type and rating. The correct fuse specification for each voltage range is marked on the product.
23. Do not turn up the volume while listening to a section with very low level inputs or no audio signals. If you do, the speaker may be damaged when a peak level section is suddenly played.
24. The only means of completely disconnecting the product from the power supply is by removing the power cord from the wall outlet or the product. The wall outlet or the power cord entry to the product must remain freely accessible at all times while the product is in use.
25. Try to install the product near a wall socket or extension cord and shall be easily accessible.
26. The highest environmental temperature suitable for this product is 35°C.
27. **ESD hints** – If the product maybe reset or not reset to operation of control due to electrostatic discharge, just switch off and reconnect again, or move the product to another location.
28. **Battery**
 - The batteries must not be exposed to excessive heat such as sunshine, fire or the like.
 - The batteries should be drawn to the environmental aspects of battery disposal.
 - Battery usage **CAUTION**-to prevent battery leakage which may result in body injuries, property damage, or damage to the apparatus:
 - Install all batteries correctly, + and – as marked on the apparatus.
 - Do not mix batteries (old and new or carbon and alkaline, etc.)
 - Remove batteries when the unit is not used for a long time.

ERP2 (Energy Related Products) note

This product with ecodesign complies with the stage 2 requirements of Commission Regulation (EC) NO. 1275/2008 implementing Directive 2009/125/EC regard to standby and off mode electric power consumption of electronic household and office equipment. After 30 minutes without any audio input, the device will automatically switch into standby mode. Follow up the instruction manual to resume the operation.

Important note:

This device is equipped with an energy saving mode: if no signal is given during 30 minutes the device will switch automatically into standby mode in order to save energy (ERP 2 standard). Please note that low volume setting in the audio source may be recognized as "no audio signal": this will affect the capability of signal detection from the

device and can also originate an automatic switch into standby mode. If this happens please reactivate the audio signal transmission or increase the volume setting on the audio source player (MP3 player, etc.), in order to resume playback. Please contact the local service center if the problem remains.

WARNING

This appliance is not intended for use by persons (including children) with reduced physical sensory or mental capabilities, or lack of experience and knowledge, unless they have been given supervision or instruction concerning use of the appliance by a person responsible for their safety. Children should be supervised to ensure that they do not play with the appliance.

1. Never use the device unsupervised! Switch off the device whenever you are not using it, even if this only for a short while.
2. The appliance is not intended to be operated by means of an external timer or separate remote control system.
3. If the supply cord is damaged, it must be replaced by the manufacturer, its service agent or similarly qualified persons in order to avoid a hazard.
4. Before operating this system, check the voltage of this system to see if it is identical to the voltage of your local power supply.
5. The unit should not be impeded by covering the ventilation opening with items such as newspaper, table-cloths, curtains etc. Make sure that there are at least 20 cm of space above and at least 5 cm of space on each side of the unit.
6. The apparatus must not be exposed to dripping or splashing and that objects filled with liquids, such as vases, must not be placed on the apparatus.
7. To prevent fire or shock hazard, do not expose this equipment to hot places, rain, moisture or dust.
8. Do not locate this unit near any water sources e.g. taps, bathtubs, washing machines or swimming pools. Ensure that you place the unit on a dry, stable surface.
9. Do not place this unit close to a strong magnetic field.
10. Do not place the unit on a amplifier or receiver.
11. Do not place this unit in a damp area as the moisture will affect the life of electric components.
12. If the system is brought directly from a cold to a warm location, or is placed in a very damp room, moisture may condense on the lens inside the player. If this occurs, the system will not operate properly. Please leave the system turned on for about an hour until the moisture evaporates.
13. Do not attempt to clean the unit with chemical solvents as this might damage the finish. Wipe with a clean, dry or slightly damp cloth.
14. When removing the power plug from the wall outlet, always pull directly on the plug, never pull on the cord.
15. Depending on the electromagnetic waves used by a television broadcast, if a TV is turned on near this unit while it is also on, lines might appear on the TV screen. Neither this unit nor the TV is malfunctioning. If you see such lines, keep this unit well away from the TV set.
16. The mains plug is used as the disconnect device, the disconnect device must remain readily operable.
17. To prevent possible hearing damage, do not listen at high volume levels for long periods.



NOTICE



Hereby, Blaupunkt Competence Center 2N-Everpol Sp. z o.o., declares that this equipment is in compliance with the essential requirement and other relevant provisions of Directive 2014/53/EU.

Declaration of conformity can be obtained from the product page at www.blaupunkt.com.

Responsible party: 2N-Everpol Sp. z o.o, Puławska 403A, 02-801 Warsaw, Poland, Phone: +48 22 688 08 00, E-mail: info@everpol.pl



Your products is designed a manufactured with high-quality materials and components, which can be recycled and reused.



If there is a crossed-out bin symbol on your device, it means that the product is covered by the provisions of European Directive 2012/19/EU. Based on this, please follow local regulations and familiarize yourself with the requirements for your local electrical and electronic waste collection system and, in the case of this product, comply with them.

DO NOT DISPOSAL THIS PRODUCT WITH YOUR HOUSEHOLD WASTE!
THIS PRODUCT CONTAINS HAZARDOUS SUBSTANCES, MIXTURES AND COMPONENTS WHICH, IF UNAUTHORIZED, CAN BE A SOURCE OF POTENTIAL EFFECTS ON THE NATURAL ENVIRONMENT AND HUMAN HEALTH!

Correct disposal of the used product will prevent negative effects on the environment and human health.



Your product contains batteries covered by the European Directive 2006/66/EC, which cannot be dispose with normal household waste. Please inform yourself about the local rules on separate collection of batteries because correct disposal helps to prevent negative consequences for the environmental and human health.

Environmental information

All unnecessary packaging has been omitted. We have tried to make the packaging easy to separate into three materials: cardboard (box), polystyrene foam (buffer) and poly ethylene (bags, protective foam sheet). Your system consists of material which can be recycled and reused if disassembled by a specialized company. Please observe the local regulations regarding the disposal of packaging materials, exhausted batteries and old equipment. Recording and playback of material might require consent. See Copyright Act 1956 and The Performer's Protection Acts 1958 to 1972.

The Bluetooth® wordmark and logos are registered trademarks owned by Bluetooth SIG, Inc. and any use of such marks by us is under license. Other trademarks and trade names are those of their respective owners. Many thanks to select our model, please read and reference this manual carefully before operate the unit. Please keep the manual for future operation reference.

Control locations

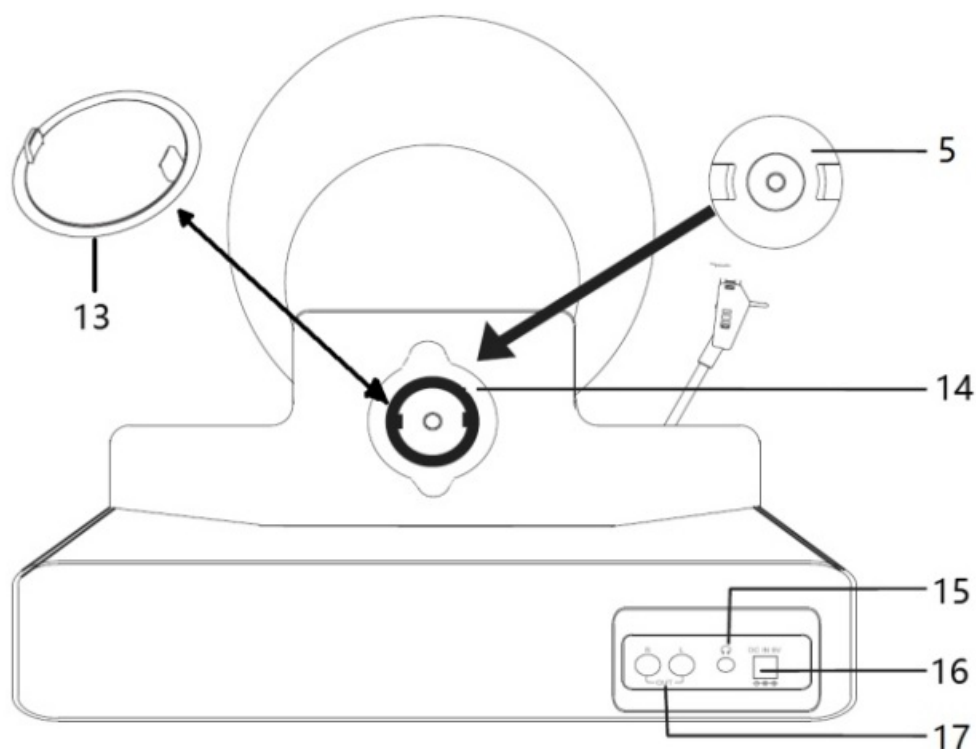
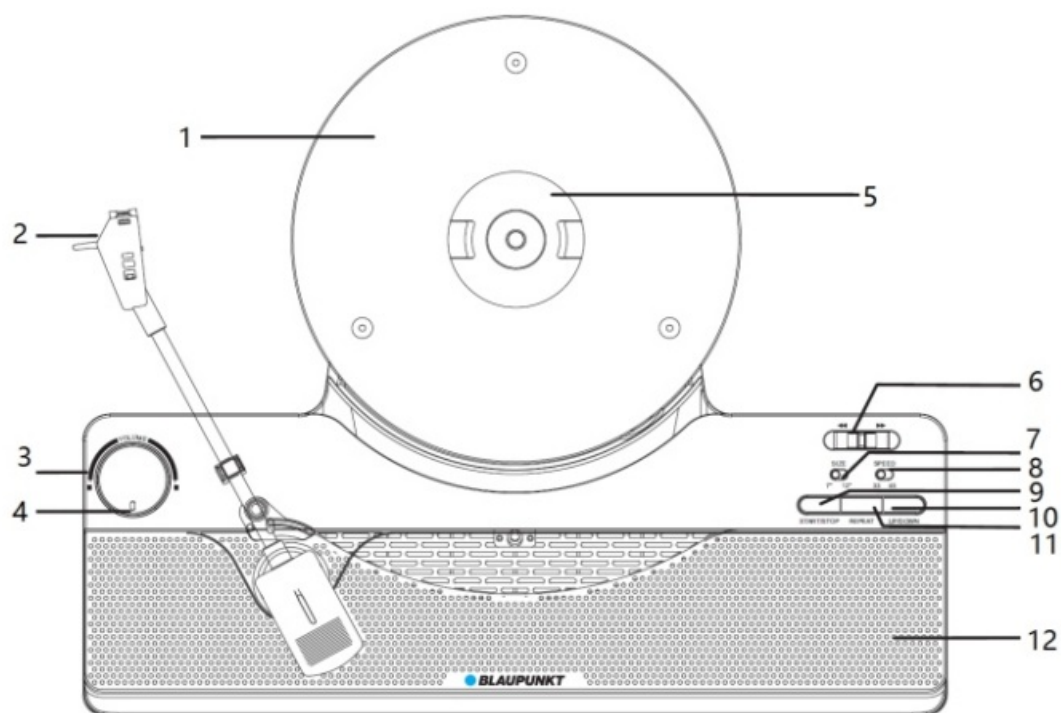

1. Record plate
2. Stylus
3. Function knob(power/mode/Volume)
4. Signal LED indicator. (White color = vinyl mode; blinker white color= vinyl stream(Bluetooth out); blue color=Bluetooth in)
5. Record fixator
6. Backward/forward selector
7. Record size selector for 7 or 12 inch
8. Speed selector (33rpm or 45rpm)
9. Start/stop button
10. Up/down button for tone arm

11. Repeat button
12. Speakers
13. Holder ring for 45RPM record
14. Record fixator storage cabinet
15. Headphone jack
16. DC IN power jack
17. RCA audio line out jack

Before start the operation, please loose the binding wire on tone arm, and remove the needle transparent protective cover gently(reference below drawing). Plug in the supplied AC/DC power adaptor to an AC household outlet in order to get power source, plug in the DC connector of power adaptor to DC input power jack on the rear panel,

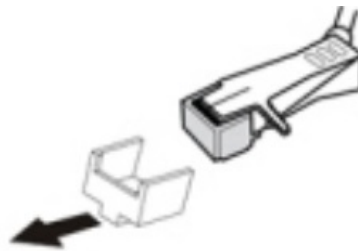

(Remove needle transparent protective cover)

Power on/switch play mode/volume adjustment: press down and hold the function knob 3 seconds to power on/off the unit; short press down the knob to switch the play mode between vinyl/vinyl stream (Bluetooth out)/Bluetooth(Bluetooth in). A relevant notice voice will come out from speaker when you switch the mode. Rotate this knob to decrease or increase the output volume.

General Notes

General notes regarding vinyl records:

1. Before starting to play a vinyl record, try to clean it of any dust or dirt particles. To do this, use a suitable brush, and in the case of larger dirt, use a special liquid for cleaning vinyl records. These accessories are not included in the set.
2. A dirty and dusty disc will have a major impact on the sound quality, which may result in crackling and minor distortions.
3. If the surface of the record is uneven (a common phenomenon with older records), this may cause the record to sway during playback and change the track path, which will affect the sound quality. Please note that this is not a defect of this turntable. To minimize this phenomenon, try to place the record properly on the platter and fix it securely using the record fixator.

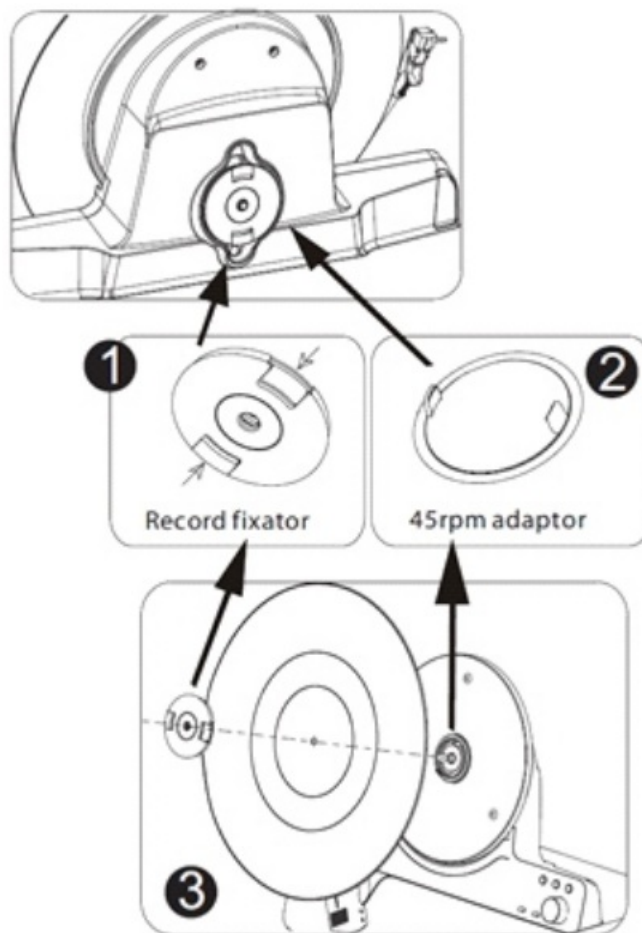

Play vinly record

Please follow up below step to play the record.

1. Power on the unit, short press the function knob repeatedly to enter the vinyl mode. The signal LED indicator will show in white color.
2. Hold and press the left and right lock button of record fixator in order loose it from record fixator storage cabinet on rear panel.
3. Gently mount and place your vinyl record on the record plate, then put on the record fixator and clip the hold pin in proper position in order to fix the record.
4. Select the correct record size and speed on the front panel.
5. Short press the play/stop button to start playing of the record. The tone arm will auto move to the edge of record for the 1st track playing. Press the button again to stop the playback, and the tone arm will go back to the arm holder automatically.
6. Push out the backward/forward selector to skip to the previous or next track; press the up/down button to suspend or lay down the tone arm.

Short press the repeat button to get the repeat playback function for record. The signal LED indicator will light up in green color. When the unit finish the playing, there will auto move and start to play the record from beginning. Press the button again to cancel the repeat function.

Play with 45RPM vinyl record: In case you have and play the 45RPM vinyl record, you have to use and mount the 45RPM holder ring on the turntable plate first. You can get and pick out the holder ring from the recorder fixator storage cabinet on rear panel. Please reference below drawing for operation.

Playing vinyl records with Bluetooth signal transmission to an external device (Bluetooth OUT): This model has a

Bluetooth OUT function, which allows wireless transmission of audio signal during vinyl record playback to external devices such as active Bluetooth speakers (e.g. BLAUPUNKT BS60, BS50, BS40 bookshelf speakers or others), Bluetooth headphones and other speakers with Bluetooth IN module. To start the audio signal transmission function to an external Bluetooth device, use the function knob (3) to select the vinyl record playback mode with Bluetooth signal transmission (the LED playback mode indicator should flash white, which means it is ready to pair with an external Bluetooth device, and the speaker will emit a sound message – “VINYL STREAM”). Turn on the external Bluetooth device and switch it to Bluetooth pairing mode (refer to the user manual of the external device for details), this turntable will automatically detect and connect to the external Bluetooth device. After successfully pairing with the external Bluetooth device, the LED indicator will stabilize and light up in white, and the speaker will emit an audio message – “CONNECTED”.

Then press the START/STOP button (9) to start playing the vinyl record, and the sound will be played through the external Bluetooth device.

Notes:

1. Please note that in this playback mode, the volume control is available on the connected external device, not on this turntable.
2. The optimal working distance between this turntable and the external Bluetooth device is 10 meters, without obstacles between the devices.

Bluetooth playback operation

This product includes Bluetooth function which can wireless playback the music from other Bluetooth device (like smart phone, tablet, TV etc).

1. Power on the unit, press the function knob repeatedly till the blue color signal LED indicator is blinkering which means the unit is ready to pair.
2. Enable the Bluetooth function on your device, and search the available device (please reference your device manual for operation), then check the available Bluetooth device on the list. Select “BP VT100” for pairing, and the white color signal LED will become stable after paired successful.
3. Select and play the music from your Bluetooth device, adjust the volume level properly, then the sound will come out from the speaker.
4. In Bluetooth playback mode, you should use your Bluetooth device for operational controlling.

Notices:

- All Bluetooth devices are not guaranteed for pairing successfully due to different design and brand.
- The best working distance of Bluetooth is within 10 meters without any obstacle in between.
- The unit only can pair and work with one Bluetooth device in one time.
- In case of an incoming phone call during Bluetooth playback; the music will stop temporary, and resume to playback after end the phone call.

RCA LINE OUT

- The Turntable provides one RCA line out jack which allow to wire connect with our external loudspeaker for playback. It is available on vinyl and Bluetooth mode.
- Using the RCA to RCA audio cable(not include) connect the RCA line out jack on Turntable with RCA line in

jack on your loudspeaker; switch to line in mode, and adjust the volume level on your external loudspeaker; select and play the music on the Turntable, then you can get sound output both on Turntable and external loudspeaker.

- In RCA line out playback, you only can control the volume level by the knob on Turntable and external loudspeaker separately. You can decrease the volume on Turntable in order to avoid overlap the sound from outsourcing loudspeaker.
- Headphone output: connect the headphone with headphone jack on rear panel can mute the sound from the Turntable, but headphone output only. Please adjust the volume level for listening.
- Using an appropriate cable, the signal from the headphone output can also be sent to the AUX input, e.g. in a micro system, active speakers, etc.
- In case you have Bluetooth headphone, you can try to connect and play with Turntable in vinyl stream mode (Bluetooth out). The connection is same as above content of this manual.

Replace the Stylus(AT3600L)

The stylus can last about 300 hours under normal using. It is recommended to replace the stylus as soon as you notice a change in sound quality.

Remove the Stylus from the cartridge

- Place your fingers at the tip of the stylus and push down to “A”.
- Pull the stylus out toward the direction “B”.

Note: When you are applying force to the Stylus, please take out it gently. The suddenly big force may damage or break the cartridge.

Install the Stylus

- Hold the tip of the stylus and insert the other edge by pressing toward the direction “C”.
- Push the stylus up toward the direction “D” until it locks at the tip.

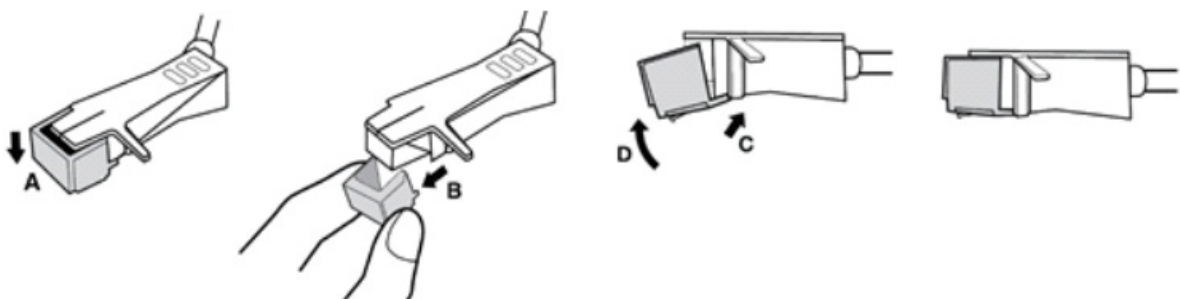

Caution:

1. Turn off the power before you replace the stylus. Do not remove or bend the stylus needle.
2. Sharp edges, do not touch the needle to avoid injury to your hand. Keep out of reach of children.



3. We recommend to have experienced or professional service person for the Stylus replacement.

Troubleshooting

1. The speaker cannot turn on.
 - Please check if the power connection is correct.
2. No sound output.
 - Please try to adjust the volume knob and check the play source.
 - please contact service center for support if the issue remained.
3. Sound distortion.
 - Please try to adjust and play the music at a lower volume level.
 - Please try to clean up your vinyl record, and retry.
4. The sound is sounding intermittently in Bluetooth mode.
 - Please try to move the Bluetooth device closer to speaker.
 - Please try to repair the speaker with Bluetooth device.

Specification

- Power source: DC IN, 9V/1.5A
 - RMS output: 2 x 5W, THD10%
 - Bluetooth version: V5.1
 - Bluetooth in/out work range: approx.10 meters
 - Transmission frequency: 2.402~2.480GHz
 - Protocols: A2DP/AVCTP/AVDTP/AVRCP/GAVDP/HFP/HID/OPP/RFCOMM/SPP Turntable rotation deviation:
axial run-out <0.6mm
 - Cartridge tracing force: 3.5 +/-0.5g
 - Cartridge model number: AT3600L, Audio Technica brand
 - Power consumption: 13.5W
 - Standby power consumption: <0.5W
- (Notes: the product spec may change without prior notice).

Power adaptor information

Information published	Value and precision	Unit
Manufacturer's name or trade mark Commercial registration number Address	Shenzhen Simsukian Electronics Technology CO., LTD The 5th plant, Jiayi Industrial Park, Daping Community, Guanlan Street, Longhua District, Shenzhen P.R. China	
Model identifier	SK01T8-0900150V	
Input voltage	100-240	V
Input AC frequency	50/60	Hz
Output voltage	DC9	V
Output current	1.5	A
Output power	13.5	W
Average active efficiency	≥84.845	%
Efficiency at low load (10 %)	82.18 %	%
No-load power consumption	≤0.049	W

Competence Center

2N-Everpol Sp. z o.o.

ul. Pulawska 403A

02-801 Warsaw, Poland phone: +48 22 688 08 00 e-mail: info@everpol.pl

www.blaupunkt.com

In case of questions or problems please contact our service.

Tel. 00 48 22 688 08 33 E-mail: info@blaupunkt-audio.pl

All rights reserved. All brand names are registered trademarks of their respective owners. Specifications are subject to change without prior notice.

This product has been manufactured and sold under the responsibility of 2N-Everpol Sp. z o.o .. BLAUPUNKT,

BLAUPUNKT logo, and the 1 OOEYEARS BLAUPUNKT logo are trademarks used under license by 2N-Everpol Sp. z o.o. -further information at brand.blaupunkt.com. All other products, services, companies, trademarks, trade or product names and logos referenced herein are the property of their respective owners.

Frequently Asked Questions

Q: Can I use the VT100BK/VT100SL in a bathroom?

A: No, the turntable should not be placed in a humid atmosphere such as a bathroom.

Q: Can I connect the VT100BK/VT100SL to other stereo equipment?

A: Avoid placing the turntable on top of other stereo equipment that radiates excessive heat to prevent damage.

Q: Is it safe to operate the turntable near candles?

A: No, do not place the turntable near candles or other naked flames for safety reasons.

Documents / Resources

	<p>BLAUPUNKT VT100BK Vertical Turntable With Bluetooth In Out [pdf] Owner's Manual VT100BK, VT100SL, VT100BK Vertical Turntable With Bluetooth In Out, VT100BK, Vertical Turntable With Bluetooth In Out, Bluetooth In Out</p>
---	--

References

- [Home - Blaupunkt](#)
- [User Manual](#)

Manuals+, Privacy Policy

This website is an independent publication and is neither affiliated with nor endorsed by any of the trademark owners. The "Bluetooth®" word mark and logos are registered trademarks owned by Bluetooth SIG, Inc. The "Wi-Fi®" word mark and logos are registered trademarks owned by the Wi-Fi Alliance. Any use of these marks on this website does not imply any affiliation with or endorsement.