



# BLAUPUNKT MS12BT Bluetooth CD Micro System with FM and USB Owner's Manual

[Home](#) » [Blaupunkt](#) » [BLAUPUNKT MS12BT Bluetooth CD Micro System with FM and USB Owner's Manual](#) 

## Contents

- [1 BLAUPUNKT MS12BT Bluetooth CD Micro System with FM and USB](#)
- [2 OVERVIEW](#)
- [3 IMPORTANT SAFETY INSTRUCTIONS](#)
- [4 Explanation of Graphical Symbols:](#)
- [5 SAFETY INSTRUCTIONS](#)
- [6 COMPACT DISC MAINTENANCE](#)
- [7 Environmental information](#)
- [8 General operation](#)
- [9 Specification](#)
- [10 Troubleshooting](#)
- [11 Documents / Resources](#)
- [12 Related Posts](#)



**BLAUPUNKT MS12BT Bluetooth CD Micro System with FM and USB**



## OVERVIEW

Thanks for your purchase of our product. Please read through this manual before making connections and operating this product. Retain this manual for future reference.

### Features:

- Compatible with CD, MP3, CD-R, CD-RW, etc.
- USB playback
- Full function remote
- FM radio
- Bluetooth for audio streaming playback function
- **Note:** The player is not compatible with all discs; Some of the discs could not read, caused by the disc is dirty, disc of poor quality, etc.

### What do you get from the package?

- 1 pcs x instruction manual.
- 1 pcs x main unit.
- 2 pcs x satellite speaker
- 1 pcs x remote control
- 1 x AAA battery.

## IMPORTANT SAFETY INSTRUCTIONS

**Caution:**

To reduce the risk of electric shock, do not dismantle the product and do not expose the apparatus to rain or moisture. No user-serviceable parts inside. Refer servicing to qualified personnel only.

**Explanation of Graphical Symbols:**

- The lightning flash within an equilateral triangle is intended to alert you to the presence of uninsulated dangerous voltage within the product's enclosure that may be of sufficient magnitude to constitute an electric shock to a person or persons.
- The exclamation point within an equilateral triangle is intended to alert you to the presence of important operating and maintenance (servicing) instructions in the literature accompanying the product.
- This mark indicates this unit belongs to the class 1 laser product. The laser beam may produce radiation harm to the directly touching human body

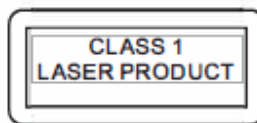

To achieve the utmost in enjoyment and performance, and in order to become familiar with its features, please read this manual carefully before attempting to operate this product. This will assure you years of trouble free performance and listening pleasure.

**Important Notes**

This safety and operating instruction should be retained for future reference.

- The apparatus should not be exposed to dripping or splashing or placed in a humid atmosphere such as a bathroom.
- Do not install the product in the following areas:
  - .Places exposed to direct sunlight or close to radiators.
  - .On top of other stereo equipment that radiates too much heat.
  - .Blocking ventilation or in a dusty area.

- .Areas where there is constant vibration.
- .Humid or moist places.
- Do not place near candles or other naked flames.
- Operate the product only as instructed in this manual.
- Before turning on the power for the first time, make sure the power adaptor is properly connected.

For safety reasons, do not remove any covers or attempt to gain access to the inside of the product. Refer any servicing to qualified personnel. Do not attempt to remove any screws, or open the casing of the unit; there are no user-serviceable parts inside. Refer all servicing to qualified service personnel.

## SAFETY INSTRUCTIONS

1. **Read Instructions** -All the safety and operating instructions must be read before the product is operated.
2. **Retain Instructions** -The safety and operating instructions should be kept with the product for future reference.
3. **Heed warnings** – All warnings on the product and in the operating instructions should be adhered to.
4. **Follow instructions** -All operating and users' instructions should be followed.
5. **Installation** – Install in accordance with the manufacturer's instructions.
6. **Power sources** -This product should be operated only from the type of power source indicated by the marking adjacent to the power cord entry. you are not sure of the type of power supply to your home, consult your product dealer or local power company.
7. **Grounding or polarization** – the product is not required to be grounded. Ensure that the plug is fully inserted into the wall outlet or extension cord receptacle to prevent blade or pin exposure. Some versions of the product are equipped with a power cord fitted with a polarized alternating line plug (a plug having one blade wider than the other). This plug will fit onto the power outlet only one way. This is a safety feature. If you are unable to insert the plug fully into the outlet, try reversing the plug. If the plug should still fail to fit, contact your electrician to replace your obsolete outlet. Do not defeat the safety purpose of the polarized plug. When using an extension power-supply cord or a power-supply cord other than that supplied with the appliance, it should be fitted with the appropriate molded plugs and carry safety approval appropriate to the country of use.
8. **Power cord protection** -Power-supply cords should be routed so that they are not likely to be walked on, kinked or pinched by items placed on or against them, paying particular attention to cords from plugs, receptacles and the point where they exit from the product.
9. **Overloading** – Do not overload wall outlets, extension cords, or multiple sockets, as this can result in a risk of fire or electric shock.
10. **Ventilation** – The product must be properly ventilated. Do not place the product on a bed, sofa, or another similar surface. Do not cover the product with any items such as tablecloths, newspapers, etc.
11. **Heat** – The product should be situated away from heat sources such as radiators, heat registers, stoves, or other products, including amplifiers that produce heat. No naked flame sources, such as lighted candles, should be placed on the apparatus.
12. **Water and moisture** – To reduce the risk of fire or electric shock, do not expose the product to rain, dripping, splashing or excessive moisture such as in a sauna or bathroom. Do not use this product near water, for example, near a bathtub, washbowl, kitchen sink, laundry tub, in a wet basement or near a swimming pool (or similar).
13. **Object and Liquid Entry**- Never push objects of any kind into this product through openings, as they may

touch dangerous voltage points or short circuit parts that could result in a fire or electric shock. Never spill liquid of any kind on the product. Do not place any object containing liquid on top of the product.

14. **Cleaning** – Unplug the product from the wall outlet before cleaning. Dust in the woofer may be cleaned with a dry cloth. If you wish to use an aerosol cleaning spray, do not spray directly on the cabinet; spray onto the cloth. Be careful not to damage the drive units.
15. **Attachments** – Do not use attachments not recommended by the product manufacturer, as they may cause hazards.
16. **Accessories** – Do not place this product on an unstable cart, stand, tripod, bracket or table. The product may fall, causing serious injury to a child or adult, and serious damage to the product. Use only with a cart, stand, tripod, bracket, or table recommended by the manufacturer or sold with the product. Any mounting of the product should follow the manufacturer's instructions and should use a mounting accessory recommended by the manufacturer.
17. **Moving the product** – A product and cart combination should be moved with care. Quick stops, excessive force, and uneven surfaces may cause the product and cart combination to overturn.
18. **Unused periods** – The power cord of the appliance should be unplugged from the outlet during lightning storms or when the apparatus is left unused for a long period of time.
19. **Servicing**- Do not attempt to service this product yourself, as opening or removing covers may expose you to dangerous voltage or other hazards. Refer all servicing to qualified service personnel.
20. Please remove the power plug from the main power source or wall power source when not in use. When plugged into a power source, the system is in standby mode, so the power is not entirely cut off.
21. Replacement parts -When replacement parts are required, ensure that the service technician has used replacement parts specified by the manufacturer or have the same characteristics as the original part. Unauthorized substitutions may result in fire, electric shock or other hazards.
22. **Mains fuses** – For continued protection against fire hazards, use fuses only of the correct type and rating. The correct fuse specification for each voltage range is marked on the product.
23. Do not turn up the volume while listening to a section with very low-level inputs or no audio signals. If you do, the speaker may be damaged when a peak level section is suddenly played.
24. The only means of completely disconnecting the product from the power supply is by removing the power cord from the wall outlet or the product. The wall outlet or the power cord entry to the product must remain freely accessible at all times while the product is in use.
25. Try to install the product near a wall socket or extension cord and shall be easily accessible.
26. The highest environmental temperature suitable for this product is 35°C.
27. **ESD hints** – The normal function of the product may be disturbed by strong Electro-Magnetic Interference. If so, simply reset the product to resume normal operation by following the instruction manual. In case the function could not resume, please use the product in another location.

## 28. **Battery**

The batteries must not be exposed to excessive heat such as sunshine, fire or the like.

The batteries should be drawn to the environmental aspects of battery disposal.

Battery usage CAUTION-to prevents battery leakage which may result in bodily injuries, property damage, or damage to the apparatus:

Install all batteries correctly, + and – as marked on the apparatus.

Do not mix batteries (old and new or carbon and alkaline, etc.)

Remove batteries when the unit is not used for a long time.

## Bluetooth

The Bluetooth® word mark and logos are registered trademarks owned by Bluetooth SIG, Inc. and any use of such marks by us is under license. Other trademarks and trade names are those of their respective owners.

### ERP2 – (Energy Related Products) note

This product with ecodesign complies with the Stage 2 requirements of Commission Regulation (EC) NO. 1275/2008 implementing Directive 2009/125/EC regard to standby and off mode electric power consumption of electronic household and office equipment. After 60 minutes without any audio input, the device will automatically switch into standby mode. Follow up the instruction manual to resume the operation.

### Important note:

This device is equipped with an energy-saving mode: if no signal is given during 60 minutes the device will switch automatically into standby mode in order to save energy (ERP 2 standard). Please note that low volume setting in the audio source may be recognized as “no audio signal”: this will affect the capability of signal detection from the device and can also originate an automatic switch into standby mode. If this happens please reactivate the audio signal transmission or increase the volume setting on the audio source player (MP3 player, etc.), in order to resume playback. Please contact the local service center if the problem remains.

### Warning

This appliance is not intended for use by persons (including children) with reduced physical sensory or mental capabilities, or lack of experience and knowledge unless they have been given supervision or instruction concerning use of the appliance by a person responsible for their safety. Children should be supervised to ensure that they do not play with the appliance.

- To prevent possible hearing damage, do not listen at high volume levels for long time periods respectively a sudden high volume level.



- Never use the device unsupervised! Switch off the device whenever you are not using it, even if this only for a short while.
- The appliance is not intended to be operated by means of an external timer or separate remote control system.
- If the supply cord is damaged, it must be replaced by the manufacturer, its service agent or similarly qualified persons in order to avoid a hazard.
- Before operating this system, check the voltage of this system to see if it is identical to the voltage of your local power supply.

The unit should not be impeded by covering the ventilation opening with items such as newspaper, tablecloths, curtains etc. Make sure that there are at least 20 cm of space above and at least 5 cm of space on each side of the unit.

- The apparatus must not be exposed to dripping or splashing and objects filled with liquids, such as vases, must not be placed on the apparatus.
- To prevent fire or shock hazards, do not expose this equipment to hot places, rain, moisture or dust.

- Do not locate this unit near any water sources e.g. taps, bathtubs, washing machines or swimming pools. Ensure that you place the unit on a dry, stable surface.
- Do not place this unit close to a strong magnetic field.
- Do not place the unit on an amplifier or receiver.
- Do not place this unit in a damp area as the moisture will affect the life of electric components.
- If the system is brought directly from a cold to a warm location or is placed in a very damp room, moisture may condense on the lens inside the player. If this occurs, the system will not operate properly. Please leave the system turned on for about an hour until the moisture evaporates.
- Do not attempt to clean the unit with chemical solvents as this might damage the finish. Wipe with a clean, dry or slightly damp cloth.
- When removing the power plug from the wall outlet, always pull directly on the plug, never pull on the cord.
- The mains plug is used as the disconnect device, the disconnect device must remain readily operable.

## COMPACT DISC MAINTENANCE

1. Always use a compact disc bearing the mark as shown.
2. Notes on handling discs

Store discs in their case when not in use.

Do not touch the reflective recorded surface.

Do not stick paper or write anything on the surface.



### 1. Storage

Store the disc in its case.

Do not expose discs to direct sunlight or high temperatures, high humidity or dusty



### 1. Cleaning a disc

Should the disc become soiled, wipe off dust, dirt and fingerprints with a soft cloth.

The disc should be cleaned by wiping in a straight line from the center to the edge.

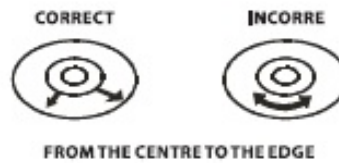

- Never use benzene, thinners, record cleaner fluid or anti-static spray.
- Be sure to keep the CD compartment door closed when not in use to keep it clean from dust and other contaminants.
- Do not touch the lens.

## NOTICE

- This product complies with the radio interference requirements of the European community.
- Your products is designed and manufactured with high-quality materials and components, which can be recycled and reused.
- When this crossed-out wheeled bin symbol is attached to a product it means that the product is covered by the European Directive 2002/96/EC. Please inform yourself about the local separate collection system for electrical and electronic products. Please cat according to your local rules and do not dispose of your old products with your normal household waste. Correct disposal of your old product helps to prevent potential negative consequences for the environment and human health.
- Your product contains batteries covered by the European Directive 2006/66/EC, which cannot be disposed of with normal household waste. Please inform yourself about the local rules on separate collection of batteries because correct disposal helps to prevent negative consequences for the environmental and human health.

## Environmental information

All unnecessary packaging has been omitted. We have tried to make the packaging easy to separate into three materials: cardboard(box), polystyrene foam(buffer) and polyethylene (bags, protective foam sheet). Your system consists of material that can be recycled and reused if disassembled by a specialized company. Please observe the local regulations regarding the disposal of packaging materials, exhausted batteries, and old equipment. Recording and playback of material might require consent. See Copyright Act 1956 and The Performer's Protection Acts 1958 to 1972.

### Control locations

#### Front & rear panel

1. Display,
2. stand by,
3. LED indicator,
4. Stop,
5. Sou rce,
6. Play/pause,
7. remote control sensor,
8. Eject,
9. Next



10. Volume +/-
11. Previous
12. CD disc tray
13. MP3 LINK
14. USB port
15. FM antenna
16. L/R
17. Power input

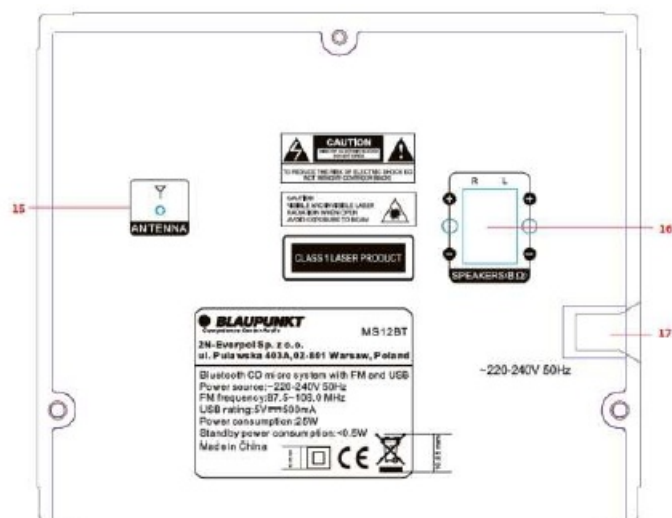
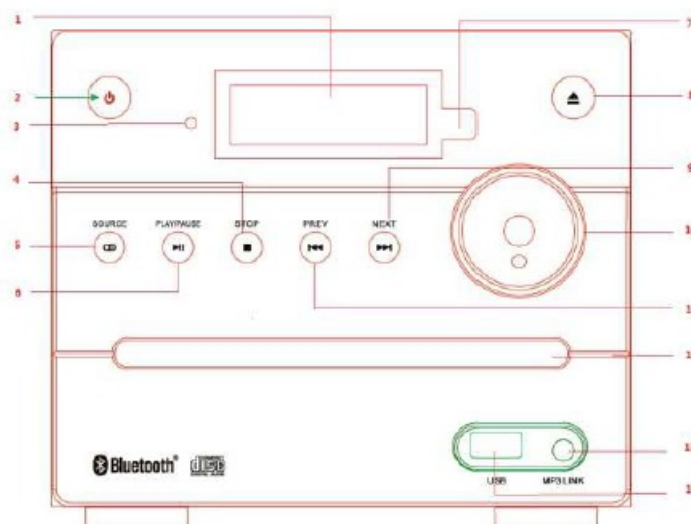

## Remote control

1. Standby/power,
2. Mute,
3. Play,
4. Previous,
5. Repeat,
6. Tone,
7. Volume -,

8. Digits button,
9. Search,
10. Save,
11. Eject,
12. Pause
13. Fast-rewind
14. Next
15. Stop
16. Fast-forward
17. Program
18. Volume +
19. Bluetooth, CD/USB,AUX,FM mode
20. Frequency
21. Mono/stereo

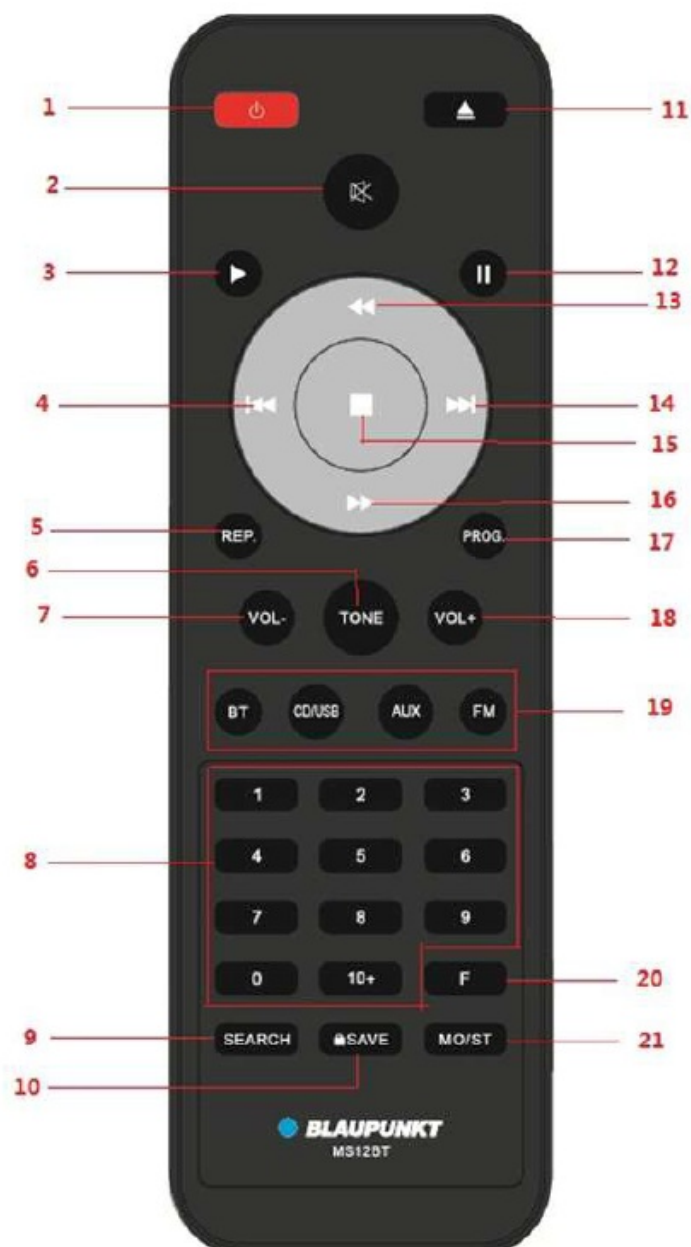

## Remote control battery installation

Before using the remote control, please make sure that you have installed the batteries(included) power inside. Please reference the below operation.

1. Open the battery door on the bottom of the remote control and insert 2 x AAA dry batteries into the compartment. Please pay attention to the polarity symbol and aim it accordingly.
2. Close the battery door and put the remote control sensor aim to the IR sensor during operation

#### **Notes:**

- The best working distance of remote control is within 5 meters without any obstacle, the working angle is +/- 30 degrees based on the IR sensor on the unit front panel.
- Please dispose of the exhausted battery in environmentally friendly. Please reference and check your local government requirements for the detail.

### **General operation**

#### **1. Speaker system connection and power on**

Before starting the audio playing, please connect the satellite speaker to the main unit's speaker output L/R terminals with their attached speaker wire. (Connect the black color speaker wire to "-" symbol jack, and rest color speaker wire to "+" symbol jack).

Connect the AC power plug to household AC power sourcing, then press the "power" button on front panel of unit, or remote control to power on the unit.

#### **2. Volume adjustment**

Press the Vol +/Vol – button can increase or decrease the volume output.

#### **3. Play mode selection**

Press the SOURCE button on the front panel or BT, CD/USB, AUX, FM button on the remote control can select the relative play mode.

#### **4. Mute, play/pause, stop**

Pressing the mute button on the remote control can make the speaker output in silence, and press again to resume the playing.

To Press the pause button for playing pause, and press the play button to resume the playing.

Press the stop button to stop the playback on CD mode.

#### **5. Repeat**

To press it for repeat one, repeat all tracks playback.

#### **6. Digits button**

Press the relative digit button to select the track and FM preset station.

#### **7. Fast-forward, Fast-rewind,**

Press it for fast-rewind or fast-forward the current playing track.

#### **8. previous and next button**

Press it to select the last and next track.

#### **9. Treble and bass adjustment**

Press the TONE button recycled to switch the EQ between "TREBLE" and "BASS". Then press the "VOL-" and "VOL+" buttons to adjust the treble or bass setting value. The speaker output sound will be changed accordingly.

### CD operation

The system includes CD playback function which allows you to play CD/-R/-RW/MP3 format disc. Before starting the CD playback, please make sure there is no scratch or dirty dot on the disc which impacts the playing sound quality. Power on the unit, and press the CD/USO button on the remote control, or the SOURCE button on the front panel of the unit in order enter to the CD playback mode.

1. CD program (FOR CD disc only): in CD playing mode, press the "STOP" button first, then press the "PROG" button and shows "P 0100" on display; Input the number of track that you want to be programmed (E.g. input "04", then the NO.4 track will be programmed as the first playing song). Then the display will skip and show "P 0200". Continuous to Input the relative track number till the display shows "full" in order to complete the track program. Then press the "PLAY" button to start the programmed track playing.

Pressing the "STOP" button twice can cancel the program operation.

To review the sequence of the programmed track, please press the "PROG." Button first, then press the "11 NEXT" for checking.

2. In CD playback mode, you can achieve the volume adjustment, mute, play/pause, repeat, fast-forward and fast-rewind, previous and next, and treble & bass adjustment function after pressing the relative button. You also can fast select the track by the digit button.

### FM radio operation

Before starting, the FM listening, please kindly fully extent the rear FM wire antenna or move the unit next to the window in order to get better FM reception. Power on the unit, press the FM button on the remote control or the SOURCE button on the front panel in order to enter FM mode.

1. **Autotune and preset (all-in-one):** short press the "SEARCH" button on the remote control can tune and save the available station automatically. The unit can save up to 30 preset stations.
2. **Auto-scan and manual tune:** Short press the "fast-rewind" and "fast-forward" buttons on the remote control can increase or decrease the FM frequency per 0.05MHz. Press and hold the button in 2 seconds can auto-scan the available station.
3. **Station memory:** if you want to save 99.70MHz as the NO.15 preset station, please input "1,5" from the digit button on the remote control, then press the "F" button and input the frequency number "9,9,7,0"; and press the SAVE button at last. Then the station will be saved as preset station NO.15.
4. **Get a specific frequency station:** in order to get a specific frequency station, you can input the frequency directly by the digit button on the remote control. For example, you want to listen to the radio frequency at "104.3 MHz", you just need to press the F button on the remote control first, then key in 1-4-3 by the digit button of the remote control. Then the unit will skip and play the defined station.
5. **Preset station picking up:** short press the "Previous" or "Next" button on the remote control or the front panel can pick up the preset station; Or input the preset station number by digit button on the remote control for picking up. For example, you want to listen to the preset station number 12, please just key in 1-2 by remote control, then the related station will be played.

**Tips:** In FM radio mode, if there have any background noise on the station, please try to press the "MO/ST" button on the remote control switch to mono speaker output which may reduce the background noise.

### USB playback operation

Before starting the playing, please copy MP3 format music and insert the USB device into the USB port, press the CD/USB button on the remote control or the SOURCE button on the front panel to enter the USB mode. The unit will auto-detect the device and start playing. In CD playback mode, you can achieve the volume adjustment, mute,

play/pause, repeat, fast-forward and fast-rewind, previous and next track, and treble & bass adjustment function after pressing the relative button.

#### **Notes:**

- Depending on the amount of data and media, it may take longer for the unit to read out the USB device. In some cases, the reading time may up to 60 seconds. This is not a malfunction.
- Using a USB extension cable for playing connection is not recommended which may impact the audio data transfer, and cause the sound output intermittently.
- Even when the files are in a support MP3 format, some may not play or display depending on the compatibility.
- The maximum supported capacity of a USB device is up to 32GB.

#### **Bluetooth operation:**

The unit includes a Bluetooth function that allows you to wireless playback the music from your Bluetooth device. Please reference below for operation.

1. Press the BT or SOURCE button to enter Bluetooth mode.
2. Enable the Bluetooth function on your Bluetooth device (please reference your device user manual for the operation), and check the available Bluetooth device on the menu list of your device. Please select" BP MS 12BT" on list(please input "0000" in case of POP password request). Then your device will start to pair the speaker system.
3. Please select the music from your Bluetooth device and start the playing, then the audio will output from the speaker system.
4. You can press the "Next/Previous" button to select the track, and press the "play/pause" button for playback operation.

#### **Note:**

- Some devices may pair and connect immediately; some may take a longer time due to different brands and designed Bluetooth products.
- The unit only can pair and playback with one device at one time.
- The best working distance of Bluetooth is within 10 meters. You can try to move your Bluetooth device close to the unit in case of sound output intermittently.
- To connect to another Bluetooth device, you have to turn off the Bluetooth function on your current device. Then reference above for operation.

#### **AUX IN/MP3 LINK playback operation**

Using the 3.5mm to 3.5mm stereo audio cable connect with the line out jack of your player (E.g. mp3 player etc), and connect another terminal of the audio cable to the MP3 LINK jack on the front panel of the unit, then press the AUX button on the remote control or SOURCE button on front panel enter to the AUX IN mode. Select the music and start the playing from your player, then adjust the volume of the unit. The music will output from the microsystem speaker. Please kindly note the main control is from your player in AUX IN mode. You can adjust the volume from the microsystem.

#### **Specification**

- Power source: ~220V-240v, 50Hz

- CD: compatible to CD/-R/-RW/MP3.
- FM radio frequency: 87.5~108.0MHz
- Bluetooth version: 2.1 + EDR
- USB rating: SV/S00mA
- USB support device: up to 30GB max.
- RMS output: 2 x 1 OW
- Power consumption: 25W
- Standby power consumption: <0.5W

## Troubleshooting

### 1. There is no sound from the speaker

Check if the volume was turned up;

Check if the speaker was connected with the main unit properly;

Control the local service center for support if the issue still remains;

### 2. The sound is distorted

Please try to turn the volume a little down.

Please try to adjust the bass and treble setting.

### 3. Background noise on FM ration station

Please try to extend and adjust the antenna direction, or move the unit next to the window for better signal reception.

Please turn to another station for listening.

### 4. There have unexpected noise in CD playing

Please try to clean the CD disc and replay it.

### 5. The sound is intermittent output in Bluetooth mode

Please try to move your Bluetooth device close to the speaker.

Please turn off the Bluetooth function and re-pairing.

## Documents / Resources

	<p><a href="#">BLAUPUNKT MS12BT Bluetooth CD Micro System with FM and USB</a> [pdf] Owner's Manual MS12BT, Bluetooth CD Micro System with FM and USB, MS12BT Bluetooth CD Micro System with FM and USB, FM and USB</p>
---	--