



BLAUPUN Linear User Manual

[Home](#) » [BLAUPUN](#) » BLAUPUN Linear User Manual 



Enjoy it.

Blaupunkt Linear IP65 Installation and Operation Manual

Please read the following instructions carefully to ensure that the mounting operation will be carried out in the right way. These instructions should be properly preserved for future reference.

Contents

[1 SPECIFICATIONS](#)

[2 SAFETY TIPS](#)

[3 Documents /
Resources](#)

[4 Related Posts](#)

SPECIFICATIONS

Data/Item	BLAUPUNKT-LH-18-NW	BLAUPUNKT-LH-36-NW	BLAUPUNKT-LH-50-NW
RATED WORKING VOLTAGE	220-240 Vac / 50-60 Hz		
Wattage	18W	36W	50W
protection class II	II		
Protection	IP65		

SAFETY TIPS

1. Use HO7RN-F, 2×1.0mm² rubber cable.
2. Luminaire should be installed by authorized electrician only acc to national wiring rules. If the external flexible cable or cord of this luminaire is damaged, it shall be exclusively replaced by the manufacturer or his service agent or similar qualified person in order to avoid a hazard.
3. The power supply must be deactivated prior to assembly, maintenance, exchanging the lamp or cleaning processes. Remove the fuse or switch the fuse to OFF and secure from reactivation.
4. Open the terminal box.
5. Connect brown wire(L) to terminal L., blue wire (N) to terminal N.
6. Reinstall the terminal box, note that the terminal box must be installed in the correct position.

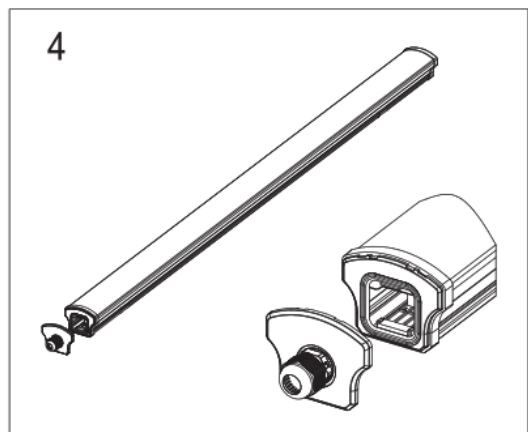
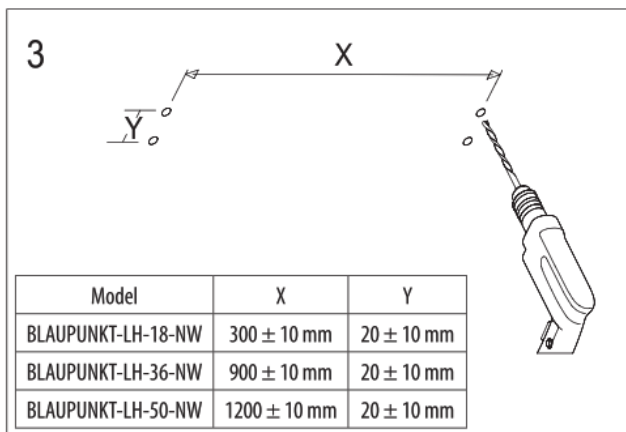
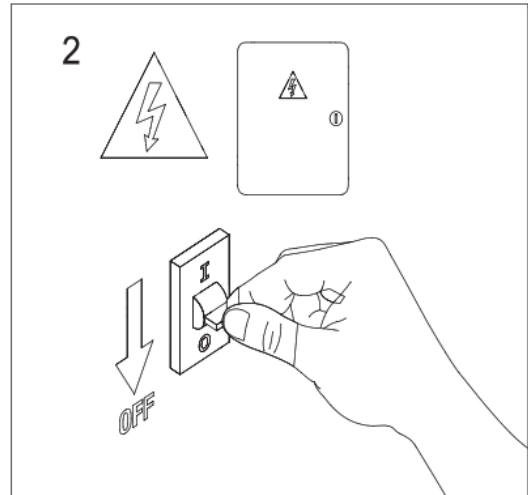
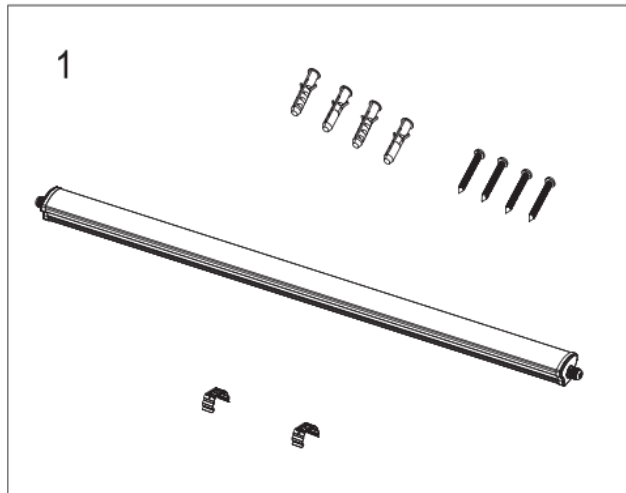
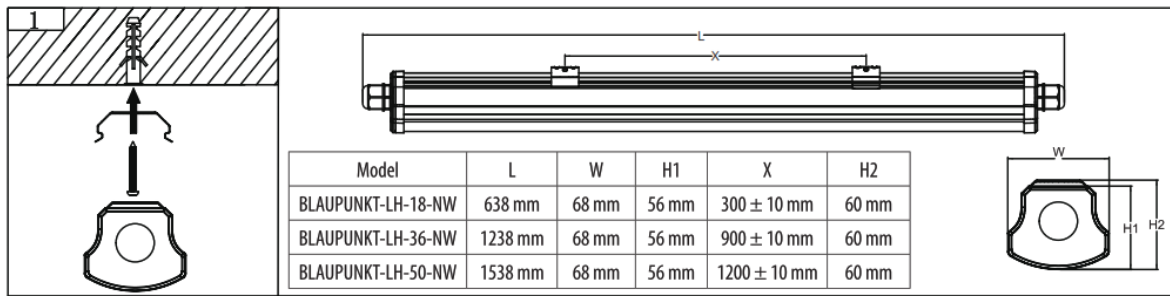

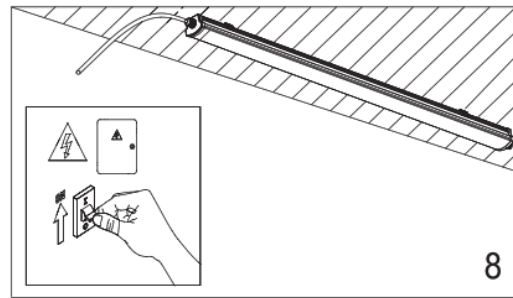
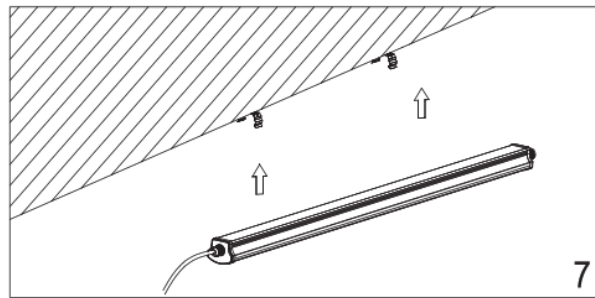
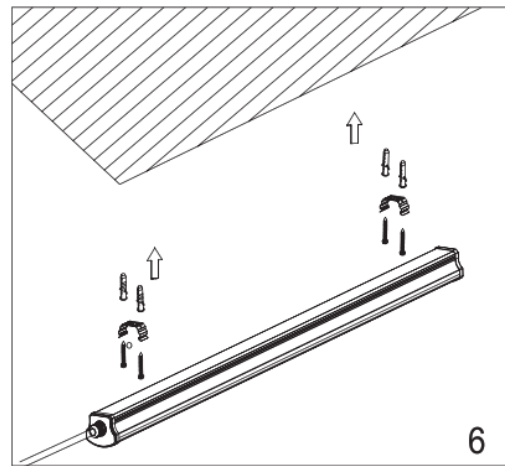
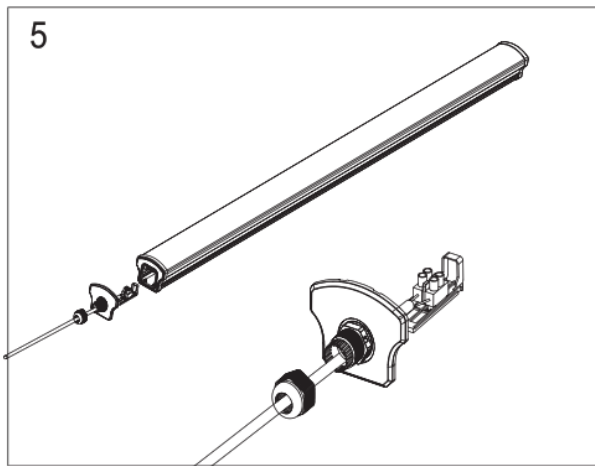

Documents / Resources

<p>BLAUPUNKT</p> <p>User Manual Instrukcja obsługi</p>  <p>Enjoy it.</p>	<p>BLAUPUNKT Linear [pdf] User Manual Linear, IP65</p>
--	--