



BLAISE V8S Bluetooth 5.3 Motorcycle Helmet Intercom User Manual

[Home](#) » [BLAISE](#) » BLAISE V8S Bluetooth 5.3 Motorcycle Helmet Intercom User Manual 

BLAISE

BLAI SE V8S User Manual



Contents

- 1 Product overview
- 2 Power on/off/voice switching
- 3 Intercom pairing
- 4 Bluetooth connection
- 5 Telephone function
- 6 Music features
- 7 Charging mode
- 8 Intercom function
- 9 List of items
- 10 Things to note
- 11 Product specifications
- 12 Documents / Resources
 - 12.1 References
- 13 Related Posts

Product overview

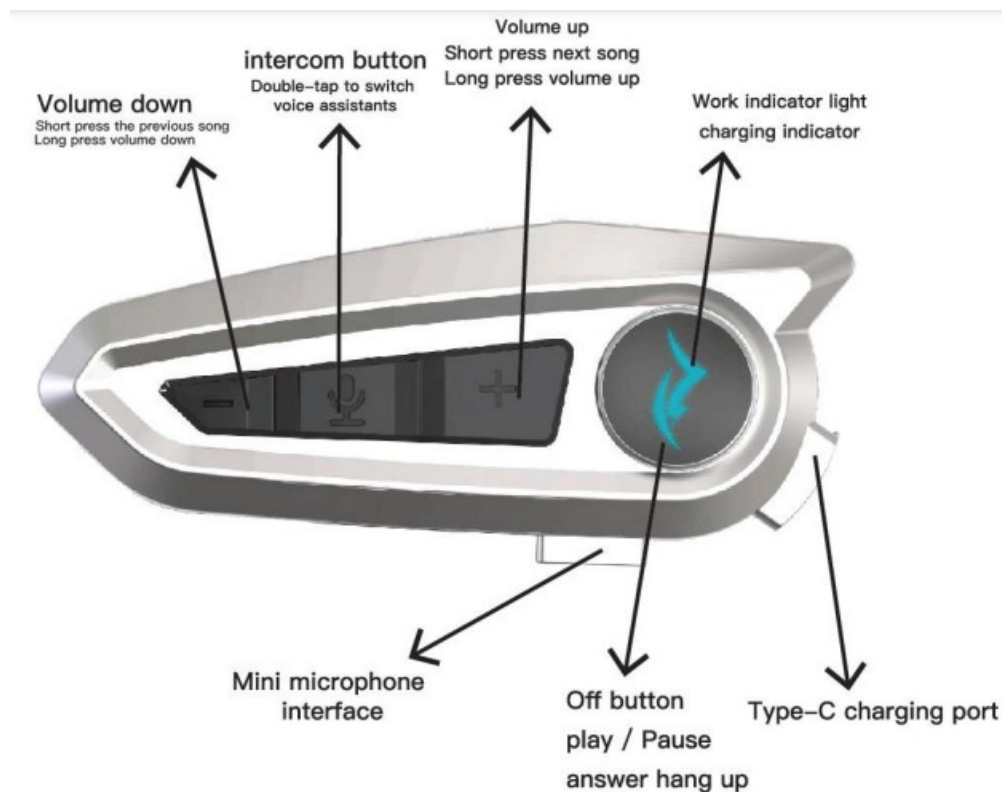

Important reminder:

If there is a big difference in the sound effect and volume after being installed 'on the helmet, please adjust the position of the speaker inside the helmet.

Power on/off/voice switching

Double-click to switch between Chinese and English voice broadcast (disconnect Bluetooth)

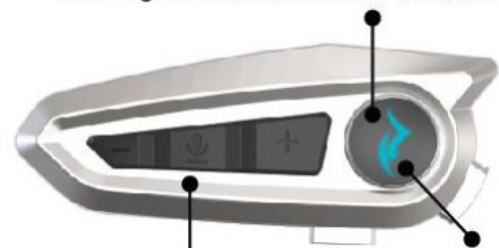

Double click to wake up the voice assistant (connected to Bluetooth)

Long press for 3 seconds to turn on

→
Boot sound



LED light flashes quickly

Intercom pairing



Short press the intercom button

Light flashes quickly when not connected

))) Before connecting to Bluetooth



Short press successfully, green light accompanied by blue light

Light flashes quickly when not connected

After the two machines are tuned on and before Bluetooth is connected, click the Intercom button on either machine to enter the intercom mode, Click again to exit the Intercom mode. Press and held to switch the intercom: transmitting and receiving modes for intercom pairing After successful pairing, the light flashes blue and green quickly, and you can enter the Intercom call.

Bluetooth connection



Bluetooth not connected
Light flashes quickly



Bluetooth mode
prompt sound



Bluetooth connection successful
LED light flashes slowly

Telephone function

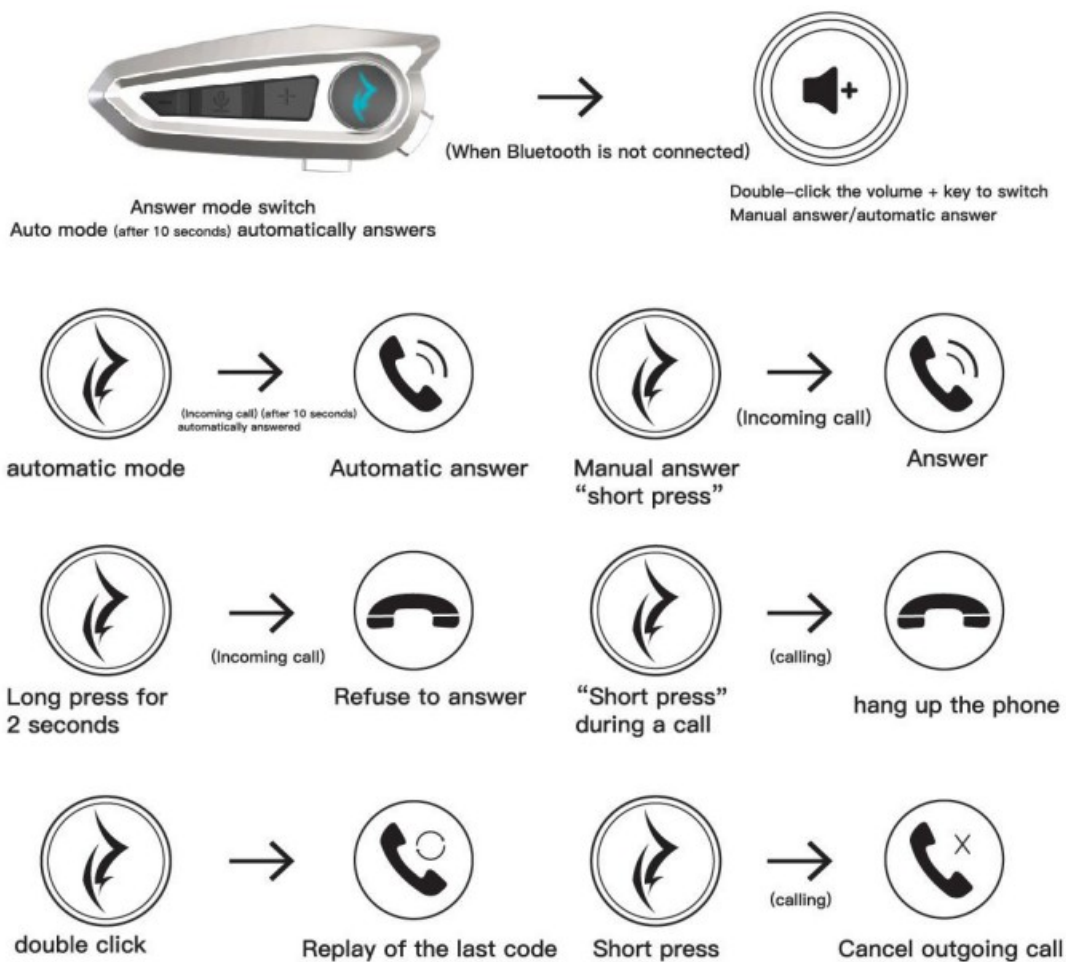

Music features

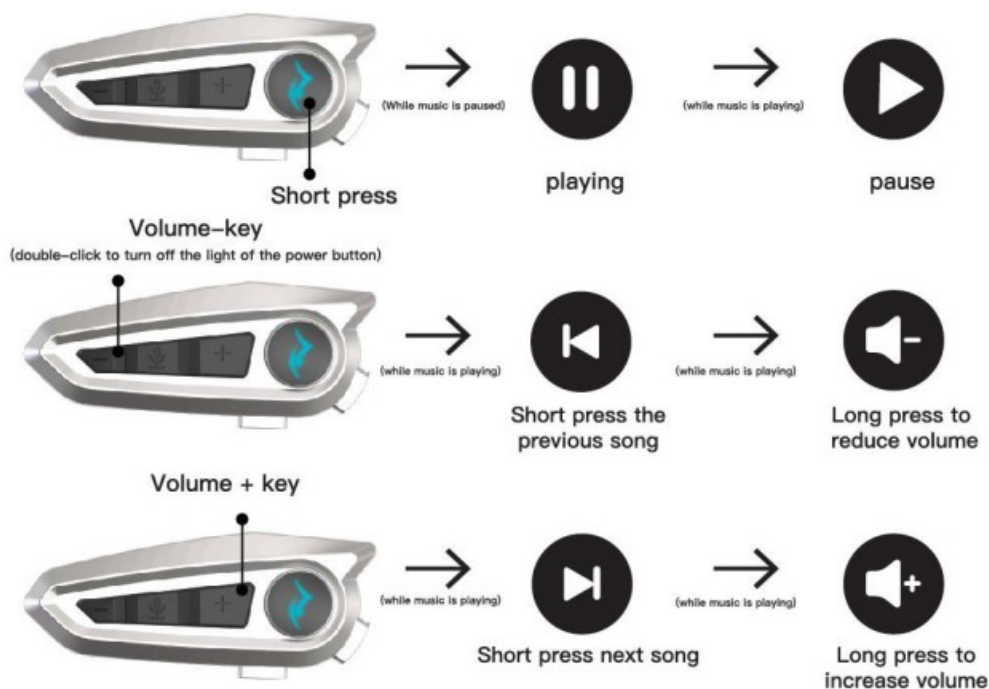

Charging mode

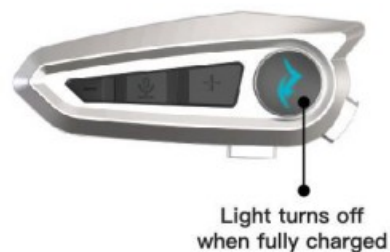
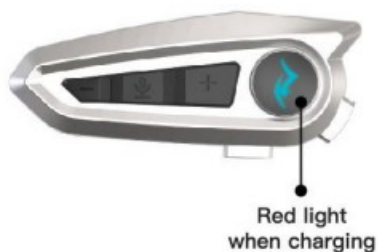

Intercom function



Introduction to Bluetooth intercom connection operation:

Operation of intercom mode: Click the intercom button to enter the launch mode, while the other one needs to first click to enter the launch mode and then long press to switch to the acceptance mode. Intercom connection conditions: One machine needs to be in intercom reception mode and one machine needs to be in intercom transmission mode in order to pair.

Two machines are connected for the first time for intercom: After the machine is turned on, without Bluetooth connection, short press the intercom button to enter intercom mode. At this time, long press and hold one of the intercom buttons to enter intercom transmission mode, and intercom pairing can be carried out.

When the walkie-talkie connection between the two devices is successful, and Bluetooth is also connected to a mobile phone, the system will automatically switch to phone call reception when there is an incoming call. After ending the phone call, the walkie-talkie functionality will automatically resume.

List of items



①V8S host*1

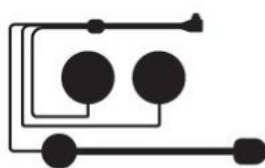

②Speaker microphone*1



③Clip type*2



④Screws



⑤Speaker Velcro*1

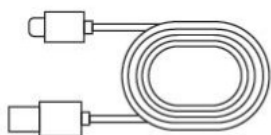

⑥Type-C charging cable



⑦Mini microphone Velcro*1



⑧Instruction Manual*1

Things to note

1. Do not put the product into an open flame to avoid explosion;
2. Please do not get close to sharp objects, which may cause damage to the product;

3. Please do not disassemble the product to avoid damage to the product's electronic components;
4. If not used for a long time, please place in a dry place.

Product specifications

Product Name:	BLAISE
Bluetooth version:	5.
Host weight:	50g (± 5g)
Host size:	110mm * 46.6mm * 24mm
Battery capacity:	1500mAh
Charging time:	2.5 >
Working hours:	about 14 hours
Waterproof grade:	IP67

This device complies with part 15 of the FCC Rules. Operation is subject to the following two conditions: (1) This device may not cause harmful interference, and (2) this device must accept any interference received, including interference that may cause undesired operation. Any changes or modifications not expressly approved by the party responsible for compliance could void the user's authority to operate the equipment.

NOTE: This equipment has been tested and found to comply with the limits for a Class B digital device, pursuant to Part 15 of the FCC Rules. These limits are designed to provide reasonable protection against harmful interference in a residential installation. This equipment generates, uses and can radiate radio frequency energy and, if not installed and used in accordance with the instructions, may cause harmful interference to radio communications. However, there is no guarantee that interference will not occur in a particular installation. If this equipment does cause harmful interference to radio or television reception, which can be determined by turning the equipment off and on, the user is encouraged to try to correct the interference by one or more of the following measures:

- Reorient or relocate the receiving antenna.
- Increase the separation between the equipment and receiver.
- Connect the equipment into an outlet on a circuit different from that to which the receiver is connected.
- Consult the dealer or an experienced radio/TV technician for help.

The device has been evaluated to meet general RF exposure requirement. The device can be used in portable exposure condition without restriction.

Documents / Resources

	BLAISE V8S Bluetooth 5.3 Motorcycle Helmet Intercom [pdf] User Manual V8S Bluetooth 5.3 Motorcycle Helmet Intercom, V8S, Bluetooth 5.3 Motorcycle Helmet Intercom , 5.3 Motorcycle Helmet Intercom, Motorcycle Helmet Intercom, Helmet Intercom, Intercom
---	--

References

- [User Manual](#)

[Manuals+](#), [Privacy Policy](#)

This website is an independent publication and is neither affiliated with nor endorsed by any of the trademark owners. The "Bluetooth®" word mark and logos are registered trademarks owned by Bluetooth SIG, Inc. The "Wi-Fi®" word mark and logos are registered trademarks owned by the Wi-Fi Alliance. Any use of these marks on this website does not imply any affiliation with or endorsement.