



Contents [[hide](#)]

- [1 BLACKVUE ELITE Series LTE GPS WiFi Filters Remote Button](#)
- [2 Product Specifications](#)
- [3 Product Usage Instructions](#)
- [4 FAQs](#)
- [5 Documents / Resources](#)
 - [5.1 References](#)



BLACKVUE ELITE Series LTE GPS WiFi Filters Remote Button



Product Specifications

- **Product Model Name:** Remote Button EB-1B
- **Connectivity:** 2.4GHz Wireless Technology
- **Dimensions:** 45 x 42 x 14.5 mm / 1.77 x 1.65 x 0.57 in.
- **Net Weight:** 23g (1oz)
- **Battery:** CR2450 (DC 3.0V, 620mAh)

Product Usage Instructions

Pairing the Remote Button with your Dash Cam

Fleet Plan users should complete registration via the Fleeta App.

1. **Step 1:** Go to Camera Settings > Event Trigger > Manual Recording in the BlackVue App.
2. **Step 2:** Click Register in the Remote Button menu to pair it with your Dash Cam.
3. **Step 3:** Press the Remote Button and confirm the beep sound from the BlackVue ELITE.
4. **Step 4:** Confirm the registration is complete. For a more detailed guide, scan the QR code.

FCC ID: YCK-EB1B / IC:23402-EB1B / HVIN: EB-1B

- **Product** Remote Button
- **Model Name** EB-1B
- **Specification** Connectivity: 2.4GHz Wireless Technology Dimensions: 45 x 42 x 14.5 mm / 1.77 x 1.65 x 0.57 in. Net Weight: 23g (≈1oz)
- **Battery:** CR2450 (DC 3.0V, 620mAh)
- **Compatible Models** BlackVue ELITE Series
- **Manufacturer** Pittasoft Co., Ltd.
- **Address** 4F ABN Tower, 331, Pangyo-ro, Bundang-gu, Seongnam-si, Gyeonggi-do, Republic of Korea, 13488
- **Customer Support** cs@pittasoft.com
- **Product Warranty** 2-Year Limited Warranty
- facebook.com/BlackVueOfficial
- instagram.com/BlackVueOfficial
- youtube.com/BlackVueOfficial
- www.blackvue.com

Pairing the Remote Button with your Dash Cam

- Fleet Plan users should complete registration via the Fleeta App.

Step1

Go to Camera Settings > Event Trigger

Manual Recording in the BlackVue App.

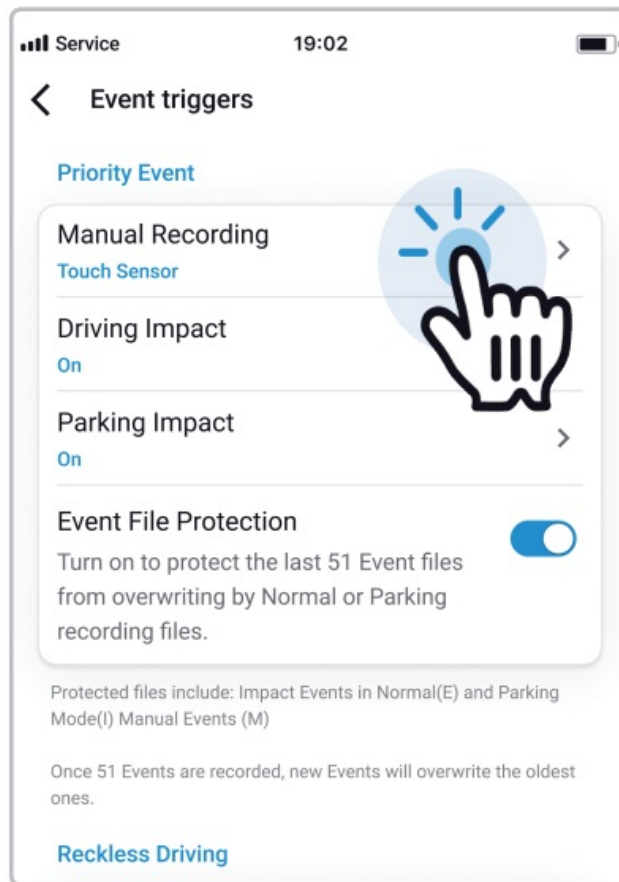

Step2

Click "Register" in the Remote Button menu to pair it with your Dash Cam.

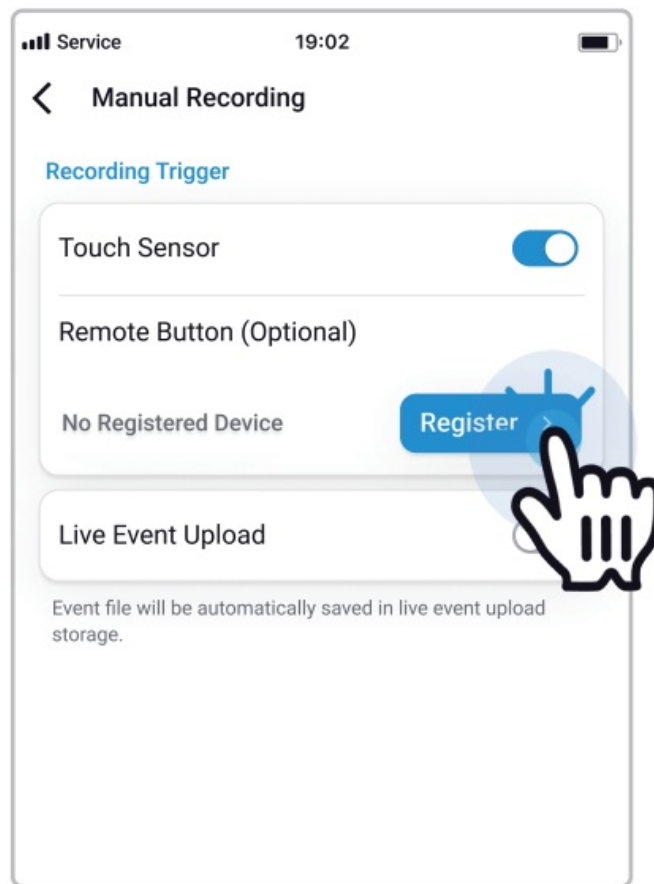

Step3

Press the Remote Button and confirm the beep sound from the BlackVue ELITE.

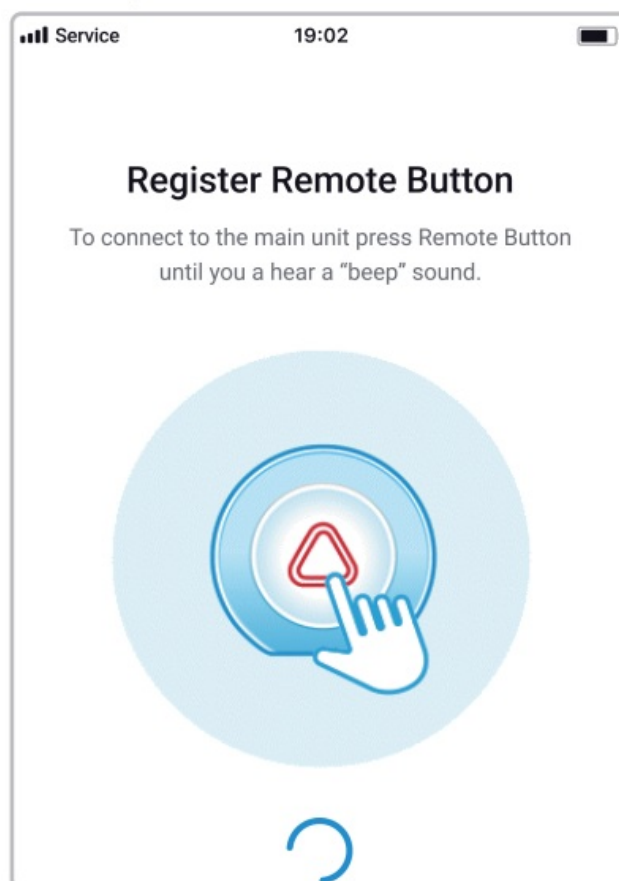

Step4

- Confirm the registration is complete.
- For a more detailed guide, scan the QR code.

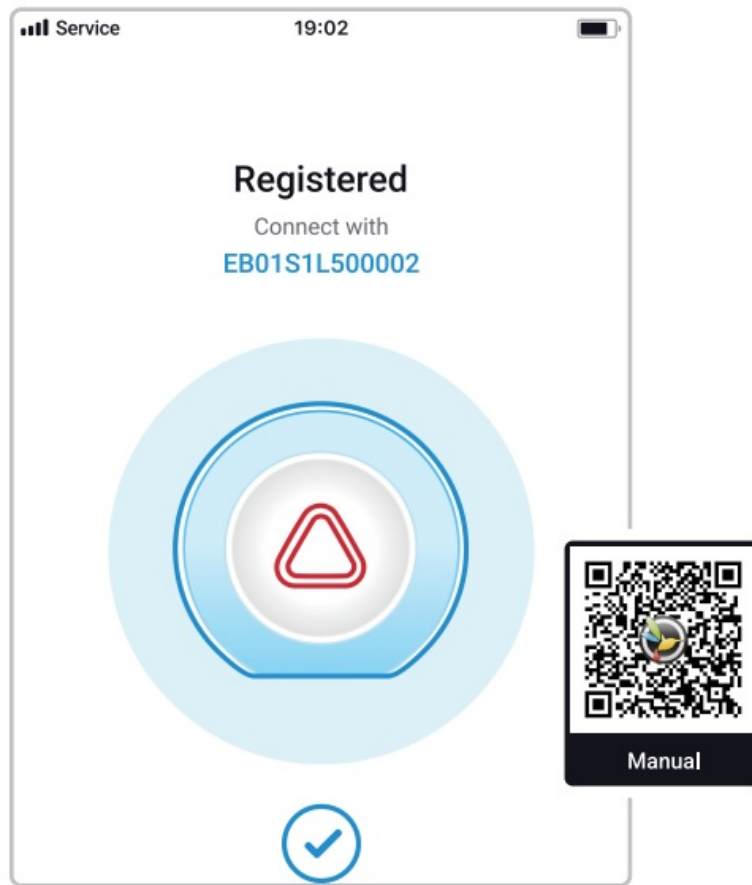

Important Safety Information

- To ensure safety and avoid damage, read this manual and follow all safety instructions. Do not disassemble, repair, or modify the product yourself. This may cause fire, electric shock, or malfunction. For repairs, contact the service centre.
- Do not operate the product with wet hands to prevent electric shock.
- If foreign objects enter the product, remove the battery immediately and contact the service centre.
- Keep the product away from extreme temperatures, direct sunlight, and humid environments.
- It is recommended to install and use the device at a minimum distance of 0.5 cm from the human body (excluding hands, wrists, feet, and ankles).

CAUTION

- Unauthorised modifications to this device may void the user's authority to operate it. Replacing the battery with an incorrect type may cause an explosion.
- Dispose of used batteries following local regulations.
- Do not ingest the battery, as it may cause chemical burns.
- This product contains a coin/button cell battery. Swallowing it can cause severe internal burns within 2 hours and may be fatal.
- Keep new and used batteries away from children.
- If the battery compartment does not close securely, stop using the product and keep it away from children. If ingestion occurs, seek immediate medical attention. Do not dispose of the battery in fire, a hot oven, or crush/cut it, as this could cause an explosion.
- Exposure to extremely high temperatures or humid environments may lead to battery leakage, fire, or an explosion.
- Extremely low air pressure may cause battery leakage, fire, or an explosion.

CE Warning

- Changes and modifications not expressly approved by the responsible party may void the user's authority to operate this equipment.
- It is recommended to install and use the device at a minimum distance of 0.5 cm from the human body (excluding hands, wrists, feet, and ankles).

IC Compliance

- This Class B digital apparatus complies with Canadian ICES-003. This radio transmitter has been approved by Industry Canada to operate only with the antenna types listed below.
- Each antenna type must comply with the specified maximum permissible gain and required impedance.
- Antennas not listed, or with higher gains, are strictly prohibited.

IC Warning

This device complies with Industry Canada license-exempt RSS standards. Operation is subject to the following two conditions:

1. This device may not cause interference.
2. This device must accept any interference, including interference that may cause undesired operation.

FCC Compliance Information

This equipment has been tested and found to comply with the limits for a Class B digital device, pursuant to Part 15 of the FCC Rules. These limits are designed to provide reasonable protection against harmful interference in a residential installation.

- This equipment generates, uses, and can radiate radio frequency energy.
- If not installed and used according to the instructions, it may cause harmful interference to radio communications.
- However, interference-free operation is not guaranteed in every installation.

If this equipment does cause interference to radio or television reception, the user can try to correct the interference by:

- Reorienting or relocating the receiving antenna.
- Increasing the distance between the equipment and the receiver.
- Connecting the equipment to a different power outlet than the receiver.
- Consult a dealer or an experienced radio/TV technician for assistance.

Only shielded interface cables should be used. Any changes or modifications not expressly approved by the manufacturer may void the user's authority to operate this equipment.

This device complies with Part 15 of the FCC Rules. Operation is subject to the following two conditions:

1. This device may not cause harmful interference.
2. This device must accept any interference received, including interference that may cause undesired operation.

FCC ID: YCK-EB1B

Disposal Information

- Electrical and electronic products must be disposed of separately from household waste at designated collection facilities.
- Contact local authorities for proper disposal and recycling options in your area. Proper disposal of this product helps protect the environment and human health.

FAQs

Q: How do I dispose of the product?

A: Electrical and electronic products must be disposed of separately from household waste at designated collection facilities. Contact local authorities for proper disposal and recycling options in your area.

Q: What is the warranty on this product?

A: The product comes with a 2-Year Limited Warranty. For further details, please contact Customer Support.

Documents / Resources

	<p>BLACKVUE ELITE Series LTE GPS WiFi Filters Remote Button [pdf]</p> <p>User Guide</p> <p>ELITE Series, ELITE Series LTE GPS WiFi Filters Remote Button, LTE GPS WiFi Filters Remote Button, WiFi Filters Remote Button, Remote Button</p>
---	---

References

- [User Manual](#)

BLACKVUE, Elite Series, ELITE Series LTE GPS WiFi Filters Remote Button, LTE GPS WiFi Filters Remote Button, REMOTE BUTTON, WiFi Filters Remote Button

Leave a comment

Your email address will not be published. Required fields are marked *

Comment *

Name

Email

Website

☐ Save my name, email, and website in this browser for the next time I comment.

Post Comment

Search:

e.g. whirlpool wrf535swhz

Search

[Manuals+](#) | [Upload](#) | [Deep Search](#) | [Privacy Policy](#) | [@manuals.plus](#) | [YouTube](#)

This website is an independent publication and is neither affiliated with nor endorsed by any of the trademark owners. The "Bluetooth®" word mark and logos are registered trademarks owned by Bluetooth SIG, Inc. The "Wi-Fi®" word mark and logos are registered trademarks owned by the Wi-Fi Alliance. Any use of these marks on this website does not imply any affiliation with or endorsement.