

**Blackstar®**  
the sound in your head  
**POLAR 2**  
**Fet Input**  
**Interface**



## Blackstar POLAR 2 Fet INput Interface Instruction Manual

[Home](#) » [Blackstar](#) » Blackstar POLAR 2 Fet INput Interface Instruction Manual 

### Contents

- [1 Blackstar POLAR 2 Fet Input Interface](#)
- [2 Product Usage Instructions](#)
- [3 GETTING STARTED](#)
- [4 FEATURES](#)
- [5 USING ENHANCE](#)
- [6 POWER](#)
- [7 Important safety information](#)
- [8 FCC Warning](#)
- [9 Documents / Resources](#)
  - [9.1 References](#)
- [10 Related Posts](#)

**Blackstar®**  
the sound in your head

**Blackstar POLAR 2 Fet Input Interface**



## Specifications

- **Input Connectors:** 1/4" Input Switch
- **Phantom Power Switch:** Yes
- **Input Enhance Switch:** Yes
- **Gain Controls:** 6
- **Headphones Connector and Level Control:** Yes
- **Input Level Meters:** 8
- **Monitor Level:** Yes
- **Output Level Meters:** 9
- **Output Connectors:** 10
- **Power Requirements:** 5V DC
- **Additional Power:** DC power may be required for use with iPhone or iPad

## Product Usage Instructions

### Connection Setup

- Connect your instruments or microphones to the appropriate input connectors.

### Gain Adjustment

- Turn up the gain controls to adjust the input levels as needed.

### Using Enhance Feature

- Toggle the Input Enhance switch to enhance the instrument or microphone input signal.

### Powering Up

- The Polar 2 is bus-powered, but for specific cases like using it with an iPhone or iPad, additional DC power may be required. Refer to the owner's manual for details.

## Frequently Asked Questions

**Q: What power source does the Polar 2 require?**

**A:** The Polar 2 is bus-powered, but additional DC power may be needed for certain devices like iPhones or iPads.

**Q: How do I adjust the input levels?**

**A:** Use the gain controls on the device to adjust the input levels according to your preference.

**Q: Can I use pedals with the Polar 2?**

**A:** Yes, the Polar 2 is designed to work with pedals for added versatility in your setup.

## GETTING STARTED

- Scan the QR code or go to: [www.blackstaramps.com/polar2/go](http://www.blackstaramps.com/polar2/go).

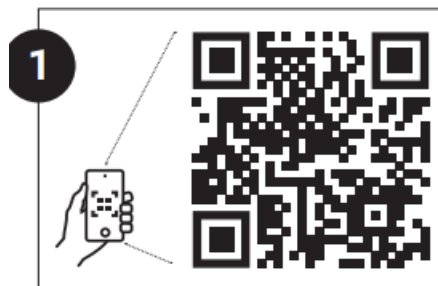

- Sign in or create a Blackstar User account.

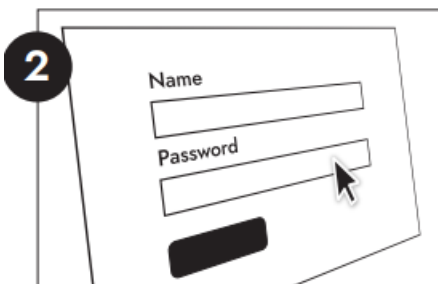

- Get the Blackstar Guitar Software Suite

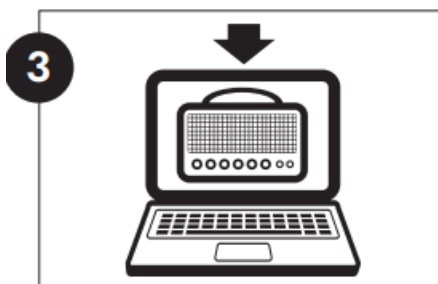

- Get the Polar 2 Control Software

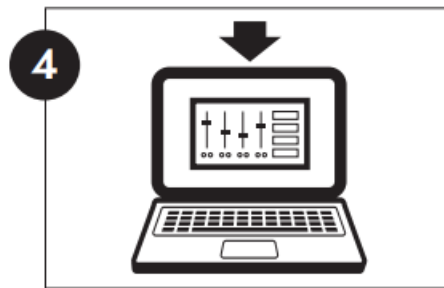

- Get the Music Software Collection

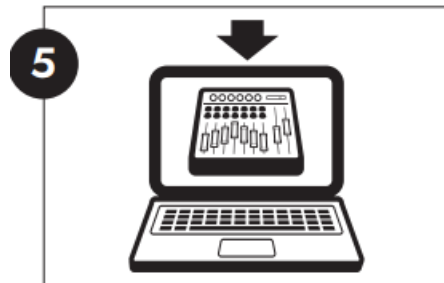

- Connect the USB-C cable to your computer to the POLAR 2 interface

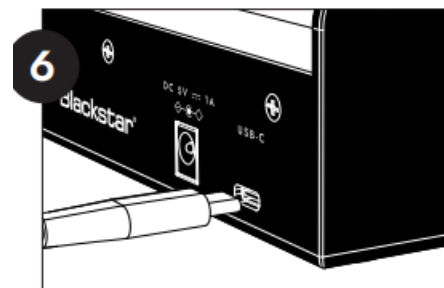

- Connect headphones or speakers and turn up the volume

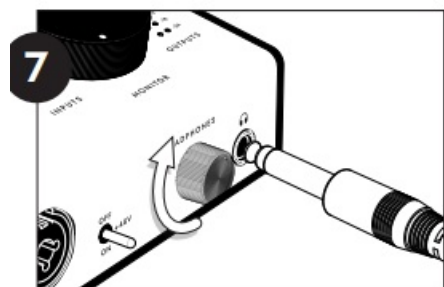

- Connect your instruments or microphones and turn up the gains

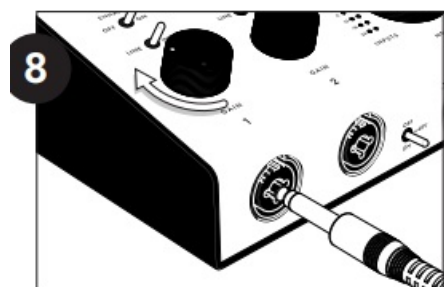

- Enable ENHANCE for superior guitar and mic sound

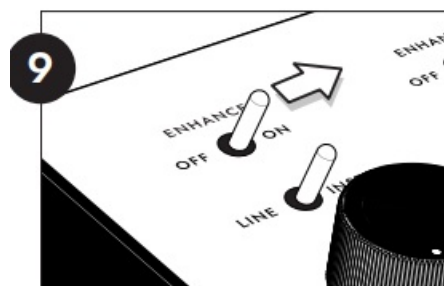

- Need help or support? Scan the QR code or go to: [www.Blackstaramps.com/polar2/help](http://www.Blackstaramps.com/polar2/help).



## FEATURES

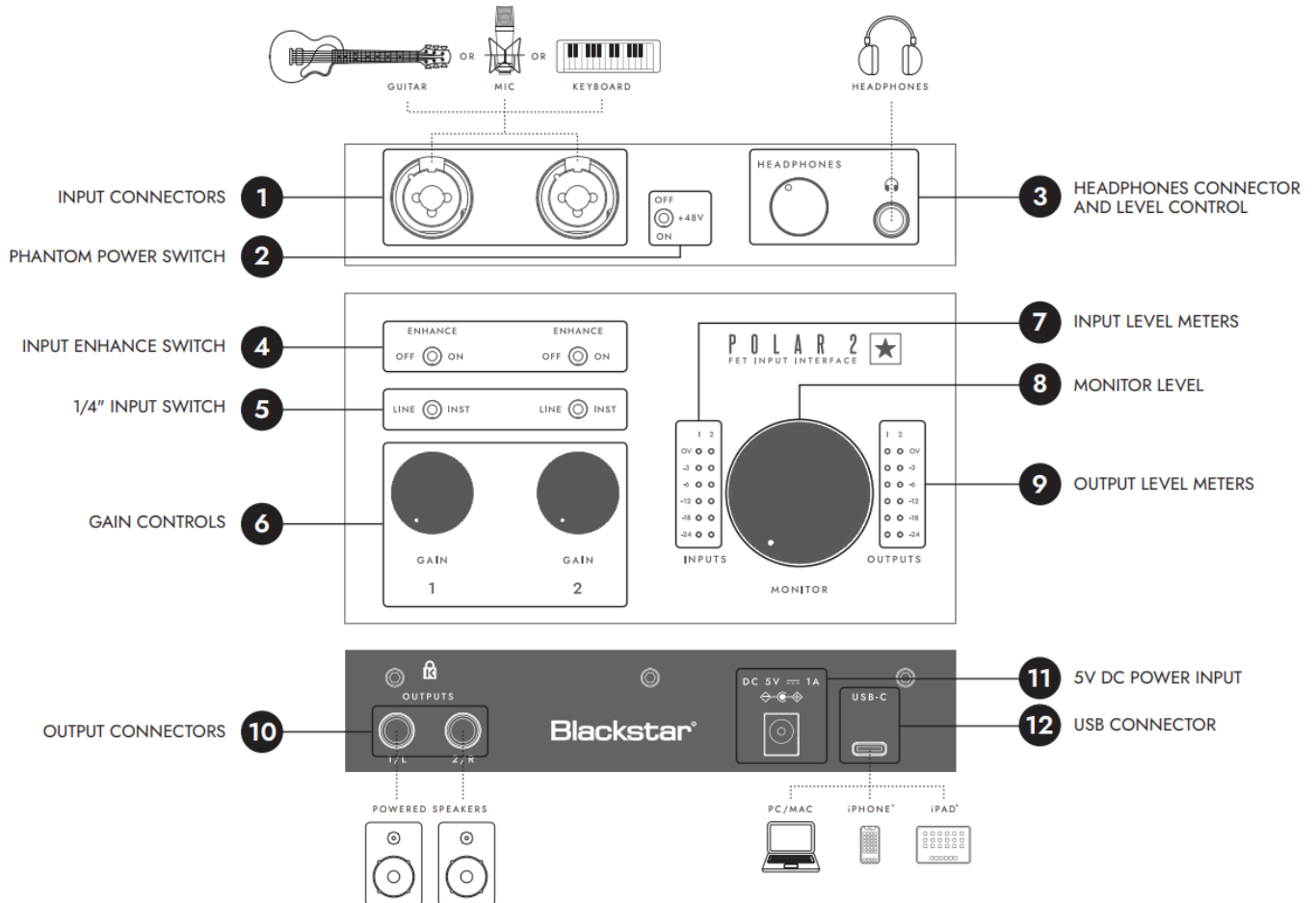

## USING ENHANCE

Each input has an ENHANCE switch to enable one of two distinct analog circuits.

### INST / GUITAR



### LINE / MIC



VINTAGE MIC  
PREAMP TONE



ADDS WARMTH  
AND LIFTS VOCALS

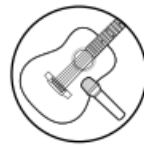

CRISP AND CLEAR  
MIC'D INSTRUMENTS

## POWER

The Polar 2 is bus-powered though it may require additional DC power for specific cases, such as using it with an iPhone or iPad. Refer to the owner's manual for more information.

### Important safety information

- READ THE FOLLOWING INFORMATION CAREFULLY. SAVE ALL INSTRUCTIONS FOR FUTURE REFERENCE!
- Do not open the equipment case.
- There are no user-serviceable parts in this equipment. Refer all servicing to qualified service personnel.
- Clean only with a dry cloth.
- Condensation can form on the inside of the product if it is moved from a cold environment to a warmer location.
- Before switching the unit on, it is recommended that the unit be allowed to reach room temperature.
- Unauthorized modification of this equipment is expressly forbidden by Blackstar Amplification Ltd.
- Never push objects of any kind into ventilation slots on the equipment casing. Do not expose this apparatus to rain, liquids, or moisture of any type.
- Do not place this product on an unstable trolley, stand, or table.
- The product may fall, causing serious damage to the product or persons!
- Do not cover or block ventilation slots or openings.
- This product should not be placed near a source of heat such as a stove, radiator, or another heat-producing amplifier
- Use only the supplied power cord which is compatible with the mains voltage supply in your area.
- Power supply cords should always be handled carefully and should be replaced if damaged in any way
- Never break off the earth (ground) pin on the power supply cord.
- The power supply cord should be unplugged when the unit is to be unused for long periods.
- Before the unit is switched on, the loudspeaker should be connected as described in the handbook using the lead recommended by the manufacturer.
- Always replace damaged fuses with the correct rating and type.
- Never disconnect the protective mains earth connection.
- High loudspeaker levels can cause permanent hearing damage. You should therefore avoid the direct vicinity of loudspeakers operating at high levels.
- Wear hearing protection if continuously exposed to high levels.
- This product may be susceptible to electromagnetic interference. If this occurs take steps to limit interference.
- If the product does not operate normally when the operating instructions are followed, then refer the product to a qualified service engineer
- The U.S. Government's Occupational Safety and Health Administration (OSHA) has specified the following permissible noise level exposures.

## **Duration Per Day In Hours Sound Level dBA, Slow Response**

- 8 90
- 6 92
- 4 95
- 3 97
- 2 100
- 1½ 102
- 1 105
- ½ 110
- ¼ or less 115
- According to OSHA, any exposure above the above permissible limits could result in some hearing loss
- An ear plug protector in the ear canals or over the ears must be worn when operating this amplification system in order to prevent permanent hearing loss if exposure is over the limits set forth above.
- To ensure against potentially dangerous exposure to high sound pressure levels, it is recommended that all persons exposed to equipment capable of producing high sound pressure levels such as this amplification system be protected by hearing protectors while this unit is in operation.
- All electrical and electronic products should be disposed of separately from the municipal waste stream via designated collection facilities appointed by the government or the local authorities.
- To prevent possible hearing damage, do not listen at high volume levels for long periods.

## **IMPORTANT SAFETY INSTRUCTIONS**

1. Read these instructions.
2. Keep these instructions.
3. Heed all warnings.
4. Follow all instructions.
5. Do not use this apparatus near water.
6. Clean only with a dry cloth.
7. Do not block any ventilation openings.
8. Install under the manufacturer's instructions.
9. Do not install near any heat sources such as radiators, heat registers, stoves, or other apparatus including amplifiers) that produce heat.
10. Do not defeat the safety purpose of the polarized or grounding-type plug. A polarized plug has two blades one wider than the other. A grounding-type plug has two blades and a third grounding prong.
  - The wide blade or the third prong is provided for your safety. If the provided plug does not fit into your outlet, consult an electrician for the replacement of the obsolete outlet.
11. Protect the power cord from being walked on or pinched particularly at plugs, convenience receptacles, and the point where they exit from the apparatus.
12. Only use attachments/accessories specified by the manufacturer.
13. Unplug this apparatus during lightning storms or when unused for long periods.
14. Refer all servicing to qualified service personnel. Servicing is required when the apparatus has been damaged in any way, such as power-supply cord or plug is damaged, liquid has been spilled or objects have fallen into the apparatus, the apparatus has been exposed to rain or moisture, does not operate normally, or has been

dropped.

- **WARNING:** TO REDUCE THE RISK OF FIRE OR ELECTRIC SHOCK, DO NOT EXPOSE THIS APPARATUS TO RAIN OR MOISTURE, AND OBJECTS FILLED WITH LIQUIDS, SUCH AS VASES, SHOULD NOT BE PLACED ON THIS APPARATUS.
- This symbol is intended to alert the user to the presence of important operation and maintenance (servicing) instructions in the literature accompanying the appliance.
- This symbol is intended to alert the user to the presence of uninsulated “dangerous voltage” within the product’s enclosure that may be of sufficient magnitude to constitute a risk of electric shock to persons.

## FCC Warning

Changes or modifications to this unit not expressly approved by the party responsible for compliance could void the user’s authority to operate the equipment.

**Note:** This equipment has been tested and found to comply with the limits for a Class B digital device, under Part 15 of the FCC Rules. These limits are designed to provide reasonable protection against harmful interference in a residential installation. This equipment generates, uses, and can radiate radio frequency energy and, if not installed and used under the instructions, may cause harmful interference to radio communications. However, there is no guarantee that interference will not occur in a particular installation. If this equipment does cause harmful interference to radio or television reception, which can be determined by turning the equipment off and on, the user is encouraged to try to correct the interference by one or more of the following measures:

- Reorient or relocate the receiving antenna.
- Increase the separation between the equipment and the receiver
- Connect the equipment to an outlet on a circuit different from that to which the receiver is connected.
- Consult the dealer or an experienced radio/TV technician for help.

The device has been evaluated to meet general RF exposure requirements. The device can be used in portable exposure conditions without restriction.

## IC Warning:

This device complies with Industry Canada license-exempt RSS standard(s). Operation is subject to the following two conditions:

This device may not cause interference,

This device must accept any interference, including interference that may cause undesired operation of the device. Please download the CE declaration of conformity for your Blackstar product at this address:

<https://www.blackstaramps.com/declaration-of-conformity>.



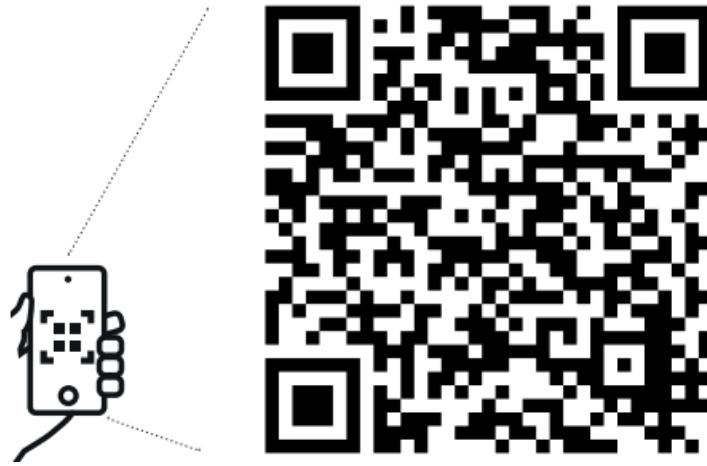

## Documents / Resources

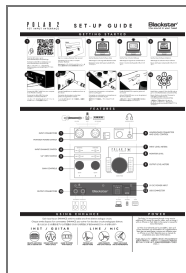

[Blackstar POLAR 2 Fet INput Interface](#) [pdf] Instruction Manual  
POLAR-2-QSG, 247400M-VA-1, POLAR 2 Fet INput Interface, POLAR 2, Fet INput Interface, I  
Nput Interface, Interface

## References

- [User Manual](#)

### Manuals+, Privacy Policy

This website is an independent publication and is neither affiliated with nor endorsed by any of the trademark owners. The "Bluetooth®" word mark and logos are registered trademarks owned by Bluetooth SIG, Inc. The "Wi-Fi®" word mark and logos are registered trademarks owned by the Wi-Fi Alliance. Any use of these marks on this website does not imply any affiliation with or endorsement.