

BIYU BAE4C-E8XwU Cleaning Instructions Hub Operations



BIYU BAE4C-E8XwU Cleaning Instructions Hub Operations Instruction Manual

[Home](#) » [BIYU](#) » BIYU BAE4C-E8XwU Cleaning Instructions Hub Operations Instruction Manual 

Contents

- 1 [BIYU BAE4C-E8XwU Cleaning Instructions Hub Operations](#)
- 2 [Accessories](#)
- 3 [Consumables](#)
- 4 [PRODUCT OVERVIEW](#)
- 5 [DIFFERENT PURPOSES](#)
- 6 [HOW TO OPERATE](#)
- 7 [Documents / Resources](#)
 - 7.1 [References](#)
- 8 [Related Posts](#)

BIYU

BIYU BAE4C-E8XwU Cleaning Instructions Hub Operations



Accessories



Drive disc with pin back



Brush edge with rubber band



Vacuum cleaner hose
5m



Vacuum cleaner
adapters

Consumables

- Comes standard with 1 pad



Pad 16 Inch black

- You can order sanding mesh (60, 80, 100, 120) through customer service.

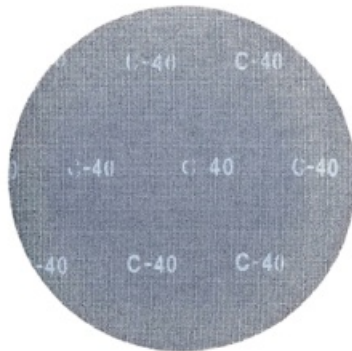

Sanding mesh double-sided Ø 406 mm

PRODUCT OVERVIEW

What is attached to the Woodboy:



Hose Splitter



Brush edge with rubber band



2x Suction hose

What is in the box:



Vacuum cleaner hose 5m



Vacuum cleaner
adapters



Drive disc with pin back



Pad 16 Inch black

- Happy Woodboying!



DIFFERENT PURPOSES

USING THE WOOD BOY FOR DIFFERENT PURPOSES

- Using the Woodboy for sanding with the sanding mesh
 - Put the black pad on the drive disc with the pin back and the sanding mesh on the pad.

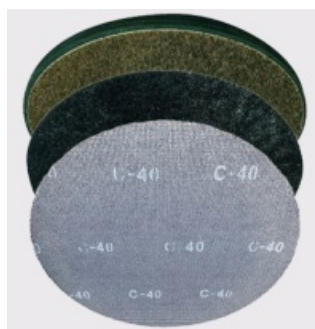

Using the Woodboy with the pad(s)

Pads are available for various applications.

- **Black:** Intermediate sanding of coatings and usable as a pad for mesh sanding discs.
- **White:** Polishing and brightening waxes
- **Beige:** Scrubbing in and out of wax
- **Red:** Polishing or light scrubbing
- **Green:** Scrubbing and removal of ground in dirt, grease and streaks



BIYU only has black pads, which can be used to attach the mesh sanding discs and for intermediate sanding and scrubbing of floors.

HOW TO OPERATE

1. Unroll the power cord completely.
2. Attach the drive disc



3. If you are using the Woodboy for sanding, attach the black pad to the drive disc and attach the sanding mesh to the black pad.

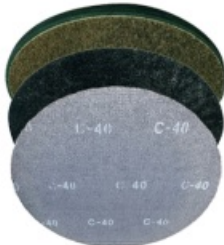

4. If you are using the Woodboy for intermediate sanding or floor scrubbing, attach the black pad to the drive disc.



5. Use the large grey switch to position the handle at hip height. This provides maximum control of the machine.

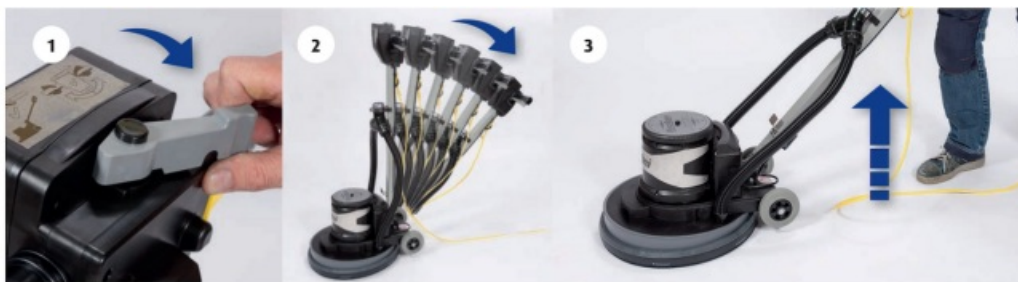

6. Plug in the power cord.
7. Place the Woodboy in the centre of the room and simultaneously press the yellow switch down with your right thumb and the grey switches on the handle with both hands. You can release the yellow switch once the machine is spinning. The first time the machine will probably swing 1 way, loosen the grey knobs to make the machine stop before hitting anything. The trick is to hold the handle so that the Woodboy keeps spinning on the spot. You only need to make minimal movements with the handle to make the Woodboy go in the right direction once you have 1 found the zero point. This requires very little force.
- **Handle up:** Woodboy moves to the right
 - **Handle down:** Woodboy moves to the left

- **Handle left:** Woodboy moves forward
- **Handle right:** wood boy moves backwards



Documents / Resources

| | |
|---|--|
|  <p>BIYU WOODBOY MANUAL Your BEST guide to using your Woodboy</p> <p>NOTE: BIYU, we want the Woodboy with a variety of accessories and attachments. The manual applies to the Woodboy with the accessories and attachments as provided only.</p> <p>BIYU</p> | <p>BIYU BAE4C-E8XwU Cleaning Instructions Hub Operations [pdf] Instruction Manual BAE4C-E8XwU Cleaning Instructions Hub Operations, BAE4C-E8XwU, Cleaning Instructions Hub Operations, Instructions Hub Operations, Hub Operations, Operations</p> |
|---|--|

References

- [User Manual](#)

Manuals+ Privacy Policy

This website is an independent publication and is neither affiliated with nor endorsed by any of the trademark owners. The "Bluetooth®" word mark and logos are registered trademarks owned by Bluetooth SIG, Inc. The "Wi-Fi®" word mark and logos are registered trademarks owned by the Wi-Fi Alliance. Any use of these marks on this website does not imply any affiliation with or endorsement.