

BIXOLON SPP-C200 Bluetooth Connection



# BIXOLON SPP-C200 Bluetooth Connection Manual User Manual

[Home](#) » [BIXOLON](#) » BIXOLON SPP-C200 Bluetooth Connection Manual User Manual 

## Contents

- [1 BIXOLON SPP-C200 Bluetooth Connection](#)
- [2 Product Information](#)
- [3 Product Usage Instructions](#)
- [4 FAQ](#)
  - [4.1 Bluetooth Information Print](#)
- [5 Bluetooth Connection Instructions](#)
- [6 Troubleshooting](#)
- [7 Documents / Resources](#)
  - [7.1 References](#)

# BIXOLON

BIXOLON SPP-C200 Bluetooth Connection



## Product Information

### Specifications

- Product Name: SPP-C200/C300 Mobile Printer
- Version: Ver. 1.01
- Manufacturer: BIXOLON
- Bluetooth-enabled for iOS and Android Host devices
- Maximum Connection Range: 10m
- Power Button: FEED

## Product Usage Instructions

### Precautions

1. Ensure devices are within 10m for Bluetooth connection.
2. Avoid transmission obstacles like cement walls that can reduce the connection range.
3. Avoid interference from devices using the same frequency by maintaining a distance of at least 5m.

## Bluetooth Connection Instructions

### iOS Mode

1. Turn off the printer.
2. Ensure the iOS device's Bluetooth is enabled.
3. Search for the printer in the Bluetooth settings of the iOS device.

4. Pair and connect to the printer when found.

## **Android Mode**

1. Power off the printer.
2. Enable Bluetooth on the Android device.
3. Locate the printer in the Bluetooth settings of the Android device.
4. Establish a pairing and connection with the printer.

## **FAQ**

### **Q: How do I troubleshoot Bluetooth connection issues?**

A: If facing connectivity problems, ensure devices are within range, no obstacles, and no interfering devices nearby. Restart both devices and try reconnecting.

## **Copyright**

© BIXOLON Co., Ltd. All rights reserved.

This user manual and all property of the product are protected under copyright law. It is strictly prohibited to copy, store, and transmit the whole or any part of the manual and any property of the product without the prior written approval of BIXOLON Co., Ltd. The information contained herein is designed only for use with this BIXOLON product. BIXOLON is not responsible for any direct or indirect damages, arising from or related to use of this information.

- The BIXOLON logo is the registered trademark of BIXOLON Co., Ltd.
- All other brand or product names are trademarks of their respective companies or organizations.

BIXOLON maintains ongoing efforts to enhance and upgrade the functions and quality of all our products. In the following, product specifications and/or user manual content may be changed without prior notice.

## **Caution**

Electronics, such as printers, are prone to damage by static electricity. Therefore, to protect the printer from static electricity, be sure to turn off the printer before connecting or disconnecting the cable to the rear of the printer. If the printer is damaged by static electricity, contact your local dealer.

## **Manual Information**

This Bluetooth Connection Manual provides information on the connection of Bluetooth-enabled iOS or Android Host devices with the printer. We at BIXOLON maintain ongoing efforts to enhance and upgrade the functions and quality of all our products. In the following, product specifications and/or user manual content may be changed without prior notice.

## **Precautions**

1. To connect the printer with another device via Bluetooth, the devices must be within 10m of one another. The connection is broken if the distance between devices exceeds 10m.

2. The maximum separating distance may be shortened if transmission obstacles, such as cement walls, are present.
3. If a device (such as a microwave oven, wireless LAN, etc.) that uses the same Frequency is present, transmission may be interrupted. Separate the printer and Bluetooth-enabled device from such interrupting devices by a distance of at least 5m.

#### **Bluetooth Information Print**

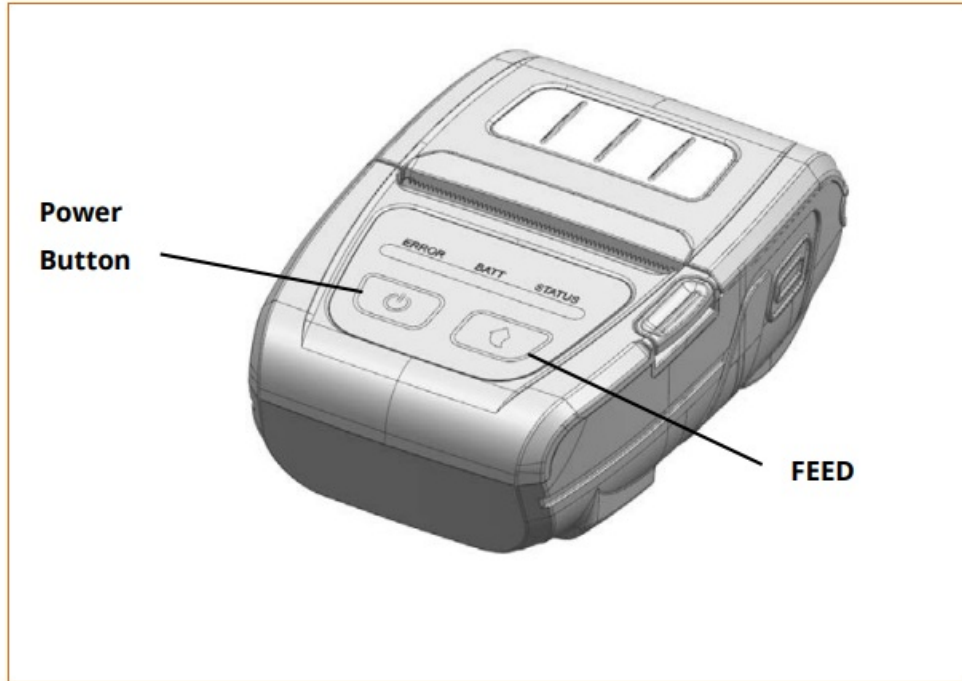

Turn the printer power off and close the printer paper cover. Then press and hold both paper feed and power button simultaneously to turn on the printer. After printing Self-Test begins, release the two buttons

#### **Bluetooth Connection Instructions**

This manual focuses on the use of the following Host devices. For other Host devices, please refer to the relevant Host device manual

#### **iOS mode**

1) Select the  icon.

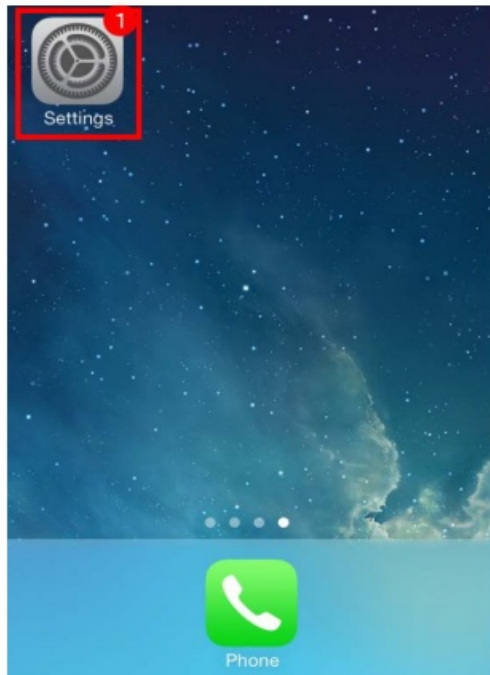

2) Select "Bluetooth".



- Select the printer to connect.
- Bluetooth communication is available

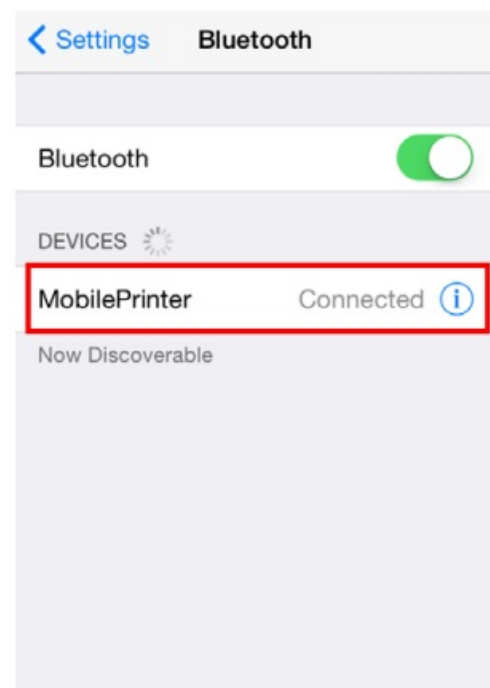
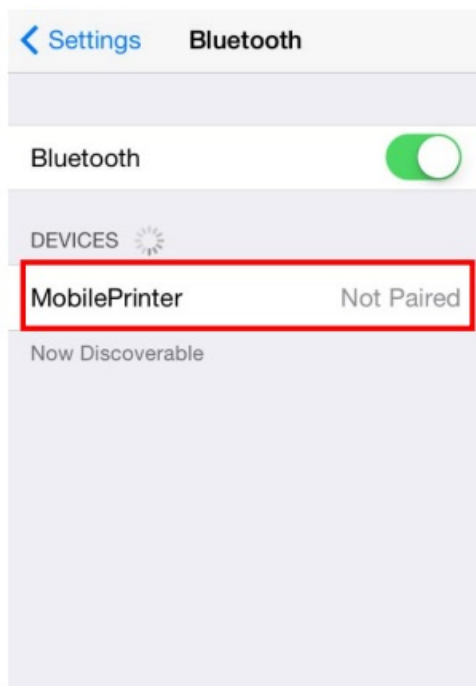

## Android mode

- Select the icon 
- Select "Bluetooth".

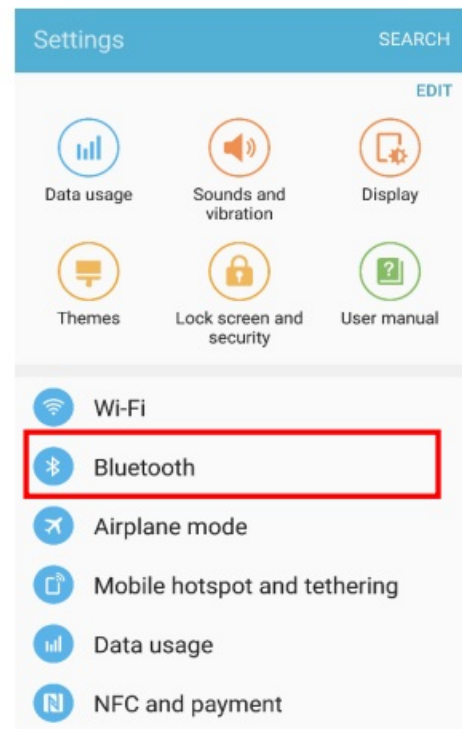
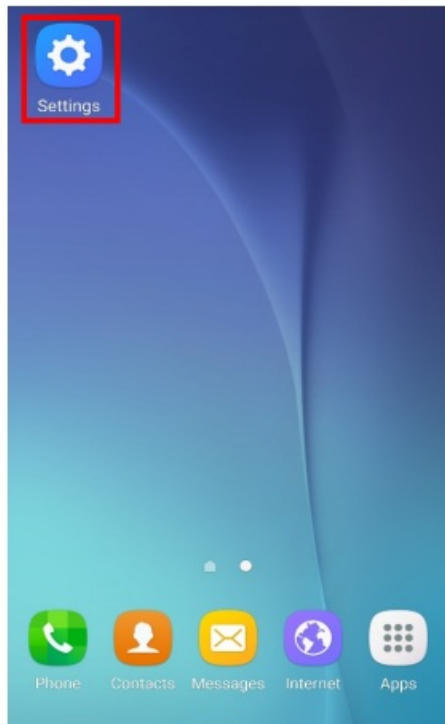

- Select the printer to connect
- Bluetooth communication is available

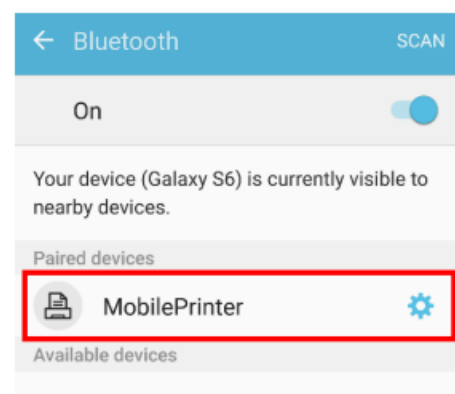
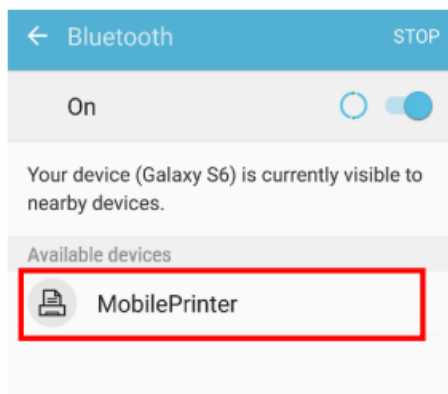

## Troubleshooting

Please follow the guide below if Bluetooth is not searched on iOS devices. Check whether the printer is connected to other Bluetooth device. Printer is not able to be found on your iOS device if it is connected to other bluetooth device.

Check the printer's STATUS LED.

- STATUS LED on: When the printer is not connected to other devices via Bluetooth
- STATUS LED blinks: When the printer is connected to another device via Bluetooth

You need to disconnect the connection to other Bluetooth device or turn on the printer. The printer is automatically connected to last iOS device that was connected.

## Revision history

Rev.	Date	Description
1.00	06-04-2022	New
1.01	05-02-2024	Renewed pairing instruction image. Legacy(PIN) → SSP Just works

- [www.bixolon.com](http://www.bixolon.com)

## Documents / Resources

	<p><b><a href="#">BIXOLON SPP-C200 Bluetooth Connection Manual</a></b> [pdf] User Manual SPP-C200 Bluetooth Connection Manual, SPP-C200, Bluetooth Connection Manual, Connection Manual</p>
---	---

## References

- [User Manual](#)

[Manuals+.](#) [Privacy Policy](#)

This website is an independent publication and is neither affiliated with nor endorsed by any of the trademark owners. The "Bluetooth®" word mark and logos are registered trademarks owned by Bluetooth SIG, Inc. The "Wi-Fi®" word mark and logos are registered trademarks owned by the Wi-Fi Alliance. Any use of these marks on this website does not imply any affiliation with or endorsement.