



Bitvae C2 Water Flosser Professional Instruction Manual

[Home](#) » [Bitvae](#) » Bitvae C2 Water Flosser Professional Instruction Manual 

Bitvae C2 Water Flosser Professional Instruction Manual



Thanks for choosing the Oral Irrigator. Before operating the product, please read the manual carefully and keep it for future reference.

Contents

[1 Important Safeguards](#)

[2 Notes](#)

[3 Designs](#)

[4 How To Use:](#)

[5 Specifications](#)

[6 Warranty](#)

[7 Documents /
Resources](#)

[8 Related Posts](#)

Important Safeguards

All information in this section is provided to instruct you on the correct and safe operation of this device so that you can avoid injury to yourself and others as well as damage to property.

- Toddlers, infants, people who are unable to operate the device should not use it by themselves. Please also keep it away and out of reach from children.
- Never try to alter, disassemble or repair the device.
- Do not place or store the product where it will fall or end up in a tub or sink.
- Do not reach for the product if it has fallen into water. Unplug immediately.
- Do not use the product while bathing.

Notes

- This appliance can be used by children from age 8 and above; and people with reduced physical, sensory or mental capabilities or lack of experience and knowledge if they have been given supervision or instruction concerning use of the device in a safe way and understand the hazards involved.
- Children shall not play with the device. Cleaning and user maintenance shall not be made by children without supervision.
- The device can only be used with the power supply unit provided with the device.
- Do not fill the tank with water warmer than 40 °C.
- If the external flexible cable or cord of this transformer is damaged, it shall be replaced by the manufacturer, a service agent or a similarly qualified person in order to avoid any hazard.
- Keep the cord away from heated surfaces.
- Please do not use it if you lose the nozzle.
- Do not submerge the device in water.
- Do not use for any purpose other than oral cleaning.
- Keep nozzle away from young children. The nozzle is small enough to swallow and can be lodged in the throat.
- Certain types of mouthwash may damage the equipment by cracking the housing or water reservoir. Therefore, do not use mouthwash in the water reservoir.
- People who experience tooth or gum pain may not be able to use this device and should consult with their dentist before use.
- Do not press the nozzle too firmly against your teeth or gums, it will hurt your gums if you do so.
- Please use an adapter so that the voltage is 5V=1000mA during charging, otherwise the battery could be damaged by overcharging.

Designs

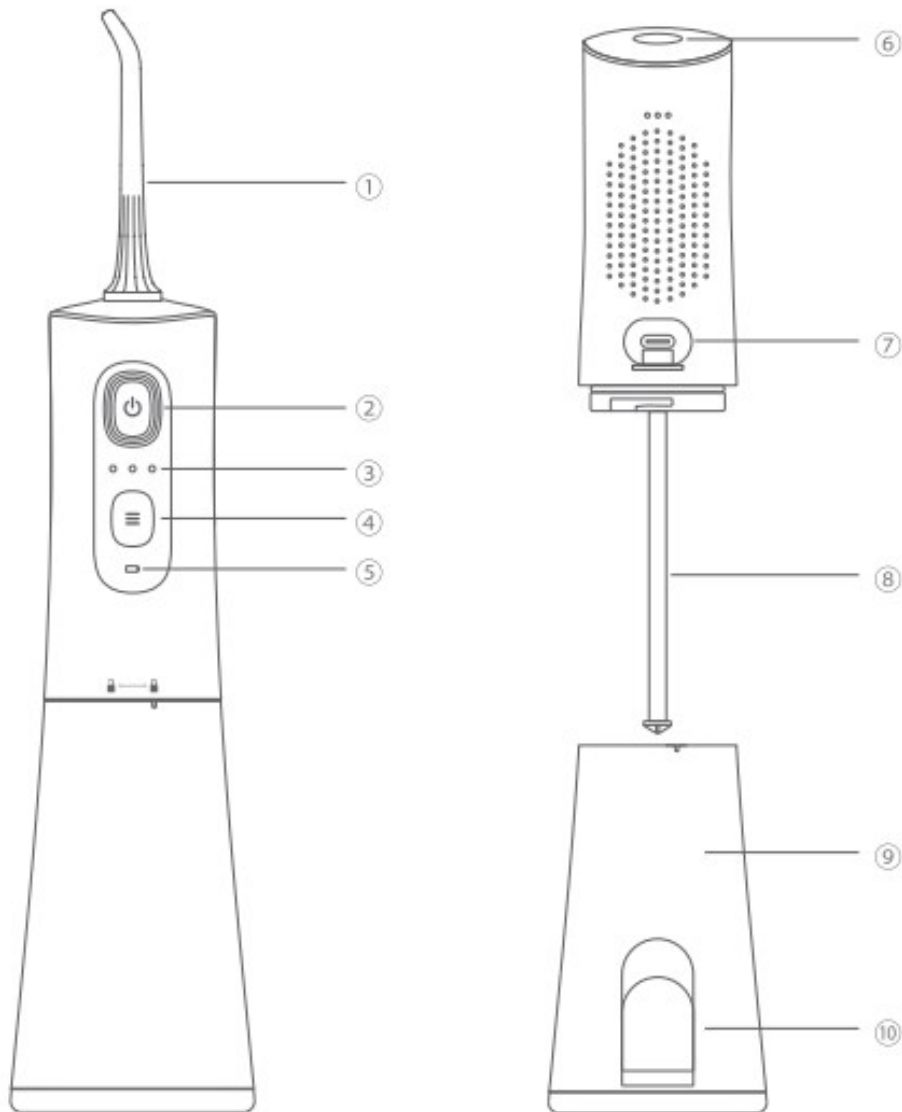

1. Standard Nozzle
2. On/Off Button
3. Mode Indicator
4. Mode Button
5. Power Indicator
6. Nozzle Unlock Button
7. Charging Port (Charger base)
8. Water Inlet Pipe
9. Water Tank
10. Water Tank Lid

Note:

There may be some liquid remaining inside the main device before use (tank, water suction tube, etc), this is the remaining distilled water that was used for the performance (water flow) test, so there are no health concerns.

How To Use:

Charging the device (As Fig. 1)

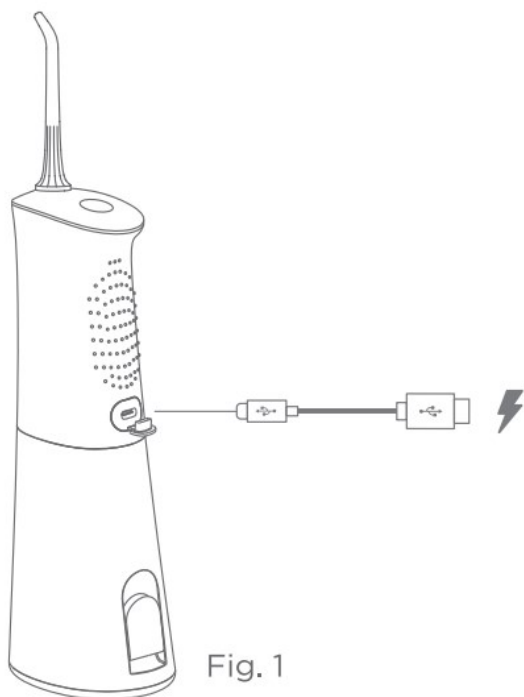

- Please cover the lid of the tank tightly before using the oral irrigator to avoid water leakage.
- Take the charger base cover down and insert the device socket (make sure no liquid is remaining inside the device plug).
- Insert the charging adaptor securely into the power outlet.
- The “Power” indicator blinks when the device is charging. When it is fully charged, the white “Power” indicator will stay on for 2 minutes, and it will turn off automatically after that.
- Put the cover on the charger base again after charging is finished.

Note:

The “Power” indicator will flash in red when the power is lower than 20%; when the power is lower than 3%, the red “Power” indicator will flash for 5 times, and then it will turn off automatically, the device will also be powered off and is not able to work. It takes 3 hours to fully charge the device.

Use the Oral Irrigator

- Attach the nozzle onto the unit. **(Fig. 2)**
- Open the cap of the water tank to fill the tank with water which should not exceed 40°C, then close the cap. **(Fig. 3)**

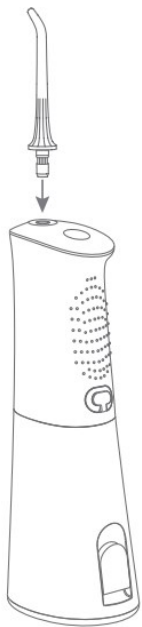

Fig. 2

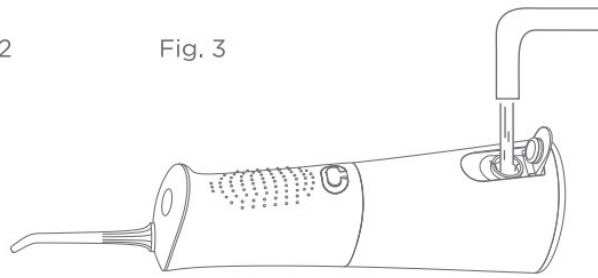

Fig. 3

- Or, slide the water tank down off the unit, fill the tank with water which should not exceed 40°C, then attach the tank on the unit. **(Fig. 4)**

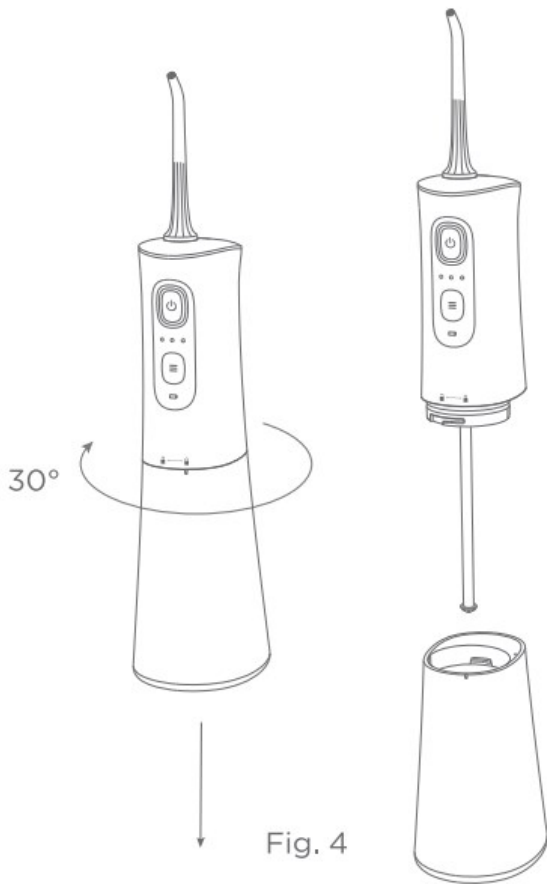



Fig. 4

- Press the “” button to change the working mode after the irrigator turns on, the default mode keeps the same as last shutoff in that situation.

Nozzle Introductions:

Standard Nozzle: Rinse the residues between teeth and teeth gaps, keep the oral cavity clean.



Tongue Scraper: For cleaning the coating on the tongue and reduce the growth of the bacteria.

Mode Introductions:

Soft: for gentle cleaning of sensitive gums, the water pressure will be 50-70psi. A white mode indicator will turn on.

Normal: for normal cleaning, the water pressure will be 70-90psi. 2 white mode indicators will turn on under this situation.

Potent: for people who have high requirements of teeth and gum cleaning, the water pressure will be 90-120psi. All the 3 mode indicators will turn on.

- Hold the unit in an upright position with the nozzle tip pointing toward your teeth.
- Keep your mouth opened slightly so that the water can flow out.
- Press the “” button shortly to start the device, it will start at the previous mode. Users can also stop it by pressing the “”. The irrigator will enter into a standby status after that and it will turn off automatically when it left for 20 seconds of non-working. **(Fig. 5)**

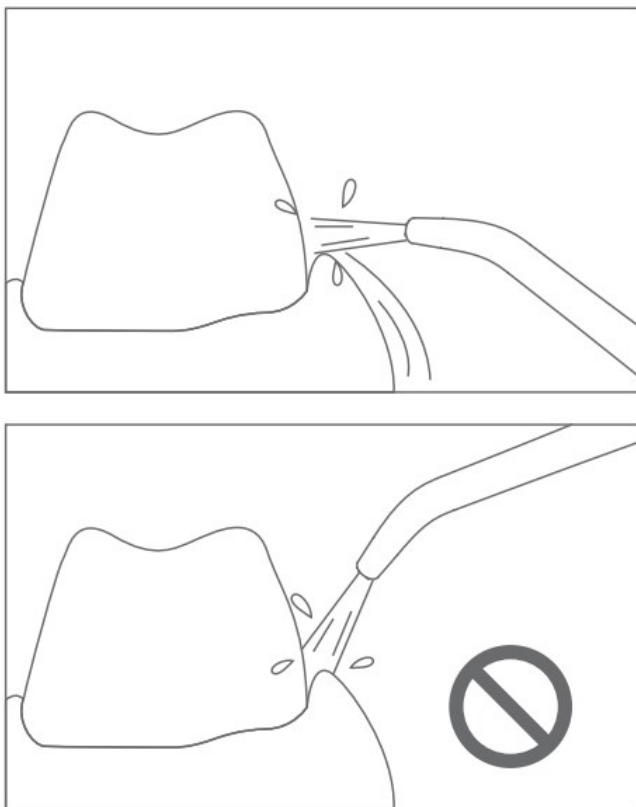

Fig. 5

- **1)** Direct the water jet flow at a 90-degree angle to the teeth and gums.
- **2)** Direct the water jet slowly along the teeth.
- **3)** Direct the water jet along the gum line with the nozzle tip at a 90 degree angle to the gum tissue.
- **4)** Cleaning between the teeth and around any braces, crowns or bridgework thoroughly.
- Firmly hold the base then, pull the nozzle out away from the base. **(Fig. 6)**

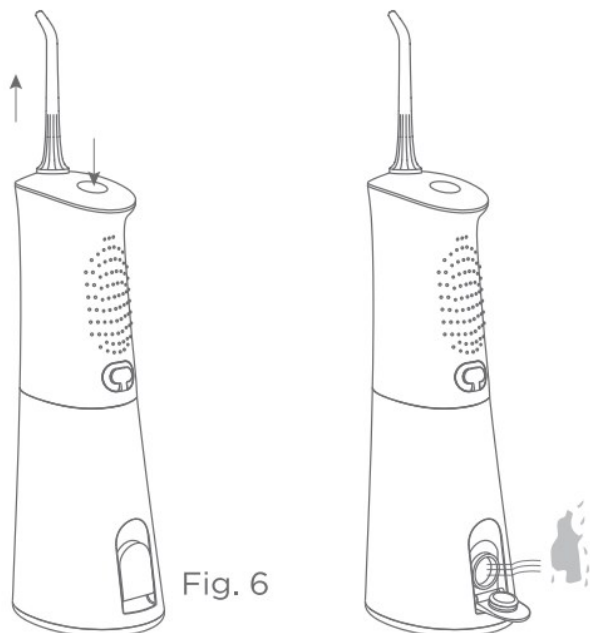

Fig. 6

- Once irrigating is completed, press the “” button again to turn off the device.

After using the appliance (Fig. 7)

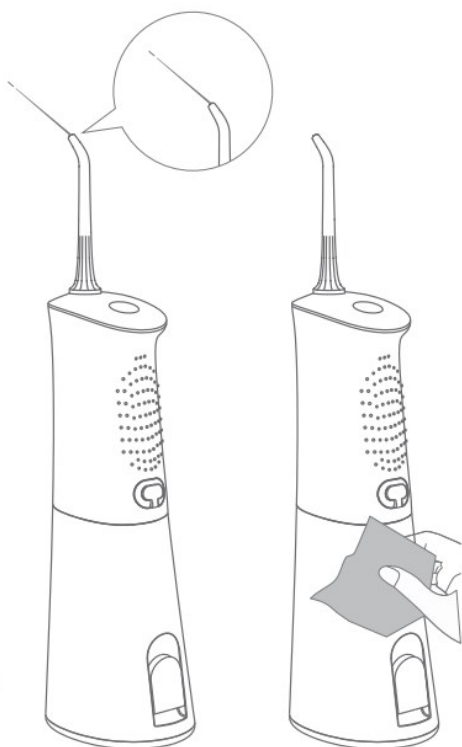



Fig. 7

- Open the cap of the water tank and dispose of the water in the tank.
- Press the “” key to turn on the unit, and drain the water inside the device.
- Press the “” key again to turn off the unit, and close the water tank cap.
- Wipe the device with a dry cloth.

Note:

To prevent bacteria from propagating, make sure there is no remaining water inside the unit. If you're not going to use this appliance for a long time, be sure to wipe and dry the appliance as soon as possible before storing it.

Specifications

- **Working temperature:** 0-50°C
- **Working voltage:** DC3.7V
- **Input voltage:** DC5.0V
- **Rated power:** 6.0-7.0W
- **Waterproof rating:** IPX7

Warranty

- 1-year warranty is offered, starting from the first day of purchase. You may contact us,
- During the warranty period, for any defect that may arise from materials or product process, we will replace the parts or the whole product according to certain circumstances.
- When you apply for free repair, you must submit the product and proof that can prove the date of purchase to us.
- The following conditions are not included in the warranty:
 - Damages caused by improper use, for example, wrong use of power supply, plugged into an improper socket, artificial damage etc.
 - Ageing and normal wear and tear from use.
 - Problems occur due to its use for other purposes, or improper use or use components not supplied by us.
- This warranty does not affect your statutory rights.

Clevo Innovation INC
2060 N COLLINS BLVD STE 110 RICHARDSON TX 75080



support@bitvae.com



972-479-9048

MADE IN CHINA

Bitvae

Documents / Resources

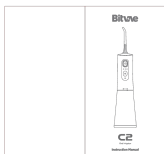
	<p>Bitvae C2 Water Flosser Professional [pdf] Instruction Manual C2, Water Flosser Professional, Flosser Professional, Water Flosser, Flosser</p>
---	---