



## Contents [ [hide](#) ]

- [1 Birdfy Netvue Feeder Bamboo Mini](#)
- [2 What's in the Box](#)
- [3 PACKAGE CONTENT](#)
- [4 HARDWARE](#)
- [5 About the Product](#)
- [6 Charging](#)
- [7 Downloading the Birdfy App](#)
- [8 Assembly](#)
- [9 Outdoor Installation](#)
- [10 Cleaning](#)
- [11 The Birdfy Community](#)
- [12 FCC](#)
- [13 Contact us](#)
- [14 Documents / Resources](#)
  - [14.1 References](#)



## Birdfy Netvue Feeder Bamboo Mini



**What's in the Box**

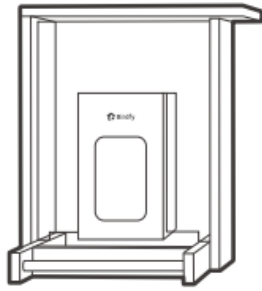

Feeder  
Alimentador  
Mangeoire

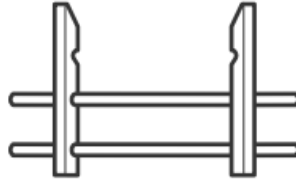

Extension perch  
Percha de extensión  
Perchoir d'extension



Camera  
Cámara  
Caméra

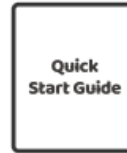

Quick Start Guide  
Guía de inicio rápido  
Guide de démarrage rapide

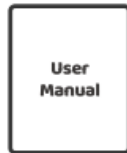

User Manual  
Manual del usuario  
Manuel d'utilisation



\*Solar panel package  
\*Paquete de panel solar  
\*Pack de panneaux solaires

## PACKAGE CONTENT



Installation package  
Paquete de instalación  
Pack d'installation



Charging cable  
Cable de carga  
Câble de chargement

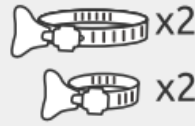

Hose clips  
Clips para manguera  
Clips de tuyau



Hanging bracket  
Soporte colgante  
Support de suspension

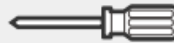

Screwdriver  
Destornillador  
Tournevis

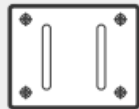

Drilling template  
Plantilla de perforación  
Gabarit de perçage

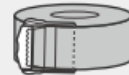

Black strap  
Correa negra  
Sangle noire

## HARDWARE

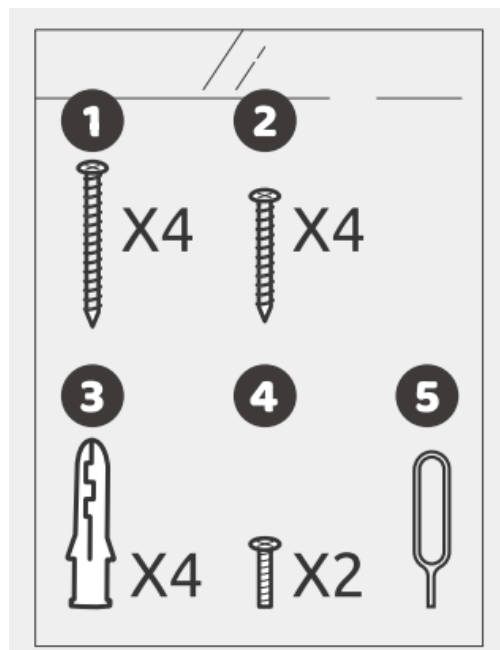

1. Screws for mounting on wood
2. Screws for mounting on concrete

3. Anchors
4. Perch screws
5. Ejector pin

\* Please note that if you have purchased the no-solar bundle, the package will not include a solar panel.

## About the Product

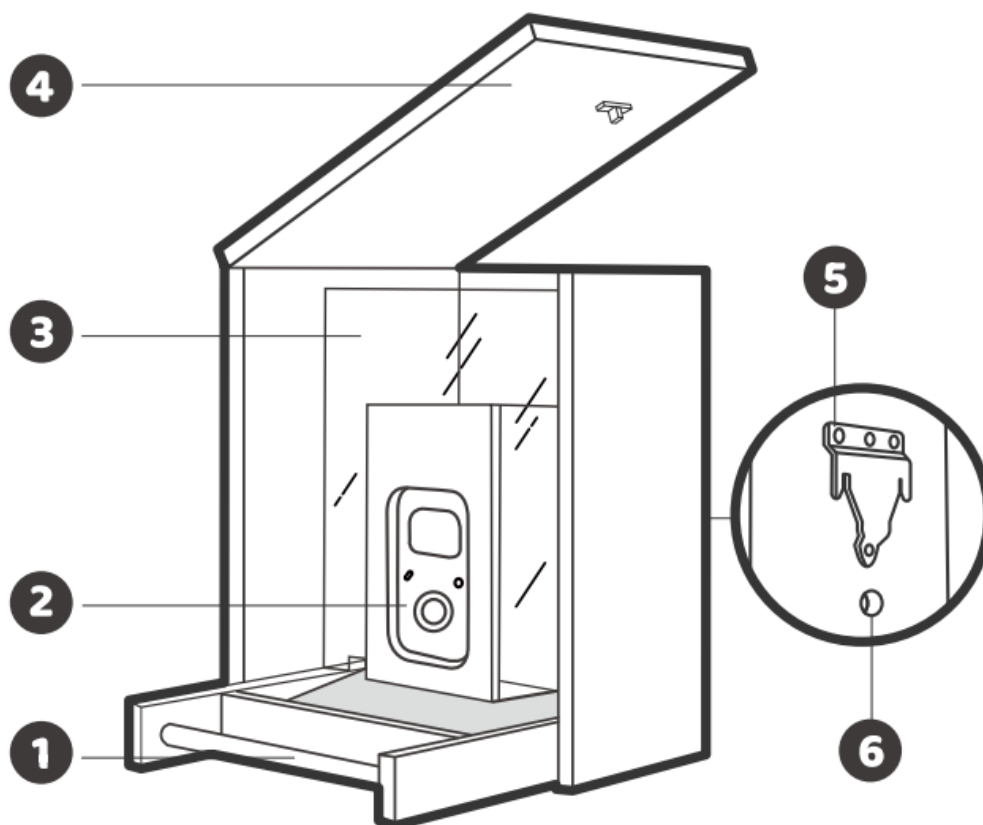

1. Perch
2. Camera
3. Acrylic panel
4. Seed bin cover
5. Mounting bracket
6. Charging cable port

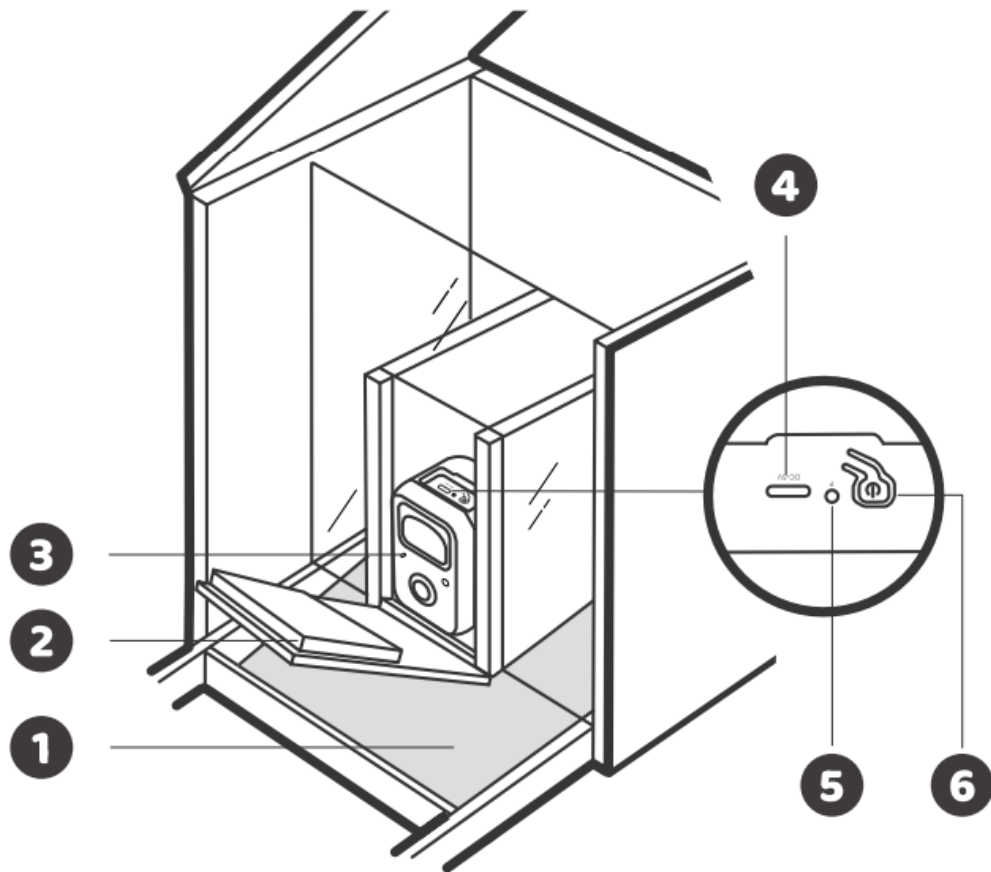

1. Metal mesh
2. Camera compartment cover
3. Status light
4. Charging port
5. Reset hole
6. Power button

\* Please note that the microSD card slot on the camera is intended only for manufacturer testing during production. This product does not support microSD card storage.

## Charging

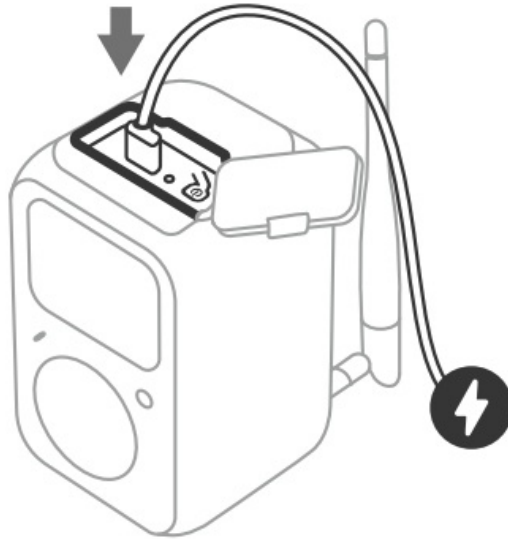

### **Fully charge the camera before use**

- The camera does not come fully charged due to safety regulations. Before using it for the first time, please charge it for 14 hours with the charging cable inside the box (DCSV / 1.SA).

### **Status Light**

- Solid yellow
- Solid green
- Solid blue
- None

### **Description**

- Charging
- Fully charged
- Working
- Sleep/power off

When charging, both the ambient temperature and camera temperature should be above 32°F (0°C). If the camera has been exposed to low temperatures for an extended period, it should be brought back to room temperature before charging.

## Downloading the Birdfy App



## Pair your Birdfy device with the app

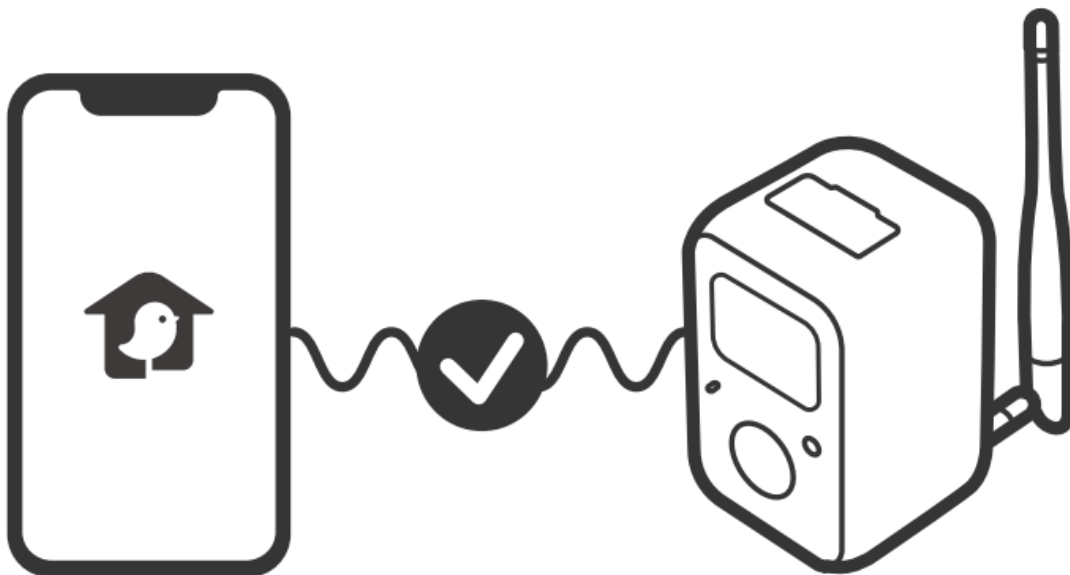

## Bird Identification

- If you have the Birdfy Feeder Bamboo Mini with Lifetime Free AI, the AI bird identification feature is included and activated automatically; no further action needed.
- If you have the Birdfy Feeder Bamboo Mini with AI by Subscription, you need to subscribe on [my.birdfy.com](https://my.birdfy.com) to access this feature.

## Assembly



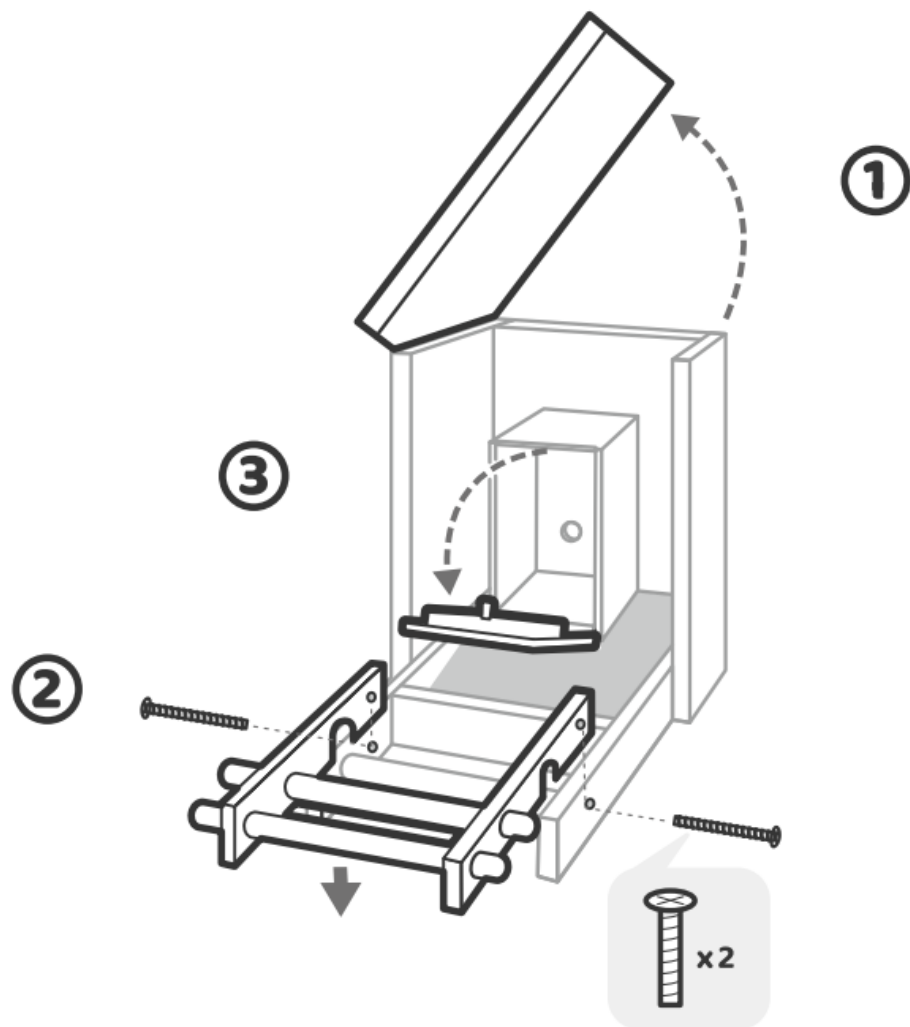

- Install the extension perch with provided screws.

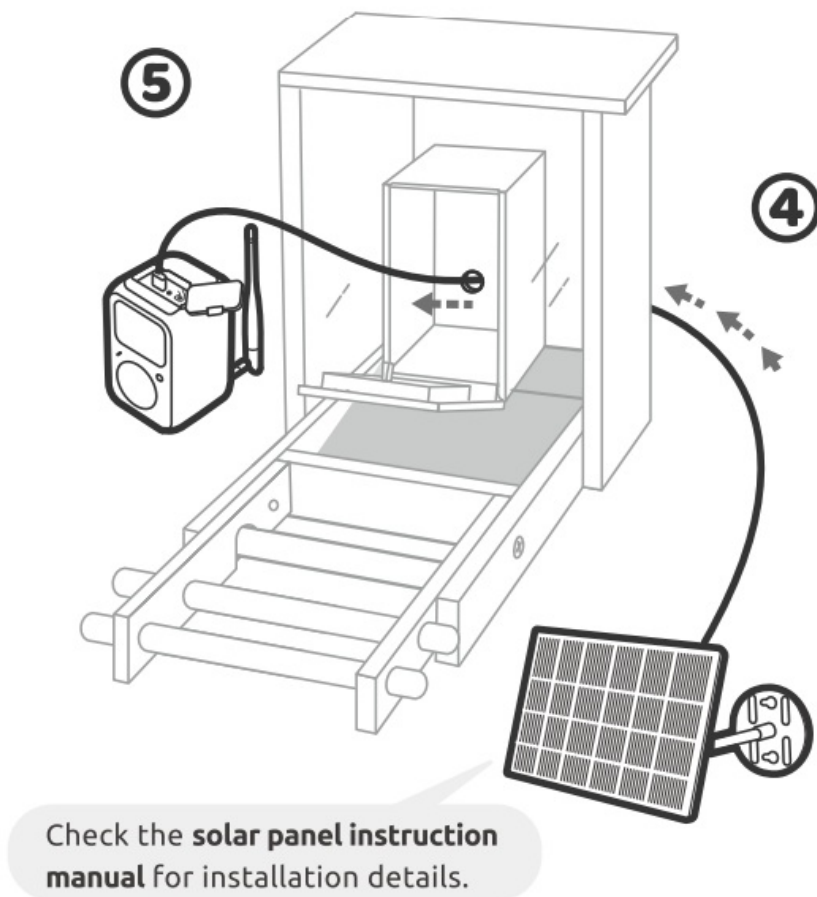

- Connect the camera to the solar panel, then put it into the camera compartment.

## Outdoor Installation

### A. Pole-mounted

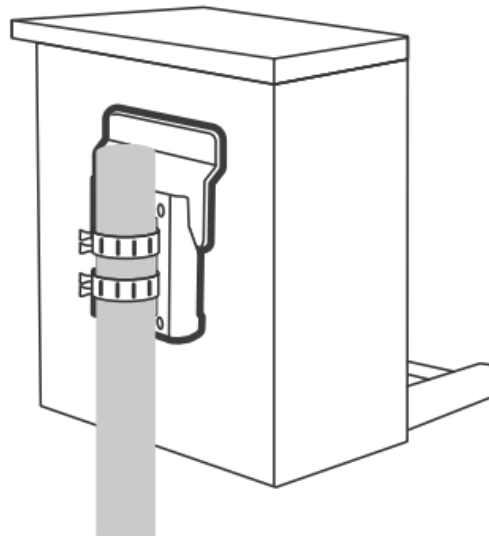
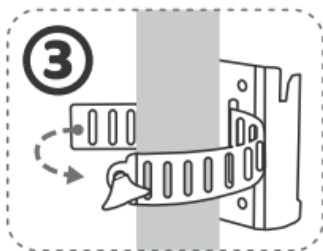
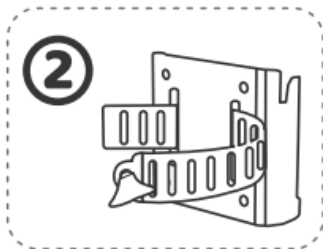
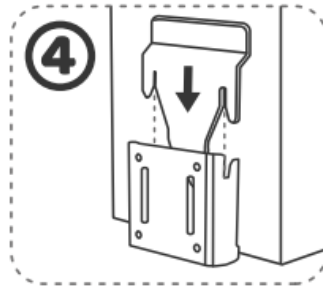
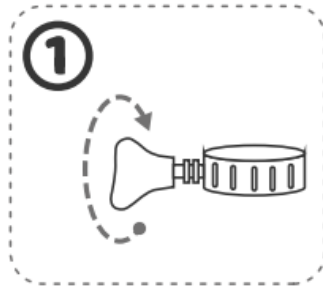

1. Loosen the hose clip.
2. Wrap the hose clip around the bracket.
3. Attach the bracket to the pole.
4. Hang the feeder on the pole.

#### **B. Tree-mounted**

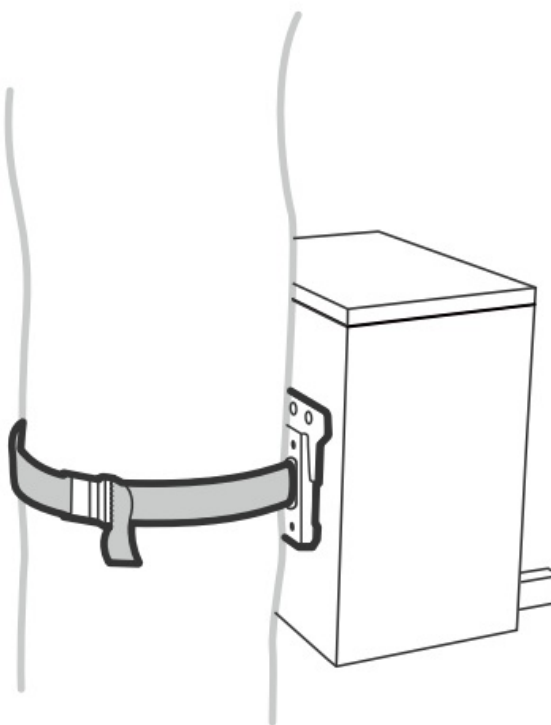
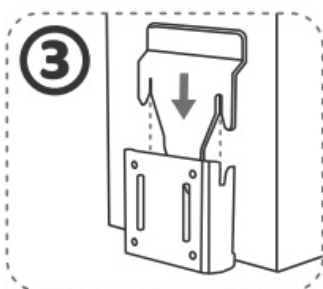
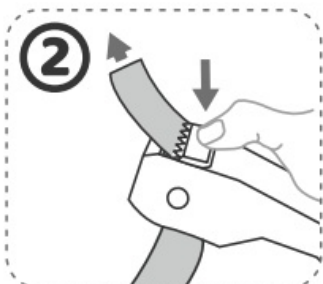
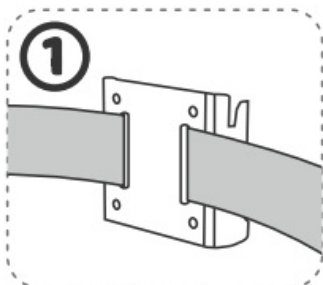
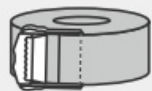

1. Slide the strap through the bracket slots.
2. Wrap the strap around the tree.
3. Hang the feeder on the tree.

### C. Wall-mounted

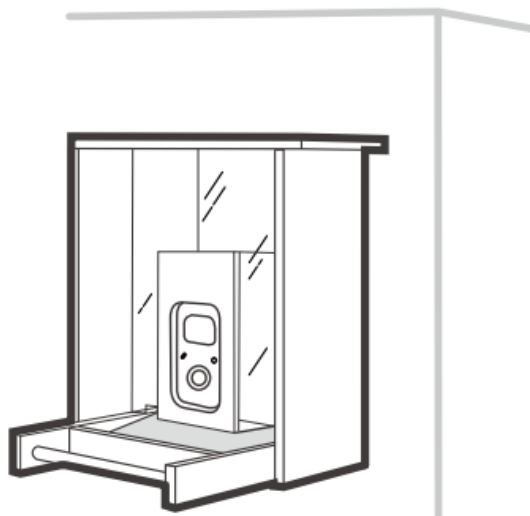
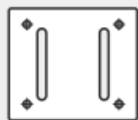

①

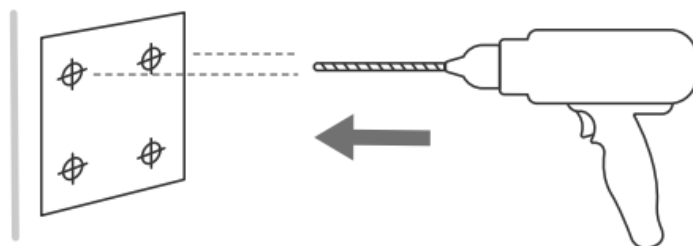

②

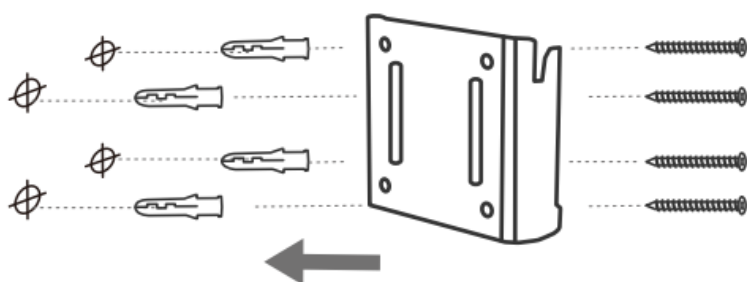

③

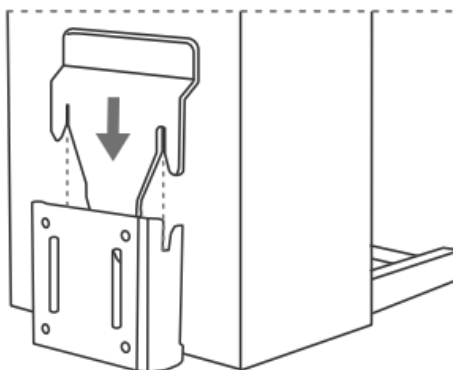

1. Use the drill template and an electric drill (15/64", 6mm) to drill four holes.
2. Drive the provided plastic anchors into the holes. Skip this step if you are mounting on wood. Next, fasten the hanging bracket on the wall using the screws.
3. Hang the feeder on the wall.

### **Adding Birdseed**

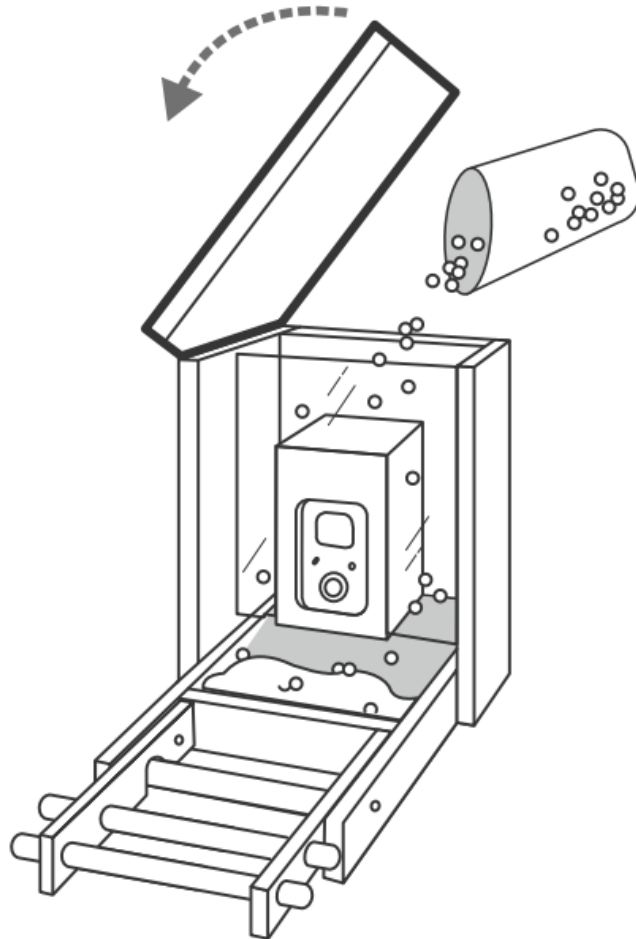

### **Cleaning**

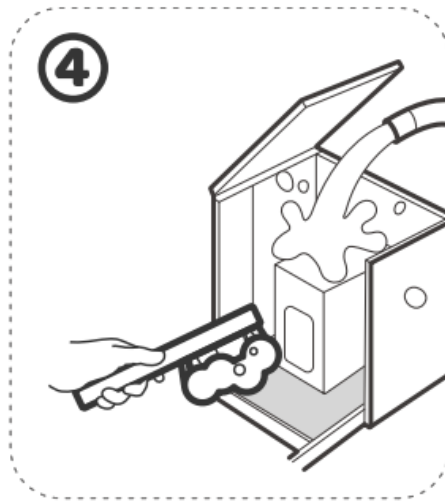
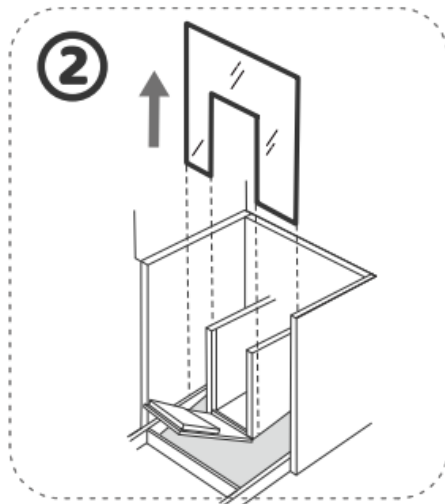
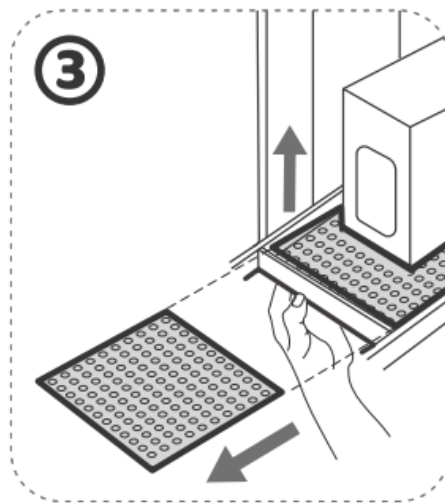
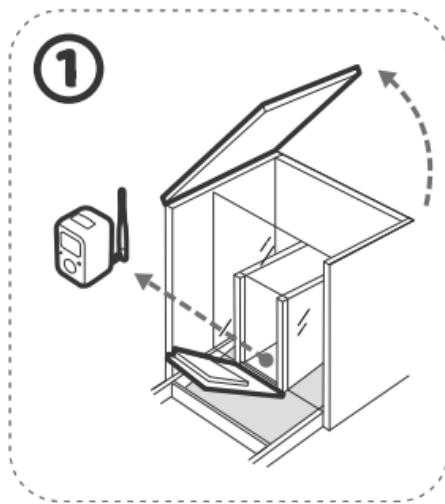

- \* Please note that bleach should not be used.

## Maintenance Seal Your Birdfy

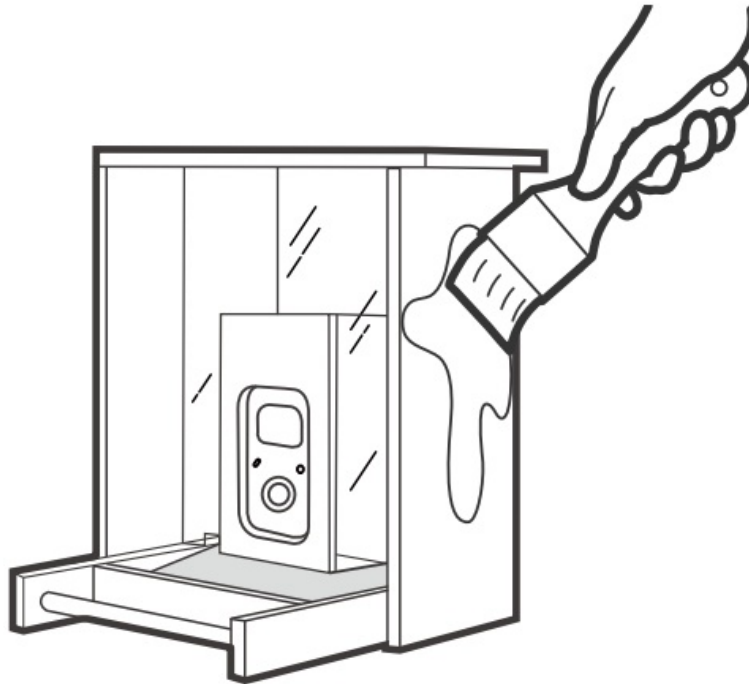

- Ensure the longevity of your bamboo Birdfy product by sealing it before use.

## The Birdfy Community

- Scan the QR code to join our vibrant Facebook community and connect with fellow bird enthusiasts!
- Discover valuable insights on birdwatching and bird feeding techniques, exchange your finest Birdfy captures, and witness exotic birds from around the world!



Birdfy FB Community

Join our community!



@birdfy by netvue



## **Warning**

**Note:** This equipment has been tested and found to comply with the limits for a Class B digital device, pursuant to part 15 of the FCC Rules. These limits are designed to provide reasonable protection against harmful interference in a residential installation. This equipment generates, uses and can radiate radio frequency energy and, if not installed and used in accordance with the instructions, may cause harmful interference to radio communications. However, there is no guarantee that interference will not occur in a particular installation. If this equipment does cause harmful interference to radio or television reception, which can be determined by turning the equipment off and on, the user is encouraged to try to correct the interference by one or more of the following measures:

- Reorient or relocate the receiving antenna.
- Increase the separation between the equipment and receiver.
- Connect the equipment into an outlet on a circuit different from that to which the receiver is connected.
- Consult the dealer or an experienced radio/TV technician for help.

This device complies with part 15 of the FCC Rules.

## **Operation is subject to the following two conditions:**

1. This device may not cause harmful interference, and
2. this device must accept any interference received, including interference that may cause undesired operation.

Any changes or modifications made without explicit approval from the responsible party in compliance may result in the user being unauthorized to operate the device. This device meets the FCC radiation exposure limits for uncontrolled environments. To ensure safe installation and operation, maintain a minimum distance of 20cm between the radiator and your body.

**FCC ID:** 2BC96NI-8411

## **CE Statement**

The information provided on the packaging is allowed to identify geographical areas

within the member states where restrictions on use or requirements for authorized use exist, if applicable. The structure of the product allows it to be used in at least one member state without violating applicable requirements for the use of radio spectrum.

- NETVUE INC.
- 1055 East Colorado Boulevard 5th Floor
- Pasadena,CA,91106

## **IC Statement**

This device contains licence-exempt transmitter(s)/receiver(s) that comply with Innovation, Science and Economic Development Canada's licence-exempt RSS(s). Operation is subject to the following two Economic Development Canada's licence-exempt RSS(s).

### **Operation is subject to the following two conditions:**

1. This device may not cause interference.
2. This device must accept any interference, including interference that may cause undesired operation of the device.

This equipment complies with IC radiation exposure limits set forth for an uncontrolled environment. This transmitter must not be co-located or operating in conjunction with any other antenna or transmitter. This equipment should be installed and operated with a minimum distance of 20cm between the radiator and your body.



-  Contains batteries; keep away from fire.

## **Contact us**

- [support@birdfy.com](mailto:support@birdfy.com)
- In-App Chat
- 1(866)749-0567
- Mon-Fri, 9am-5pm, PST
- [www.birdfy.com](http://www.birdfy.com)

- © Netvue Inc.
- V-Birdfy Feder Bamboo Mini-A3-20240729

## Documents / Resources

 	<a href="#">Birdfy Netvue Feeder Bamboo Mini [pdf]</a> User Manual NI-8411, 2BC96NI-8411, NI8411, Netvue Feeder Bamboo Mini, Feeder B amboo Mini, Bamboo Mini
--	---

## References

- [User Manual](#)

2BC96NI-8411, Bamboo Mini, Birdfy, Feeder Bamboo Mini, Netvue Feeder Bamboo Mini, NI-8411,

Birdfy NI8411

—Previous Post

[Birdfy NI8702 Feeder Cyan User Manual](#)

Next Post—

[Birdfy Cam 2 Pro Feeder Camera with Portrait User Manual](#)

## Leave a comment

Your email address will not be published. Required fields are marked \*

Comment \*

Name

Email

Website

☐ Save my name, email, and website in this browser for the next time I comment.

**Post Comment**

**Search:**

e.g. whirlpool wrf535swhz

**Search**

[Manuals+](#) | [Upload](#) | [Deep Search](#) | [Privacy Policy](#) | [@manuals.plus](#) | [YouTube](#)

This website is an independent publication and is neither affiliated with nor endorsed by any of the trademark owners. The "Bluetooth®" word mark and logos are registered trademarks owned by Bluetooth SIG, Inc. The "Wi-Fi®" word mark and logos are registered trademarks owned by the Wi-Fi Alliance. Any use of these marks on this website does not imply any affiliation with or endorsement.