



BIONIC 8511FEC Blade Blender Instruction Manual

[Home](#) » [BIONIC](#) » **BIONIC 8511FEC Blade Blender Instruction Manual** 

Contents

- 1 [BIONIC 8511FEC Blade Blender Instruction Manual](#)
- 2 **IMPORTANT SAFEGUARDS**
- 3 **UNPACKING – BEFORE FIRST USE**
- 4 **SAVE THESE INSTRUCTIONS FOR HOUSEHOLD USE ONLY.**
- 5 **PACKAGE CONTENTS:**
- 6 **PARTS AND FEATURES – CHARGING**
- 7 **CHARGING**
- 8 **USAGE**
- 9 **USAGE —**
- 10 **CLEANING**
- 11 **CLEANING**
- 12 **STORAGE AND TROUBLESHOOTING**
- 13 **STORAGE**
- 14 **TROUBLESHOOTING**
- 15 **Read More About This Manual & Download PDF:**
- 16 **Documents / Resources**
 - 16.1 **References**

BIONIC 8511FEC Blade Blender Instruction Manual



IMPORTANT SAFEGUARDS

Read all instructions. Before using this appliance, the following basic precautions should always be followed including the following:

- **WARNING:** To avoid personal injury, never blend hot liquid or ingredients in a Bionic Blade blender container. Heated ingredients can build up pressure inside a sealed container during blending and expel hot contents upon opening. Always use refrigerated or room temperature ingredients/liquids (70°F/21°C or cooler).
- Never blend hot or carbonated liquids inside the blender container.
- Do not over blend the ingredients. Do not continuously operate the blender for longer than one minute.
- Due to friction during the blending process, some heat can generate and cause pressure inside the blender container. If the container is warm to the touch, allow to cool before opening it carefully.
- Do not leave mixtures that have been blended inside the sealed container as pressure may built up. To store the mixture, remove the blade assembly and cover the container with plastic wrap, then refrigerate. Do not store in sealed container.
- Do not place any of the Bionic Blade parts in the microwave, oven or stove-top pot or immerse in boiling water as this may result in damage to the Bionic Blade accessory.
- If the unit is operated without any food or water (or too little amount), the motor will run only for 5 seconds.
- Cut food ingredients down to pieces about 2 inch. When processing vegetables or fruits, remove all the cores, hard seeds, thick skin or shells.
- In case a protection mode is activated, it will automatically reset the unit after a brief cool off. Close supervision is necessary when the appliance is operated near children. Do not allow children to use this appliance.

This appliance is not intended for use by persons (including children) with reduced physical, sensory or mental capabilities, or lack of experience and knowledge, unless they have been given supervision or instruction

concerning use of the appliance by a person responsible for their safety. Children should be supervised to ensure that they do not play with the appliance.\

- Before use, please check if the charging cable, or any other part is damaged. Do not operate any appliance with a damaged cable, or after the appliance malfunctions, or is dropped or damaged in any manner. If any of the parts is damaged, stop using the appliance. Do not try to repair it yourself. Return appliance to the nearest authorized service facility for examination, repair or mechanical adjustment.
- Prior to using the device, always check to ensure that all parts are properly assembled. Refer to Usage on p. 6.
- Do not immerse charging cable or housing into water due to the risk of electric shock.
- The use of accessories not recommended by the manufacturer may cause injuries to persons.
- Do not operate the appliance for other than its intended use.]

UNPACKING – BEFORE FIRST USE

When not in use, before putting on or taking off parts and before cleaning – make sure to turn the appliance off. Avoid contact with moving parts while in use to prevent injury and/or damage to the appliance. Do not use fingers to scrape food away from discharge disk while appliance is operating. Cut type injury may result.

- Do not disassemble the parts of the appliance immediately after use until the blade has stopped and the power supply has been disconnected.
- Blades are sharp. Handle carefully. Always operate blender with main power unit and container completely sealed.
- Only open the USB port cover when charging. Cover must remain closed during operation and cleaning.
- Servicing and repair should only be conducted by a qualified technician. « Do not clean the appliance with any abrasive cleaning agents or steel wool.
- Do not submerge the main unit in water.

SAVE THESE INSTRUCTIONS FOR HOUSEHOLD USE ONLY.

UNPACKING – BEFORE FIRST USE

Unpack the unit and all parts and remove all packaging materials. Before using the unit for the first time, wipe the surface of the main power unit with damp cloth. Rinse all part (not the Main Power Unit or cable) in warm soapy water prior to use. Dry all parts thoroughly. Refer to a full cleaning instructions on p. 7 if needed.

WARNING: Do not immerse the main unit, or cable in water or any other liquid. Do not use abrasive cleansers.

PACKAGE CONTENTS:

- = MAIN POWER UNIT WITH BLADE
- = BLENDER CONTAINER (max line 16.50z/490ml)
- = LID WITH SPOUT
- = BLADE COVER
- = USB TYPE-C CHARGING CABLE

PARTS AND FEATURES – CHARGING

LED LIGHT INDICATOR GUIDE

Green Light – indicates the unit is working

Red Light – indicates the unit is charging

Green Light – indicates the unit is fully charged

Flashing Red Light – indicates the unit is very low on power and needs to be charged

Light Flashes Red 3 times – indicates the unit is completely out of power and needs to be charged

Flashing Green Light – indicates the unit is not properly assembled: container and main unit are not aligned.

Light Flashes Red & Green 3 times – indicates the unit is jammed or stopped working after the unit is flipped upright due to too much food inside the container, or ingredients are too hard.

Please refer to Troubleshooting on p.8 for more information.

CHARGING

1. Make sure the unit is turned off. Insert one end of the charging cable into the main power unit.
2. Connect the other end of the cable to power. Insert the USB end into the power adapter (not included).
—— USB TYPE-C CHARGINGCABLE
3. Red LED light indicates that the unit is charging. It should take approximately
4. hours to fully charge the unit. Unit cannot be charged during use.
5. Once fully charged, the indicator light will turn green. Unplug the charging cable.
6. Unit can operate for up to 12 blending cycles (max) on a full charge. It will depend onthe type of ingredients to be blended (blending with less ingredients or softer ingredients
7. will require less power).

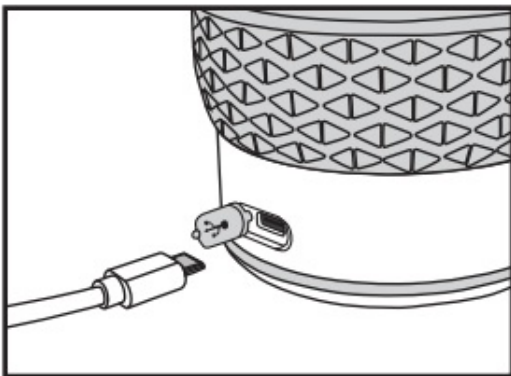

USAGE

USAGE —

USAGE

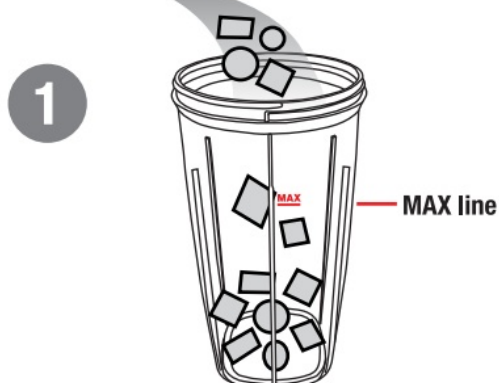

- Add chilled or room temperature ingredients (70°F/21°C or cooler) to the blender container in this order:
- 2-3 ice cubes (if using)
- food ingredients (cut into pieces no bigger than ½ inch)
- water or liquid (about a cup (220ml))
- For best results do not overfill, leave some space at the top. Do not exceed the MAX line (490ml/16.5oz).
- Do not add hot or carbonated liquids.
- If adding frozen food, only use frozen berries or thaw before blending.
- If the unit is operated without any food or water (or too little amount), the motor will run only for 5 seconds.

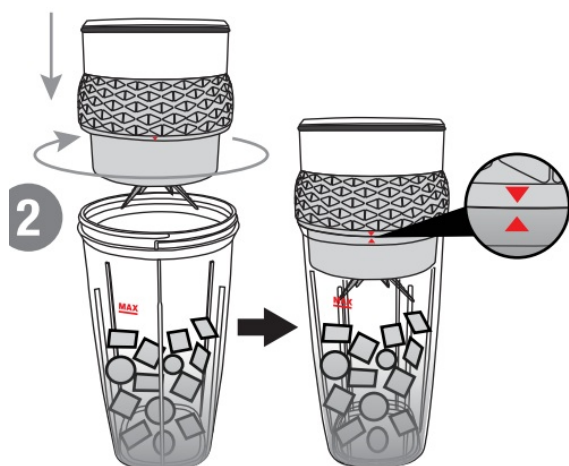

- Make sure to remove the blade cover before blending.
- Place the main power unit over the container and twist it clockwise to tighten.
- Must align both arrows of the main unit and top of container in order to operate blender.
- If both pieces are not properly aligned, the LED indicator light will flash green.
- Remove the main unit from the container and reattach it.

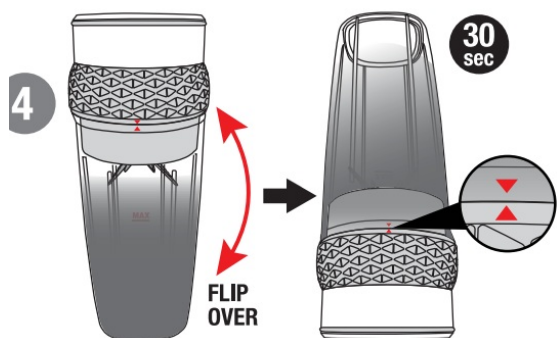

If blending ingredients that are too hard, thick or sticky, shake the blender during blending.

- Safety feature: The unit will automatically stop after blending for 30 seconds. If additional blending is needed, wait a few seconds before pressing the power button.

CLEANING

- To stop blending, press the power button. Attach the lid with one time. The green LED light will turn off spout (included) to once the motor stops. Wait until the blade enjoy the drink on stops moving. the go or pour it

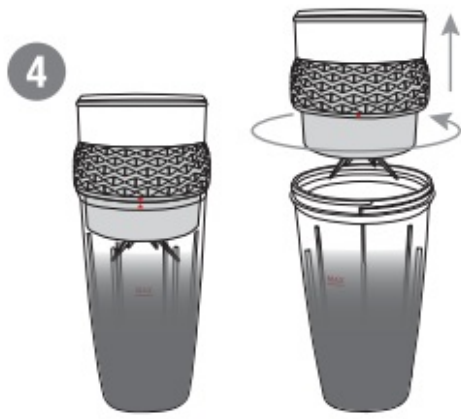

- Flip the blender over and twist the main into a glass. unit counterclockwise to remove from the container.

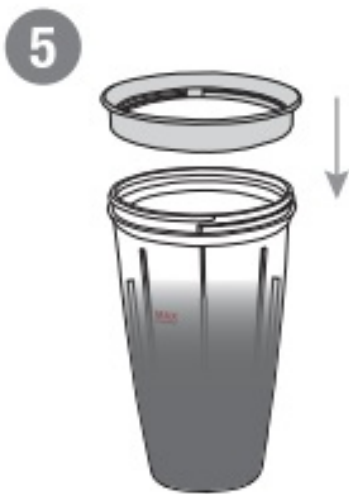

CLEANING

WARNING: Do not immerse the Main Power Unit or charging cable in water or any other liquid. Do not use abrasive cleansers. The unit is NOT dishwasher safe.

CAUTION: Blades are sharp. Handle carefully. Do not let hands come in direct contact with the blades.

CONTAINER AND LID: Do not place in the dishwasher. Using warm soapy water, wash the container and lid. Rinse and dry.

MAIN UNIT WITH BLADE: Close the USB port cover. While holding the main unit, carefully rinse the blade part only, clean with a damp sponge, then dry thoroughly.

Important: Do not fully submerge the main unit under water. Do not place under running water.

QUICK CLEANING: Fill the container with warm soapy water (do not exceed MAX line). Press the Power Button 2 times to turn the unit on for a few seconds.

Empty out the water and rinse.

STORAGE AND TROUBLESHOOTING

STORAGE

- When the container is in use, do not leave the main unit with blade uncovered. Twist the blade cover over the main unit.
- We recommend to charge the unit prior to storing to prolong battery life.
- When storing a complete set, keep all parts together.

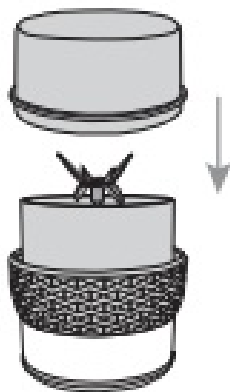

TROUBLESHOOTING

PROBLEM	CAUSE	SOLUTION
Red Light	Unit is charging.	Once unit is fully charged, the LED light will turn green.
Flashing Red Light	Unit is very low on power.	Unit needs to be charged. Connect to charging cable and see p.5 for Charging.
Flashing Red Light (3 times)	Unit is completely out of power.	Unit needs to be charged. Connect to charging cable and see p.5 for Charging.
Flashing Green Light	The main unit and container are not properly aligned.	<ul style="list-style-type: none"> • Remove the main unit from the container. • Make sure to align the arrows of the main unit and top of container to ensure tight closure. • Press the Power button 2 times to turn the unit on. • Flip the unit over and place it down on flat and leveled surface for blending.
Flashing Red & Green lights (3 times)	Blender is jammed or stopped working after the unit is flipped upright, due to too much food inside the container, or ingredients are too hard, thick or sticky.	<ul style="list-style-type: none"> • Open the blender to remove some of the ingredients, or cut into smaller pieces. If blending thick and sticky ingredients, add more water. • Wait at least 15 seconds before blending again.
Red light dims suddenly, then turns off	Blender stopped working after the unit is flipped upright, due to too much food inside the container, or ingredients are too hard, thick or sticky.	<ul style="list-style-type: none"> • Open the blender to remove some of the ingredients, or cut into smaller pieces. Wait at least 2-3 minutes to allow the blender to completely cool down before blending again.

Read More About This Manual & Download PDF:



[BIONIC 8511FEC Blade Blender](#) [pdf] Instruction Manual
8511FEC Blade Blender, 8511FEC, Blade Blender, Blender

References

- [User Manual](#)

Manuals+.