

BIOFIRE 423745 Pouch Loading Station with FilmArray System User Guide

[Home](#) » [BioFire](#) » BIOFIRE 423745 Pouch Loading Station with FilmArray System User Guide 

Contents

- [1 BIOFIRE 423745 Pouch Loading Station with FilmArray System](#)
- [2 Intended Use](#)
- [3 Package Contents](#)
- [4 Review Results](#)
- [5 Documents / Resources](#)
- [6 Related Posts](#)



BIOFIRE 423745 Pouch Loading Station with FilmArray System

Use clean gloves and other Personal Protective Equipment (PPE) when performing this procedure.

Step 1: Prepare Pouch

1. Insert pouch into Pouch Loading Station.
2. Place Sample Injection Vial into red well.
3. Place Hydration Injection Vial into blue well.

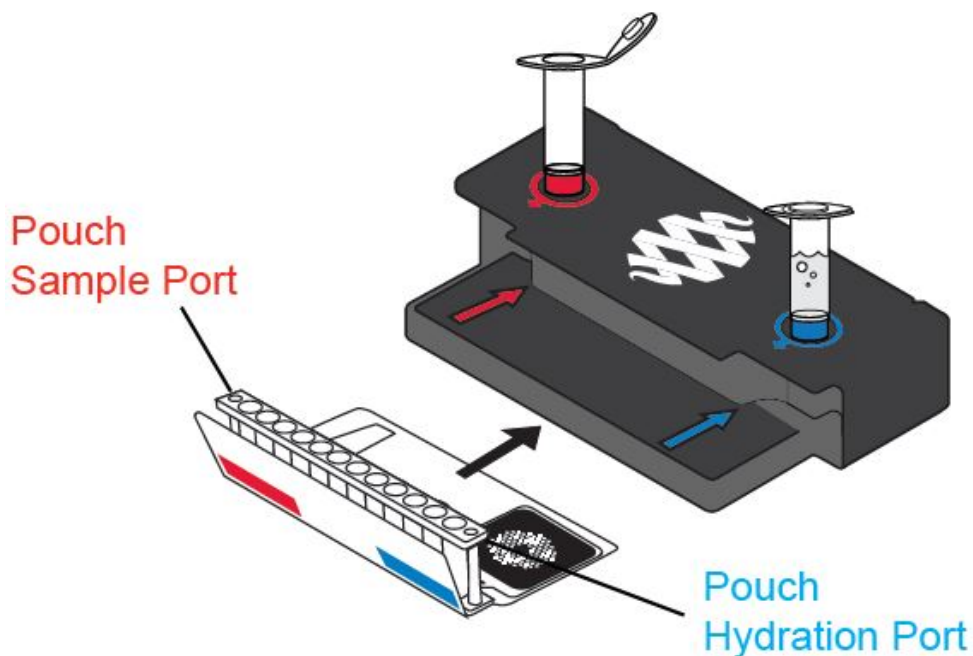

Step 2: Hydrate Pouch

1. Unscrew Hydration Injection Vial from cover.
2. Remove Hydration Injection Vial, leaving blue plastic cover in Pouch Loading Station.
3. Insert Hydration Injection Vial into pouch hydration port.
4. Push down to puncture seal and wait as Hydration Solution is drawn into the pouch.

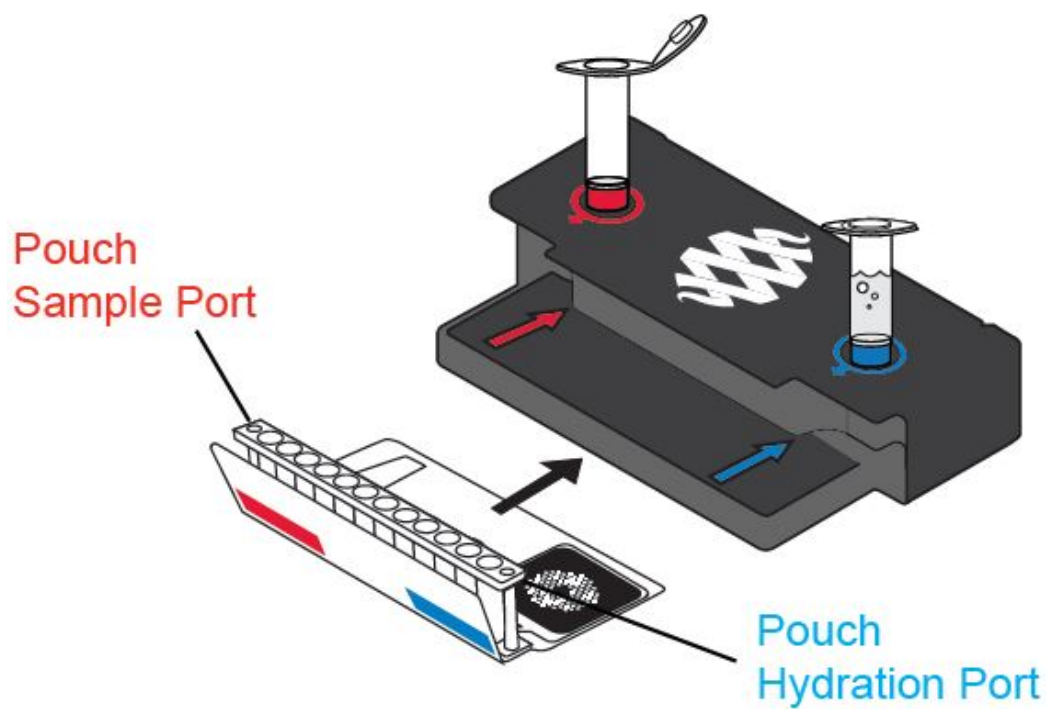

NOTE: Verify the pouch has been hydrated.

Step 3: Prepare Sample Mix

1. Use the transfer pipette to draw specimen in transport media to the 3rd line. Add specimen to Sample Injection Vial.

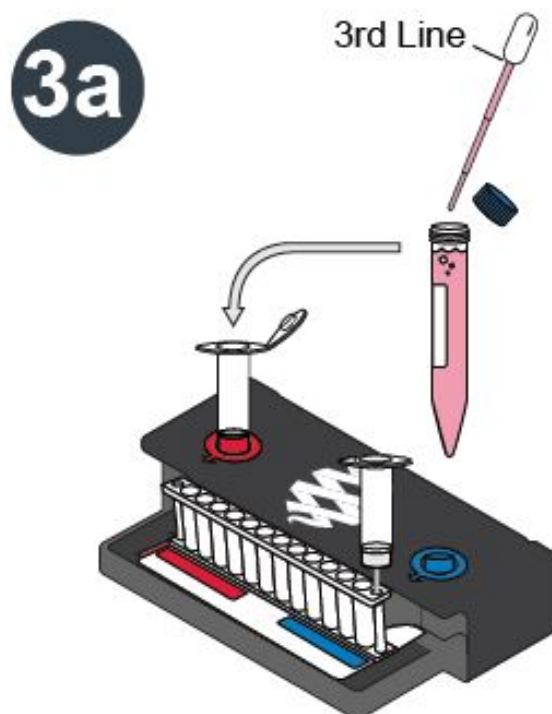

2. Hold Sample Buffer Tube tip facing up and firmly pinch at textured plastic tab on side of tube until seal snaps.

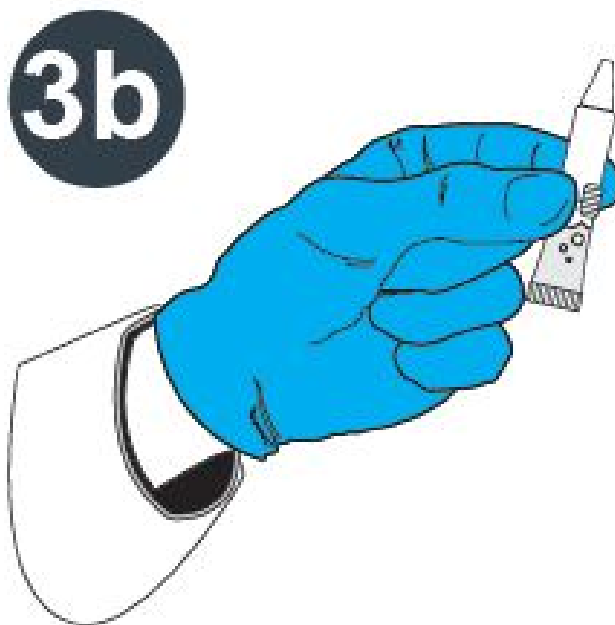

NOTE: Do not touch tube tip.

3. Dispense Sample Buffer into Sample Injection Vial using a slow, forceful squeeze followed by a second squeeze.

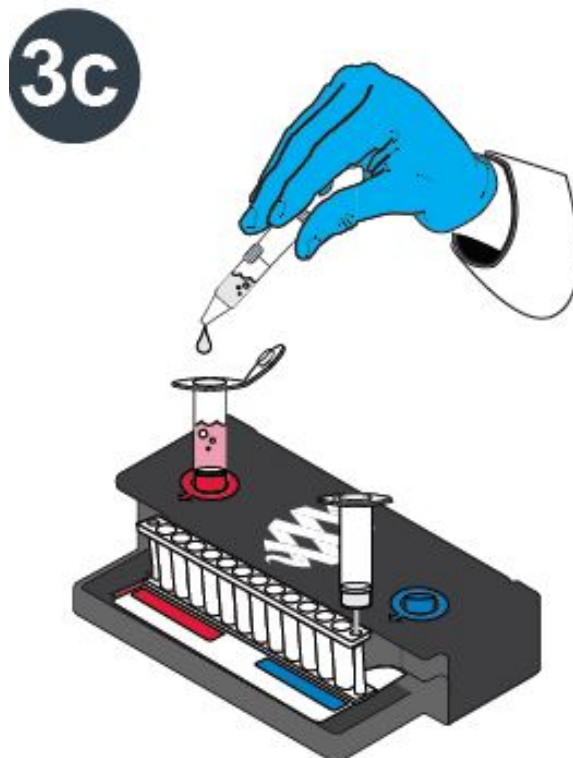

NOTE: Avoid generating excessive foam.

4. Tightly close the lid on the Sample Injection Vial and invert it 3 times, return it to the red well of Pouch Loading Station.

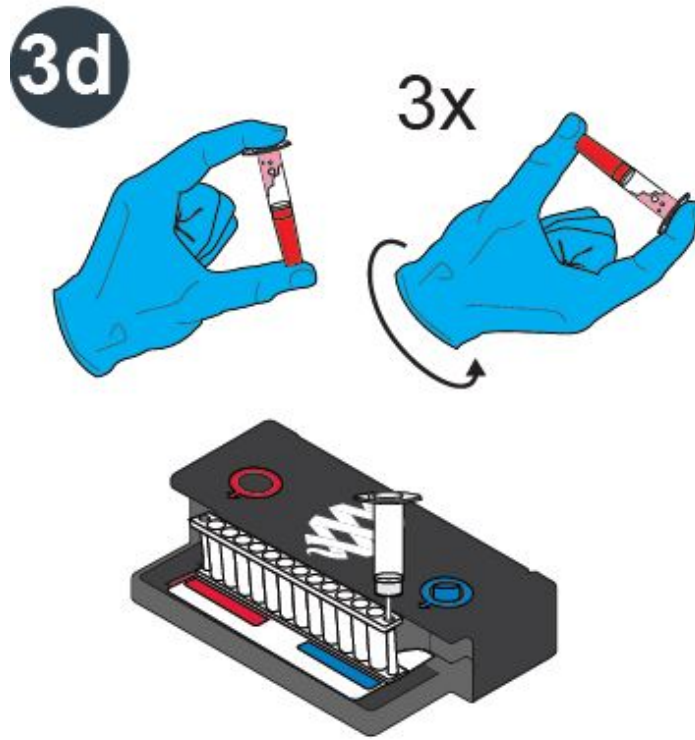

Step 4: Load Sample Mix

1. Unscrew Sample Injection Vial from red plastic cover.
2. Wait for 5 seconds, then lift Sample Injection Vial, leaving red plastic cover in Pouch Loading Station.

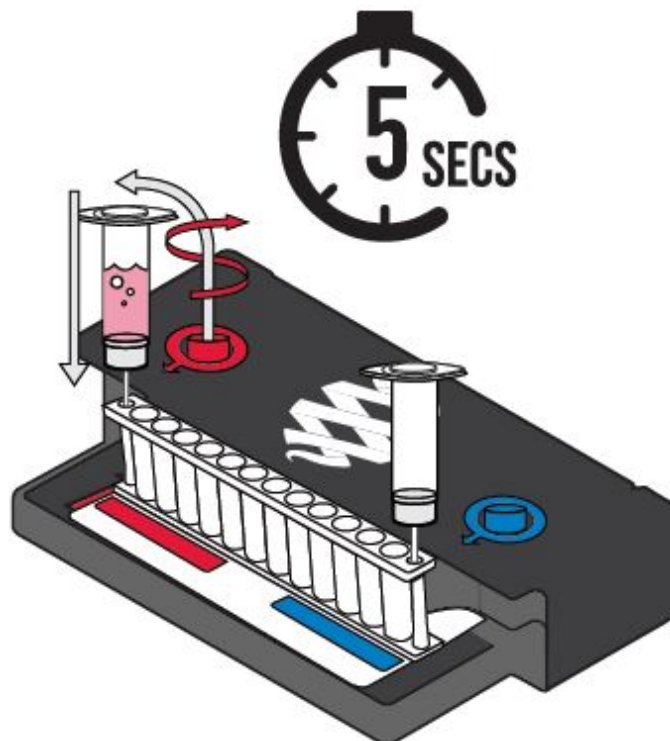

NOTE: Waiting five seconds decreases the contamination risk.

3. Insert Sample Injection Vial into pouch sample port.
4. Push down to puncture seal and wait as Sample Mix is drawn into the pouch.

NOTE: Verify the sample has been loaded.

Step 5: Run Pouch

1. Discard the Sample Injection Vial and the Hydration Injection Vial in a biohazard sharps container.
2. Follow instructions on the computer for starting a test.

Review Results

Run Summary – Displays information about the sample and a summary of the Internal Controls and test results.

Internal Controls:

- If 'Passed', results are valid.
- If 'Failed' or 'Invalid', RETEST SAMPLE and refer to Instructions for Use.
-

BioFire® COVID-19 Test v1.0		BIO FIRE	
www.BioFireDefense.com			
Run Summary			
2a	Sample ID:	Example Report	1
	Detected:	SARS-CoV-2	Run Date: 31 Dec 2019 8:00 AM
	Equivocal:	None	Internal Controls: Passed
Result Summary			
3	Viruses		
	✓ Detected	SARS-CoV-2	
	✓ Detected	SARS-CoV-2a	
	✓ Detected	SARS-CoV-2d	
	✓ Detected	SARS-CoV-2e	
Run Details			
4	Pouch:	COVID-19 Test v1.0	Protocol: NPS2 v3.2
	Run Status:	Completed	Operator: Anonymous
	Serial No.:	01234567	Instrument: FA0000
	Lot No.:	012345	

Figure 1. 'DETECTED' Report

Test Interpretation:

- If 'Detected', or 'Not Detected', report the results.(Figure 1)

BioFire® COVID-19 Test v1.0		BIO FIRE	
www.BioFireDefense.com			
Run Summary			
2a	Sample ID:	Example Report	1
	Detected:	SARS-CoV-2	Run Date: 31 Dec 2019 8:00 AM
	Equivocal:	None	Internal Controls: Passed

- If 'Equivocal', RETEST SAMPLE and refer to Instructions for Use. (Figure 2)

3	Result Summary	
	Viruses	
	→ Equivocal	SARS-CoV-2
	✓ Detected	SARS-CoV-2a
	Not Detected	SARS-CoV-2d
	Not Detected	SARS-CoV-2e
4	Run Details	
	Pouch:	COVID-19 Test v1.0
	Run Status:	Completed
	Serial No.:	01234567
	Lot No.:	012345
	Protocol:	NPS2 v3.2
	Operator:	Anonymous
	Instrument:	FA0000

Figure 2. 'EQUIVOCAL' Report

Result Summary – Displays test interpretation (Top Line) with detailed assay results.

Run Details – Displays information about the pouch, protocol, run status, operator, serial number, instrument, and lot number.

Run Status:

- If 'Completed', run is complete.
- If 'Incomplete', 'Aborted', or any other error message, RETEST SAMPLE and refer to Instructions for Use.\

NOTE: Refer to Instructions for Use for reporting information.

If repeated error messages are obtained, contact BioFire Defense Technical Support.

Conditions of Authorization

The BioFire COVID-19 Test has not been FDA cleared or approved but has been authorized for emergency use by FDA under a EUA for use by authorized laboratories.

The BioFire COVID-19 Test has been authorized only for the detection of nucleic acid from SARS-CoV-2, not for any other viruses or pathogens.

The emergency use of the BioFire COVID-19 Test is only authorized for the duration of the declaration that circumstances exist justifying the authorization of emergency use of in vitro diagnostics for the detection and/or diagnosis of COVID-19 under Section 564(b)(1) of the Federal Food, Drug and Cosmetic Act, 21 U.S.C. § 360bbb-3(b)(1), unless the declaration is terminated or authorization is revoked sooner

Documents / Resources

	<p>BIOFIRE 423745 Pouch Loading Station with FilmArray System [pdf] User Guide 423745, Pouch Loading Station with FilmArray System, 423744</p>
---	--