



Biocare ECG1000 Connecting ECG Machine Instruction Manual

[Home](#) » [Biocare](#) » Biocare ECG1000 Connecting ECG Machine Instruction Manual 

Biocare ECG1000 Connecting ECG Machine Instruction Manual



Contents

- [1 Operation on the computer side:](#)
- [2 Operation on the ECG machine side:](#)
- [3 Documents / Resources](#)
 - [3.1 References](#)

Operation on the computer side:

Lookup of the IP address of a computer:

1. **Open the Command Prompt:** Press the Windows key (Windows logo key) + R, then type "cmd" and press Enter. This will open a Command Prompt window.
2. **Enter the command:** In the Command Prompt window type "ipconfig" and press Enter. Please record the IP address (IPv4) of the computer displayed here.

```

Connection-specific DNS Suffix . : 
Link-local IPv6 Address . . . . . : 
IPv4 Address. . . . . : 
Subnet Mask . . . . . : 
Default Gateway . . . . . : 

```

Operation on the ECG machine side:

IP Address: Set an IP address for the ECG machine that is not occupied by a computer or other device.

Subnet Mask: Same value as computer setting.

Default Gateway: Same value as computer setting.

Or connect the ECG machine to a Wi-Fi network (2.4GHz only).

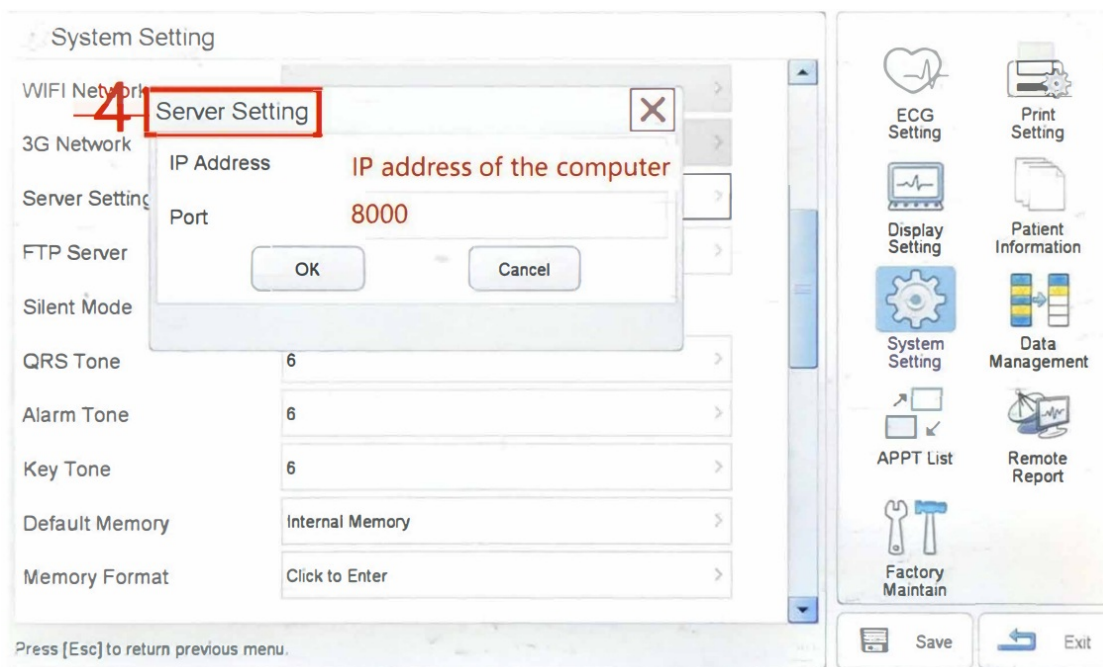

Documents / Resources

	<p>Biocare ECG1000 Connecting ECG Machine [pdf] Instruction Manual ECG1000 Connecting ECG Machine, ECG1000, Connecting ECG Machine, ECG Machine, Machine</p>
---	--

References

- [User Manual](#)

[Manuals+](#), [Privacy Policy](#)

This website is an independent publication and is neither affiliated with nor endorsed by any of the trademark owners. The "Bluetooth®" word mark and logos are registered trademarks owned by Bluetooth SIG, Inc. The "Wi-Fi®" word mark and logos are registered trademarks owned by the Wi-Fi Alliance. Any use of these marks on this website does not imply any affiliation with or endorsement.