

Bimar VPN42 Mist Stand Fan



Bimar VPN42 Mist Stand Fan User Manual

[Home](#) » [bimar](#) » Bimar VPN42 Mist Stand Fan User Manual 

Contents

- 1 Bimar VPN42 Mist Stand Fan User Manual
- 2 GENERAL WARNINGS
- 3 INSTALLATION
- 4 ASSEMBLY
- 5 USE
- 6 CLEANING AND MAINTENANCE
- 7 GUARANTEE
- 8 References



Bimar VPN42 Mist Stand Fan User Manual



This symbol invites you to read these instructions carefully before using the appliance and also to inform other users of them, if necessary. Store this booklet for future reference and the entire lifetime of the device. If any parts of these instructions prove difficult to understand or if in doubt, contact the company at the address written on the last page before using the product.

This symbol highlights instructions and precautions for safe use. Warnings and appliance installation, use, cleaning and maintenance procedures may be updated slightly from those described in this manual; for further details, please consult the updated online manual at www.bimaritaly.it. This symbol indicates Class II electrical insulation, that is, the plug is not earthed. This symbol shows that the fan is suitable for tropical climates at a room temperature of about 40°C.

This symbol indicates Attention: Clean the water tank every three days.

GENERAL WARNINGS

- This appliance is exclusively intended for domestic use, for circulating, cooling and filtering the air in indoor environments, as per the methods outlined in these instructions. Do not use it for other purposes.
- Do not use the appliance outdoors or in very dusty areas or areas with airborne particles/materials that could damage to motor.
- 0Any other use should be considered inappropriate and dangerous. The manufacturer cannot be held responsible for any damages caused by improper, incorrect or irresponsible use and/or by repairs done by an unqualified person.

Examples of appliances for domestic use are those used for common domestic reasons, in domestic environments and that can be used by non-experts:

- in shops, offices and other similar places of work;
- in farming businesses or similar businesses;

- by guests in hotels, motels and other residential-type environments;
- in bed and breakfast accommodation.
- Warning: when using electrical appliances, always follow basic safety precautions to prevent fire, electrocution and physical injury.
- Even more attention and care are required when using electrical appliances incorporating a container/tank of water: should the water overflow, immediately disconnect it from the mains by turning off the switch on the electrical board, and only thereafter, remove the plug from the plug point.
- Check that the electrical parts of the appliance are not wet, and if they are, dry thoroughly and carefully. Plug into the mains and then continue using the appliance. If in doubt consult a qualified professional.
- Do not put any tools or fingers through the mesh of the fan's protective grilles.
- This appliance can be used by children aged 8 years and above and persons with reduced physical, sensory or mental capabilities or lack of experience and knowledge if they have been given supervision or instruction concerning the use of the appliance in a safe way and whether they understand the hazards involved. Children shall not play with the appliance. Cleaning and user maintenance shall not be done by children without supervision.
- The appliance must be kept out of reach of children.
- Do not use the appliance if it does not work properly or if it appears damaged; when in doubt, contact a qualified technician.
- If the appliance is not being used, unplug it from the plug point.
- Always unplug the appliance from the plug point before assembly, disassembly, filling or emptying the tank, and before cleaning the filters and the appliance.
- Do not allow the appliance to be exposed to the weather (sun, rain, etc.).
- Do not move the appliance when it is running.
- Do not touch the device or the plug with wet hands or feet.
- Do not direct the vapour at things or walls.
- Do not breathe in the vapour given off.
- Do not pull on the power cable or the device itself to unplug the appliance from the mains.
- If the power cable is damaged, it must be replaced by the manufacturer or its technical assistance centre or by someone who is similarly qualified, to prevent any risks.
- Make sure the cable is correctly positioned and do not place anything on top of it.
- Ensure that the fan is switched off from the supply mains before removing the guard.
- Do not permit the area around the appliance to become damp. If dampness occurs, turn the output of the nebuliser down.
- Never leave water in the tank when the appliance is not in use.
- Empty and clean the appliance before storing it, and always clean the fan before the next use Empty the tank and refill it every 72 hours.
- Before filling, clean it with cold tap water or with cleaning products, if required by the manufacturer. Remove and descale any deposits or films that have formed.
- Warning: do not use the nebulizer without water. Only use demineralised or distilled water at room temperature. Do not add anything to the water (aromas or essences). Do not use hot water or water from wells; the temperature of the water must never exceed 50°C If the tank is dirty or there are impurities in it, rinse it carefully, drip dry and place it back into the appliance.
- Warning: Microorganisms that may be present in the water or in the environment where the appliance is used

or stored can grow in the water reservoir and be blown in the air causing very serious health risks when the water is not renewed and the tank is not cleaned properly every 3 days.

- Warning: the user of this device must be aware of the fact that the levels of moisture may increase the growth of biological organisms in the environment.
- Increasing warning humidity can promote the growth of the organism.

INSTALLATION

- After unpacking, check that all parts of the appliance are present; if in doubt, do not use it and contact a qualified technician. The packaging materials (plastic bags, polystyrene, metal staples, etc.) must not be left within reach of children, as they constitute possible sources of danger and must be disposed of according to applicable regulations in recycling containers
- All packaging elements must be disposed of according to their raw material (see the symbol stamped on each one) and according to the provisions of their municipality. The secondary elements of the packaging with low weight (es: packing tape) are unmarked as are its small size packing materials, and the protective film of surfaces: therefore you have to follow the procedures for the disposal in force in your municipality.
- Before connecting the appliance, check that the voltage on the data plate matches that of the electric system. In the event of incompatibility between the power socket and the appliance's plug, have the plug replaced with a suitable model by a qualified professional, who should ensure that the cable is appropriate for the power rating of the device. The use of adaptors or extensions is generally not advisable; if it is necessary to use them, they must comply with safety regulations and the total current (amps) must not be rated lower than the maximum current of the appliance.
- Before each use, check that the appliance is in good condition and that the power cord is not damaged: if in doubt consult a qualified professional.
- Do not use the appliance in areas where vaporisers (sprays) or oxygen concentrators are used.
- The plug point must be accessible to easily remove the plug in case of an emergency.
- Stand the appliance on a flat, horizontal and stable surface, and keep it away from:
 - heat sources (e.g. open flames, gas stoves, etc.)
 - liquids (e.g. from bathtubs, showers, sinks etc.) to avoid splashing water and to prevent it from falling into them (the appliance should be kept a minimum of 2 metres away).
 - fabrics (curtains, etc.) or floating materials/particles that may block the aspiration grid; check also that the front part is free from floating particles (dust, etc.).
- Do not use the nebulizer in areas where vaporisers (sprays) or oxygen concentrators are used.
- Do not use together with or directly next to an air freshener or similar product.
- Do not spray flammable substances, such as insecticides or perfume, near the appliance.
- The appliance must be kept away from heat sources and environments with corrosive gases.
- Do not use this appliance if household gas insecticide has been sprayed or in places where there are oily residues, burning incense or chemical vapours.
- Do not remove the tank when the nebulizer is working.

ASSEMBLY

Attention: always unplug the appliance before you assemble it. To assemble it, refer to the figures.

1. Assemble the 5 wheels onto the base, inserting them fully into their respective holes. Check that all 5 wheels are supported.

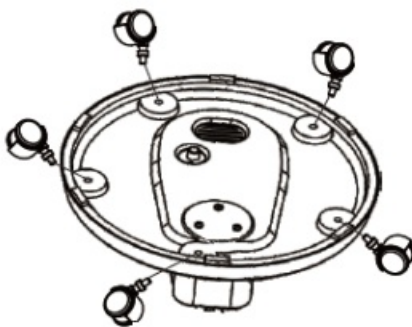

2. Completely unscrew the screw on the base rod. Insert the electrical cables (make sure that no wires are outside) through column (9), so that the lower hole (A) and the hole of the base fixing rod (B) coincide.

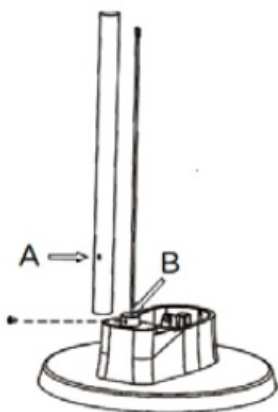

3. Secure the locking with the screw supplied.3. Make sure the 3 screws (C) on the bottom of the base are tightened correctly. At the end of the work, check that the base (including counterweight) and column are firmly assembled.

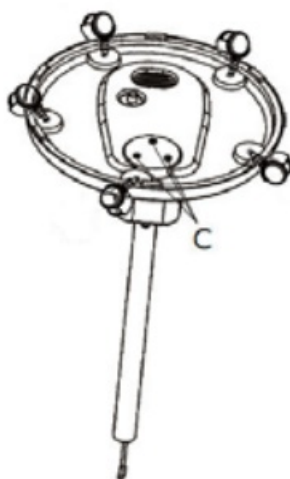

4. Unscrew the pedestal fixing screw (D). Make the electrical connections by connecting the respective connectors (E-F), (2 poles: female ↔ male) and (3 poles: female ↔ male). Position the fan body (make sure that no wires are outside) on the stand, fit the lower hole onto the stand rod, and lock it by tightening the stand fixing screw (D). Unscrew the ring nuts: propeller fastening (3) and rear grille (6).

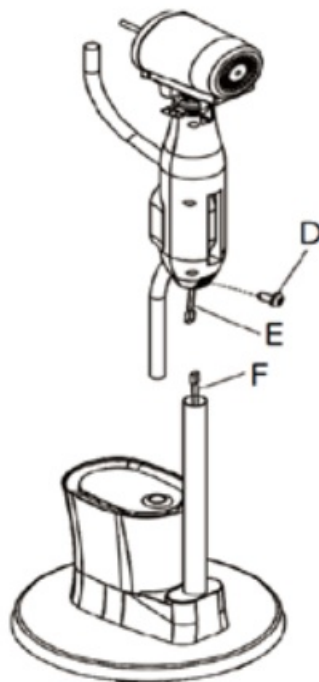

5. Insert the rear grille (7) on the engine crankcase, positioning it so that the pins fit into the corresponding holes, and lock it with the appropriate ring nut (6).
6. Insert the propeller (4) on the motor shaft, so that the slot matches the key. Lock with the appropriate ring nut (3) by screwing it (counterclockwise) tightly.

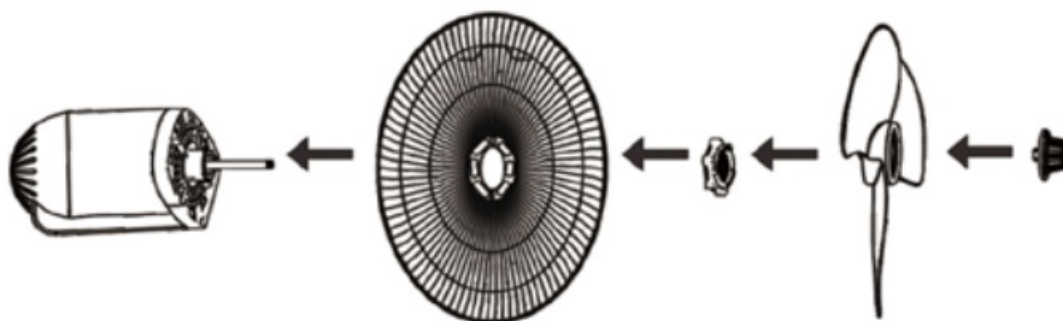

7. Couple the front grille (2) to the rear one (7), so that the hole in the steam ring (1) must face downwards, blocking them with a plastic ring, ensuring fastening with the appropriate screw c/nut (G), (the screw must be in the lower part). At the end of the work, check that the protection grilles are firmly coupled and fixed to the motor. Insert the steam hose (13) into the hole in the front grille as far as it will go.

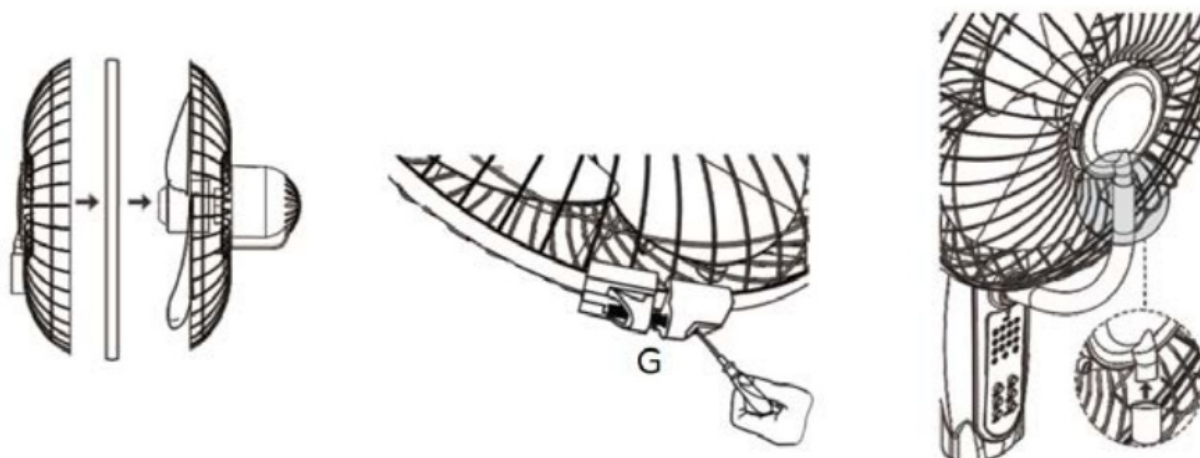

8. At the end of the operation, check the tube is firmly coupled and fixed 7. Check that the tank cap (15) is always correctly inserted and positioned in its seat (14) on the bottom of the base.

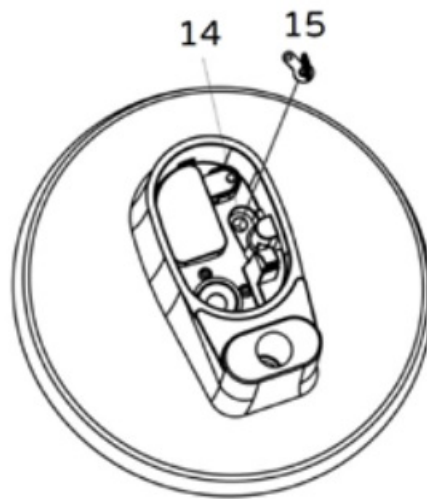

9. Place the tank in its seat. Insert the steam hose (13) of the lower end into the tank and cover the hole as far as it will go. Fill the tank (10), pour in clean water (up to the maximum level indicated "MAX" on the tank, approximately 2.8L water), then position the lid correctly. It is also possible to pour water from the slots in the lid.

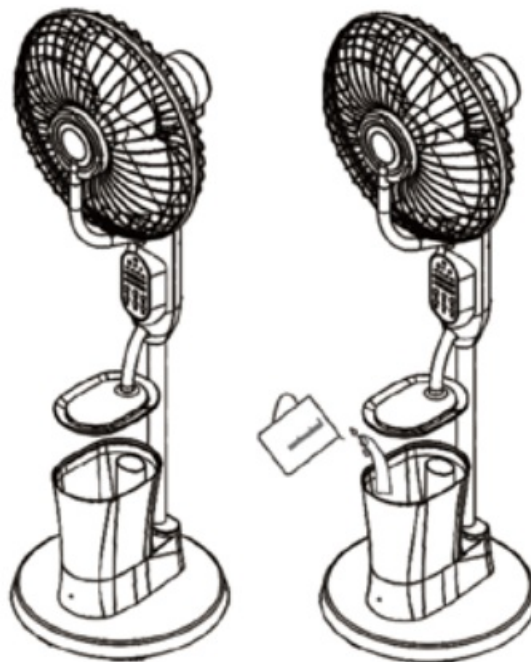

Warning: do not fill the tank beyond the prescribed level.

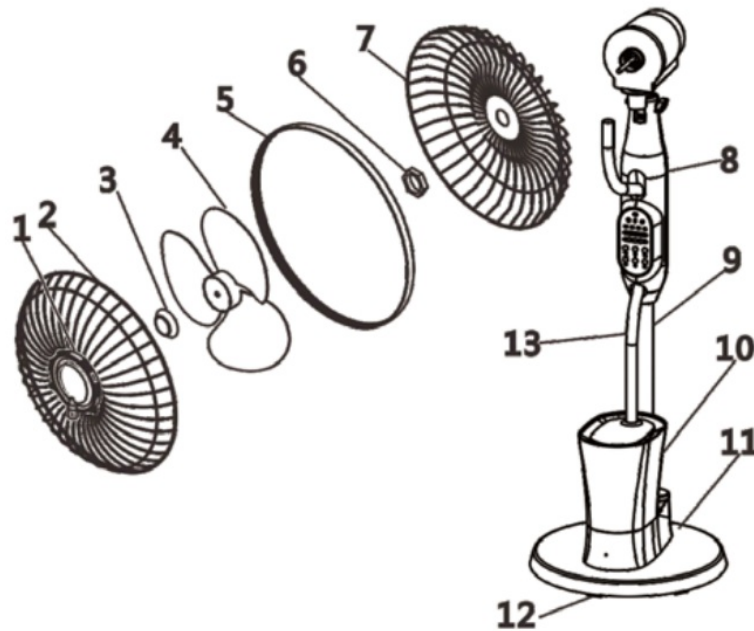

1. Steam ring
2. Front grille
3. Fan fixing ring
4. Helix
5. Grid closing ring
6. Grid fixing ring
7. Rear grille
8. Engine body
9. Column
10. Tank
11. Base
12. Wheels
13. Steam hose

USE

Before each use, verify that the unit is in good condition, and the electric cord is not damaged, if the the power cord is damaged, it must be replaced by the manufacturer or a competent qualified electrician or a person with similar qualifications, to avoid any risk. In addition to the control panel, the convection heater is equipped with a remote control for controlling the functions described on the side: it must be pointed (upper side) towards the control panel, within a 4m distance making a 20-degree angle.

The remote must be pointed at the display. Before using it, insert the batteries (open the rear flap and insert 2 "AAA" batteries (not included) with correct polarity; close the flap). Replacing all batteries at the same time is recommended. Do not mix used batteries with new batteries. Should the remote control not be used for long periods remove the batteries.

WARNING: Do not allow children to replace batteries. Do Not Ingest Batteries. Chemical Burn Hazard. If the battery is swallowed, it can cause severe internal burns in just 2 hours and can lead to death. Keep new and used batteries away from children. If the battery compartment does not close securely, stop using the product and keep it away from children. If you think batteries might have been swallowed or placed inside any part of the body, seek immediate medical attention.

The batteries contain materials, which are hazardous to the environment; they must be removed from the appliance before it is scrapped and that they are disposed of safely. The fan has the following setting and control

elements: – Stand/by-ON button “” (H): to turn the fan on or turn it off in standby mode.

Ventilation: the three speeds are selected by pressing the “O” button: the symbol corresponding to the selected speed will light up (X). Press the button repeatedly, with each press the speed varies: on the display (V): minimum speed, the first three white vertical lines light up at medium speed, and the following lights up: 3 white vertical lines + 3 green lines at maximum speed, the following light up 3 white vertical lines + 3 green lines + 3 red lines Mode: the fan can work both at a constant speed “Mode” (H, M, L), as well as at two different speeds that are intermittent: “Sleep” and “Natural”. The three modes are selected by pressing the “M” button:

Normal: constant ventilation, the symbol will light up (X).

Sleep: the symbol will light up (S). This mode reduces ventilation speed from one speed to a lower speed every half hour. The cycles are:

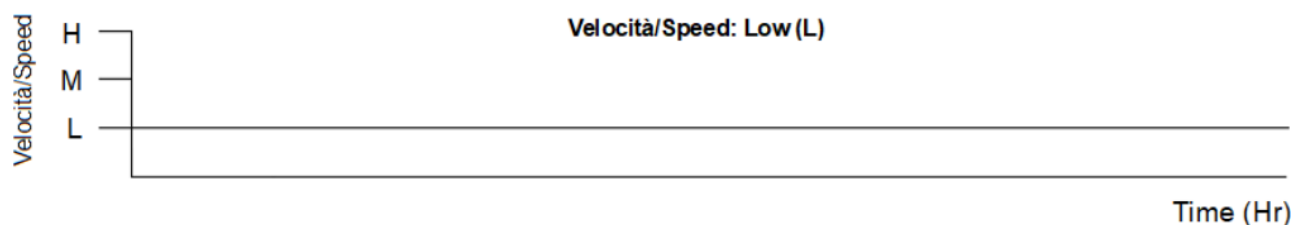
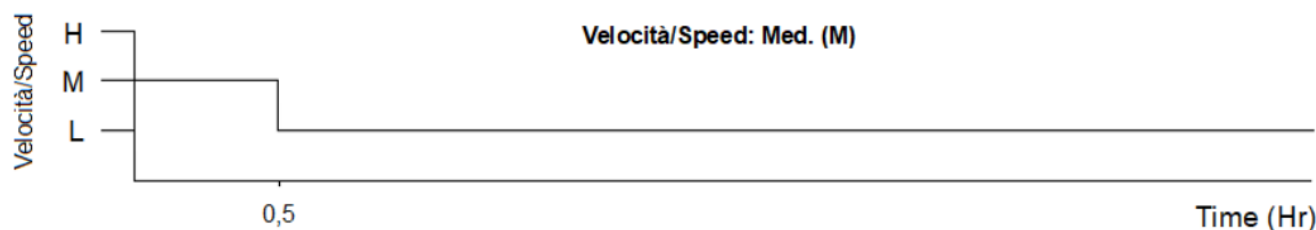
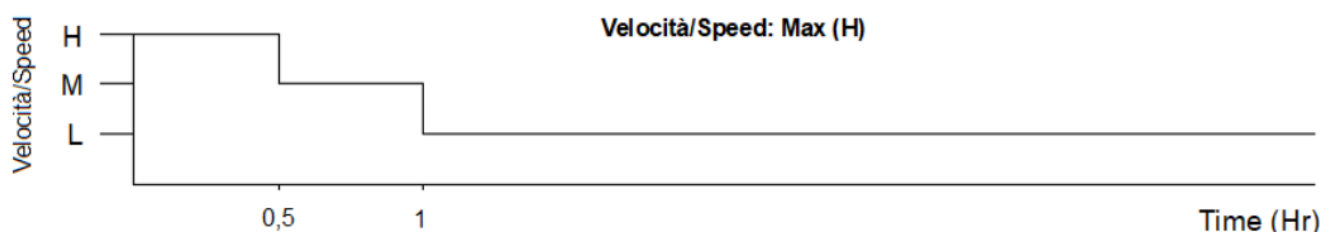

Natural: the symbol will light up (R): speeds are random and cyclic (see images with specified time and speed) during each cycle:

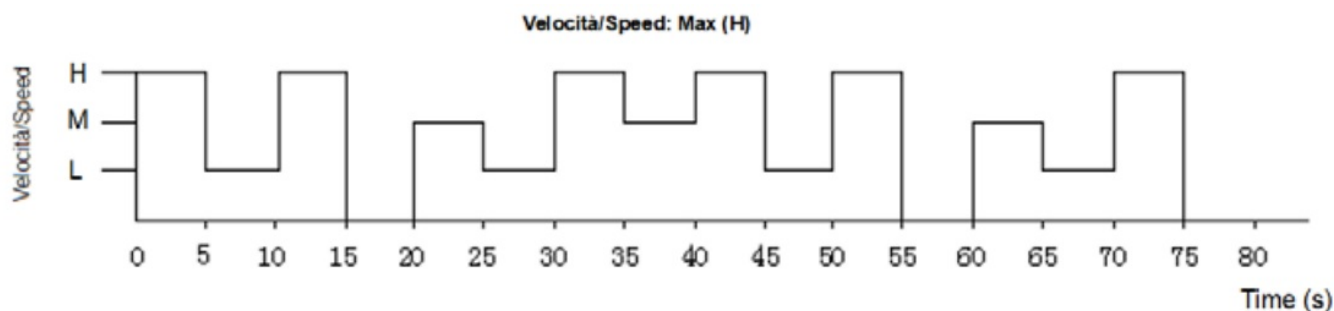

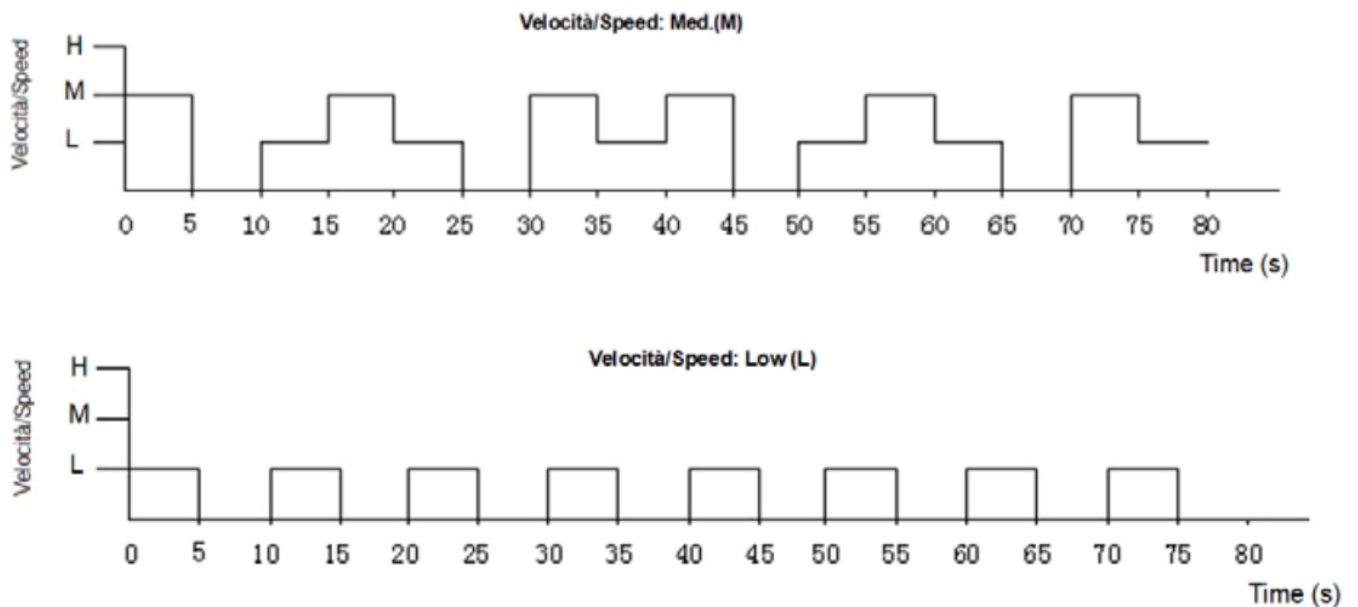

Misting: the temperature of the water must never exceed 50°C. The mister works only when there is water in the tank: only use tap water or distilled water, that does not contain any additives (perfumes or essences). Check that the tank cap is always correctly inserted and positioned in its seat at the bottom of the base. Nebulizer works only if water is in the tank, use only fresh and clean tap water or distilled water, without any additives. Press the button “L” repeatedly, each press changes the volume (ml/h di H₂O):

- Maximum ↔ symbol (U) lit green
- Media ↔ symbol (Q) lit green
- Minimum ↔ symbol (P) lit green

To deactivate the nebulizer, press the button again and the corresponding lights will go off. The indicator lights will be red if there is no water in the tank. Nebulization works even if the ventilation is turned off.

Timer: sets the operating time at which the unit shuts down. Press the “I” button repeatedly: each press changes the time, the symbol will light up (Z) (from 0,5 hour-1 hour-1,5 hour-2 hours, etc), and the maximum operating time is 7.5 hours. To disable the timer, set the maximum time, then press the button again and the corresponding indicator lights will turn off. Horizontal oscillation (right-left): press the “N” button, turn it on and press again to turn it off.

Control Panel

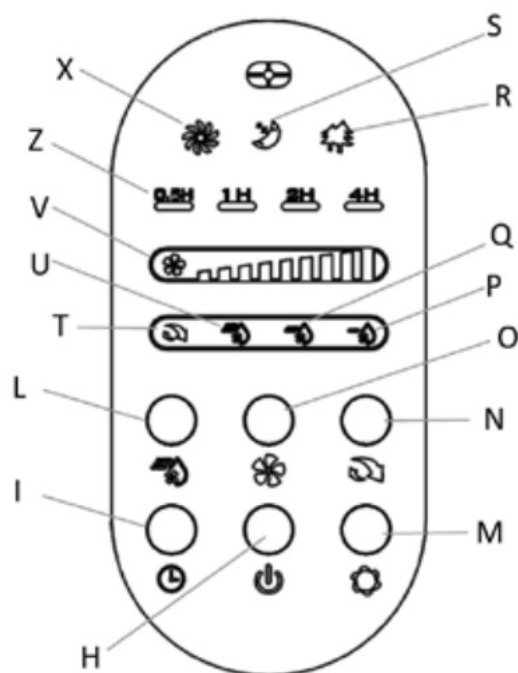

Remote control

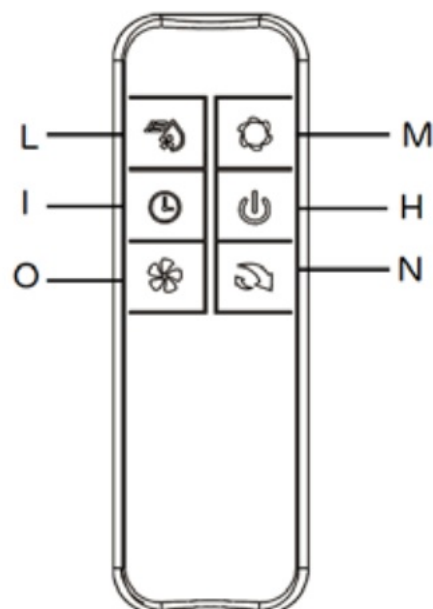

Vertical inclination (up-down): loosen the appropriate screw and adjust by holding the motor body and directing it in the desired direction; screw the screw to lock the motor body in the desired position. To operate the fan, plug it

into a socket: you will hear a “beep” indicating that the appliance is the standby status; press the “” button to

activate the fan and select the desired functions. To deactivate the unit, press the “” button and unplug it from the socket. If the appliance is not being used for long periods, remove the plug from the socket and water inside the tank.

Technical data : 220-240V~50/60Hz 75W

<i>Prescrizioni relative alle informazioni/Information requirements</i>			
Descrizione/Description	Simbolo/Symbol	Valore/Value	Unità/Unit
Portata massima d'aria/Maximum fan flow rate	F	37.92	m ³ /min
Potenza assorbita del ventilatore/Fan power input	P	46.0	W
Valori di esercizio/Service value	Sv	0.82	(m ³ /min)/W
Consumo elettrico in modo “attesa”/Standby power consumption	PSB	0,18	W
Livello di potenza sonora del ventilatore/Fan sound power level	Lwa	56.7	dB(A)
Velocità massima dell'aria/Maximum air velocity	C	2.73	m/sec
Norme di misura per il valore di esercizio/Measurement standard for service value	Regolamento/Commission Regulation(UE) n.206/2012		

CLEANING AND MAINTENANCE

Note: turn the appliance off and unplug it before cleaning.

Descaling

To prevent bacteria or deposits from forming (and Recommend cleaning), and to increase the longevity of the nebulizer and its accessories, remove any limescale deposits (or more frequently if the water is very hard) or impurities.

Tank (weekly)

- Fill the tank with water and add 10/15 drops of white vinegar (8%) or descaling agents.
- After 10 minutes empty, rinse and dry the outside

Main unit/base (performed weekly)

- Clean the inside of the base with a cloth that has been dampened slightly with water and vinegar, then dry. Do not use abrasive products that may damage the surface finish.
- Do not wash it under running water, do not place it in water, and do not wash it in the dishwasher. Before use, ensure it is perfectly dry.
- Failure to maintain and clean the appliance could lead to the formation of micro-organisms in the water.
- The following cleaning operations, therefore, must be performed regularly to ensure the correct and efficient operation of your humidifier periodically check that the vapour outlet is not blocked.

The water tank and its space within the main body must be cleaned periodically: the water must be emptied, then washed with soapy water and rinsed with care, to avoid the formation of dirt and lime scale. To remove any water residue from the tank, unscrew the cap. Avoid the use of abrasive products that can damage the surface finish; do not use steel wool or abrasive products. Before use, ensure they are perfectly dry.

- Failure to maintain and clean the appliance could lead to the formation of micro-organisms in the water. The following cleaning operations, therefore, must be performed regularly to ensure the correct and efficient operation of your nebulizer. We cannot emphasise enough the importance of correct and thorough cleaning of the unit to prevent the formation of bacteria and algae inside the unit.
- To clean the body, use a soft cloth dampened with water and, if necessary, use also a mild everyday detergent.
- Do not use abrasive or corrosive products.
- Do not immerse any electrical parts in water or another liquid. In the event, this occurs, dry carefully and check that the electric parts are perfectly dry and, only thereafter, plug the appliance into the mains. If in doubt, contact a qualified professional.
- If the appliance is not used for long periods, you should store it away from dust and moisture; we recommend using the original packaging.
- If you decide to no longer use the device, it is recommended that it be made inoperative by cutting the power cable (first ensure that the appliance has been unplugged from the power supply), and ensure that any parts that could be a hazard to playing children are put away (e.g. the ice bricks).

GUARANTEE

it is advised to register the appliance on the website <https://www.bimaritaly.it/it/garanzia> or to scan the QR code on the side to properly register the warranty (fill out the form to activate the warranty on the product you purchased).



General guarantee terms

Guarantee coverage starts from the moment of purchase of the appliance as indicated by a fiscally mandatory delivery document (bill tax receipt or shipping document). Guarantee coverage lasts 24 months and terminates after the prescribed term. Guarantee coverage covers all replacements or repairs that become necessary due to defects in material or manufacture. Guarantee coverage does not cover all those parts that become defective due to failure to comply with installation, operating or maintenance instructions, shipping damage, operating neglect or negligence, improper use or any circumstances that are not due to manufacturing defects of the appliance.

Guarantee coverage is also excluded for replacement or repair of all parts subject to fair wear and tear or to expiry, as well as removable parts, light bulbs, glass components, ceramic parts, external tubes, batteries and disposable (throw-away) accessories. Replacements or repairs that come under guarantee coverage are performed free of charge for goods delivered free to the Manufacturer's factory or one of our Technical Service Centres. The Customer must only pay for shipping costs.

Guarantee coverage is not granted if repairs are performed by personnel not belonging to authorized Technical Service Centres or when non-genuine spare parts are used. This warranty is governed by and construed by applicable laws in force in the country where the product is purchased. For details, contact Customer Support in your country or the Bimar website. (www.bimaritaly.it). The Manufacturer declines all responsibility for any direct or indirect harm to persons, pets or property consequent to failure to comply with all the provisions specified in the appliance instruction booklet especially those regarding appliance maintenance, operation, installation or warnings.

Via G.Amendola, 16/18
25019 Sirmione (BS) – ITALY www.bimaritaly.it
Servizio clienti: Assistenza.privati@bimaritaly.it

Download PDF: [Bimar VPN42 Mist Stand Fan User Manual](#)

References

- [User Manual](#)

[Manuals+](#), [Privacy Policy](#)

This website is an independent publication and is neither affiliated with nor endorsed by any of the trademark owners. The "Bluetooth®" word mark and logos are registered trademarks owned by Bluetooth SIG, Inc. The "Wi-Fi®" word mark and logos are registered trademarks owned by the Wi-Fi Alliance. Any use of these marks on this website does not imply any affiliation with or endorsement.