



## bigston C500 LCD Display USB Aansluiting Controle User Manual

[Home](#) » [bigston](#) » bigston C500 LCD Display USB Aansluiting Controle User Manual 

### BIGSTONE C500

#### Turning on the display

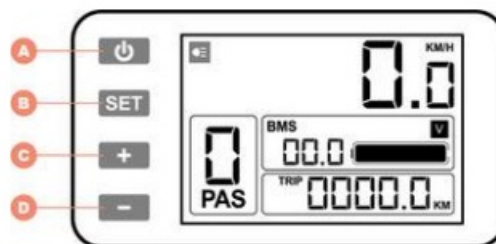

Press the “On/off” button **(A)** left of the display to turn the electric circuit on. The display is turned on and a menu appears.

- A = On/off button and lights
- B = Menu display
- C = Motor support up
- D = Motor support down

#### Switching bicycle lights on and off

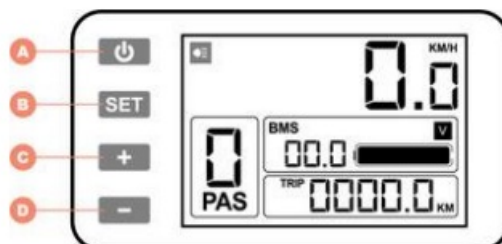

Press the “On/off” button (A) once to turn on the lights. A symbol will appear on the display. Press button (A) again to turn it off.

## Thumb lever

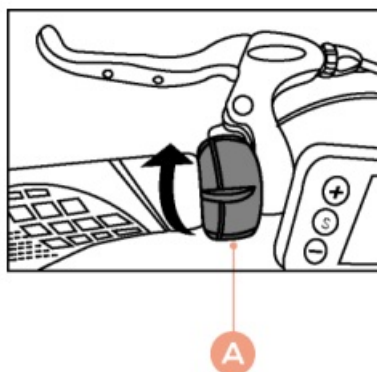

By pushing the lever (A) forward when stationary, the walk assist will be activated (which gives support up to 6 km/h). Walk assist will be activated when the (-) button is pressed for a few seconds.

**Attention:** Walk assist does not work when support mode is set to '0'. Using the lever while pedaling, the support will go to its maximum speed of 25 km/h.

### Contents

- [1 Switching between the 9 levels of electric](#)
- [2 Documents / Resources](#)
- [3 Related Posts](#)

## Switching between the 9 levels of electric

### support

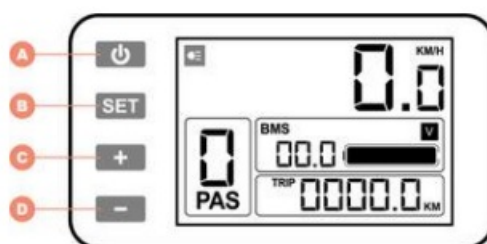

The electric support has 9 positions. The current support setting is shown at the bottom left of the display. You can switch between these settings by briefly pressing the “+” (C) or “-” (D) button.

## USB-port

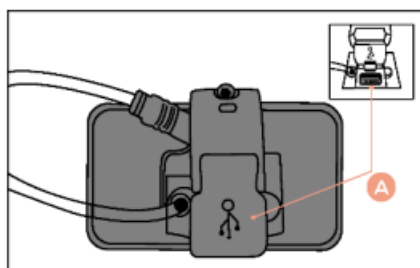

Below the display is a USB port (A) where you can charge, for example, your smartphone or navigation device while cycling. You must activate the port by pressing the “set” and “+” buttons for a few seconds.

Reset Trip mode

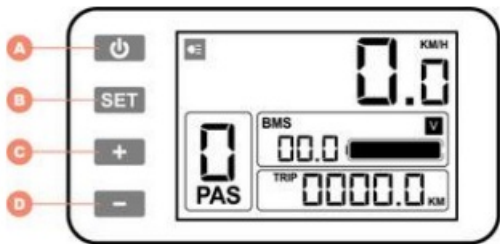

Press the “SET” button **(B)** for a few seconds, maintenance menu will appear. Press the “-” button **(D)** once to reset trip mode. Press the “SET” button **(B)** again to exit the menu.

Documents / Resources

	<p><a href="#">bigston C500 LCD Display USB Aansluiting Controle</a> [pdf] User Manual C500, LCD Display USB Aansluiting Controle</p>
---	---