



BEVERAGE-AIR WTRCS48HC Two Drawer Chef Base Owner's Manual



Contents [[hide](#)]

[1 OPTIONS & ACCESSORIES](#)

[2 CABINET CONSTRUCTION](#)

[3 REFRIGERATION SYSTEM](#)

[4 Model Views](#)

[5 ELECTRICAL CONNECTION](#)

[6 Documents / Resources](#)

[6.1 References](#)

OPTIONS & ACCESSORIES

- Stainless steel back
- Stainless steel interior
- Additional pan supports
- 6" Adjustable legs, 6" seismic legs
- 6" Casters
- Gasket guards

- Flat top overhang (up to 6" overhang on each side)
- Remote option* (refrigerant must be specified at time of order, see note on back on page)

CABINET CONSTRUCTION

- Stainless steel front, sides, drawers and grille (galvanized back & bottom)
- Interior liner is made of corrosion resistant aluminum
- Top has full marine edge to prevent spills from dripping over sides
- Full electronic control
- Top weight capacity 1000 lbs
- One-piece, snap-in magnetic drawer gasket
- 12-Gauge stainless steel drawer slides with Delrin® rollers rated at 275 lbs
- Lifetime warranty on all drawers and slides
- Heavy duty, fire-proof, insulated 16 gauge top
- No heat shield required (must adhere to proper clearance per owners manual)
- Accommodates 6" deep full size food service pans (not included)
- Self-closing drawer feature
- Compressor available on left or right, specify at time of unit order
- 3" Casters, 2 with brakes standard

REFRIGERATION SYSTEM

- Uses environmentally friendly, energy efficient R290 refrigerant, and meets all regulatory requirements for CARB, SNAP, DOE & more
- Adaptive defrost
- Non-electric defrost with hot gas condensate evaporation
- Refrigerator capable of maintaining product temperature 36°F to 38°F



Please verify qualifying units by visiting:

www.energystar.gov/cfs

MODEL	WTRCS48HC
--------------	------------------

EXTERNAL DIMENSIONAL DATA	
Width Overall (in)	48"
Depth Overall (with handle & bumper) (in)	34 3/4"
Height Overall (with casters) (in)	24 3/8"
No. of Drawers / Pans	2 / 4 Full size
Depth with Drawers Extended (in)	57 3/4"
Drawer Openings (in)	(2) 27 3/8" x 6 1/2"
INTERNAL DIMENSIONAL DATA	
NET Capacity (cubic ft.)	7.21
Internal Width Overall (in)	34"
Internal Depth Overall (in)	22 3/8"
Internal Height Overall (in)	16 3/8"
ELECTRICAL DATA	
Full Load Amperes	3.3
Voltage	115/60/1
Nema Plug (8' cord)	5-15P
REFRIGERATION DATA	
Horsepower	1/3
Capacity (BTU/Hr)	1942
Heat Rejection (BTU/Hr)	2913
Charge (lbs/grams/ounces)	0.287 / 130 / 4.59

WEIGHT DATA	
Gross Weight – Crated	375 lbs
Height – Crated	27"
Width – Crated	58"
Depth – Crated	38"

NOTE: Remote units are field wired and come with 6” legs. Refrigerant must be specified at time of order.

We reserve the right to change specifications and product design without notice. Such revisions do not entitle the buyer to corresponding changes, improvements, additions or replacements for previously purchased equipment. Dimensional tolerances +/- 1 /4”.
Metric dimensions (MM).

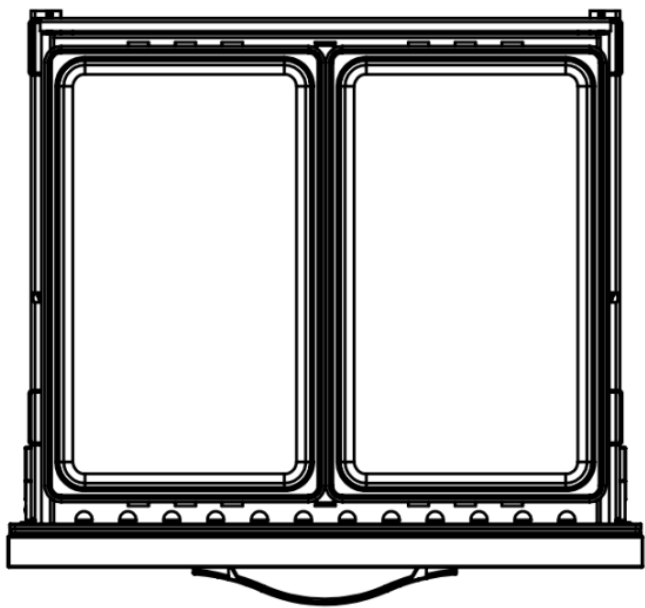

(Per drawer)

Model Views

PLAN VIEW

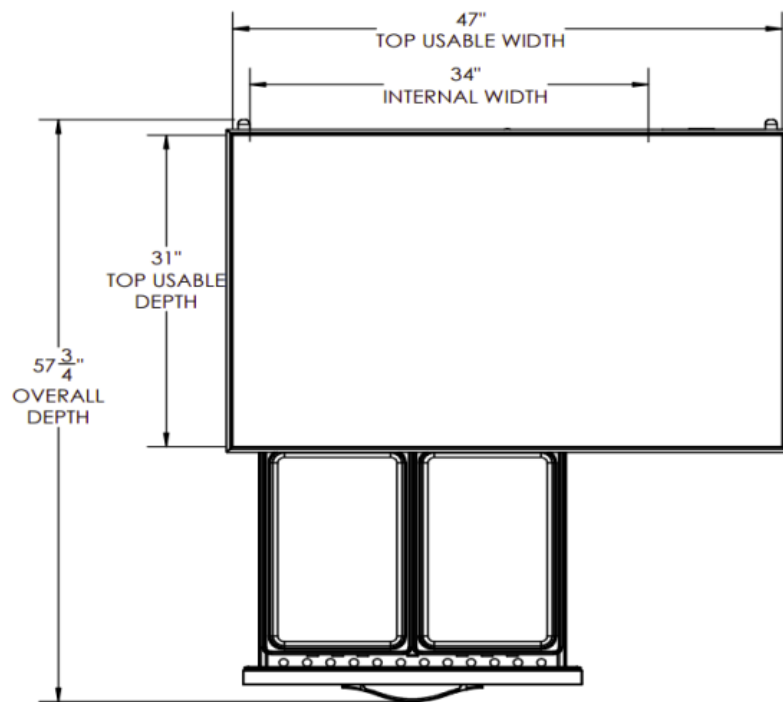

ELEVATION VIEW

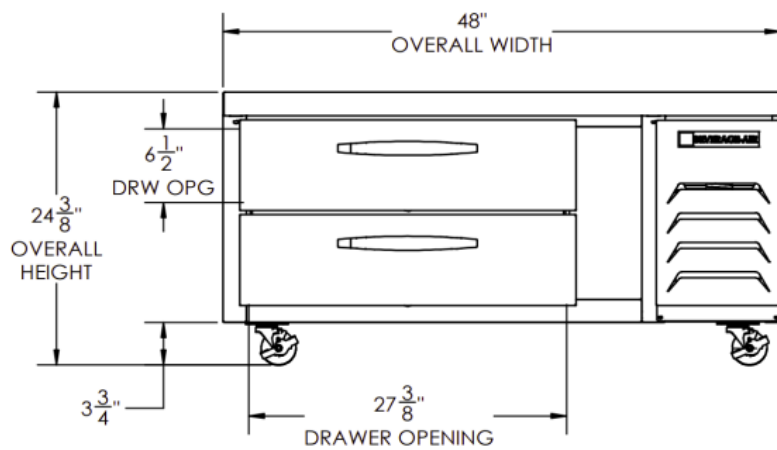

SIDE VIEW

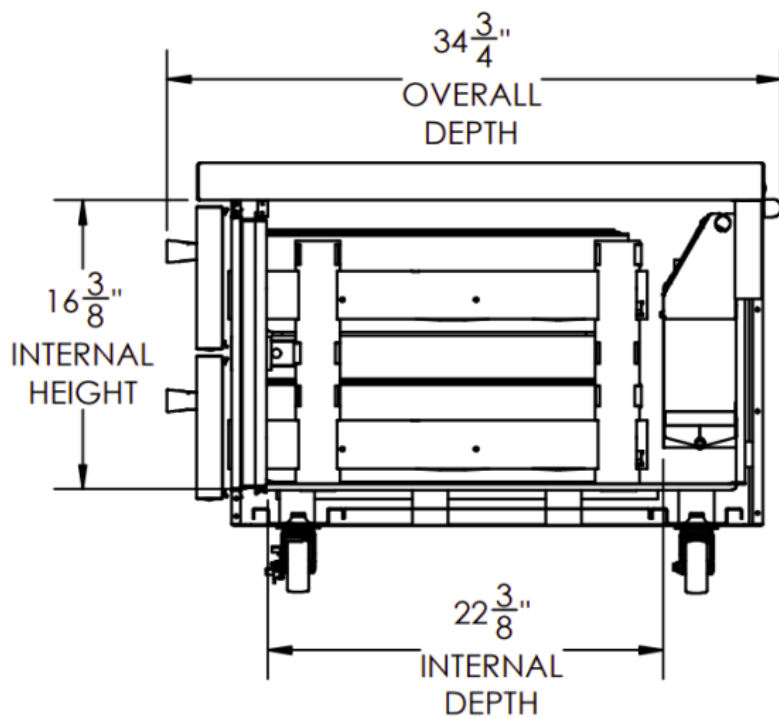

ELECTRICAL CONNECTION



115/60/1 NEMA 5-15P

Unit pre-wired at factory and include 8' long cord and plug set.

Symbols



3779 Champion Blvd., Winston-Salem, NC 27105

1-[888-845-9800](tel:8888459800)

Fax: 1-[336-245-6453](tel:3362456453)

Beverage-Air.com

Sales@bevair.com



BEVERAGE-AIR®

Documents / Resources



[BEVERAGE-AIR WTRCS48HC Two Drawer Chef Base \[pdf\]](#) Owner's Manual

WTRCS48HC Two Drawer Chef Base, WTRCS48HC, Two Drawer Chef Base, Drawer Chef Base, Chef Base, Base

References

- [User Manual](#)

■ Beverage-Air

◆ Base, Beverage-Air, Chef Base, Drawer Chef Base, Two Drawer Chef Base, WTRCS48HC, WTRCS48HC Two Drawer Chef Base

Leave a comment

Your email address will not be published. Required fields are marked *

Comment *

Name

Email

Website

☐ Save my name, email, and website in this browser for the next time I comment.

Post Comment

Search:

e.g. whirlpool wrf535swhz

Search

[Manuals+](#) | [Upload](#) | [Deep Search](#) | [Privacy Policy](#) | [@manuals.plus](#) | [YouTube](#)

This website is an independent publication and is neither affiliated with nor endorsed by any of the trademark owners. The "Bluetooth®" word mark and logos are registered trademarks owned by Bluetooth SIG, Inc. The "Wi-Fi®" word mark and logos are registered trademarks owned by the Wi-Fi Alliance. Any use of these marks on this website does not imply any affiliation with or endorsement.