



Bestway 67922 TriTech Connect and Rest 3 in 1 Inflatable Mattress Owner's Manual

[Home](#) » [Bestway](#) » Bestway 67922 TriTech Connect and Rest 3 in 1 Inflatable Mattress Owner's Manual 

Contents

- [1 Bestway 67922 TriTech Connect and Rest 3 in 1 Inflatable Mattress](#)
- [2 WARNING](#)
- [3 INFLATION](#)
- [4 DEFLATION](#)
- [5 REPAIR](#)
- [6 DISPOSAL](#)
- [7 CLEANING AND STORAGE](#)
- [8 Documents / Resources](#)
 - [8.1 References](#)
- [9 Related Posts](#)

Bestway®

Bestway 67922 TriTech Connect and Rest 3 in 1 Inflatable Mattress



©2022 Bestway Inflatables & Material Corp.

All rights reserved Trademarks used in some countries under license from Bestway Inflatables & Material Corp., Shanghai, China Manufactured, distributed and represented in the European Union by Besay Europe S.p.a., Via Resistenza, 5, 20098 San Giuliano Milanese (Milano), Italy

Distributed in Latin America by

www.bestwaycorp.com

NOTE: Please read instructions carefully before using this airbed. **WARNING:** NOTE: Please read instructions carefully before using this airbed.

WARNING

1. Keep away from heat sources and fires.
2. Avoid the sharp and rough objects, or the airbed may get damages.
3. Do not over-inflated or jump on the airbed, doing so may decrease the airbed's life span.
4. The airbed is not a life saving device, do not use in water.
5. Exclusively designed for air beds

NOTICE: Read the instructions completely and save these instructions.

Retain this booklet for future reference.

CAUTION: There are risks when you use the article in the open and/or watercraft.

6. The airbed is not a toy, children should be supervised to ensure that they do not play with airbed/valve.
7. Max Load: 150kg/330lbs(Single); 300kg/661lbs(King).

INFLATION

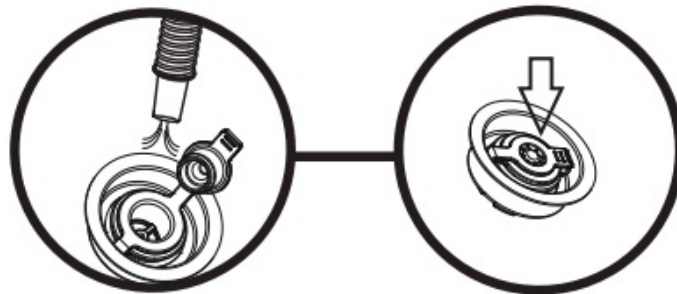

Spread out the airbed and open the valve to inflate. Inflate airbed to proper firmness and most of wrinkles are gone.

NOTE: Do not use high pressure air pump or over inflate.

After use, airbed may require additional air to increase firmness, add air according to your desired firmness.

DEFLATION



Open the valve to deflate.

REPAIR

If the airbed surface is damaged, use the provided repair patch.

To repair:

1. Completely deflate the airbed.
2. Clean and dry the damaged area.
3. Apply a repair patch and smooth out any air bubbles.

NOTE: Never use other liquid glue or adhesive fabric, only use the repair patch like the provided one.

DISPOSAL

If the product is out of service, please cut it and dispose according to your local council. Dispose the package carefully and thoughtfully. Do not litter. To be a good citizen and dispose of litter in an environmentally manner.

CLEANING AND STORAGE

1. If the airbed is dirty, use a clean and gently wipe down the surface. Be sure to dry the airbed before storing.
Check the product for damage at the beginning of each season and at regular intervals when in use.

NOTE: Do not use harsh detergents that may damage the airbed.

2. Once deflated, carefully fold the airbed and store in a cool, dry location away from chemicals and heavy, or sharp objects.

Documents / Resources

	<p>Bestway 67922 TriTech Connect and Rest 3 in 1 Inflatable Mattress [pdf] Owner's Manual 67922 TriTech Connect and Rest 3 in 1 Inflatable Mattress, 67922, TriTech Connect and Rest 3 in 1 Inflatable Mattress, Rest 3 in 1 Inflatable Mattress, 3 in 1 Inflatable Mattress, Inflatable Mattress</p>
---	---

References

- [ned.Se](#)
- [Home Page](#)