

**best**  
best HBN22 Series  
Built In Range  
Hood



# best HBN22 Series Built In Range Hood Instruction Manual

[Home](#) » [best](#) » best HBN22 Series Built In Range Hood Instruction Manual 

## Contents

- [1 best HBN22 Series Built In Range Hood](#)
- [2 Operation](#)
- [3 Installation](#)
- [4 Hood Specifications](#)
- [5 Remove back trim \(optional\)](#)
- [6 Replacement Parts](#)
- [7 Documents / Resources](#)
  - [7.1 References](#)
- [8 Related Posts](#)

**best**<sup>®</sup>

**best HBN22 Series Built In Range Hood**

**WARNING**

TO REDUCE THE RISK OF FIRE, ELECTRIC SHOCK, OR INJURY TO PERSONS, OBSERVE THE FOLLOWING:

- Use this unit only in the manner intended by the manufacturer. If you have questions, contact the manufacturer at the address or telephone number listed in the warranty.
- Before servicing or cleaning unit, switch power off at service panel and lock the service disconnecting means to prevent power from being switched on accidentally. When the service disconnecting means cannot be locked, securely fasten a prominent warning device, such as a tag, to the service panel.
- Installation work and electrical wiring must be done by qualified personnel in accordance with all applicable codes and standards, including fire-rated construction codes and standards.
- Sufficient air is needed for proper combustion and exhausting of gases through the flue (chimney) of fuel burning equipment to prevent backdrafting. Follow the heating equipment manufacturer's guideline and safety standards such as those published by the National Fire Protection Association (NFPA), and the American Society for Heating, Refrigeration and Air Conditioning Engineers (ASHRAE), and the local code authorities.
- When cutting or drilling into wall or ceiling, do not damage electrical wiring and other hidden utilities.
- Ducted fans must always be vented to the outdoors.
- Do not use this unit with any separate solid-state speed control device.
- To reduce the risk of fire, use only metal ductwork.
- This unit must be grounded.
- When installing, servicing or cleaning the unit, it is recommended to wear safety glasses and gloves.
- When applicable local regulations comprise more restrictive installation and/or certification requirements, the aforementioned requirements prevail on those of this document and the installer agrees to conform to these at his own expense.

**WARNING**

**TO REDUCE THE RISK OF A RANGE TOP GREASE FIRE:**

- Never leave surface units unattended at high settings. Boilovers cause smoking and greasy spillovers that may ignite. Heat oils slowly on low or medium settings.

- Always turn hood ON when cooking at high heat or when flambeing food (i.e. Crepes Suzette, Cherries Jubilee, Peppercorn Beef Flambé).
- Clean ventilating fans frequently. Grease should not be allowed to accumulate on fan or filter.
- Use proper pan size. Always use cookware appropriate for the size of the surface element.

TO REDUCE THE RISK OF INJURY TO PERSONS IN THE EVENT OF A RANGE TOP GREASE FIRE, OBSERVE THE FOLLOWING:\*

1. SMOTHER FLAMES with a close-fitting lid, cookie sheet, or metal tray, then turn off the burner. BE CAREFUL TO PREVENT BURNS. If the flames do not go out immediately, EVACUATE AND CALL THE FIRE DEPARTMENT.
2. NEVER PICK UP A FLAMING PAN – You may be burned.
3. DO NOT USE WATER, including wet dishcloths or towels -violent steam explosion will result.
4. Use an extinguisher ONLY if:
  - You know you have a Class ABC extinguisher and you already know how to operate it.
  - The fire is small and contained in the area where it started.
  - The fire department is being called.
  - You can fight the fire with your back to an exit.
  - Based on “Kitchen Fire Safety Tips” published by NFPA

## **CAUTION**

- For indoor use only.
- For general ventilating use only. Do not use to exhaust hazardous or explosive materials and vapors.
- To avoid motor bearing damage and noisy and/or unbalanced impellers, keep drywall spray, construction dust, etc. off power unit.
- Your hood motor has a thermal overload which will automatically shut off the motor if it overheats. The motor will restart when it cools down. If the motor continues to shut off and restart, have the hood serviced.
- The minimum hood distance above cooktop must not be less than 24". A maximum of 30" above cooktop is recommended for best capture of cooking impurities.
- Two installers are recommended because of the large size and weight of this unit.
- To reduce the risk of fire and to properly exhaust air on a ducted installation, be sure to duct air outside – Do not exhaust air into spaces within walls or ceiling or into attics, crawl spaces, or garage.
- Because of the high exhausting capacity of this hood, make sure enough air is entering the house. Open a window close to or in the kitchen.
- To reduce the risk of fire and electrical shock, the BEST HBN5 and HBN22 Series models should only be installed with their own built-in blowers.
- Please read specification label on product for further information and requirements.

For ADA compliance installation guidelines, please type the model number into our website.

## **Operation**



### 1. Lights:

Press this key to turn ON the lights to the last saved intensity. If there was no light intensity saved, the lights will be set on LOW intensity.

Press this key for 3 seconds to switch to Color mode. The LED indicator switches from Intensity to Color mode.

Use the slider to select the desired color. Press for 3 seconds to exit Color mode.

When the lights are ON, press this key to turn the lights OFF and the current light intensity is saved to memory.

### 2. Light Slider and Light LED Bar:

The slider area is spaced in 8 sections from LOW to HIGH. There is no OFF position on the slider.

When touching a section on the slider, the corresponding light intensity illuminates right away on the LED bar.

Light intensity can be increased or decreased by touching the corresponding section on the slider.

### 3. WiFi:

This key is used to pair the range hood (via Bluetooth®) to a smart device and to connect it to your home WiFi network or deactivate WiFi/Bluetooth®

## Activating Pairing Mode

Before starting this procedure, ensure fan and lights are OFF.

Press the key 3 seconds to initiate the pairing process. If the WiFi/Bluetooth function was OFF, it will turn back ON. The WiFi LED indicator will flash (60 sec) showing that the device is ready to be paired.

## WIFI/BLUETOOTH FUNCTIONALITY

To turn OFF the WiFi/Bluetooth function, press the key for 3 seconds. Once the WiFi LED is flashing, press the fan Master ON/OFF key for 3 seconds. The WiFi LED will stop flashing and turn OFF. The WiFi/Bluetooth function will turn OFF. Press the key for 5 seconds to turn back ON the WiFi/Bluetooth function.

Sleep mode: When the fan and lights are OFF and not in use for 3 minutes, the WiFi LED will automatically turn OFF. Pressing any key will turn the WiFi LED back on.

## RESETTING WIFI/BLUETOOTH

To reset the WiFi/ Bluetooth connectivity (remove saved devices and disconnect from the WiFi network), press the key for 3 seconds. Once the WiFi LED is flashing, press the key again for 10 seconds.

## ESSENTIALS TO CONNECT YOUR WIFI/BLUETOOTH UNIT

Before you connect your range hood to a WiFi network, you will need:

- A smart device with the latest version of iOS or Android operating system
- The smart device has access to the internet and WiFi and Bluetooth are enabled
- The smart device is within 5 meters (16 ft.) of the range hood unit
- The range hood unit is within the WiFi signal range of your home network
- The name of your WiFi home network (SSID) and its password
- No other Bluetooth enabled smart device nearby.

## CONNECTING YOUR WIFI/BLEETOOTH UNIT

1. Download the BEST Kitchen app.
2. Follow the instructions in the app.
3. Scan the QR code below using your smart device to download the BEST Kitchen app.



- Apple and the Apple logo are trademarks of Apple Inc., registered in the U.S. and other countries.
- App Store is a service mark of Apple Inc., registered in the U.S. and other countries.
- Google Play and the Google Play logo are trademarks of Google LLC.
- The Bluetooth® word mark and logos are registered trademarks owned by Bluetooth SIG, Inc. and any use of such marks by BEST is under license.
- Other trademarks and trade names are those of their respective owners.

## USING YOUR CONNECTED ITEM

Now that your unit is properly connected, you can experience all the functionalities through the app. Even if you are not physically close to the unit, you can control it through the app using your WiFi network.

## VOICE CONTROL

You can control the range hood through your voice assistant device (Alexa or Google Home). Assigning a custom name in the Best Kitchen app does not make it available on Alexa or Google Home.

## USING ALEXA APP OR ALEXA SPEAKER OR DISPLAY

- You can rename your range hood using the Alexa app. Keep in mind that this only renames the device on Alexa's end.
- Here are some of the currently Alexa voice commands for your range hood:

### Range hood:

- Alexa, turn ON the range hood
- Alexa, turn the range hood ON
- Alexa, turn OFF the range hood
- Alexa, turn the range hood OFF

### Fan:

- Alexa, turn ON the range hood fan
- Alexa, turn OFF the range hood fan
- Alexa, set the range hood fan speed to [1-8]

#### **Lights:**

- Alexa, turn ON the range hood lights
- Alexa, turn OFF the range hood lights
- Alexa, set the range hood lights to [1-8]
- USING GOOGLE ASSISTANT ENABLED SPEAKER OR DISPLAY
- Say “Hey Google” and Google will start listening to your commands.
- Here are some of the currently Google voice commands for your range hood:

#### **Range hood:**

- Hey Google, turn ON the hood
- Hey Google, turn the hood ON
- Hey Google, turn OFF the hood
- Hey Google, turn the hood OFF

#### **Fan:**

- Hey Google, turn ON the range hood fan
- Hey Google, turn OFF the range hood fan
- Hey Google, set the range hood fan speed to one Hey Google, set the range hood fan speed to [1-8]

#### **Lights:**

- Hey Google, turn ON the range hood lights
- Hey Google, turn OFF the range hood lights
- Hey Google, set the range hood lights to [1-8]

### **FIRMWARE UPDATE**

Periodic firmware updates will improve your experience using the unit. You will be able to explore new features that are added to the device and have enhanced user experience while interacting with the device. A BEST user account must be created in order to take advantage of Firmware updates.

When updates are available, you will be notified through the app. We recommend installing updates when they are available; it only takes a few minutes. They should be prompted upon starting the app otherwise it can be manually verified by going in the settings.

When a firmware update is available, you will need:

- The range hood to be connected to your WiFi home network
- Your smart device with the BEST Kitchen app properly installed and configured
- WIFI option to be activated in the application

**Delay OFF:**

When fan is ON or AUTO mode enabled and running, press this key to activate the delay function; the delay OFF LED indicator will turn ON for the duration of the delay (or until cancelled). The fan will continue to operate for 10 minutes and then, will shut off automatically.

When the delay mode is active, it is possible to change the fan speed by touching the fan slider without affecting the remaining time of the delay.

To cancel the delay function before the end of the 10-minute cycle, press again on the delay OFF key, press on AUTO key or turn OFF fan using fan Master ON/OFF key.

When the fan is OFF, pressing this key will have no effect.

**AUTO (SmartSense®):**

When the fan is OFF, press this key to enable the Auto mode. When a cooking session is detected, this function will automatically start the lights at maximum intensity and the fans according to the heat detected on the cooktop. Fan speed gets adjusted with the air quality. The fan will automatically turn OFF when there is no longer sufficient heat detected on the cooktop. The lights will turn off 6 minutes after the blower. After this time, the lights goes back to their previous last saved intensity.

When the hood is OFF and not in use for 3 minutes, the Auto LED indicator will automatically turn OFF. Pressing any key will turn the LED indicator back ON.

To disable the Auto mode, press the Auto key until the LED indicator turns OFF.

**Manual fan speed adjustment in Auto mode:**

When the Auto mode is operating, it is possible to manually change the fan speed using the fan slider. The Auto LED indicator will turn OFF to indicate that the Auto mode is on pause until the Auto key is pressed again. When the Auto mode is operating, it is possible to manually turn the fan OFF using the fan master ON/OFF key. The Auto LED indicator will turn OFF to indicate that the Auto mode is on pause. When the heat is sufficiently low on the cooktop, the Auto mode function will automatically be re-enabled and the Auto LED indicator will turn ON.

When the Auto mode is on pause, it is also possible to enable it again by pressing the Auto mode key.

**Auto Mode Characteristics:**

- The Auto mode sensor measures the temperature and the air quality related to cooking activity.
- The hood will continue to operate if heat is detected on the cooktop.
- The fan may turn OFF when cooking at a very low temperature level, especially with induction units.
- The fan may turn OFF temporarily when adding cold or frozen items in the pan or pot. When the items heat up sufficiently, the fan will automatically turn back ON.
- When opening the door of a hot oven or when running a self-cleaning oven, the fan may start automatically.
- When starting to cook, there may be a short delay of the fan operation while the pot/pan heats up.
- After cooking is finished, the fan may stay ON for a long moment in order to return to before cooking ambient conditions.
- High polluted environment may impact Auto mode responsiveness.
- Automatic infrared controlled operation is possible only from the app.
- Light automation can be disabled from the app.
- Recommended sensitivity according to cooktop: Default: Medium
- Induction: Medium-High
- Electric: Medium-High
- Gas: Low-Medium
- Sensitivity can be tuned according to personal preferences.

**For best Auto mode rendering, refer to dimensions:**

Cooktop	Induction		Electric		Gas	
Height (in)	24	30	24	30	24	30
Max width (in)	38	36	38	40	40	46

### Fan Slider and Fan LED Bar:

The slider area is spaced in 8 sections from LOW to HIGH. There is no OFF position on the slider.

When touching a section on the slider, the corresponding fan speed is activated right away. The fan LED bar will light up as per the corresponding selected section.

When pressing the slider on the same section that is currently active, the fan remains at the same speed. The fan LED bar also remains lit up at the same selected section.

It is possible to touch a section on the slider and then slide the finger into another section. During this time, the corresponding fan speed is activated right away. The fan LED bar will also light as per the corresponding selected section.

### Fan:

Press this key to turn ON the fan to the last saved speed. If there was no speed saved, the fan will be set on LOW speed.

When the fan is ON, press this key to turn the fan OFF and the current fan speed is saved to memory.

When the fan filter reminder is active, press this key for 3 seconds to clear the reminder.

### Filter Cleaning Reminder

When the user turns the fan OFF, and the right section of the fan LED bar flashes slowly for 30 seconds, then this means it is time to clean the hood and filters (every 30 hours of continuous operation). Refer to the next section.

This will happen every time the user turns the fan OFF (and the timer has not been reset). Once the cleaning is done, at any time during the 30-second signal (and the fan is OFF), a long press on the fan key will reset the timer and stop the fan LED bar flashing.

### Code Ready Technology™ Activation

The Code Ready Technology option allows to change the blower output from the factory setting to a maximum of 400 CFM or 300 CFM. Activating the CRT option will reduce the airflow, so that the range hood will perform within the allowable limit of Make-Up Air (MUA) codes (to meet some building code requirements). Do not change the blower CFM setting unless this change is required by code. This change will alter the performance of the product.

### IMPORTANT NOTES:

1. This change CANNOT be reverted, except for 600 CFM.
2. CRT can only be set within the first 5 minutes of applying power to the unit.
3. A power outage will not deactivate the CRT.
4. Fan and lights must be OFF.

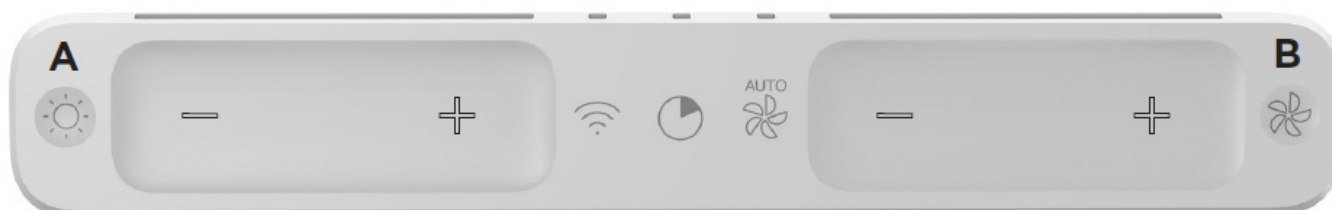

- Switch power OFF using the main power switch (located behind the filters) then turn it ON and press



simultaneously on Lights (A) and Fan (B) keys for 5 seconds; left section of Lights LED bar and right section of Fan LED bar will now flash to indicate you entered the CRT menu.

400 CFM maximum airflow

- 2. To select the 400 CFM maximum airflow, press on the Fan (B) key for 5 seconds, then release; the right section of Fan LED bar will now flash to indicate 400 CFM has been selected (the Lights (A) LED bar will be off).
- 3. A second 5-second press on the Fan (B) key and release confirms the selection; the right section of Fan LED bar quickly flashes twice, and the buzzer sounds a double beep. The user interface returns to normal operation.
- 4. Locate the CRT sticker near the HVI Certification label inside the range hood, behind the filters. Check the proper box (400 CFM).

300 CFM maximum airflow

- 2. To select the 300 CFM maximum airflow, press on the Lights (A) key for 5 seconds, then release; the left section of Lights LED bar will now flash to indicate 300 CFM has been selected (the Fan (B) LED bar will be off).
- 3. A second 5-second press on the Lights (A) key and release confirms the selection; the left section of Lights LED bar quickly flashes twice, and the buzzer sounds a double beep. The user interface returns to normal operation.
- 4. Locate the CRT sticker near the HVI Certification label inside the range hood, behind the filters. Check the proper box (300 CFM).

600 CFM maximum airflow (Except for HBN53696SSs)

- 2. To select the 600 CFM maximum airflow, press on the Delay (C) key for 5 seconds, then release; the Delay light LED will now flash to indicate 600 CFM has been selected (the Lights (A) and Fan (B) LED bar will be off).
  - 3. A second 5-second press on the Delay (C) key and release confirms the selection; the Delay light LED quickly flashes, and the buzzer sounds a double beep. The user interface returns to normal operation.
- If 600 CFM maximum airflow is activated enter the CRT menu by pressing Fan (B) & Light (A) keys for 5 seconds. The Delay light LED will flash fast to indicate current selection.
- Press Fan (B) & Light (A) keys a second time for 5 seconds to reset CFM mode.

## HEAT SENTRY™

Your unit is equipped with a HEAT SENTRY™ thermostat.

This thermostat is a device that will turn on or speed up the blower if it senses excessive heat above the cooking surface.

1. If blower is OFF – it turns blower ON to HIGH speed.
2. If blower is ON at a lower speed setting – it turns blower up to HIGH speed.

When the temperature level drops to normal, the blower will return to its original setting.

NOTE: When Heat Sentry is activated, the fan LED bar flashes slowly and the fan speed cannot be changed.

## WARNING

The HEAT SENTRY thermostat can start the blower even if the hood is turned OFF. When this occurs, it is impossible to turn the blower OFF with its key. If you must stop the blower, set the main power switch (located behind the filters, on inner side of the unit faceplate) in OFF position (if it is possible to do so safely).

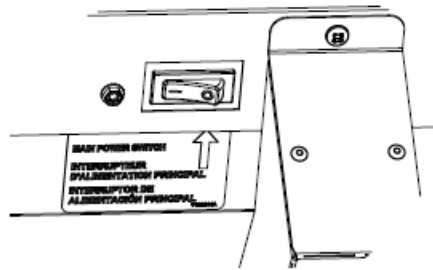

Wait 2 minutes after power off to service the unit.

### **Grease Filters**

The hybrid baffle filters should be cleaned frequently. Use a warm dishwashing detergent solution. The hybrid baffle filters are dishwasher safe.

Clean the filters in the dishwasher using a non-phosphate detergent. Discoloration of the filters may occur if using phosphate detergents, or as a result of local water conditions – but this will not affect filter performance. This discoloration is not covered by the warranty. To minimize or prevent discoloration, hand wash filters using a mild detergent.

### **Hood Cleaning**

#### **Stainless Steel Cleaning:**

##### **Do:**

- Regularly wash with clean cloth or rag soaked with warm water and mild soap or liquid dish detergent.
- Always clean in the direction of original polish lines.
- Use clean rag or cloth soaked with clean water (2 or 3 times) after cleaning. Wipe dry completely.
- You may also use a specialized household stainless steel cleaner.

##### **Don't:**

- Use any steel or stainless steel wool or any other scrapers to remove stubborn dirt.
- Use any harsh or abrasive cleansers.
- Allow dirt to accumulate.
- Let plaster dust or any other construction residues reach the hood. During construction/renovation, cover the hood to make sure no dust sticks to stainless steel surface.

#### **Avoid when choosing a detergent:**

- Any cleaners that contain bleach will attack stainless steel.
- Any products containing chloride, fluoride, iodide, bromide will deteriorate surfaces rapidly.
- Any combustible products used for cleaning such as acetone, alcohol, ether, benzol, etc., are highly explosive and should never be used close to a range.

### **Installation**

#### **Recommended Tools and Accessories**

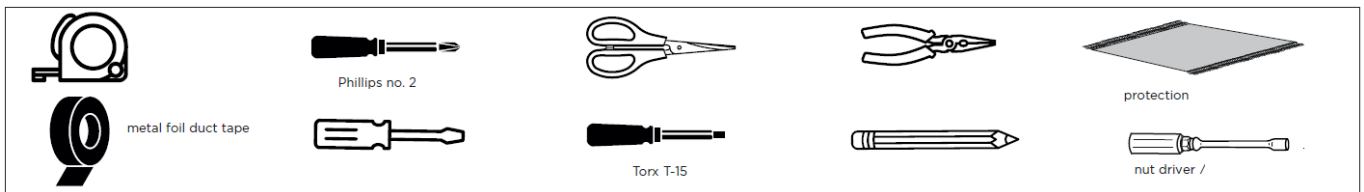

## Box Contents

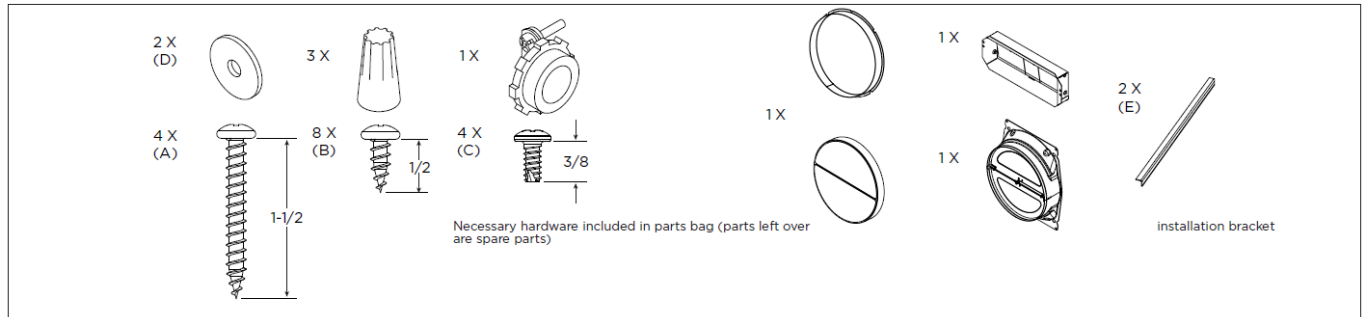

Some illustrations may slightly differ from your actual range hood.  
Dimensions are in inches unless otherwise specified

## Select Installation Type

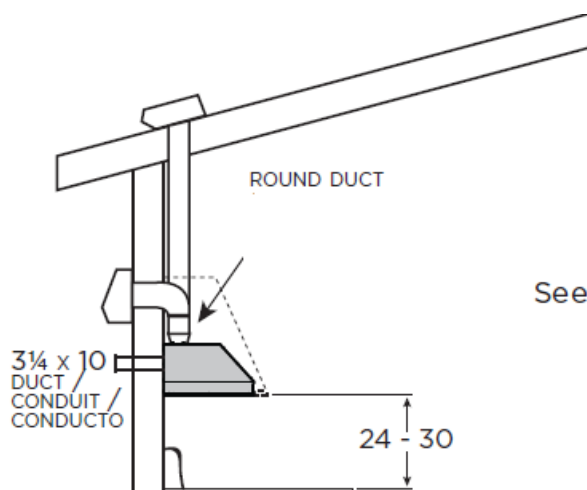

See table below for installation type ,

Use metal foil duct tape to seal duct joints and openings.

1. Determine whether hood will discharge vertically (10 round) or horizontally (3-1/4 x 10).  
Note : Horizontal 3-1/4 x 10 discharge option only available for HBN53696SS model.
2. Decide where the ductwork will run between the hood and the outdoors.
3. The ducting from this fan to the outside of the building has a strong effect on the air flow, noise and energy use of the fan. Use the shortest, straightest duct routing possible for best performance, and avoid installing the fan with smaller ducts than recommended. Insulation around the ducts can reduce energy loss and inhibit mold growth. Fans installed with existing ducts may not achieve their rated airflow. Refer to the table below to help you plan the most efficient installation.
4. Install wall cap or roof cap (sold separately). Connect metal ductwork to cap and work back towards the hood location. Use 2" metal foil duct tape to seal the joints between ductwork sections.

## Maximum Duct Lengths Recommended to Achieve 80% Exhaust Efficiency

3-1/4 x 10 hor. MAX. duct length/	8 round MAXiMuM duct length	rooF or WALL cAP With dAMPer	eldoW/ coude/cod o* (90° or 45°)
202 ft./pi.	1177 ft./pi.	1	0
194 ft./pi.	1159 ft./pi.	1	1
185 ft./pi.	1140 ft./pi.	1	2

10 round MAXiMuM duct length	rooF or WALL cAP With dAMPer	eldo (90° or 45°)
668 ft./pi.	1	0
642 ft./pi.	1	1
615 ft./pi.	1	2

10 round MAXiMuM duct length	rooF or WALL cAP With dAMPer	eldoW/ (90° or 45°)
668 ft./pi.	1	0
642 ft./pi.	1	1
615 ft./pi.	1	2

## Hood Specifications

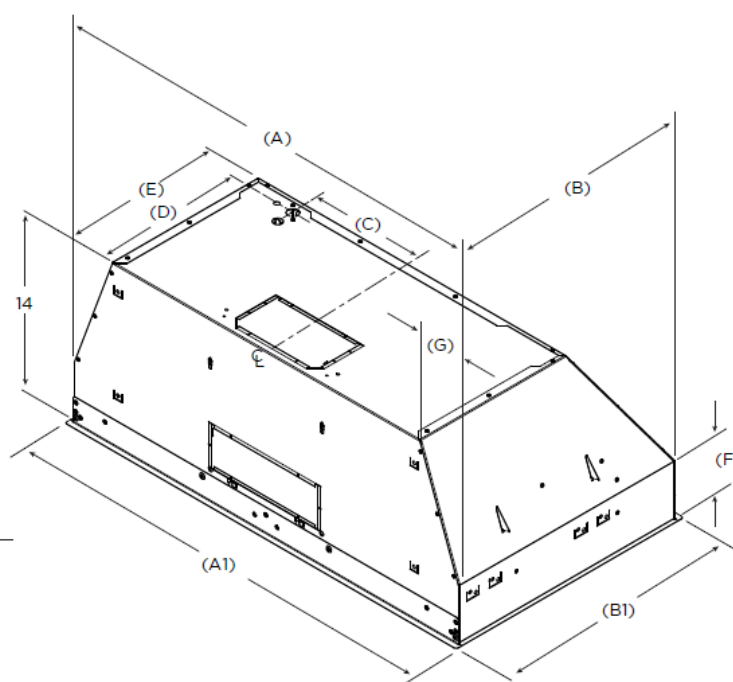
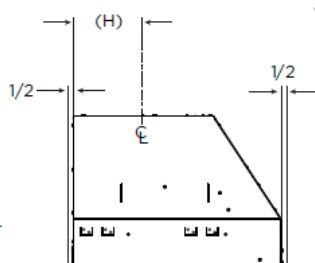
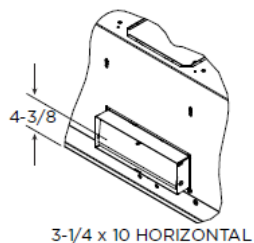
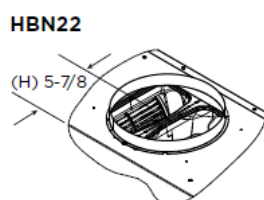
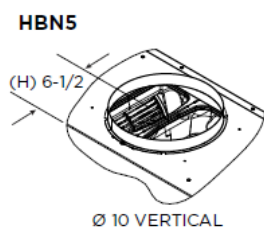
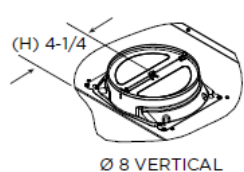

	WIDTH/LARGEUR/ANCHURA			DEPTH/PROFONDEUR/PROFUNDIDAD			OTHER/AUTRE/OTRO					DAMPER/VOL ET/COMPUERTA
	Nominal(e)	With (avec) rivet	With trim/	Nominal(e)	With (avec) rivet/	With trim	Electrical Hole		(E)	(F)	(G)	Installation type
							(C)	(D)				
HBN53 696SS	36	34-7/16	34-7/8	19-1/4	19-1/2	20-1/4	9-1/2	11-7/8	13	4-1/2	3-7/16	Ø 8 vertical / 3-1/4 x 10 horizontal
HBN53 6912SS	36	34-7/16	34-7/8	19-1/4	19-1/2	20-1/4	12-1/2					Ø 10 vertical
HBN54 2912SS	42	40-7/16	40-7/8	19-1/4	19-1/2	20-1/4	12-1/2					Ø 10 vertical
HBN54 8912SS	48	46-7/16	46-7/8	19-1/4	19-1/2	20-1/4	12-1/2					Ø 10 vertical
HBN54 8212SS	48	46-7/16	46-7/8	22-1/2	22-3/4	23-1/2	12-1/2					Ø 10 vertical
HBN55 4212SS	54	52-7/16	52-7/8	22-1/2	22-3/4	23-1/2	12-1/2					Ø 10 vertical
HBN56 0212SS	60	58-7/16	58-7/8	22-1/2	22-3/4	23-1/2	12-1/2					Ø 10 vertical
HBN56 6212SS	66	64-7/16	64-7/8	22-1/2	22-3/4	23-1/2	12-1/2	13-1/4	13-13/16	5	3-1/4	Ø 10 vertical
HBN22 3012SS	30	28-7/16	28-7/8	14-5/8	14-13/16	15-9/16	11-9/16					Ø 10 vertical
HBN22 3612SS	36	34-7/16	34-7/8				14-9/16					
HBN22 4812SS	48	46-7/16	46-7/8				20-9/16					

Dimensions to be complied with

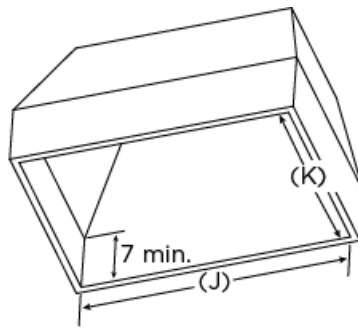

	WIDTH / LARGEUR / ANCHURA	INSIDE DIMENSIONS / DIMENSIONS INTÉRIEURES / DIMENSIONES INTERIORES	
		(J)	(K)
HBN53696SS	36	34-1/2	19-5/8
HBN536912SS	36	34-1/2	19-5/8
HBN542912SS	42	40-1/2	19-5/8
HBN548912SS	48	46-1/2	19-5/8
HBN548212SS	48	46-1/2	22-7/8
HBN554212SS	54	52-1/2	22-7/8
HBN560212SS	60	58-1/2	22-7/8
HBN566212SS	66	64-1/2	22-7/8
HBN223012SS	30	28-1/2	15
HBN223612SS	36	34-1/2	15
HBN224812SS	48	46-1/2	15

④

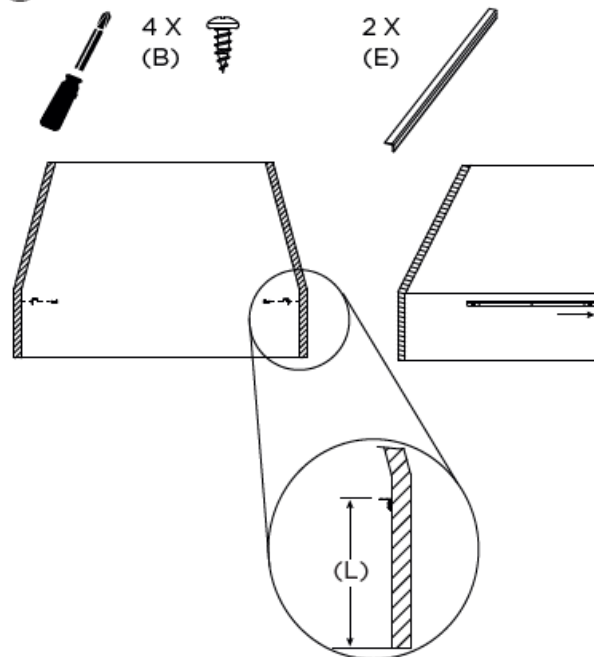

	(L)
HBN5	5-7/8
HBN22	6-3/8

⑤

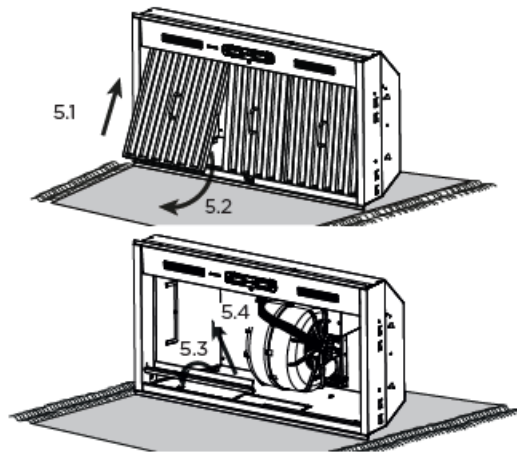

HBN554212SS

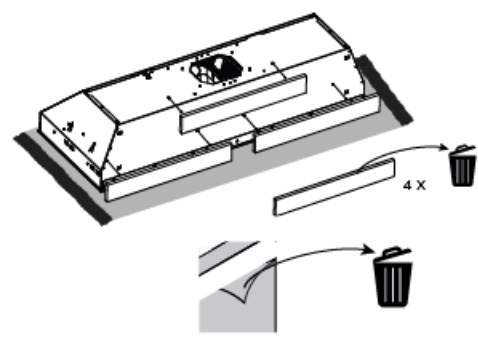

NOTE: Remove protective film

⑥



HBN5

HBN22

HBN5

HBN22

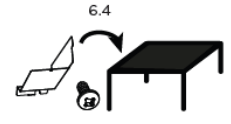
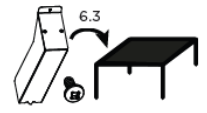
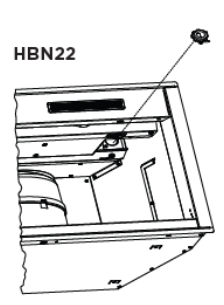
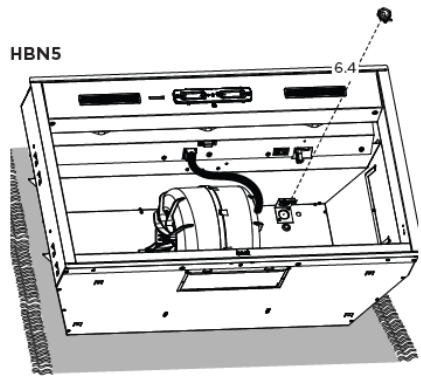
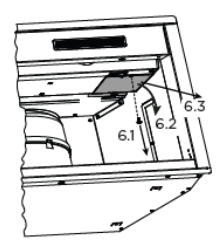
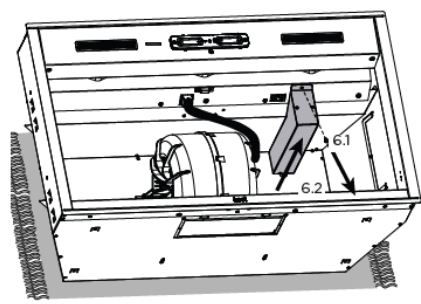

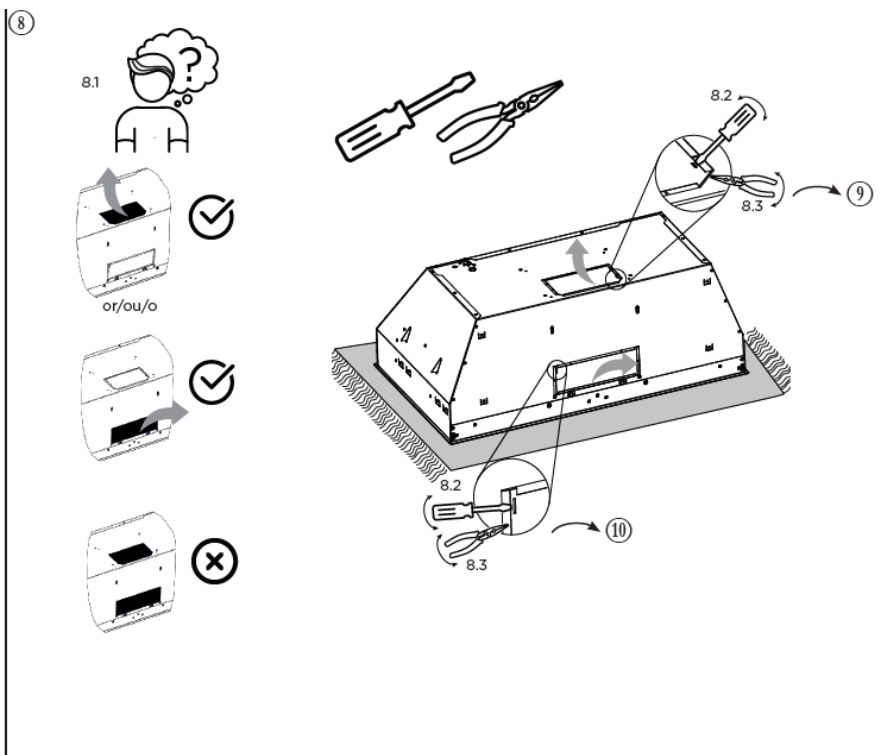
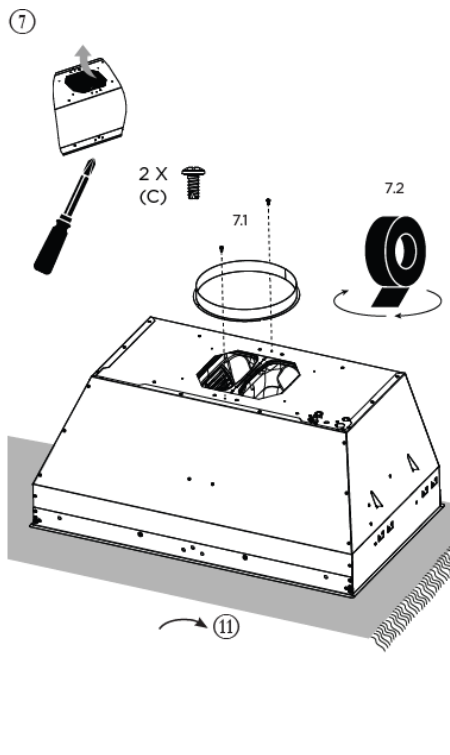

## Remove back trim (optional)

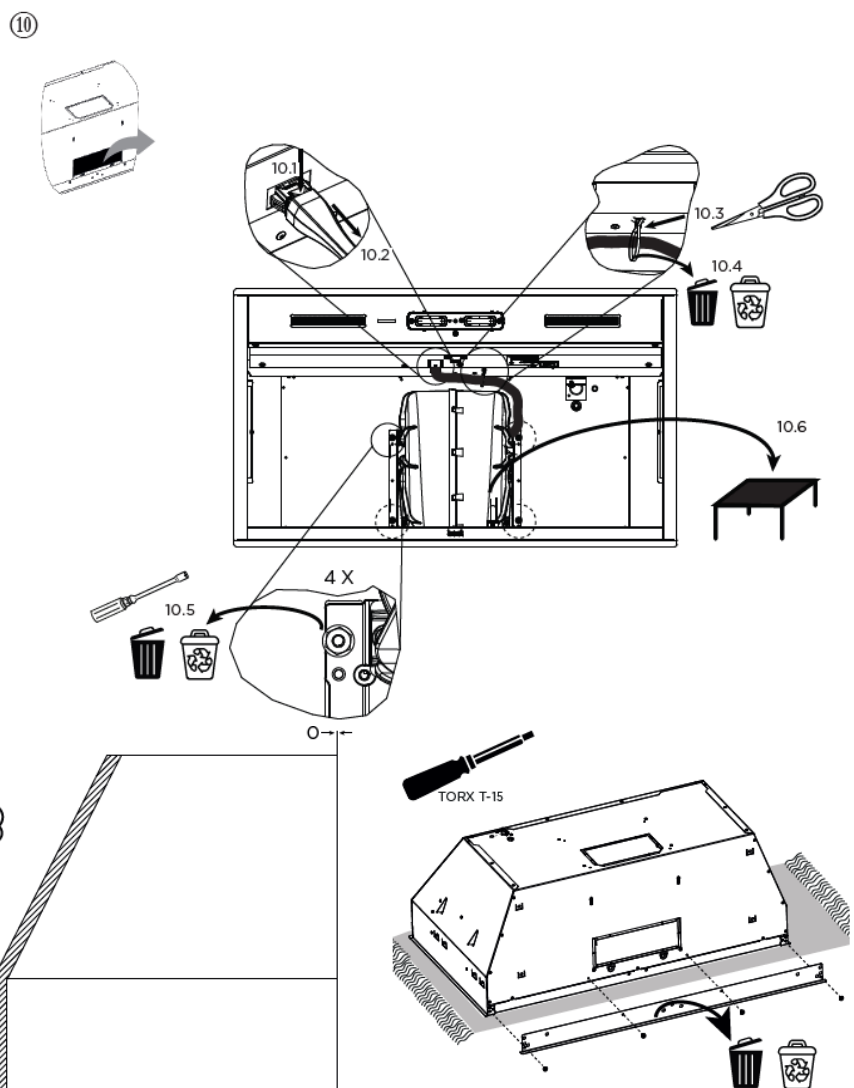
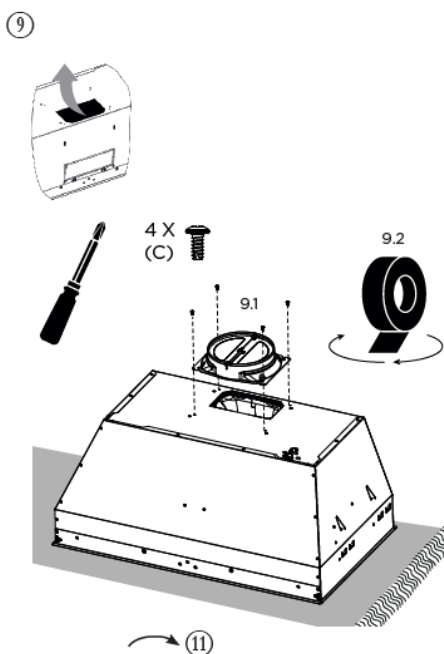

NOTE: Proper structural support is required to accommodate the weight of the hood.



(12)

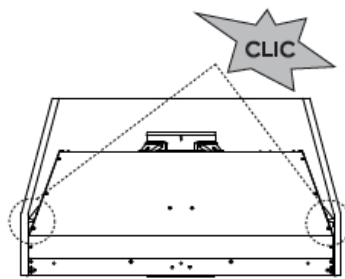
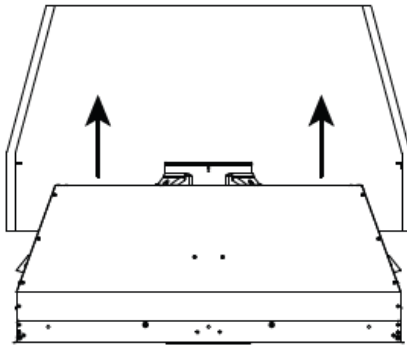

(13)

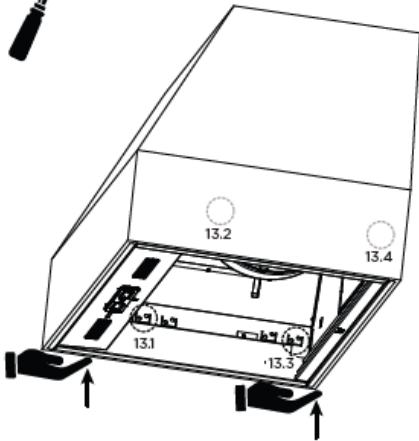
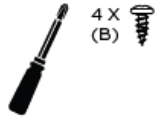
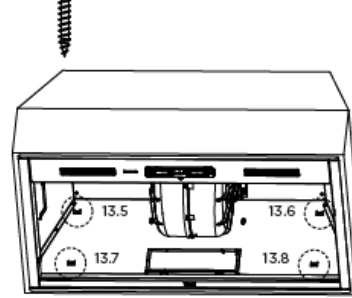
4 X  
(A)

(14)

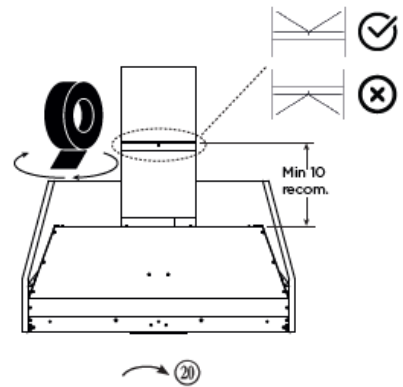

(15)

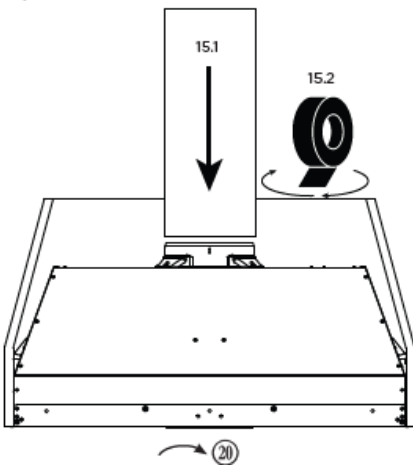

(16)

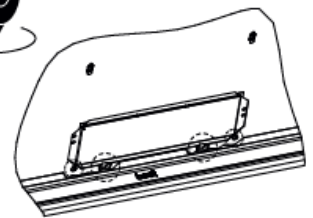
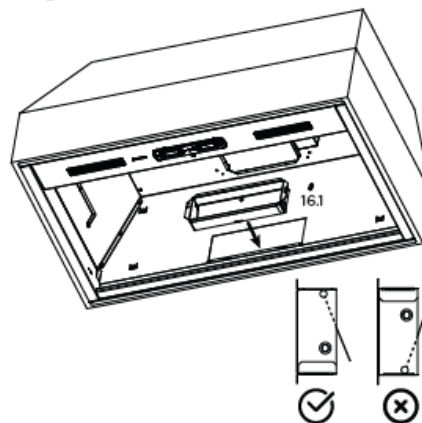

**CAUTION**  
Do not tape in dotted areas shown in illustration above.

17

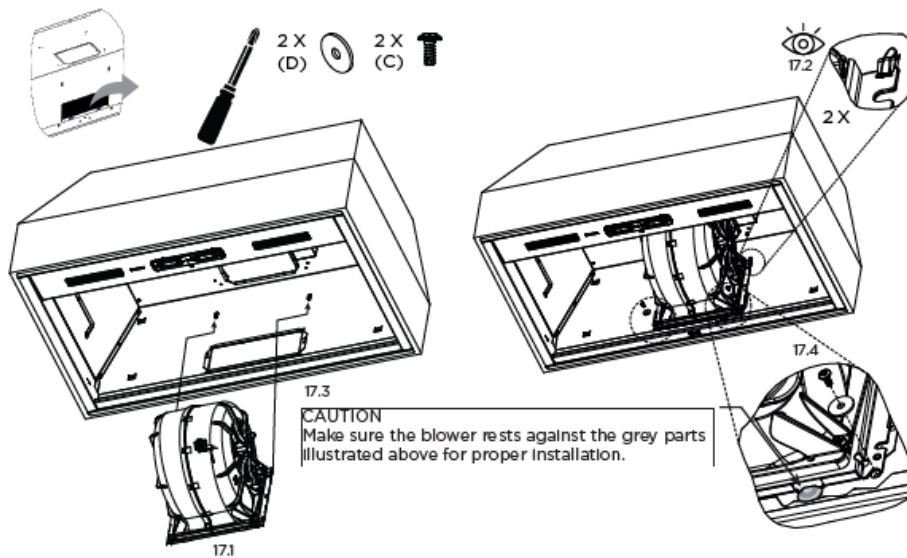

18

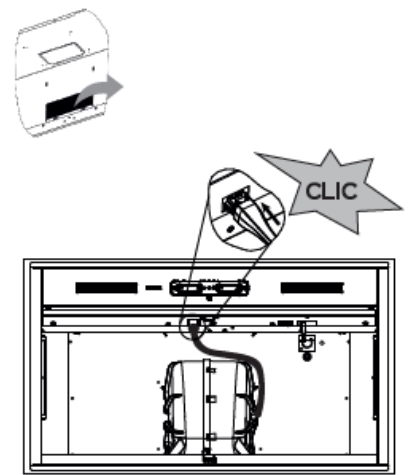

19 Wiring/

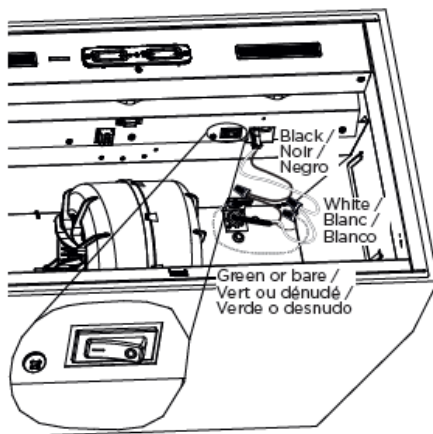

NOTE: Make sure the main power switch is set to position 1.

20

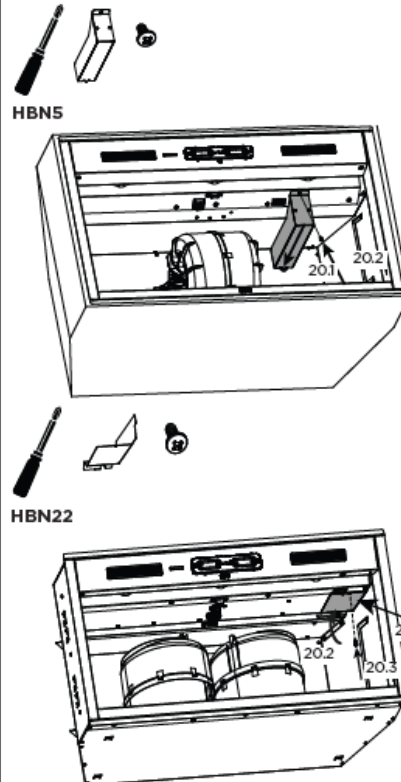

21

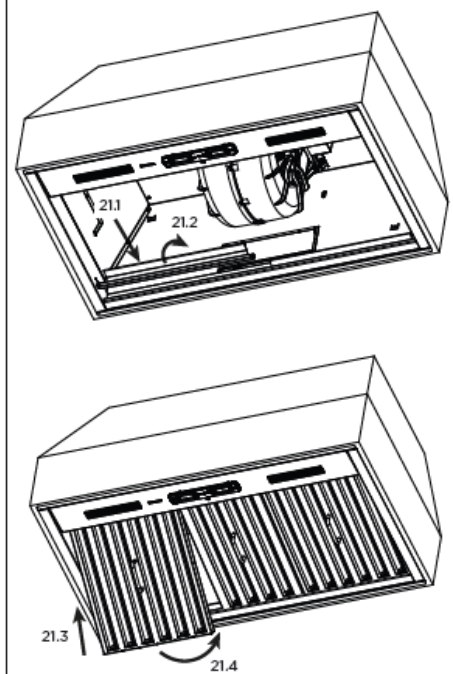

## Replacement Parts

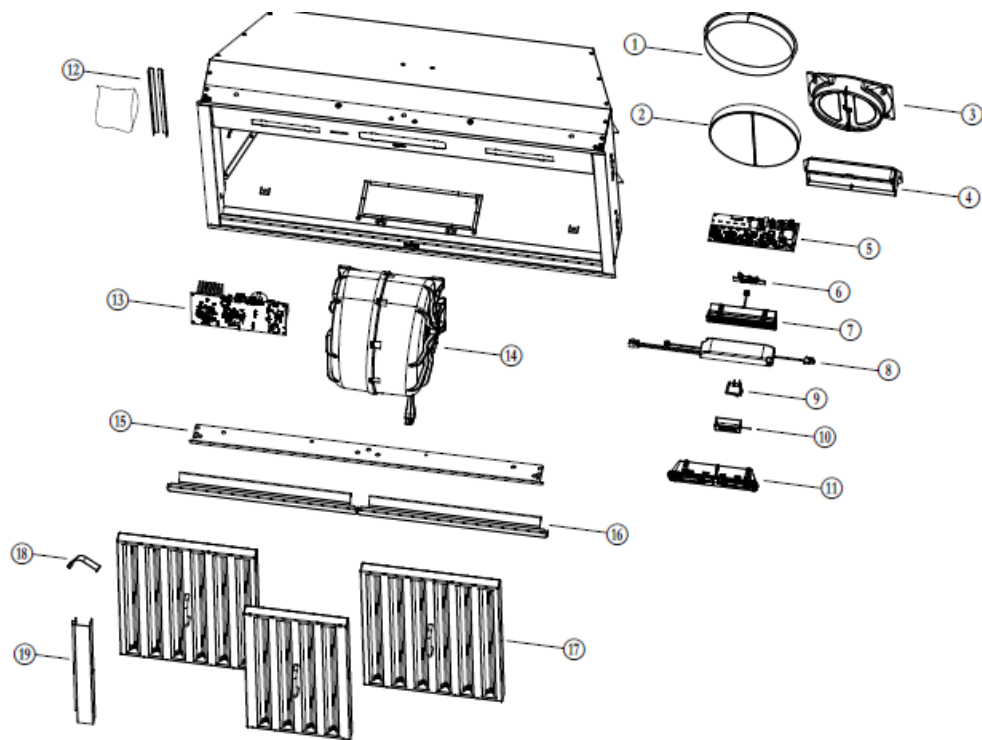

## REPLACEMENT PARTS AND REPAIRS

In order to ensure your unit remains in good working condition, you must use BEST genuine replacement parts only. BEST genuine replacement parts are specially designed for each unit and are manufactured to comply with all the applicable certification standards and maintain a high standard of safety. Any third party replacement part used may cause serious damage and drastically reduce the performance level of your unit, which will result in premature failing. BEST recommends to contact a certified service depot for all replacement parts and repairs.

key no.	Part no. . no de	descriPtion descriPción	h B n 53 69 6s s	h B n 53 69 12 ss	h B n 54 29 12 ss	h B n 54 89 12 ss	h B n 54 82 12 ss	h B n 55 42 12 ss	h B n 56 02 12 ss	h B n 56 62 12 ss
1	SV0854 1	AdAptor 10 round		1	1	1	1	1	1	1
2	SV0854 2	dAmper 10 round		1	1	1	1	1	1	1
3	SV0854 3	dAmper 8 round	1							
4	SV1329 6	dAmper 3-1/4 x 10	1							
5	S99271 705- 800	eleCtroniC BoArd And HARneSS	1	1	1	1	1	1	1	1
6	S11168 76	ir And Air quAlity SenSorS	1	1	1	1	1	1	1	1

7	S11146 46	led module	2	2	2	2	2	4	4	4
8	S11168 75	led driVer And HARneSS	1	1	1	1	1	2	2	2
9	S11119 62	roCker SwitCH	1	1	1	1	1	1	1	1
1 0	S11068 41	wifi AntennA	1	1	1	1	1	1	1	1
1 1	S11067 70-006	uSer interfACe duAl Blower			1	1	1	1	1	1
	S11067 70-007	uSer interfACe Single Blower	1	1						
1 2	S11164 91	pArtS BAg And inStAllAtion BrACketS	1	1	1	1	1	1	1	1
1 3	S11168 77	Single Blower eleCtroniC driVe	1							
	S11168 78	duAl Blower eleCtroniC driVe		1	1	1	1	1	1	1
1 4	S11156 36	Blower	1	2	2	2	2	2	2	2
1 5	S11152 75-36	trim kit 36	1	1						
	S11152 75-42	trim kit 42			1					
	S11152 75-48	trim kit 48				1	1			
	S11152 75-54	trim kit 54						1		
	S11152 75-60	trim kit 60							1	
	S11152 75-66	trim kit 66								1
1 6	S11131 01-36	greASe rAiLS kit 36	1	1						
	S11131 01-42	greASe rAiLS kit 42			1					
	S11131 01-48	greASe rAiLS kit 48				1	1			
	S11131 01-54	greASe rAiLS kit 54						1		
	S11131 01-60	greASe rAiLS kit 60							1	

	S11131 01-66	greASe rAilS kit 66								1
1 7	S11106 40	HyBrid BAffle filter 8.84 x 15 x	1	1	4	5	5	3	1	
	S11106 41	HyBrid BAffle filter 11.84 x 15 x	2	2				2	4	5
1 8	SV0833 7	SpringS kit (6)	1	1	1	1	1	1	1	1
1 9	S11164 52	filter filler			2					2
*	S11072 28	AC Supply HARneSS	1	1	1	1	1	1	1	1

## HBN22

<b>k e y n o .</b>	<b>PArT no . no de</b>	<b>descriPtion descriPción</b>	<b>hBn223 012ss</b>	<b>hBn223 612ss</b>	<b>hBn224 812ss</b>
1	SV0854 1	AdAptor 10 round /	1	1	1
2	SV0854 2	dAmper 10 round	1	1	1
3	—	—			
4	—	—			
5	S99271 705-800	eleCtroniC BoArd And HARneSS	1	1	1
6	S11168 76	ir SenSor And Air quAlity	1	1	1
7	S11146 46	led module	2	2	2
8	S11168 75	led driVer And HARneSS	1	1	1
9	S11119 62	roCker SwitCH	1	1	1
1 0	S11068 41	wifi AntennA	1	1	1
1 1	S11067 70-008	uSer interfACe duAl Blower	1	1	1
1 2	S11164 91	pArTS BAg And inStAllAtion BrACketS	1	1	1

1 3	S11168 78	duAl Blower eleCtroniC driVe	1	1	1
1 4	S11164 68	Blower	2	2	2
1 5	S11152 75-30	trim kit 30	1		
	S11152 75-36	trim kit 36		1	
	S11152 75-48	trim kit 48			1
1 6	S11131 01-30	greASe rAiLS kit 30	1		
	S11131 01-36	greASe rAiLS kit 36		1	
	S11131 01-48	greASe rAiLS kit 48			1
1 7	SV6168 3	HyBrid BAffle filter 8.84 x 12	3	1	5
	SV6168 4	HyBrid BAffle filter 11.84 x 12		2	
1 8	SV0833 7	SpringS kit (6)	1	1	1
*	S11072 28	AC Supply HARneSS	1	1	1

### Not show

For complete warranty statement or to learn more about the instructions above, please type your model number in on our website.

## Documents / Resources

	<a href="#">best HBN22 Series Built In Range Hood</a> [pdf] Instruction Manual HBN22 Series, HBN22 Series Built In Range Hood, Built In Range Hood, Range Hood, Hood
---	---

## References

-  [BEST: Range Hoods - Performance that inspires](#)
- [User Manual](#)

This website is an independent publication and is neither affiliated with nor endorsed by any of the trademark owners. The "Bluetooth®" word mark and logos are registered trademarks owned by Bluetooth SIG, Inc. The "Wi-Fi®" word mark and logos are registered trademarks owned by the Wi-Fi Alliance. Any use of these marks on this website does not imply any affiliation with or endorsement.