



BeSafe Go Beyond 3 Point Vehicle Belt User Manual

[Home](#) » [BeSafe](#) » BeSafe Go Beyond 3 Point Vehicle Belt User Manual 

BeSafe Go Beyond 3 Point Vehicle Belt User Manual



Thank you for choosing BeSafe Go Beyond

We're so excited to accompany you and your little one on your travels and keep them safe!
In this manual we'll explain to you all there is to know about your seat.



It is important that you read this user manual BEFORE installing your seat. Incorrect installation could endanger your child.

Contents

- 1 Vital information
- 2 Handling & maintenance
- 3 Components
- 4 Attaching the SIP+
- 5 Installing the seat with the vehicle belt
- 6 Installing the seat onto the Beyond Base
- 7 Rotating the seat
- 8 Using the carry handle
- 9 Placing the child into the seat
- 10 Comfort for the baby
- 11 Adjusting the seat to the growing child
- 12 Attaching onto a stroller
- 13 Removing from a stroller
- 14 Use in an aircraft
- 15 Removing and refitting the cover
- 16 Disassembly & disposal of the product
- 17 Disposal of the packaging
- 18 Documents / Resources
 - 18.1 References
- 19 Related Posts

! Vital information

Installation & usage



- The child seat **MUST NOT** be installed in a front seat **WITH AN ACTIVATED FRONTAL AIRBAG**.
- When using in Spain: Article 117 of the General Regulation of Traffic in Spain prohibits driving with children of stature height equal to or less than 135 centimeters located in the front seats of the vehicle, unless the vehicle does not have rear seats, all rear seats are already occupied by children below 135 cm or if it is not possible the install the child seat in the rear seat.
- This seat can be installed on the BeSafe Beyond Base or with a 3-point car belt, approved according to UN/ECE Regulation No.16 or other equivalent standards.
- **Note:** the installation of this seat in an aircraft differs from the installation on a vehicle seat. Only in an aircraft is the installation with a 2-point lap belt allowed.
- This seat is approved rear facing for children with a stature height from 40 to 87 cm and a maximum weight up to 13 kg.
- When driving with a child sitting in the seat, the seat must always be locked in the driving position. Never drive with the seat rotated to the side when a child is sitting in the seat.
- The harness straps must always be locked when the child is in the seat.
- The harness straps must be tightened without slack and not twisted.
- Make sure to tighten the harness extremely well, so that you can no longer make a horizontal fold in the belts. When you tighten the harness, make sure that the child is positioned well against the backrest.
- The shoulder pads contain magnets. Magnets can influence electronic equipment such as pacemakers or other

medical devices.

- Protect any part of the child's body which is exposed to the sun.
- Always dress your child in a thin layer of clothes to avoid direct contact between harness belts and skin. Avoid puffy clothes since this prevents being able to tighten the belts fully.
- Remove the baby cushion when the child is taller than 60 cm or older than 6 months.
- You must stop using this seat and change to the next suitable seat when ONE of these conditions is met: 1) The child is taller than 87 cm; 2) or the child incl. clothes weighs more than 13 kg, 3) The shoulder belts sit more than 2 cm higher than the openings slots of the headrest in its highest position.
- Never leave your child unattended in the seat.
- Make sure all passengers are informed about how to release your child in case of emergency.

Handling & maintenance

- Replace the product if it has been in a collision where the speed was 10 km/h and above or if there is a suspicion that the seat has been damaged for whatever reason. Although it may look undamaged, if you were to have another accident, the seat may not be able to protect your child to the level to which it was designed.
- Prevent the product from becoming trapped or weighed down by luggage, seats and/or slamming doors.
- Make sure luggage or other objects are properly secured. Unsecured luggage may cause severe injuries to children and adults in case of accidents.
- DO NOT attempt to dismantle, modify or add any part to the product.
Warranty will be void if non-original parts or accessories are used.
- Never use the seat without the cover. The cover is a safety feature and may only be replaced by an original BeSafe cover.
- Do not use any aggressive cleaning products; these may harm the construction material of the product.
- When washing the seat cover, make sure to follow the wash label on the inside of the cover.
- BeSafe advises that child seats should not be bought or sold secondhand.
- DO NOT use the product for longer than 15 years. Due to ageing, the quality of the material may change.
- When the product is mounted in the car, check all the areas where the child seat might touch the interior. We recommend using a (BeSafe) protection cover in these places to avoid cuts, marks or discolouration to the interior of the vehicle, especially in vehicles with leather or wooden interiors.
- If in doubt, consult either the car seat manufacturer or the retailer.

Warnings (EN 12790-2023) using the seat as a reclined cradle

IMPORTANT! KEEP FOR FUTURE REFERENCE.

- Never leave the child unattended.
- Stop using the product when the child starts trying to sit up.
- Never use this product on an elevated surface (e.g. a table).
- Always use the restraint system.
- Never let the child sleep in this product. This product does not replace a cot or a crib. Should the child fall asleep, then it should be placed in a suitable cot or crib.
- Do not use the product if any components are broken or missing.

- Do not use accessories or replacement parts other than those approved by the manufacturer.
- If in doubt, consult either the car seat manufacturer or the retailer.

Components

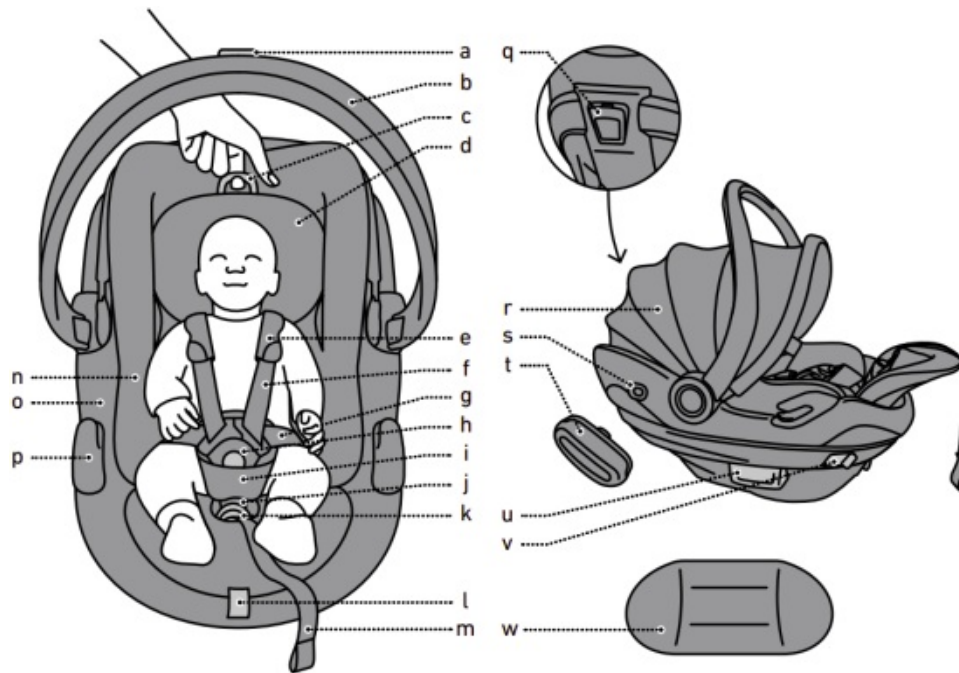

- a Carry handle button
- b Carry handle
- c Headrest handle
- d Headrest
- e Shoulder pads (2x)
- f Shoulder belts (2x)
- g Hip belts (2x)
- h Harness buckle
- i Crotch strap pad
- j Crotch strap
- k Central adjuster button
- l Lay flat strap
- m Central adjuster strap
- n Inner part
- o Outer part
- p Lap belt guiders (2x)
- q Shoulder belt guider
- r Sun canopy
- s SIP+ attachment point
- t SIP+
- u Stroller adapter housing
- v Rotation handle
- w Baby cushion

Attaching the SIP+

1. The seat is delivered with removable SIP+ (side impact protection+).

This extra side impact protection should be used on the door side of the vehicle. It can be connected by placing it onto the SIP+ attachment point and then rotating it clockwise until you feel it click into place. The seat already offers high level integrated side impact protection. This extra side impact protection improves the protection in

the side impact even further. (1, 2, 3, 4)

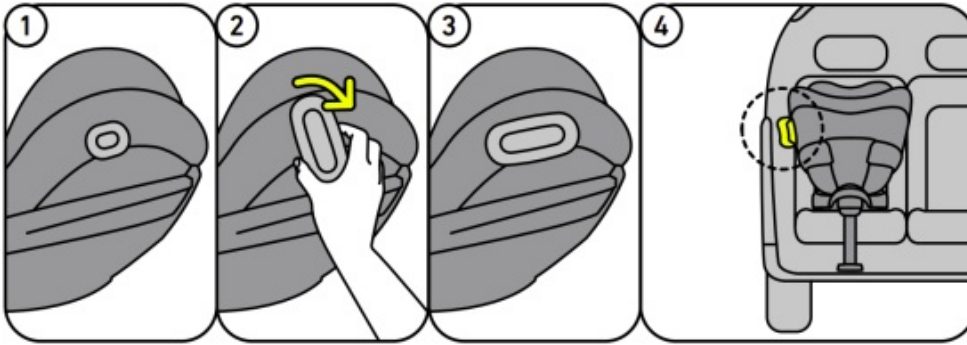

2. Do not use the SIP+ on the seat when the space between seat and door of the vehicle is too small, which might lead to a situation where the seat is not positioned correctly on the vehicle seat.
3. In case the SIP+ sits at the height of the door window and your car is equipped with side curtain airbags, then do not use the SIP+ if there is less than 10 cm distance between the SIP+ and the window.

Installing the seat with the vehicle belt

1. Position the seat on the vehicle seat. Make sure the inner part is in the upright position (NOT lay flat position) and the carry handle is up in the carrying position. (1, 2, 3)
2. Take the hip belt part of the vehicle's 3-point belt and guide it under the 2 hip belt guiders. Then fasten the seat belt buckle with a "click". (4, 5, 6)

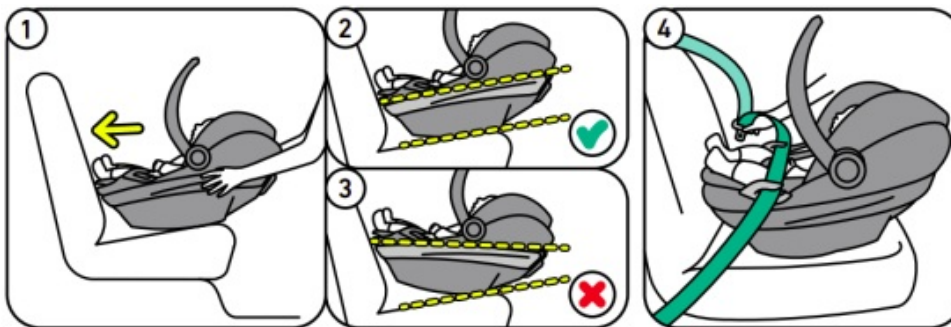

3. Tighten the hip belt part by pulling on the shoulder belt part. (7)

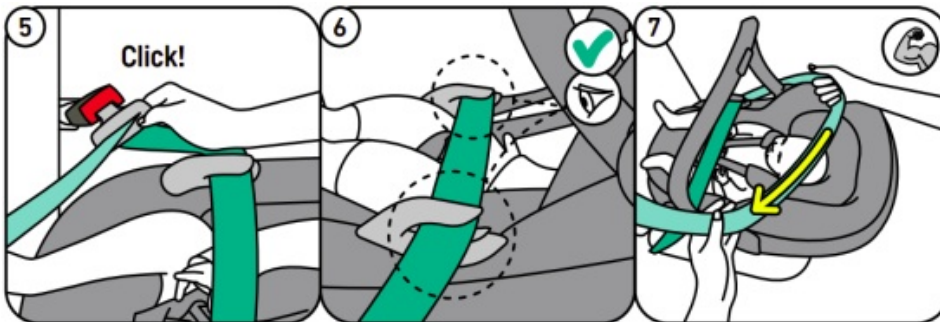

4. Take the shoulder belt part of the 3-point belt and guide it around the back of the seat and into the shoulder belt guider. Make sure it sits fully inside the shoulder belt guider. (1, 2)

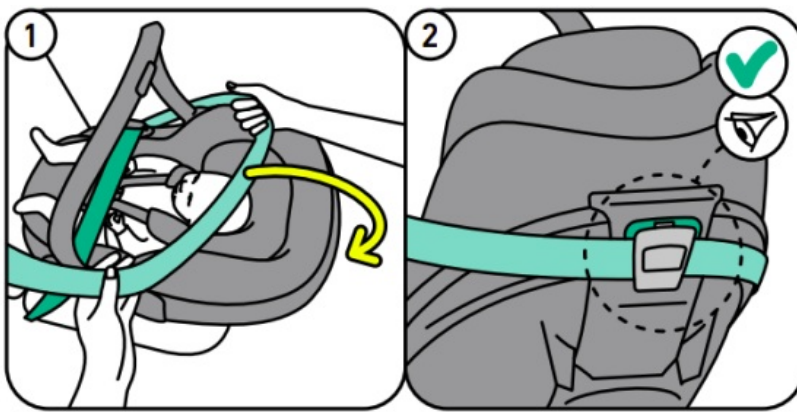

5. Tighten the shoulder belt part by pulling on it. With your other hand, keep the child seat in place. (3)

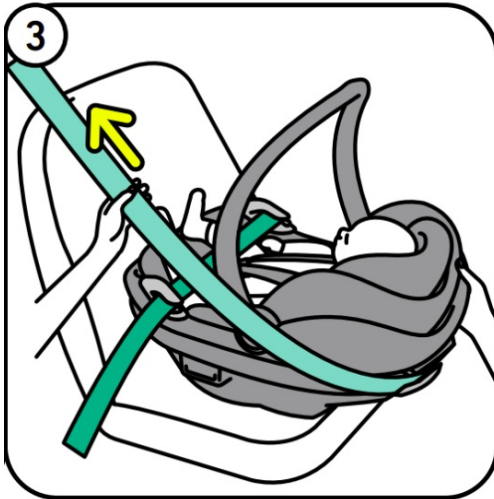

6. Leave the carry handle up in upright position and the inner part of the seat in upright position (NOT lay flat position). (4, 5, 6)



7. If you have installed the child seat on the back seat: Move the front vehicle seat backwards, so that it is in light contact with the child seat. If this is not possible, then move the front seat forward to create as much distance as possible between the child seat and front seat, preferably at least 25 cm.

Installing the seat onto the Beyond Base

1. Check if the ISOfix and floor support indicators on the base are green.
2. Make sure that the base's front brace is in the most upright (compact) position.
3. You find the detailed explanation on how to install the base into the car in the base's user manual.
4. If you want to install the seat rotated towards you onto the base, you can turn the rotation disc, so that the child on the sticker is facing towards you. (1, 2)

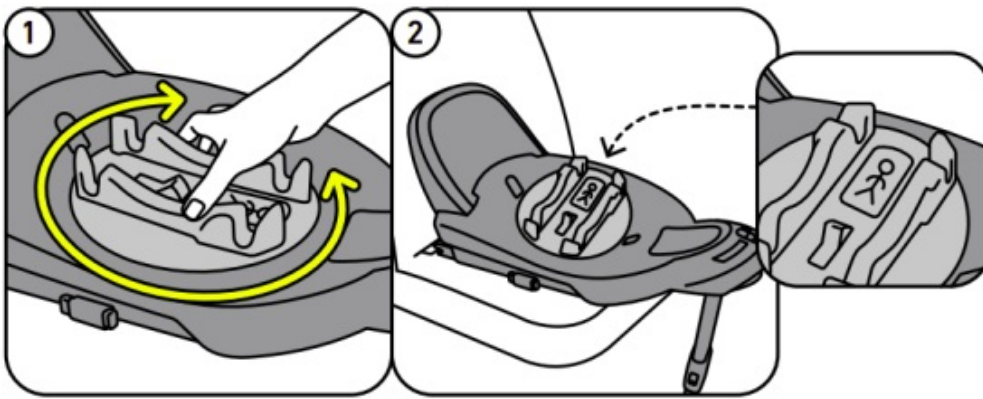

5. Position the seat in the correct position on the base until it clicks with the base and the seat connection indicator at the front shows green. (3, 4, 5)

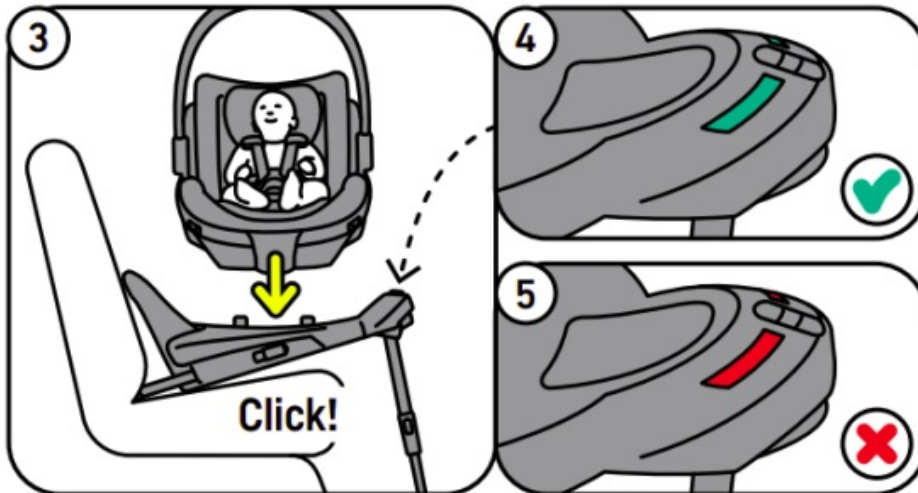

6. To help you find the position, you can use the yellow markings on the bottom of the seat and on the base disc. Align the yellow markings with each other. (6)

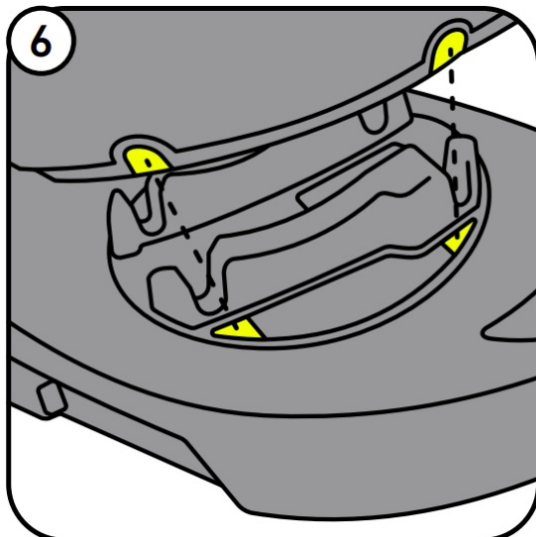

7. When having the child seat installed rear facing in the back, it is recommended to position the front vehicle seat in a way that it is close to touching the child seat. Make sure that the child seat can still rotate freely.
8. Leave the carry handle up in the carrying position. (1, 2)

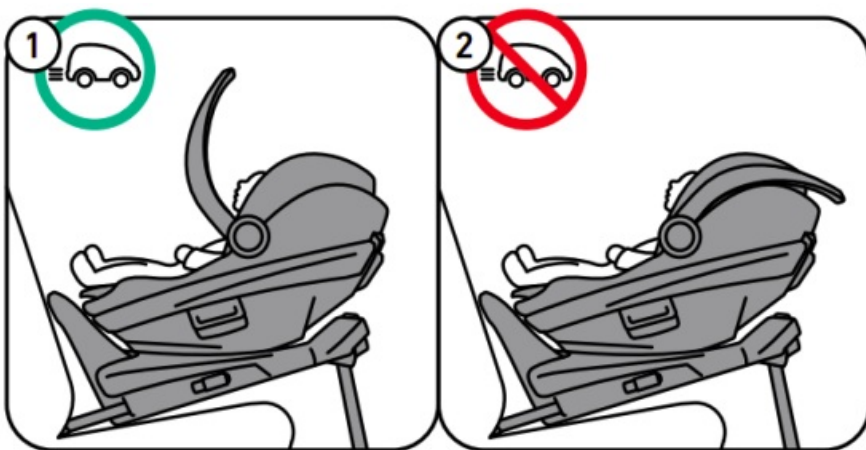

Removing the seat from the base

1. The seat can be taken off by pulling the seat release handle at the front of the base. (3, 4)

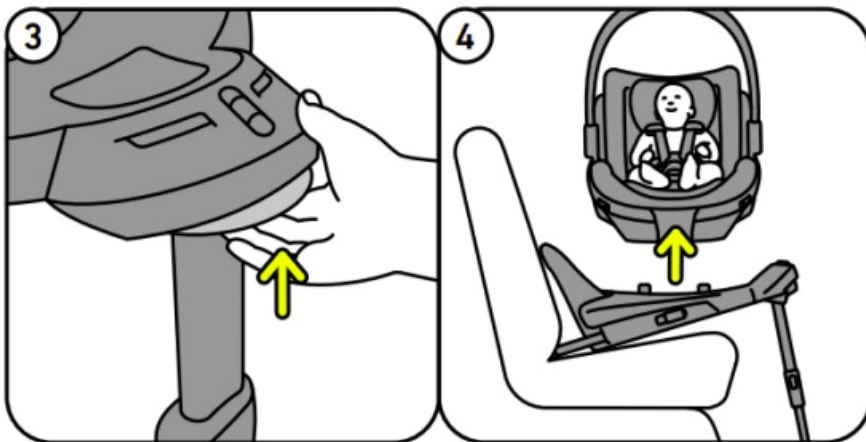

Rotating the seat

1. To make getting your child in and out of the seat easier, you can rotate the seat towards the door.
2. To rotate the seat, pull the rotation handle on the side of the seat. You can use the handle on either side of the seat, but you only need to use one. (1, 2, 3)

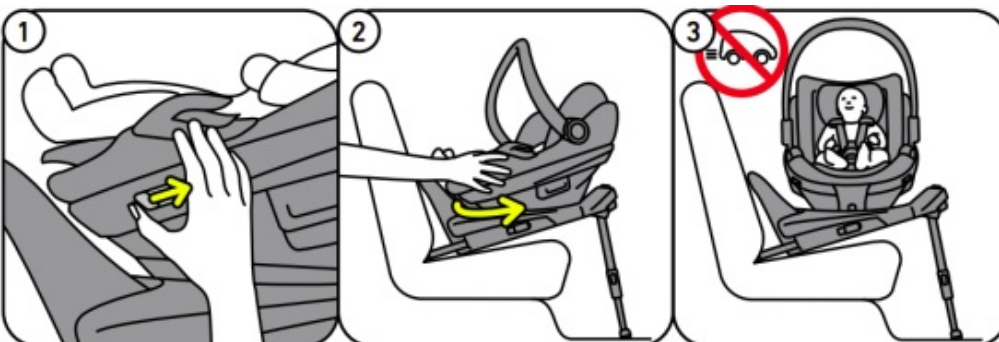

3. To bring the seat back into driving position, rotate it into rear facing position until you hear a click and the seat is locked. (4, 5)

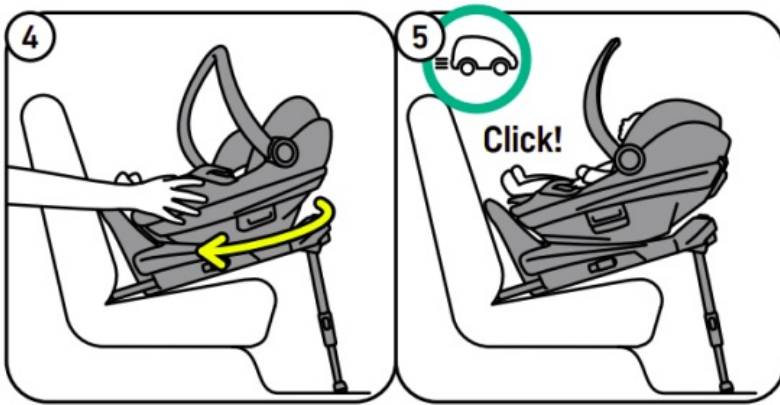

4. The seat can maximum rotate approx. 110° away from the rear facing position, then it is blocked.

Using the carry handle

1. To take your baby more easily in and out of the seat, you can fold away the carry handle to the back.
2. Before driving, the carry handle must always be put back into the upright carrying position. Never drive with the carry handle folded to the back.

(1, 2)

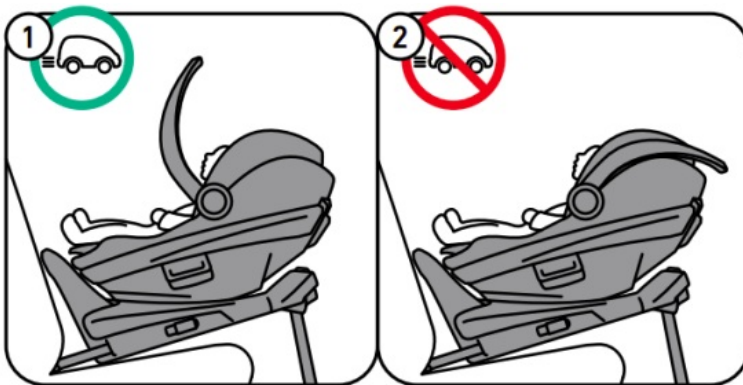

3. In order to fold the carry handle to the back, press the button on the backside of the carry handle and at the same time push the handle vertically downwards into the seat. This unlocks the mechanism and you can then move the handle away to the back. (3, 4, 5)

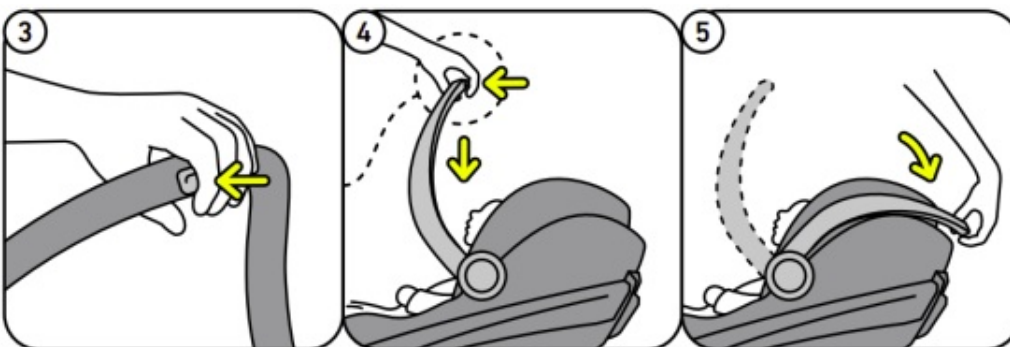

Placing the child into the seat

1. While pressing the button of the central adjuster, pull the shoulder belts away from the seat with a flat hand. Make sure to pull the belts evenly so that they stay at the same length. Do not pull on the shoulder pads, as they are fixed and cannot move. (1)

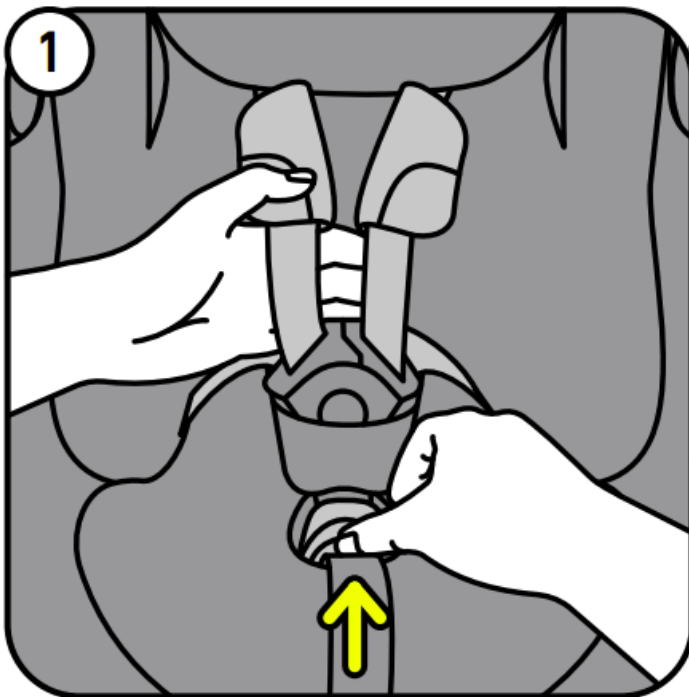

2. Open the harness buckle. (2)

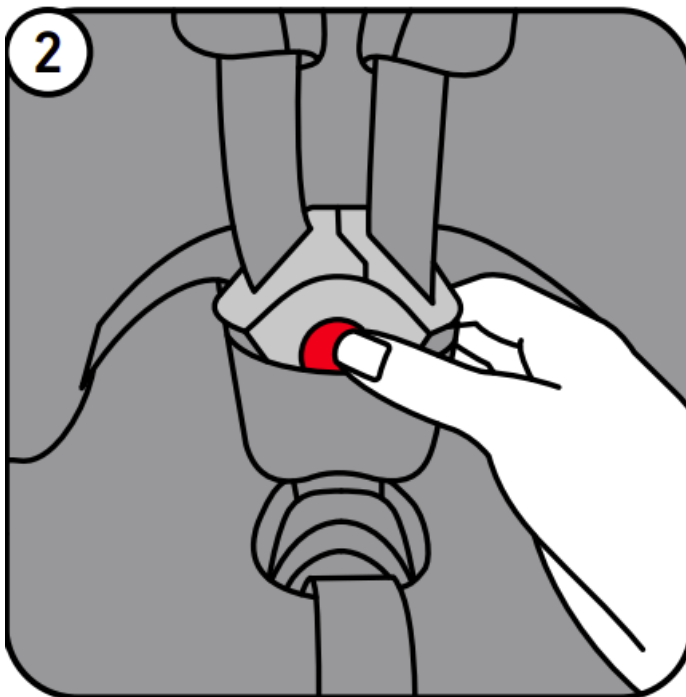

3. To keep the shoulder straps out of the way, place the shoulder pads onto the magnets on each side of the seat shell. (3, 4)

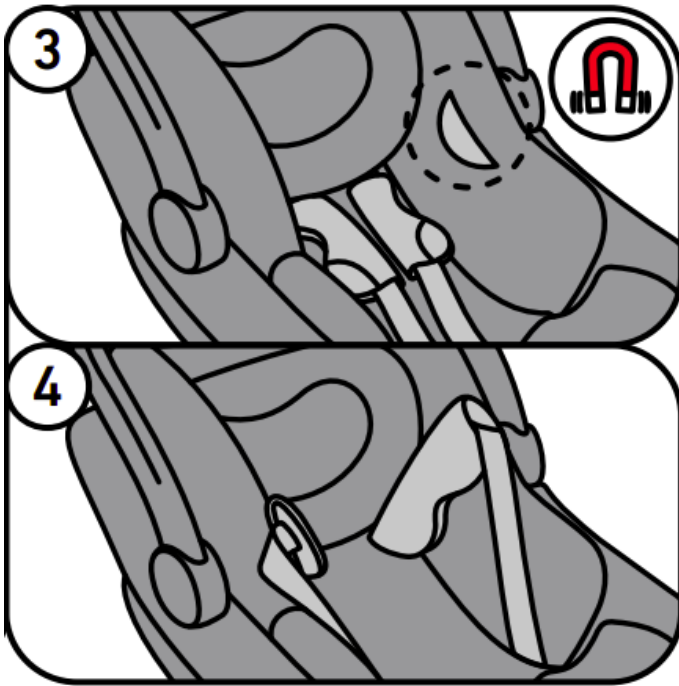

4. Place your child into the seat and adjust the position of the shoulder belts and headrest if needed – see section “Adjusting to the growing child”.

5. **Place the shoulder belts over the child’s shoulders and close the buckle:**

CLICK! (5)

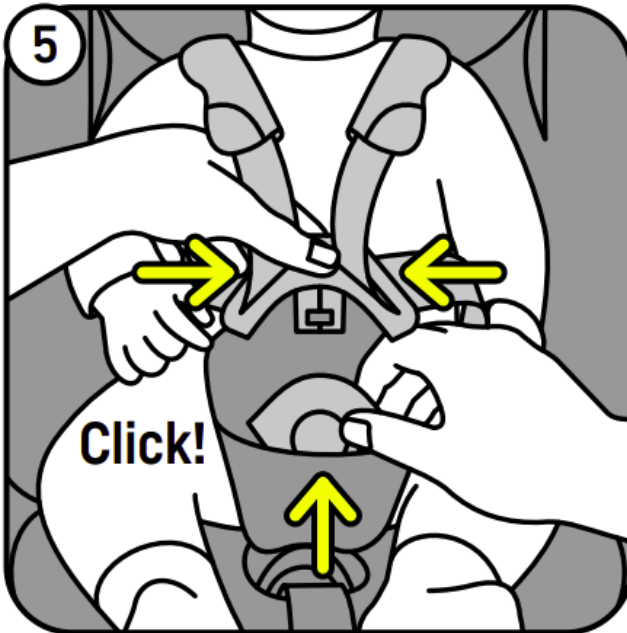

6. Pull the central adjuster strap straight away from the seat to tighten the harness. Make sure to tighten the harness extremely well, so that you can no longer make a horizontal fold in the belts. When you tighten the harness, make sure that the child is positioned well against the backrest.

(6, 7, 8)

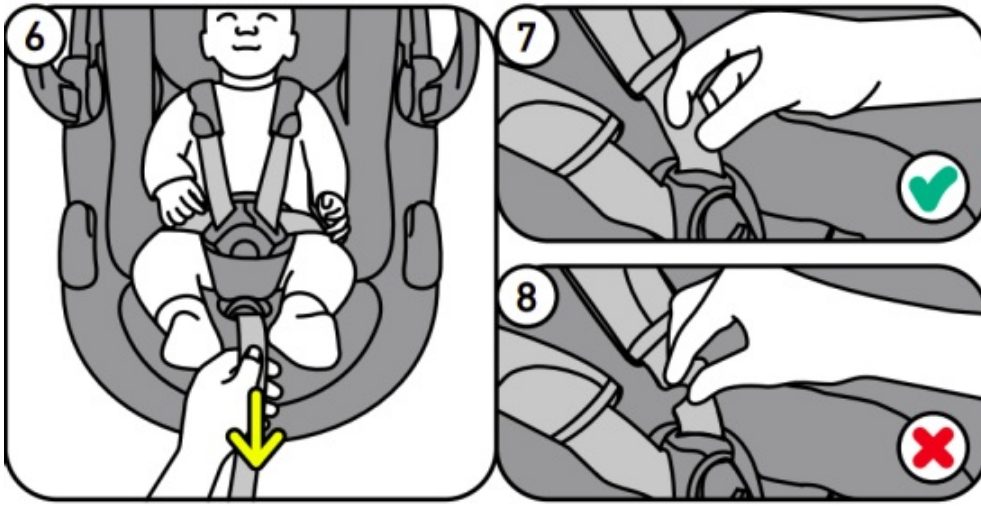

Comfort for the baby

Using the lay flat position

1. To increase your baby's comfort, especially when they're small, the seat is equipped with a lay flat position, in which the inner part of the seat moves into a more flat position, while the outer part remains in place.
2. You can use the lay flat position on a stroller or in the car when the seat is installed with the ISOfix base.
3. It is not allowed to use the lay flat position in the car when the seat is installed with the 3-point vehicle belt. You will notice that the seat is constructed to block going into lay flat position when installed with the 3-point belt.
4. To put the seat into lay flat position, pull the lay flat strap or anywhere at the foot end of the seat's inner part downwards/towards you. You will notice a small resistance at first, this is normal. (1, 2, 3)

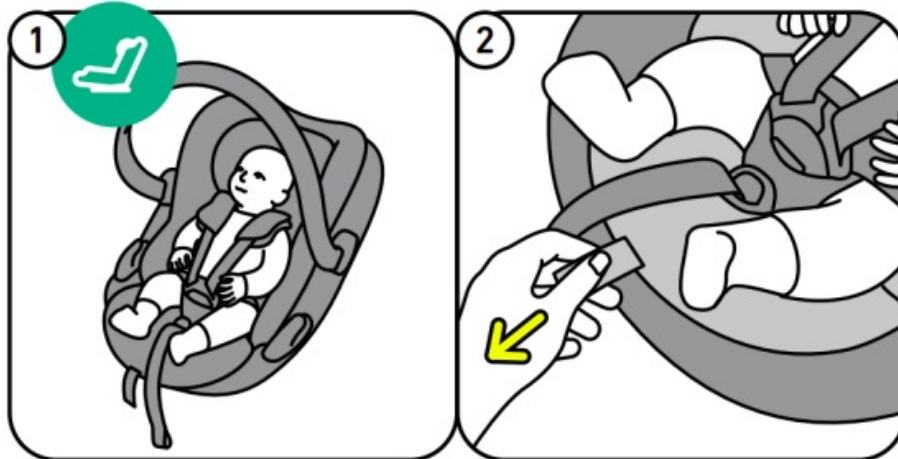

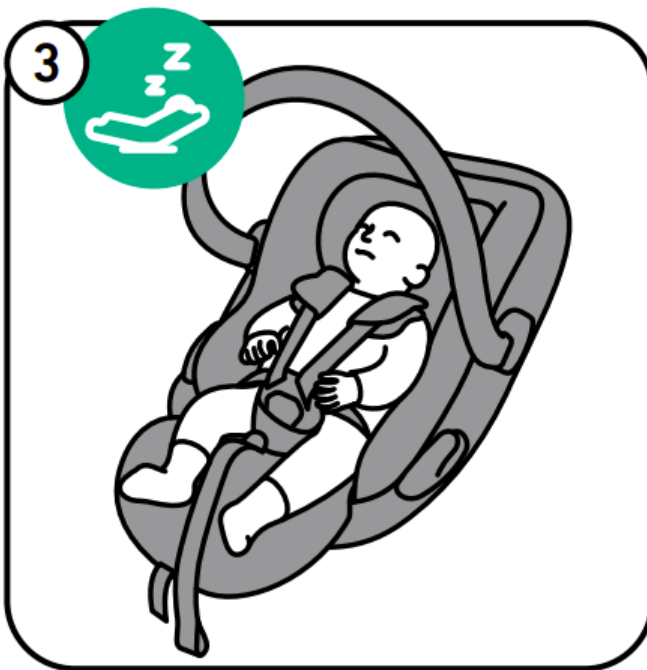

5. To put the seat into upright position, push the seat's inner part by its foot end upwards/away from you. You will notice a small resistance at first, this is normal. (4)

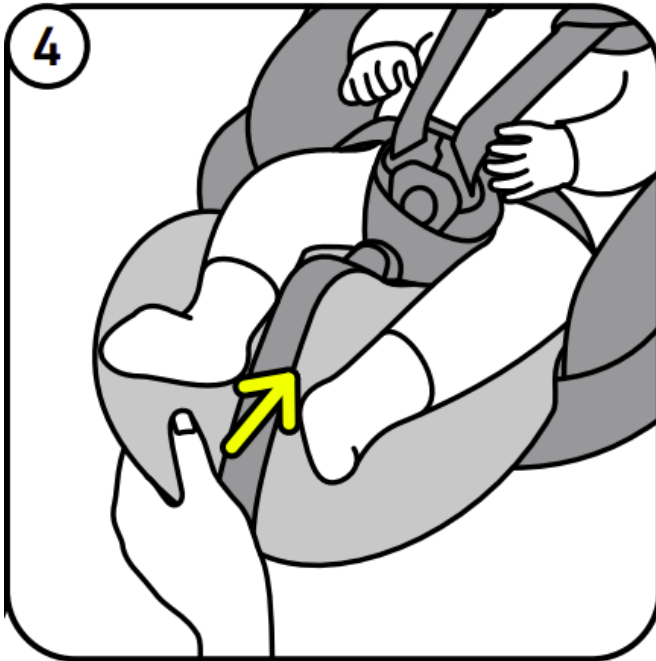

Sun canopy

1. To protect your baby from sun and wind, the seat is equipped with a large sun canopy with an extended ventilation strip on its backside. (1)

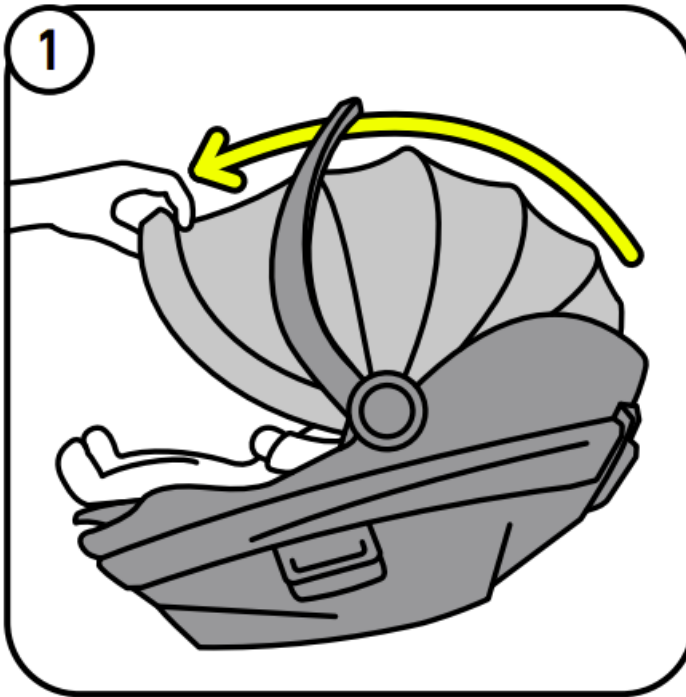

2. You can use the sun canopy on the stroller and in the car, but take extra care in the car to check for good airflow and avoid heat build-up.
3. To enable you to see your baby at the same time, the sun canopy has a function where you can adjust the left and right side of it individually.

Hold one side in place while with the other hand move the other side up or down. (2)

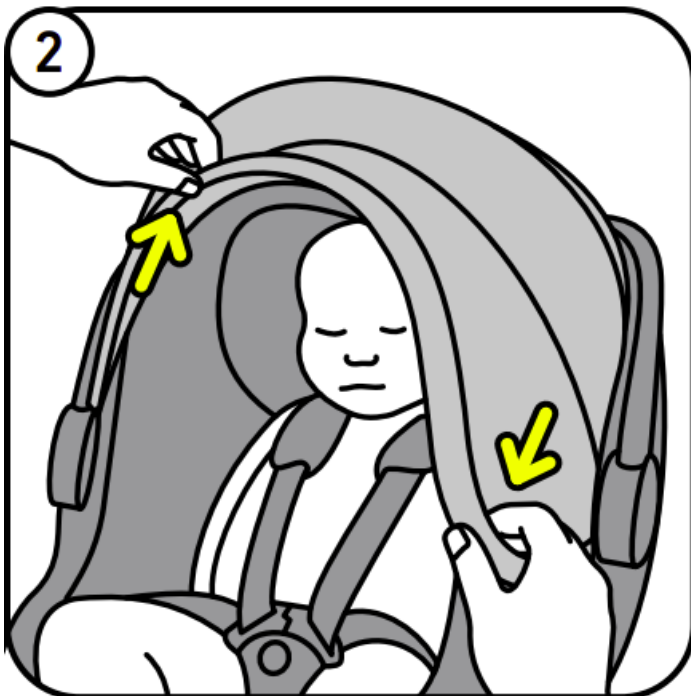

Adjusting the seat to the growing child

Shoulder belt/headrest height

1. The height of the shoulder belts and the headrest can be adjusted by pulling the headrest handle upwards at the back of the headrest and moving the headrest up or down. To be able to do so, the harness buckle has to be opened and the straps have to be pulled out. (1)

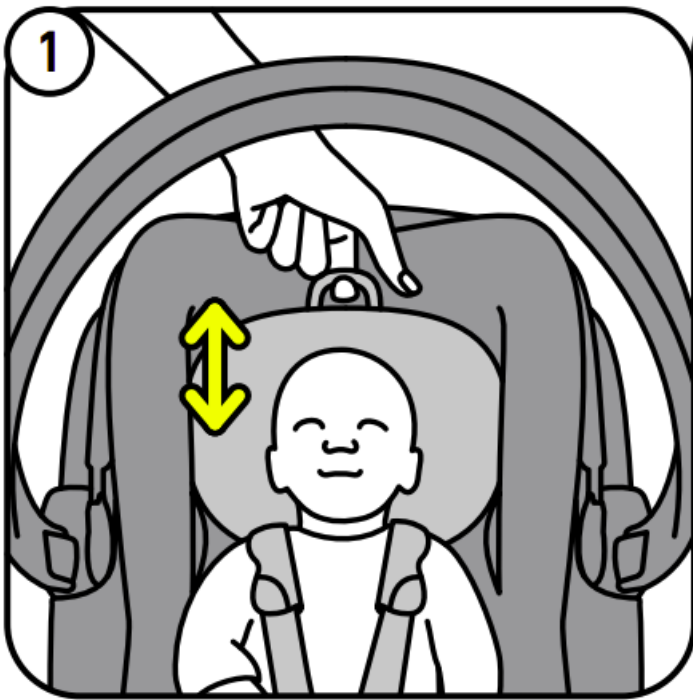

2. To find the right height for your child, move the headrest all the way up, place your child into the seat, and then move the headrest downwards until it sits directly on your child's shoulders. (2)

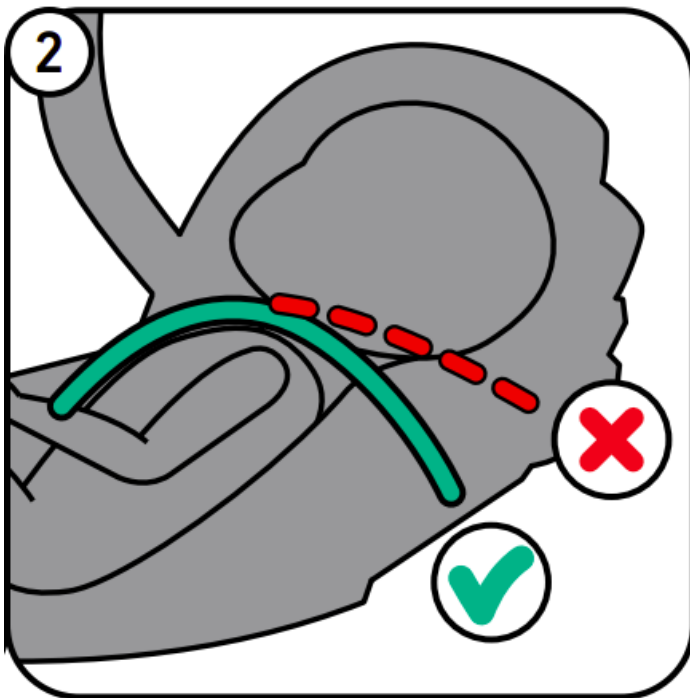

3. For children above 75 cm stature height it is allowed to have the shoulder belts max. 2 cm. higher than the openings (slots) of the headrest. 1 2

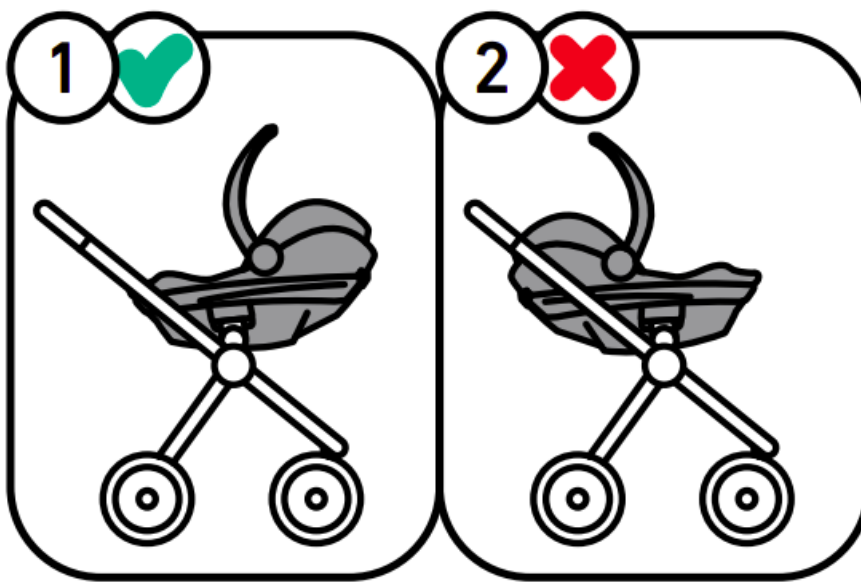

Cushion inserts

- Remove the baby cushion when the child is taller than 60 cm or older than 6 months.

Attaching onto a stroller

1. The seat can be used in combination with strollers that offer matching car seat adapters. Check the BeSafe strollerlist.
2. Make sure to position the seat rear/parent facing onto the stroller, NOT to the front/world facing. (1, 2)
3. Align the stroller adapter housings above the adapters of the stroller and push straight down, click! (2x) (3)

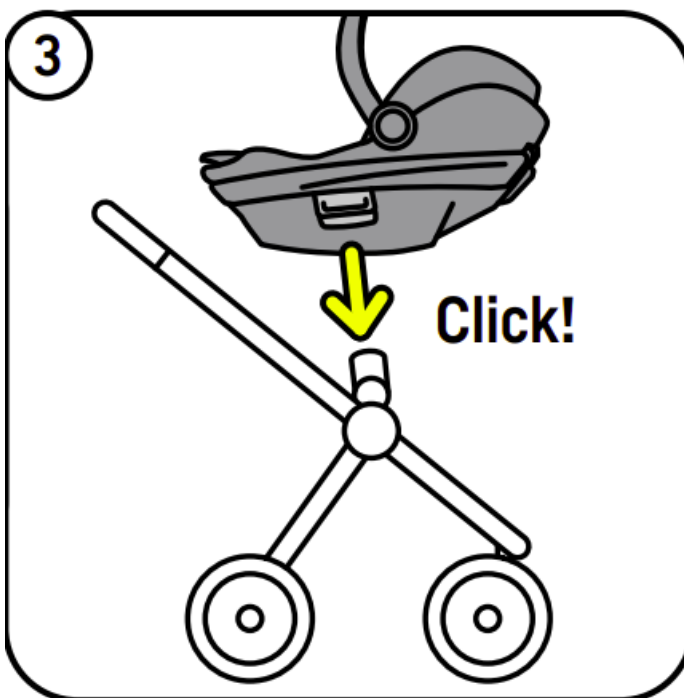

Removing from a stroller

1. Move the carry handle into carrying position.
2. Pull the stroller adapter housing outwards on both sides while lifting the seat upwards. (4)

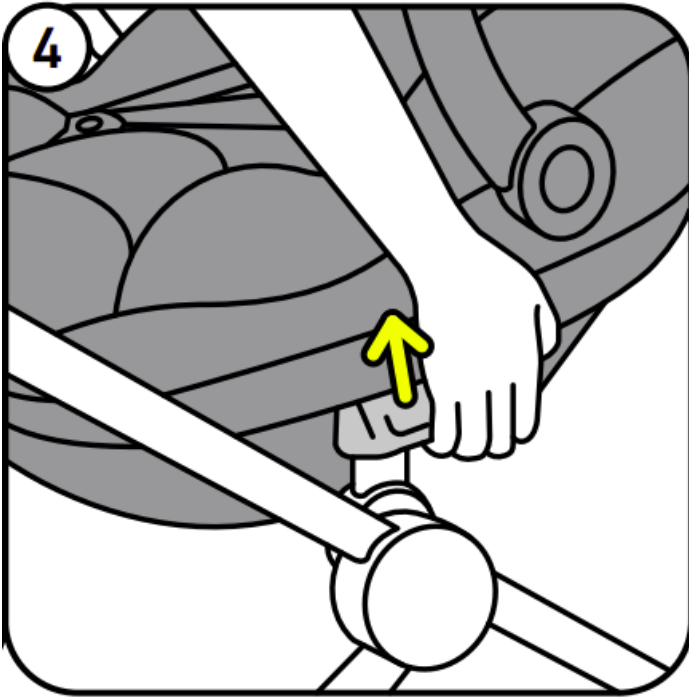

3. You can also release one side at a time, but pay attention that the first side remains unattached while releasing the second side.

Use in an aircraft

Installation in an aircraft

1. Always follow the airline's safety instructions.
2. Only install the seat on aircraft passenger seats that are approved for this purpose by the airline, that are facing in the direction of flight and where there is no area of airbag deployment.
3. Place the seat on the aircraft seat rear facing/against the direction of travel. (1)



4. Position the seat on the aircraft seat. Make sure the inner part is in the upright position (NOT lay flat position) and the carry handle is up in the carrying position. (2, 3, 4)

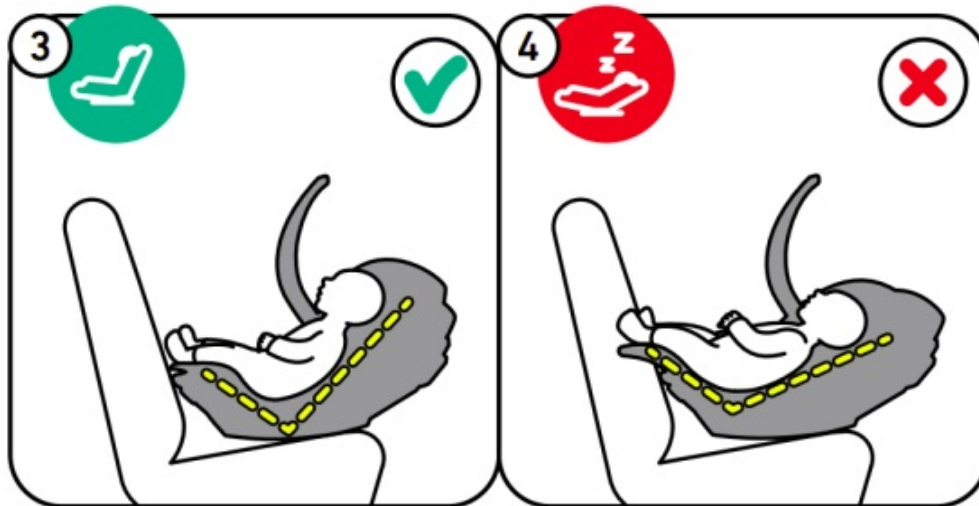
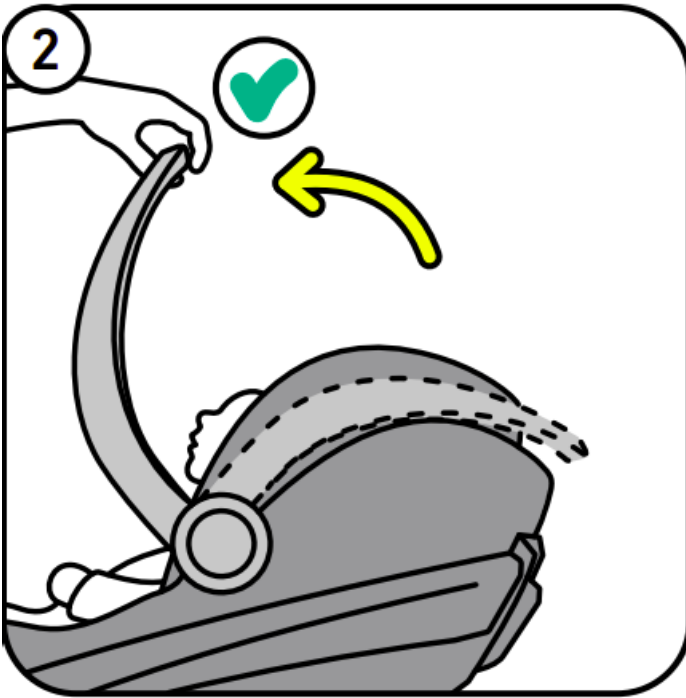

5. Place the aircraft seat belt through both green hip belt guiders and close the aircraft seat belt buckle. (1)

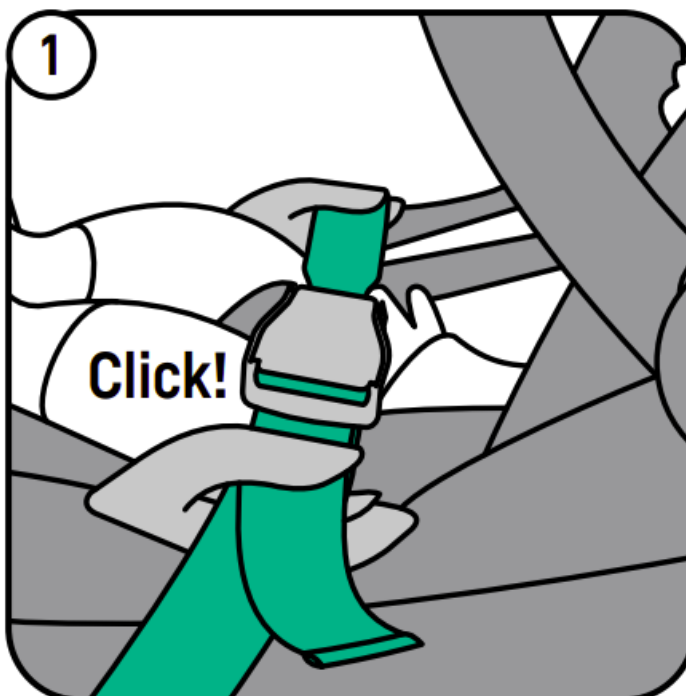

6. Pull the strap end of the aircraft seat belt to tighten it fully. (2)

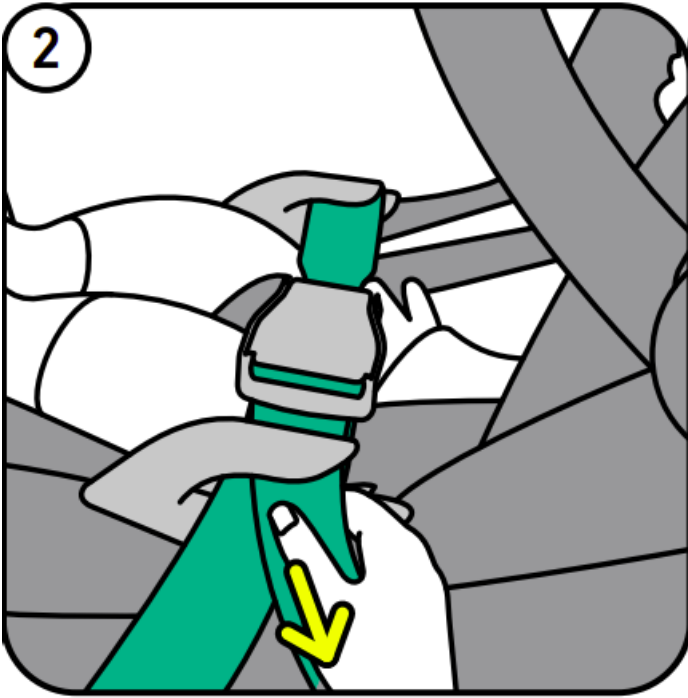

7. Take care that the aircraft seat belt buckle is not in or against one of the green hip belt hooks. (3)

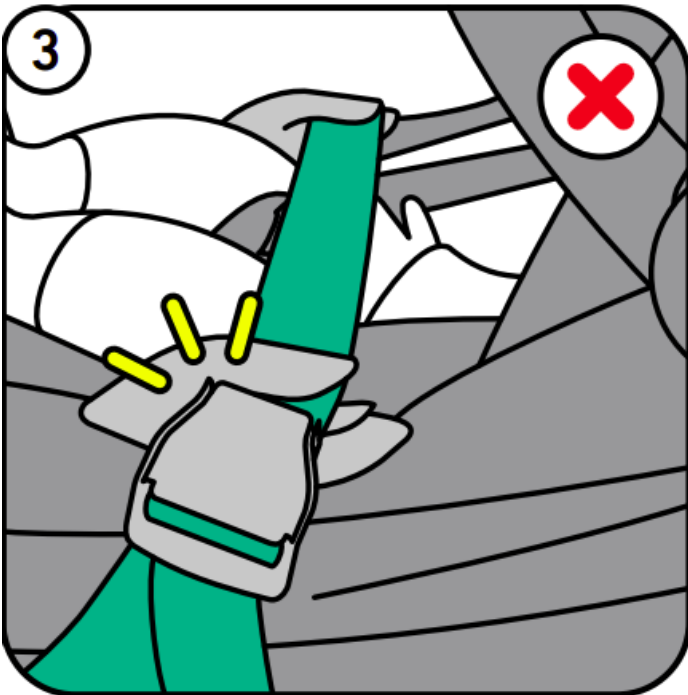

8. If this problem occurs, you can use a belt shortener to shorten the belt as described below, so that the buckle placement is no longer conflicting with the lap belt guider. Note that a belt shortener is not included with the seat but is available as a service part. Please contact BeSafe to request one.
9. Note that the shoulder belt guider on the backside of the seat stays unused when installing the seat on an aircraft seat.

Using a belt shortener

1. Attach the belt shortener onto the side of the aircraft belt which has the buckle tongue. Take care to position the belt shortener so that it sits on the side of the car seat, not inside the hip belt guider. (1, 2)

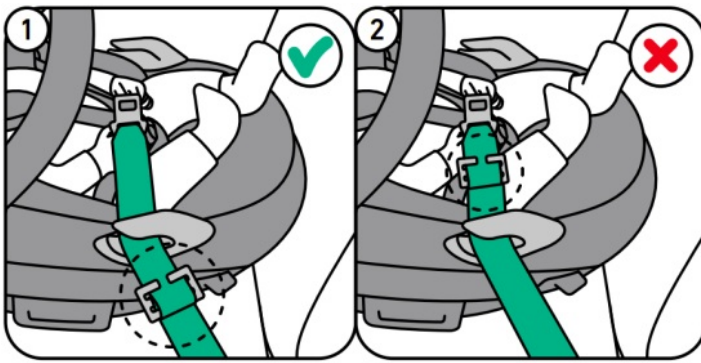

2. Guide the aircraft seat belt through both sides of the belt shortener, so that the center bar of the shortener is still visible. (3, 4, 5)

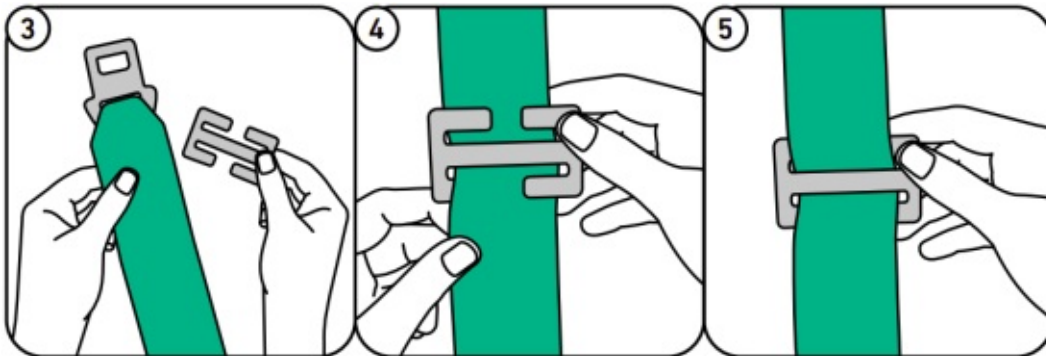

3. Shorten the belt by rotating the belt shortener half a turn, then slot the aircraft seat belt into the open slot of the belt shortener. (1, 2, 3, 4)

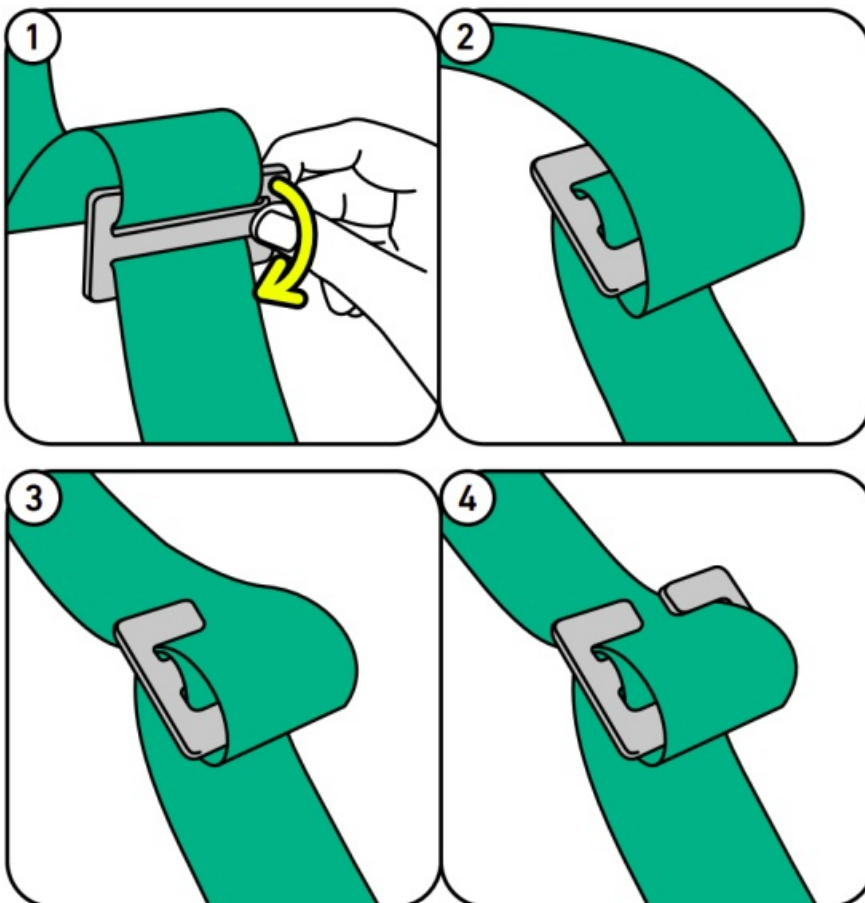

4. Repeat rotating and slotting until the aircraft belt buckle is no longer in the car seat's belt guider.

During the flight

1. Buckle up your baby securely whenever they are in the seat – see section “Placing the child into the seat”
2. Take the baby out of the seat as often as possible to avoid having your baby in the same position for too long.
3. Make sure that the seat is always properly installed, also when your baby is not in the seat.
4. Buckle up your baby in the seat whenever the seat belt sign lights up and in case of turbulences.

In case of an emergency evacuation

1. Remove the baby from the seat.
2. Follow the instructions of the cabin crew.
3. **Note:** when not complying with the instructions from this manual, the safety of the child cannot be guaranteed.

Removing and refitting the cover

- Please take care when you remove the cover, as re-fitting the cover is done in reverse
- The cover of the headrest and the inner part can be taken off separately.
- The sun canopy can be carefully removed and its fabric slid off the frame to wash it as well.
- For further instructions, please visit www.besafe.com
- Before washing make sure to close all velcro and zippers.
- When washing the seat cover, make sure to follow the wash label on the inside of the cover.

! **Warning:** potential misuse



- The child seat **MUST NOT** be installed in a front passenger seat **WITH AN ACTIVATED AIRBAG**.
- The floor support must always be used. Make sure that the floor support is fully pushed down and that the seat is positioned horizontal with the spirit level in the green area.
- Never drive with a child in the seat if the seat is rotated to the side.
- Make sure all indicators are green before you drive.

Guarantee

- Should this product prove faulty within 24 months of purchase due to materials or manufacturing fault, except covers and harness straps, please return it to the original place of purchase.
- The guarantee is only valid when you use your seat appropriately and with care. Please contact your retailer, they will decide if the seat will be returned to the manufacturer for repair. Replacement or return cannot be claimed. The guarantee is not extended through repair.
- The guarantee expires: when there is no receipt, when defects are caused by incorrect and improper use, when defects are caused by abuse, misuse or negligence.

Disassembly & disposal of the product

- This product can be disassembled in different materials for waste handling; please visit www.besafe.com for detailed instructions.

- Please hand in the product at a designated collection point for handling non-general household waste.

Disposal of the packaging

- The packaging of this product contains several components like cardboard, please separate these materials and hand them in the designated collection points in your area.

HTS BeSafe AS
NO-3535 Krøderen
Norway

Visit us: besafe.com

 facebook.com/BeSafe



 @besafeinternational

BeSafe®

Documents / Resources

	<p>BeSafe Go Beyond 3 Point Vehicle Belt [pdf] User Manual R129 i-Size, Go Beyond 3 Point Vehicle Belt, Go Beyond, 3 Point Vehicle Belt, Vehicle Belt, Belt</p>
-------------------------------------------------------------------------------------	-------------------------------------------------------------------------------------------------------------------------------------------------------------------------------------

References

-  besafe-servicepoint.de
-  [Developing the safest possible car seats for children of all ages | BeSafe](#)
-  [Developing the safest possible car seats for children of all ages | BeSafe](#)
- [User Manual](#)

Manuals+, Privacy Policy

This website is an independent publication and is neither affiliated with nor endorsed by any of the trademark owners. The "Bluetooth®" word mark and logos are registered trademarks owned by Bluetooth SIG, Inc. The "Wi-Fi®" word mark and logos are registered trademarks owned by the Wi-Fi Alliance. Any use of these marks on this website does not imply any affiliation with or endorsement.