



BEOK TCR7 WiFi RGB Colorful LCD Screen Smart Thermostat Instruction Manual

[Home](#) » [BEOK](#) » BEOK TCR7 WiFi RGB Colorful LCD Screen Smart Thermostat Instruction Manual 



Verson:TCR71.0(04/2021)

RGB Colorful LCD Screen Smart Thermostat

- √ Scan QR code to finish network configuration swiftly, easily and conveniently.
- √ The programmable device, multiple periods allowed to set per day.
- √ 2.8 inches ultra-large colorful LCD screen, delicate visual effect.
- √ Work with TmallGenie, voice control available.

Parameter

Supply voltage	AC100~240V;50–60Hz	
Power consumption	1W Max (Wi-Fi 3W Max)	
Temp. setting range	5~95°C	
Floor limited range	20.90°C	
On/off deviation	0.5~10°C, Factory setting $\pm 1^{\circ}\text{C}$	
Ambient temperature	-5,–50°C	
Protection level	I	P20
Shell material	Anti-Flammable PC	

Contents

[1 Product Overview](#)

[2 RGB Colorful LCD Screen Smart Thermostat](#)

[3 Installation instructions](#)

[4 Documents / Resources](#)

[5 Related Posts](#)

Product Overview

This series of thermostats has Floor Heating, Fan Coil, and Integrated version, meeting the requirements under different scenarios.

Version	System mode	Model	Application
Floor heating	Heating	EP Weekly programming	Built-in & floor sensor, floor limit sensor +
		WP	An NC/NO dual-output + Weekly programming
		WP B	An NC/NO dual-output + Weekly programming+ Potential-free output
Fan Coil	Heating /Cooling / Ventilation	Ac2	Timer task + 2-pipe system
		Ac2 485	Timer task + 2-pipe system + 485Modbus (optional)
		Ac4	Timer task + 4-pipe system + 485Modbus (optional)
Integrated	Heating / Cooling / Ventilation /Floor heating / Floor heating + Heating	AW y	Floor heating & fan coil, weekly programming + Potential-free output + Timer task + 485Modbus (optional) + Door card (optional)

Display Symbols

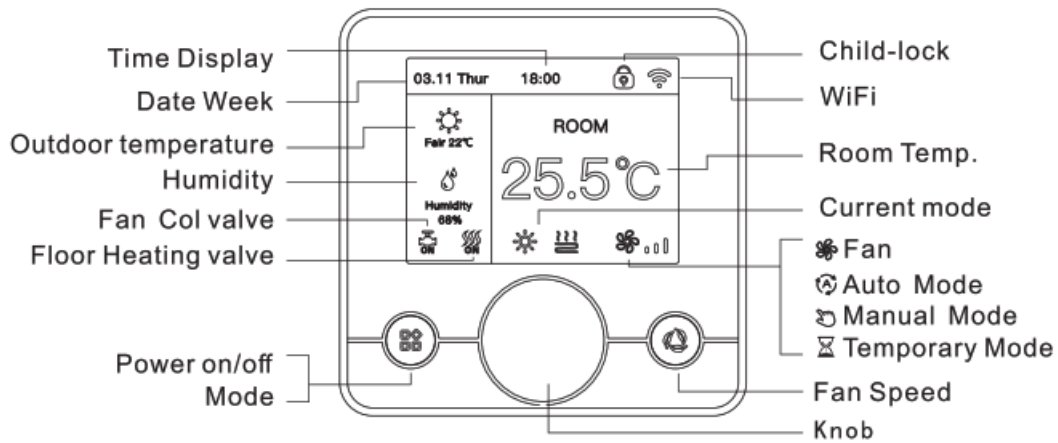

Temperature Control Mode(Floor Heating/Integrated)

 Auto Mode Weekly-circled program, up to 6 heating events can be set per day. Heating events, workdays, and temperatures can be separately customized based on personal routines.

 Manual Mode Thermostat works based on manually-set temperature, disconnecting from auto mode.

 Temporary Mode Thermostat works based on manually-set temperature temporarily and then shifts back to auto mode till the next event.

User Operation

Power off Press " " shortly to turn on/off the thermostat.

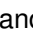
Temp setting: Rotate handwheel " " to change the set temperature by 0.5°C.

System node: Press " " shortly to switch cooling/heating/ventilation. (Fan Coil)

Press " " shortly to switch cooling/heating/ventilation/floor heating/ floor heating + heating. (Integrated)



Enter menu: Press " " enter the menu interface.



Temp control mode: Press " " shortly to switch manual/auto mode. (Floor heating)

Press " " shortly to switch manual/auto mode. (Integrated, floor heating)

Child-lock Press " M " + " " for 3 seconds to activate child-lock.

Auto-mode Setting

When device is off, press " " to enter menu page, choose "period setting" to set parameters, then press " " to save and exit.

Events		Time		Temperature		
		Default value		Modify	Default value	Modify
Workdays	Sunrise	0 6	0 0	 Rotate h and wheel	20°C	 Rotate h and wheel
	Morning	0 8 :	0 0		1 5 °C	
	Nooning	11 :	30		15°C	
	Afternoon	12 :	30		15°C	
	Evening	17 :	00		22°C	
	Night	22 :	00		15°C	
Weekends	Sunrise	06 :	00		20°C	
	Night	22 :	00		15°C	

Advanced Setting (Usually for Professional Technicians)

Choose “advanced setting” on the menu page and put in password 123456 to enter the advanced setting page, set parameters then press “” to save and exit.

Meaning	 Rotate handwheel	Default value
Sensor Mode	Built-in Sensor Floor Sensor Built-in Control&Floor Limitation	IN
Built-in Sensor Calibration	-5-5°C	-3°C
Built-in Max Setting Value	5-95°C	50°C
Floor Max Setting Value	10-95°C	50°C
Limitation Value	20-95°C	35°C
Output Jitter Control	0-5°C	1°C
Anti-Freeze Protection	ON/OFF	OFF
Linkage Mode	Noninverting Inverting Inverting Inverting and Anti-Freeze closed	Noninverting
Linkage Time Delay	0-5Min	0Min
Weekday Mode	Monday to Friday/Monday to Saturday /Monday to Sunday/	2-day
Boot Type	Function Off/Function On/Function Saved	OFF
Temperature Unit	F/°C	°C
Child Lock Type	None Lock All All but power	None
Control Mode	All/Air/Floor	Floor
Cloud Region	CN/US/EU	CN
Reset All Settings	/	/

RGB Colorful LCD Screen Smart Thermostat

Sensor failure

Please select the work mode of sensors correctly. When it shows EO/E1 error, the thermostat will stay power-off till the error is eliminated. EO: the built-in sensor is short-circuited or disconnected. EI: floor sensor is short-circuited or disconnected.

Timer Task Setting (Fan Coil/Integrated)

Press " " to enter the menu. Turn the knob " " , choose "Auto Mode", and then choose "Schedule". Set the parameters by turning the knob, then press " " to save and exit to the home page

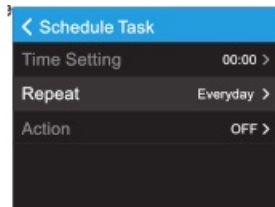

Dimensions (Unit: mm)

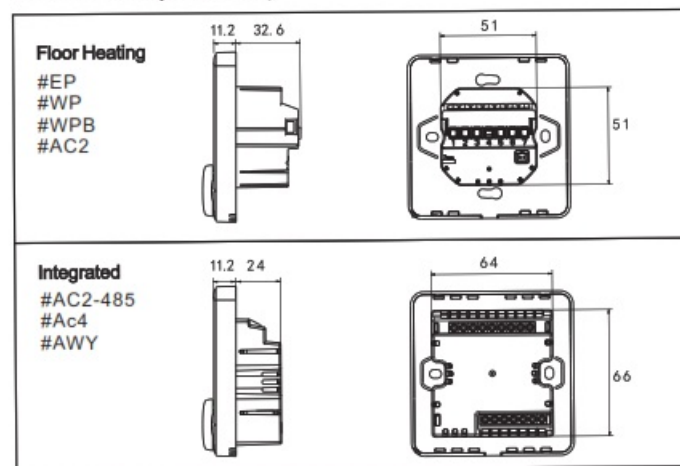

Mounting Steps

The thermostat adopts a pre-guide and limited snap-fit design. It is easy to mount.

1. Release the front cover by inserting a head screwdriver into the bottom crack.

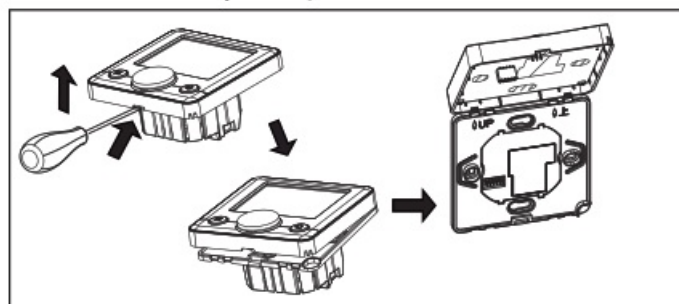

2. Insert the wires and then fix these wires with screws. The suggested wire-stripping length is 7-9mm.
3. Mount backing plate into wall-cassette, put screws, and then fix the thermostat. Make sure that the thermostat is fixed without deformation. Suggested torque is 0.2-0.4N.m (2.0-4. lkgf.cm).

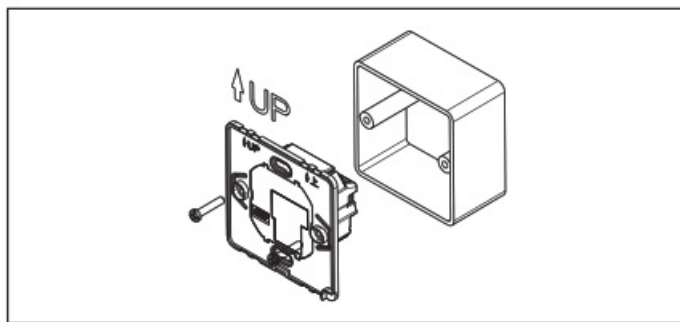

4. Re-mount the front cover via a snap-fit connection.

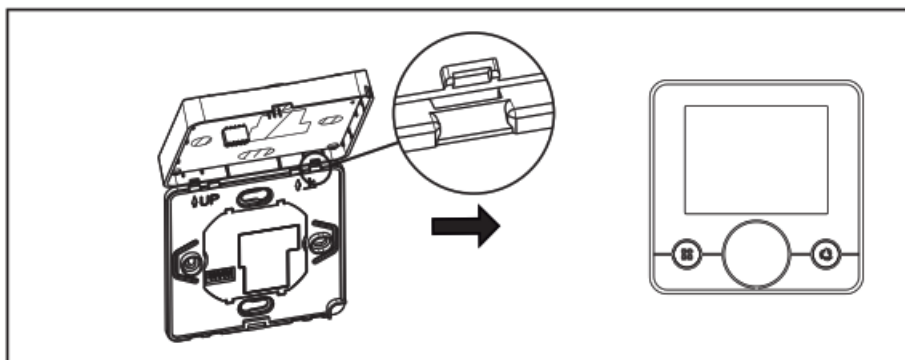

Installation instructions

Connecting Diagram

The thermostat operates in full capacity in areas with an altitude of less than 2500 above sea level. The power rating of external load should be less than or equal to 80% rated power of the thermostat in areas with an altitude of 2500m to 4200m.

Floor Heating

Fan Coil

#TCR7-WIFI-AC2
#TCR7-AC2

#TCR7-WIFI-AC2-485
#TCR7-AC2-485

#TCR7-WIFI-AC4
#TCR7-AC4

#TCR7-WIFI-EP
#TCR7-EP

#TCR7-WIFI-WP
#TCR7-WP
#TCR7-WIFI-WPB
#TCR7-WPB

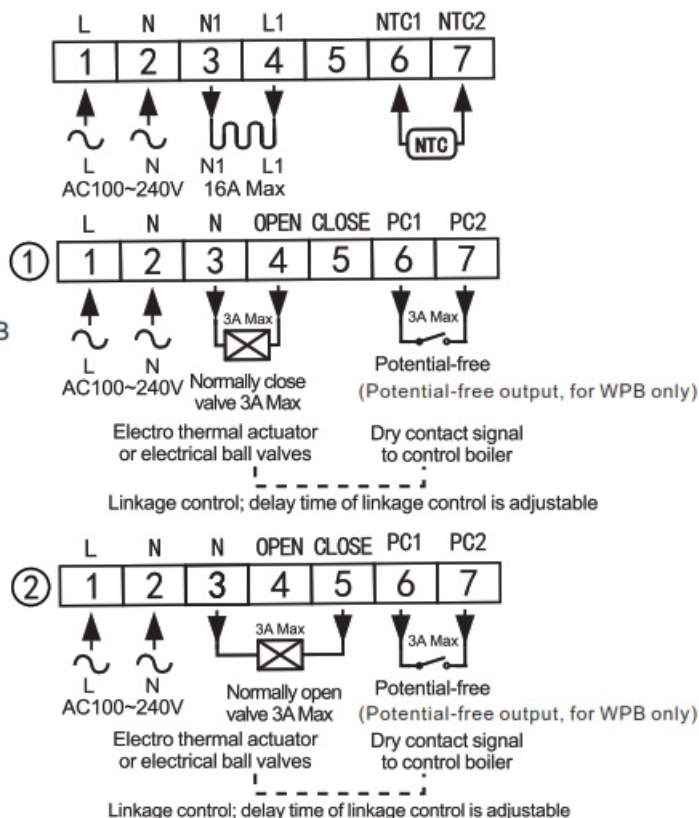

Integrated

#TCR7-WIFI-AWY
#TCR7-AWY

Linkage contr
linkage contr

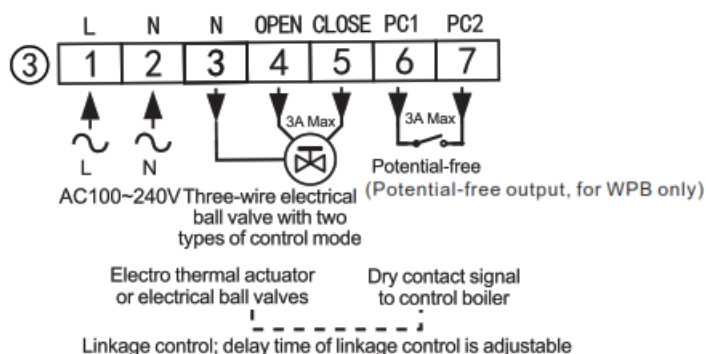

Documents / Resources

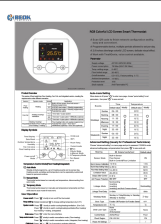

[BEOK TCR7 WiFi RGB Colorful LCD Screen Smart Thermostat](#) [pdf] Instruction Manual
TCR7, WiFi RGB Colorful LCD Screen Smart Thermostat, TCR7 WiFi RGB Colorful LCD
Screen Smart Thermostat