



BenQ AR17C ScreenBar Plus eReading LED Computer Monitor Light Bar User Guide

[Home](#) » [BenQ](#) » BenQ AR17C ScreenBar Plus eReading LED Computer Monitor Light Bar User Guide 

Contents

- [1 BenQ AR17C ScreenBar Plus eReading LED Computer Monitor Light Bar](#)
- [2 Specifications](#)
- [3 Installation](#)
- [4 For Your Safety](#)
- [5 Using the Lamp](#)
- [6 Maintenance and Troubleshooting](#)
- [7 Specifications](#)
- [8 FAQ](#)
- [9 Documents / Resources](#)
 - [9.1 References](#)
- [10 Related Posts](#)



BenQ AR17C ScreenBar Plus eReading LED Computer Monitor Light Bar



Specifications

- **Monitor frame thickness range:** 1cm – 3cm
- **Power source:** USB
- **Color temperature settings:** Adjustable
- **Brightness settings:** Adjustable

Installation

1. Check the packaging for the following items. If any is missing or damaged, please contact the place of purchase immediately.

- ScreenBar Plus lamp x 1
- Clip x 1
- USB power cable (with controller) x 1

The illustrations in this guide are for your reference only and may look different from the appearance of the actual product.

2. As shown in [Figure A], insert the lamp into the clip.

3. Rest the clip on top of your monitor [Figures B 1 B 2,]. It is recommended that you fit the clip closely against the monitor frame so there is no visible gap in between [Figure B 3].

The applicable range of the monitor frame thickness is 1cm – 3cm.

4. Connect the Micro-USB/Type-C connector of the supplied USB power cable to the Micro-USB/Type-C port on the lamp [Figure C 1], and the USB connector to the USB port of your computer [Figure C 2]. The lamp will automatically turn ON upon receiving power from the USB port.

- Do not use a USB extension cable, or a USB cable other than the one supplied. Otherwise, the lamp will

not function properly.

- It is recommended that the lamp's power be supplied by the USB port of your computer. If a portable power bank or AC power adapter is to be used as the power source for the lamp, the power output shall meet the requirement (output voltage: 5V, output current: 1A or above) for the lamp to function normally.
- If the Auto Dimmer Mode indicator flashes, make sure you are using the USB cable that is provided and no USB extension cable is being used.

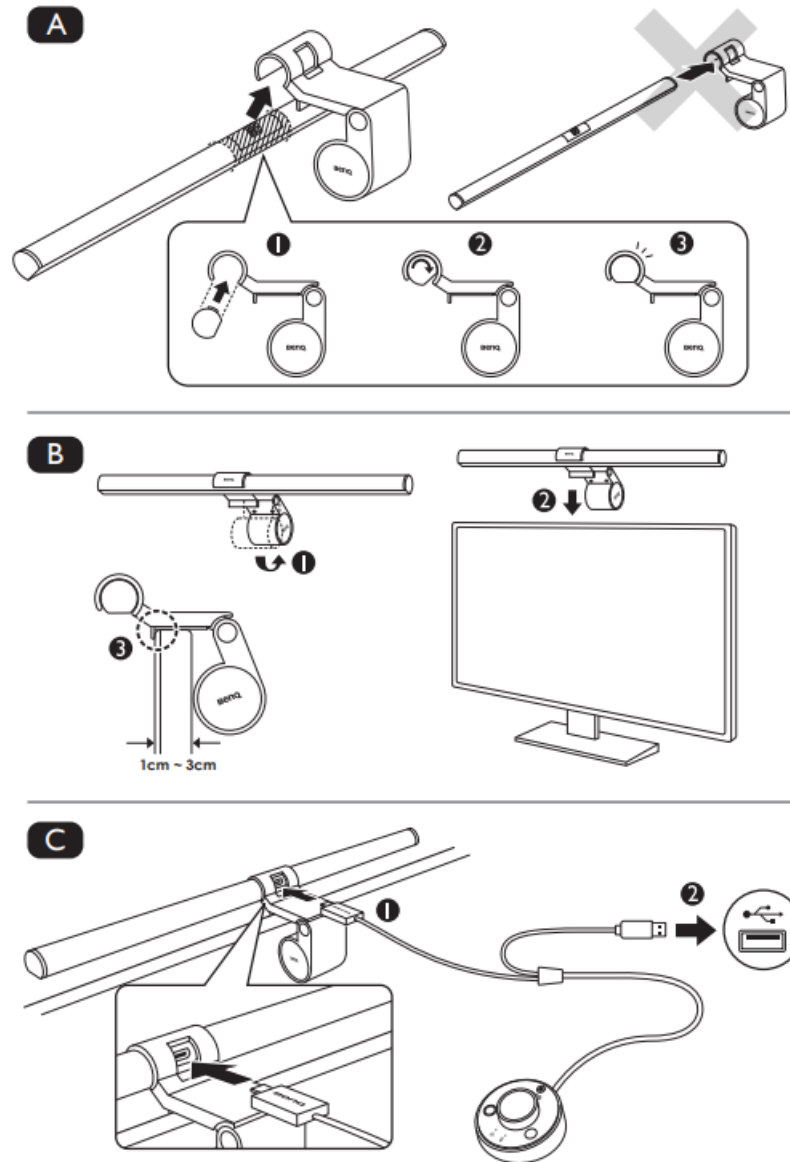

For Your Safety

- Use only the supplied USB power cable and connect only to USB port power (5V DC, 1A). Otherwise, the lamp will fail to work normally or result in a fire hazard.
- In order to prevent any damage to the lamp, do not hang or place any objects on the lamp.
- Route the USB power cable to prevent it from being pinched by items placed upon it or against it.
- If the lamp will not be used for a long time, unplug it from the USB port.
- The light source contained in this luminaire can't be replaced.

CAUTION

- In case of the following situations, unplug the lamp from the USB port immediately and contact the authorized

service center or a qualified service person for inspection or repair:

- When the outer casing of the lamp is broken
- When strange odors are coming from the lamp
- When the LED light source flickers
- When the insulation of the lamp's wiring is damaged or frayed, and the metal strings inside can be seen
- Do not use the lamp in a humid environment (like in a bathroom or outdoors). Otherwise, the components inside may short-circuit and result in accidents.
- This lamp is designed for indoor use only. Do not use it outdoors.
- Never disassemble the lamp or remove any components from it, as doing so may result in accidents and will void the product warranty.

Using the Lamp

Turning on/off the Lamp and Entering Auto Dimmer Mode

Turning on/off the Lamp

To turn on the lamp, press the knob on the controller. To turn off the lamp, press the knob again.

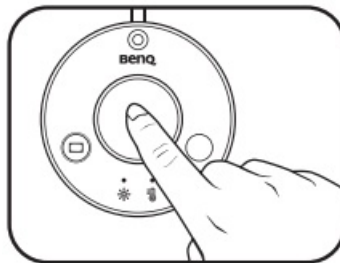

Entering Auto Dimmer Mode

To enter Auto Dimmer Mode, press the Auto Dimmer Mode button  on the controller when the lamp is on. The Auto Dimmer Mode indicator will light up. The Auto Dimmer Mode automatically adjusts the lamp's brightness according to the ambient lighting condition and optimizes the color temperature setting for reading.

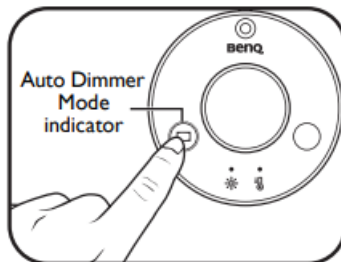

- Do not block the light sensor on the controller. Otherwise, the Auto Dimmer Mode will not function properly.
- The Auto Dimmer Mode will be canceled and the Auto Dimmer Mode indicator will go off when you adjust brightness or color temperature.

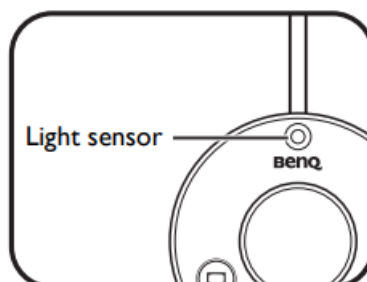

Adjusting Brightness and Color Temperature

Adjusting Brightness

When the lamp is on, press the Color temperature/Brightness selection button on the controller. When the Brightness adjustment indicator  lights up, turn the knob clockwise to increase brightness, or counter-clockwise to decrease it. You can select from 15 brightness levels.

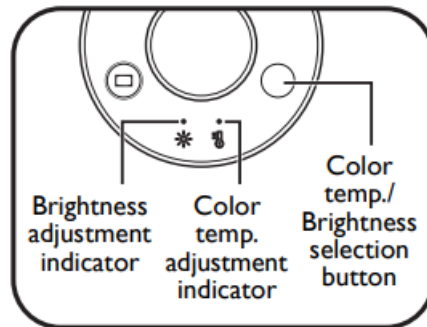

Adjusting Color Temperature

When the lamp is on, press the Color temperature/Brightness selection button on the controller. When the Color temperature adjustment indicator  lights up, turn the knob clockwise to increase color temperature, or counter-clockwise to decrease it. You can select from 8 color temperature settings: 6500K (daylight), 5700K (cool white), 5000K, 4500K (neutral white), 4000K, 3500K (warm white), 3000K and 2700K (soft white).

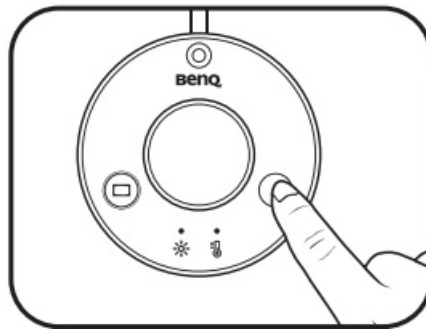

- The brightness and color temperature settings will be memorized automatically.
- If power supply to the lamp is interrupted unexpectedly, the lamp will resume the last used brightness and color temperature settings upon the recovery of the power supply

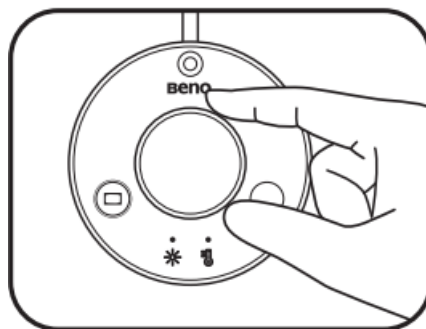

Maintenance and Troubleshooting

- Turn off the lamp first, and unplug the lamp from the USB port. Wipe any smears or dust off the lamp's outer casing using a soft, lint-free cloth lightly moistened with a mild detergent solvent. Do not use alcohol or any other chemical solvents like kerosene, naphtha, and so on, as the lamp's casing may become damaged.
- Do not rinse the lamp or any of its components directly with water.
- If the lamp does not turn on, check to make sure that there are no loose connections between the USB cable

and USB ports.

- If the lamp does not turn on and the Auto Dimmer Mode indicator keeps blinking, the lamp is supplied with insufficient power voltage. Connect the lamp to another USB port that provides a 5V output voltage to solve this problem.
- If the problem persists, please contact the original place of purchase for help

Specifications

Model

- DC power input
- Dimensions

AR17_C

- 5V, 1A
- 450 x 90 x 92 mm (Width x Depth x Height)

FAQ

- **Q: What should I do if the outer casing of the lamp is broken?**
 - A: If the outer casing of the lamp is broken, please stop using the lamp and contact customer support for assistance.
- **Q: What should I do if strange odors are coming from the lamp?**
 - A: If strange odors are coming from the lamp, please stop using the lamp and contact customer support for assistance.
- **Q: What should I do if the LED light source flickers?**
 - A: If the LED light source flickers, please stop using the lamp and contact customer support for assistance.
- **Q: What should I do if the insulation of the lamp's wiring is damaged or frayed?**
 - A: If the insulation of the lamp's wiring is damaged or frayed, and the metal strings inside can be seen, please stop using the lamp and contact customer support for assistance.

BenQ.com

© 2021 BenQ Corporation.

All rights reserved. Rights of modification reserved.

P/N: 4J.W4301.001

	BenQ AR17C ScreenBar Plus eReading LED Computer Monitor Light Bar [pdf] User Guide AR17C ScreenBar Plus eReading LED Computer Monitor Light Bar, AR17C, ScreenBar Plus eReading LED Computer Monitor Light Bar, Plus eReading LED Computer Monitor Light Bar, eReading LED Computer Monitor Light Bar, Computer Monitor Light Bar, Monitor Light Bar, Light Bar, Bar
---	--

References

- [LCD Monitors, Projectors, Speakers and Lighting | BenQ AU](#)
- [User Manual](#)