

Benjara BM123639 Transitional Style Computer Desk



Benjara BM123639 Transitional Style Computer Desk Instruction Manual

[Home](#) » [Benjara](#) » Benjara BM123639 Transitional Style Computer Desk Instruction Manual 

Contents

- [1 Benjara BM123639 Transitional Style Computer Desk](#)
- [2 Specifications](#)
- [3 Product Usage Instructions](#)
- [4 FAQ](#)
- [5 TOOLS REQUIRED](#)
- [6 PRE ASSEMBLY INTRODUCTION](#)
- [7 ASSEMBLY AND CARE ADVICE](#)
- [8 PARTS](#)
- [9 HARDWARE](#)
- [10 ASSEMBLY INSTRUCTIONS](#)
- [11 Documents / Resources](#)
 - [11.1 References](#)

Benjara

Benjara BM123639 Transitional Style Computer Desk



Specifications

- **Assembly Rating:** 4 out of 5
- **Recommended Number of People for Assembly:** 2
- **Material:** Wood, metal, glass
- **Colour:** Varies
- **Dimensions:** Varies

Product Usage Instructions

Pre-Assembly Preparation

- **Teamwork:** Always have at least two people to help with transporting and assembling the product to avoid potential injury and/or damage.
- **Suitable Location:** Assemble near the area of the intended location.
- **Sufficient Space:** Ensure you have enough space to move around during assembly.
- **Avoid Scratches:** Use cardboard, blankets, or a carpeted area while assembling furniture to prevent scratches and damages.
- **Flat Surface:** Ensure the furniture rests on a flat and level surface with each leg evenly touching the floor.

Assembly Steps

1. **Step 1:** Do not fully tighten all bolts until assembly is complete. This will help all parts to assemble properly.
2. **Step 2:** Align the leveller (#1) to the bottom hole of the side panel (#3). Secure by using bolt (#A) with washer (#G).

Note: Refer to the provided diagrams and part numbers to ensure correct assembly.

Post-Assembly

- **Final Check:** Ensure the furniture rests on an even and flat surface. If the product wobbles or feels loose, double-check all bolts and/or screws are properly tightened and secured.
- **Storage:** Retain the instruction manual and any order-related information for future reference.
- **Handling:** Always lift the product when transporting or adjusting the placement to prevent damage.

FAQ

- **Q:** How long does it take to assemble the product?
- **A:** The assembly time may vary based on experience, but typically it takes around 1-2 hours with two people working together efficiently.
- **Q:** Can I assemble the product alone?
- **A:** While it is recommended to have two people for assembly, experienced individuals may be able to assemble it alone with caution.

TOOLS REQUIRED



Allen Wrench

(Included)



Phillips Screwdriver

(Not Included)

2 – People Recommended

ASSEMBLY RATING



The Assembly Rating is a 5-point system showing the level of effort needed to assemble a specific product.

PRE ASSEMBLY INTRODUCTION

We understand building ready-to-assemble furniture can be a challenging experience for some. To help avoid confusion, we have provided some helpful tips that may speed up the process.

Teamwork

ALWAYS have at least two people to help with transporting and assembling the product to avoid potential injury and/or damage.



Suitable Location

Assembling near the area of the intended location is highly recommended.



Sufficient Space

Make sure you have enough space to move around during the assembly.



Avoid Scratches

Use cardboard, blankets or a carpeted area while assembling furniture to prevent scratches and damages.

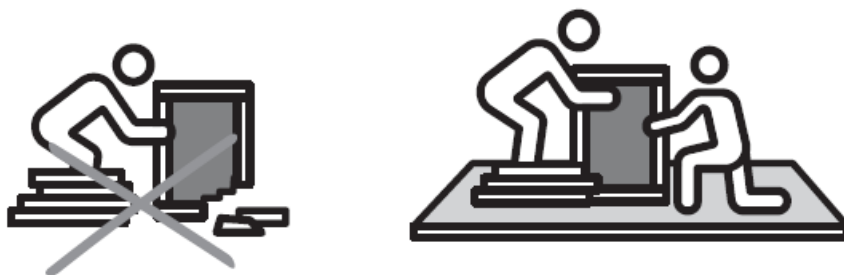

Flat Surface

Make sure the furniture rests on a flat and level surface with each leg evenly touching the floor.

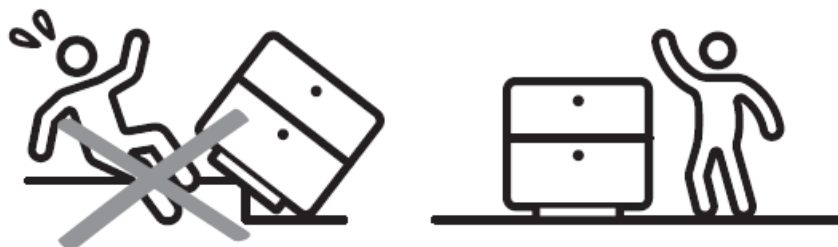

ASSEMBLY AND CARE ADVICE

FAILURE TO FOLLOW THE GUIDELINES BELOW MAY RESULT IN INJURY AND/OR PROPERTY DAMAGE.

- Position each part correctly and insert screws or bolts into their respective holes.



- Use the appropriate hand tools or power tools for assembly. Select steps, such as tightening screws and/or bolts, may require hand tools to avoid causing damage during assembly.



- Turn clockwise to tighten and only tighten when the step is completed or when instructed to do so.

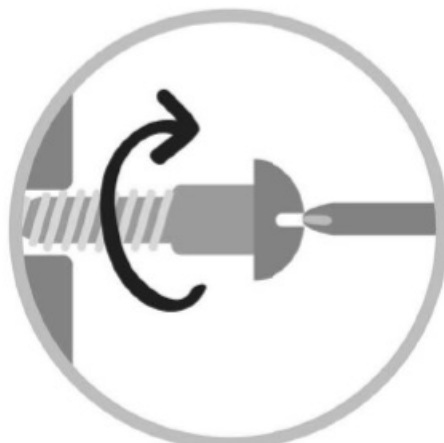

- Save the instructions and store any supplied tools for later maintenance.



- After two weeks, check and tighten any loose hardware and repeat every six months thereafter.



IT IS THE USER'S RESPONSIBILITY TO MAINTAIN THE FURNITURE. THE HARDWARE MAY LOOSEN OVER TIME AND MAY CAUSE THE FURNITURE TO BE WOBBLY AND UNABLE TO SUPPORT ITS INTENDED WEIGHT CAPACITY. THIS MAY LEAD TO COLLAPSE AND MAY CAUSE SERIOUS INJURY.

COMPUTER DESK WITH WOOD BOARD KEYBOARD

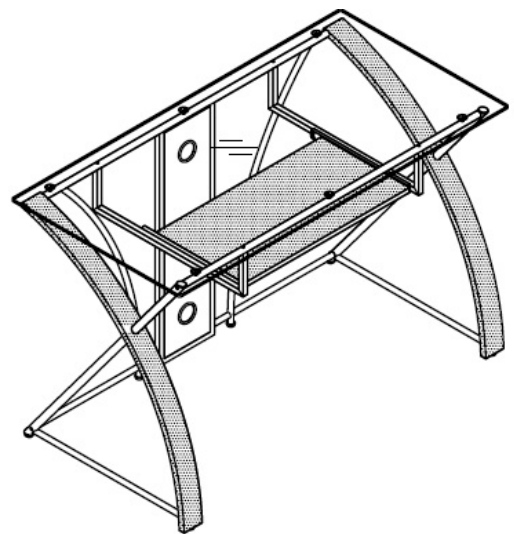
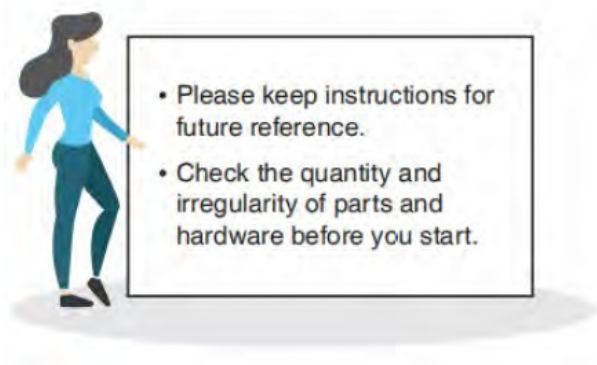

PARTS

#1 1pc

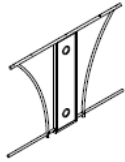

Back Panel

#2 2pcs



Arc Panel

#3 2pcs

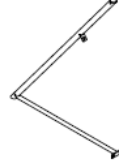

Side Panel

#4 1pc

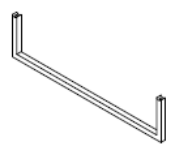

Left Frame for
Keyboard

#5 1pc

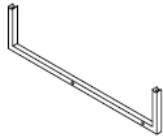

Right Frame for
Keyboard

#6 1pc

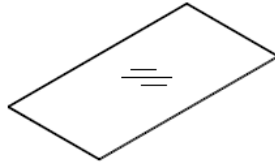
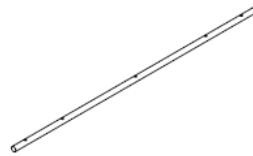

Table Top Glass

#7 1pc



Top Cross Bar

#8 1pc

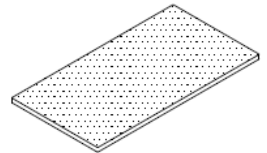

Wood Shelf

#9 1pc

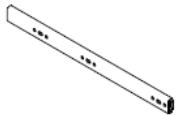

Left Slide

#10 1pc



Right Slide

HARDWARE

#A 6pcs

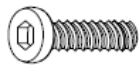

Bolt $\phi 1/4$ "x5/8"
(White)

#B 4pcs



Bolt $\phi 1/4$ "x1-1/2"
(White)

#C 4pcs



Bolt $\phi 1/4$ "x1-1/2"
(White)

#D 2pcs



Bolt $\phi 1/4$ "x3-1/4"
(White)

#E 8pcs



Bolt $\phi 3/16$ "x1/2"
(White)

#F 4pcs



Screw M4 x13mm
(White)

#G 8pcs



Flat Washer $\phi 1/4$ "
(White)

#H 6pcs



Suction Cup

#I 4pcs



Leveler $1/4$ "

#J 1pc



ASSEMBLY INSTRUCTIONS

ASSEMBLY Do not fully tighten all bolts until assembly is complete. This will help all parts to assemble properly.

- Part #3 x2pcs Hardware #1x2pcs

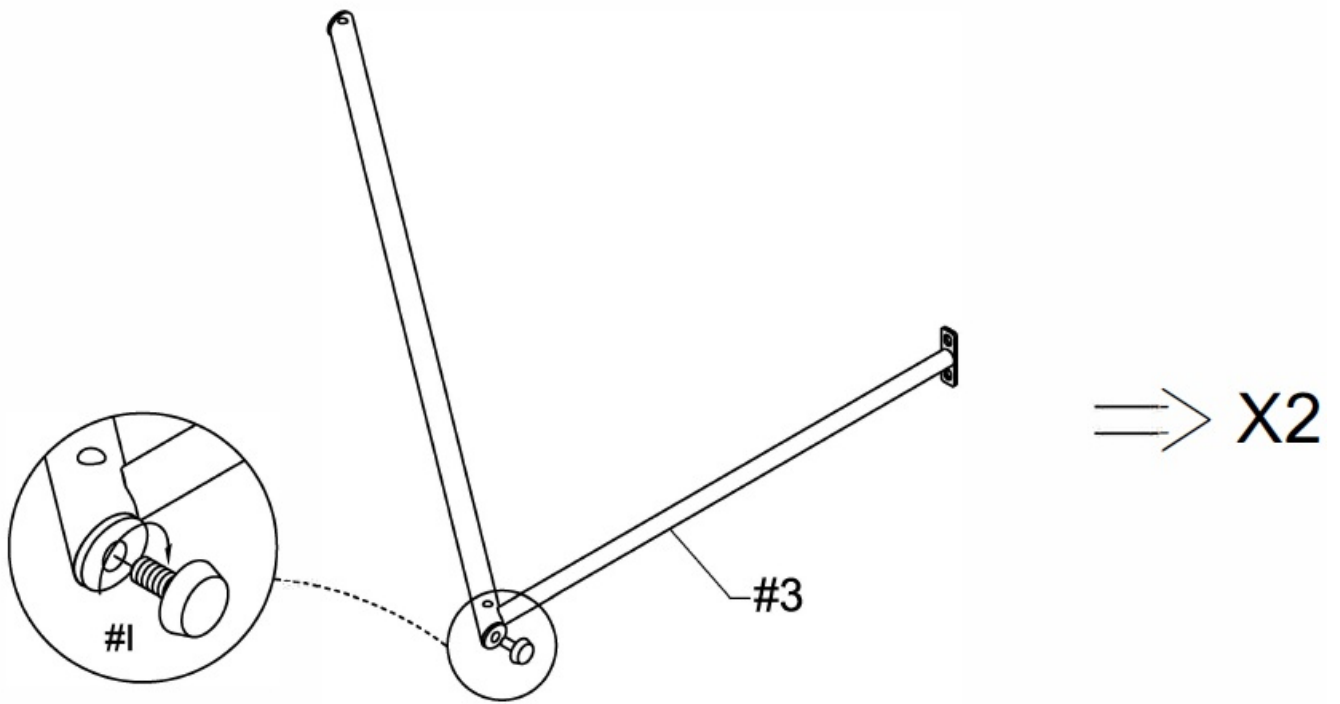

- Align the leveller (#1) to the bottom hole of the side panel (#3).
- Part 2x2pcs
- Hardware A x6pcs
- Hardware G x6pcs
- Hardware J x1 pc

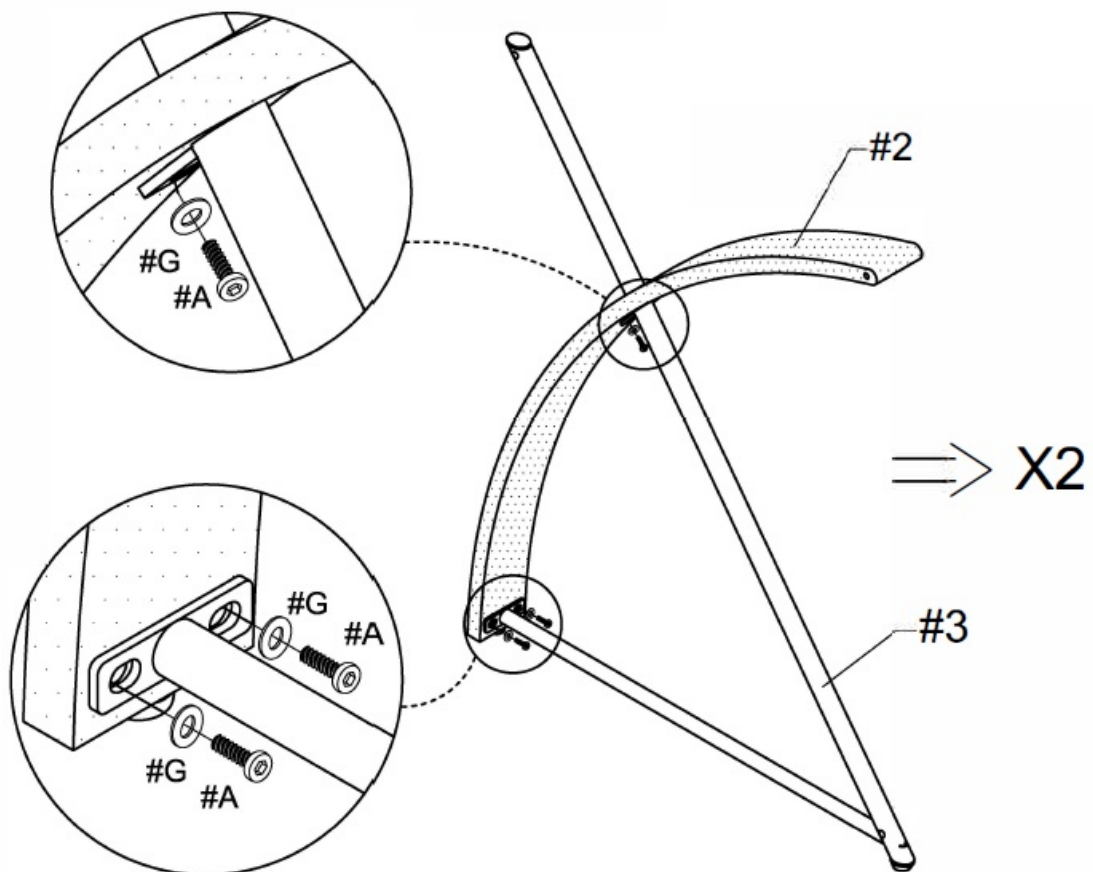

Align arc panel (#2) to side panel (#3), then secure by using bolt (#A) with washer (#G).

- Part 1 x1pc
- Hardware 1c2pcs

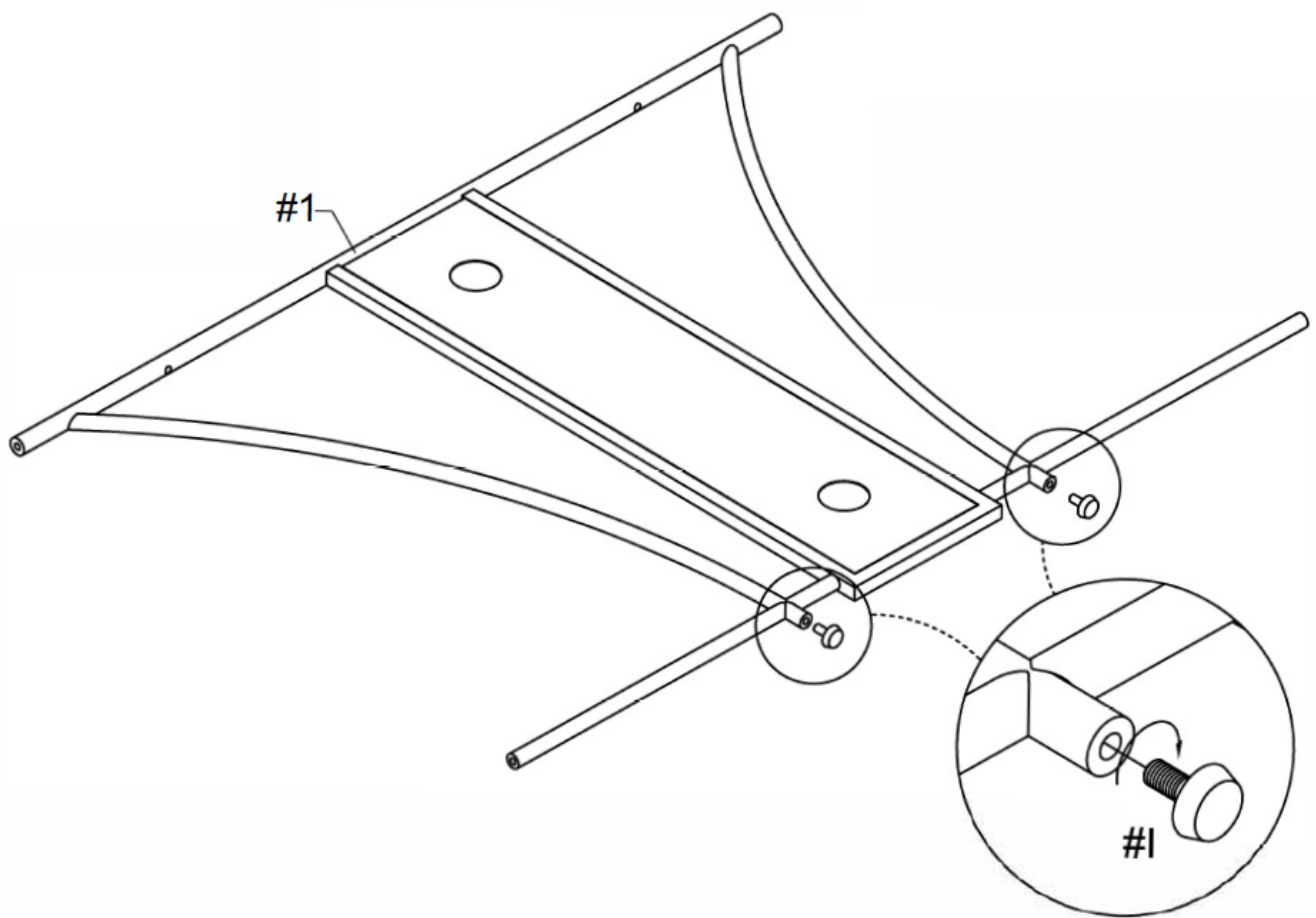

Align leveller (#1) to the bottom hole of the back panel (#1).

- Part 7 x1pc
- Hardware Bx4pcs
- Hardware Dx2pcs
- Hardware G x2pcs
- Hardware Jx1 pc

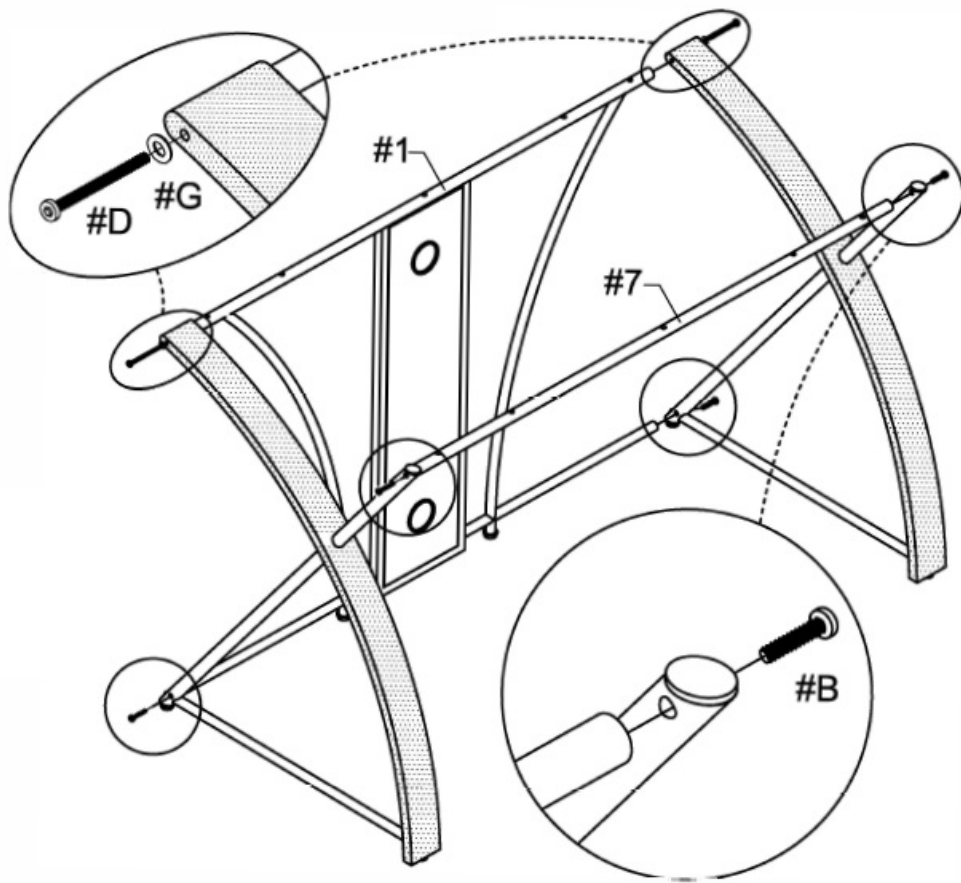

Align back panel (#1), and top cross bar(#?) to side panel (#3) and arc panel (#2), then secure by using bolt (#A, #D) with washer (#G).

- Part 4x1pc
- Part 5x1pc
- Hardware C x4pcs
- Hardware Jx1 pc

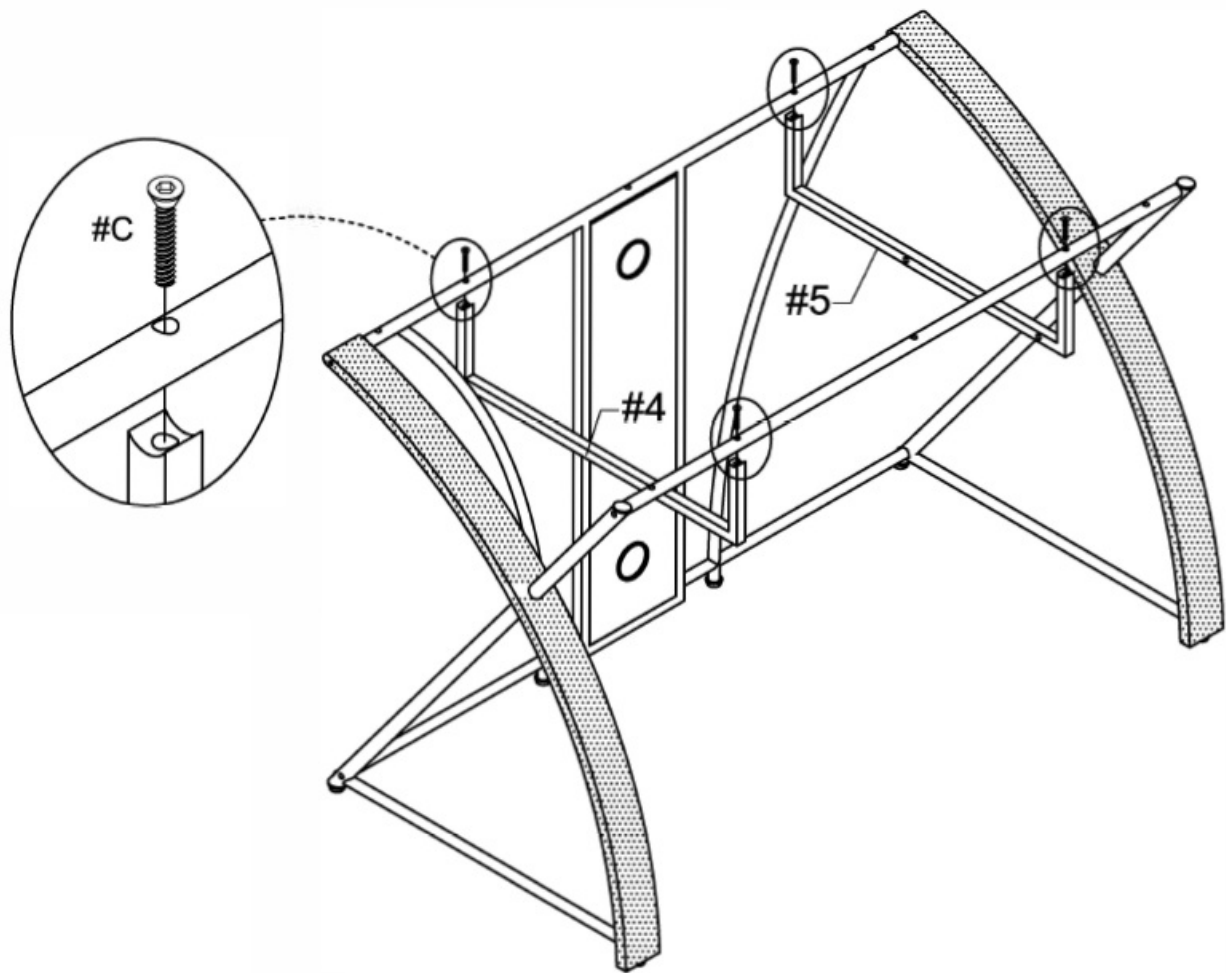

Align the frame for the keyboard (#4, #5) to the back panel (#1) and top crossbar (#7), then secure by using bolts (#C) as shown in the diagram.

- Part 9 x1pc
- Part 10 x1pc
- Hardware E x4pcs

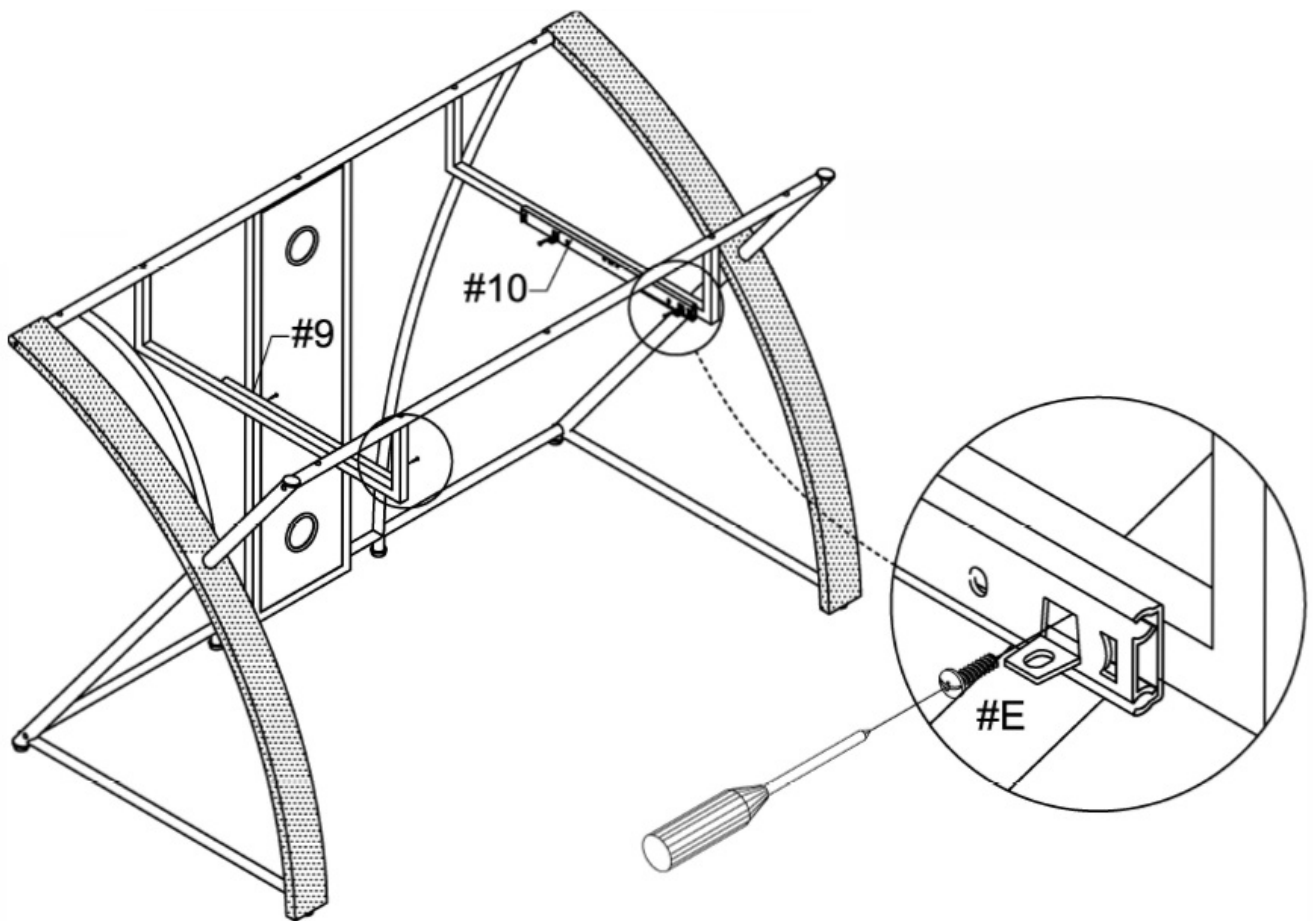

Align slides (#9, #10) to the frame for the keyboard (#4, #5), then secure by using bolts (#E).

- Part 8 x1pc
- Hardware F x4pcs

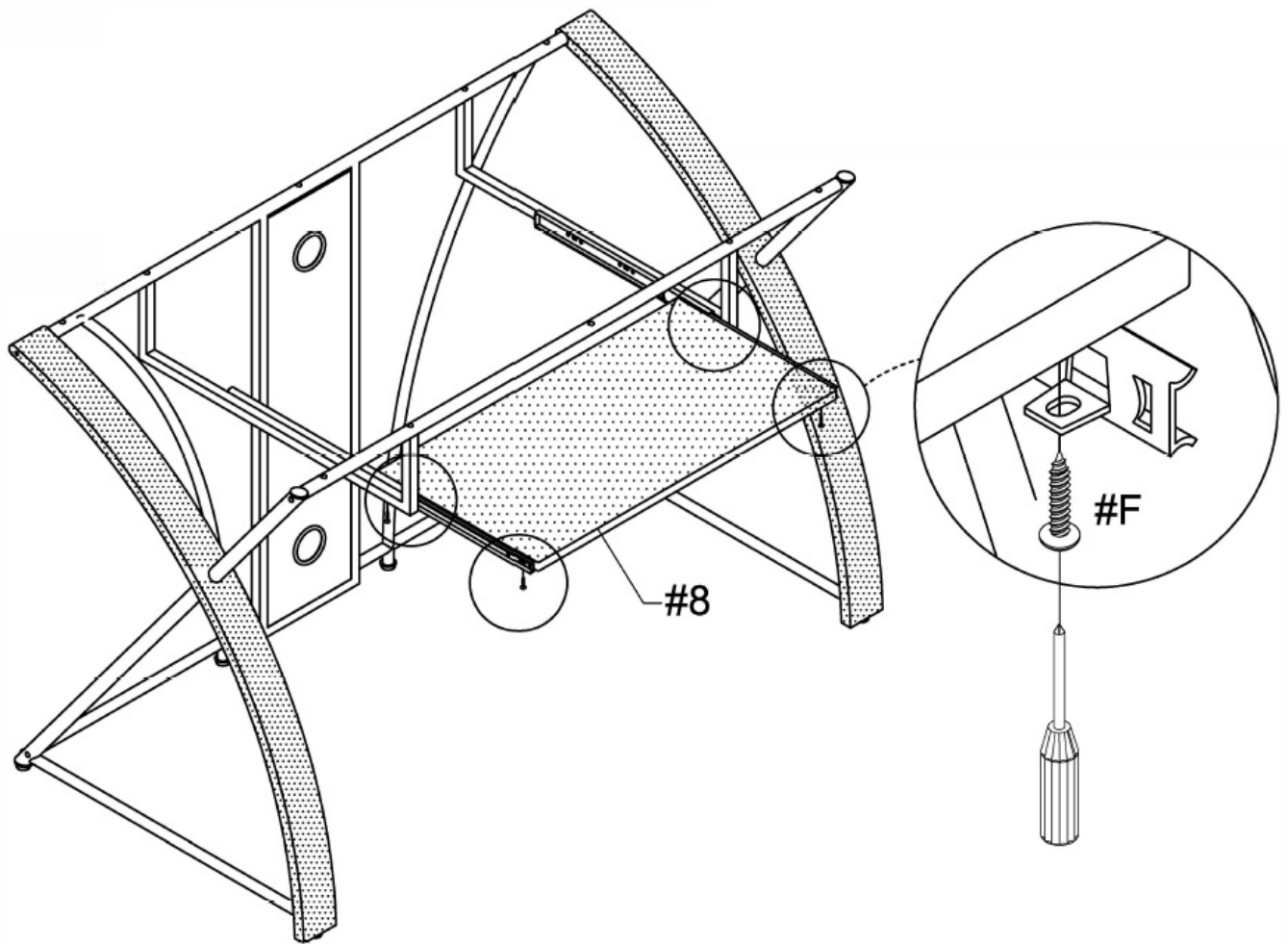

Align the wood shelf (#8) to the frame for the keyboard (#9, #10), then secure by using screws (#F)

- Part 6 x1pc
- Hardware H x6pcs

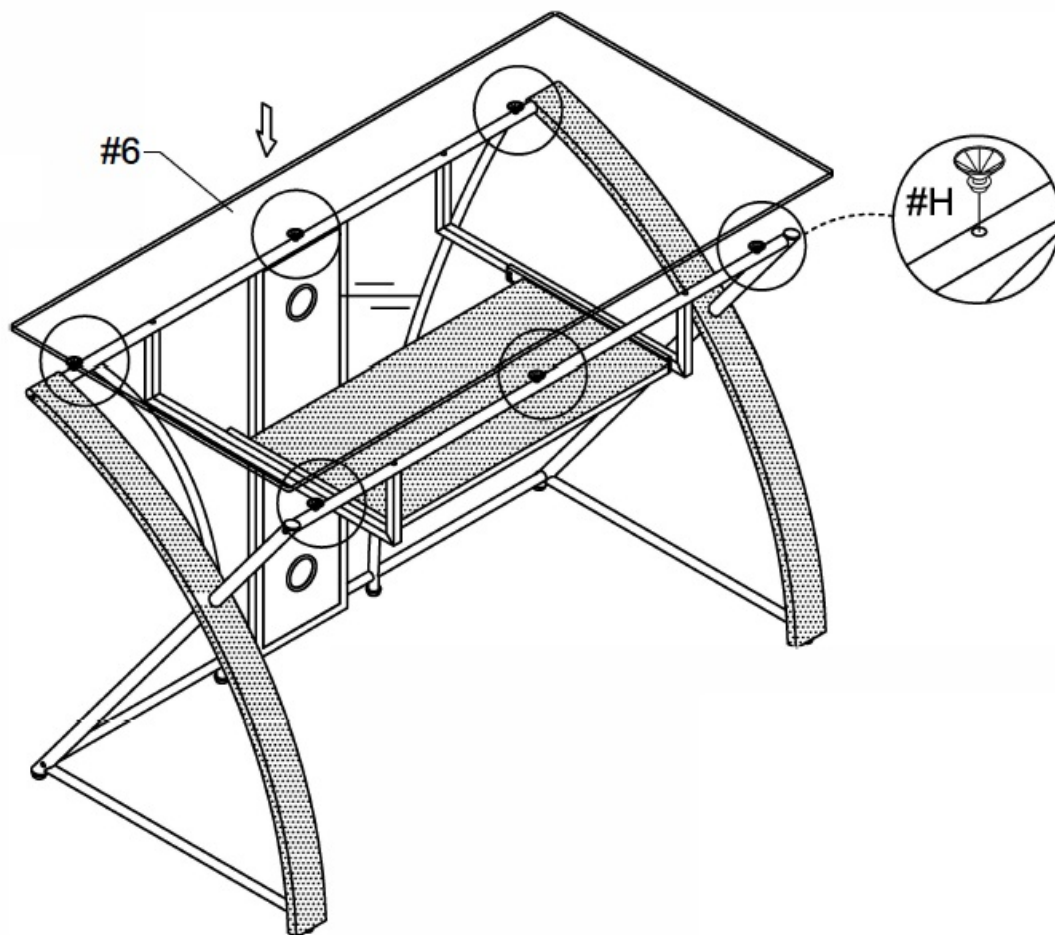

Align the suction cup (#H) to the top of the back panel (#1) and top crossbar (#7), then put the table-top glass (#6) on the suction cups (#H) as shown in the diagram.

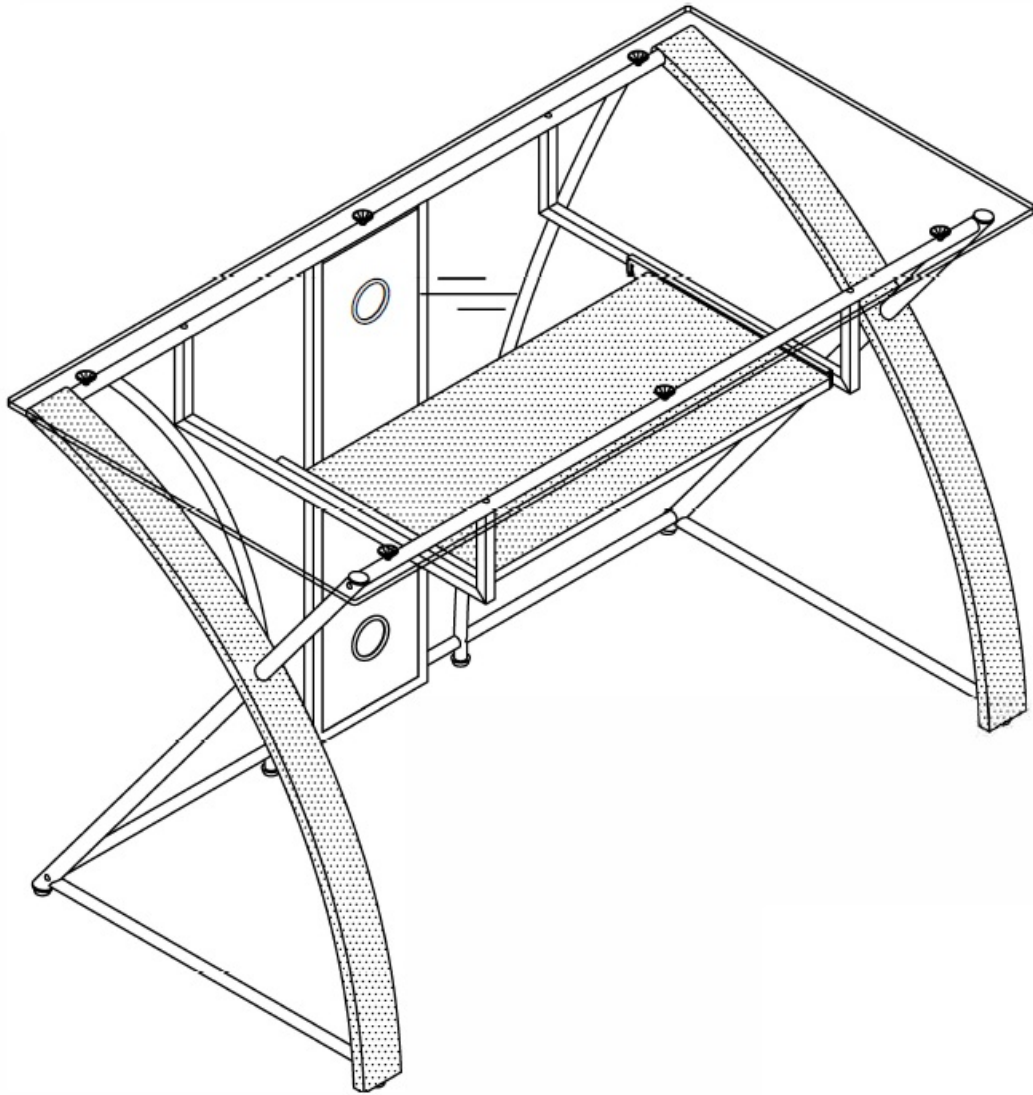

ASSEMBLY COMPLETED

Keep this handy!

Please retain this instruction manual and any order-related information for future reference.

Lift, don't drag!

To avoid damage to a product please always LIFT the product when transporting or adjusting the placement.

Documents / Resources

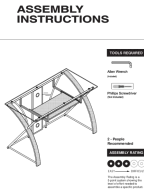
	<p>Benjara BM123639 Transitional Style Computer Desk [pdf] Instruction Manual BM123639 Transitional Style Computer Desk, BM123639, Transitional Style Computer Desk, St yle Computer Desk, Computer Desk, Desk</p>
---	--

References

- [User Manual](#)

[Manuals+](#), [Privacy Policy](#)

This website is an independent publication and is neither affiliated with nor endorsed by any of the trademark owners. The "Bluetooth®" word mark and logos are registered trademarks owned by Bluetooth SIG, Inc. The "Wi-Fi®" word mark and logos are registered trademarks owned by the Wi-Fi Alliance. Any use of these marks on this website does not imply any affiliation with or endorsement.