



BENINCA BOB3024 Automations Swing Gates Instruction Manual

[Home](#) » [BENINCA](#) » BENINCA BOB3024 Automations Swing Gates Instruction Manual 

Contents

- [1 BENINCA BOB3024 Automations Swing Gates](#)
- [2 BOB2124 / BOB2124 E BOB3024 / BOB3024 E](#)
- [3 Dimensions](#)
- [4 EC Declaration of Conformity](#)
- [5 Safety rules](#)
- [6 Maintenance](#)
- [7 Documents / Resources](#)
 - [7.1 References](#)
- [8 Related Posts](#)

BENINCA®

BENINCA BOB3024 Automations Swing Gates



BOB2124 / BOB2124 E BOB3024 / BOB3024 E

Dimensions

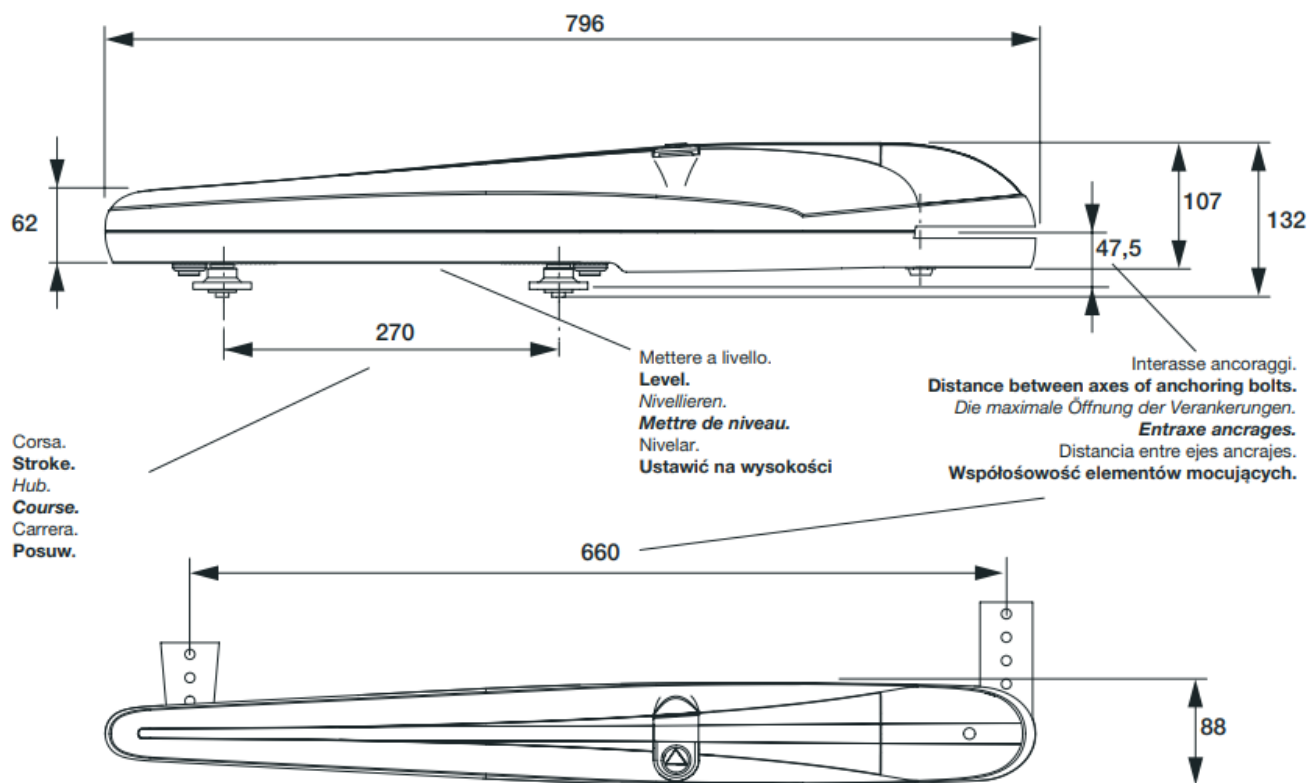

Longueur max. porte

BOB2124 – BOB 2124 E		BOB3024 – BOB 3024 E	
		Door leaf width	Door leaf weight
Longueur porte	Poids porte	Longueur porte	Poids porte
(m)	(kg)	(m)	(kg)
1	300	1,0	400
1,5	250	1,5	350
2	215	2,0	300
2,1	200	2,5	250
—	—	3,0	200

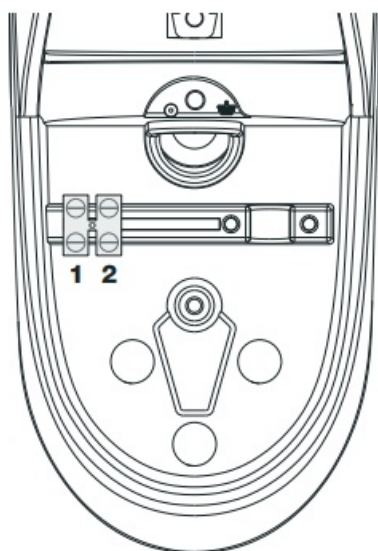

B0B 2124 / B0B 3024

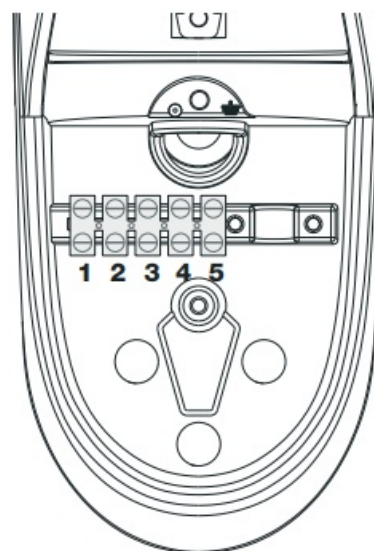

B0B 2124 E / B0B 3024 E

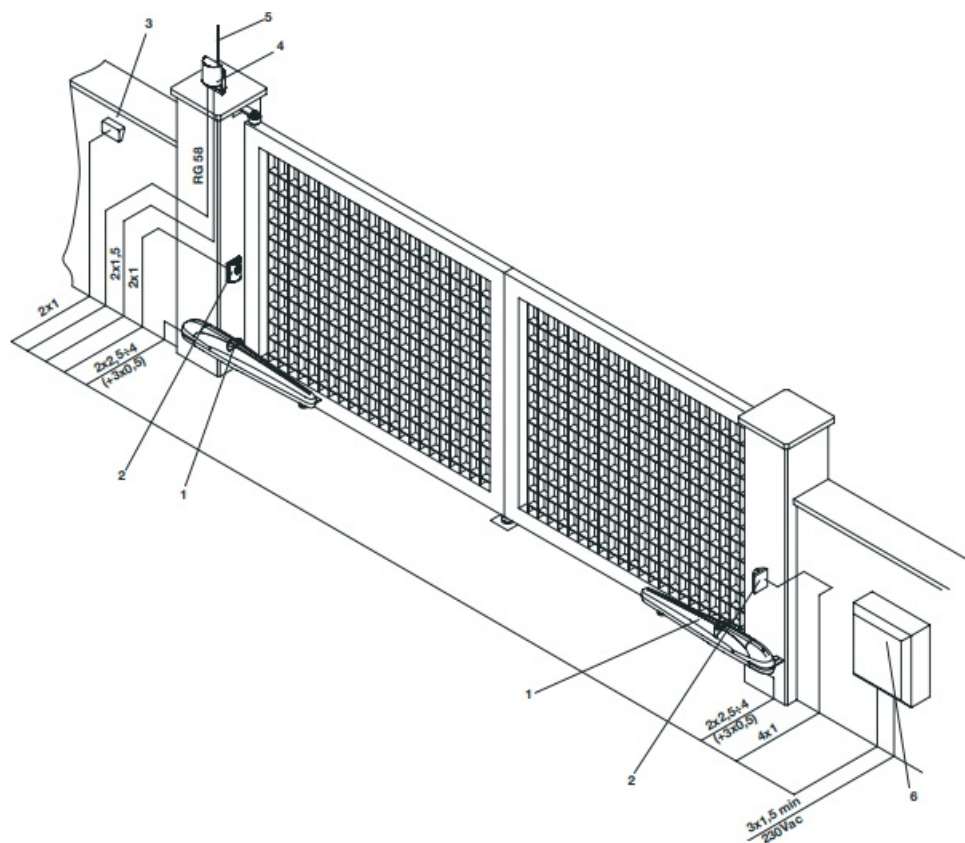

Legends:

1. Moto reducer
2. Photo-electric cells
3. Key selector (external) or digital keyboard
4. Flash-light
5. Antenna
6. Electronic board.

The power cables must be kept separated from the auxiliary cables. For cable length lower than 5m, use a cable

2×2.5sqmm. For cable length from 5 to 10 m use a cable 2x4sqmm. Cables longer than 10m are not recommended to connect control unit and motor.

EC Declaration of Conformity

- **Manufacturer:** SpA.
- **Address:** Via, 45 – 36066 (VI) – Italia
- **Herewith declares that:** the operator for hinged gates model BOB 2124 / BOB2124 E / BOB 3024 / BOB 3024 E is complying with provisions set forth by the following other EC Directive:
- **DIRECTIVE 2004/108/EC OF THE EUROPEAN PARLIAMENT AND OF THE COUNCIL of 15 December 2004,** on the harmonization of the laws of Member States relating to electromagnetic compatibility and which cancels Directive
- **89/336/EEC, according to the following harmonised regulations:** EN 61000-6-2:2005, EN 61000-6-3:2007. Luigi, Legal responsible., 10/03/2011.

WARNING

- The product shall not be used for purposes or in ways other than those for which the product is intended for and as described in this manual. Incorrect uses can damage the product and cause injuries and damages.
- The company shall not be deemed responsible for the non-compliance with a good manufacture technique of gates as well as for any deformation, which might occur during use.
- Keep this manual for further use.
- Qualified personnel, in compliance with regulations in force, shall install the system.
- Packaging must be kept out of reach of children, as it can be hazardous. For disposal, packaging must be divided the various types of waste (e.g. carton board, polystyrene) in compliance with regulations in force.
- The installer must supply all information on the automatic, manual and emergency operation of the automatic system and supply the end user with instructions for use
- An omnipolar switch/section switch with remote contact opening equal to, or higher than 3mm must be provided on the power supply mains.. Make sure that before wiring an adequate differential switch and an overcurrent protection is provided. Pursuant to safety regulations in force, some types of installation require that the gate connection be earthed. During installation, maintenance and repair, cut off power supply before accessing to live parts.
- Descriptions and figures in this manual are not binding. While leaving the essential characteristics of the product unchanged, the manufacturer reserves the right to modify the same under the technical, design or commercial point of view without necessarily update this manual

Introduction

- Before installing the system, read the instruction herein.
- It is mandatory not to use the BOB item for applications different from those indicated in the instructions herein.
- Supply the end user with instructions for using this system.
- The end user should receive special instruction manual.
- All items are covered by an insurance policy for damages and injuries caused by manufacture faults. It is however required that the machine bear the CE marking and original parts be used.

General information

- To ensure a good operation of these automatic devices, the gate to be automated should meet the following requirements:
- good strength and stiffness. – hinges should have a minimum backlash and allow for smooth and regular manual operations.
- when closed, the gate leaves should correctly overlap for their entire height. As the actuator is not supplied with electromagnetic limit switches, it is indispensable to provide mechanical stops on closing and opening on the gate that is to be automated (fig. 1)

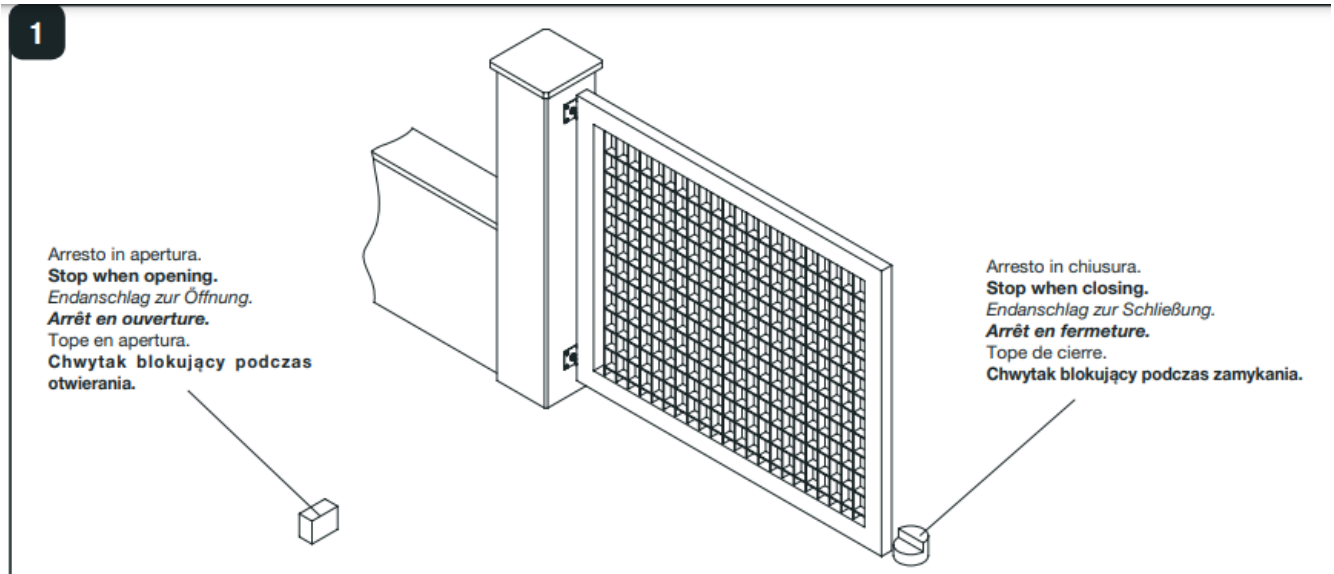

Fitting the automatic system

- Stabilise the height of the automatic system above ground level it should be as central as possible with respect to the gate and corresponding to a sturdy cross piece).
- Then weld the plate P respecting the distances in fig. 2. When the gate is closing, weld the bracket S respecting the distance in fig. 3, onto a cross piece of the gate or another suitably robust element; bear in mind that in this condition the actuator must not be completely at the end of travel.

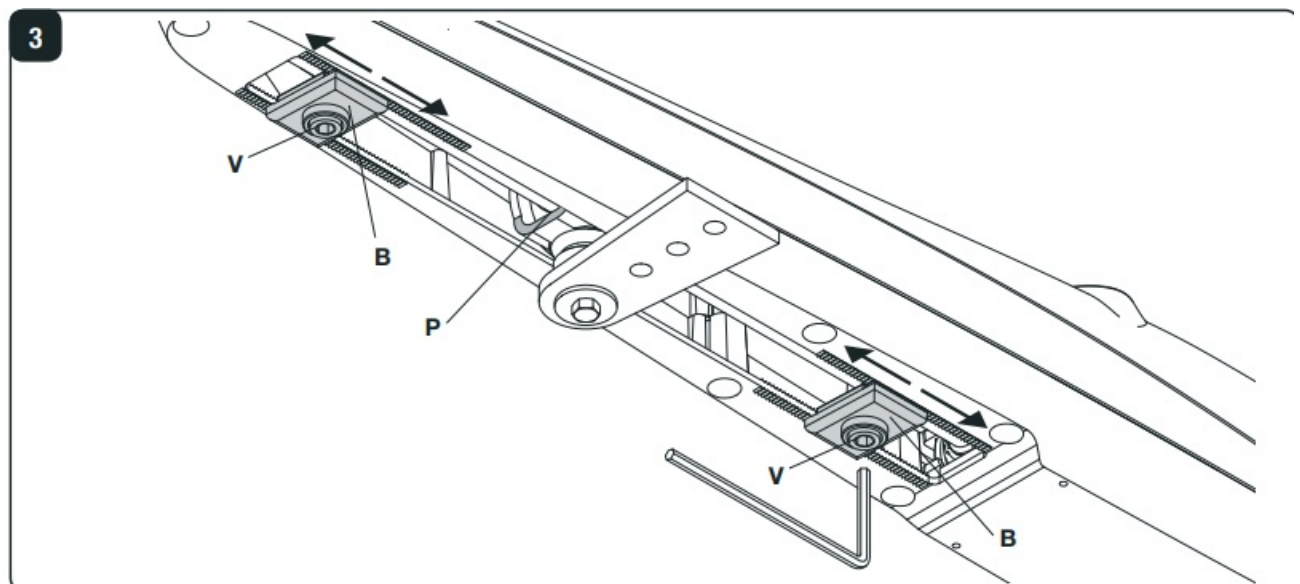

- Remove the protective cover C unscrewing the screw F, then fix the actuator to the plate P with the screw T, the washer L and the nut D (fig. 3). Lastly block the actuator on the plate S with the screw V and the washer R.

- The holes in the actuator (fig.2A) help you respect the optimum installation distances. The adjustable fixing brackets, available on request, allow a wider possibility of adapting the actuator to the different installation conditions, also avoiding cutting and welding the brackets supplied.

How to adjust the mechanical stoppers

The actuator is provided with adjustable mechanical stoppers in the opening and closing phases. The system is adjusted by suitably positioning the “Open” and “Close” mechanical locks, as shown hereunder (Fig.2):

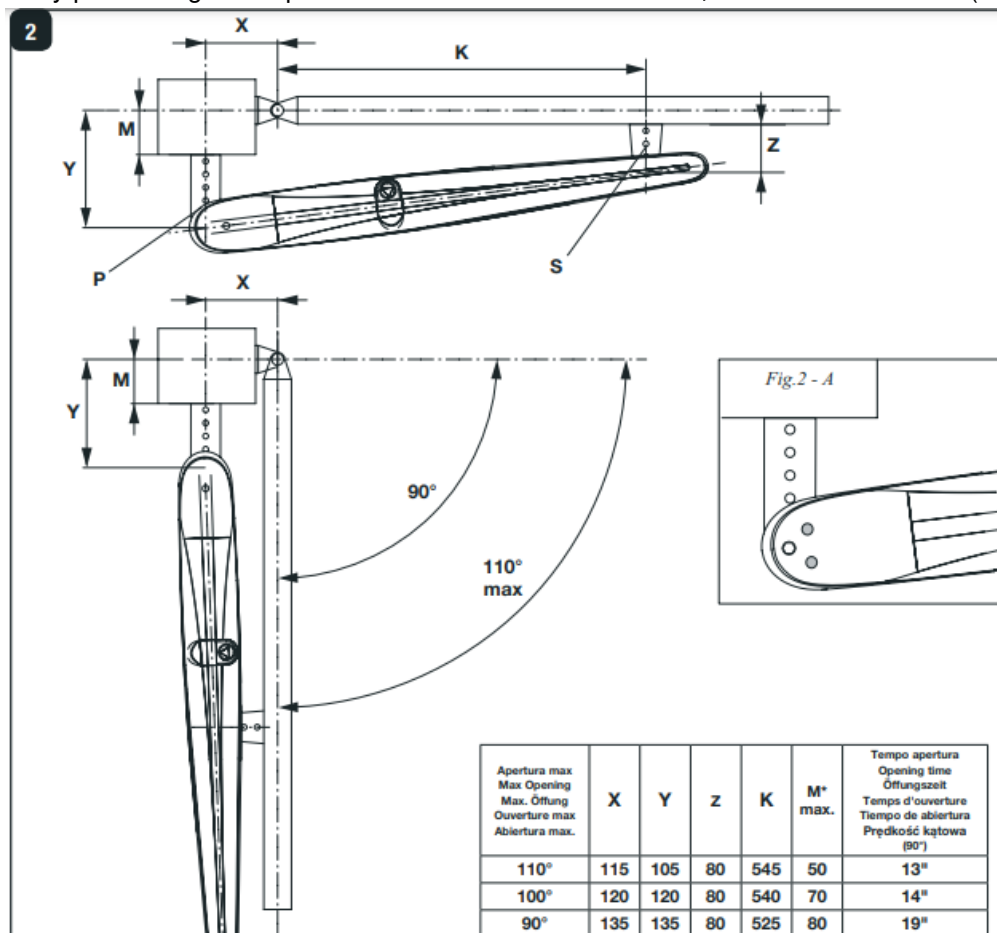

1. Unlock the automatic system by using the special
2. release lever, as shown in the instructions for the user.
3. Close the door/gate leaf.
4. Loosen screws V1 and move the “Close” lock until it reaches the pivot P, then tighten screws V1.
5. Open the door/gate leaf.
6. Loosen screws V2 and move the “Open” lock until it reaches the pivot P, then tighten screws V2.
7. Reset the automatic operating mode.

• Connections

- The special plate P (Fig. 5) allows for using a link for sheath or cable gland PG11, or PG13,5. Once the type of cable gland is applied to the plate, fix the latter to the adaptor cover by means of screws V.

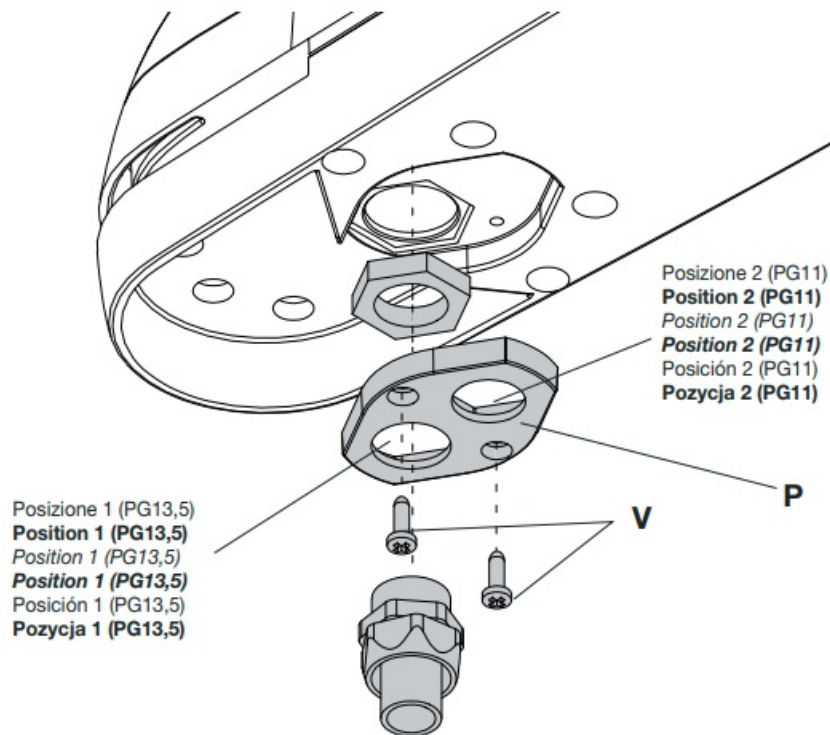

• WARNING

- The insurance policy, which covers any damages or injuries caused by manufacture faults, requires that the installation comply with regulations in force and Benincà original accessories be used.

TECHNICAL DATA	BOB2124	BOB3024
	BOB2124 E	BOB3024 E
Power supply	24Vdc	
Absorbed current	5,5 A	
Thrust	1800 N	
Jogging	Intensiv	
Protection degree	IP44	
Operating temperature	-20°C / +50°C	
Useful stroke:		
- with 2 stoppers	270 mm	
- without stoppers	325 mm	
Noise level	<70 dB	
Lubrication	Permanent grease	
Weight	8,2 kg	8,3 kg

User's handbook

Safety rules

- Do not stand in the movement area of the gate.
- Do not let children play with controls and near the gate.
- Should operating faults occur, do not attempt to repair the fault but call a qualified technician.

Manual and emergency manoeuvre

- In the event of a power cut or breakdown, proceed as follows to operate the wings manually (refer to figures A,B,C):

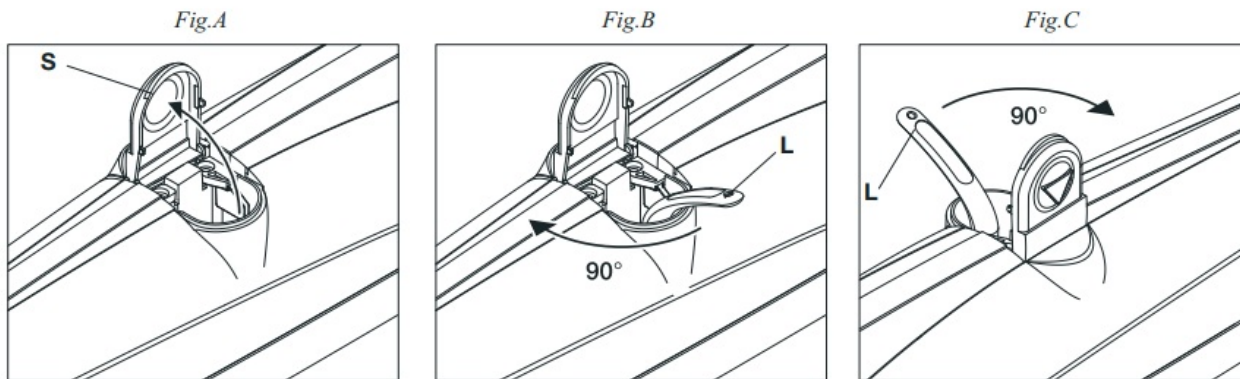

- Open the protective door of the release mechanism (fig. A).
- Insert the special release key supplied and turn it through 90°, as indicated in fig. B for a right actuator or as indicated in fig. C for a left actuator.
- It is now possible to open/close the wing manually.
- To restore automatic operation, return the release key to its initial position.
- Remove the release lever and close the protective door.

Maintenance

- Every month check the good operation of the emergency manual release.
- It is mandatory not to carry out extraordinary maintenance or repairs as accidents may be caused. These operations must be carried out by qualified personnel only.
- The operator is maintenance free but it is necessary to check periodically if the safety devices and the other components of the automation system work properly. Wear and tear of some components could cause dangers.

Waste disposal

As indicated by the symbol shown, it is forbidden to dispose this product as normal urban waste as some parts might be harmful for environment and human health, if they are disposed of incorrectly. Therefore, the device should be disposed in special collection platforms or given back to the reseller if a new and similar device is purchased. An incorrect disposal of the device will result in fines applied to the user, as provided for by regulations in force



Warning

All Benincá products are covered by insurance policy for any possible damages to objects and persons caused by construction faults under condition that the entire system be marked CE and only Benincá parts be used.

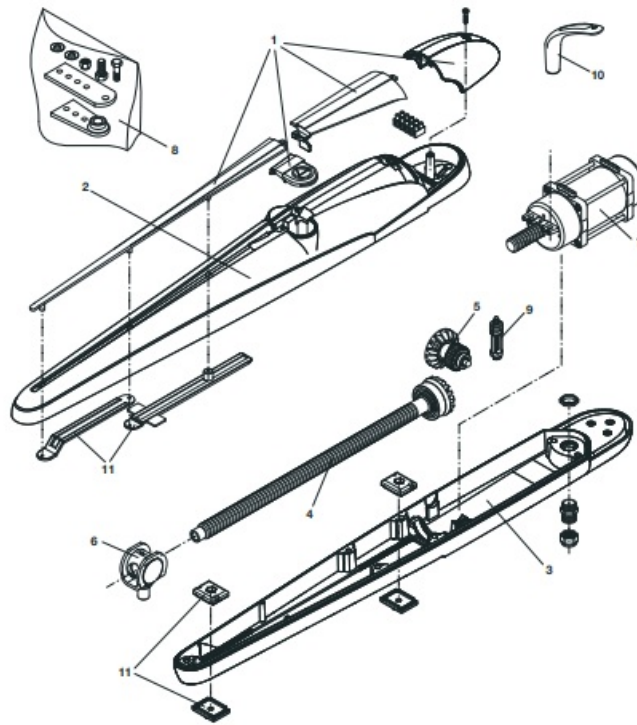

Ref.	BOB 2124 Code	BOB 2124 E Code	BOB 3024 Code	BOB 3024E Code	Note
1	9686868	9686868	9686769	9686769	
2	9686869	9686869	9686869	9686869	
3	9686766	9686766	9686766	9686766	
4	9686871	9686871	9686871	9686871	
5	9686872	9686872	9686872	9686872	
6	9686873	9686873	9686816	9686816	
7	9686881	9686767	9686881	9686767	
8	9686765	9686765	9686765	9686765	
9	9686876	9686876	9686876	9686876	
10	9686877	9686877	9686877	9686877	
11	9686883	9686883	9686883	9686883	

Documents / Resources

<div><div>BOB2124 / BOB2124 E BOB3024 / BOB3024 E</div><div></div><div><div>BENINCA AUTOMATIONS</div><div>CE</div></div></div>	<div>BENINCA BOB3024 Automations Swing Gates [pdf] Instruction Manual</div> <div>BOB3024 Automations Swing Gates, BOB3024, Automations Swing Gates, Swing Gates, Gate S</div>
--	---

References

- [User Manual](#)

Manuals+, Privacy Policy

This website is an independent publication and is neither affiliated with nor endorsed by any of the trademark owners. The "Bluetooth®" word mark and logos are registered trademarks owned by Bluetooth SIG, Inc. The "Wi-Fi®" word mark and logos are registered trademarks owned by the Wi-Fi Alliance. Any use of these marks on this website does not imply any affiliation with or endorsement.