



Bellman BE1521-433 Bridge Transceiver User Manual

[Home](#) » [Bellman](#) » Bellman BE1521-433 Bridge Transceiver User Manual 

The Bellman logo, consisting of the word "Bellman." in white, sans-serif font, centered within a solid red rectangular background.

Contents

- [1 Bellman BE1521-433 Bridge Transceiver User Manual](#)
- [2 Troubleshooting](#)
- [3 Installing the app](#)
- [4 Warranty and Safety Information](#)
- [5 Operating Conditions](#)
- [6 Cleaning](#)
- [7 Service and Support](#)
- [8 Two-Year Limited Warranty](#)
- [9 Documents / Resources](#)
 - [9.1 References](#)
- [10 Related Posts](#)



BE1521-433 Bridge Transceiver

Welcome!

Scan the QR code with your phone to watch the installation video.



About the product

This Bridge Transceiver makes it possible to connect your Visit system to your mobile phone and the line of Bluetooth powered products from Bellman.

What you'll need

A mobile phone with iOS 15 / Android 8 or later if you plan to connect it to your Visit system.

What's in the box

- | | |
|----------------------|-----------------|
| 1 Bridge Transceiver | 3 Power cable |
| 2 Screw and plug | 4 Power adapter |



1

Getting started

1. Prepare

Pull the battery tab to start the bridge.

The top indicator breathes in blue to show that it is ready for pairing.



2. Pair

- To pair the bridge with your mobile phone, follow the steps on p 5.
- To pair with a Bluetooth device from Bellman, follow the steps in the product's user manual. Then, hold down the bridge **top** test button to initiate pairing.



3. Position

To optimize coverage, select a central position in the house.

Connect the power adapter and mount it on the wall using the supplied screw and plug.



2

Finishing up

4. Test the connection

To your Visit system

- Press the **bottom** test button on the bridge. The bottom LED lights up in green to show that a signal is being transmitted.
- The yellow Visit LED on your receiver lights up and it starts to sound, flash or vibrate depending on the type of receiver.



Done!

Need help?

If the bridge fails to generate a notification on your receiver, you need to adjust the bridge's radio key to match your system's radio key. The radio switches are located under the front cover.

- Remove the front lid on one of the transmitters to see your current radio key settings. They are marked with the symbol **RADIO** and a radio icon.
- Remove the front lid on your bridge, set the radio key switches to the same position and put the lid back on. Test the connection by pressing the bottom test button on the bridge.

Troubleshooting

If	Try this
The bottom LED blinks in green every minute	<ul style="list-style-type: none">■ It means that the bridge is running on backup battery.■ Check that the power cord is connected to mains.
The bottom LED blinks in green	<ul style="list-style-type: none">■ It means that the backup batteries are not detected.■ Insert batteries and make sure they are positioned correctly.
The bottom LED blinks in amber every 30s	<ul style="list-style-type: none">■ It means that the backup batteries are running low.■ Remove the front lid and replace them with two fresh 1.5V AA batteries. Put the lid back on.
The bottom LED blinks in red every 15s	<ul style="list-style-type: none">■ It means that the backup batteries are almost depleted.■ Remove the front lid and replace them with two fresh 1.5V AA batteries. Put the lid back on.

Unpairing your bridge

If you want to use the bridge in another system, you need to unpair it from your current system.

1. Hold down both buttons for at least 6s. The top LED will start to blink rapidly in purple.
2. Release the buttons and hold down the top button for 3s to confirm. The top and bottom LED lights up.
3. Remove the power adapter and batteries to restart.

Installing the app

1. Turn on Bluetooth®

Swipe down from the top of the screen and tap the Bluetooth icon to turn it on.



2. Install the app



Download the **Bellman Assistant** app from the App Store® or Google Play™ and follow the setup instructions.



Warranty and Safety Information

This booklet guides you on how to use and maintain your Bridge Transceiver. Ensure you read it carefully, including the Safety and Handling section. If you have additional questions, contact your point of purchase for further assistance.

Safety and Handling

Failure to follow these instructions could result in fire, electric shock, or other injury or damage to the device or other property.

- Keep this device out of reach of children under 3 years.

- Note that notifications can be missed if batteries run out.
- This product uses Alkaline batteries as power backup.
Do not expose the batteries to fire or to direct sunlight.
Only use 1.5 V AA alkaline batteries.
- This device is designed for indoor use only. Do not expose the device to moisture.
- Protect the device from shocks during storage and transport.
- This equipment generates, uses and can radiate radio frequency energy and, if not installed and used in accordance with the user guide, may cause harmful interference to radio communication.
- Do not use or store this device near any heat sources such as flames, radiators, ovens or other devices that produce heat.
- Do not dismantle the device; there is a risk of electric shock. Tampering with or dismantling the device will void warranty.
- Protect cables from any potential source of damage.
- Do not make any changes or modifications to this device. Use only power adapters and accessories that are specified in the user guide.
- Batteries are toxic. Do not swallow them! Keep out of reach of children and pets. If they are swallowed, consult your physician immediately!
- Do not expose batteries to fire or to direct sunlight.
- Do not drop your device. Dropping onto a hard surface can damage it.
- Do not install the device in areas where electronic equipment is prohibited.
- The device may only be repaired by an authorized service center.

No company, enterprise or user is allowed to change the frequency, enhance the transmitting power or alter the original characteristics or performance on an approved low power radio frequency device.

Operating Conditions

Operate the device in a dry environment within the temperature and humidity limits stated in this leaflet. If the product gets wet or is exposed to moisture, it should no longer be regarded as reliable and should therefore be replaced.

Cleaning

Disconnect all cables before you clean your device. Use a soft, lint-free cloth. Avoid getting moisture in openings. Do not use household cleaners, aerosol sprays, solvents, alcohol, ammonia, abrasives or compressed air.

Service and Support

If the device appears to be damaged or doesn't function properly, follow the instructions in the user guide. If the product still doesn't function as intended, contact an authorized service center for information on service and warranty.

Two-Year Limited Warranty

The company guarantees this product for two (2) years from date of purchase against any defects that are due to faulty materials or workmanship. This guarantee only applies to normal conditions of use and service, and does not include damage resulting from accident, neglect, misuse, unauthorized dismantling, or contamination howsoever caused. This guarantee excludes incidental and consequential damage. Furthermore, the warranty does not cover Acts of God, such as fire, flood, hurricanes and tornadoes.

This warranty gives you specific legal rights and you may also have other rights that vary with territory. Some countries or jurisdictions do not allow the limitation or exclusion of incidental or consequential damages, or limitations on how long an implied warranty lasts, so the above limitation may not apply to you. This guarantee is in addition to your statutory rights as a consumer. The above warranty may not be altered except in writing signed by both parties hereto.

For Australian Consumers: Our goods come with guarantees that cannot be excluded under the Australian Consumer Law. BE1521_

You are entitled to a replacement or refund for a major failure and for compensation for any other reasonably foreseeable loss or damage. You are also entitled to have the goods repaired or replaced if the goods fail to be of acceptable quality and the failure does not amount to a major failure.



Documents / Resources

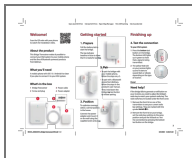

[Bellman BE1521-433 Bridge Transceiver](#) [pdf] User Manual

BE1521, 2APAKBE1521, BE1521-433 Bridge Transceiver, BE1521-433, Bridge Transceiver, Transceiver

References

- [Bellman & Symfon | Start](#)
- [User Manual](#)

[Manuals+](#), [Privacy Policy](#)

This website is an independent publication and is neither affiliated with nor endorsed by any of the trademark owners. The "Bluetooth®" word mark and logos are registered trademarks owned by Bluetooth SIG, Inc. The "Wi-Fi®" word mark and logos are registered trademarks owned by the Wi-Fi Alliance. Any use of these marks on this website does not imply any affiliation with or endorsement.