



# behringer ULM202USB High-Performance 2.4 GHz Digital Wireless System User Guide

[Home](#) » [Behringer](#) » behringer ULM202USB High-Performance 2.4 GHz Digital Wireless System User Guide 



## Quick Start Guide



## ULTRALINK ULM202USB/ULM200USB

High-Performance 2.4 GHz Digital Wireless System with 2 Handheld Microphones and Dual-Mode USB Receiver

### Contents

- 1 ULM202USB/ULM200USB Hook-Up
- 2 ULM200USB/ULM202USB Getting Started
- 3 Specification
- 4 LIMITED WARRANTY
- 5 Documents / Resources
  - 5.1 References
- 6 Related Posts

### ULM202USB/ULM200USB Hook-Up

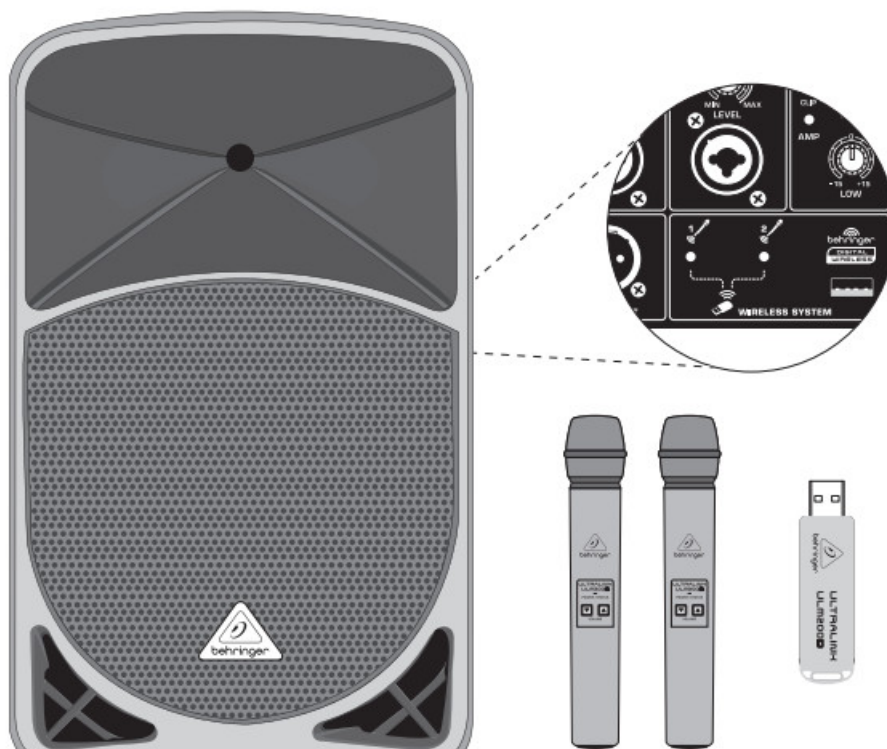
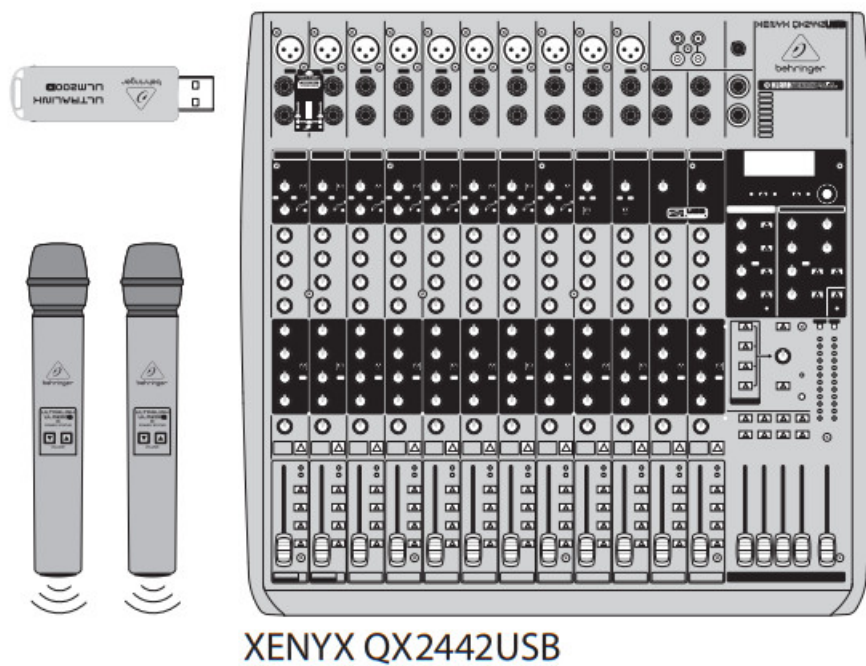

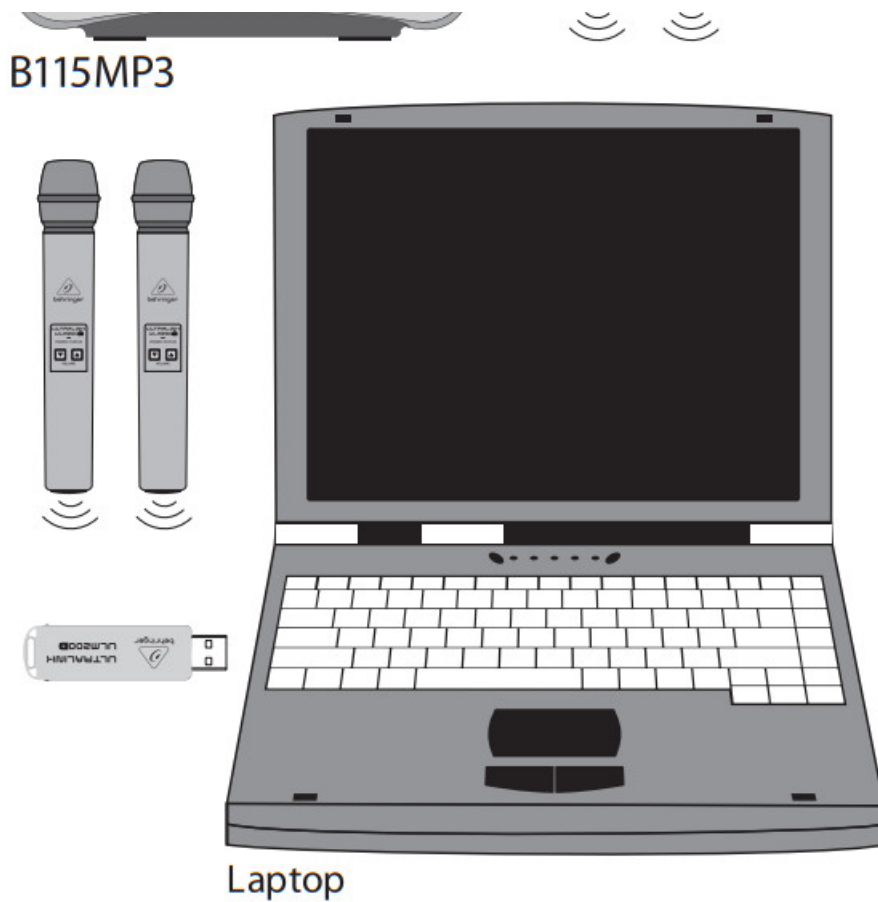

#### ULM202USB/ULM200USB Controls

Model: ULM200M

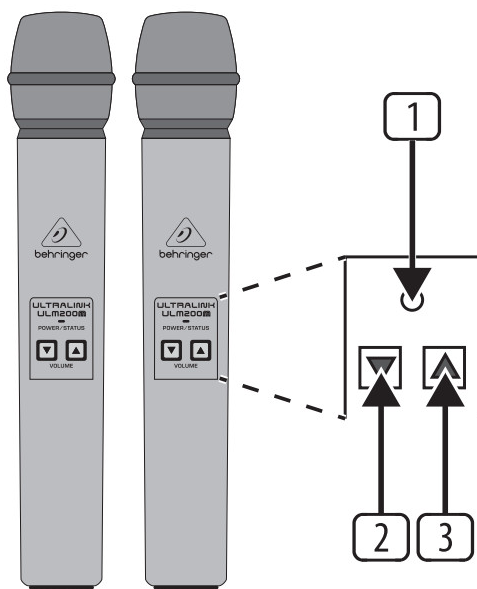

Model: ULM200D

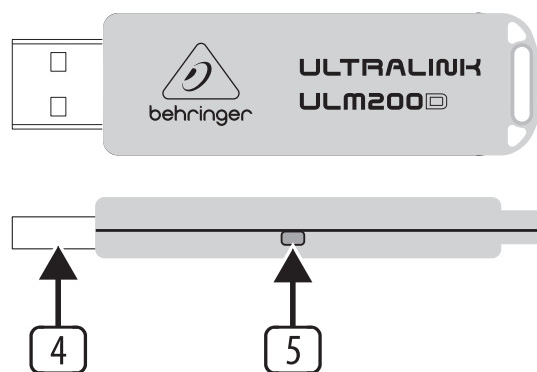

Type of product: Wireless Microphone  
ULM200USB/ULM202USB Controls

1. **POWER/STATUS** LED
2. **▼ VOLUME** Button (Mute/volume down)
3. **▲ VOLUME** Button (Power on/unmute/volume up)
4. USB connector

## 5. Wireless Link Status LED

### ULM200USB/ULM202USB Getting Started

1. Connect the ULM200D wireless receiver to the "WIRELESS ONLY!" The USB connector on wireless-enabled Behringer mixers, powered speakers, or other compatible products, or to a USB port on a computer.
2. Press and hold the ▲ button on the ULM200M wireless microphone to connect wirelessly to the ULM200D receiver. The LED on the microphone will flash slowly during the connecting sequence and will light solid once connected.

If the ULM200M wireless microphone cannot connect to a receiver, the microphone will automatically power down after 10 seconds.

3. Once connected, the ULM200M microphone will be set at a medium volume. Use the ▲ and ▼ buttons to adjust the volume
4. A long press of the ▼ button will put the ULM200M microphone into mute. The mute condition is indicated by the rapid flashing of the LED. If the user does not unmute within 60 seconds, the ULM200M microphone will power down to save battery life.
5. A short press of the ▲ button will unmute the ULM200M microphone. If the ULM200M microphone is unmuted more than 10 seconds after muting, it will return to the previous volume level, if unmuted after less than 10 seconds it will be set to the minimum volume level.
6. Unplug the ULM200D wireless receiver to power down. The ULM200M wireless microphone will power down 10 seconds after the ULM200D wireless receiver is unplugged.
7. The LED in the ULM200M wireless microphone will indicate when the battery is low by regular brief flashes.
8. Should the ULM200M wireless microphone become unpaired with the ULM200D wireless receiver, the microphone can be re-paired from the powered down state by simultaneously pressing the ▲ and ▼ buttons and moving the microphone to within 10 cm (4 inches) of the ULM200D wireless receiver. The LED on the microphone will flash slowly during the pairing sequence and will light solid once connected. If the ULM200M wireless microphone cannot pair to the receiver it will automatically power down after 10 seconds.

### Specification

RF output	<20 dBm (100 mW)
Operating range	120 m (Line of Sight)*
Dynamic range	92 dB, A-weighted**
Equivalent input noise	-112 dBu
Frequency Response (Wireless Link)	20 Hz – 20 kHz, $\pm 1$ dB**
Sampling rate	48 kHz
Resolution	24-bit
Encoding	232 kbps SLAC (Slightly Loss' Audio Codec)
Latency	14.5 ms
RF frequency I	2.4 GHz ISM band (2406 MHz – 2474 MHz), 18 channels
USB current consumption	70 mA @ 5 VDC
Battery type	2 x AA (LR6) Alkaline cells
Battery life	30 hours
Dimensions (W x D x H)	45.7 x 45.7 x 243.8 mm (1.8 x 1.8 x 9.6")
Weight	
ULM200USB	0.2 kg (0.4 lbs)
ULM202USB	0.4 kg (0.9 lbs)

\*Achievable range will be dependent on nearby sources of RF interference and/or line of sight obstacles.

\*\*Measured from analog input to analog output, unity gains operation without wireless compression.

## LEGAL DISCLAIMER

Music Tribe accepts no liability for any loss which may be suffered by any person who relies either wholly on or in part upon any description, photograph, or statement contained herein. Technical specifications, appearances, and other information are subject to change without notice. All trademarks are the property of their respective owners. Midas, Klark Teknik, Lab Gruppen, Lake, Tannoy, Turbosound, TC Electronic, TC Helicon, Behringer, Bugera, Oberheim, Auratone, Aston Microphones, and Coolaudio are trademarks or registered trademarks of Music Tribe Global Brands Ltd. © Music Tribe Global Brands Ltd. 2021 All rights reserved.

## LIMITED WARRANTY

For the applicable warranty terms and conditions and additional information regarding Music Tribe's Limited Warranty, please see complete details online at [musictribe.com/warranty](https://musictribe.com/warranty).

## FEDERAL COMMUNICATIONS COMMISSION COMPLIANCE INFORMATION

**Behringer**

**ULTRALINK ULM202USB/ULM200USB**

<b>Responsible Party Name:</b>	Music Tribe Commercial NV Inc.
<b>Address:</b>	5270 Procyon Street, Las Vegas NV 89118, United States
<b>Phone Number:</b>	+1 702 800 8290

**FCC ID: QWHULM200D01, QWHULM200M01  
ULTRALINK ULM202USB/ULM200USB**

This equipment has been tested and found to comply with the limits for a Class B digital device, pursuant to part 15 of the FCC Rules. These limits are designed to provide reasonable protection against harmful interference in a residential installation. This equipment generates, uses, and can radiate radio frequency energy and, if not installed and used in accordance with the instructions, may cause harmful interference to radio communications. However, there is no guarantee that interference will not occur in a particular installation. If this equipment does cause harmful interference to radio or television reception, which can be determined by turning the equipment off and on, the user is encouraged to try to correct the interference by one or more of the following measures:

- Reorient or relocate the receiving antenna.
- Increase the separation between the equipment and receiver.
- Connect the equipment into an outlet on a circuit different from that to which the receiver is connected.
- Consult the dealer or an experienced radio/TV technician for help.

**This device complies with Part 15 of the FCC rules. Operation is subject to the following two conditions:**

1. this device may not cause harmful interference, and
2. this device must accept any interference received, including interference that may cause undesired operation.

**Important information:**

Changes or modifications to the equipment not expressly approved by Music

The tribe can void the user's authority to use the equipment.

This equipment complies with FCC RF radiation exposure limits set forth for an uncontrolled environment.



Hereby, Music Tribe declares that this product is in compliance with Directive 2014/53/EU, Directive 2014/30/EU, Directive 2014/35/EU, Directive 2011/65/EU and Amendment 2015/863/EU, Directive 2012/19/EU, Regulation 519/2012 REACH SVHC and Directive 1907/2006/EC.



The full text of the EU DoC is available at <https://community.musictribe.com/>

EU Representative: Music Tribe Brands DK A/S

**Address:** Ib Spang Olsens Gade 17, DK – 8200 Aarhus N, Denmark



**Documents / Resources**

<div><div>Quick Start Guide</div><div><div>ULMALINK ULM202USB/U, M200USB High-Performance 2.4 GHz Digital Wireless System with 2 Handheld Microphones and Dual Mode USB Receiver</div></div><div><div>EN</div><div>ES</div><div>FR</div><div>DE</div><div>PT</div><div>IT</div><div>NL</div><div>SE</div><div>PL</div></div><div><div>101</div><div></div></div></div>	<div><div><a href="#">behringer ULM202USB High-Performance 2.4 GHz Digital Wireless System</a> [pdf] User Guide</div><div>e</div><div>ULM202USB, ULM200USB, ULM202USB High-Performance 2.4 GHz Digital Wireless System, ULM202USB, High-Performance 2.4 GHz Digital Wireless System</div></div>
--	---

References

-  [Music Tribe](#)