



# behringer Automatic and Ultra-Fast Feedback Destroyer Parametric EQ with 24 FBQ Filters User Guide

[Home](#) » [Behringer](#) » behringer Automatic and Ultra-Fast Feedback Destroyer Parametric EQ with 24 FBQ Filters User Guide

## Quick Start Guide



## FEEDBACK DESTROYER FBQ1000

Automatic and Ultra-Fast Feedback Destroyer/Parametric EQ with 24 FBQ Filters

### Contents [ [hide](#) ]

- [1 Important Safety Instructions](#)
- [2 FEEDBACK DESTROYER FBQ1000 Hook-up](#)
- [3 FEEDBACK DESTROYER FBQ1000 Controls](#)
- [4 FEEDBACK DESTROYER FBQ1000 Controls](#)
- [5 FEEDBACK DESTROYER FBQ1000 Controls](#)
- [6 FEEDBACK DESTROYER FBQ1000 Controls](#)
- [7 FEEDBACK DESTROYER FBQ1000 Getting started](#)
- [8 FEEDBACK DESTROYER FBQ1000 Preset chart](#)
- [9 Specifications](#)
- [10 Documents / Resources](#)
  - [10.1 References](#)
- [11 Related Posts](#)



## Important Safety Instructions





Terminals marked with this symbol carry an electrical current of sufficient magnitude to constitute a risk of electric shock. Use only high-quality professional speaker cables with ¼" TS or twist-locking plugs pre-installed. All other installation or modifications should be performed only by qualified personnel.



This symbol, wherever it appears, alerts you to the presence of uninsulated dangerous voltage inside the enclosure – voltage that may be sufficient to constitute a risk of shock.



This symbol, wherever it appears, alerts you to important operating and maintenance instructions in the accompanying literature. Please read the manual. Caution To reduce the risk of electric shock, do not remove the top cover (or the rear section). No user-serviceable parts inside. Refer servicing to qualified personnel.



#### **Caution**

To reduce the risk of fire or electric shock, do not expose this appliance to rain and moisture. The apparatus shall not be exposed to dripping or splashing liquids and no objects filled with liquids, such as vases, shall be placed on the apparatus.



#### **Caution**

These service instructions are for use by qualified service personnel only. To reduce the risk of electric shock do not perform any servicing other than that contained in the operation instructions. Repairs have to be performed by qualified service personnel.

1. Read these instructions.
2. Keep these instructions.
3. Heed all warnings.
4. Follow all instructions.
5. Do not use this apparatus near water.
6. Clean only with dry cloth.
7. Do not block any ventilation openings. Install in accordance with the manufacturer's instructions.
8. Do not install near any heat sources such as radiators, heat registers, stoves, or other apparatus (including amplifiers) that produce heat.
9. Do not defeat the safety purpose of the polarized or grounding-type plug. A polarized plug has two blades with one wider than the other. A grounding-type plug has two blades and a third grounding prong. The wide blade or the third prong are provided for your safety. If provided plug does not fit into your outlet, consult an electrician for replacement of the obsolete outlet.
10. Protect the power cord from being walked on or pinched particularly at plugs, convenience receptacles, and the point where they exit from the apparatus.
11. Use only attachments/accessories specified by the manufacturer.
12. Use only with the cart, stand, tripod, bracket or table specified by the manufacturer, or sold with the apparatus.  
When a car is used, use caution when moving the cart/apparatus combination to avoid injury from tip-over.
13. Unplug this apparatus during lightning storms or when unused for long periods of time.
14. Refer all servicing to qualified service personnel. Servicing is required when the apparatus has been damaged in any way, such as power supply cord or plug is damaged, liquid has been spilled or objects have fallen into the apparatus, the apparatus has been exposed to rain or moisture, does not operate normally, or has been dropped.



15. The apparatus shall be connected to a MAINS socket outlet with a protective earthing connection.
16. Where the MAINS plug or an appliance coupler is used as the disconnect device, the disconnect device shall remain readily operable.
17. Correct disposal of this product: This symbol indicates that this product must not be disposed of with household waste, according to the WEEE Directive (2012/19/EU) and your national law. This product should be taken to a collection center licensed for the recycling of waste electrical and electronic equipment (EEE). The mishandling of this type of waste could have a possible negative impact on the environment and human health due to potentially hazardous substances that are generally associated with EEE. At the same time, your cooperation in the correct disposal of this product will contribute to the efficient use of natural resources. For more information about where you can take your waste equipment for recycling, please contact your local city office or your household waste collection service.
18. Do not install in a confined space, such as a bookcase or similar unit.
19. Do not place naked flame sources, such as lighted candles, on the apparatus.
20. Please keep the environmental aspects of battery disposal in mind. Batteries must be disposed of at a battery collection point. This apparatus may be used in tropical and moderate climates up to 45°C.



#### **LEGAL DISCLAIMER**

Music Tribe accepts no liability for any loss which may be suffered by any person who relies either wholly on or in part upon any description, photograph, or statement contained herein. Technical specifications, appearances, and other information are subject to change without notice. All trademarks are the property of their respective owners. Midas, Klark Teknik, Lab Gruppen, Lake, Tannoy, Turbosound, TC Electronic, TC Helicon, Behringer, Bugera, Oberheim, Auratone, and Coolaudio are trademarks or registered trademarks of Music Tribe Global Brands Ltd. © Music Tribe Global Brands Ltd. 2021 All rights reserved.

#### **LIMITED WARRANTY**

For the applicable warranty terms and conditions and additional information regarding Music Tribe's Limited Warranty, please see complete details online at [musictribe.com/warranty](https://musictribe.com/warranty).

## **FEEDBACK DESTROYER FBQ1000 Hook-up**

### **Step 1: Hook-Up**

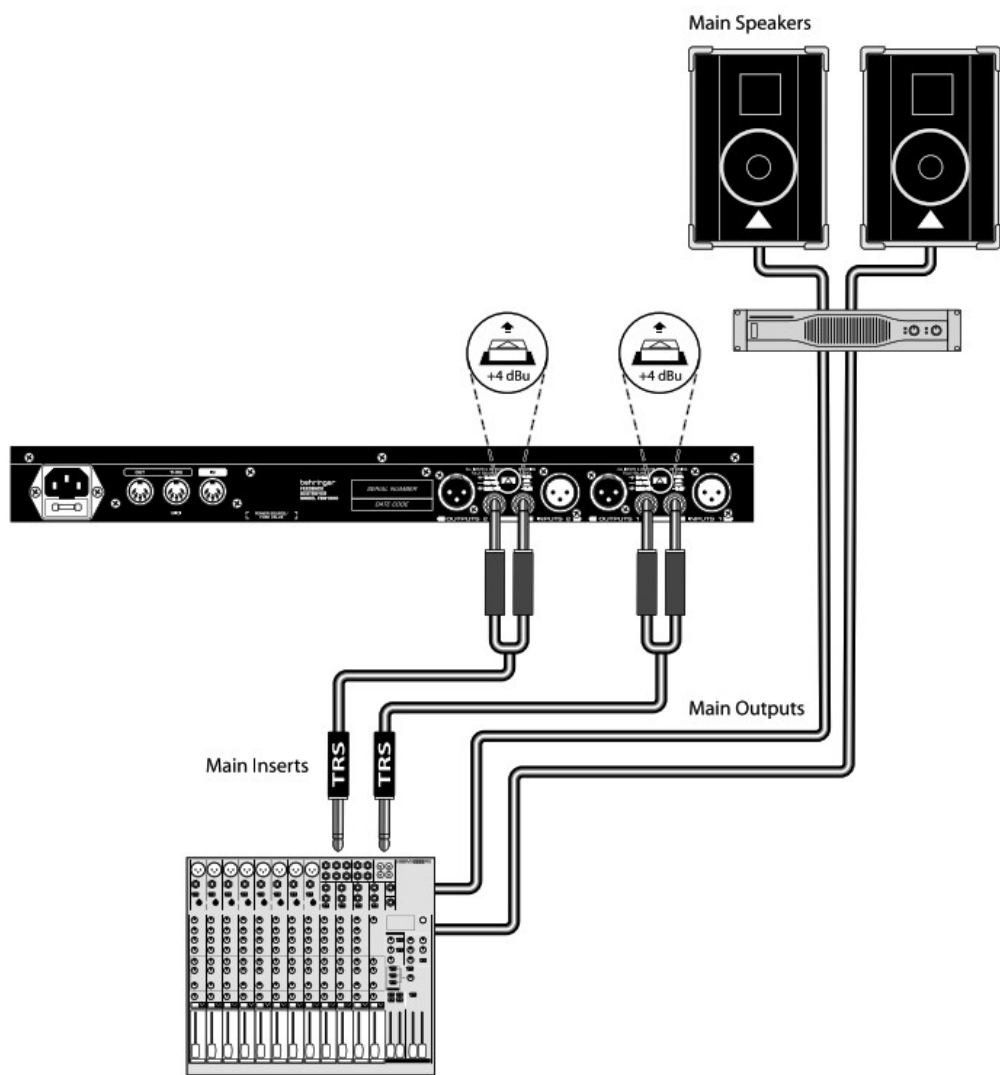

FBQ1000 in the insert path

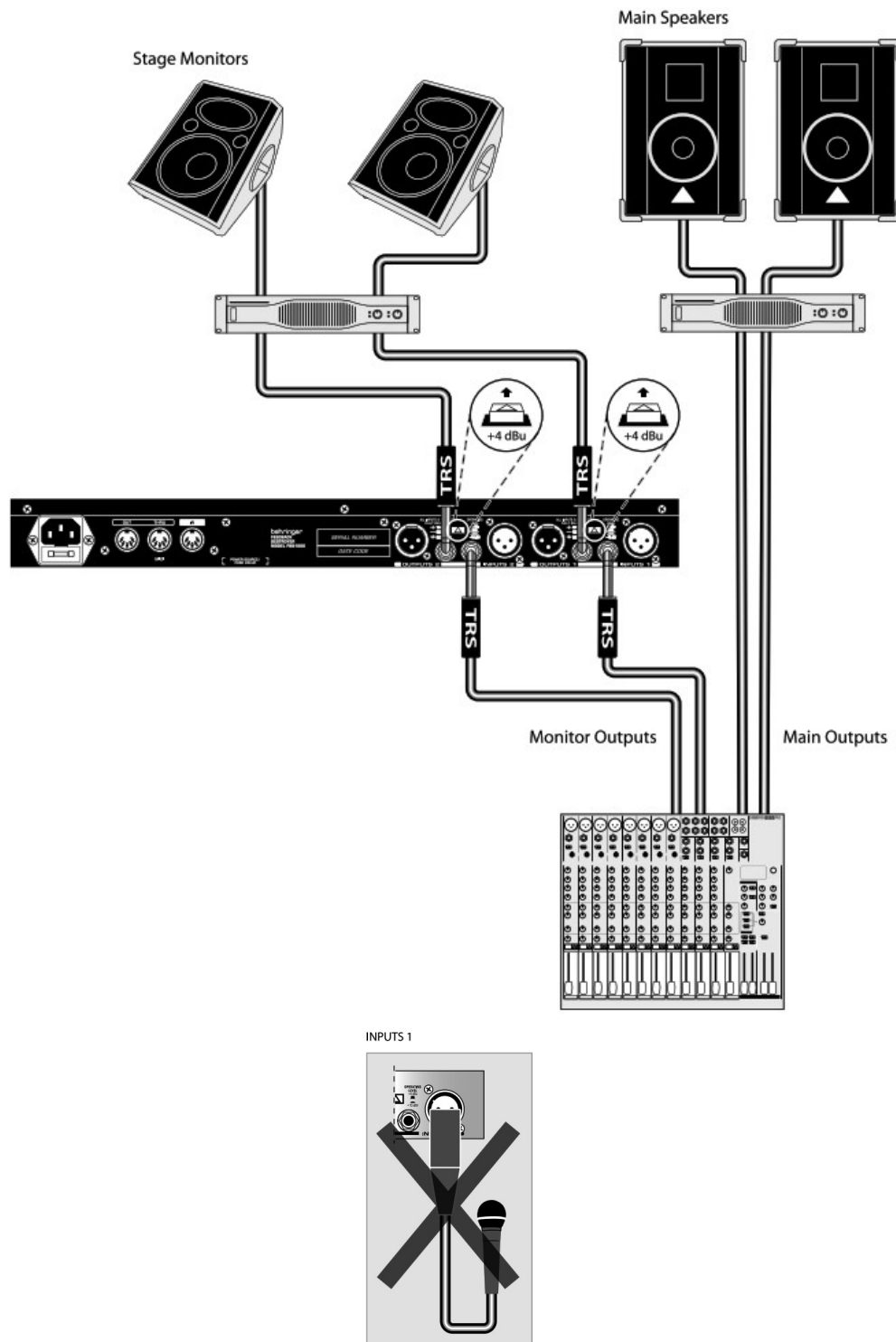

Feedback protection for stage monitors

## FEEDBACK DESTROYER FBQ1000 Controls

### Step 2: Controls

**LED METER** displays the output signal level. If the CLIP LED lights frequently, lower the gain setting for the channel. In Total Bypass mode, the LED METER displays the input signal level.

**STATUS LEDs** display the status of the 12 individual filters for each channel. Active filters or EQs are displayed by a lit LED. A flashing LED signifies that a filter is searching for feedback frequencies. Inactive filters are

displayed by an unlit LED.

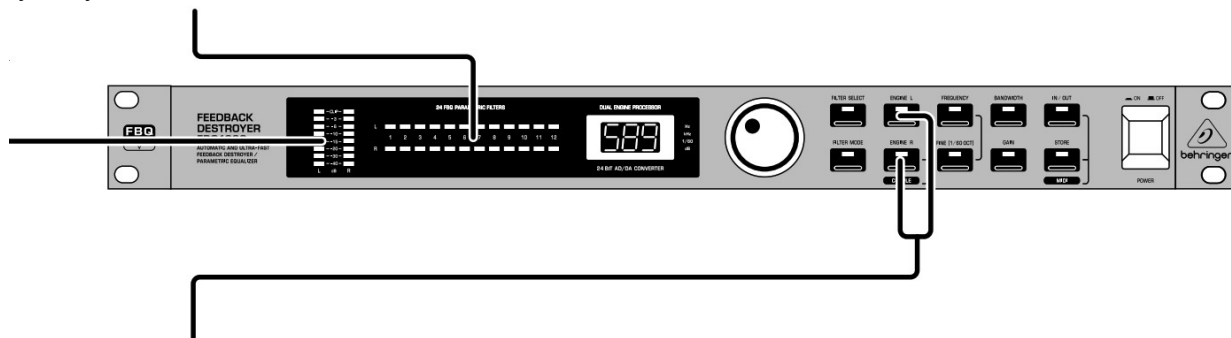

**ENGINE L** and **R** buttons select the left (L) and right (R) audio channels. Press both buttons simultaneously to enter Couple mode, which allows both channels to be edited at the same time.

## FEEDBACK DESTROYER FBQ1000 Controls

### Step 2: Controls

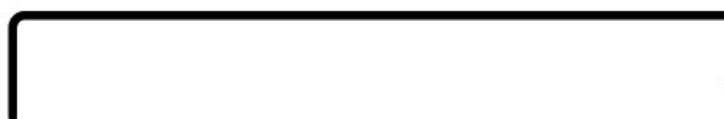

#### **FILTER MODE** button

accesses the four filter modes: Off (OF), Parametric EQ (PA), Single-Shot (SI), and Auto (AU).

**JOG WHEEL** scrolls through presets and adjusts parameter values.

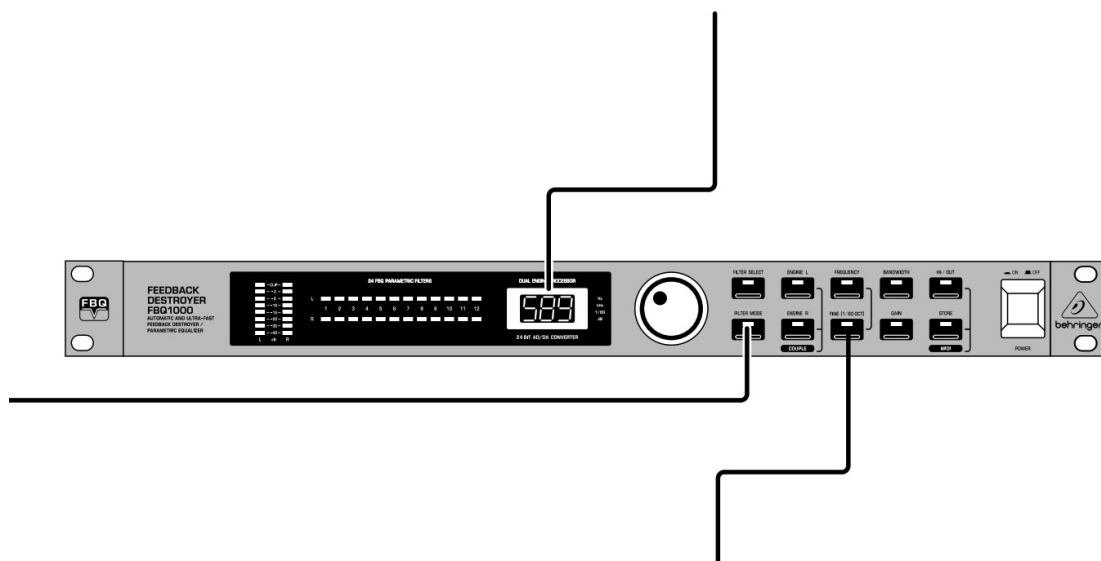

**FINE** button enables the JOG WHEEL to fine-tune the standard ISO frequencies.

## FEEDBACK DESTROYER FBQ1000 Controls

### Step 2: Controls



**FREQUENCY** button enables the JOG WHEEL to select the frequency that is to be edited in Parametric EQ mode.

**BANDWIDTH** button enables the JOG WHEEL to adjust the filter bandwidth (Q factor) of the selected filter.

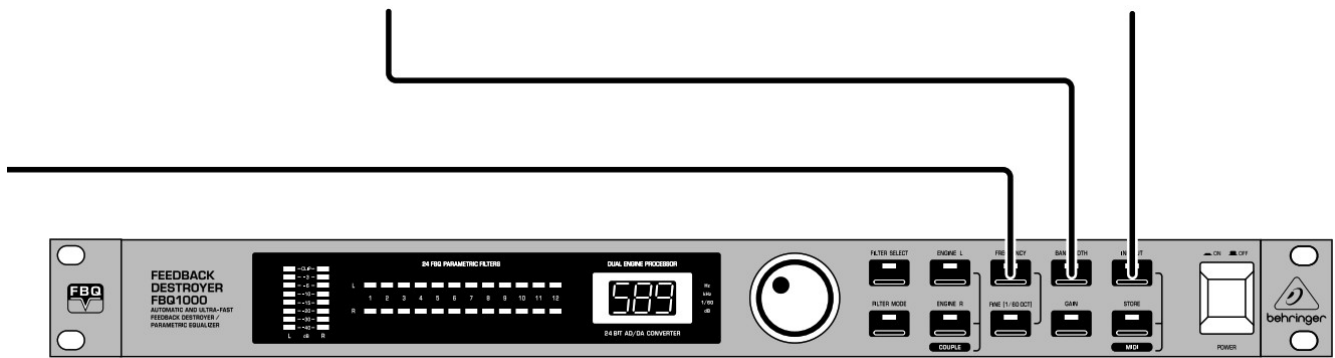

**OPERATING LEVEL** button switches between -10 dBV and +4 dBu, allowing the FBQ1000 to operate in its optimum range.

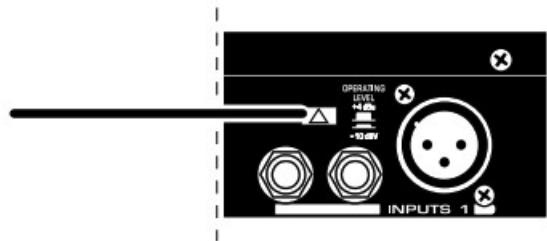

## FEEDBACK DESTROYER FBQ1000 Controls

### Step 2: Controls



**GAIN** button enables the JOG WHEEL to adjust the amount of boost or attenuation of the selected filter (+16 dB to -48 dB).

**JOG WHEEL** scrolls through presets and adjusts parameter values.

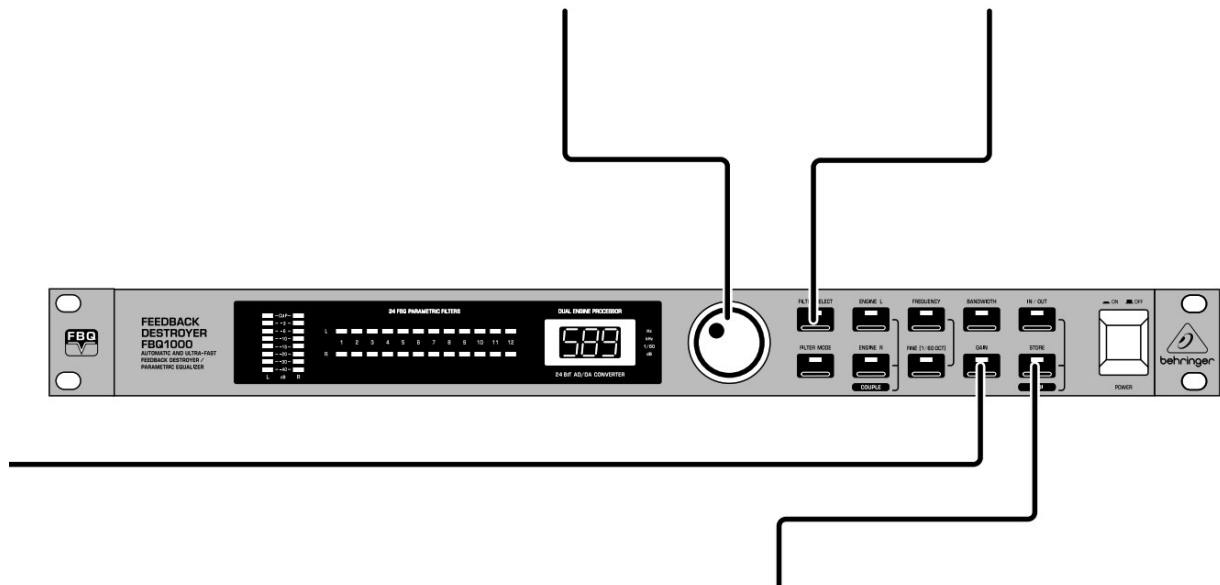

**STORE** button enables the JOG WHEEL to scroll through the 10 available preset slots. Press the STORE button again to confirm and save to the selected slot.

## FEEDBACK DESTROYER FBQ1000 Getting started

### Step 3: Getting started

1. Make all appropriate audio and power connections to the FBQ1000. Leave the power for all devices off!
2. Select the proper levels with the OPERATING LEVEL buttons to suit your application.
3. Press the POWER BUTTON to turn the unit on.

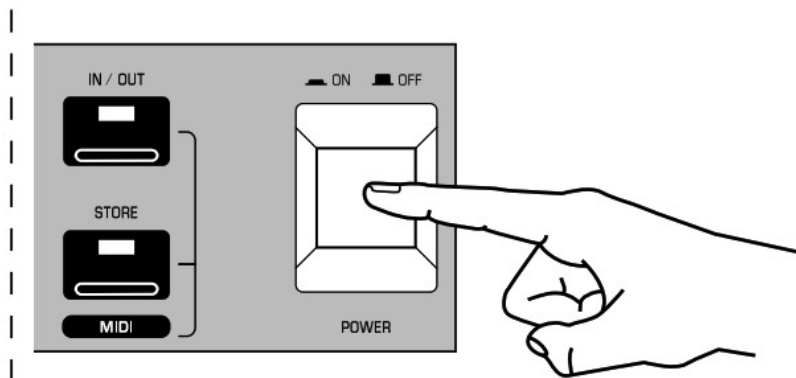

4. Use the JOG WHEEL to select preset 3. This sets all filters to Auto mode, which is a good starting point for eliminating feedback.

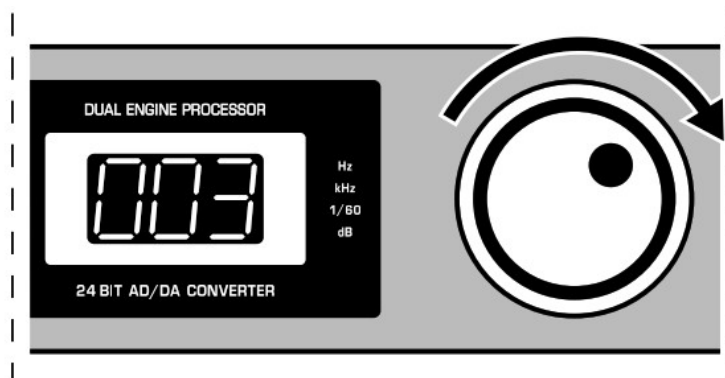

5. Press the ENGINE L or ENGINE R button to edit a specific channel. Press both ENGINE buttons simultaneously to enter Couple mode which allows both channels to be edited at the same time.
6. Press the FILTER SELECT button and turn the JOG WHEEL to select a specific filter.
7. Press the FILTER MODE button and turn the JOG WHEEL to edit the type of filter.
8. To save the preset, press the STORE button and turn the JOG WHEEL to select the preset location. The digit in the DISPLAY will flash.

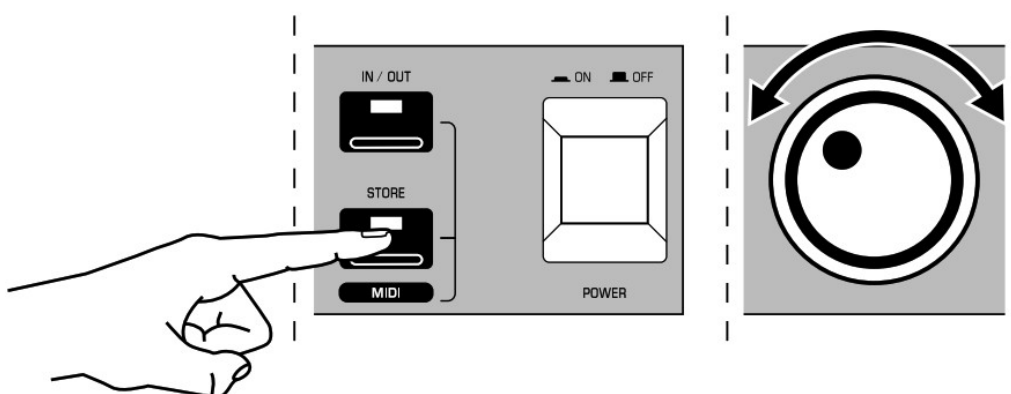

9. Press the STORE button to confirm and save.
10. Log on to [behringer.com](http://behringer.com) to download the full manual for more details on the FBQ1000's functionality.

## FEEDBACK DESTROYER FBQ1000 Preset chart



Preset	Filter 1	Filter 2	Filter 3	Filter 4	Filter 5	Filter 6	Filter 7	Filter 8	Filter 9	Filter 10	Filter 11	Filter 12
1	MONO: 9 single shot filters attenuate room resonances before 3 automatic filters destroy variable feedbacks											
L	SI	SI	SI	SI	SI	SI	SI	SI	SI	AU	AU	AU
R	SI	SI	SI	SI	SI	SI	SI	SI	SI	AU	AU	AU
2	2 x MONITOR AS FEEDBACK DESTROYER ONLY: 7 single shots / 5 automatic filters for most monitor setups											
L	SI	SI	SI	SI	SI	SI	SI	AU	AU	AU	AU	AU
R	SI	SI	SI	SI	SI	SI	SI	AU	AU	AU	AU	AU
3	MONO AUTO PILOT: 12 Filters per channel constantly chase and destroy feedbacks											
L	AU	AU	AU	AU	AU	AU	AU	AU	AU	AU	AU	AU
R	AU	AU	AU	AU	AU	AU	AU	AU	AU	AU	AU	AU
4	STEREO PARAMETRIC EQ: Preset with 12 ISO frequencies, all set to 1/3 Oct., Gain + 0 dB											
Couple	125 Hz	160 Hz	200 Hz	250 Hz	315 Hz	400 Hz	500 Hz	630 Hz	800 Hz	1 k	1.25 k	1.6 k
5	STEREO PARAMETRIC EQ: Preset with 12 ISO frequencies, all set to 2/3 Oct., Gain + 0 dB											
Couple	40 Hz	63 Hz	100 Hz	160 Hz	250 Hz	400 Hz	630 Hz	1 k	1.6 k	2.5 k	4 k	6.3 k
6	2 x MONO: Sample monitoring, left for handheld (lead) microphone(s), right for fixed (backing) ones											
L	SI	SI	SI	AU	AU	AU	AU	AU	PA def	PA def	PA def	PA def
R	SI	SI	SI	SI	SI	AU	AU	AU	PA def	PA def	PA def	PA def
7	MONO PARAMETRIC AND SINGLE SHOT FILTERS: A good start for a monitor equalization											
L	SI	SI	SI	SI	SI	SI	SI	SI	PA def	PA def	PA def	PA def
R	SI	SI	SI	SI	SI	SI	SI	SI	PA def	PA def	PA def	PA def
8	STEREO FOH EQ, providing 4 parametric EQ's (low roll off in filter 1 and 2), plus 8 single shot filters											
Couple	PA	PA	PA d.	PA d.	SI	SI	SI	SI	SI	SI	SI	SI
	40 Hz	80 Hz	Channels coupled, changes on one channel are valid for both									
	1 Oct.	1 Oct.										
	-8 dB	-4 dB										
9	MONO FREE											
L	SI	SI	SI	SI	SI	SI	SI	AU	AU	PA	PA	PA
R	SI	SI	SI	SI	SI	SI	SI	AU	AU	PA	PA	PA
10	STEREO: libre.											
Couple	SI	SI	SI	SI	SI	SI	SI	AU	AU	PA	PA	PA

## Specifications

Audio Inputs	
Connectors	XLR and ¼" TRS
Type	RF-filtered, servo-balanced input
Impedance	60 kΩ balanced, 30 kΩ unbalanced
Nominal operating level	-10 dBV to +4 dBu (switchable)
Max. input level	+16 dBu at +4 dBu nominal level, +2 dBV at -10 dBV nominal level
Audio Outputs	

Connectors	XLR and ¼" TRS
Type	Electronically servo-balanced output stage
Impedance	60 kΩ balanced, 30 kΩ unbalanced
Max. output level	+16 dBu at +4 dBu nominal level, +2 dBV at -10 dBV nominal level
System Specifications	
Bandwidth	20 Hz to 20 kHz, +0/-1 dB
Noise	> 94 dB, unweighted (20 Hz to 20 kHz)
THD	0.0075% typ. @ +4 dBu, 1 kHz, Gain 1
Crosstalk	< -76 dB
MIDI Interface	
Type	5-Pin DIN Socket IN/OUT/THRU
Digital Processing	
Converters	24-bit Sigma-Delta, 64/128-times oversampling
Display	
Type	2 ½-digit numeric LED display
Power Supply	
Mains Voltages	
USA/Canada	120 V~, 60 Hz (T 200 mA L, 250 V)
U.K./Australia	240 V~, 50 Hz (T 100 mA L, 250 V)
Europe	230 V~, 50 Hz (T 100 mA L, 250 V)
Korea	220 V~, 60 Hz (T 100 mA L, 250 V)
China	220 V~, 50 Hz (T 100 mA L, 250 V)
Japan	100 V~, 50/60 Hz (T 200 mA L, 250 V)
Power consumption	approx. 15 Watts max.
Mains connection	Standard IEC receptacle
Physical	
Dimensions (H x W D)	44 x 483 x 195 mm (1.7 x 19 x 7.7")
Weight	1.9 kg (4.22 lbs)

## FEDERAL COMMUNICATIONS COMMISSION COMPLIANCE INFORMATION

Behringer

FEEDBACK DESTROYER FBQ1000

Responsible Party Name: Music Tribe Commercial NV Inc.

Address: 5270 Procyon Street, Las Vegas NV 89118, United States

## FEEDBACK DESTROYER FBQ1000

This equipment has been tested and found to comply with the limits for a Class B digital device, pursuant to part 15 of the FCC Rules. These limits are designed to provide reasonable protection against harmful interference in a residential installation. This equipment generates, uses, and can radiate radio frequency energy and, if not installed and used in accordance with the instructions, may cause harmful interference to radio communications. However, there is no guarantee that interference will not occur in a particular installation. If this equipment does cause harmful interference to radio or television reception, which can be determined by turning the equipment off and on, the user is encouraged to try to correct the interference by one or more of the following measures:

- Reorient or relocate the receiving antenna.
- Increase the separation between the equipment and receiver.
- Connect the equipment into an outlet on a circuit different from that to which the receiver is connected.
- Consult the dealer or an experienced radio/TV technician for help.

This equipment complies with Part 15 of the FCC Rules. Operation is subject to the following two conditions:

- (1) This device may not cause harmful interference, and
- (2) This device must accept any interference received, including interference that may cause undesired operation.

### Important information:

Changes or modifications to the equipment not expressly approved by MUSIC Tribe can void the user's authority to use the equipment.



Hereby, Music Tribe declares that this product is in compliance with Directive 2014/35/EU, Directive 2014/30/EU, Directive 2011/65/EU and Amendment 2015/863/EU, Directive 2012/19/EU, Regulation 519/2012 REACH SVHC and Directive 1907/2006/EC.

Full text of EU DoC is available at <https://community.musictribe.com/>



EU Representative: Music Tribe Brands DK A/S

Address: Ib Spang Olsens Gade 17, DK – 8200 Aarhus N, Denmark

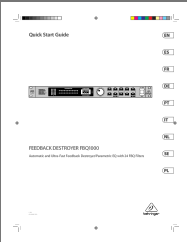
## Documents / Resources

	<a href="#">behringer Automatic and Ultra-Fast Feedback Destroyer Parametric EQ with 24 FBQ Filters [pdf] User Guide</a> Automatic and Ultra-Fast Feedback Destroyer Parametric EQ with 24 FBQ Filters, FEEDBACK DESTROYER FBQ1000
---	---

## References

-  [Behringer | Home](#)
-  [Music Tribe](#)