

BEGA 85237 Performance Floodlight



# BEGA 85237 Performance Floodlight Instruction Manual

[Home](#) » [BEGA](#) » BEGA 85237 Performance Floodlight Instruction Manual 

## Contents

- 1 BEGA 85237 Performance Floodlight
- 2 Product Usage Instructions
- 3 Instructions for use
- 4 Product Description
- 5 DIMENSION
- 6 Safety
- 7 Overvoltage protection
- 8 Installation
- 9 Cleaning/Maintenance
- 10 Replacing the LED module
- 11 Accessories
- 12 Documents / Resources
  - 12.1 References

# BEGA

**BEGA 85237 Performance Floodlight**



## Specifications

- Application: Performance floodlight with mounting box
- Interior and exterior lighting applications
- Lamp Module Connected Wattage: 55.5 W
- Luminaire Connected Wattage: 60 W
- Colour Temperature: 3000 K and 4000 K
- Colour Rendering Index (CRI): > 90
- Luminaire Luminous Flux: 2971 lm (3000 K) and 3222 lm (4000 K)
- Luminaire Luminous Efficiency: 49.5 lm/W (3000 K) and 53.7 lm/W (4000 K)
- Rated Temperature: 25 – 45 degrees Celsius

## Product Usage Instructions

### Safety

The installation and operation of this luminaire must adhere to national safety regulations. Only a qualified electrician should perform installation and commissioning to ensure safety.

### Installation

- LED components are sensitive; avoid direct contact with the light output opening during installation or relamping.
- Place the floodlight unit onto the mounting plate as shown in the sketch, align it, and securely screw them together.

### Adjustment of Beam Direction

Loosen the joint screw using a hexagon socket head wrench size 5 mm to set the desired beam direction. Retighten the joint screw with a torque of 7 Nm.

### Maintenance

The connecting cable between the mounting box and the floodlight should be inspected for damages periodically. Only a qualified electrician should replace the cable if needed.

## FAQ

- Q: Can I touch the LED directly during installation?

A: It is recommended to avoid touching the light output opening of the LED directly during installation to prevent damage to the components.

- Q: Who should perform the installation and commissioning of the luminaire?

A: Only a qualified electrician should carry out the installation and commissioning of the luminaire to ensure compliance with safety regulations.

Performance floodlight with minimal diffuse light percentage  IP 65

## Instructions for use

### Application

- Performance floodlight with mounting box. For a variety of interior and exterior lighting applications.
- BEGA Ultradark Optics® offer maximum of illumination and eye comfort due to a minimised diffuse light percentage and highly efficient glare suppression.

## Product Description

- Luminaire made of aluminium alloy, aluminium and stainless steel
- BEGA Unidure® coating technology
- Colour graphite or silver
- Matt safety glass
- Internal louvres and polymer lens
- BEGA Ultradark Optics®
- Louvres and the interior surface of the anti-glare ring
- with maximum light-absorbing ultra-black nano-coating
- The rotation range of floodlight is 350°
- Swivel range -30°/+90°
- Mounting box with 2 fixing holes ø 6 mm · 85 mm spacing
- 2 cable entries for through-wiring of mains supply cable ø 7-10.5 mm, max. 5 G 1.5@
- Connecting terminal 2.5@ with plug connection
- Earth conductor connection
- BEGA Ultimate Driver®
- Complies with flicker requirements by IEEE 1789,
- DIN IEC/TR 63158, DIN IEC/TR 61547-1
- LED power supply unit 220-240 V x 0/50-60 Hz
- DC 176-264 V
- DALI-controllable
- Number of DALI addresses: 1
- Basic insulation is provided between the mainland control cables
- BEGA Thermal Control®
- Temporary thermal regulation to protect temperature-sensitive components without switching off the luminaire
- Safety class I

- Protection class IP 65
- Dust-tight and protection against water jets
- Impact strength IK07
- Protection against mechanical impacts < 2 joule
-  – Conformity mark
- Wind catching area: 0.057 m²
- This product contains light sources of energy efficiency class(es) F

## DIMENSION

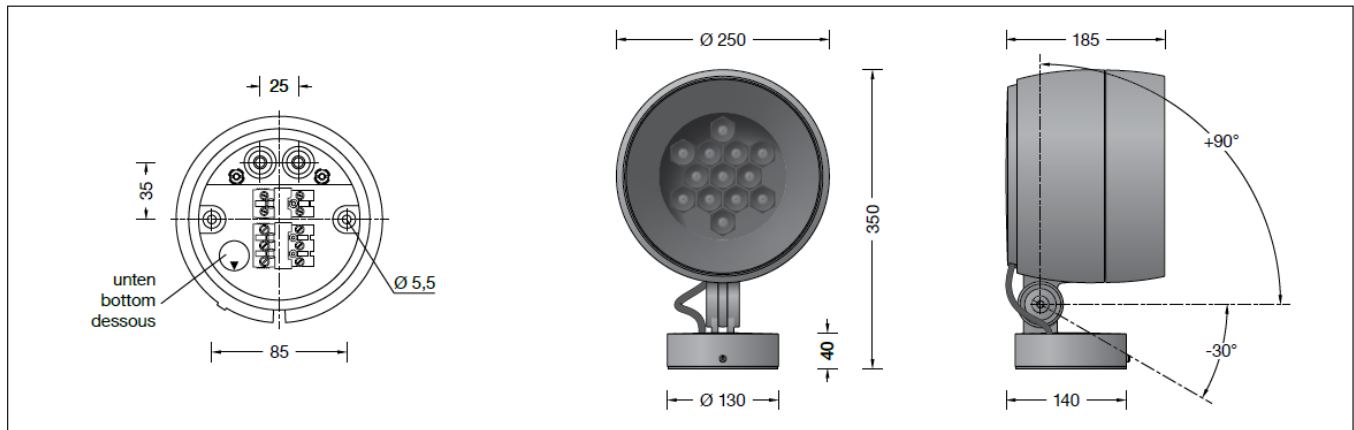

## Safety

- The installation and operation of this luminaire are subject to national safety regulations.
- Installation and commissioning may only be carried out by a qualified electrician.
- The manufacturer accepts no liability for damage caused by improper use or installation.
- If subsequent modifications are made to the luminaire, the person responsible for these modifications shall be considered the manufacturer.

## Overvoltage protection

- The electronic components installed in the luminaire are protected against overvoltage by DIN EN 61547.
- To achieve additional protection against e. g. transients, etc. we recommend separate overvoltage protection components.
- You can find them on our website at [www.bega.com](http://www.bega.com).
- The ideal protection of all electronic components installed in the luminaires is achieved by using bounce-free switching contacts such as an electronic relay (solid-state relay), e.g. BEGA 71 320.

### Please note:

Contact with the inner surface of the luminaire reflector should be avoided to permanently protect the special stray light minimising properties of the nano-coating.

## Installation

- LEDs are high-quality electronic components!
- Please avoid touching the light output opening of the LED directly during installation or relamping.
- Undo the hexagon socket head screws (wrench size 3 mm) at the mounting box and remove the mounting plate.

- Pass the power connecting cable through the cable entry in the mounting plate.
- Note the position of application of the mounting plate “arrow down”.
- Fix the mounting plate with enclosed or any other suitable fixing material onto the mounting surface.
- Be sure to use the gasket rings supplied.
- Make an earth conductor connection.
- Push silicone sleeves over the lines and make an electrical connection to the terminal (plug connection).
- For digital control please use the 2-pole plug connector DA, DA.
- In case this connector is not used the luminaire will be operated at full light output.
- Make earth conductor connection between floodlight and mounting box.
- Push the plug into the coupler as far as it will go. Make sure that the gasket is positioned correctly

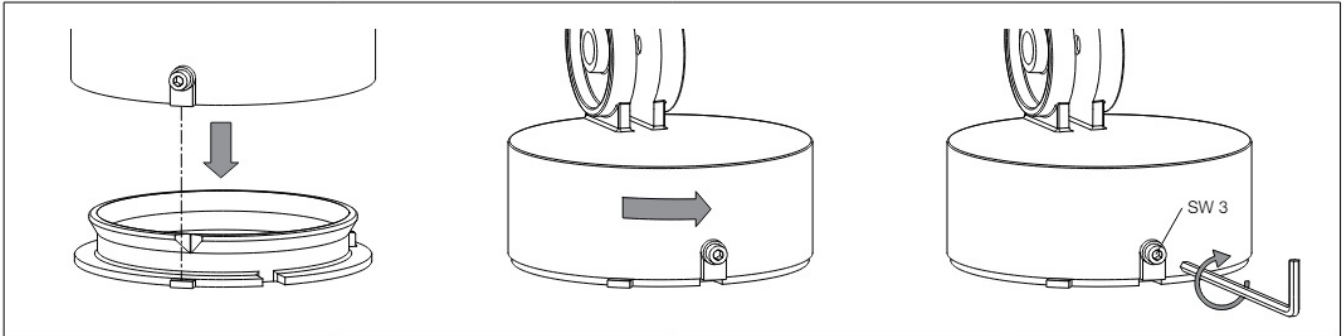

Place the floodlight unit onto the mounting plate as displayed in the sketch, and align and screw together firmly.

#### **Adjustment of beam direction:**

- Undo joint screw (hexagon socket head wrench size 5 mm) and set the desired beam direction.
- Tighten the joint screw.
- Torque = 7 Nm.

#### **Lamp**

- Module connected wattage 55.5 W
- Luminaire connected wattage 60 W
- Rated temperature  $t_a = 25\text{ }^{\circ}\text{C}$
- Ambient temperature  $t_a \text{ max} = 45\text{ }^{\circ}\text{C}$

#### **85 237 K3**

- Module designation LED-1263/930
- Colour temperature 3000 K
- Colour rendering index CRI > 90
- Module luminous flux 5985 lm
- Luminaire luminous flux 2971 lm
- Luminaire luminous efficiency 49,5 lm / W

#### **85 237 K4**

- Module designation LED-1263/940
- Colour temperature 4000 K
- Colour rendering index CRI > 90
- Module luminous flux 6490 lm

- Luminaire luminous flux 3222 lm
- Luminaire luminous efficiency 53,7 lm / W

### **Lighting technology**

- Symmetrically focused broad-spread light distribution with minimal diffuse light percentage.
- Half beam angle 56°

### **Cleaning/Maintenance**

- Clean the luminaire regularly with solvent-free cleansers from dirt and deposits.
- Do not use high-pressure cleaners.

### **Maintenance**

The connecting cable between the mounting box and the floodlight has to be inspected regarding obvious damages and has to be replaced by a qualified electrician only.

### **Replacing the LED module**

- The designation of the LED module is noted on a separate label in the luminaire or on the underside of the specific LED module.
- The light colour and light output of BEGA replacement modules correspond to those of the modules originally fitted. The module can be replaced by a qualified person using commercially available tools.
- Disconnect the system from the power supply.

### **Open the floodlight:**

- Loosen the back locking pin (hexagon socket wrench size 2) in the trim ring.
- Remove the trim ring along with the safety glass and reflector by twisting it anti-clockwise.

### **Please note:**

- Contact with the inner surfaces of the louvres and luminaire reflector should be avoided to permanently protect the special stray light-minimising properties of the nano-coating.
- Grasp the louvres from the outside and lift them out. Loosen the three mounting screws (Torx drive T20) and lift the lens holder (with the loosely inserted lenses) upward horizontally out of the housing.
- Replace the LED module.
- Please follow the installation instructions for the LED module.
- Install in reverse order.
- When installing the lens holder, make sure that the LED connecting cable is not pinched.
- Inspect and, if necessary, replace the luminaire gaskets.
- The defective glass must be replaced.
- Place the trim ring with glass and reflector on the floodlight housing so that the notches in the trim ring and luminaire housing sit on top of each other.
- Twist on the trim ring clockwise as far as the stop. Screw in the locking pin.

### **Accessories**

- 71 334 Shield
- 71 339 Cylindrical shield

For the accessories, a separate instructions for use can be provided upon request

## Spares

- Spare glass internal 14 001 666
- Trim ring graphite with glass 25 000 285
- Trim ring silver with glass 25 000 286
- LED power supply unit DEV-0356/1400i
- LED module 3000 K LED-1263/930
- LED module 4000 K LED-1263/940
- Gasket housing 83 001 780
- Gasket mounting box 83 001 838
- Gasket trim ring 83 002 225

BEGA Gantenbrink-Leuchten KG · Postfach 31 60 · 58689 Menden · [info@bega.com](mailto:info@bega.com) · [www.bega.com](http://www.bega.com)

---

## Documents / Resources

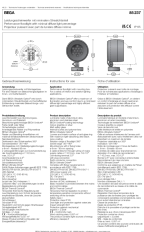
|                                                                                     |                                                                                                                                                               |
|-------------------------------------------------------------------------------------|---------------------------------------------------------------------------------------------------------------------------------------------------------------|
|  | <p><a href="#">BEGA 85237 Performance Floodlight</a> [pdf] Instruction Manual<br/>85237 Performance Floodlight, 85237, Performance Floodlight, Floodlight</p> |
|-------------------------------------------------------------------------------------|---------------------------------------------------------------------------------------------------------------------------------------------------------------|

## References

- BEGA [BEGA · Das gute Licht.](#)
- [User Manual](#)

### Manuals+, Privacy Policy

This website is an independent publication and is neither affiliated with nor endorsed by any of the trademark owners. The "Bluetooth®" word mark and logos are registered trademarks owned by Bluetooth SIG, Inc. The "Wi-Fi®" word mark and logos are registered trademarks owned by the Wi-Fi Alliance. Any use of these marks on this website does not imply any affiliation with or endorsement.