



BEGA 85148 RGBW Performance Floodlight Instruction Manual

[Home](#) » [BEGA](#) » BEGA 85148 RGBW Performance Floodlight Instruction Manual 

BEGA
Technical amendments reserved
85 146
Performance floodlight RGBW
UK CA CE IP 65

Contents

- [1 85148 RGBW Performance Floodlight](#)
- [2 Application](#)
- [3 Product description](#)
- [4 Light technique](#)
- [5 Safety](#)
- [6 Overvoltage protection](#)
- [7 Installation](#)
- [8 Cleaning · Maintenance](#)
- [9 Replacing the LED module](#)
- [10 Accessories](#)
- [11 Documents / Resources](#)
 - [11.1 References](#)

85148 RGBW Performance Floodlight

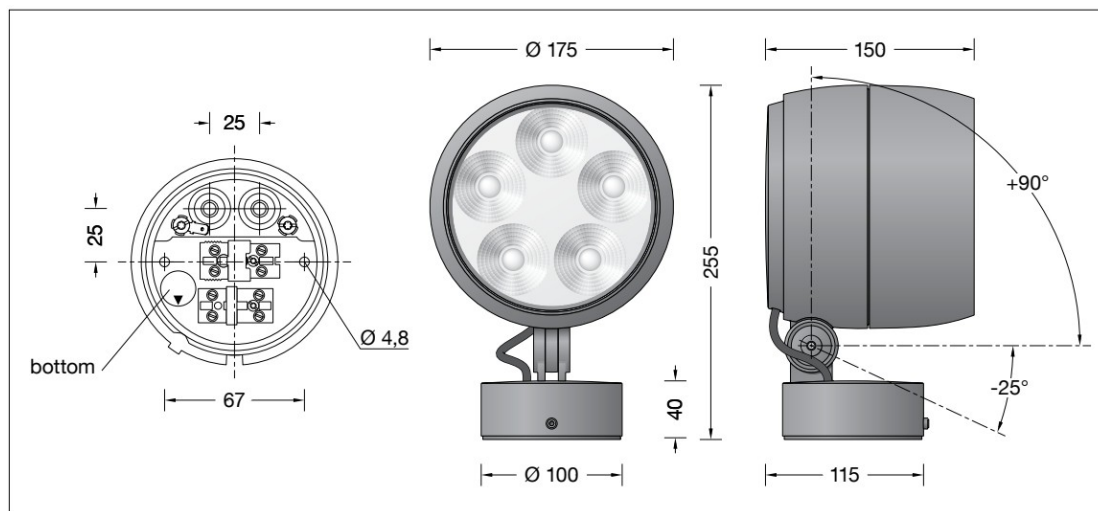

Instructions for use

Application

Performance floodlight with mounting box.

For a variety of interior and exterior lighting applications.

The floodlight can be controlled by DALI colour light control (DT8, RGBWAF, xy, TC).

Product description

Luminaire made of aluminium alloy, aluminium and stainless steel

BEGA Unidure® coating technology

Colour graphite or silver

Safety glass with optical structure

Silicone gasket

Reflector surface made of pure aluminium

BEGA Constant Optics®

Rotation range of floodlight 350°

Swivel range -25°/+90°

Mounting box with 2 fixing holes \varnothing 4.8 mm · 67 mm spacing

2 cable entries for through-wiring of mains supply cable \varnothing 7-10.5 mm, max. 5 G 1.5

Connecting terminal 2.5 with plug connection

Earth conductor connection

BEGA Ultimate Driver®

Complies with flicker requirements in accordance with IEEE 1789, DIN IEC/TR 63158, DIN IEC/TR 61547-1

LED power supply unit

220-240 V \sim 0/50-60 Hz

DC 176-264 V

DALI-controllable(DT8, RGBWAF, xy, TC)

Number of DALI addresses: 1

Basic insulation is provided between the mains and control cables

BEGA Thermal Control®

Temporary thermal regulation to protect temperature-sensitive components without switching off the luminaire

Safety class I

Protection class IP 65

Dust-tight and protection against water jets

Impact strength IK08

Protection against mechanical impacts < 5 joule

CE – Conformity mark

Wind catching area: 0.031 m²

Weight: 3.2 kg

Light technique

Symmetrical wide beam light distribution

Half beam angle 24°

For special lighting applications, an optical filter can be used to change the symmetrical light cone into a flat beam light distribution.

Lamp

Module connected wattage	34.8 W
Luminaire connected wattage	38.6 W
Rated temperature	ta = 25 °C
Ambient temperature	ta max = 30 °C

Module designation	LED-1160/RGBW
Colour temperature of the white LED	4000 K
Luminaire luminous flux	2076 lm
Luminaire luminous efficiency	53,8 lm / W

Safety

The installation and operation of this luminaire are subject to national safety regulations. Installation and commissioning may only be carried out by a qualified electrician.

The manufacturer accepts no liability for damage caused by improper use or installation. If subsequent modifications are made to the luminaire, the person responsible for these modifications shall be considered the manufacturer.

Overvoltage protection

The electronic components installed in the luminaire are protected against overvoltage in accordance with DIN EN 61547.

To achieve an additional protection against e. g. transients, etc. we recommend separate overvoltage protection components.

You can find them on our website at www.bega.com.

The ideal protection of all electronic components installed in the luminaires is achieved by using bounce-free switching contacts such as an electronic relay (solid-state relay), e.g. BEGA 71 320.

Installation

LED are high-quality electronic components!

Please avoid touching the light output opening of the LED directly during installation or relamping.

Undo hexagon socket head screw (wrench size 3 mm) up to the stop and disassemble the mounting plate.

Pass the power connecting cable through the cable entry in the mounting plate.

Note position of application of the mounting plate "arrow down".

Fix the mounting plate with enclosed or any other suitable fixing material onto the mounting surface.

Be sure to use the gasket rings supplied.

Make earth conductor connection.

Push silicone sleeves over the lines and make electrical connection to terminal (plug connection).

For digital control please use the 2-pole plug connector DA, DA.

In case this connector is not used the luminaire will be operated at full light output.

Push plug into coupler as far as it will go.

Connect the floodlight unit's green and yellow protective earth conductor to the terminal marked  in the mounting plate.

Make sure that gasket is positioned correctly.

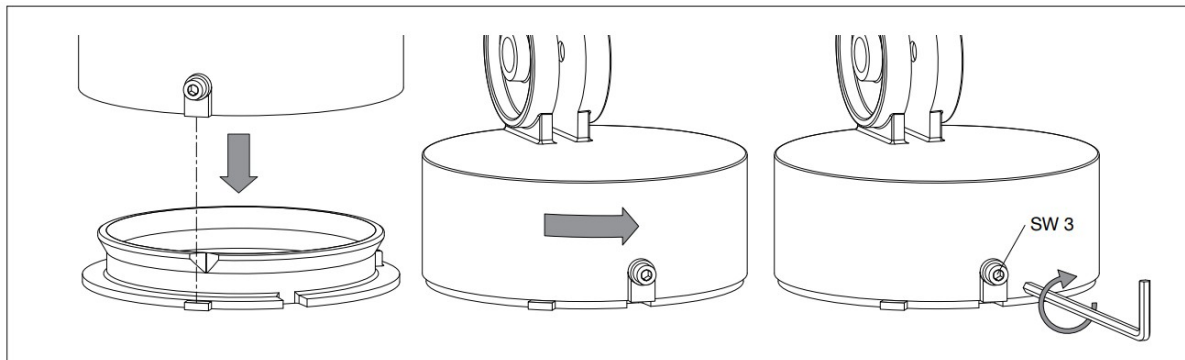

Place floodlight unit onto the mounting plate as displayed in the sketch, align and screw together firmly.

Adjustment of beam direction:

Undo joint screw (hexagon socket head wrench size 5 mm) and set the desired beam direction.

Tighten the joint screw.

Torque = 7 Nm.

Cleaning · Maintenance

Clean luminaire regularly with solvent-free cleansers from dirt and deposits.

Do not use high pressure cleaners.

Maintenance

The connecting cable between mounting box and floodlight has to be inspected regarding obvious damages and has to be replaced by a qualified electrician only.

Please note:

Do not remove the desiccant bag from the luminaire housing.

It is needed to remove residual moisture.

Replacing the LED module

The designation of the LED module is noted on a separate label in the luminaire or on the underside of the specific LED module.

The light colour and light output of BEGA replacement modules correspond to those of the modules originally fitted. The module can be replaced by qualified persons using standard tools.

Disconnect the system.

Open the floodlight:

Undo locking pin (hexagon socket head wrench size 2.5 mm) on the back side of the floodlight housing.

Remove the trim ring along with the safety glass and reflector by twisting it counter-clockwise.

Replace LED module.

Please follow the installation instructions for the LED module.

Inspect and, if necessary, replace the luminaire gaskets.

Defective glass must be replaced.

Place trim ring with glass and reflector on the floodlight housing in such a way that the notches in the trim ring and floodlight housing align on top to each other.

Twist on the trim ring clockwise as far as the stop. Tighten locking pin.

Accessories

71 291	Optical filter flat beam
71 333	Shield
71 338	Cylindrical shield

For the accessories a separate instructions for use can be provided upon request.

Spares

Trim ring graphite with glass	25 000 283
Trim ring silver with glass	25 000 284
LED power supply unit	DEV-0357/200
LED module	LED-1160/RGBW
Reflector	76 002 009
Gasket housing	83 001 579
Gasket mounting box	83 001 839
Gasket trim ring	83 002 306

BEGA Gantenbrink-Leuchten KG

- Postfach 31 60
- 58689 Menden
- info@bega.com
- www.bega.com

Documents / Resources

	<p>BEGA 85148 RGBW Performance Floodlight [pdf] Instruction Manual 85148, 85148 RGBW Performance Floodlight, RGBW Performance Floodlight, Performance Floodlight, Floodlight</p>
---	---

References

- BEGA [BEGA · Das gute Licht.](#)
- [User Manual](#)

[Manuals+](#), [Privacy Policy](#)

This website is an independent publication and is neither affiliated with nor endorsed by any of the trademark owners. The "Bluetooth®" word mark and logos are registered trademarks owned by Bluetooth SIG, Inc. The "Wi-Fi®" word mark and logos are registered trademarks owned by the Wi-Fi Alliance. Any use of these marks on this website does not imply any affiliation with or endorsement.