



## **BEGA 85147 RGBW Performance Floodlight Instruction Manual**

[Home](#) » [BEGA](#) » BEGA 85147 RGBW Performance Floodlight Instruction Manual 

### **BEGA 85147 RGBW Performance Floodlight**



## Contents

### 1 Dimension

### 2 Instructions for use

### 3 Customers Support

### 4 Documents / Resources

#### 4.1 References

### 5 Related Posts

## Dimension

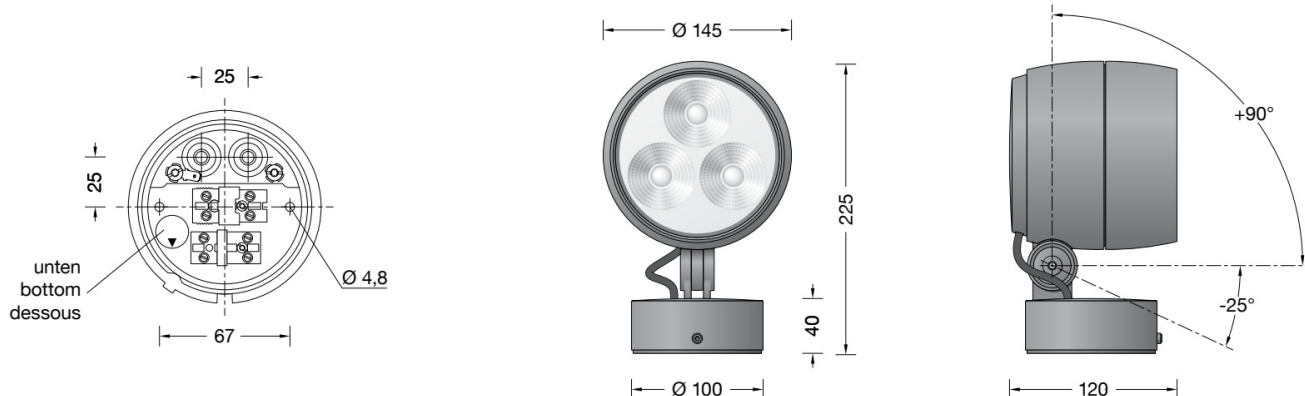

## Instructions for use

### Application

Performance floodlight with mounting box.

For a variety of interior and exterior lighting applications.

The floodlight can be controlled by DALI colour light control (DT8, RGBWAF, xy, TC).

### Product description

Luminaire made of aluminium alloy,

aluminium and stainless steel

BEGA Unidure® coating technology

Colour graphite or silver

Safety glass with optical structure

Silicone gasket

Reflector surface made of pure aluminium

BEGA Constant Optics®

Rotation range of floodlight  $350^\circ$

Swivel range  $-25^\circ/+90^\circ$

Mounting box with 2 fixing holes

$\varnothing 4.8\text{mm} \cdot 67\text{mm}$  spacing

2 cable entries for through-wiring of mains

supply cable  $\varnothing 7-10.5\text{mm}$ , max.  $5\text{G}1.5@$

Connecting terminal  $2.5@$

with plug connection

Earth conductor connection

BEGA Ultimate Driver®

Complies with flicker requirements in

accordance with IEEE 1789,

DIN IEC/TR 63158, DIN IEC/TR 61547-1

LED power supply unit

220-240 V  $\sim$  0/50-60 Hz  
DC 176-264 V  
DALI-controllable(DT8, RGBWAF, xy, TC)  
Number of DALI addresses: 1  
Basic insulation is provided between the mains  
and control cables  
Safety class I  
Protection class IP 65  
Dust-tight and protection against water jets  
Impact strength IK06  
Protection against mechanical  
impacts < 1 joule  
**CE** – Conformity mark  
Wind catching area: 0.023 m<sup>2</sup>  
This product contains light sources of energy  
efficiency class(es) F

## Lighting technology

Symmetrical wide beam light distribution Half beam angle 50°  
For special lighting applications, an optical filter can be used to change the symmetrical light cone into a flat beam light distribution.

## Lamp

Module connected wattage **20.8 W**  
Luminaire connected wattage **24 W**  
Rated temperature **ta=25 °C**  
Service life criteria **50000 h/L70**  
Module designation **LED-1161/RGBW**  
Colour temperature of the white LED **4000 K**  
Luminaire luminous flux **1297 lm**  
Luminaire luminous efficiency **54 lm/W**

## Safety

The installation and operation of this luminaire are subject to national safety regulations.  
Installation and commissioning may only be carried out by a qualified electrician.  
The manufacturer accepts no liability for damage caused by improper use or installation.  
If subsequent modifications are made to the luminaire, the person responsible for these modifications shall be considered the manufacturer.

## Overvoltage protection

The electronic components installed in the luminaire are protected against overvoltage in accordance with DIN EN 61547. To achieve an additional protection against e.g. transients, etc. we recommend separate overvoltage protection components. You can find them on our website at [www.bega.com](http://www.bega.com).

The ideal protection of all electronic components installed in the luminaires is achieved by using bounce-free switching contacts such as an electronic relay (solid-state relay), e.g. BEGA 71320.

## Installation

LED are high-quality electronic components!

Please avoid touching the light output opening of the LED directly during installation or relamping.

Undo hexagon socket head screw (wrench size 3mm) up to the stop and disassemble the mounting plate.

Pass the power connecting cable through the cable entry in the mounting plate.

Fix the mounting plate with enclosed or any other suitable fixing material onto the mounting surface.

Be sure to use the gasket rings supplied.

Make earth conductor connection.

Push silicone sleeves over the lines and make electrical connection to terminal (plug connection).

For digital control please use the 2-pole plug connector DA, DA.

In case this connector is not used the luminaire will be operated at full light output.

Push plug into coupler as far as it will go.

Connect the floodlight unit's green and yellow protective earth conductor to the terminal marked  in the mounting plate.

Make sure that gasket is positioned correctly

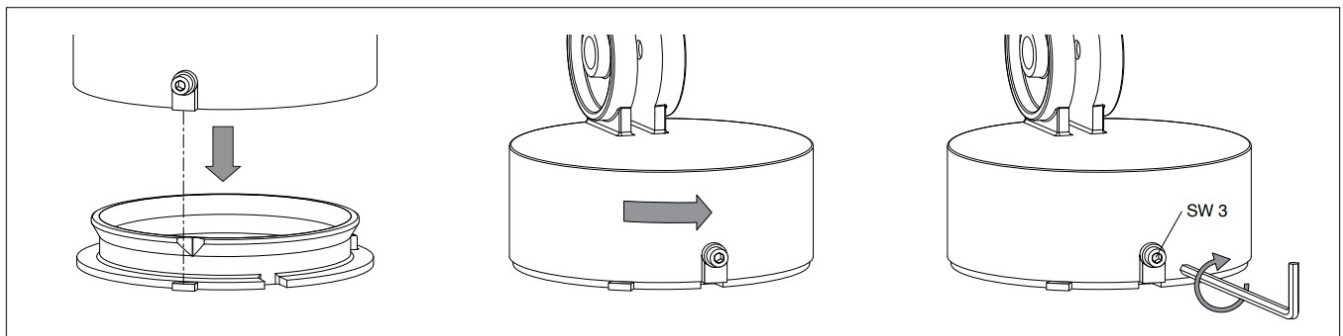

Place floodlight unit onto the mounting plate as displayed in the sketch, align and screw together firmly.

#### **Adjustment of beam direction:**

Undo joint screw (hexagon socket head wrench size 5 mm) and set the desired beam direction.

Tighten the joint screw.

Torque = 7Nm.

#### **Cleaning · Maintenance**

Clean luminaire regularly with solvent-free cleansers from dirt and deposits.

Do not use high pressure cleaners.

#### **Maintenance**

The connecting cable between mounting box and floodlight has to be inspected regarding obvious damages and has to be replaced by a qualified electrician only.

#### **Please note:**

Do not remove the desiccant bag from the luminaire housing.

It is needed to remove residual moisture.

#### **Replacing the LED module**

The designation of the LED module is noted on a separate label in the luminaire or on the underside of the specific LED module.

The light colour and light output of BEGA replacement modules correspond to those of the modules originally fitted. The module can be replaced by qualified persons using standard tools.

Disconnect the system.

Open the floodlight:

Undo locking pin (hexagon socket head wrench size 2.5 mm) on the back side of the floodlight housing.

Remove the trim ring along with the safety glass and reflector by twisting it counterclockwise.

Replace LED module.

Please follow the installation instructions for the LED module.

Inspect and, if necessary, replace the luminaire gaskets.

Defective glass must be replaced.

Place trim ring with glass and reflector on the floodlight housing in such a way that the notches in the trim ring and floodlight housing align on top to each other.

Twist on the trim ring clockwise as far as the stop. Tighten locking pin.

## Accessories

**71 290** Optical filter flat beam

**71332** Shield

**71 337** Cylindrical shield

For the accessories a separate instructions for use can be provided upon request.

## Spares

Trim ring graphite with glass **25 000 279**

Trim ring silver with glass **25 000 280**

LED power supply unit **DEV-0418/200i**

LED module **LED-1161/RGBW**

Reflector **76 002 012**

Gasket housing **83 000 521**

Gasket mounting box **83 001 839**

Gasket trim ring **83 001 952**

## Customers Support

UK  
CA C E IP 65

**BEGA Gantenbrink-Leuchten KG**

Postfach 3160

58689 Menden

[info@bega.com](mailto:info@bega.com)

[www.bega.com](http://www.bega.com)

# BEGA

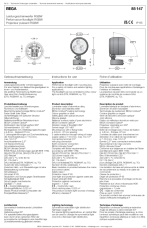

**[BEGA 85147 RGBW Performance Floodlight](#)** [pdf] Instruction Manual  
85147 RGBW Performance Floodlight, 85147, RGBW Performance Floodlight, Performance Floodlight, Floodlight

## References

- BEGA **[BEGA · Das gute Licht.](#)**
- **[User Manual](#)**

**[Manuals+](#)**, **[Privacy Policy](#)**

This website is an independent publication and is neither affiliated with nor endorsed by any of the trademark owners. The "Bluetooth®" word mark and logos are registered trademarks owned by Bluetooth SIG, Inc. The "Wi-Fi®" word mark and logos are registered trademarks owned by the Wi-Fi Alliance. Any use of these marks on this website does not imply any affiliation with or endorsement.