

**BEGA 85145 RGBW Performance Floodlight**



# **BEGA 85145 RGBW Performance Floodlight Instruction Manual**

[Home](#) » [BEGA](#) » **BEGA 85145 RGBW Performance Floodlight Instruction Manual** 

## **Contents**

- [1 BEGA 85145 RGBW Performance Floodlight](#)
- [2 DIMENSION](#)
- [3 Product Usage Instructions](#)
- [4 Instructions for use](#)
- [5 Product description](#)
- [6 SPECIFICATION](#)
- [7 Safety](#)
- [8 Accessories](#)
- [9 MORE INFORMATION](#)
- [10 FAQ](#)
- [11 Documents / Resources](#)
  - [11.1 References](#)

# **BEGA**

**BEGA 85145 RGBW Performance Floodlight**

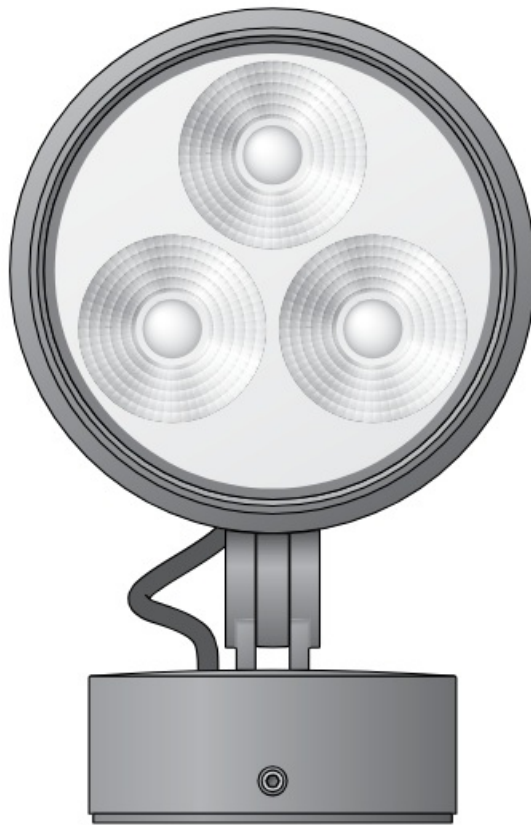

## Specifications

- **Light Source:** LED-1161/RGBW
- **Module Connected Wattage:** 20.8 W
- **Luminaire Connected Wattage:** 24 W
- **Colour Temperature:** 4000 K
- **Luminaire Luminous Flux:** 1288 lm
- **Luminaire Luminous Efficiency:** 53.7 lm/W

## DIMENSION

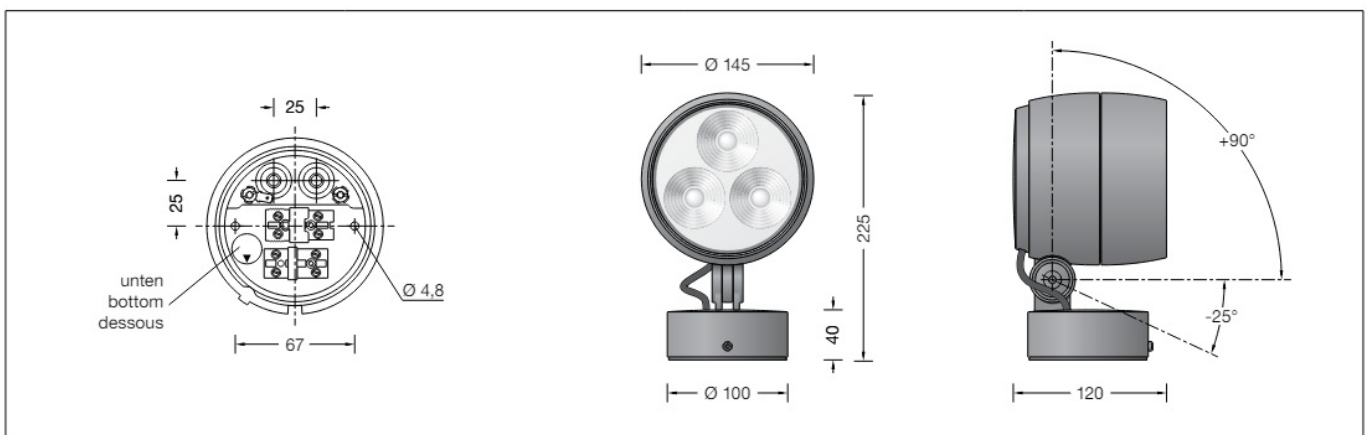

## Product Usage Instructions

### Application

The RGBW Performance floodlight is suitable for a variety of interior and exterior lighting applications. It can be controlled by DALI colour light control (DT8, RGBWAF, xy, TC).

**Safety:**

The installation and operation must comply with national safety regulations and should only be carried out by a qualified electrician to prevent damage due to improper use or installation.

**Overvoltage Protection:**

The luminaire is protected against overvoltage according to DIN EN 61547. Additional overvoltage protection components are recommended for further protection.

**Installation:**

Avoid direct contact with the LED output opening during installation or relamping. Place the floodlight unit onto the mounting plate, align it as per the sketch, and securely fasten it. Adjust the beam direction using the joint screw (torque = 7 Nm).

**Maintenance:**

Inspect the connecting cable for damages and replace it if necessary by a qualified electrician. Do not remove the desiccant bag from the luminaire housing as it helps remove residual moisture.

**Accessories:**

Optional accessories like optical filters and shields are available. Request a separate set of instructions for their use if needed.

**Instructions for use****Application**

- Performance floodlight with mounting box. For a variety of interior and exterior lighting applications.
- The floodlight can be controlled by DALI colour light control (DT8, RGBWAF, xy, TC).

**Product description**

- Luminaire made of aluminium alloy, aluminium and stainless steel
- BEGA Unidure® coating technology
- Colour graphite or silver
- Safety glass with optical structure
- Silicone gasket
- Reflector surface made of pure aluminium BEGA Constant Optics®
- The rotation range of floodlight 350°
- Swivel range -25°/+90°
- Mounting box with 2 fixing holes
- $\varnothing$  4.8 mm · 67 mm spacing
- 2 cable entries for through-wiring of mains supply cable  $\varnothing$  7-10.5 mm, max. 5 G 1.5@ Connecting terminal 2.5@
- with plug connection
- Earth conductor connection
- BEGA Ultimate Driver®
- Complies with flicker requirements by IEEE 1789,
- DIN IEC/TR 63158, DIN IEC/TR 61547-1 LED power supply unit
- 220-240 V x 0/50-60 Hz

- DC 176-264 V
- DALI-controllable(DT8, RGBWAF, xy, TC) Number of DALI addresses: 1
- Basic insulation is provided between the mains and control cables
- Safety class I
- Protection class IP 65
- Dust-tight and protection against water jets Impact strength IK06
- Protection against mechanical
- impacts < 1 joule
- CE– Conformity mark
- Wind catching area: 0.023 m<sup>2</sup>
- This product contains light sources of energy efficiency class(es) F

## Light technique

- Symmetrical wide beam light distribution
- Half beam angle 24°
- For special lighting applications, an optical filter can be used to change the symmetrical light cone into a flat beam light distribution.

## SPECIFICATION

### Lamp

- **Module connected wattage** 20.8 W
- **Luminaire connected wattage** 24 W
- **Rated temperature**  $t_a = 25\text{ °C}$
- **Service life criteria** 50 000 h / L70
- **Module designation** LED-1161/RGBW
- **The colour temperature** of the white LED 4000 K
- **Luminaire luminous flux** 1288 lm
- **Luminaire luminous efficiency** 53,7 lm / W

### Safety

The installation and operation of this luminaire are subject to national safety regulations. Installation and commissioning may only be carried out by a qualified electrician.

The manufacturer accepts no liability for damage caused by improper use or installation. If subsequent modifications are made to the luminaire, the person responsible for these modifications shall be considered the manufacturer.

### Overvoltage protection

- The electronic components installed in the luminaire are protected against overvoltage in accordance with DIN EN 61547.
- To achieve additional protection against e. g. transients, etc. we recommend separate overvoltage protection components.

- You can find them on our website at: [www.bega.com](http://www.bega.com).
- The ideal protection of all electronic components installed in the luminaires is achieved by using bounce-free switching contacts such as an electronic relay (solid-state relay), e.g. BEGA 71 320.

## Installation

- LEDs are high-quality electronic components! Please avoid touching the light output opening of the LED directly during installation or relamping.
- Undo the hexagon socket head screw (wrench size 3 mm) up to the stop and disassemble the mounting plate.
- Pass the power connecting cable through the cable entry in the mounting plate.
- Note the position of application of the mounting plate “arrow down”.
- Fix the mounting plate with enclosed or any other suitable fixing material onto the mounting surface.
- Be sure to use the gasket rings supplied. Make an earth conductor connection.
- Push silicone sleeves over the lines and make an electrical connection to the terminal (plug connection).
- For digital control please use the 2-pole plug connector DA, DA.
- In case this connector is not used the luminaire will be operated at full light output.
- Push the plug into the coupler as far as it will go. Connect the floodlight unit's green and yellow protective earth conductor to the terminal marked 1 in the mounting plate.
- Make sure that the gasket is positioned correctly.

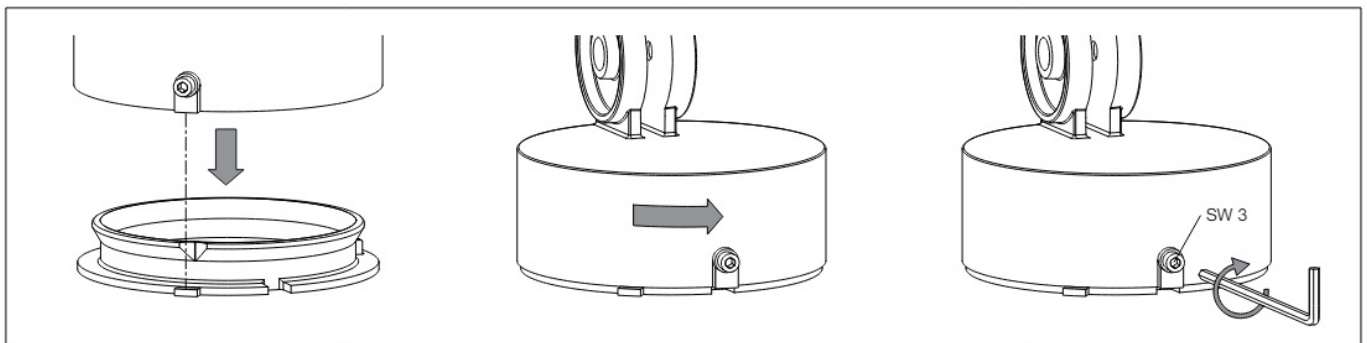

Place the floodlight unit onto the mounting plate as displayed in the sketch, and align and screw it together firmly.

## Adjustment of beam direction:

- Undo the joint screw (hexagon socket head wrench size 5 mm) and set the desired beam direction.
- Tighten the joint screw.
- Torque = 7 Nm.

## Cleaning Maintenance

- Clean the luminaire regularly with solvent-free cleansers from dirt and deposits.
- Do not use high-pressure cleaners.

## Maintenance

- The connecting cable between the mounting box and the floodlight has to be inspected for obvious damages

and has to be replaced by a qualified electrician only.

### **Please note**

- Do not remove the desiccant bag from the luminaire housing.
- It is needed to remove residual moisture.

### **Replacing the LED module**

- The designation of the LED module is noted on a separate label in the luminaire or on the underside of the specific LED module.
- The light colour and light output of BEGA replacement modules correspond to those of the modules originally fitted. The module can be replaced by qualified persons using standard tools.
- Disconnect the system.

### **Open the floodlight**

- Undo the locking pin (hexagon socket head wrench size 2.5 mm) on the back side of the floodlight housing.
- Remove the trim ring along with the safety glass and reflector by twisting it counterclockwise.

### **Replace the LED module**

- Please follow the installation instructions for the LED module.
- Inspect and, if necessary, replace the luminaire gaskets.
- The defective glass must be replaced.
- Place the trim ring with glass and reflector on the floodlight housing in such a way that the notches in the trim ring and floodlight housing align on top to each other.
- Twist on the trim ring clockwise as far as the stop. Tighten the locking pin.

### **Accessories**

- 71 290 Optical filter flat beam
- 71 332 Shield
- 71 337 Cylindrical shield

For the accessories, separate instructions for use can be provided upon request.

### **Spares**

- **Trim ring graphite with glass** 25 000 279
- **Trim ring silver with glass** 25 000 280
- **LED power supply unit** DEV-0418/200i
- **LED module** LED-1161/RGBW
- **Reflector** 76 002 013
- **Gasket housing** 83 000 521

- **Gasket mounting box** 83 001 839
- **Gasket trim ring** 83 001 952

## MORE INFORMATION

- **ADDRESS:** BEGA Gantenbrink-Leuchten KG · Postfach 31 60 · 58689 Menden ·
- [info@bega.com](mailto:info@bega.com)
- [www.bega.com](http://www.bega.com)

## FAQ

- **Q: Can the floodlight be used for both interior and exterior applications?**
  - A: Yes, the RGBW Performance floodlight is suitable for both interior and exterior lighting applications.
- **Q: What type of control systems are compatible with this floodlight?**
  - A: The floodlight can be controlled by DALI colour light control systems including DT8, RGBWAF, xy, and TC.

## Documents / Resources

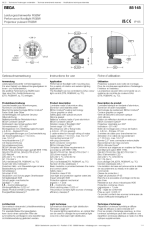
	<p><b><a href="#">BEGA 85145 RGBW Performance Floodlight</a></b> [pdf] Instruction Manual</p> <p>85145 RGBW Performance Floodlight, 85145, RGBW Performance Floodlight, Performance Floodlight, Floodlight</p>
--	--

## References

- BEGA [BEGA · Das gute Licht.](#)
- [User Manual](#)

### Manuals+, [Privacy Policy](#)

This website is an independent publication and is neither affiliated with nor endorsed by any of the trademark owners. The "Bluetooth®" word mark and logos are registered trademarks owned by Bluetooth SIG, Inc. The "Wi-Fi®" word mark and logos are registered trademarks owned by the Wi-Fi Alliance. Any use of these marks on this website does not imply any affiliation with or endorsement.