

BEGA
85137K3
Performance
Floodlight



BEGA 85137K3 Performance Floodlight Instruction Manual

[Home](#) » [BEGA](#) » BEGA 85137K3 Performance Floodlight Instruction Manual 

Contents

- [1 BEGA 85137K3 Performance Floodlight](#)
- [2 Product Information](#)
- [3 Product Usage Instructions](#)
- [4 Application](#)
- [5 Product Description](#)
- [6 Lighting technology](#)
- [7 Lamp](#)
- [8 Safety](#)
- [9 Overvoltage protection](#)
- [10 Installation](#)
- [11 Dimension](#)
- [12 Cleaning and maintenance](#)
- [13 Replacing the LED module](#)
- [14 Accessories](#)
- [15 Spare Parts](#)
- [16 Documents / Resources](#)
 - [16.1 References](#)
- [17 Related Posts](#)

BEGA

BEGA 85137K3 Performance Floodlight



Product Information

Specifications

- **Material:** Aluminum alloy, aluminum, stainless steel
- **Power Supply:** LED power supply unit 220-240 V x 0/50-60 Hz DC 176-280 V
- **Control:** DALI-controllable, with 1 DALI address
- **Insulation:** Basic insulation provided between hands
- **Safety:** Safety class I, Protection class IP 65, Impact strength IK06
- **Light Sources:** Energy efficiency class E

Product Usage Instructions

Facility

1. Installation and commissioning should only be carried out by a qualified electrician.
2. Ensure the luminaire is mounted securely using the provided mounting box with 2 fixing holes.
3. Connect the earth conductor properly to ensure safety.

Operation

1. Ensure the power supply is within the specified range (220-240 V x 0/50-60 Hz DC 176-280 V).
2. Use the DALI control to adjust the lighting as needed.

Maintenance

Regularly check for any signs of damage or wear and tear. Contact a professional if repairs are needed.

FAQ

• **Q: What should I do if the luminaire is not working?**

A: Check the power supply, and connections, and ensure proper installation. If issues persist, contact a qualified electrician for assistance.

• **Q: Can I modify the luminaire myself?**

A: No, any modifications to the luminaire should be done by a professional to avoid damage or safety hazards.

Application

- Performance floodlight with mounting box.
- For a variety of interior and exterior lighting applications.

Product Description

- Luminaire made of aluminum alloy, aluminum, and stainless steel
- BEGA Unidure® coating technology
- Color graphite or silver
- Clear safety glass
- Silicone gasket
- The reflector surface is made of pure aluminum
- BEGA Hybrid Optics®
- The rotation range of floodlight is 350°
- Swivel range -35°/+90°
- Mounting box with 2 fixing holes \varnothing 4.8 mm · 67 mm spacing 2 cable entries for through-wiring of mains supply cable \varnothing 7-10.5 mm, max. 5G 1.5@
- Connecting terminal 2.5@ with plug connection
- Earth conductor connection
- BEGA Ultimate Driver®
- Comply with flicker requirements by IEEE 1789,
- DIN IEC/TR 63158, DIN IEC/TR 61547-1
- LED power supply unit 220-240 V x 0/50-60 Hz
- DC 176-280 V
- DALI-controllable
- Number of DALI addresses: 1
- Basic insulation is provided between the hands and control cables
- BEGA Thermal Control®
- Temporary thermal regulation to protect temperature-sensitive components without switching off the luminaire
- Safety class I
- Protection class IP 65
- Dust-tight and protection against water jets
- Impact strength IK06
- Protection against mechanical impacts < 1 joule
-  – Conformity mark
- Wind catching area: 0.017 m²

- Weight: 1.4 kg
- This product contains light sources of energy efficiency class(es) E

Lighting technology

- Symmetrical wide beam light distribution
- Half beam angle 45°
- For special lighting applications, an optical filter can be used to change the symmetrical light cone into a flat beam light distribution.

Lamp

- Module connected wattage 10.2 W
- Luminaire connected wattage 11.6 W
- Rated temperature $t_a = 25\text{ °C}$
- Ambient temperature $t_a \text{ max} = 50\text{ °C}$

85 137 K3

- Module designation LED-1148/930
- Color temperature 3000 K
- Color rendering index CRI > 90
- Module luminous flux 1500 lm
- Luminaire luminous flux 1098 lm
- Luminaire luminous efficiency 94,7 lm/W

85 137 K4

- Module designation LED-1148/940
- Color temperature 4000 K
- Color rendering index CRI > 90
- Module luminous flux 1575 lm
- Luminaire luminous flux 1153 lm
- Luminaire luminous efficiency 99,4 lm/W

Safety

- The installation and operation of this luminaire are subject to national safety regulations.
- Installation and commissioning may only be carried out by a qualified electrician.
- The manufacturer accepts no liability for damage caused by improper use or installation.
- If subsequent modifications are made to the luminaire, the person responsible for these modifications shall be considered the manufacturer.

Overvoltage protection

- The electronic components installed in the luminaire are protected against overvoltage under DIN EN 61547.
- To achieve additional protection against e. g. transients, etc. we recommend separate overvoltage protection components.
- You can find them on our website at www.bega.com.
- The ideal protection of all electronic components installed in the luminaires is achieved by using bounce-free switching contacts such as an electronic relay (solid-state relay), e.g. BEGA 71 320.

Installation

- LEDs are high-quality electronic components!
- Please avoid touching the light output opening of the LED directly during installation or relamping.
- Undo the hexagon socket head screw (wrench size 3 mm) up to the stop and disassemble the mounting plate.
- Pass the power connecting cable through the cable entry in the mounting plate.
- Note the position of application of the mounting plate "arrow down".
- Fix the mounting plate with enclosed or any other suitable fixing material onto the mounting surface.
- Be sure to use the gasket rings supplied.
- Make an earth conductor connection.
- Push silicone sleeves over the lines and make an electrical connection to the terminal (plug connection).
- For digital control please use the 2-pole plug connector DA, DA.
- In case this connector is not used the luminaire will be operated at full light output.
- Push the plug into the coupler as far as it will go.
- Connect the floodlight unit's green and yellow protective earth conductor to the terminal marked  in the mounting plate.
- Make sure that the gasket is positioned correctly.

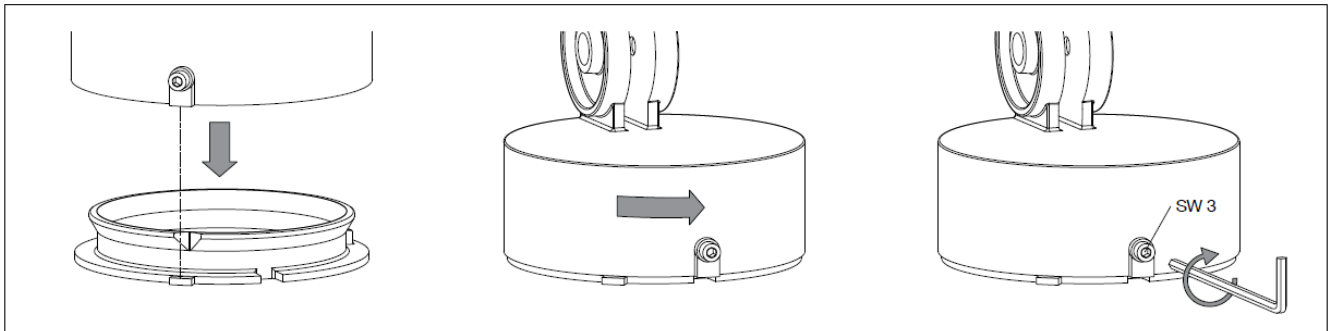

- Place the floodlight unit onto the mounting plate as displayed in the sketch, and align and screw together firmly.

Adjustment of beam direction:

- Undo the joint screw (hexagon socket head wrench size 5 mm) and set the desired beam direction.
- Tighten the joint screw.
- Torque = 7 Nm.

Dimension

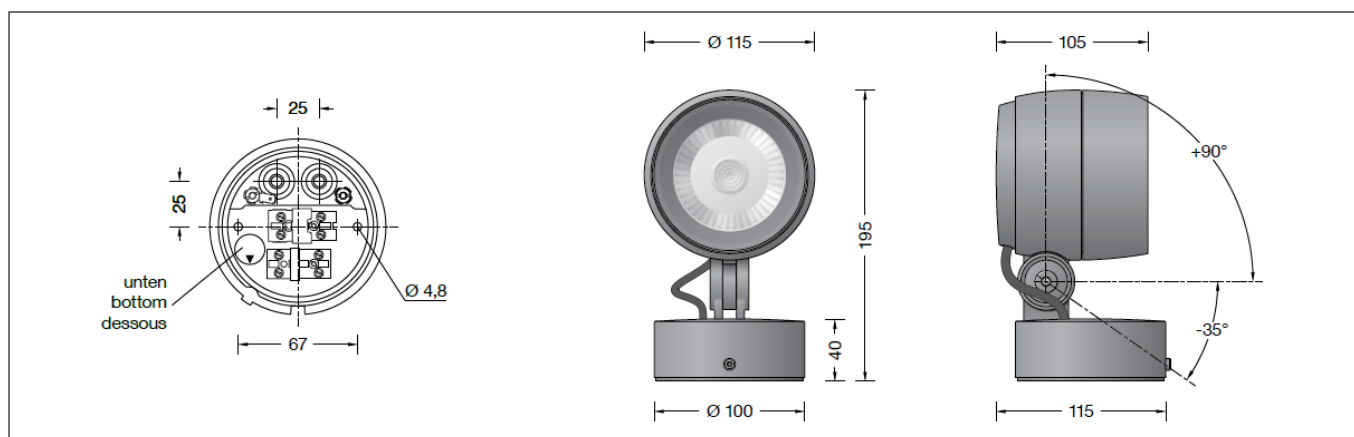

Cleaning and maintenance

- Clean the fixture regularly with solvent-free cleaners from dirt and deposits.
- Do not use high-pressure cleaners.

Maintenance

The connecting cable between the mounting box and floodlight has to be inspected for obvious damages and has to be replaced by a qualified electrician only.

Please note:

- Do not remove the desiccant bag from the luminaire housing.
- It is needed to remove residual moisture.

Replacing the LED module

- The designation of the LED module is noted on a separate label in the luminaire or on the underside of the specific LED module.
- The light color and light output of BEGA replacement modules correspond to those of the modules originally fitted. The replacement can be carried out by a qualified person using standard tools.
- Disconnect the system from the power supply.

Open the floodlight:

- Remove the trim ring along with the safety glass and reflector by twisting it anti-clockwise.
- Replace the LED module.
- Please follow the installation instructions for the LED module.
- Inspect and, if necessary, replace the luminaire gaskets.
- The defective glass must be replaced.
- Place the trim ring with glass and reflector on the floodlight housing so that the notches in the trim ring and luminaire housing sit on top of each other.
- Twist on the trim ring clockwise as far as the stop.

Accessories

- 71 289 Optical filter flat beam
- 71 331 Shield
- 71 336 Cylindrical shield

For the accessories, separate instructions for use can be provided upon request.

Spare Parts

- Trim ring graphite with glass 25 000 273
- Trim ring silver with glass 25 000 274
- LED power supply unit DEV-0515/300i
- LED module 3000 K LED-1148/930
- LED module 4000 K LED-1148/940
- Reflector 75 005 131
- Gasket housing 83 000 486
- Gasket mounting box 83 001 839
- Gasket trim ring 83 002 169

BEGA Gantenbrink-Leuchten KG · Postfach 31 60 · 58689 Menden · info@bega.com · www.bega.com .

Documents / Resources

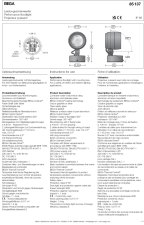
	<p>BEGA 85137K3 Performance Floodlight [pdf] Instruction Manual 85137K3, 85137K4, 85137K3 Performance Floodlight, 85137K3, Performance Floodlight, Flood light</p>
---	--

References

- BEGA **[BEGA · Das gute Licht.](#)**
- **[User Manual](#)**

[Manuals+.](#) **[Privacy Policy](#)**

This website is an independent publication and is neither affiliated with nor endorsed by any of the trademark owners. The "Bluetooth®" word mark and logos are registered trademarks owned by Bluetooth SIG, Inc. The "Wi-Fi®" word mark and logos are registered trademarks owned by the Wi-Fi Alliance. Any use of these marks on this website does not imply any affiliation with or endorsement.