

BEGA 85130 Performance Floodlight



# BEGA 85130 Performance Floodlight Instruction Manual

[Home](#) » [BEGA](#) » BEGA 85130 Performance Floodlight Instruction Manual 

## Contents

- 1 [BEGA 85130 Performance Floodlight](#)
- 2 [Product Information](#)
- 3 [Product Usage Instructions](#)
- 4 [FAQs](#)
- 5 [DIMENSION](#)
- 6 [Instructions for use](#)
- 7 [Application](#)
- 8 [Product Description](#)
- 9 [Installation](#)
- 10 [Cleaning Maintenance](#)
- 11 [Accessories](#)
- 12 [CONTACT](#)
- 13 [Documents / Resources](#)
  - 13.1 [References](#)

# BEGA

**BEGA 85130 Performance Floodlight**



## Product Information

- **Specifications:**

- **Product Name:** Performance Floodlight
- **Model Number:** 85 130
- **Power Consumption:** 8.4 W – 9.6 W
- **Colour Temperature:** 3000 K / 4000 K
- **Colour Rendering Index (CRI):** > 90
- **Luminous Flux:** 1265 lm – 1330 lm
- **Luminous Efficiency:** 96.5 lm/W – 101.5 lm/W

## Product Usage Instructions

- **Application:**

- The Performance Floodlight is designed for a variety of interior and exterior lighting applications.

- **Safety Information:**

- Installation and operation must comply with national safety regulations.
- Only a qualified electrician should perform the installation and commissioning.
- The manufacturer is not liable for damage due to improper use or installation. Any modifications should be done by authorized personnel.

- **Overvoltage Protection:**

- The luminaire's electronic components are protected against overvoltage according to DIN EN 61547.
- For additional protection against transients, separate overvoltage protection components are recommended, available on the manufacturer's website.

- **Installation:**

- LED components are sensitive; avoid direct contact with the light output opening during installation or relamping.

- To install, place the floodlight unit on the mounting plate as shown in the diagram, align it, and securely screw it together.
- To adjust the beam direction, loosen the joint screw with a 3 mm hexagon socket head wrench, set the desired direction, and tighten the screw to a torque of 2.5 Nm.

## FAQs

• **Q: Can I install the Performance Floodlight myself?**

- **A:** Installation and commissioning should only be done by a qualified electrician to ensure the safety and proper functioning of the product.

• **Q: What should I do if I need to make modifications to the luminaire?**

- **A:** Any modifications to the luminaire should be carried out by authorized personnel to maintain product integrity and safety standards.

## DIMENSION

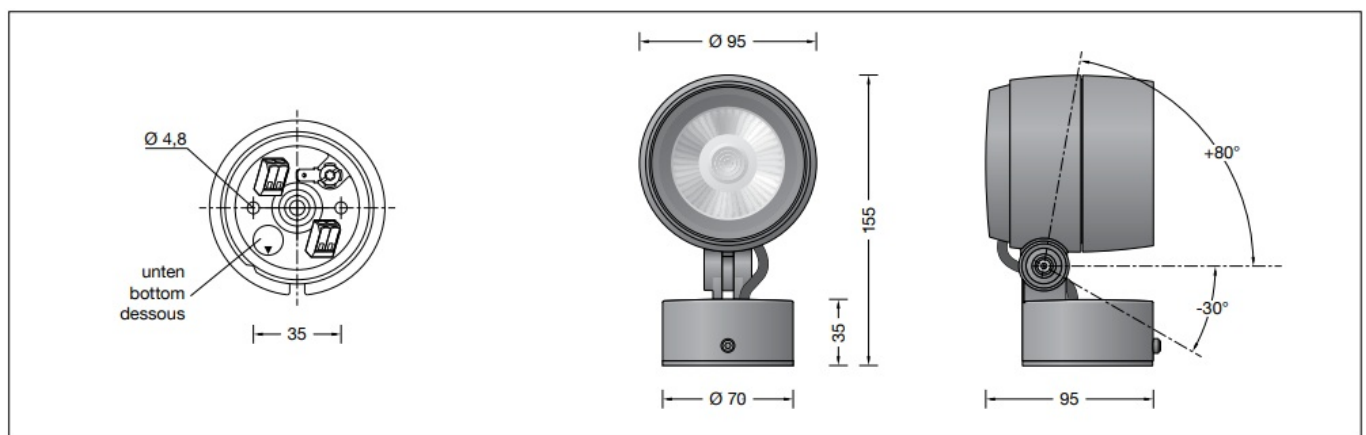

## Instructions for use

### Application

- Performance floodlight with mounting box.
- For a variety of interior and exterior lighting applications.

## Product Description

- Luminaire made of aluminium alloy, aluminium and stainless steel
- BEGA Unidure® coating technology
- Colour graphite or silver
- Clear safety glass
- Silicone gasket
- The reflector surface is made of pure aluminium
- BEGA Hybrid Optics®
- The rotation range of floodlight is 350°
- Swivel range -30°/+80°

- Mounting box with 2 fixing holes  $\varnothing$  4.8mm · 35mm spacing 1 cable entry for mains supply cable up to  $\varnothing$  10,5mm
- Connecting terminals 2.5@
- Earth conductor connection
- BEGA Ultimate Driver®
- Complies with flicker requirements by IEEE 1789,
- DIN IEC/TR 63158, DIN IEC/TR 61547-1
- LED power supply unit
- 220-240 V x 0/50-60 Hz
- DC 176-280 V
- Safety class I
- Protection class IP 65
- Dust-tight and protection against water jets Impact strength IK07
- Protection against mechanical impacts < 2 joule



- **CE** Conformity mark
- Wind catching area: 0.01 m<sup>2</sup>
- **Weight:** 0.9 kg
- This product contains light sources of energy efficiency class(es) D

## Lamp

- Module connected wattage 8.4 W
- Luminaire connected wattage 9.6 W
- Rated temperature  $t_a=25$  °C
- Ambient temperature  $t_a \text{ max}=50$  °C

## 85 130K3

- Module designation LED-1269/930
- Colour temperature 3000 K
- Colour rendering index CRI >90
- Module luminous flux 1265 lm
- Luminaire luminous flux 926 lm
- Luminaire luminous efficiency 96,5 lm/W

## 85 130K4

- Module designation LED-1269/940
- Colour temperature 4000 K
- Colour rendering index CRI >90
- Module luminous flux 1330 lm
- Luminaire luminous flux 974 lm
- Luminaire luminous efficiency 101,5 lm/W

## Safety

- The installation and operation of this luminaire are subject to national safety regulations.
- Installation and commissioning may only be carried out by a qualified electrician.
- The manufacturer accepts no liability for damage caused by improper use or installation.
- If subsequent modifications are made to the luminaire, the person responsible for these modifications shall be considered the manufacturer.

## Overvoltage protection

- The electronic components installed in the luminaire are protected against overvoltage by DIN EN 61547.
- To achieve additional protection against e.g. transients, etc. we recommend separate overvoltage protection components.
- You can find them on our website at [www.bega.com](http://www.bega.com).
- The ideal protection of all electronic components installed in the luminaires is achieved by using bounce-free switching contacts such as an electronic relay (solid-state relay), e.g. BEGA 71320.

## Installation

- LEDs are high-quality electronic components!
- Please avoid touching the light output opening of the LED directly during installation or relamping.
- Undo the hexagon socket head screw (wrench size 3mm) up to the stop and disassemble the mounting plate.
- Pass the power connecting cable through the cable entry in the mounting plate.
- Note the position of application of the mounting plate “arrow down”.
- Fix the mounting plate with enclosed or any other suitable fixing material onto the mounting surface.
- Be sure to use the gasket rings supplied.
- Make an earth conductor connection.
- Push silicone sleeves over the lines and make the electrical connection.
- Connect the floodlight unit's green and yellow protective earth conductor to the terminal marked  in the mounting plate. Make sure that the gasket is positioned correctly.

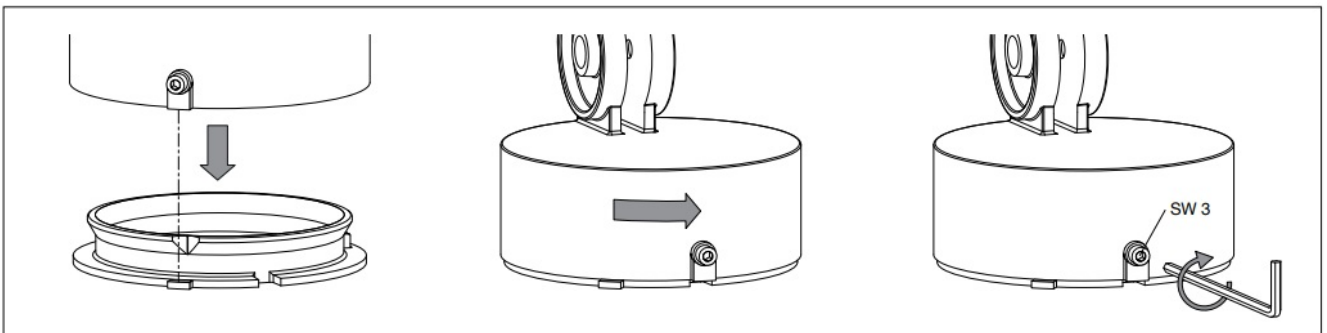

- Place the floodlight unit onto the mounting plate as displayed in the sketch, and align and screw together firmly.

## Adjustment of beam direction:

- Undo the joint screw (hexagon socket head wrench size 3 mm) and set the desired beam direction.
- Tighten the joint screw.

- Torque = 2.5Nm.

## **Cleaning Maintenance**

- Clean the luminaire regularly with solvent-free cleansers from dirt and deposits.
- Do not use high-pressure cleaners.

## **Maintenance**

- The connecting cable between the mounting box and floodlight has to be inspected for obvious damages and has to be replaced by a qualified electrician only.

### **Please note:**

- Do not remove the desiccant bag from the luminaire housing.
- It is needed to remove residual moisture.

## **Replacing the LED module**

- The designation of the LED module is noted on a separate label in the luminaire or on the underside of the specific LED module.
- The light colour and light output of BEGA replacement modules correspond to those of the modules originally fitted. The replacement can be carried out by a qualified person using standard tools.
- Disconnect the system from the power supply.

### **Open the floodlight:**

- Remove the trim ring along with the safety glass and reflector by twisting it anti-clockwise.
- Replace the LED module.
- Please follow the installation instructions for the LED module.
- Inspect and, if necessary, replace the luminaire gaskets.
- The defective glass must be replaced.
- Place the trim ring with glass and reflector on the floodlight housing so that the notches in the trim ring and luminaire housing sit on top of each other.
- Twist on the trim ring clockwise as far as the stop.

## **Accessories**

- **71 288** Optical filter flat beam
- **71330** Shield
- **71 335** Cylindrical shield

For the accessories, separate instructions for use can be provided upon request.

## **Spares**

- Trim ring graphite with glass 25 000 271
- Trim ring silver with glass 25 000 272
- LED power supply unit DEV-0447/250
- LED module 3000 K LED-1269/930
- LED module 4000 K LED-1269/940
- Reflector 75 005 132
- Gasket mounting box 83 000 659
- Gasket housing 2x 83 002 045

## CONTACT

- BEGA Gantenbrink-Leuchten KG
- Postfach 3160
- 58689 Menden
- [info@bega.com](mailto:info@bega.com).
- [www.bega.com](http://www.bega.com).

## Documents / Resources

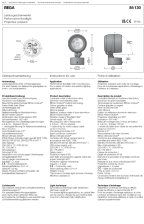
	<p><b><a href="#">BEGA 85130 Performance Floodlight</a></b> [pdf] Instruction Manual 85130, 85130 Performance Floodlight, Performance Floodlight, Floodlight</p>
---	--

## References

- <sup>BEGA</sup> [BEGA · Das gute Licht.](#)
- [User Manual](#)

[Manuals+](#), [Privacy Policy](#)

This website is an independent publication and is neither affiliated with nor endorsed by any of the trademark owners. The "Bluetooth®" word mark and logos are registered trademarks owned by Bluetooth SIG, Inc. The "Wi-Fi®" word mark and logos are registered trademarks owned by the Wi-Fi Alliance. Any use of these marks on this website does not imply any affiliation with or endorsement.