

BEGA 85 164 Performance Floodlight



BEGA 85 164 Performance Floodlight Instruction Manual

[Home](#) » [BEGA](#) » BEGA 85 164 Performance Floodlight Instruction Manual 

Contents

- [1 BEGA 85 164 Performance Floodlight](#)
- [2 Product Usage Instructions](#)
- [3 Product Specifications](#)
- [4 DIMENSION](#)
- [5 Instructions for use](#)
- [6 Product description](#)
- [7 Safety](#)
- [8 Installation](#)
- [9 Cleaning · Maintenance](#)
- [10 SPECIFICATION](#)
- [11 Accessories](#)
- [12 FAQ](#)
- [13 Documents / Resources](#)
 - [13.1 References](#)
- [14 Related Posts](#)

BEGA

BEGA 85 164 Performance Floodlight

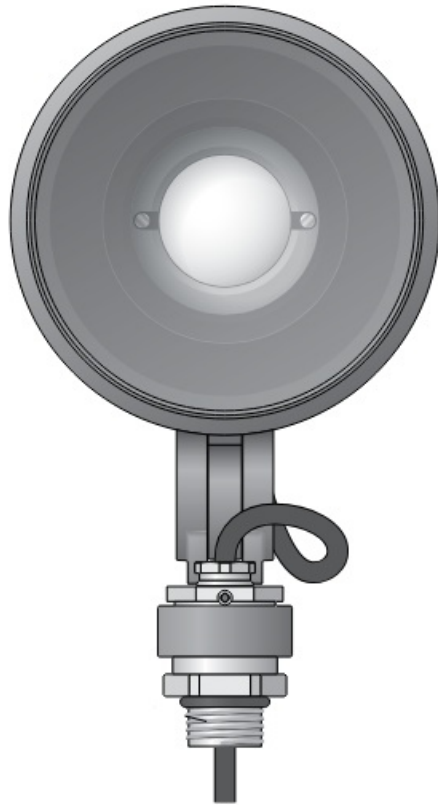

Product Usage Instructions

Safety

Follow national safety regulations for installation and operation. Only a qualified electrician should carry out installation and commissioning. The manufacturer is not liable for damage due to improper use or installation.

Overvoltage Protection

The luminaire has overvoltage protection as per DIN EN 61547. Additional protection against transients is recommended with separate components available on the manufacturer's website.

Adjusting the Half-Beam Angle

1. Remove the adjustment aid from the housing and retain it.
2. Place the trim ring with glass on the floodlight ensuring notches align.
3. Twist the trim ring clockwise until it reaches the stop position.

Planning Data

Data for corresponding half-beam angles are available for download on the manufacturer's website.

Product Specifications

Lamp	Module connected watt age	Luminaire connected wat tage	Rated temperat ure	Ambient temperat ure
LED-1218/9 30	10.8 W	12.5 W	25°C	45°C max

DIMENSION

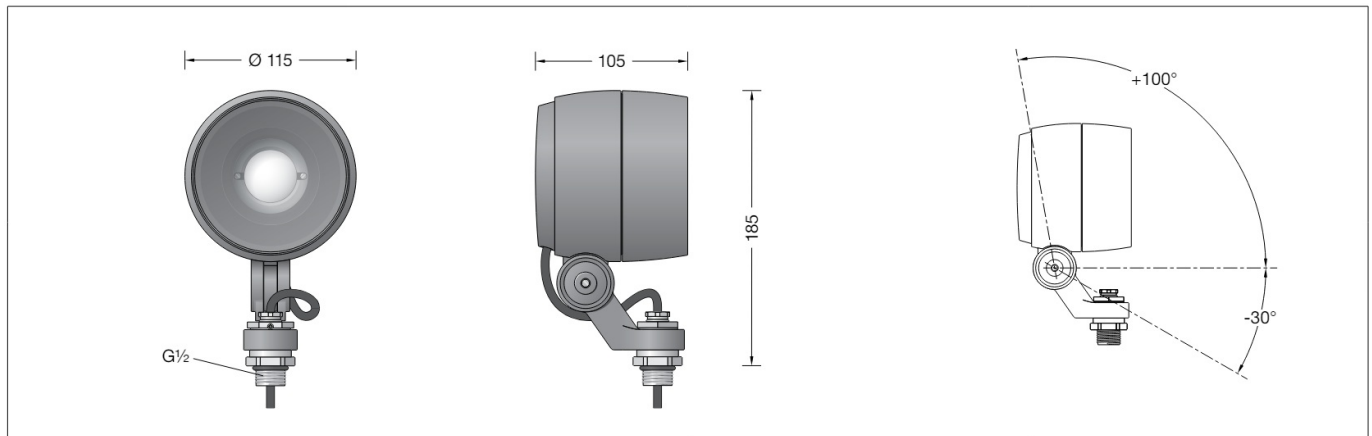

Instructions for use

Application

Performance floodlight with focusable zoom optics.

Half beam angle adjustable between 14° and 52° by turning the optical lens unit.

The floodlight can be screwed on by the customer with any G½ female thread by ISO 228 or with BEGA accessories.

For a variety of interior and exterior lighting applications.

Product description

- Luminaire made of aluminum alloy, aluminum, and stainless steel
- BEGA Unidure® coating technology
- Color graphite or silver
- Matt safety glass
- Silicone gasket
- Optical lens is made of silicate glass
- The rotation range of floodlight is 350°
- Swivel range -30°/+100°
- Mounting bracket with G½ threaded connection
- Thread length: 14 mm
- Connecting cable X05BQ-F 5 G 1 mm²
- Cable length 1 m
- BEGA Ultimate Driver®
- Complies with flicker requirements by IEEE 1789,
- DIN IEC/TR 63158, DIN IEC/TR 61547-1 LED power supply unit
- 220-240 V ~ x 0/50-60 Hz
- DC 176-280 V
- DALI-controllable
- Number of DALI addresses: 1
- Basic insulation is provided between the mains and control cables
- BEGA Thermal Control®
- Temporary thermal regulation to protect temperature-sensitive components without switching off the luminaire

- Safety class I
- Protection class IP 65
- Dust-tight and protection against water jets Impact strength IK07
- Protection against mechanical
- impacts < 2 joule
- CE – Conformity mark
 - **Wind catching area:** 0.014 m²
 - **Weight:** 1.4 kg
- This product contains light sources of energy efficiency class(es) E, F

Safety

- The installation and operation of this luminaire are subject to national safety regulations. Installation and commissioning may only be carried out by a qualified electrician.
- The manufacturer accepts no liability for damage caused by improper use or installation. If subsequent modifications are made to the luminaire, the person responsible for these modifications shall be considered the manufacturer.

Overvoltage protection

- The electronic components installed in the luminaire are protected against overvoltage by DIN EN 61547.
- To achieve additional protection against e. g. transients, etc. we recommend separate overvoltage protection components.
- You can find them on our website at: www.bega.com.

Installation

- Screw the floodlight G½ threaded connection firmly into the on-site G½ female thread or BEGA accessory.
- G½ threaded connection torque = 40 Nm. Secure the screw connection from loosening on site (if provided with locking screw S, see fig. A).
- Check the earth conductor connection between the G½ threaded connection and the on-site G½ female thread.

Adjust floodlight

- Undo the hexagon socket screw (wrench
- size 5 mm) and hexagon nut (wrench
- size 27 mm) and set the desired beam direction (see sketches B, C).

Torque:

- **Hexagon socket screw** = 7 Nm
- **Hexagon nut** = 35 Nm
- Secure bolted connection Gß against loosening by tightening the hexagon socket screws (wrench size 2 mm).

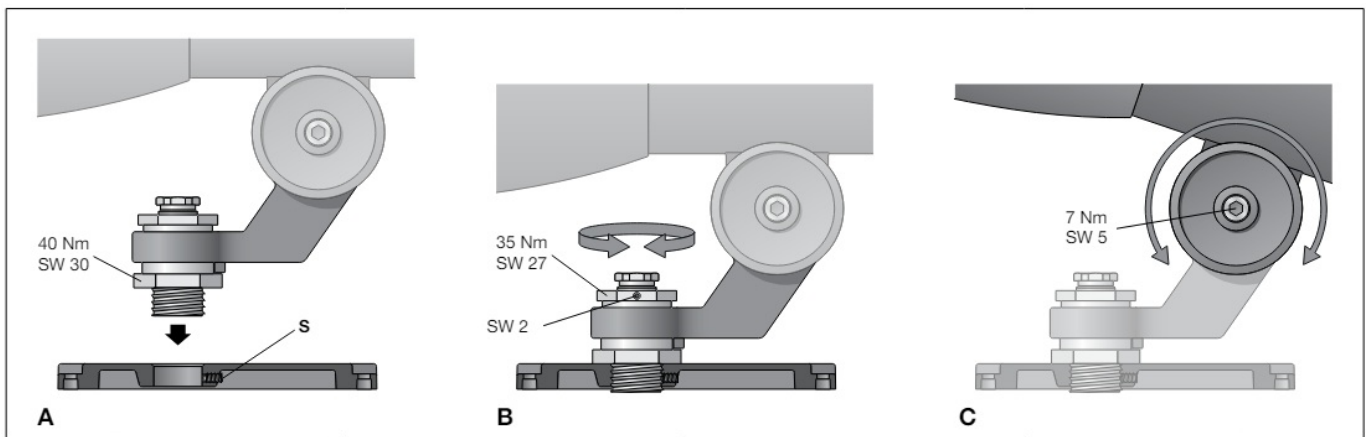

The electrical connection must be carried out with matching protection class and safety class, strain-relieved, with suitable connection terminals (not included in the scope of delivery) at the luminaire power supply cable.

Note the correct configuration of the main supply cable. The earth conductor is connected at the green-yellow () , the phase to the brown (L), and the neutral conductor to the blue (N) marked wire.

The connection of the control cables is achieved using both leads marked with DALI. In case these leads are not used the luminaire will be operated at full light output.

Cleaning · Maintenance

- Clean the luminaire regularly with solvent-free cleansers from dirt and deposits.
- Do not use high-pressure cleaners.

Adjusting the half-beam angle

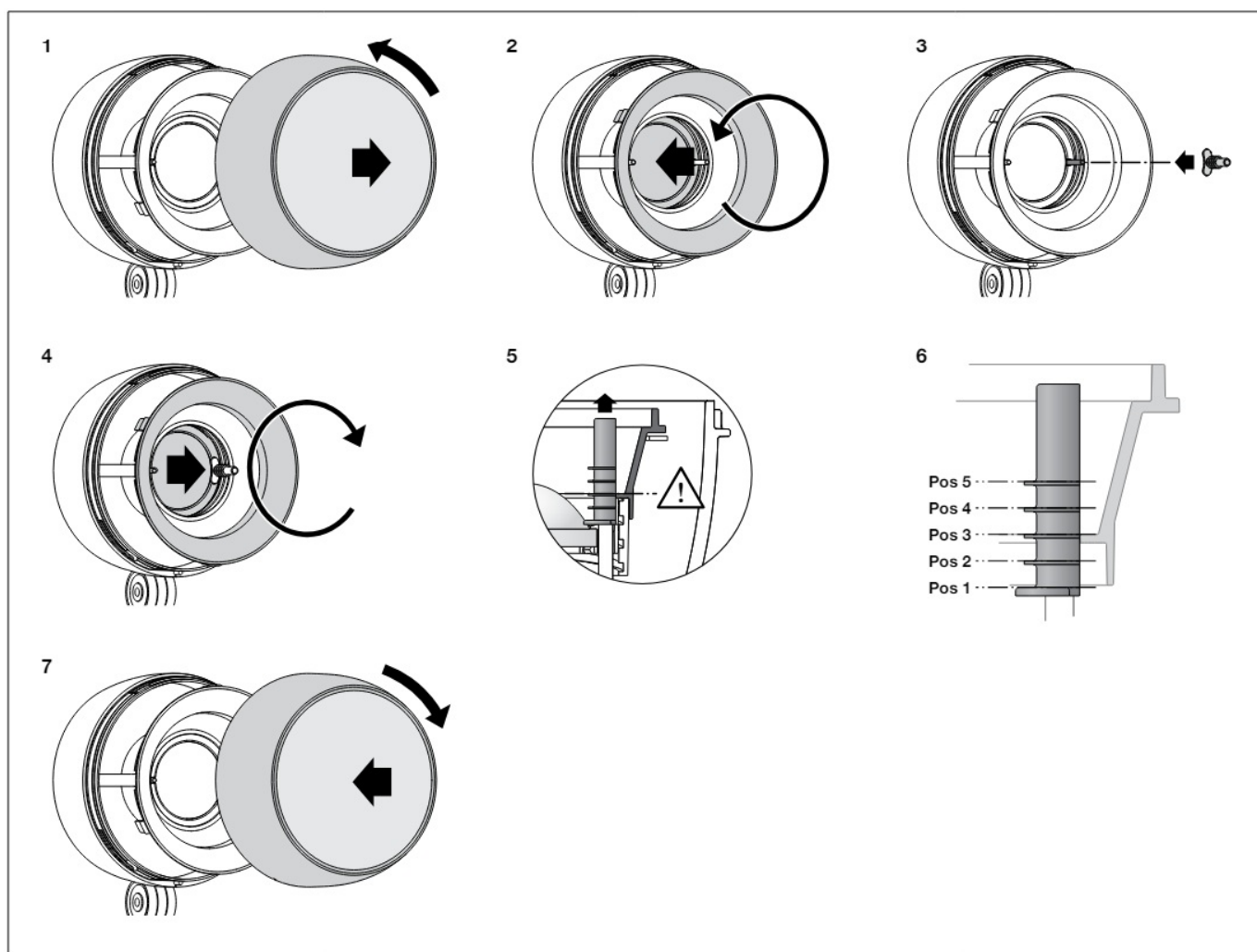

- Remove the trim ring along with the safety glass by twisting it anti-clockwise.
- The half-beam angle can be adjusted between 14° and 52° by turning the optical lens unit. Turn clockwise to decrease the half beam angle; anti-clockwise to increase it.
- The enclosed grey adjustment aid is used for simplified adjustment of the desired half-beam angle (pos. 1–5), especially for uniform adjustment of luminaires that are mounted in a line.
- To do this, turn the optical lens unit counterclockwise as far as it will go.
- Place the adjustment aid on the cylindrical pin as shown in the sketch and press it down.
- Turn the lens unit clockwise to the desired position (see table).

Pos.	β	K3	K4
1	14°	496 lm	525 lm
2	17°	602 lm	638 lm
3	25°	721 lm	764 lm
4	38°	793 lm	840 lm
5	52°	797 lm	844 lm

Remove the adjustment aid from the housing and retain it.

Place the trim ring with glass on the floodlight housing so that the notches in the trim ring and luminaire housing sit on top of each other. Twist on the trim ring clockwise as far as the stop.

Planning data for the corresponding half-beam angles are available for download on our website.

SPECIFICATION

Lamp

- Module connected wattage 10.8 W
- Luminaire connected wattage 12.5 W
- Rated temperature $t_a = 25\text{ }^{\circ}\text{C}$
- Ambient temperature $t_a \text{ max} = 45\text{ }^{\circ}\text{C}$

85 164 K3

- Module designation LED-1218/930
- Color temperature 3000 K
- Color rendering index CRI > 90
- Module luminous flux 1270 lm
- Luminaire luminous flux 797 lm
- Luminaire luminous efficiency 63,8 lm / W

85 164 K4

- Module designation LED-1218/940
- Color temperature 4000 K
- Color rendering index CRI > 90
- Module luminous flux 1345 lm
- Luminaire luminous flux 844 lm
- Luminaire luminous efficiency 67,5 lm / W

Please note:

- Do not remove the desiccant bag from the luminaire housing.
- It is needed to remove residual moisture.

Replacing the LED module

- The designation of the LED module is noted on a separate label in the luminaire or on the underside of the specific LED module.
- The light color and light output of BEGA replacement modules correspond to those of the modules originally fitted. The replacement can be carried out by a qualified person using standard tools.
- Disconnect the system from the power supply.
- Open the floodlight:
- Remove the trim ring along with the safety.
- glass and reflector by twisting it anti-clockwise.
- Replace the LED module.
- Please follow the installation instructions for the LED module.

- Inspect and, if necessary, replace the luminaire gaskets.
- The defective glass must be replaced.
- Place the trim ring with glass and reflector on the floodlight housing so that the notches in the trim ring and luminaire housing sit on top of each other.
- Twist on the trim ring clockwise as far as the stop.

Accessories

- 71 289 Optical filter flat beam
- 71 331 Shield
- 71 336 Cylindrical shield
- 70 214 Pole cap for pole ø 48 mm
- 70 248 Pole cap for pole ø 60 mm
- 70 245 Mounting box
- 70 252 General fastener
- 70 280 Tube clamp G½
- 70 283 Screw clamp
- 70 379 Crossbeam G½
- 70 889 Tension belt

For the accessories, separate instructions for use can be provided upon request.

Spares

- Trim ring graphite with glass 25 000 275
- Trim ring silver with glass 25 000 276
- LED power supply unit DEV-0515/300i
- LED module 3000 K LED-1218/930
- LED module 4000 K LED-1218/940
- Additional label 66 000 712
- Lens unit 75 004 801
- Gasket housing 83 000 486
- Gasket trim ring 83 002 169

MORE INFORMATION

- BEGA Gantenbrink-Leuchten KG · Postfach 31 60 · 58689 Menden
- info@bega.com
- www.bega.com

FAQ

- **Q: Can I remove the desiccant bag from the luminaire housing?**
 - A: No, the desiccant bag should not be removed as it is needed to remove residual moisture.

- **Q: Are there additional accessories available for this product?**
 - A: Yes, accessories such as optical filters and shields are available. Separate instructions for their use can be provided upon request.
-

Documents / Resources

	<p>BEGA 85 164 Performance Floodlight [pdf] Instruction Manual 85164AK4, 85164, 85 164 Performance Floodlight, 85 164, Performance Floodlight, Floodlight</p>
---	---

References

- BEGA [BEGA · Das gute Licht.](#)
- [User Manual](#)

[Manuals+.](#) [Privacy Policy](#)

This website is an independent publication and is neither affiliated with nor endorsed by any of the trademark owners. The "Bluetooth®" word mark and logos are registered trademarks owned by Bluetooth SIG, Inc. The "Wi-Fi®" word mark and logos are registered trademarks owned by the Wi-Fi Alliance. Any use of these marks on this website does not imply any affiliation with or endorsement.