



BEGA 84 867 Performance Floodlight RGBW Instruction Manual

[Home](#) » [BEGA](#) » BEGA 84 867 Performance Floodlight RGBW Instruction Manual 

Contents

- 1 BEGA 84 867 Performance Floodlight RGBW
- 2 Product Information
- 3 Product Usage Instructions
- 4 Technical amendments reserved
- 5 Instructions for use
- 6 Product description
- 7 Overvoltage protection
- 8 Installation
- 9 Maintenance
- 10 Documents / Resources
 - 10.1 References
- 11 Related Posts

BEGA

BEGA 84 867 Performance Floodlight RGBW



Product Information

Specifications

- Product Name: Performance floodlight RGBW
- Color: RGBW
- Mounting: With mounting box
- Recommended Usage: Interior and exterior lighting applications
- Luminaire Protection: Overvoltage protection in accordance with DIN EN 61547
- Safety Regulations: Installation and operation subject to national safety regulations
- LED Module Power: 20.8 W
- Luminaire Power: 24 W
- Color Temperature of White LED: 4000 K
- Luminaire Luminous Flux: 1259 lm
- Luminaire Luminous Efficiency: 52.5 lm/W

Product Usage Instructions

Installation

1. A qualified electrician should carry out the installation and commissioning of the luminaire.
2. Avoid touching the light output opening of the LED directly during installation or relamping.
3. To adjust the beam direction, undo the joint screw using a hexagon socket head wrench size 5 mm and set the

desired beam direction.

4. Tighten the joint screw with a torque of 7 Nm.
5. Do not remove the desiccant bag from the luminaire housing as it is needed to remove residual moisture.

Maintenance

The connecting cable between the mounting box and floodlight should be inspected for obvious damages and replaced by a qualified electrician if necessary.

Accessories

- Trim Ring Graphite with Glass: 25 000 147
- Trim Ring Silver with Glass: 25 000 148
- LED Power Supply Unit: DEV-0418/200i
- LED Module: LED-1161/RGBW
- Gasket Housing: 83 000 521
- Gasket Mounting Box: 83 001 839
- Gasket Glass Frame: 83 001 952

FAQ

- **Q: What is the color temperature of the white LED?**

A: The color temperature of the white LED is 4000 K.

- **Q: What is the luminaire luminous flux?**

A: The luminaire luminous flux is 1259 lm.

- **Q: What is the power consumption of the LED module and luminaire?**

A: The LED module has a power consumption of 20.8 W and the luminaire has a power consumption of 24 W.

- **Q: Can I remove the desiccant bag from the luminaire housing?**

A: No, the desiccant bag should not be removed as it is needed to remove residual moisture.

- **Q: Who should carry out the installation and commissioning of the luminaire?**

A: The installation and commissioning should be carried out by a qualified electrician.

Technical amendments reserved

Performance floodlight RGBW

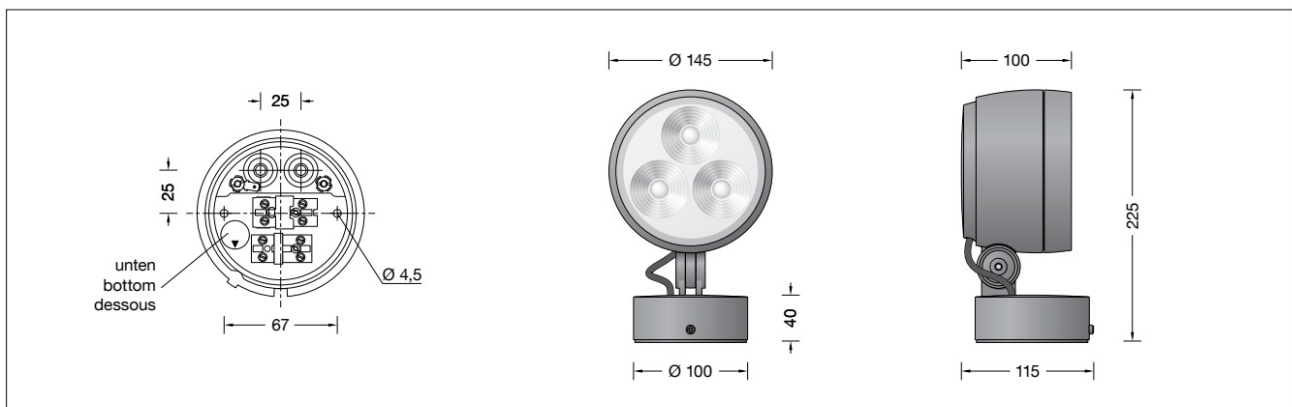



Instructions for use

Application

- Performance floodlight for additive colour mixing RGBW with mounting box.
- We recommend the use of BEGA DALI system components.
- For a variety of interior and exterior lighting applications.

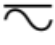
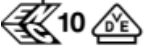
Product description

- Floodlight made of aluminium alloy, aluminium and stainless steel
- BEGA Unidure® coating technology
- Colour graphite or silver
- Safety glass with optical structure
- Silicone gasket
- Reflector surface made of pure aluminium Rotation range of floodlight 350°
- Swivel range -30°/+90°
- Mounting box with 2 fixing holes
- \varnothing 4.5 mm · 67 mm spacing
- 2 cable entries for through-wiring of mains supply cable \varnothing 7-10.5 mm, max. 5 G 1.5@ Connecting terminal 2.5@ with plug connection
- Earth conductor connection
- BEGA Ultimate Driver®
- LED power supply unit
- 220-240 V  0/50-60 Hz
- DC 176-264 V
- DALI-controllable (DT8, RGBWAF, xy) Number of DALI addresses: 1
- Basic insulation is provided between the mains and control cables
- BEGA Thermal Control®
- Temporary thermal regulation to protect temperature-sensitive components without switching off the luminaire
- Safety class I
- Protection class IP 65
- Dust-tight and protection against water jets Impact strength IK08
- Protection against mechanical impacts < 5 joule
-  Safety mark
-  – Conformity mark
- Wind catching area: 0.025 m²
- Weight: 2.0 kg
- This product contains light sources of energy efficiency class(es) F

Overvoltage protection

The electronic components installed in the luminaire are protected against overvoltage in accordance with

DIN EN 61547.

To achieve an additional protection against e. g. transients, etc. we recommend separate overvoltage protection components.

You can find them on our website at www.bega.com.

Safety

- The installation and operation of this luminaire are subject to national safety regulations. Installation and commissioning may only be carried out by a qualified electrician.
- The manufacturer accepts no liability for damage caused by improper use or installation. If subsequent modifications are made to the luminaire, the person responsible for these modifications shall be considered the manufacturer.

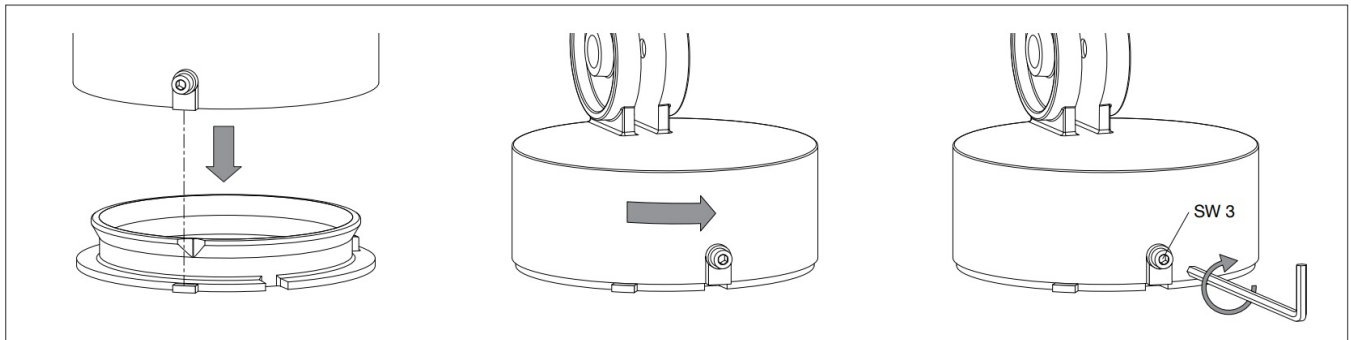

Installation

- LED are high-quality electronic components! Please avoid touching the light output opening of the LED directly during installation or relamping.
- Undo hexagon socket head screws (wrench size 3 mm) at the mounting box and remove mounting plate.
- Pass the power connecting cable through the cable entry in the mounting plate.
- Fix the mounting plate with enclosed or any other suitable fixing material onto the mounting surface.
- Be sure to use the gasket rings supplied. Establish the earth conductor connection at the terminal of the mounting plate marked with 1. Push silicone hoses over connecting wires and make the electrical connection at the terminal marked L and N (plug-in device).
- The terminals marked DA, DA (plug-in device) are to be used for digital control purposes.
- If these terminals are not used, the luminaire will operate at full light output.
- Place the earth conductor plug connector from the luminaire housing onto the mounting plate. Then press both plugs (L, N and DA, DA) firmly into the plug-in devices of the mounting plate. Make sure that gasket is positioned correctly. Place floodlight unit onto the mounting plate as displayed in the sketch, align and screw together firmly.

Adjustment of beam direction

- Undo joint screw (hexagon socket head wrench size 5 mm) and set the desired beam direction.
- Tighten the joint screw.
- Torque = 7 Nm.

Please note

Do not remove the desiccant bag from the luminaire housing.
It is needed to remove residual moisture.

Lamp

- Module connected wattage 20.8 W
- Luminaire connected wattage 24 W
- Rated temperature $t_a = 25\text{ °C}$
- Ambient temperature $t_a \text{ max} = 35\text{ °C}$
- Module designation LED-1161/RGBW
- Colour temperature of the white LED 4000 K
- Luminaire luminous flux 1259 lm
- Luminaire luminous efficiency 52,5 lm / W

Lighting technology

- Symmetrical wide beam light distribution
- Half beam angle 50°
- Cleaning · Maintenance
- Clean luminaire regularly with solvent-free cleansers from dirt and deposits.
- Do not use high pressure cleaners.

Maintenance

The connecting cable between mounting box and floodlight has to be inspected regarding obvious damages and has to be replaced by a qualified electrician only.

Replacing the LED module

- The designation of the LED module is noted on a label in the luminaire.
- The light colour and light output of BEGA replacement modules correspond to those of the modules originally fitted. The module can be replaced by qualified persons using standard tools.
- Disconnect the system.

Open the floodlight

- Undo locking pin (hexagon socket head wrench size 2.5 mm) on the back side of the floodlight housing.
- Remove the trim ring along with the safety glass and reflector by twisting it counter-clockwise.
- Replace LED module.
- Please follow the installation instructions for the LED module.
- Inspect and, if necessary, replace the luminaire gaskets.
- Defective glass must be replaced.
- Place trim ring with glass and reflector on the floodlight housing in such a way that the notches in the trim ring and floodlight housing align on top to each other.
- Twist on the trim ring clockwise as far as the stop. Tighten locking pin.

Accessories

71 118 Shield

A separate instructions for use can be provided upon request.

Spares

- Trim ring graphite with glass 25 000 147
- Trim ring silver with glass 25 000 148
- LED power supply unit DEV-0418/200i
- LED module LED-1161/RGBW
- Gasket housing 83 000 521
- Gasket mounting box 83 001 839
- Gasket glass frame 83 001 952

BEGA Gantenbrink-Leuchten KG · Postfach 31 60 · 58689 Menden · info@bega.com · www.bega.com

Documents / Resources

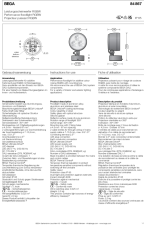
	<p>BEGA 84 867 Performance Floodlight RGBW [pdf] Instruction Manual 84867 Performance Floodlight RGBW, 84867, Performance Floodlight RGBW, Floodlight RGBW, RGBW</p>
---	--

References

- ^{BEGA} [BEGA · Das gute Licht.](#)
- [User Manual](#)