

BEGA 71332A Shield

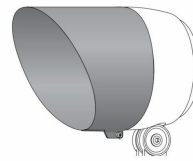

## BEGA 71332A Shield Instruction Manual

[Home](#) » [BEGA](#) » BEGA 71332A Shield Instruction Manual 

### Contents

- [1 BEGA 71332A Shield](#)
- [2 Product Usage Instructions](#)
- [3 FAQ](#)
- [4 Instructions for use](#)
- [5 Documents / Resources](#)
  - [5.1 References](#)

# BEGA

### BEGA 71332A Shield

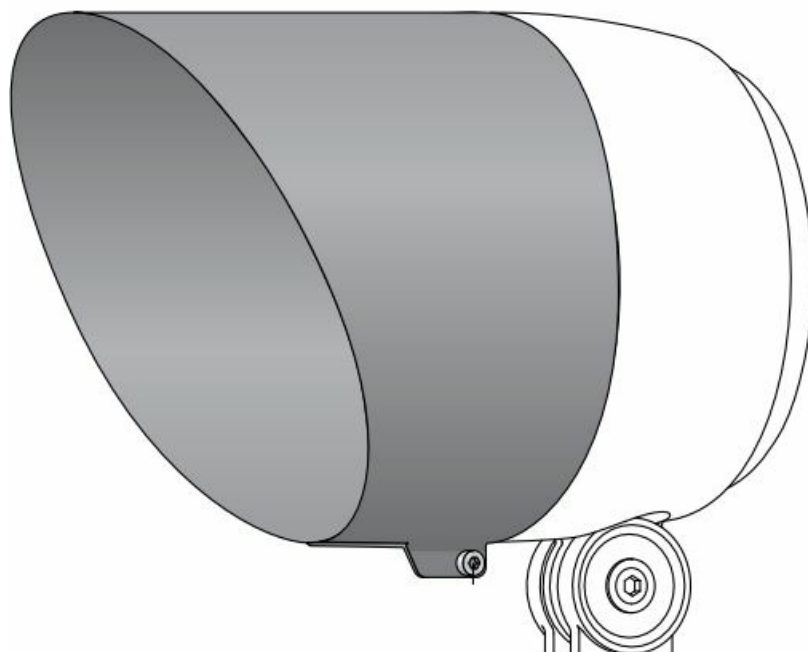

## Specifications

- Material: Stainless Steel
- Steel Grade: 1.4301
- Product Description: Surround made of stainless steel

## Product Usage Instructions

### Installation

1. Undo the hexagon socket screw (wrench size 3 mm).
2. Insert the shield into the groove in the floodlight housing.
3. Align the shield to the desired position.
4. Secure the shield in place by tightening the hexagon socket screw.

### FAQ

#### **Q: Is the stainless steel surround durable?**

A: Yes, the surround is made of high-quality stainless steel (Steel Grade 1.4301) for durability and longevity.

#### **Q: Can modifications be made to the luminaire?**

A: Modifications to the luminaire should not be made without consulting the manufacturer. Any modifications made without authorization may void the warranty and safety standards.

### Technical amendments reserved

#### Shield

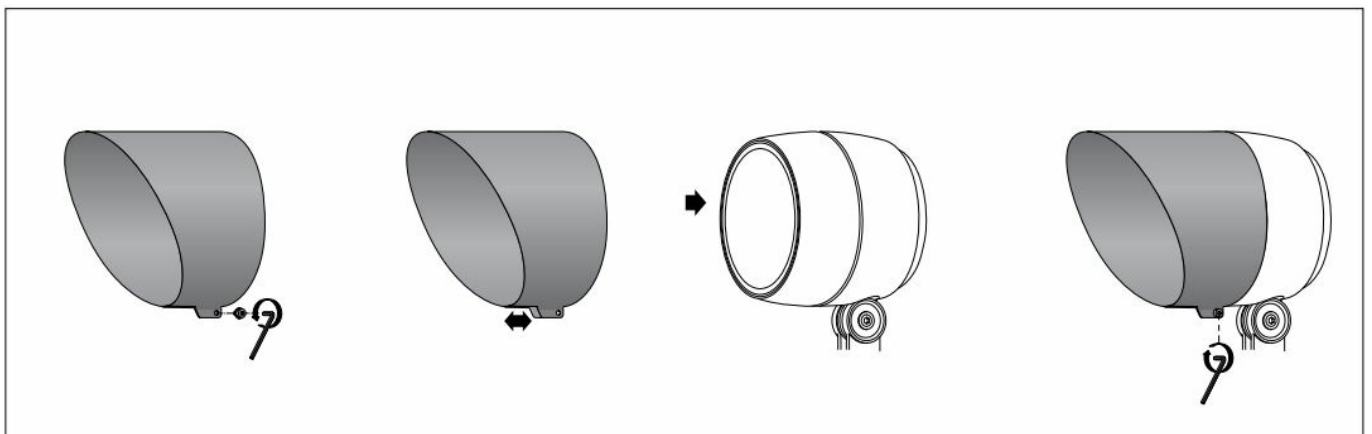

## Instructions for use

### Application

The shield can be installed by 360° and prevents lateral glare from one direction up to 45°.

suitable for BEGA performance floodlights

85 126 · 85 132 · 85 138 · 85 143 · 85 145  
85 147 · 85 150 · 85 155 · 85 160 · 85 165  
85 167 · 85 169 · 85 173 · 85 175 · 85 232  
85 233 · 85 238 · 85 239

### Product description

Surround made of stainless steel Steel grade no. 1.4301 Colour graphite or silver c – Conformity mark

**Wind catching area:** 0.01 m<sup>2</sup>

**Weight:** 0.15 kg

### Safety

The manufacturer accepts no liability for damage caused by improper use or installation. If subsequent modifications are made to the luminaire, the person responsible for these modifications shall be considered the manufacturer.

### Installation

Undo the hexagon socket screw (wrench size 3 mm) and insert the shield into the groove in the floodlight housing. Align the shield and secure it in place.

BEGA Gantenbrink-Leuchten KG · Postfach 31 60 · 58689 Menden · [info@bega.com](mailto:info@bega.com) · [www.bega.com](http://www.bega.com)

---

## Documents / Resources

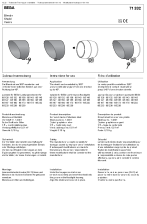
	<p><a href="#">BEGA 71332A Shield</a> [pdf] Instruction Manual 71332A Shield, 71332A, Shield</p>
---	--

## References

- BEGA [BEGA · Das gute Licht.](#)
- [User Manual](#)

[Manuals+](#), [Privacy Policy](#)

This website is an independent publication and is neither affiliated with nor endorsed by any of the trademark owners. The "Bluetooth®" word mark and logos are registered trademarks owned by Bluetooth SIG, Inc. The "Wi-Fi®" word mark and logos are registered trademarks owned by the Wi-Fi Alliance. Any use of these marks on this website does not imply any affiliation with or endorsement.