



BEGA 71148 Smart Rotary Rotary Dimmer with ZigBee Instruction Manual

[Home](#) » [BEGA](#) » BEGA 71148 Smart Rotary Rotary Dimmer with ZigBee Instruction Manual 

BEGA 71148 Smart Rotary Rotary Dimmer with ZigBee



Contents

- [1 OVERVIEW](#)
- [2 Application](#)
- [3 Safety](#)
- [4 EU Declaration of Conformity](#)
- [5 Product description](#)
- [6 Installation](#)
- [7 Range](#)
- [8 Commissioning](#)
- [9 Operating modes](#)
- [10 Reset to factory settings](#)
- [11 Explanation of symbols](#)
- [12 Documents / Resources](#)
 - [12.1 References](#)
- [13 Related Posts](#)

OVERVIEW

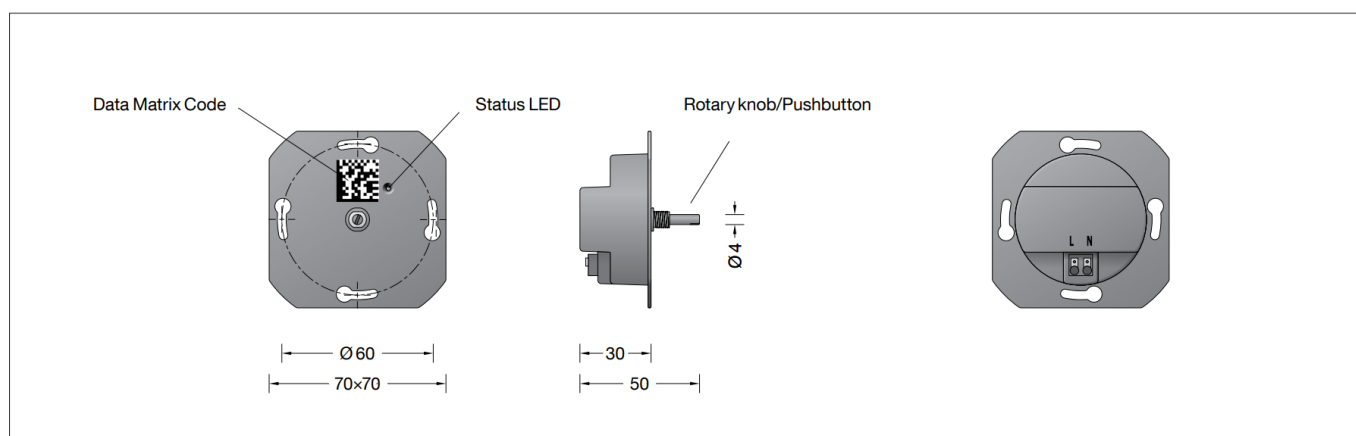

Application

The BEGA Smart Rotary Dimmer is a wireless dimmer with integrated aerial for switching, dimming and regulating the light colour of luminaires. It only requires a connection to the power supply. For installation in switching and cavity boxes. The insert is supplied without a cover and can be used in conjunction with the switch ranges of most well-known manufacturers. Once successfully installed, the switch is configured in the BEGA Smart app. The BEGA Smart app is available for free for iOS and Android.

Safety

The installation and operation of this accessory are subject to national safety regulations. Installation and commissioning may only be carried out by a qualified electrician. The manufacturer accepts no liability for damage caused by improper use or installation. If modifications are subsequently made to the accessory, the person who makes these modifications shall be considered the manufacturer.

EU Declaration of Conformity

BEGA Gantenbrink-Leuchten KG hereby declares that the radio system type 71 148 complies with Directive 2014/53/EU (RED). The complete text of the EU Declaration of Conformity is available at the following Internet address: <https://www.bega.com/conf/de/71148>

Product description

Wireless rotary dimmer for installation in switching and cavity boxes. Housing made of synthetic material. Suitable for the covers and rotary knobs of all well-known manufacturers. Some covers require the accompanying adapter. Rotary knob for adjusting the brightness and colour of tunable white or RGBW luminaires. Integrated pushbutton with configurable functions. Compatible with all products from the BEGA Smart system. Certified for use with Zigbee 3.0. Configuration via the BEGA Smart app. Advanced mode can be activated in the BEGA Smart app. In this mode, the rotary and push functions on the Smart Rotary Dimmer can be configured as desired. With integrated aerial. Zigbee transmission power $\leq +10\text{dBm}$. Bluetooth transmission power $\leq +10\text{ dBm}$. Radio frequency 2.4 GHz. Range up to 30 m – (depending on the spatial conditions). Standby output: $P_0 = 0.2\text{ W}$. Output: $P = \text{maximum } 2.5\text{ W}$. Connection terminals 0.5–1.5@. Stripping length: 8 mm. Supply voltage: 220–240 V y 50–60 Hz. Operating temperature: -20°C to 65°C . RoHS-compliant WEEE 2012/19/EU c – Conformity mark. Weight: 0.05 kg.

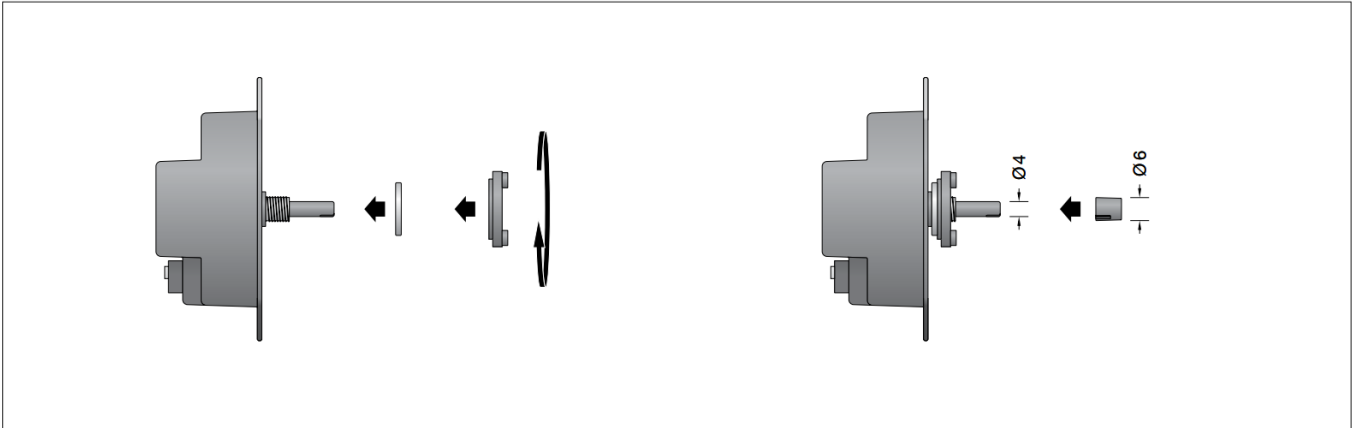

Installation

Electrical connection:

Make sure that the power supply matches the input voltage range indicated on the device's type plate.

Caution:

The device is exclusively intended for use within lightning protection zones 2 and 3 (LPZ2 and LPZ3) and meets the requirements of overvoltage category II. The Smart Rotary Dimmer is electrically connected to the terminals labelled L and N. Insert, align and secure the Smart Rotary Dimmer in the switch or cavity box. When installing a cover from a well-known manufacturer provided by the customer, use the accompanying adapters if necessary (see sketch). In order to keep the data matrix code accessible during commissioning, we recommend that the cover is only fitted upon successful installation. **Please retain the other enclosed QR codes in your on-site documentation (e.g. Instructions for use at top of Page 1).**

Range

The Zigbee radio range between individual devices is usually 30 m, with ambient conditions playing a decisive role. Significantly larger ranges can be achieved in an open field environment. We recommend the additional use of Zigbee router module 71 055 in adverse conditions.

Commissioning

Once the Smart Rotary Dimmer has been installed, it is configured using the BEGA Smart app. For successful configuration, the Smart Rotary Dimmer must be in factory settings. This status is indicated by the green flashing status LED. Install and start the BEGA Smart app. In the app, select the "Smart Rotary Dimmer" and follow the instructions. Upon successful installation, the status LED will go out.



Operating modes

The Smart Rotary Dimmer has two different control modes:

1. Basic mode (factory settings)

The basic mode is preset when the dimmer is delivered and can be used after successful installation and set-up in the app. Pushing the rotary knob switches the luminaires and devices in question on and off. The brightness can be adjusted by turning it clockwise or counter-clockwise.

2. Advanced mode

The advanced mode offers additional operating functions and lets you configure your own commands. It can be activated via the BEGA Smart app.

Reset to factory settings

If the installation is not carried out correctly, or access via the BEGA Smart app is no longer possible, the Smart Rotary Dimmer should be reset to factory settings. To reset the Smart Rotary Dimmer to factory settings, you must first remove the cover. Now give the pushbutton three short pushes followed by one long push (approx. 10 seconds) until the status LED flashes green. The dimmer has now been reset to factory settings. The LED will flash green until a new configuration is initiated.

Explanation of symbols



Caution, risk of electric shock



For indoor use only



Conformity mark



Dispose of the device in an environmentally friendly manner



Zigbee 3.0-certified



Bluetooth

BEGA

Documents / Resources

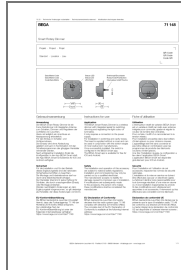

[BEGA 71148 Smart Rotary Dimmer with ZigBee](#) [pdf] Instruction Manual
71148, Smart Rotary Dimmer with ZigBee, 71148 Smart Rotary Dimmer with ZigBee

References

- BEGA [BEGA Â· Das gute Licht.](#)

[Manuals+.](#)