



# BEGA 50894.1 STUDIO LINE LED luminaire Instruction Manual

[Home](#) » [BEGA](#) » BEGA 50894.1 STUDIO LINE LED luminaire Instruction Manual 

## Contents

- [1 BEGA 50894.1 STUDIO LINE LED luminaire](#)
- [2 Product Information:](#)
  - [2.1 Product Usage Instructions](#)
  - [2.2 Recessed ceiling luminaire for indoor use](#)
  - [2.3 Instructions for use](#)
  - [2.4 Installation](#)
- [3 Documents / Resources](#)
  - [3.1 References](#)
- [4 Related Posts](#)

# BEGA

## BEGA 50894.1 STUDIO LINE LED luminaire



### Product Information:

- Safety: The installation and operation of this luminaire must be done according to national safety regulations. Only a qualified electrician should carry out the installation and commissioning.

The manufacturer is not liable for any damage caused by improper use or installation. If any modifications are made to the luminaire, the person responsible for those modifications is considered the manufacturer.

- Overvoltage Protection: The electronic components in the luminaire are protected against overvoltage according to DIN EN 61547. To provide additional protection against transients, it is recommended to use separate overvoltage protection components, which can be found on the manufacturer's website at [www.bega.com](http://www.bega.com).
- Lamp Module Connected Wattage: 42.6 W
- Luminaire Connected Wattage: 47.6 W
- Rated Temperature: 25°C to 45°C
- Ambient Temperature: 25°C to 45°C
- Lamp: LED-0805/930
- Colour Temperature: 3000 K
- Colour Rendering Index (CRI): >90
- Module Luminous Flux: 6135 lm
- Luminaire Luminous Flux: 4254 lm
- Luminaire Luminous Efficiency: 89.4 lm/W

## Product Usage Instructions

1. Connect the luminaire to the LED power supply unit.
2. Guide the LED power supply unit through the opening in the ceiling and position it on the suspended ceiling.
3. The recessed opening is covered by the frame of the luminaire housing.
4. Fix the installation housing in the recessed opening using three adjustable springs.
5. Ensure that the luminaire housing and external LED power supply unit are not covered by any heat insulating materials.
6. Place the synthetic diffuser onto the luminaire housing, ensuring that the cam pins fit into the notches of the synthetic diffuser.
7. Screw in the synthetic diffuser by turning it clockwise to achieve a safe and vibration-resistant holding.
8. To release the synthetic diffuser from the luminaire housing, turn it counter-clockwise.
9. The power supply units provided are suitable for operating only one LED luminaire.
10. For accessories, a separate instructions for use can be provided upon request.

**Note:** The user manual provides additional information and instructions for specific parts and replacements. Please refer to the manual for further details.

## Recessed ceiling luminaire for indoor use

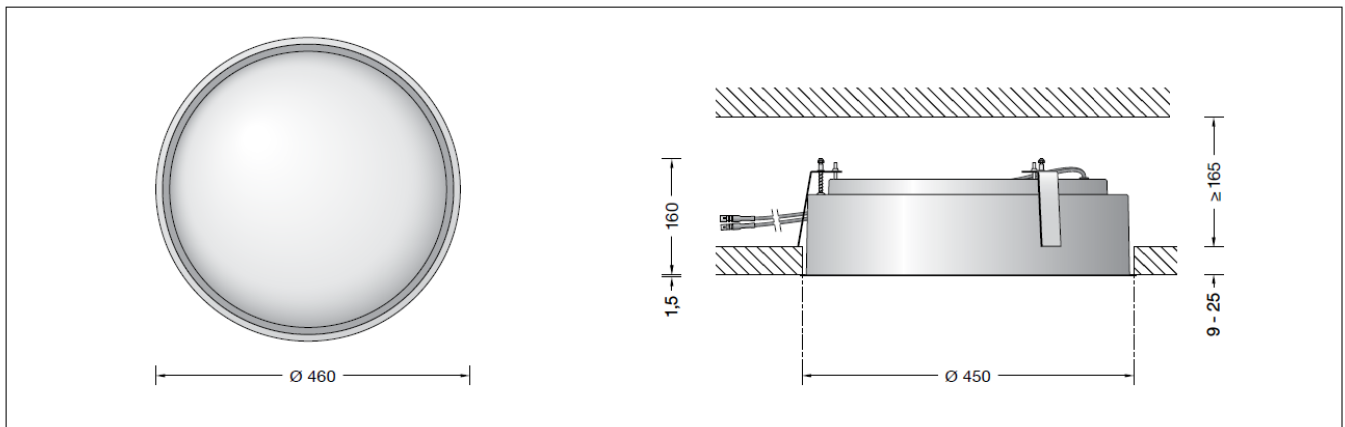

## Instructions for use

### Application

Recessed ceiling luminaire · indoor luminaire with impact resistant synthetic diffuser, translucent white and aluminium housing for connection to an external LED power supply unit.  
For installation in suspended ceilings of 9-25 mm in interior applications.

### Product description

- Recessed ceiling luminaire downlight
- STUDIO LINE« without power supply unit Luminaire housing made of aluminium inside hue white
- Impact resistant synthetic diffuser, translucent-white, with bayonet closure
- Recessed opening Ø 450 mm
- Required installation depth 165 mm Luminaire housing with 3 fastening springs and guide screws
- 2 connecting cables with strain relief and plug connector system for BEGA power supply unit, on/off or DALI
- Safety class III 
- **CE** – Conformity mark
- **Weight:** 3.1 kg

This product contains light sources of energy efficiency classes E

### Safety

The installation and operation of this luminaire are subject to national safety regulations. Installation and commissioning may only be carried out by a qualified electrician.

The manufacturer accepts no liability for damage caused by improper use or installation. If subsequent modifications are made to the luminaire, the person responsible for these modifications shall be considered the manufacturer.

### Overvoltage protection

The electronic components installed in the luminaire are protected against overvoltage in accordance with DIN EN 61547.

To achieve an additional protection against e. g. transients, etc. we recommend separate overvoltage protection components.

You can find them on our website at [www.bega.com](http://www.bega.com).

### Lamp

- Module connected wattage 42.6 W
- Luminaire connected wattage 47.6 W
- Rated temperature  $t_a = 25\text{ }^{\circ}\text{C}$
- Ambient temperature  $t_a \text{ max} = 45\text{ }^{\circ}\text{C}$

### 50 894.1 K3

- Module designation LED-0805/930
- Colour temperature 3000 K
- Colour rendering index CRI > 90
- Module luminous flux 6135 lm
- Luminaire luminous flux 4254 lm
- Luminaire luminous efficiency 89,4 lm / W

## Installation



Luminaire housing must not be installed in heat-insulating material.

A separate power supply unit is required to operate the luminaire.

For connection to external LED power supply unit – accessory 13 179 or 13 175—the luminaire is equipped with two 2-pin connectors.

Observe the instructions for use for LED power supply units.

LED are high-quality electronic components! Please avoid touching the light output opening of the LED directly during installation or relamping.

Connect to the LED power supply unit.

Guide the LED power supply unit through the opening in the ceiling and position it on the suspended ceiling.

The recessed opening is covered by the frame of the luminaire housing.

Fixing of the installation housing in the recessed opening is achieved by using three adjustable springs.

Luminaire housing and external LED power supply unit must not be covered by any heat insulating materials.

### Installation into inserted ceilings:

- A recessed opening of 450 mm with a minimum depth of 165 mm is required.
- Push luminaire housing into the ceiling cut-out and tighten evenly screws (T 20) of the three mounting springs.
- The mounting springs catch the ceiling facing from the back side. The minimum thickness of the panel must be 9 mm and the maximum thickness 25 mm. If the ceiling facing has a thickness of less than 3 mm, the facing thickness in the region of the mounting springs must be increased from the back side.
- Connect the two 2-pin plug connectors between luminaire and external LED power supply unit.
- Unpack LED unit, lift it with enclosed gloves and insert it into the luminaire housing – keyholes – .
- Turn the LED device anticlockwise until it stops and tighten the screws (T 10) evenly.
- Place the synthetic diffuser to the luminaire housing and observe that the cam pins fit into the notches of the synthetic diffuser.
- Screw in synthetic diffuser by turning it clockwise.
- Thus, you reach a safe and vibration- resistant holding of the synthetic diffuser.
- To release the synthetic diffuser from the luminaire housing, turn it counter-clockwise.

## Cleaning · Maintenance

Clean luminaire regularly with solvent-free cleaning agents to remove dirt.  
A defective synthetic cover must be replaced.

## Replacement of the LED module

The designation of the LED module is noted on a label in the luminaire.

The light color and light output of BEGA replacement modules correspond to those of the modules originally fitted. The module can be replaced by qualified persons using standard tools.

Disconnect the system.

Unscrew synthetic diffuser from luminaire housing by turning it counter-clockwise. Please follow the installation instructions for the LED module.

Screw in synthetic diffuser by turning it clockwise.

Defective synthetic diffuser must be replaced.

## Accessories

Power supply units for LED luminaires 220-240 V · 0/50-60 Hz with strain relief and plug connector system.

13 179 Power supply unit on/off

13 175 Power supply unit DALI

The power supply units are only suitable for the operation of one LED luminaire.

For the accessories a separate instructions for use can be provided upon request.

## Spares

- Synthetic cover 15 000 634
- LED module 3000 K LED-0805/930

BEGA Gantenbrink-Leuchten KG · Postfach 31 60 · 58689 Menden · [info@bega.com](mailto:info@bega.com) · [www.bega.com](http://www.bega.com)

## Documents / Resources

	<p><b><a href="#">BEGA 50894.1 STUDIO LINE LED luminaire</a></b> [pdf] Instruction Manual</p> <p>50894.1 STUDIO LINE LED luminaire, 50894.1, STUDIO LINE LED luminaire, LINE LED luminaire, LED luminaire, luminaire</p>
---	--

## References

- BEGA [BEGA · Das gute Licht.](#)