



BEGA 33019K3 Shielded Luminaire Instruction Manual

[Home](#) » [BEGA](#) » BEGA 33019K3 Shielded Luminaire Instruction Manual 

BEGA

33019K3 Shielded Luminaire
Instruction Manual



Contents

- [1 33019K3 Shielded Luminaire](#)
- [2 Application](#)
- [3 Safety](#)
- [4 Overvoltage protection](#)
- [5 Installation](#)
- [6 Cleaning · Maintenance](#)
- [7 Replacing the LED module](#)
- [8 Accessories](#)
- [9 Documents / Resources](#)
 - [9.1 References](#)

33019K3 Shielded Luminaire

Technical amendments reserved
Recessed luminaire

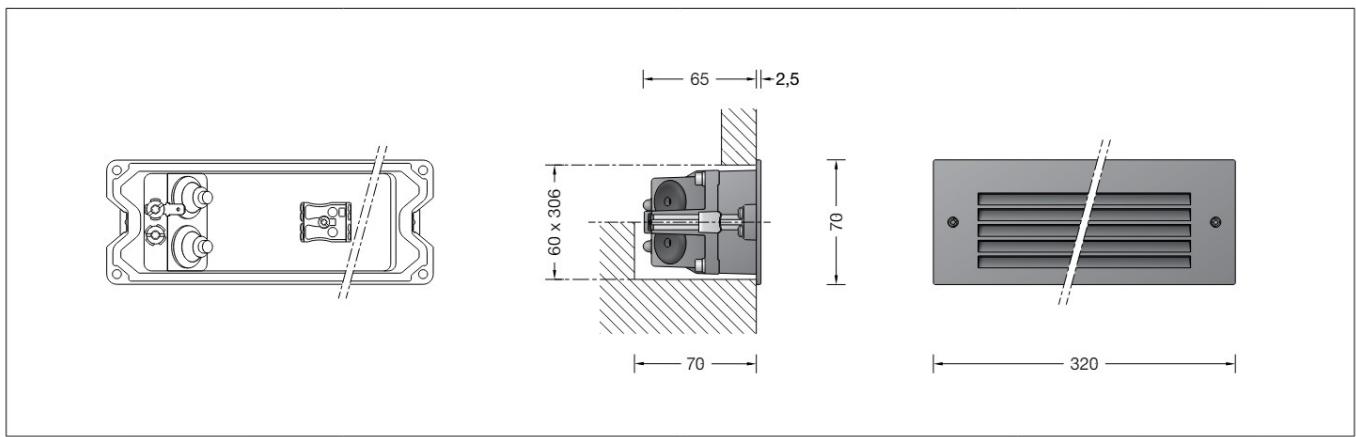

Instructions for use

Application

Shielded luminaire for walls and stairs.

Product description

Luminaire made of aluminium alloy,
aluminium and stainless steel

BEGA Tricoat® coating technology

Matt safety glass

Fixing is achieved by using two adjustable wedge-shaped claws

Required recessed opening 306 x 60 mm

Recessed depth 70 mm 2 cable entries for through-wiring of mains supply cable \varnothing 7-10.5 mm

Connection terminal 2.5□

Earth conductor connection

BEGA Ultimate Driver®

LED power supply unit

220-240 V \sim 0/50-60 Hz

DC 176-280 V

BEGA Thermal Control®

Temporary thermal regulation to protect temperature-sensitive components without switching off the luminaire



Safety class I

Protection class IP 65

Dust-tight and protection against water jets

Impact strength IK08

Protection against mechanical impacts < 5 joule

 10  – Safety mark

 – Conformity mark

Weight: 1.0 kg

This product contains light sources of energy efficiency class(es) C

Safety

The installation and operation of this luminaire are subject to national safety regulations.

Installation and commissioning may only be carried out by a qualified electrician.

The manufacturer accepts no liability for damage caused by improper use or installation.

If subsequent modifications are made to the luminaire, the person responsible for these modifications shall be considered the manufacturer.

Overvoltage protection

The electronic components installed in the luminaire are protected against overvoltage in accordance with DIN EN 61547.

To achieve an additional protection against e. g. transients, etc. we recommend separate overvoltage protection components. You can find them on our website at www.bega.com.

Lamp

Module connected wattage	3.2 W
Luminaire connected wattage	4.1 W
Rated temperature	ta = 25 °C
Ambient temperature	ta max = 60 °C
When installed in heat-insulating material	ta max = 55 °C

33 019 K3

Module designation	LED-1330/830
Colour temperature	3000 K
Colour rendering index	CRI > 80
Module luminous flux	575 lm
Luminaire luminous flux	42 lm
Luminaire luminous efficiency	10,2 lm / W

33 019 K4

Module designation	LED-1330/840
Colour temperature	4000 K
Colour rendering index	CRI > 80
Module luminous flux	605 lm
Luminaire luminous flux	45 lm
Luminaire luminous efficiency	11 lm / W

Please note:

This luminaire is coated with BEGA Tricoatb. BEGA Tricoatb is a registered trademark for a technology that we use to achieve optimal corrosion resistance.

Even the best possible surface protection and the highest corrosion resistance can be rendered almost ineffective in some cases by aggressive media caused by leaching of building materials.

Where such media are suspected, a material analysis must be carried out before installation.

Always avoid excessive use of chemical cleaning agents in the vicinity of the luminaire.

Installation

The recessed opening will be covered by the frame of the luminaire housing.

Fixing of the luminaire is achieved by using two adjustable wedge-shaped claws.

Installation in solid, plastered walls:

The installation housing 10 426 is available for this purpose. If this is not used, an exact recessed opening of 306 x 60 mm with a minimum depth of 70 mm is required.

Installation in exposed brickwork:

The construction of an on-site recessed opening with the exact installation dimensions of 306 x 60 mm with a minimum depth of 70 mm is required. An installation housing cannot be used.

Installation in drywalling:

A recessed opening of 306 x 60 mm with a minimum depth of 70 mm is required.

The claws grip behind drywall.

Installation into insulated façades:

For installation in EWIS external wall insulation systems please use installation housing 13 521 in combination with a plaster frame 10 026 or 13 505.

Open luminaire:

Undo hexagon socket screws (SW 3) and remove housing cover.

Disconnect plug-connection of the LED connecting cable.

Disconnect the earth conductor connection from the plug connection.

Lead the mains supply cable through the cable entry into the luminaire housing.

Make earth conductor connection.

Push silicone sleeves over the lines and make electrical connection.

In order to guarantee the maximum service life of the electrical components, the enclosed desiccant pouch must be placed in the luminaire.

Remove the desiccant pouch from the foil packaging and place it in the position marked by the red information label immediately before finally closing the luminaire.

Connect the LED connection cable by means of a plug connector.

Put on earth conductor connection of the housing cover. Assemble housing cover.

Make sure that gasket is positioned correctly.

Tighten the screws evenly.

Insert luminaire housing into the recessed opening. Hand-tighten screws of the claw fastener (torx drive T10) evenly. Do not use an electric screwdriver!

Cleaning · Maintenance

Clean luminaire regularly with solvent-free cleansers from dirt and deposits.

Do not use high pressure cleaners.

Replacing the LED module

The designation of the LED module is noted on a label in the luminaire.

The light colour and light output of BEGA replacement modules correspond to those of the modules originally fitted.

The module can be replaced by qualified persons using standard tools.

Disconnect the system and open the luminaire.

Please follow the installation instructions for the LED module.

Inspect and, if necessary, replace the luminaire gaskets.

Defective glass must be replaced.

Close the luminaire.

Accessories

10 426	Installation housing
13 521	Installation housing for installation in insulated façades (EWIS)
10 026	Plaster frame
13 505	Plaster frame flush

A separate instructions for use can be provided upon request.

Spares

LED power supply unit	DEV-0448/150
LED module 3000 K	LED-1330/830
LED module 4000 K	LED-1330/840
Gasket	83 001 955

BEGA
 BEGA Gantenbrink-Leuchten KG
 Postfach 31 60
 58689 Menden
info@bega.com
www.bega.com

Documents / Resources

	<p>BEGA 33019K3 Shielded Luminaire [pdf] Instruction Manual 33019K3 Shielded Luminaire, 33019K3, Shielded Luminaire, Luminaire</p>
-------------------------------------------------------------------------------------	---------------------------------------------------------------------------------------------------------------------------------------------------------------

References

- ^{BEGA} [BEGA · Das gute Licht.](#)
- [User Manual](#)

[Manuals+.](#) [Privacy Policy](#)

This website is an independent publication and is neither affiliated with nor endorsed by any of the trademark owners. The "Bluetooth®" word mark and logos are registered trademarks owned by Bluetooth SIG, Inc. The "Wi-Fi®" word mark and logos are registered trademarks owned by the Wi-Fi Alliance. Any use of these marks on this website does not imply any affiliation with or endorsement.