



BEGA 33018 Shielded Luminaire Instruction Manual

[Home](#) » [BEGA](#) » BEGA 33018 Shielded Luminaire Instruction Manual 

BEGA



IP 65

48.23 · Technical amendments reserved 33 018

Contents

- [1 Recessed luminaire](#)
- [2 Product description](#)
- [3 Safety](#)
- [4 Installation](#)
- [5 Cleaning · Maintenance](#)
- [6 Accessories](#)
- [7 Documents / Resources](#)
 - [7.1 References](#)

Recessed luminaire

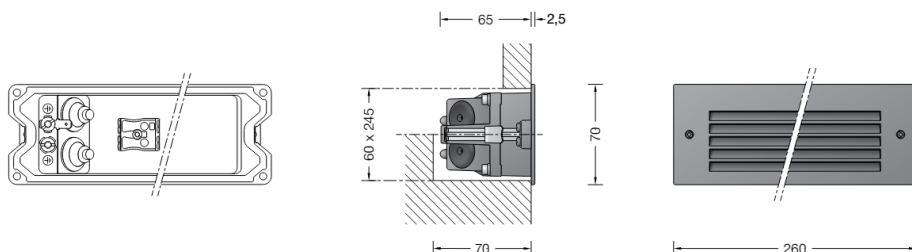

Instructions for use Application

Shielded luminaire for walls and stairs.

The colour temperature of the luminaire can be set optionally to 3000 K and 4000 K.

Product description

Luminaire made of aluminium alloy, aluminium and stainless steel BEGA Tricoat ® coating technology Colour graphite or silver Safety glass, white Silicone gasket Fixing is achieved by using two adjustable wedge-shaped claws Required recessed opening 245 x 60 mm Recessed depth 70 mm 2 cable entries for through-wiring of mains supply cable ø 7-10.5 mm Connection terminal 2.5@ Earth conductor connection BEGA Ultimate Driver ® Complies with flicker requirements in accordance with IEEE 1789, DIN IEC/TR 63158, DIN IEC/TR 61547-1 LED power supply unit 220-240 V x 0/50-60 Hz DC 176-280 V BEGA Thermal Control ® Temporary thermal regulation to protect temperature-sensitive components without switching off the luminaire

Safety class I

Protection class IP 65

Dust-tight and protection against water jets

Impact strength IK09

Protection against mechanical impacts < 10 joule

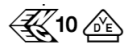

– Safety mark

c – Conformity mark

Weight: 0.8 kg

This product contains light sources of energy efficiency class(es) B

Safety

The installation and operation of this luminaire are subject to national safety regulations.

Installation and commissioning may only be carried out by a qualified electrician.

The manufacturer accepts no liability for damage caused by improper use or installation.

If subsequent modifications are made to the luminaire, the person responsible for these modifications shall be considered the manufacturer.

Overvoltage protection

The electronic components installed in the luminaire are protected against overvoltage in accordance with DIN EN 61547.

To achieve an additional protection against e. g. transients, etc. we recommend separate overvoltage protection components.

You can find them on our website at www.bega.com.

The ideal protection of all electronic components installed in the luminaires is achieved by using bounce-free switching contacts such as an electronic relay (solid-state relay), e.g. BEGA 71 320.

Please note:

This luminaire is coated with BEGA Tricoatb.

BEGA Tricoatb is a registered trademark for a technology that we use to achieve optimal corrosion resistance.

Even the best possible surface protection and the highest corrosion resistance can be rendered almost ineffective in some cases by aggressive media caused by leaching of building materials.

Where such media are suspected, a material analysis must be carried out before installation. Always avoid excessive use of chemical cleaning agents in the vicinity of the luminaire.

Installation

The recessed opening will be covered by the frame of the luminaire housing.

Fixing of the luminaire is achieved by using two adjustable wedge-shaped claws.

Installation in solid, plastered walls:

The installation housing 10 425 is available for this purpose. If this is not used, an exact recessed opening of 245 x 60 mm with a minimum depth of 70 mm is required.

Installation in exposed brickwork:

The construction of an on-site recessed opening with the exact installation dimensions of 245 x 60 mm with a minimum depth of 70 mm is required. An installation housing cannot be used.

Installation in drywalling:

A recessed opening of 245 x 60 mm with a minimum depth of 70 mm is required.

The claws grip behind drywall.

Installation into insulated façades:

For installation in EWIS external wall insulation systems please use installation housing 13 520 in combination with a plaster frame 10 025 or 13 504.

Open luminaire:

Undo hexagon socket screws (SW 3) and remove housing cover.

Disconnect plug-connection of the LED connecting cable.

Disconnect the earth conductor connection from the plug connection.

Lead the mains supply cable through the cable entry into the luminaire housing.

Make earth conductor connection.

Push silicone sleeves over the lines and make electrical connection.

In order to guarantee the maximum service

life of the electrical components, the enclosed desiccant pouch must be placed in the luminaire.

Remove the desiccant pouch from the foil packaging and place it in the position marked by the red information label immediately before finally closing the luminaire.

The LED module can optionally be operated with a colour temperature of 3000 K or 4000 K.

Check the labelling to ensure a correct socket match when connecting the plug-in device to the LED connecting cable.

Switching may only be carried out when disconnected from the power supply!

Put on earth conductor connection of the housing cover. Assemble housing cover.

Make sure that gasket is positioned correctly.

Tighten the screws evenly.

Insert luminaire housing into the recessed opening. Hand-tighten screws of the claw fastener (torx drive T10) evenly. Do not use an electric screwdriver!

Lamp

Module connected wattage	2.8 W
Luminaire connected wattage	3.8 W
Module designation	LED-1533/83040
Colour rendering index	CRI > 80
Rated temperature	t a = 25 °C
Ambient temperature	t a max= 60 °C
When installed in heat-insulating material	t a max = 55 °C
Operation at colour temperature	3000 K
Module luminous flux	580 lm
Luminaire luminous flux	47 lm
Luminaire luminous efficiency	12,4 lm / W
Operation at colour temperature	4000 K
Module luminous flux	595 lm
Luminaire luminous flux	48 lm
Luminaire luminous efficiency	12,6 lm / W

Cleaning · Maintenance

Clean luminaire regularly with solvent-free cleansers from dirt and deposits.

Do not use high pressure cleaners.

Replacing the LED module

The designation of the LED module is noted on a label in the luminaire.

The light colour and light output of BEGA replacement modules correspond to those of the modules originally fitted.

The module can be replaced by qualified persons using standard tools.

Disconnect the system and open the luminaire.

Please follow the installation instructions for the LED module.

Inspect and, if necessary, replace the luminaire gaskets.

Defective glass must be replaced.

Close the luminaire.

Accessories

10 425 Installation housing

13 520 Installation housing for installation in insulated façades (EWIS)

10 025 Plaster frame

13 504 Plaster frame flush

A separate instructions for use can be provided upon request.

Spares

LED power supply unit	DEV-0450/350
LED module	LED-1533/83040
Gasket	83 001 526

BEGA Gantenbrink-Leuchten KG · Postfach 31 60 · 58689 Menden

info@bega.com

www.bega.com

Documents / Resources

	<p>BEGA 33018 Shielded Luminaire [pdf] Instruction Manual 33018, 71320, 33018 Shielded Luminaire, Shielded Luminaire, Luminaire</p>
---	--

References

- [User Manual](#)

This website is an independent publication and is neither affiliated with nor endorsed by any of the trademark owners. The "Bluetooth®" word mark and logos are registered trademarks owned by Bluetooth SIG, Inc. The "Wi-Fi®" word mark and logos are registered trademarks owned by the Wi-Fi Alliance. Any use of these marks on this website does not imply any affiliation with or endorsement.