



**Work. Flow. Home.**

**Basalt**

**Monitor stand extension for Tenon Workspace**

**Contents** [ [hide](#) ]

- [1 Placing cables inside Basalt](#)
- [2 Attaching a monitor to Basalt](#)
- [3 Assembling Basalt to Tenon](#)
- [4 Adjusting Tilt](#)
- [5 Documents / Resources](#)
  - [5.1 References](#)

## Placing cables inside Basalt

Unscrew the center bolt.

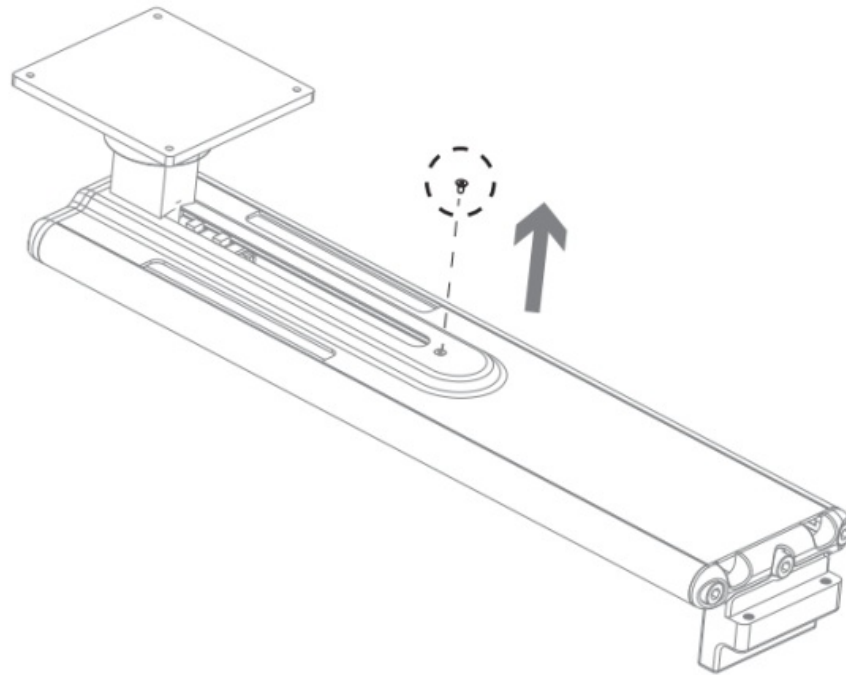

## Specifications

Dimension: 510 x 120 x 100 mm

Weight: 5.4lbs / 2.4kg

1.2 Remove the bottom cap by unscrewing the two bolts

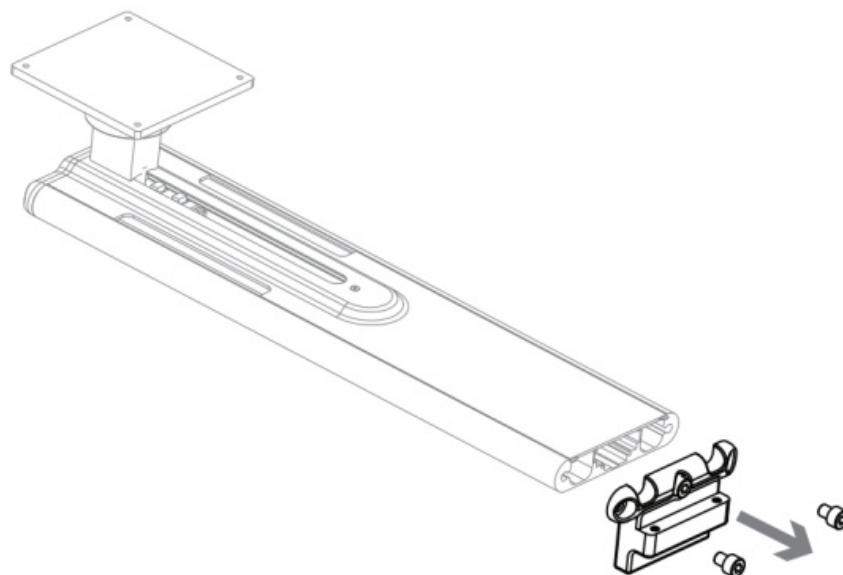

1.3 Lift up the front lid.

You can now insert your display cables by sliding them underneath the lid.

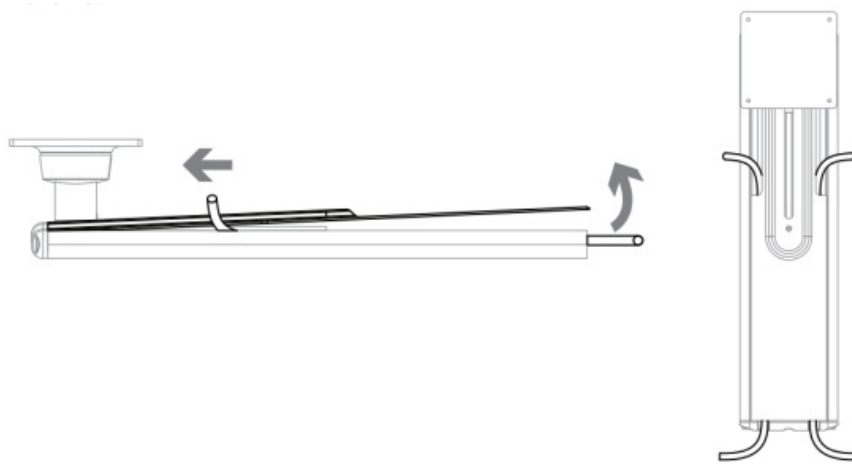

1.4 Close the lid.

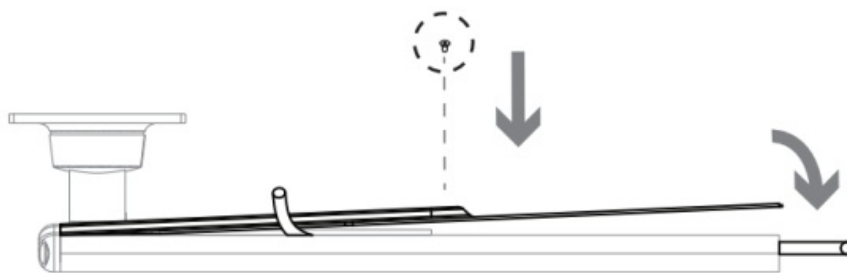

1.5 Screw back the bottom lid.

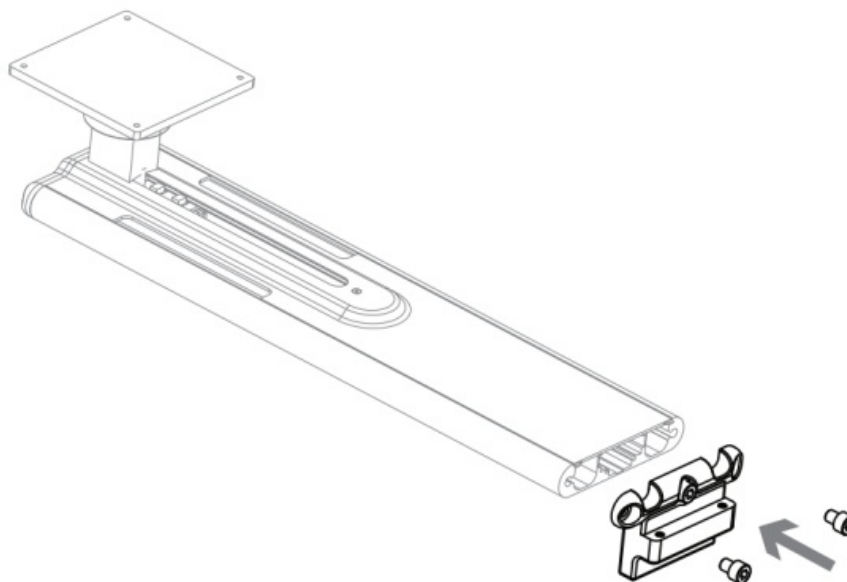

## Attaching a monitor to Basalt

Twist Basalt to the left at the VESA mount hinge. Then screw the two screws on the right of the VESA mount. Repeat for opposite side.

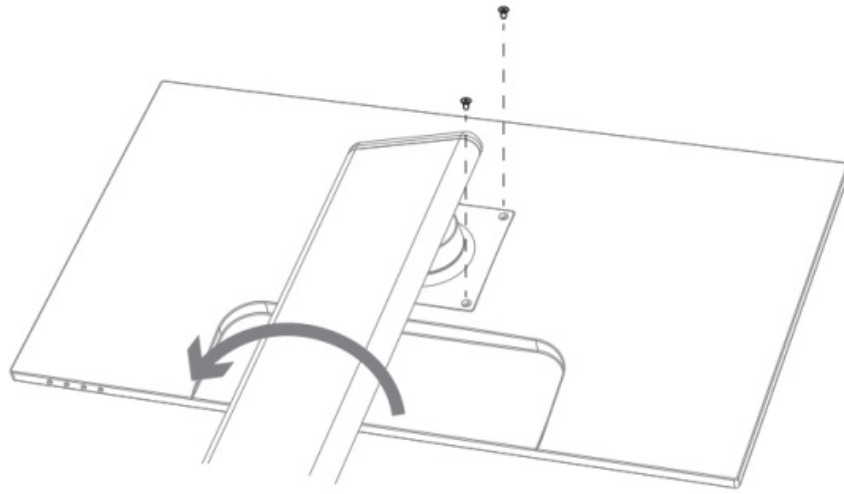

## Assembling Basalt to Tenon

Unscrew the adapter from the bottom cap.

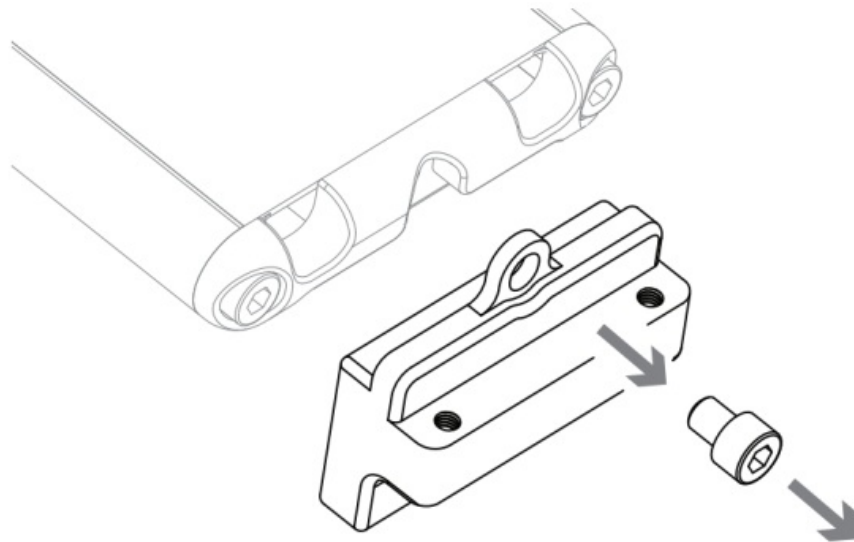

3.2 Place the adapter into the rear frame of Tenon.

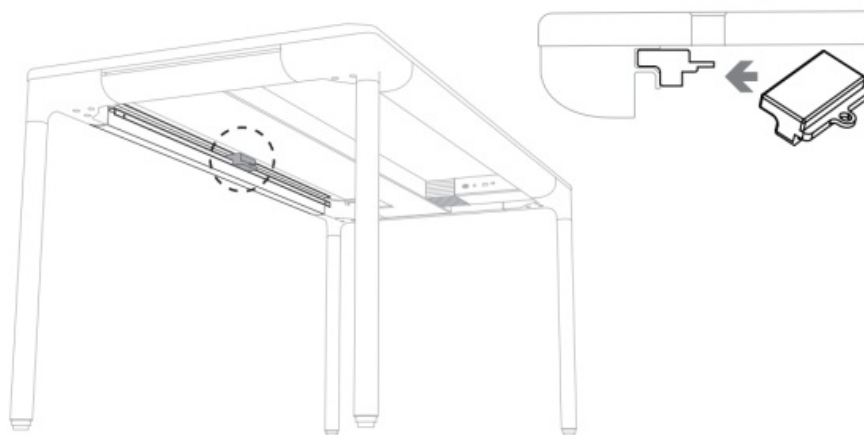

3.3 Lower Basalt through the desktop slot onto the adapter from above.

Keep Basalt perfectly vertical.

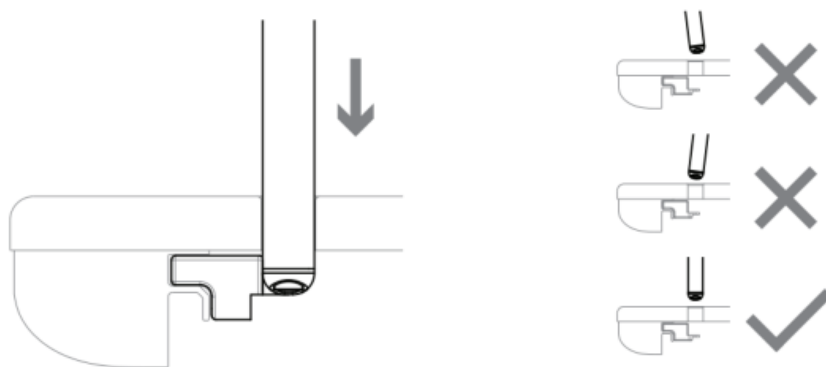

3.4 Fasten the middle bolt to secure both parts together.

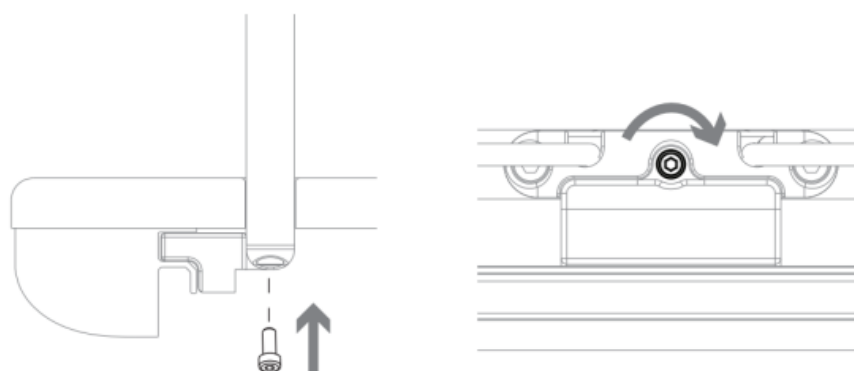

## Adjusting Tilt

If Basalt is not perfectly upright after assembly, the two additional plastic screws may be used to adjust Basalt's tilt.

Screw the screws into the adapter until they hit the frame, after this point each turn of the screws will affect Basalt's upright angle.

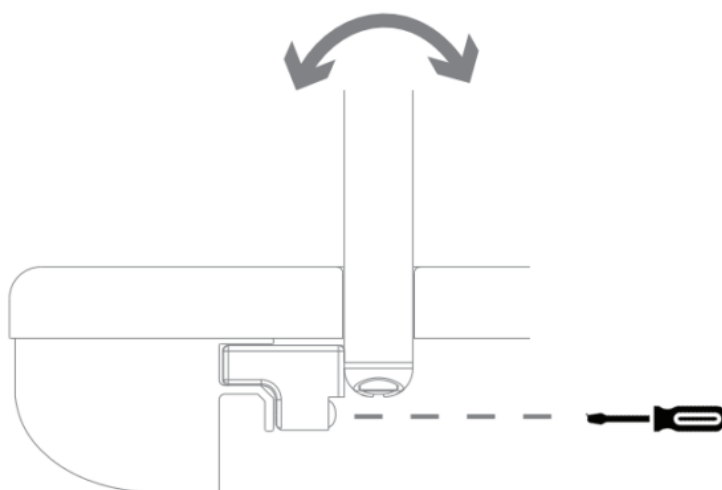

## Documents / Resources

	<a href="#">beflo Basalt Monitor Stand Extension [pdf]</a> Instruction Manual Basalt Monitor Stand Extension, Monitor Stand Extension, Stand Extension
---	---

## References

- [User Manual](#)

Basalt Monitor Stand Extension, beflo, Monitor Stand Extension, Stand Extension

## Leave a comment

Your email address will not be published. Required fields are marked \*

Comment \*

Name

Email

Website

☐ Save my name, email, and website in this browser for the next time I comment.

**Post Comment**

**Search:**

e.g. whirlpool wrf535swhz

**Search**

[Manuals+](#) | [Upload](#) | [Deep Search](#) | [Privacy Policy](#) | [@manuals.plus](#) | [YouTube](#)

This website is an independent publication and is neither affiliated with nor endorsed by any of the trademark owners. The "Bluetooth®" word mark and logos are registered trademarks owned by Bluetooth SIG, Inc. The "Wi-Fi®" word mark and logos are registered trademarks owned by the Wi-Fi Alliance. Any use of these marks on this website does not imply any affiliation with or endorsement.