



Beeline BLD2.0 GPS Quickstart guide

[Home](#) » [BEELINE](#) » Beeline BLD2.0 GPS Quickstart guide 

Contents

- [1 Beeline BLD2.0 GPS](#)
- [2 Introduction](#)
- [3 Specifications](#)
- [4 What's in the box](#)
- [5 Features](#)
- [6 How to use](#)
 - [6.1 Device buttons](#)
 - [6.2 Charging](#)
 - [6.3 Smartphone pairing](#)
 - [6.4 Device interface](#)
- [7 Installation Instruction](#)
- [8 Warranty & returns](#)
- [9 FCC ID](#)
- [10 Need more info?](#)
- [11 FAQs](#)
- [12 Video- Product Usage](#)
- [13 Related Posts](#)



Beeline BLD2.0 GPS



Introduction

Navigating on a motorcycle requires equipment that's both intuitive and reliable. Beeline BLD2.0 GPS stands out as an exceptional navigation solution tailored for the modern rider. Gone are the days of complex and cumbersome devices. With the Beeline BLD2.0 GPS, riders are granted the power to explore confidently, making every journey, whether known or uncharted, a seamless adventure.

Specifications

- **Brand:** Beeline
- **Model Name:** Beeline BLD2.0_BLK
- **Vehicle Service Type:** Motorcycle
- **Special Feature:** Touchscreen, Waterproof
- **Connectivity Technology:** Bluetooth
- **Map Type:** Waypoint and Smart Compass
- **Sport:** Cycling
- **Included Components:** Beeline BLD2.0_BLK
- **Battery Life:** 30 Hours
- **Mounting Type:** Handlebar Mount
- **Product Dimensions:** 1.97 x 1.97 x 0.79 inches; 8.2 Ounces
- **Item model number:** BLD2.0_BLK
- **Batteries:** 1 Lithium Metal battery is required. (included)

What's in the box

- Beeline BLD2.0_BLK GPS Device

Features

1. **Intuitive Route Navigation:** No more aimless wandering or getting lost midway. With the Beeline BLD2.0 GPS, finding and adhering to routes becomes second nature. This is ensured even in areas with weak or no signal, thanks to the device's robust design and continuous updates.
2. **Track Your Adventure:** With turn-by-turn directions that are easy to follow, riders can focus on the joy of the ride while being guided safely to their destination. Plus, connectivity to Strava means you can keep track of your ride stats, monitor maps, and log your rides.
3. **Dependable Offline Technology:** Whether you're on a mountain trail or deep in a forest, the Beeline BLD2.0 GPS ensures that you're never truly off the grid. Even in places where your phone signal might waver, this GPS will consistently point you in the right direction.
4. **Route Customization:** Every rider has their preferences, and this GPS understands that. Whether you want to steer clear of tolls, avoid ferries, or skip the motorways, you have the freedom to plan and modify your route accordingly. All of this, with a clear arrow for real-time navigation.
5. **Superior Location Accuracy:** The Beeline BLD2.0 GPS isn't just another GPS unit; its advanced sensor fusion technology ensures high-quality ride data and minimizes reliance on unpredictable phone signals. It syncs seamlessly with a free companion app available for both iOS & Android, enriching your experience with route planning, route import, and ride-tracking capabilities.

How to use

Device buttons

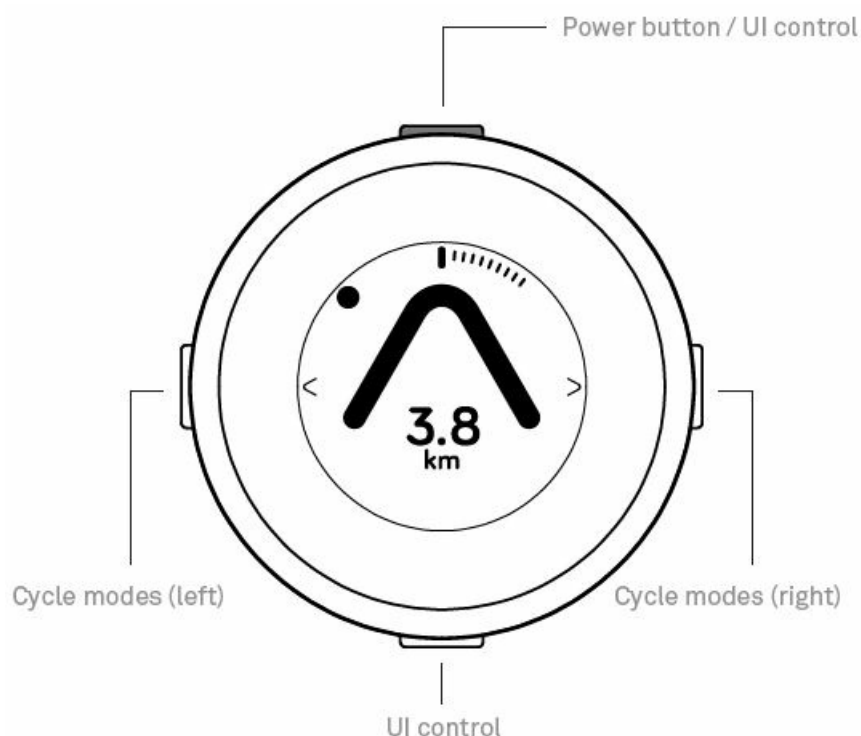

Charging

Align the two yellow markers, and twist them to lock.

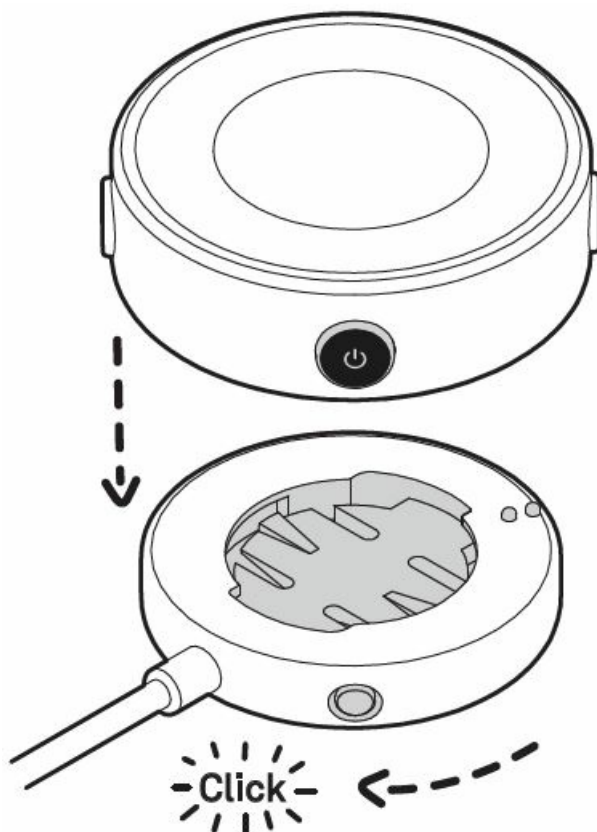

Smartphone pairing

Pair the Beeline Moto with your smartphone as prompted by the Beeline app. N.B: Do not pair in your smartphone's Bluetooth settings menu.

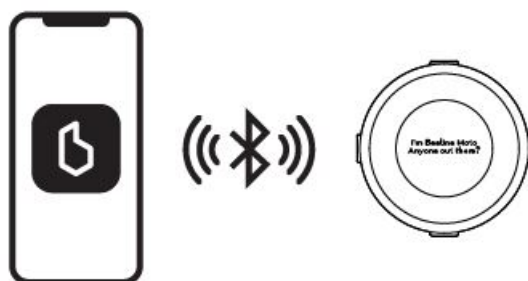

Download the app from this link: beeline.co/app

Device interface

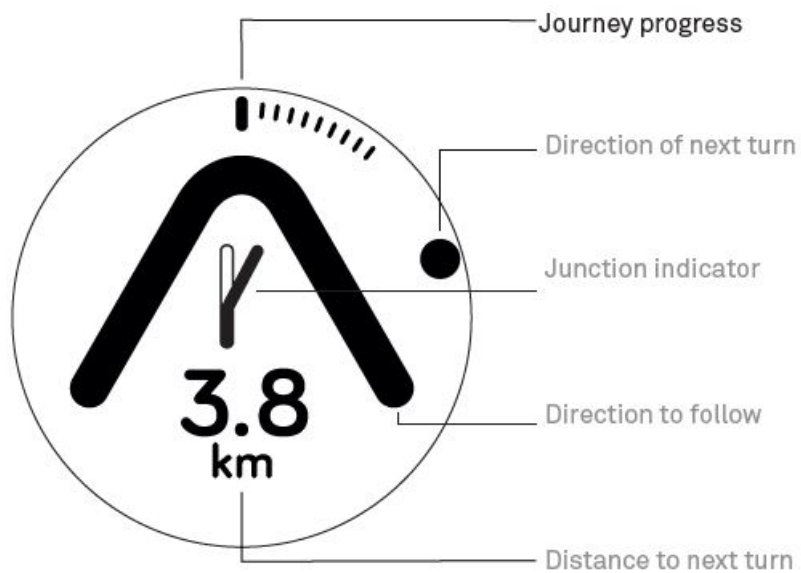

Installation Instruction

Universal elastic strap

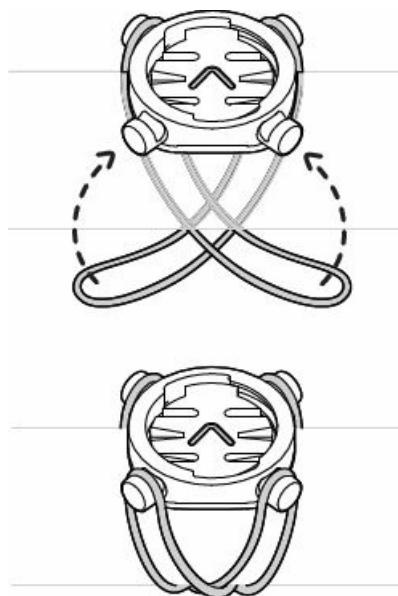

Sticky pad modular mount

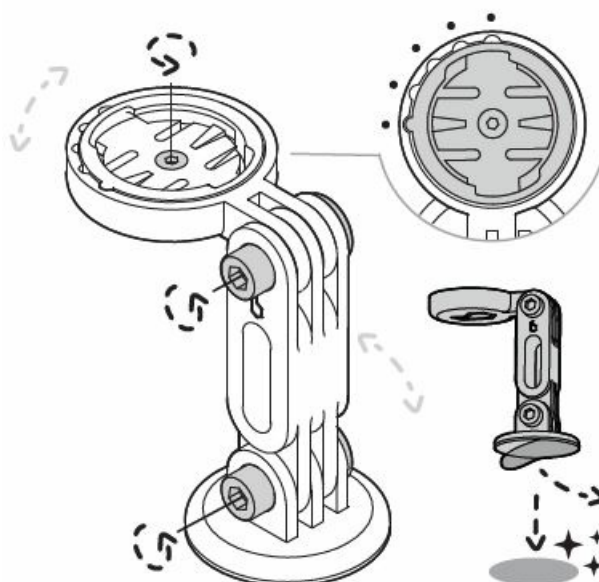

Bar clamp

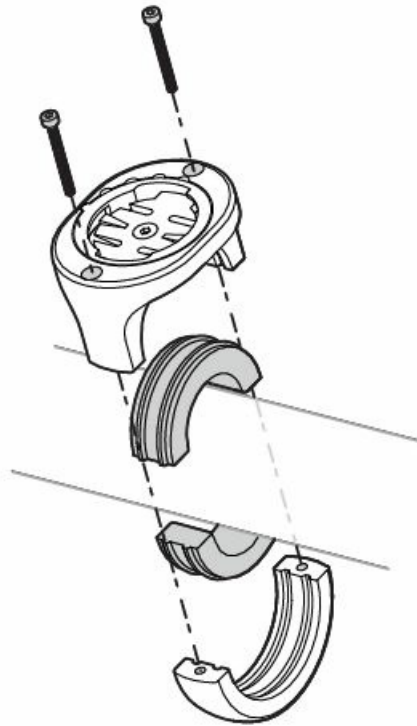

1-inch ball adapter

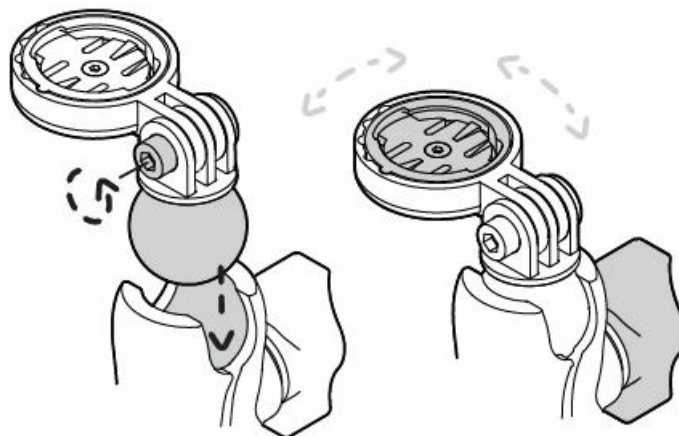

Scooter mirror stalk clamp

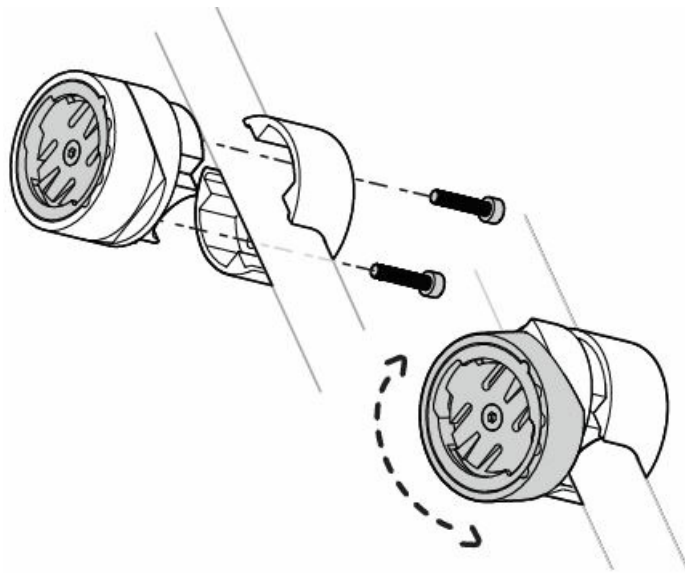

Warranty & returns

All information on warranty and returns can be found at beeline.co/warranty

Use of Beeline products while driving still means that you need to drive with due care and attention. Your device is intended to serve as a driving aid and is not a substitute for driving with due care and attention. Always obey posted road signs and applicable laws. Distracted driving can be extremely dangerous. Please do not operate this device in any manner that diverts a driver's attention from the road in an unsafe manner.

FCC ID

FCC ID: 2AKLE-MOTO

FCC ID: 2AKLE-MOTO1

FCC STATEMENT: This device complies with Part 15 of the FCC Rules. Operation is subject to the following two conditions:

1. This device may not cause harmful interference, and
2. This device must accept any interference received, including interference that may cause undesired operation.

Warning: Changes or modifications not expressly approved by the party responsible for compliance could void the user's authority to operate the equipment.

NOTE: This equipment has been tested and found to comply with the limits for a Class B digital device, pursuant to Part 15 of the FCC Rules. These limits are designed to provide reasonable protection against harmful interference in a residential installation. This equipment generates uses and can radiate radio frequency energy and, if not installed and used in accordance with the instructions, may cause harmful interference to radio communications. However, there is no guarantee that interference will not occur in a particular installation. If this equipment does cause harmful interference to radio or television reception, which can be determined by turning the equipment off and on, the user is encouraged to try to correct the interference by one or more of the following measures:

- Reorient or relocate the receiving antenna.
- Increase the separation between the equipment and the receiver.
- Connect the equipment to an outlet on a circuit different from that to which the receiver is connected.

- Consult the dealer or an experienced radio/TV technician for help.

FCC Radiation Exposure Statement: This equipment complies with FCC radiation exposure limits set forth for an uncontrolled environment. This equipment should be installed and operated with a minimum distance of 20cm between the radiator & your body.

Need more info?

Scan the QR code below for more detailed information and FAQs. beeline.co/moto-user-guide Thanks for joining the ride! #beelinemoto #ridebeeline @ridebeeline

Watch a video explanation here: beeline.co/explainer



FAQs

How do I charge the Beeline BLD2.0 GPS?

Use the provided charging cable to connect your device to a power source.

Can I use the Beeline GPS without the companion app

The Beeline GPS is designed to work best with its companion app, which facilitates route planning, ride tracking, and more.

What do I do if my Beeline GPS isn't syncing with my phone?

Ensure that Bluetooth is enabled on your smartphone. If problems persist, try restarting both your phone and the Beeline GPS. Ensure the Beeline app is updated to the latest version.

How accurate is the Beeline GPS?

The Beeline BLD2.0 GPS employs sensor fusion technology to improve ride-data quality, ensuring high accuracy even when phone signals are weak.

Can I share my ride data with friends?

Yes, you can connect to platforms like Strava through the app and share your stats, maps, and logged rides.

How do I update the software on my Beeline GPS?

Updates are typically provided through the Beeline companion app. Ensure your app is updated, and follow on-screen prompts to update your device's software when available.

Does the Beeline GPS have voice navigation?

The Beeline BLD2.0 GPS provides intuitive turn-by-turn directions visually through an arrow display. It does not have voice navigation features.

How do I handle the Beeline GPS in areas with no phone signal?

The Beeline GPS features reliable offline technology, ensuring that you remain on the correct route even when there's no signal.

Can I use the Beeline GPS in any country?

The Beeline GPS is designed for global use. However, always ensure that the companion app has mapping support for the country you're in.

How does the avoid motorways, tolls, or ferries feature work?

Within the companion app, when planning your route, you can select preferences to avoid specific route types, ensuring a more tailored journey.

Video- Product Usage



[Manuals+](#)