



BAUHN ABTWPDQ-0223-C Wireless Charging Stand User Guide

[Home](#) » [BAUHN](#) » [BAUHN ABTWPDQ-0223-C Wireless Charging Stand User Guide](#) 

Contents

- [1 BAUHN ABTWPDQ-0223-C Wireless Charging Stand](#)
- [2 Have you got everything](#)
- [3 Product Overview](#)
- [4 Charging](#)
- [5 Troubleshooting](#)
- [6 Specifications](#)
 - [6.1 General Safety Warnings](#)
- [7 Documents / Resources](#)
- [8 Related Posts](#)

BAUHN®

BAUHN ABTWPDQ-0223-C Wireless Charging Stand



Have you got everything

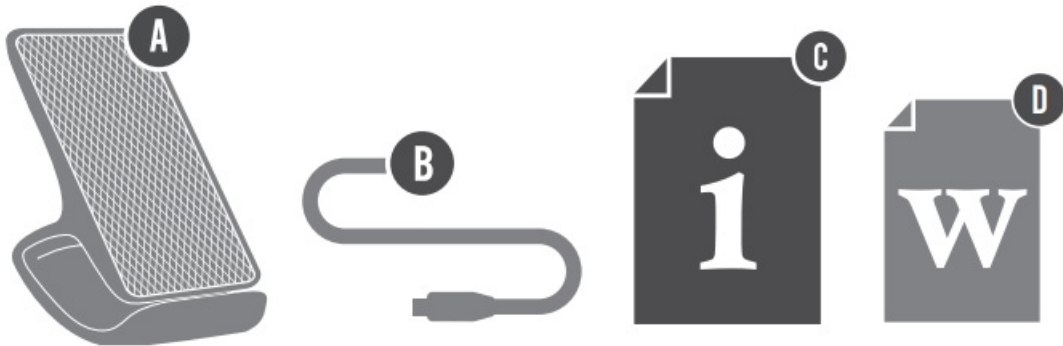

- **A.** Wireless Charging Stand
- **B.** USB-C Cable
- **C.** User Guide
- **D.** Warranty Certificate

Product Overview

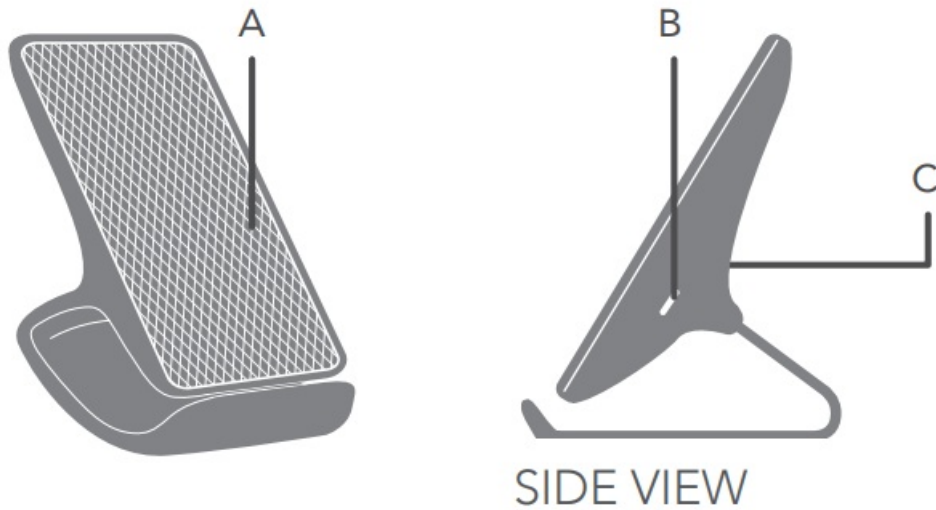

- **A.** Charging Pad
- **B.** LED Status Indicator
- **C.** USB-C Port

Charging

Charging your device



- Connect the USB-C cable to a 12V 2A or 9V 1.67A (Quick Charge 2.0 or 3.0) power supply (power supply not included).
- The LED status indicator will light blue, green then off.
- Place your smart phone facing up on the charging pad using the support base of the wireless charging stand to support your phone. You can also place your smart phone in landscape orientation. The LED status indicator will light up blue once the phone is correctly aligned.
- If no devices are being charged, the wireless charging stand will turn off after 2 seconds and the LED status indicator will turn off.
- **Note:** The LED status indicator will light up blue when charging and green when fully charged.

LED status indicator colour

- Blue – Smart phone is being charged.

- Flashing blue+green – Error. Smart phone does not support wireless charging and/or other objects are obstructing the wireless charging stand.
- **Note:** If connected to a USB power supply that supports Quick Charge 2.0 or 3.0 (12V, 2A), or 25W USB-C PD charger, the wireless charging stand will automatically achieve up to 15W charging (smart phone must support 15W quick charge). If the USB power supply is 9V, 1.67A or 20W USB-C PD charger, charging will be limited to 10W. If power supply is 5V, 1.5A, charging will be 5W.

Troubleshooting

<p>Cannot charge device</p>	<ul style="list-style-type: none"> • Check that your smart phone supports wireless charging. • If you have a smart phone case, you must remove it when charging. • Ensure the smart phone is facing up, making sure the centre of the smart phone is aligned to the centre of the wireless charging stand. • Check and remove any metal or other objects between the smart phone and the wireless charging stand. • If your smart phone is in a portrait position, rotate to landscape and ensure the centre of your smart phone is aligned to the centre of the wireless charging stand. 	
<p>Charging slowly</p>	<ul style="list-style-type: none"> • To achieve 10W/15W quick wireless charging, ensure that the wireless charging stand is connected to a USB power supply supporting Quick Charge 2.0 or Quick Charge 3.0 (12VDC, 2A), or 25W USB-C PD charger. 	

<p>Cannot achieve 15 W charging</p>	<ul style="list-style-type: none"> • Your smart phone must support 15W wireless charging. • Ensure that the wireless charging stand is connected to a USB power supply supporting Quick Charge 2.0 or Quick Charge 3.0 (12VDC, 2A), or 25W USB-C PD charger. 	
<p>LED status indicator does not light up</p>	<ul style="list-style-type: none"> • Ensure that the cable is connected to the USB port securely. • Check that the power source is switched on. 	

Specifications

Input Power & Output*	5V 2A Max.	5W
	9V 1.67A Max.	10W
	12V 2A Max.	15W**
	USB-C PD	15W***
Dimensions	70(W) x 113(H) x 89(D)mm	
Weight	200g	

- Output is dependant on input power.
- Only supported on some devices compatible with 15W wireless charging.
- Requests 25W USB-C PD power for 15W output.

General Safety Warnings

- For the safety of yourself and others, follow all instructions and take notice of all the warnings.
- When adhered to, these safety precautions can reduce the risk of fire, electric shock and injury.
This product complies with Australian Safety standard AS/NZS 62368.1 to ensure the safety of the product.
- The RCM is a visible indication of a product's compliance with all applicable ACMA regulatory arrangements, including all technical and record-keeping requirements.
- **IMPORTANT**
- Plastic wrapping can be a suffocation hazard for babies and young children, so ensure all packaging materials are out of their reach.
- To prevent environmental factors (dampness, dust, food, liquid etc.) harming the power bank, only use it in a well-ventilated, clean and dry environment, away from excessive heat or moisture.
- Keep the product away from direct sunlight or heat sources.
- In case of damage, do not disassemble, repair or modify the product yourself. Contact After Sales Support for advice on repair or replacement, or refer servicing to qualified personnel only.
- Children should be supervised to ensure they do not play with the product.

- Do not put any object on top of the product.
- Do not place or store appliance where it can fall or be pulled into a bath or sink.
- This product is not intended for use by persons (including children) with reduced physical, sensory or mental capabilities, or lack of experience and knowledge, unless they have been given supervision or instruction concerning use of the product by a person responsible for their safety.
- Do not expose the product to microwaves.
- Clean using a dry cloth only – do not use water or chemicals.
- Keep the product away from oils, chemicals or any other organic liquids.
- Use this appliance only for its intended purpose as described in this guide.

Responsible disposal of the packaging

- The packaging of your product has been selected from environmentally friendly materials and can usually be recycled. Please ensure these are disposed of correctly. Plastic wrapping can be a suffocation hazard for babies and young children, please ensure all packaging materials are out of reach and are safely disposed of. Please recycle these materials rather than throwing them away.

Responsible disposal of the product

- At the end of its working life, do not throw this product out with your household rubbish. An environmentally friendly method of disposal will ensure that valuable raw materials can be recycled. Electrical and electronic items contain materials and substances which, if handled or disposed of incorrectly, could potentially be hazardous to the environment and human health.
- **Give us a call**
- **What? You mean this User Guide didn't have ALL the answers? Speak to us! We'd love to help you get up and running as quickly as possible.**
- **Call our After Sales Support on 1300 002 534.**
- **Operating hours: Monday-Friday, 8:30am-6pm; Saturday, 9am-6pm AEST**
- **Enjoy using your product!**
- **Well done, you made it.**
- **Now sit back and relax... your product is automatically covered by a 1-year warranty. How nice!**

Documents / Resources

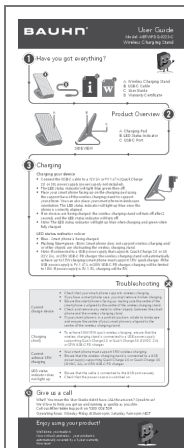

[BAUHN ABTWPDPQ-0223-C Wireless Charging Stand](#) [pdf] User Guide
ABTWPDPQ-0223-C Wireless Charging Stand, ABTWPDPQ-0223-C, ABTWPDPQ-0223-C
Charging Stand, Wireless Charging Stand, Charging Stand, Wireless Charging, Stand