



## Bauer 57710-UPC Laser Level Tripod Owner's Manual

[Home](#) » [BAUER](#) » Bauer 57710-UPC Laser Level Tripod Owner's Manual 

### Contents

- [1 Bauer 57710-UPC Laser Level Tripod](#)
- [2 IMPORTANT SAFETY INFORMATION](#)
- [3 Operation](#)
- [4 Maintenance and Servicing](#)
- [5 Parts List and Assembly Diagram](#)
- [6 LIMITED 90 DAY WARRANTY](#)
- [7 Documents / Resources](#)
- [8 Related Posts](#)

***Bauer***<sup>™</sup>

**Bauer 57710-UPC Laser Level Tripod**



## **IMPORTANT SAFETY INFORMATION**

### **WARNING SYMBOLS AND DEFINITIONS**

- This is the safety alert symbol. It is used to alert you to potential personal injury hazards. Obey all safety messages that follow this symbol to avoid possible injury or death.
- Indicates a hazardous situation which, if not avoided, will result in death or serious injury.
- Indicates a hazardous situation which, if not avoided, could result in death or serious injury.
- Indicates a hazardous situation which, if not avoided, could result in minor or moderate injury.
- Addresses practices not related to personal injury.

### **General Safety Warnings**

1. Keep work area clean and well lit.
2. This product is not a toy. Keep it out of reach of children.
3. Inspect before every use; do not use if parts are loose or damaged.
4. Stay alert, watch what you are doing and use common sense when operating Tripod. Do not use Tripod while you are tired or under the influence of drugs, alcohol or medication.
5. Dress properly. Do not wear loose clothing or jewelry. Keep your hair, clothing and gloves away from moving parts.
6. Maintain labels and nameplates on the tool. These carry important safety information. If unreadable or missing, contact Harbor Freight Tools for a replacement.
7. The warnings, precautions, and instructions discussed in this instruction manual cannot cover all possible conditions and situations that may occur. It must be understood by the operator that common sense and caution are factors which cannot be built into this product, but must be supplied by the operator.

### **Specifications**

- **Adjustable Height** 23-1/2" – 59"
- **Platform Screw Size** 1/4" – 20

## Operation

1. Position the Tripod on a flat and level ground surface capable of support the weight of the Tripod and Laser Level attached to it.
2. Extend Legs to the desired height by using the Lift Rod and Levers.



3. Turn Lift Rod to loosen from Main Shaft then lift the Tripod to desired height. Once height is achieved, turn to tighten the Lift Rod and secure in place.
4. If needed, use middle Lever on each Leg to extend height further.
  - **a.** Lift Lever and pull leg section down. The middle Lever adjusts the middle section of the Leg and the lower Lever adjusts the lower section.
  - **b.** Once height is achieved, close Lever to lock in place securely.



**Lift Lever  
to open**



**Push Lever  
to close**

5. Make sure that the Lift Rod and Levers on each Leg are securely locked, and that the Tripod is level.
6. Before attaching the Laser Level, check that its thread size matches the Platform's screw size.
7. Connect Laser Level to Platform by pulling the Spring Latch open and removing the Mounting Plate.



8. Attach Laser Level to Mounting Plate by screwing it in fully to secure.
9. Reattach Mounting Plate to the Platform.

- **a.** Pull open the Spring Latch and insert the Mounting Plate.
- **b.** Make sure the Mounting Plate is fully inserted and lies flat in the Platform.
- **c.** Release the Spring Latch and be sure it closes fully to secure the Mounting Plate in place.

10. If the height of the Platform needs to be adjusted, first grasp the Handle to support the Tripod.

- **a.** Turn Set Knob to loosed and then rotate Crank to adjust the Platform's height.
- **b.** When desired height is achieved, turn Set Knob to tighten securely and then release Handle.

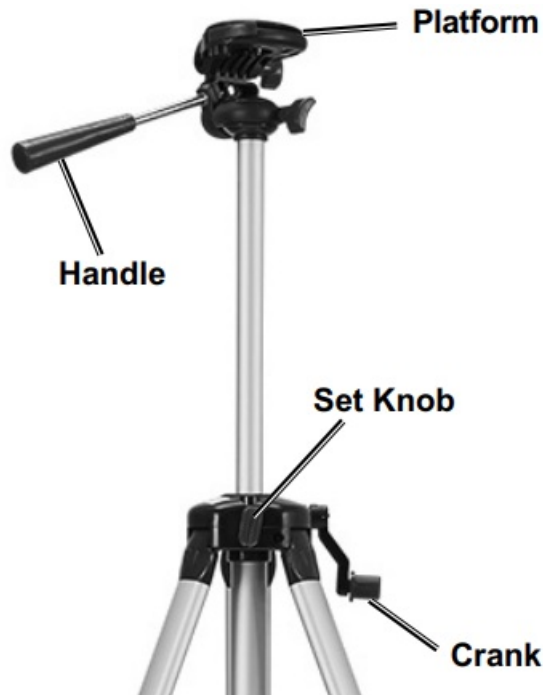

## Maintenance and Servicing

Procedures not specifically explained in this manual must be performed only by a qualified technician.

**WARNING TO PREVENT SERIOUS INJURY FROM TOOL FAILURE:** Do not use damaged equipment. If abnormal noise or vibration occurs, have the problem corrected before further use.

1. **BEFORE EACH USE**, inspect the general condition of the Tripod. Check for loose hardware, misalignment or binding of moving parts, cracked or broken parts, and any other condition that may affect its safe operation.
2. **AFTER USE**, wipe external surfaces of the tool with clean cloth. Do not immerse the Tripod in any liquids.
3. Store Tripod indoors and out of children's reach.

### PLEASE READ THE FOLLOWING CAREFULLY

THE MANUFACTURER AND/OR DISTRIBUTOR HAS PROVIDED THE PARTS LIST AND ASSEMBLY DIAGRAM IN THIS MANUAL AS A REFERENCE TOOL ONLY. NEITHER THE MANUFACTURER OR DISTRIBUTOR MAKES ANY REPRESENTATION OR WARRANTY OF ANY KIND TO THE BUYER THAT HE OR SHE IS QUALIFIED TO MAKE ANY REPAIRS TO THE PRODUCT, OR THAT HE OR SHE IS QUALIFIED TO REPLACE ANY PARTS OF THE PRODUCT. IN FACT, THE MANUFACTURER AND/OR DISTRIBUTOR EXPRESSLY STATES THAT ALL REPAIRS AND PARTS REPLACEMENTS SHOULD BE UNDERTAKEN BY CERTIFIED AND LICENSED TECHNICIANS, AND NOT BY THE BUYER. THE BUYER ASSUMES ALL RISK AND LIABILITY ARISING OUT OF HIS OR HER REPAIRS TO THE ORIGINAL PRODUCT OR REPLACEMENT PARTS THERETO, OR ARISING OUT OF HIS OR HER INSTALLATION OF REPLACEMENT PARTS THERETO.

## Parts List and Assembly Diagram

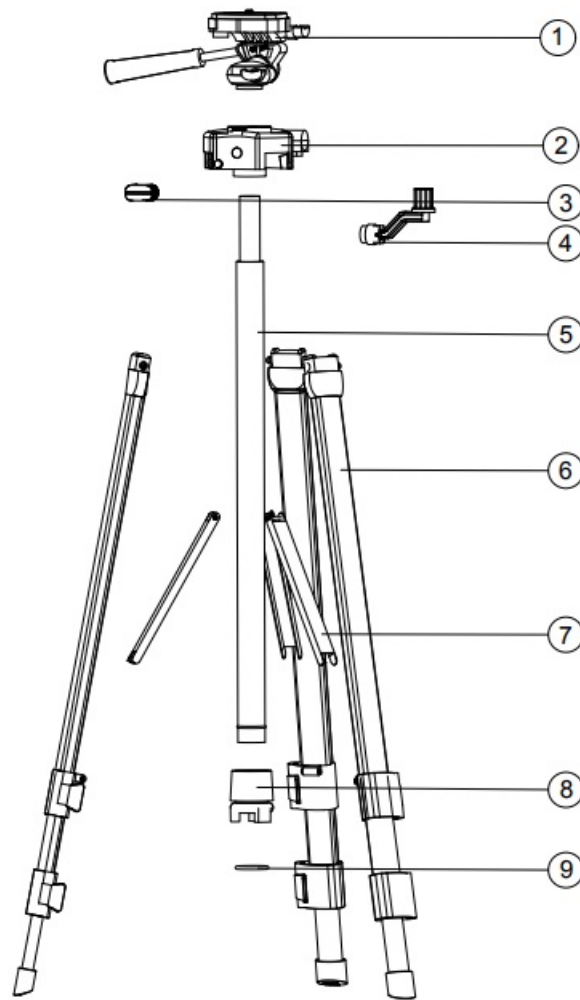

1. Platform 1
2. Base 1
3. Set Knob 1
4. Crank 1
5. Main Shaft 1
6. Leg 3
7. Leg Support 3
8. Lift Rod 1
9. O-Ring 1

**Record Product's Serial Number Here:**

- **Note:** If product has no serial number, record month and year of purchase instead.
- **Note:** Some parts are listed and shown for illustration purposes only, and are not available individually as replacement parts. Specify UPC 193175501493 when ordering parts.

**LIMITED 90 DAY WARRANTY**

Harbor Freight Tools Co. makes every effort to assure that its products meet high quality and durability standards, and warrants to the original purchaser that this product is free from defects in materials and workmanship for the period of 90 days from the date of purchase. This warranty does not apply to damage due directly or indirectly, to misuse, abuse, negligence or accidents, repairs or alterations outside our facilities, criminal activity, improper installation, normal wear and tear, or to lack of maintenance. We shall in no event be liable for death, injuries to

persons or property, or for incidental, contingent, special or consequential damages arising from the use of our product. Some states do not allow the exclusion or limitation of incidental or consequential damages, so the above limitation of exclusion may not apply to you.

THIS WARRANTY IS EXPRESSLY IN LIEU OF ALL OTHER WARRANTIES, EXPRESS OR IMPLIED, INCLUDING THE WARRANTIES OF MERCHANTABILITY AND FITNESS.

To take advantage of this warranty, the product or part must be returned to us with transportation charges prepaid. Proof of purchase date and an explanation of the complaint must accompany the merchandise. If our inspection verifies the defect, we will either repair or replace the product at our election or we may elect to refund the purchase price if we cannot readily and quickly provide you with a replacement. We will return repaired products at our expense, but if we determine there is no defect, or that the defect resulted from causes not within the scope of our warranty, then you must bear the cost of returning the product. This warranty gives you specific legal rights and you may also have other rights which vary from state to state.

- 26677 Agoura Road
- Calabasas, CA 91302
- 1-888-866-5797

Copyright© 2022 by Harbor Freight Tools®. All rights reserved.

No portion of this manual or any artwork contained herein may be reproduced in any shape or form without the express written consent of Harbor Freight Tools. Diagrams within this manual may not be drawn proportionally. Due to continuing improvements, actual product may differ slightly from the product described herein. Tools required for assembly and service may not be included.

Visit our website at: <http://www.harborfreight.com>

Email our technical support at: [productsupport@harborfreight.com](mailto:productsupport@harborfreight.com)

When unpacking, make sure that the product is intact and undamaged. If any parts are missing or broken, please call 1-888-866-5797 as soon as possible.

## Documents / Resources

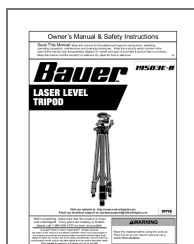

[Bauer 57710-UPC Laser Level Tripod](#) [pdf] Owner's Manual

57710-UPC, Laser Level Tripod, Level Tripod, Laser Tripod, Tripod, 57710-UPC Level Tripod