



BASU RC1BL eAlarm Plus 130db Emergency Alarm Instruction Manual

[Home](#) » [BASU](#) » BASU RC1BL eAlarm Plus 130db Emergency Alarm Instruction Manual 

BASU RC1BL eAlarm Plus 130db Emergency Alarm Instruction Manual



Manual

Thank you for choosing our anti loss personal alarm before using the device for the first time, please carefully read the instructions and keep them properly for future reference.

Contents

- [1 Standard packing list](#)
- [2 Specifications](#)
- [3 How to connect with your iphone](#)
- [4 Anti-loss device operation instructions](#)
- [5 Personal alarm Usage](#)
- [6 FCC Caution](#)
- [7 Documents / Resources](#)
 - [7.1 References](#)
- [8 Related Posts](#)

Standard packing list

- Personal alarm*1
- Manual*1
- Charging
- Cable*1
- Carabiner*1

Specifications

Model: AF-2004-Tag	Alarm frequency: 2.9~5KHz
Alarm decibel: 130dB	Battery: 3.7V 130mAh
Alarm duration: 90min	Charging time: ≥60min
Lighting time: 240min	Material: ABS
Standby current: ≤50uA	Size: 100*31*13.5mm
Illumination current: ≤45uA	Product net weight: 28g

How to connect with your iphone

1. **Power on:** Press and hold the button for 5 seconds, the device will beep and turn on. (How to confirm if the device is turned on: Press the device button twice, and the device will emit a sound, indicating that the device is turned on and does not require a reset)
2. **Enter the built-in app of the iPhone:** FindMy.
3. **Select:** Item.
4. **Select:** Add item.
5. **Select:** Other supported items.
6. During the process of searching for items, you will find “AF-2004 Tag”.
7. Click on the device and name it.
8. After naming, you can connect and use the device’s functions.
 - A. Call the device, click to play sound, and the device will emit music.
 - B. Search for network help: When the device is away from Bluetooth distance, it cannot be connected in the app. You can choose the lost mode and enable it. Enter the contact person’s phone number, If there is an

iPhone near the lost device, the iPhone owner will receive notifications and the latest location.

9. **Remove device:** To remove a device from the app, you can choose to remove the item.
10. After removing the device, device will not power off and is in a paired state.

If there is no repairing within 10 minutes, the device will exit the pairing state.

If you need to pair the device at this time, you need to reset the pairing status and then you can pair it with the APP again.

Anti-loss device operation instructions

1. **Power on:** If the device is in shutdown sleep mode, press and hold the button for 5 seconds, the device will emit a prompt sound, and the indicator light will flash 3 times. The device is turned on, and after power on, the device is in pairing mode. Device will timeout more than 10 minutes.
2. **Device status confirmation:** click the device button twice, and the device will emit a prompt sound. When not paired, click the button twice will not flash the light. After pairing, the light will flash. The indicator light will flash three times, indicating that the device is in a power on state. If the device has no sound, it is in shutdown sleep mode Press and hold for 5 seconds to turn on the device.
3. **Pairing mode timeout, device enters pairing mode again:** After removing the device, the device will emit a sound and the indicator light will flash 6 times. The device will not shut down and is in pairing mode. If there is no repairing within 10 minutes, the device will exit pairing mode (at this time, the device cannot pair with the app). If a device needs to be paired and needs to be reset, the device will emit a prompt sound. At this time, the device enters pairing mode and can search by the app again.
4. **How to query serial number:** Press the button 5 times within 2 seconds, the device will emit 6 beeps, and enter the serial number reading state
5. **Restore Factory Settings:** After the device is turned on, click the device button twice to emit a prompt sound and Indicator light flashing, and then press and hold the device button for about 8 seconds until the device emits a prompt sound, indicator light flashing 3 times, and then release the button. The factory settings have been restored.
6. **The device enters shutdown sleep mode from the power on state:** When the device is in the power on state, press and hold the button for 5 seconds, there will be a sound, and the LED will flash 3 times to enter shutdown sleep mode.
7. **Low battery notification:** The light flashes slightly and the device makes a beeping sound – 3 times simultaneously

Personal alarm Usage

Alarm:

Pull the top pin to activate the alarm with flashing light. Push the pin back in to disarm both.

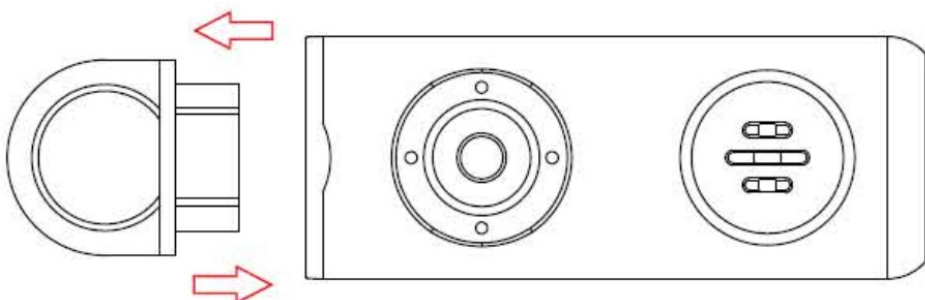

Light:

Every time you click the lighting button to switch the lighting mode, switch between 'on-flicker-off.

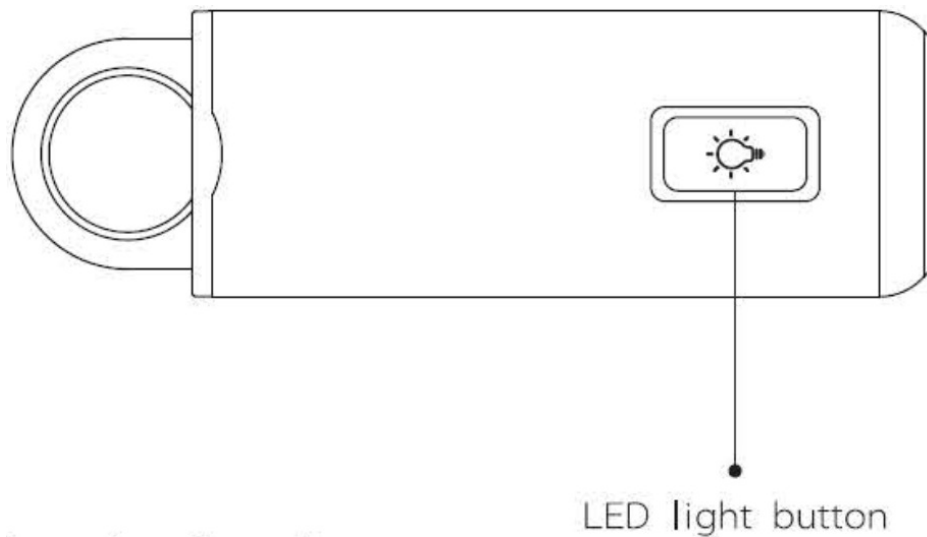
**Charging function:**

Red light is on when charging, turning green when fully charged.

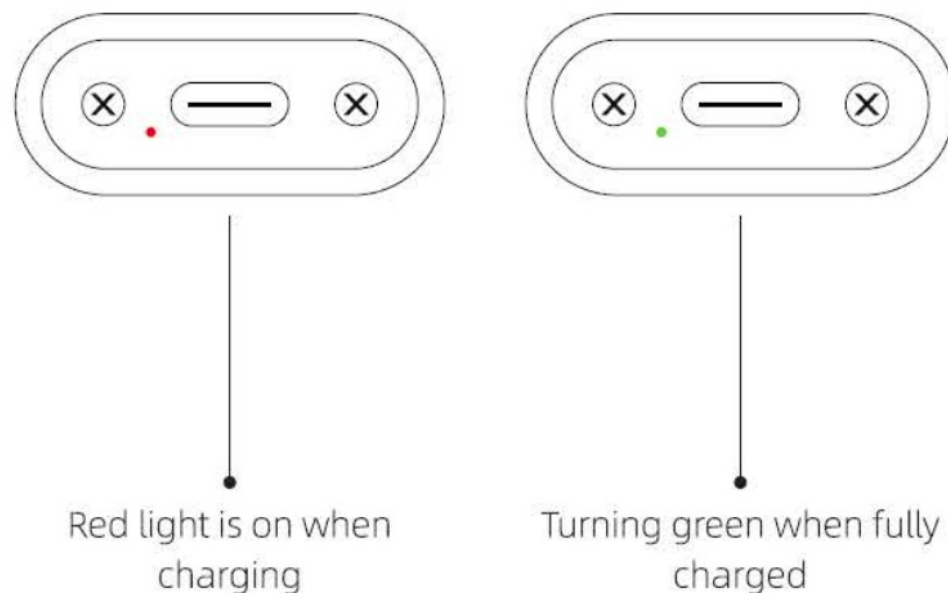
**FCC Caution**

This device complies with part 15 of the FCC Rules. Operation is subject to the following two conditions:

1. This device may not cause harmful interference, and
2. this device must accept any interference received, including interference that may cause undesired operation.

Any Changes or modifications not expressly approved by the party responsible for compliance could void the user's authority to operate the equipment.

Note: This equipment has been tested and found to comply with the limits for a Class B digital device, pursuant to part 15 of the FCC Rules. These limits are designed to provide reasonable protection against harmful interference in a residential installation. This equipment generates uses and can radiate radio frequency energy and, if not installed and used in accordance with the instructions, may cause harmful interference to radio communications. However, there is no guarantee that interference will not occur in a particular installation. If this equipment does cause harmful interference to radio or television reception, which can be determined by turning the equipment off and on, the user is encouraged to try to correct the interference by one or more of the following measures:

- Reorient or relocate the receiving antenna.
- Increase the separation between the equipment and receiver.
- Connect the equipment into an outlet on a circuit different from that to which the receiver is connected.
- Consult the dealer or an experienced radio/TV technician for help.

The device has been evaluated to meet general RF exposure requirement. The device can be used in portable exposure condition without restriction.

Documents / Resources



[BASU RC1BL eAlarm Plus 130db Emergency Alarm](#) [pdf] Instruction Manual
RC1BL eAlarm Plus 130db Emergency Alarm, RC1BL, eAlarm Plus 130db Emergency Alarm, Plus 130db Emergency Alarm, 130db Emergency Alarm, Emergency Alarm, Alarm

References

- [User Manual](#)

Manuals+, Privacy Policy

This website is an independent publication and is neither affiliated with nor endorsed by any of the trademark owners. The "Bluetooth®" word mark and logos are registered trademarks owned by Bluetooth SIG, Inc. The "Wi-Fi®" word mark and logos are registered trademarks owned by the Wi-Fi Alliance. Any use of these marks on this website does not imply any affiliation with or endorsement.