



Baseus K02 Ultra-Thin Wireless Keyboard User Manual

[Home](#) » [Baseus](#) » Baseus K02 Ultra-Thin Wireless Keyboard User Manual 

Contents

- [1 Baseus K02 Ultra-Thin Wireless Keyboard](#)
- [2 Pairing](#)
- [3 Silicon Pad](#)
- [4 Function Combinations](#)
- [5 Specifications](#)
- [6 Content](#)
- [7 FCC Rules](#)
- [8 Documents / Resources](#)

Baseus

Baseus K02 Ultra-Thin Wireless Keyboard



Pairing

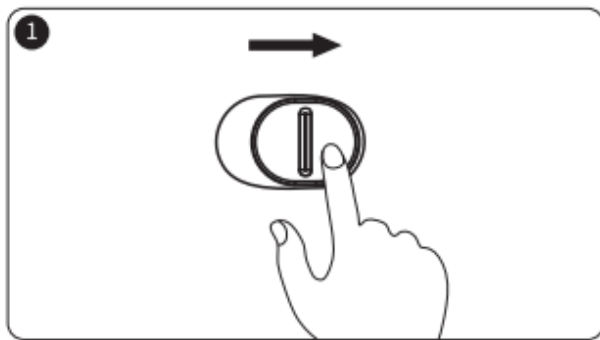

Power on the product

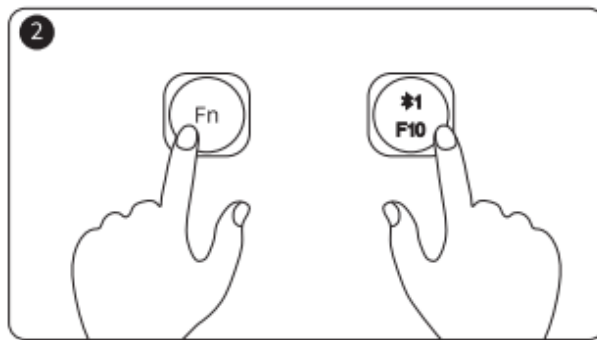

Press and hold Fn key; meanwhile, press the Wireless channel key, the blue indicator will light up for 1s before turning off

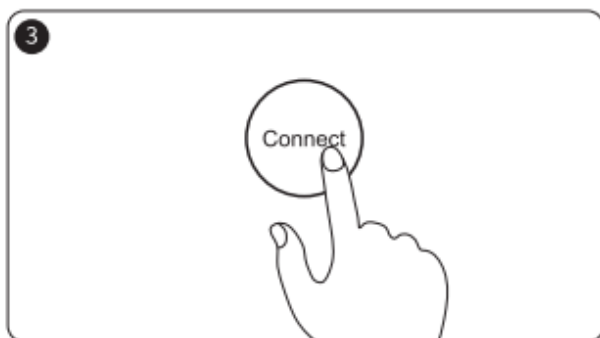

Press pairing key ; the blue indicator will flash, and then enter pairing mode

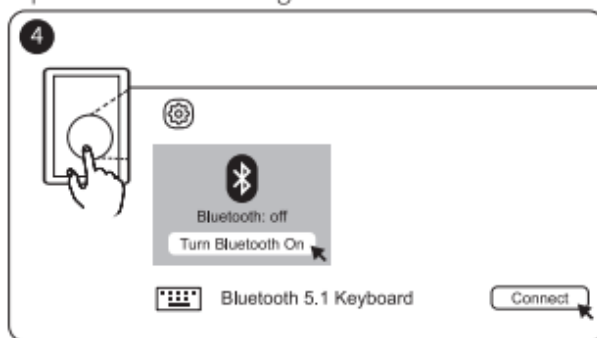





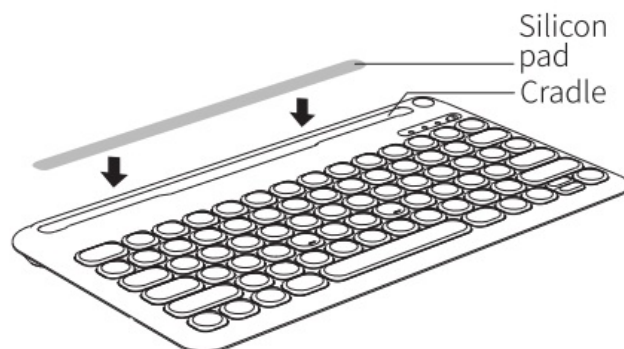
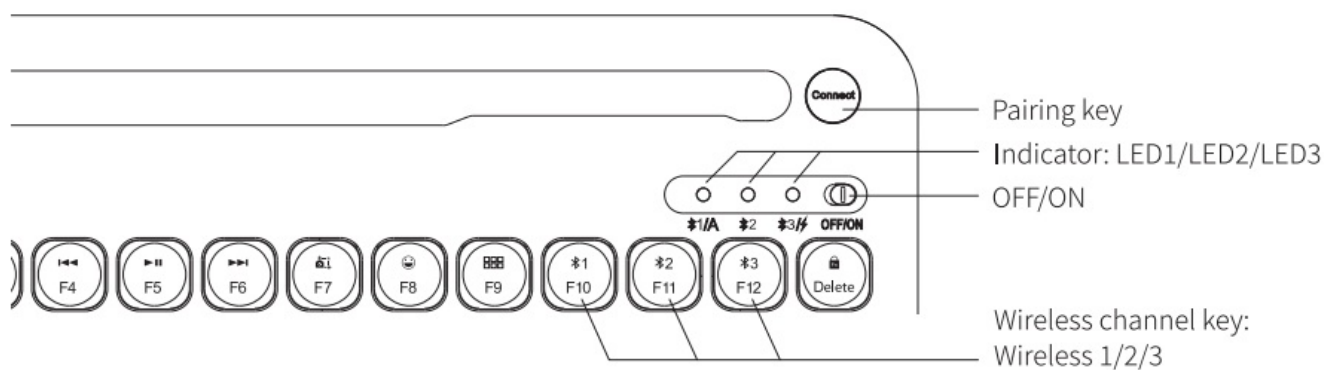















Enable Wireless function, enter searching & pairing status, select the Wireless: Baseus K02 Keyboard

Silicon Pad

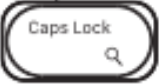

Install the silicon pad into the cradle, and place the tablet or cellphone(caseless) into the cradle.

Function Combinations

Key Icon	Mac OS System Function	Windows System Function	IPAD System Function	Samsung A6 System Function	Key Icon	Mac OS System Function	Windows System Function	IPAD System Function	Samsung A6 System Function
	Single click: ESC Fn+ esc= Return	Single click: ESC Fn+ ESC=Web	Single click: Return to the homepage Fn+ ESC= ESC			Single click: F1 Fn+ F1= Mute		Single click: Mute Fn+ F1= F1	
	Single click: F2 Fn+ F2= Volume -		Single click: Volume - Fn+ F2= F2			Single click: F3 Fn+ F3= Volume +		Single click: Volume + Fn+ F3= F3	
	Single click: F4 Fn+ F4= Previous		Single click: Previous Fn+ F4= F4			Single click: F5 Fn+ F5= Play/pause		Single click: Play/pause Fn+ F5= F5	
	Single click: F6 Fn+ F6= Next		Single click: Next Fn+ F6= F6			Single click: F7 Fn+ F7= Screenshot		Single click: Screenshot Fn+ F7= F7	
	Single click: F8 Fn+ F8= Emoji window		Single click: No function Fn+ F8= F8			Single click: F9 Fn+ F9= Launch pad	Single click: F9 Fn+ F9= Switch activity window	Single click: Return to the homepage Fn+ F9= F9	Single click: Switch activity window Fn+ F9= F9
	Single click: F10 Short press FN+ F10: Switch Wireless 1 channel Press and hold FN + F10 for 3s: Wireless 1 code match and broadcast					Single click: F11 Short press FN+ F11: Switch Wireless 2 channel Press and hold FN + F11 for 3s: Wireless 2 code match and broadcast			
	Single click: F12 Short press FN+ F12: Switch Wireless 3 channel Press and hold FN + F12 for 3s: Wireless 3 code match and broadcast					Single click: DEL FN + delete: Fn lock			
	Single click: Tab FN + tab: Lock screen				Single click: Cap FN + caps lock: Search				
	Single click: Up key FN + PgUp: Page head	Single click: Up key FN + PgUp: PgUp			Single click: Down key FN + PgDn: Page bottom	Single click: Down key FN + PgDn: PgDn			
	Single click: Left key FN + Home: Line head	Single click: Left key FN + Home: Home			Single click: Right key FN + End: Line end	Single click: Right key FN + End : End			
	Power switch Push to the left to power off Push to the right to power on								

Warnings

- Because the product contains a battery, it should never be exposed to direct sunlight, excessive heat, or a high-Intensity magnetic field.
- Never Lise it in a wet environment; instead, keep it dry. Please Lise a soft and dry cloth to dean the product.
- A professional should only dismantle the product; otherwise, it may catch fire or be completely damaged.
- Powering off the product before long-term idling is recommended to reduce power toss and extend it:s. life.

Declaration on hazardous substances and elements contained in electronic products

Part Description	Hazardous substances and elements 					
	Lead (Pb)	Mercury (Hg)	Cadmium (Cd)	Hexavalent chromium (CrVI)	Polybrominated Biphenyls (PBB)	Polybrominated Biphenyl ethers (PBDE)
PCB	X	O	O	O	O	O
Plastic	O	O	O	O	O	O
Accessory	O	O	O	O	O	O

This form is compiled in accordance with SJ/T 11364.

- **O:** It indicates that the content of the harmful substance in all homogeneous materials of the component is below the limit specified in GB/T 26572 standard.
- **X:** The content of harmful substances in at least one homogeneous material of this part exceeds the limit stipulated in GB/T 26572 standard.
- **Warm Tip:** The 10-year icon refers to the “effective life of environmental protection not the product quality assurance period. Electronic products all contain harmful substances such as lead, mercury and cadmium. Once they are overused, harmful substances may leak or mutate, cause pollution to the environment, or cause serious damage to people and property. The term of “environmental protection use” means that all electronic products will be required to use within this effective period. We will no longer be responsible for the quality of the products due to the safety risks that arise after the safe use period.

Specifications

- Name: Baseus K02 Ultra-thin Wireless Keyboard
- Model No.: BS K02
- Wireless version: Wireless 5.1
- Transmission distance: 10m
- Battery capacity: 1000mAh
- Standby current: 0.7mA
- Time to fully charge: hours
- Shallow sleep period: Enter auto sleep after idling for 3 min.
- Deep sleep period: Enter auto sleep after idling for 10 min.
- Compatible with: Windows, Apple OSN Harmony OS
- Dimensions: 294 > 169 x 19.5mm

* The data sources listed above represent measured values from the Baseus laboratory, although they may differ or be erroneous due to changes in the actual environment.

Content

- Wireless keyboard > 1,
- Silicone pad > 1,
- USB cable > 1,
- User manual > 1

It is hereby declared that BS-K02, a product model of Shenzhen Baseus Technology Co., Ltd., td., complies with the provisions of Directive 2014/53/EU, Directive 2011/65/EU. The full text of the EC Declaration of Conformity can be found on the following website: www.baseus.com

FCC Rules

This device complies with part 15 Of the FCC Rules. Operation is subject to the following two conditions: (1) this device may not cause harmful interference, and (2) this device must accept any interference received, including interference that may cause undesired operation. Any changes or modifications not expressly approved by the party responsible for compliance could void the user's authority to operate the equipment. NOTE: This equipment has been tested and found to comply with the limits for a Class B digital device, pursuant to Part 15 Of the FCC Rules. These limits are designed to provide reasonable protection against harmful interference in a residential installation. This equipment generates, uses and can radiate radio frequency energy and, if not installed and used in accordance with the instructions, may cause harmful interference to radio communications. However, there is no guarantee that interference will not occur in a particular installation. If this equipment does cause harmful interference to radio or television reception, which can be determined by turning the equipment Off and on, the user is encouraged to try to correct the interference by one or more Of the following measures:

- Reorient or relocate the receiving antenna.
- Increase the separation between the equipment and receiver.
- Connect the equipment into an outlet on a circuit different from that to which the receiver is connected.
- Consult the dealer or an experienced radio/TV technician for help.



This equipment complies with the provisions Of Directive 2012/19/EU and Directive 2006/66/EU. It is strictly forbidden to dispose Of this equipment with ordinary trash; it must be recycled. This symbol indicates that the product shall not be treated as regular domestic trash, and must be delivered to a recycling center that is capable Of recycling electronic and electrical equipment.

WARNING please keep the product away from fire source and do not dismantle or repair the product by yourself. please contact our customer service for help if you have any problem with the product.



FCC ID:2A482-BS-K02

Manufacturer: Shenzhen Baseus Technology Co., Ltd. Add: 2nd Floor, Building B, Baseus Intelligence Park, No.2008, Xuegang Rd, Gangtou Community, Bantian Street, Longgang District, Shenzhen Executive Standard: Q/BASEUS 082 Hotline: +86-4000-712-711 Website: www.baseus.com Official After-sales E-mail Address: service@baseus.com

Designed by Baseus
Made in China

Documents / Resources



[Baseus K02 Ultra-Thin Wireless Keyboard](#) [pdf] User Manual
2A482-BS-K02, 2A482BSK02, bs k02, K02, Ultra-Thin Wireless Keyboard, K02 Ultra-Thin Wire
less Keyboard, Wireless Keyboard, Keyboard