

baseus Security P1 Lite Indoor Camera



Baseus Security P1 Lite Indoor Camera User Manual

[Home](#) » [Baseus](#) » Baseus Security P1 Lite Indoor Camera User Manual 

Contents

- [1 Baseus Security P1 Lite Indoor Camera User Manual](#)
- [2 PRODUCT SPECIFICATIONS](#)
- [3 PRODUCT APPEARANCE](#)
- [4 PACKAGE INCLUDING](#)
- [5 SETUP INSTRUCTIONS](#)
- [6 CAMERA INSTALLATION](#)
- [7 FCC Statement](#)
- [8 WARRANTY](#)
- [9 References](#)
- [10 Related Posts](#)

baseus

Baseus Security P1 Lite Indoor Camera User Manual



PRODUCT SPECIFICATIONS

- **Power input:** 5 V-1 A
- **Resolution:** 2304 X 1296
- **Storage:** microSD card (up to 256 GB)
- **Working temperature:** -10°C to +40°C

PRODUCT APPEARANCE

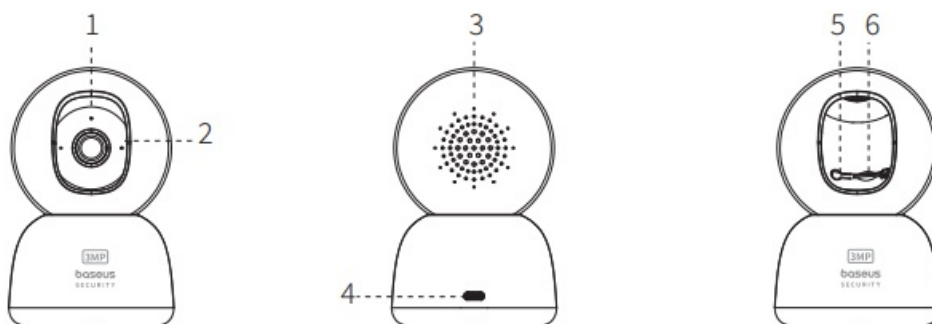

1. Indicator light
2. Microphone
3. Speaker
4. USB-C charging port
5. Reset button
6. Micro SD/TF card slot

PACKAGE INCLUDING

- Camera ×1

- Installation base ×1
- Expansion screw ×2
- Charging cable (USB-A to USB-C) ×1
- Quick Start Guide ×1

SETUP INSTRUCTIONS

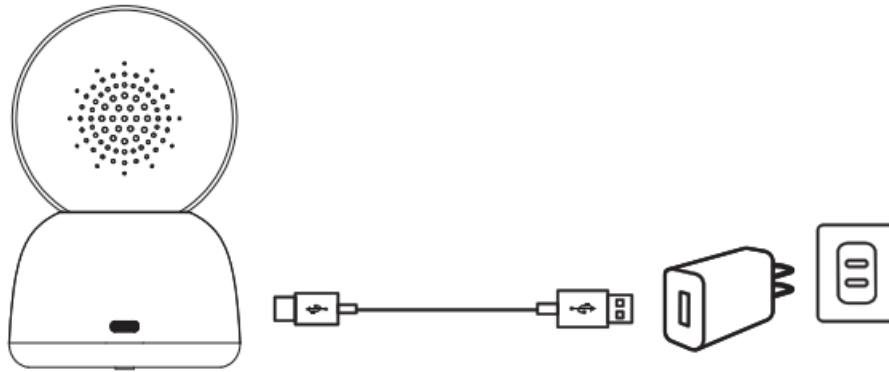

1. Download and install the baseus Security App, and register an account.
2. Plug the charging cable into the USB-C charging port on the back of the camera. The camera will automatically turn on and the indicator light will flash red.
3. Add the camera by following the instructions on the App.

CAMERA INSTALLATION

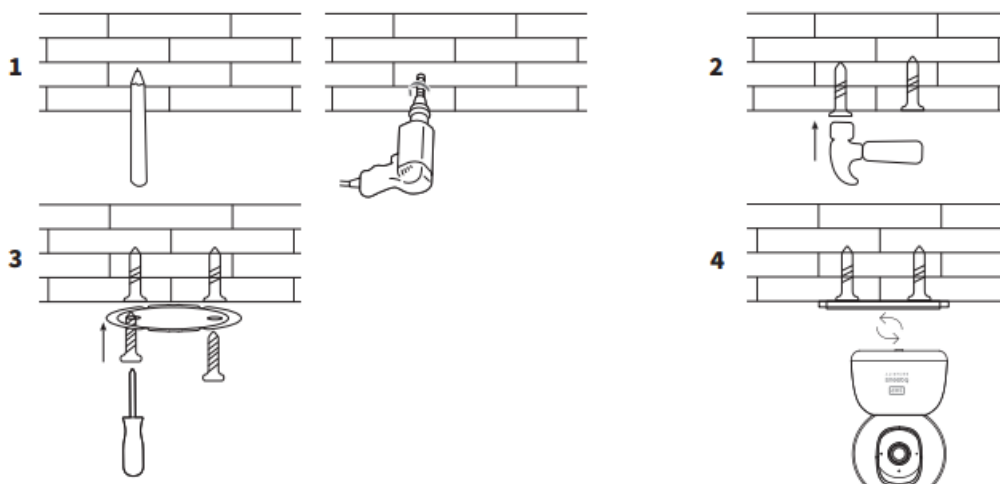

Install the camera

The camera can be placed on a flat surface such as a desk, dining table, or coffee table, or it can be fixed on the wall.

Mounting the camera on the wall:

1. Use a pencil to mark the installation positions on the wall according to the hole spacing on the installation base, and then use a drilling tool to drill two holes with a diameter of 6 mm and depth of 30 mm in the marked positions.
2. Insert the expansion sleeves into the drilled holes.

3. Align the two holes of the installation base with the holes on the wall, insert the screws through the holes of the installation base, and use a screwdriver to fasten the screws into the expansion sleeves.
4. Align the grooves on the bottom of the camera with the protruding parts of the installation base and rotate the camera clockwise to lock it in place.

NOTICE

The device is not a toy.

Choking Hazard: The product contains (or comes with) small parts, plastic elements, cables and parts that may cause choking hazard. Keep your camera and its accessories out of the reach of small children. Consult a physician immediately if small parts are swallowed. **Strangulation Hazard:** Children get strangled in cords. Keep cords out of the reach of children (more than 3ft/0.9 m away). The recommended temperature range for devices and accessories is -10°C to 40°C 14°F to 104°F). Unless specifically indicated that it is safe to do so in the user guide or instruction manual, avoid exposing your device to direct sunshine or excessively wet environments. For pluggable equipment, the socket-outlet shall be easily accessible. Use only the adapter provided by the manufacturer. Using unauthorized adapters may cause danger and violate the authorized use of the device or the warranty article.

SAFETY

This symbol indicates that this product shall not be treated as household waste. Instead, it shall be handed over to the applicable collection point for the recycling of electrical and electronic equipment. Follow local rules and never dispose of the product with normal household waste.

FCC Statement

This device complies with Part 15 of the FCC Rules. Operation is subject to the following two conditions:

1. this device may not cause harmful interference, and
2. this device must accept any interference received, including interference that may cause undesired operation.

Any Changes or modifications not expressly approved by the party responsible for compliance could void the user's authority to operate the equipment. This equipment has been tested and found to comply with the limits for a Class B digital device, pursuant to part 15 of the FCC Rules. These limits are designed to provide reasonable protection against harmful interference in a residential installation. This equipment generates, uses and can radiate radio frequency energy and, if not installed and used in accordance with the instructions, may cause harmful interference to radio communications. However, there is no guarantee that interference will not occur in a particular installation. If this equipment does cause harmful interference to radio or television reception, which can be determined by turning the equipment off and on, the user is encouraged to try to correct the interference by one or more of the following measures:

- Reorient or relocate the receiving antenna.
- Increase the separation between the equipment and the receiver.
- Connect the equipment into an outlet on a circuit different from that to which the receiver is connected.
- Consult the dealer or an experienced radio/TV technician for help

For the USA: The frequency stability of all transmission frequencies of U-NII-1 and U-NII-3 meets the requirements of 47 CFR FCC Part15.407(g), and the manufacturer declares that their transmission is maintained at Band U-NII-1 and U-NII-3.

FCC Radio Frequency Exposure Statement

The device has been evaluated to meet general RF exposure requirement. The device can be used in fixed/mobile

exposure condition. The min separation distance is 20cm.

The following importer is the responsible party (for FCC matters only)

- **Company Name:** BASEUS TECHNOLOGY (US) INC
- **Address:** 421 S BROOKHURST ST SUITE 1312 ANAHEIM, CA 92804
- **Telephone:** +6-145412699

This produce nomplies with the radio interference requirements of the European Community.

Declaration of Conformity

Shenzhen Baseus Technology Co., Ltd. Declares that the product is in compliance with Directive 2014/53/EU. The full text of the EU declaration of conformity is available at the following internet address:

<https://eu.baseus.com/pages/euro-compliance>.

RF Exposure Notice

The Maximum Permissible Exposure (MPE) level has been calculated based on a distance of d=20cm between the device and the human body. To maintain compliance with RF exposure requirements, use products that maintain a 20cm distance between the device and the human body.

WARRANTY

- support@baseussecurity.com
- <https://www.baseus.com>
- **United States:** +1(800) 220 8056

Contact Us

Monday to Friday 10:00 AM -6:00 PM (UTC-5)

Customer Service

1. 24-Month Warranty
2. Lifetime Tech Support

Frequency bands and power are as below:

Model	Function	Bands	Operation Frequency	Max. Power
S0TV00	Bluetooth	2.4GHz	2402-2480MHz	EIRP:6.68dBm
	Wi-Fi	2.4GHz	2412-2472MHz	EIRP:17.18dBm

Warning: Please follow the above safety instructions Damage or other nise fire, electric shock,

- **Manufacturer:** Shenzhen Baseus Technology Co., Ltd.
- **Add:** 2nd Floor, Building B, Baseus Intelligence Park, No.2008, Xuegang Rd, Gangtou Community, Bantian Street, Longgang District, Shenzhen
- **Hotline:** +1 800 220 8056

- Website: <https://www.baseus.com>
- Monday to Friday: 10:00AM-6:00 PM(UTC-5)
 - PB5235-P0A0
 - 0000000000

Designed by Baseus

Made in China

Download PDF: [Baseus Security P1 Lite Indoor Camera User Manual](#)

References

- [User Manual](#)

[Manuals+](#), [Privacy Policy](#)

This website is an independent publication and is neither affiliated with nor endorsed by any of the trademark owners. The "Bluetooth®" word mark and logos are registered trademarks owned by Bluetooth SIG, Inc. The "Wi-Fi®" word mark and logos are registered trademarks owned by the Wi-Fi Alliance. Any use of these marks on this website does not imply any affiliation with or endorsement.