



Bartesian 55300 Premium Cocktail and Margarita Machine User Manual

[Home](#) » [Bartesian](#) » **Bartesian 55300 Premium Cocktail and Margarita Machine User Manual** 

Contents

- [1 Bartesian 55300 Premium Cocktail and Margarita Machine User Manual](#)
- [2 IMPORTANT SAFEGUARDS](#)
- [3 PARTS AND FEATURES](#)
- [4 Control Panel and Icons](#)
- [5 Important Instructions for First Use](#)
- [6 Cleaning Cocktail Machine](#)
- [7 Cleaning Removable Parts](#)
- [8 Descaling Instructions](#)
- [9 Troubleshooting](#)
- [10 Bartesian Limited Warranty](#)
- [11 References](#)

BARTESIAN

Bartesian 55300 Premium Cocktail and Margarita Machine User Manual



IMPORTANT SAFEGUARDS

When using electrical appliances, basic safety precautions should always be followed to reduce the risk of fire, electric shock, and/or injury to persons, including the following:

1. Read all instructions.
2. This appliance must be properly installed and located by these instructions before use.
3. This appliance is intended for adults of legal drinking age. This appliance is not intended for use by children or by persons with reduced physical, sensory, or mental capabilities, or lack of experience and knowledge.
4. Close supervision is necessary when any appliance is used near children. Children should be supervised to ensure that they do not play with the appliance.
5. To protect against the risk of electrical shock, do not immerse the cord, plug, or base in water or other liquid.
6. Unplug from the outlet when not in use and before cleaning or maintenance. To unplug, grasp the plug and pull from the outlet. Never pull from the power cord.
7. Do not operate any appliance with a damaged cord or plug, or after the appliance malfunctions or has been dropped or damaged in any manner.
8. Supply cord replacement and repairs must be conducted by the manufacturer, its service agent, or similarly qualified persons to avoid a hazard.
9. Contact Bartsian Customer Service to report any malfunction of or damage to the cocktail machine.
10. Do not use outdoors.
11. Do not let the cord hang over the edge of the table or counter.
12. Only use the bottles provided with your cocktail machine. The use of accessory attachments not recommended or sold by the appliance manufacturer may cause injuries.
13. Do not use a broken, chipped, or cracked spirit bottle.
14. Do not place on or near a hot gas or electric burner, or in a heated oven.
15. Always attach the plug to the appliance first, then plug the cord into the wall outlet. To disconnect, put the

appliance to “Sleep”, then remove the plug from the wall outlet.

16. The water reservoir is for water only. Do not fill with any other liquid. Do not overfill the water reservoir with water.
17. Use a lid handle to open the lid. Do not lift the lid handle when a drink is being prepared.
18. Do not use appliances for other than intended use.
19. **CAUTION:** The machine has two sharp needles that puncture the cocktail capsule. One above the cup holder and the other at the bottom of the cup holder.
20. To avoid the risk of injury, do not put your fingers in the removable capsule holder or under lid removable housing.
21. Use only with the power supply cord provided with the appliance. Do not attempt to use the power supply with any other products.
22. Replacement and repairs must be conducted by the manufacturer, its service agent, or similarly qualified persons to avoid a hazard.
23. Only use cocktail capsules sold or recommended by the appliance manufacturer.

Other Consumer Safety Information

This appliance is intended for household use only. The length of the cord used on this appliance was selected to reduce the hazards of becoming tangled in or tripping over a longer cord. If a longer cord is necessary, an approved extension cord may be used. The electrical rating of the extension cord must be equal to or greater than the rating of the appliance. If the appliance is of the grounding type, the extension cord should be a grounding-type, 3-wire cord. Care must be taken to arrange the extension cord so that it will not drape over the countertop or tabletop where it can be pulled on by children or accidentally tripped over.

If using an extension cord, it should be connected to the unit's power cord before it is plugged into the outlet. In the case of a power failure, the same procedure should be followed. The Bartesian machine is intended for use solely by responsible adults of legal drinking age in their respective country and/or state and/or province. Please use the Bartesian machine wisely and responsibly.

PARTS AND FEATURES

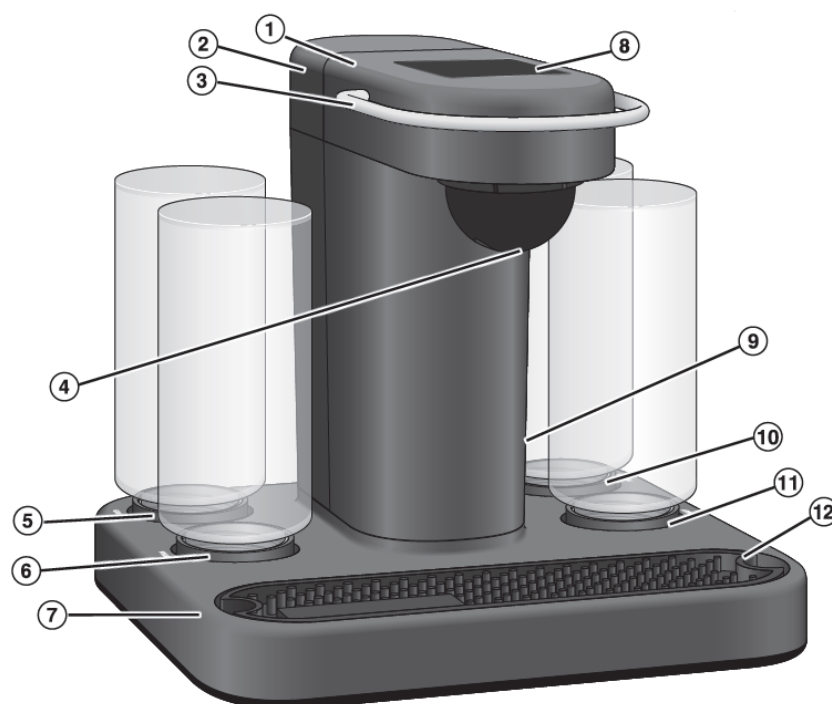

Bartesian Cocktail Machine

1. Lid
2. Removable Water
3. Reservoir with Lid
4. Lid Handle
5. Dispenser
6. Gin/Rum Spirit Bottle Holder
7. Vodka Spirit Bottle Holder
8. Base
9. Touchscreen Control Panel
10. Power Cord Port (on back)
11. Tequila Spirit Bottle Holder
12. Whiskey Spirit Bottle Holder
13. Bar Mat

UNDER THE LID

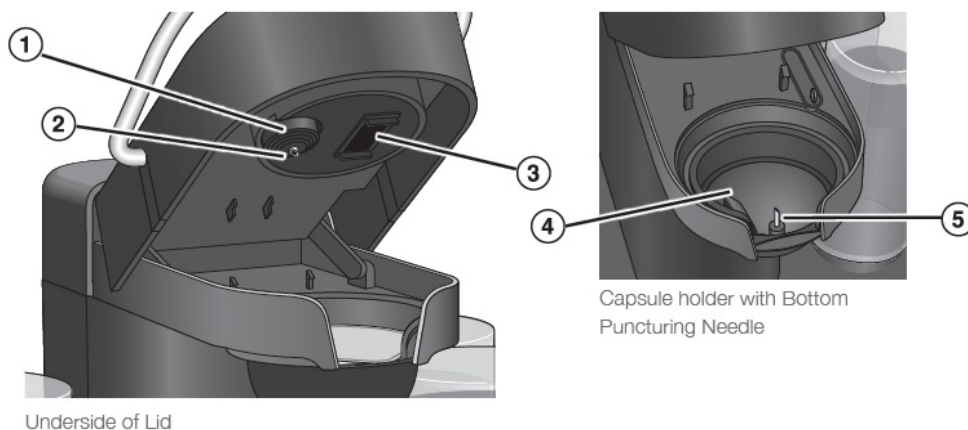

1. Removable Capsule Seal
2. Top Puncturing Needle
3. Barcode Reader
4. Capsule Holder
5. Bottom Puncturing Needle
6. Duck-Bill Valve

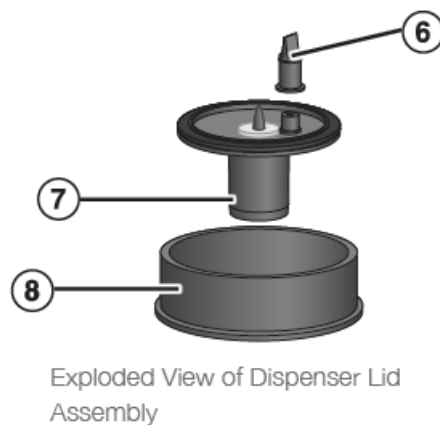

7. Spirit Lid Center

8. Spirit Lid Collar



Control Panel and Icons



Main Menu

Plug into an outlet. Touch Control Panel. The screen will display the Main Menu Screen.

Sleep – After using the machine, you can select “Sleep” to put the machine into standby mode. The Cocktail Machine will automatically go into sleep mode after 30 minutes if the Control Panel is not touched. To wake up the Cocktail Machine, touch the Control Panel.

Settings Menu (⚙️)

For first use, changing spirit bottles, cleaning, and Transport functions, select the Settings menu.

First Use – The First Use function primes the Cocktail Machine with water to ensure the machine will pump spirits and water. Follow “Important Instructions for First Use” on page 7.

Switch – When changing a Spirit Bottle over to a different spirit, the Switch function will purge the chosen spirit to eliminate cross-contamination. Follow the instructions for “How to Switch Spirits” on page 9.

Rinse/Clean – It is recommended to use the Rinse/Clean function if the Cocktail Machine will not be used for extended periods. Follow the instructions for “How to Rinse/Clean” on page 10.

Transport – The Cocktail Machine should be emptied when it is transported. This function will purge all spirits and water from the system. Follow the instructions for “How to Transport” on page 10.

Important Instructions for First Use

Remove the Cocktail Machine and components from the box and place them on a flat, sturdy surface. Wash all removable parts following “Care and Cleaning” instructions. The Bartsian Cocktail Machine features a Removable Water Reservoir with Lid. Since the mixers in the Cocktail Capsules are concentrated, all drinks are mixed with water to deliver the optimal flavor. Before using the Cocktail Machine, the water line needs to be primed. Follow these instructions to prime the system for first use.

1. Fill the Water Reservoir with water only. Do not fill with mixes, juices, club soda, or other liquids. The Cocktail Machine will stop working and void the warranty if other liquids are used.

NOTE: Because water quality varies, use bottled or filtered water for the best-tasting premium cocktails.

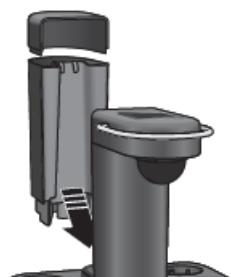

2. Place the Water Reservoir in the Base.
3. Fill each Spirit Bottle with spirits as indicated on the Dispenser Lids. Screw Lids securely in place.
4. Tip Spirit Bottles upside down and insert into Spirit Bottle Holders on Base. Spirit Bottles will snap into place. To remove, slightly tip the Spirit Bottle and slowly pull up.

NOTE: Gin and rum share the same Holder. The Cocktail Machine will prompt you to switch bottles if necessary for your cocktail. It is very important to put the Spirit Bottles in the correct Spirit Bottle Holder. If in the wrong position, the finished cocktail will be incorrectly mixed.



5. Insert the Removable Power Cord end into the Power Cord Port at the back of the Base.
6. Plug into an outlet. Touch the Control Panel to wake up the Cocktail Machine.
7. Touch Settings Menu (⚙️) on the Control Panel.
8. Place an 8-ounce (237 ml) container under Dispenser.
9. Select “First Use” and follow the prompts to prime water line.

NOTE: All four Spirit Bottles do not need to be filled and installed for the Cocktail Machine to operate, only Spirit Bottle(s) listed on label of the Cocktail Capsule in use.

How to Make Cocktails



1. Place a cocktail glass on Bar Mat. Lift Lid Handle and insert a Cocktail Capsule in Capsule Holder with tab facing front center position.
2. Lower the Handle and press firmly until latch clicks into place.



NOTE: Once Capsule is punctured, the drink must be made. The contents of the Capsule will drain if removed from Holder before finishing drink.

3. Barcode Reader will recognize cocktail. Display will indicate what type of glass to place under Dispenser, and if ice is recommended.
4. Drinks may also be dispensed into a Shaker. After placing the appropriate glass, touch "Next" on Control Panel.



IMPORTANT: If Main Menu is displayed after puncturing capsule, open Lid and wipe top of Capsule and Barcode Reader with a soft, damp cloth and close Lid.

NOTE: If rum or gin are needed for the cocktail, the machine will ask to confirm correct spirit is in Spirit Bottle Holder.



5. Control Panel will show choices of strength: Mocktail, Light, Regular, or Strong. Refer to Cocktail Capsule Packaging to understand strength for each cocktail. Press desired strength and then press “Mix” on Control Panel.
6. Cocktail Machine will dispense appropriate spirit, contents of Capsule, and water. Control Panel will show a bar that tracks progress. Bubbles will appear in Spirit Bottle as spirit is being dispensed.
7. Once drink is complete, lift Lid Handle to remove the Cocktail Capsule and dispose of the recyclable container. The Cocktail Machine is ready for next drink.

NOTE: When finished making cocktails, remove Water Reservoir and discard water. Replace the Reservoir on Base and add water before next use.

How to Switch Spirits Back

- Ensure the water reservoir has water
- Remove the spirit bottle.

Select spirit above

Gin and rum share a Bottle Holder. The following instructions are recommended to purge system when switching from one spirit to the other.

1. To change a spirit, place glass under the Dispenser and remove Spirit Bottle that is being replaced. On the Control Panel, touch Settings Menu (⚙️).
2. Select the “Switch” function from the Settings Menu and follow the instructions on the Control Panel.



3. Touch which spirit you are replacing and the machine will purge the remaining spirit from Bottle Holder. After purging is complete, the Control Panel will go back to the Main Menu.
4. After spirits are purged from the Cocktail Machine, insert a new Spirit Bottle into Bottle Holder and follow "How to Make Cocktails."



NOTE: This reminder screen will always show up when capsule is inserted for a gin or rum cocktail. If

5. Spirit Bottle has not been switched, you can change bottles now, however, you will have a small amount of previous spirit in your cocktail.

How to Rinse/Clean

If the Cocktail Machine will not be used for an extended period, it is recommended to use Rinse/Clean function.

1. Remove Spirit Bottles and return spirits back to original bottle or a suitable container.

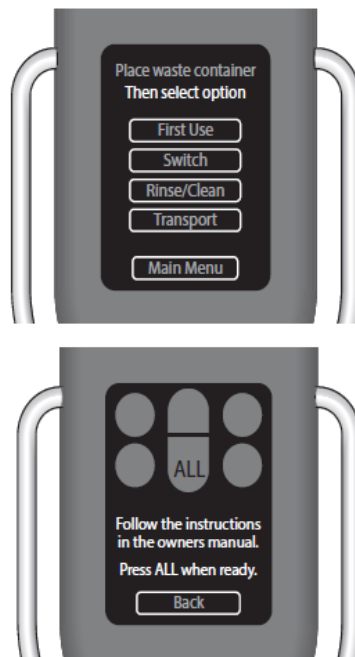

2. Wash and rinse Spirit Bottles, then fill with water.
3. Place Spirit Bottle Dispenser Lid on Bottle and screw Lids securely in place.
4. Insert Spirit Bottles with water in all four Bottle Holders.



5. Place a 10-ounce (296 ml) or larger container under Dispenser on Bar Mat.
6. On the Control Panel, touch Settings icon (⚙️).
7. From Settings Menu, touch "Rinse/Clean." Select "ALL" and cleaning will start. Cocktail Machine will automatically rinse water and spirit lines. When rinsing is complete, Main Menu will appear.

How to Transport

It is recommended to go through both Rinse/Clean and Transport functions to drain lines and drain water in Cocktail Machine if transporting the Cocktail Machine or not planning to use it for an extended period of time.

1. Follow the instructions in "How to Rinse/Clean."
2. Remove Water Reservoir and all Spirit Bottles. Place container under Dispenser.
3. On Control Panel, touch Settings icon (⚙️).
4. On Settings Menu, touch "Transport." Select "ALL" and cleaning of spirit lines will start. Cocktail Machine will

automatically remove remaining water and spirit from lines.

5. When function is complete, Main Menu will appear.

Cleaning Cocktail Machine

WARNING

Electrical Shock Hazard. Disconnect power before cleaning. Do not immerse cord, plug, or base in any liquid.

1. Unplug Cocktail Machine.

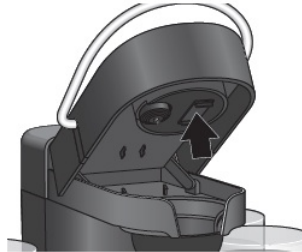

2. Remove Bar Mat and Removable Water Reservoir.

3. Wipe outside surface of machine with a soft, damp cloth or sponge. Dry surface with a clean cloth. Wash Bar Mat and Water Reservoir in hot, soapy water. Rinse and air-dry. Lift Lid Handle. Wipe Barcode Reader with a damp cloth.

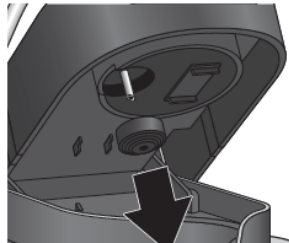
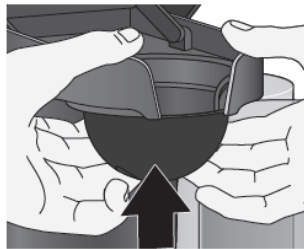

Cleaning Removable Parts

1. To remove Capsule Holder, lift Lid Handle.

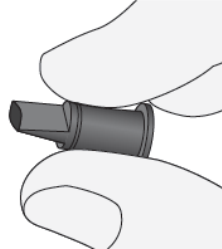
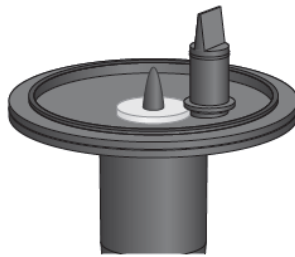

2. Holder up with both hands to remove.

CAUTION: The Capsule Holder contains a sharp needle that punctures the Cocktail Capsule. To avoid risk of injury, do not put your fingers in the Capsule Holder. Carefully, pull down on Removable Capsule Seal to clean.

3. Wash in hot, soapy water and rinse. This part must be reinstalled before making cocktails.

CAUTION: The Capsule Seal surrounds a sharp needle that punctures the Cocktail Capsule. To avoid risk of injury, do not put your fingers on the needle.

4. Capsule Holder and Spirit Bottles with Dispenser Lids are dishwasher-safe.
5. Remove Duck-Bill Valve from Spirit Lid Center.
6. Squeeze Duck-Bill Valve to open mouth and free any build-up. Rinse and dry. Ensure part is properly inserted onto Spirit Lid Center before use. Not having Duck-Bill Valve in place will cause Spirits to leak.

Descaling Instructions

If you live in an area with hard water, descale Cocktail Machine every 1 to 2 months, depending on frequency of use.

1. In a large bowl, stir together 1/2 cup (120 ml) white vinegar and 4 cups (946 ml) water.
2. Divide vinegar mixture between four Spirit Bottles and Removable Water Reservoir.
3. Place a 10-ounce (296 ml) or larger container under Dispenser on Bar Mat. Make sure Capsule Holder is in place. From Settings Menu, touch “Rinse/Clean.”



4. Back Follow the instructions in the owners manual. ALL Press ALL when ready.
5. Select “ALL” and cleaning will start. Cocktail Machine will automatically rinse water and spirit lines.
6. Let vinegar mixture in water and spirit lines stand for 30 minutes.

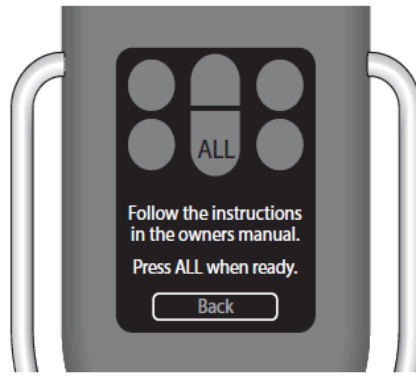

7. Remove Spirit Bottles and Water Reservoir and clean in hot, soapy water. Rinse and dry.
8. Fill Spirit Bottles and Water Reservoir with water.
9. Place Spirit Bottles and Water Reservoir onto Base.
10. Repeat Steps 3 through 5 at least twice to flush vinegar mixture from Cocktail Machine.
11. Empty water from Spirit Bottles. Follow “Important Instructions before First Use.” Cocktail Machine is now ready to use.

Troubleshooting

- Cocktail Machine does not have power.
- Ensure unit is plugged into a working outlet.
- Ensure Removable Power Cord is plugged into Power Cord Port on back of unit.
- Cocktail Machine will not make drinks.
- Check to see if “ADD WATER” is displayed on Control Panel. If so, add water to Water Reservoir.
- Check that Cocktail Capsule is properly placed in Capsule Holder.
- Open Lid. Using a soft, dry cloth wipe off top of Cocktail Capsule and Barcode Reader under Lid. Close and latch Lid. Check Display on Control Panel.
- Spirit/water flows over the capsule.
- Ensure the Removable Capsule Seal is in place on upper needle.
- The Cocktail Machine will not pump alcohol.
- Check if Spirit Bottle is placed in correct Spirit Bottle Holder.
- Clean Dispenser Lids.
- Follow “Important Instructions Before First Use.”
- Clean Duck-Bill Valve. Follow Steps 4 and 5 of “Cleaning Removable Parts.”
- The Cocktail Machine does not respond or recognize when a Cocktail Capsule has been inserted.
- Open Lid. Using a soft, dry cloth wipe off the top of Cocktail Capsule and Barcode Reader under Lid. Close and latch Lid. Check Display on Control Panel.
- Ensure that Lid is properly latched.
- Lid will not close with the Cocktail Capsule installed.
- Make sure you are pushing down on the Handle when closing Lid.
- Open Lid, reposition Cocktail Capsule, and try again. Ensure that the Cocktail Capsule is installed correctly. See “How to Make Cocktails”.
- cocktail tastes different.
- Ensure that the labeled Dispenser Lid matches the spirit in the bottle.
- Ensure that the correct Spirit Bottle is in the correct Spirit Bottle Holder.

- Use filtered or bottled water in the Water Reservoir.

Bartesian Limited Warranty

This warranty applies to products purchased and used in the U.S. and Canada. This is the only express warranty for this product and is instead of any other warranty or condition. This product is warranted to be free from defects in material and workmanship for one (1) year from the date of original purchase. During this period, your exclusive remedy is repair or replacement of this product or any component found to be defective, at our option; however, you are responsible for all costs associated with returning the product to us and our returning a product or component under this warranty to you. If the product or component is no longer available, we will replace with a similar one of equal or greater value.

This warranty does not cover glass, filters, wear from normal use, use not in conformity with the printed directions, or damage to the product resulting from accident, alteration, abuse, or misuse. This warranty extends only to the original consumer purchaser or gift recipient. Keep the original sales receipt, as proof of purchase is required to make a warranty claim. This warranty is void if the product is used for other than single-family household use or subjected to any voltage and waveform other than as specified on the rating label (e.g., 120 V ~ 60 Hz).

We exclude all claims for special, incidental, and consequential damages caused by breach of express or implied warranty. All liability is limited to the amount of the purchase price. Every implied warranty, including any statutory warranty or condition of merchantability or fitness for a particular purpose, is disclaimed except to the extent prohibited by law, in which case such warranty or condition is limited to the duration of this written warranty. This warranty gives you specific legal rights. You may have other legal rights that vary depending on where you live. Some states or provinces do not allow limitations on implied warranties or special, incidental, or consequential damages, so the foregoing limitations may not apply to you. To make a warranty claim, do not return this appliance to the store. Please visit bartesian.com. For faster service, locate the model, type, and series numbers on your appliance.

Download PDF: [Bartesian 55300 Premium Cocktail and Margarita Machine User Manual](#)

References

- [User Manual](#)