



BARTEC RS1000 Programmable TPMS Rite Sensor User Guide

[Home](#) » [BARTEC](#) » BARTEC RS1000 Programmable TPMS Rite Sensor User Guide 

BARTEC RS1000 Programmable TPMS Rite

Sensor User Guide



User Guide

Technical Support:
[866]407-TPMS
(8767)

Product Information

FCC and IC Notice

The RITE-SENSOR complies with Part 15 of the FCC Rules and with RSS-210 of Industry Canada. Operation is subject to the following two conditions:

1. This device may not cause harmful interference, and
2. This device must accept any interference received, including interference that may cause undesired function.

Warning: Any changes or modifications in construction of this device which are not expressly approved by the party responsible for compliance could void the user's authority to operate the equipment.

Prop 65 Warning

Cancer & reproductive harm www.P65warnings.com

Contents

The RITE-SENSOR® assembled with a rubber valve stem, optional aluminum valve stem and anti-rotational pin.

Warranty

The RITE-SENSOR has a limited lifetime guarantee to be free from material and manufacturing defects. This warranty covers any defects in material or workmanship under normal use. Excluded from the warranty are

normal wear and tear and defects due to improper installation and usage.*

Caution

- Any maintenance and repair work must be carried out by trained experts. Failure to do so may result in the failure of the TPMS sensor. The manufacturer does not assume any liability in case of faulty or incorrect installation of the product.
- Read the installation and safety instructions carefully, before installing the sensor.
- When the tire bead is initially broken, ensure the valve is on the opposite side of the wheel from the bead breaker blade. When a tire is removed or a sensor is serviced it is highly recommended to replace or service the sensor.
- A Snap-In sensor always requires the valve stem to be replaced.
- A Clamp-In sensor is properly serviced by replacing the valve nut/collar/core, rubber grommet and if necessary, the valve stem. It is very important to tighten the nut/collar to the correct torque of 35.5 in-lbs.

Assembly

The RITE-SENSOR comes assembled with a rubber valve stem. In some cases the aluminum valve stem is required or needed. First remove the rubber valve stem by unscrewing the fastener. Insert the aluminum stem into the sensor. Insert the anti-rotation pin into the hole at the base of the stem, just above the sensor body. Insert NEW fastener into stem and torque to 35.5 in-lbs (4Nm).

Programming

The RITE-SENSOR needs to be programmed BEFORE use. To program the RITE-SENSOR® according to specific year, make and model being serviced, follow the instructions on your Bartec Tech400Pro, Tech500, Tech300Pro, or Tech400SD TPMS service tool. It is important to know the precise application information to accurately program your RITE-SENSOR®

*The sensor valve is warranted for twenty-four (24) months, however if the tire is removed, the valve must be serviced to uphold the sensor lifetime warranty.

RITE-SENSOR with Rubber Valve Standard

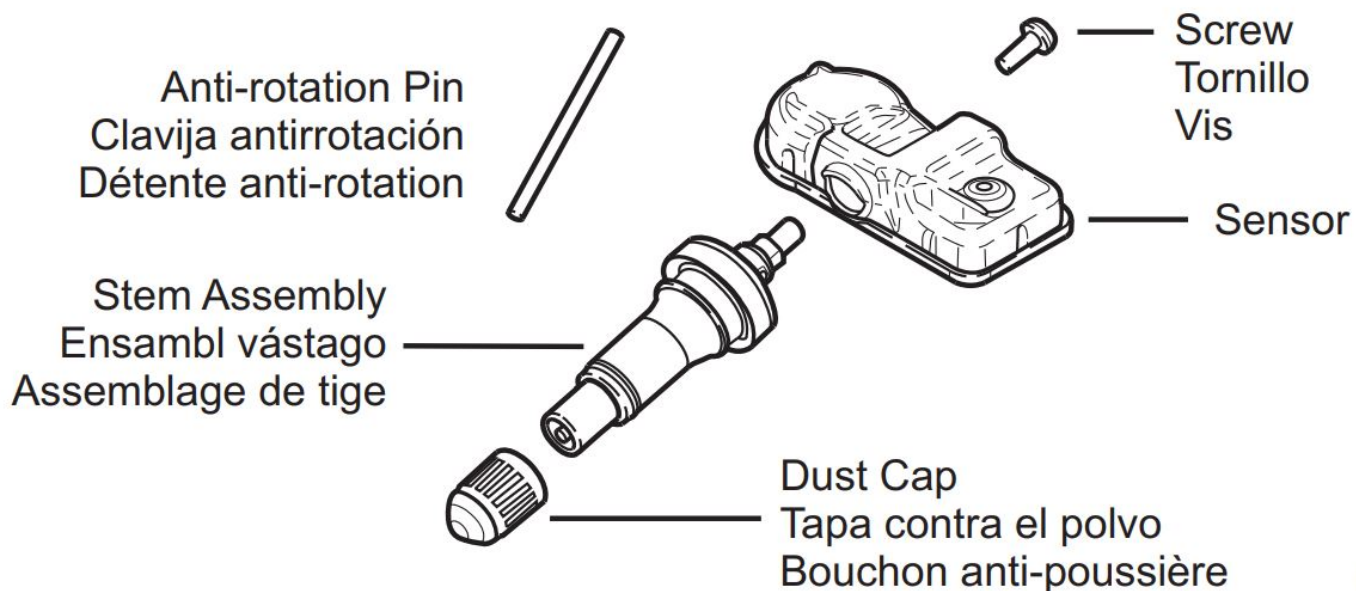

www.ritesensor.com

Installation Guide

Deflate and Disassemble Tire and Wheel

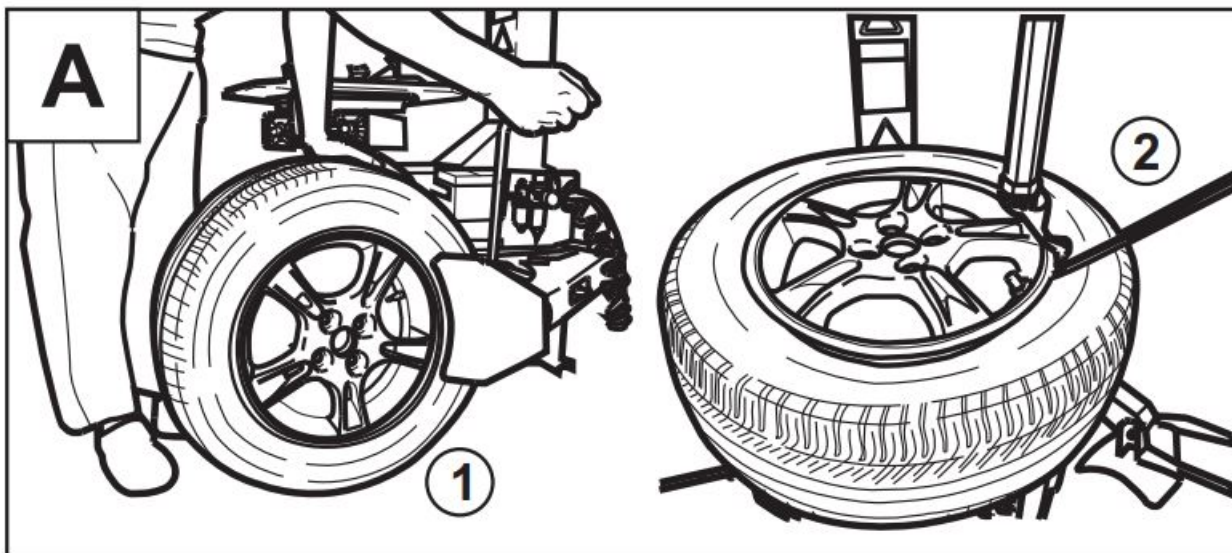

Detach Sensor from Stem, Remove Stem and Inspect the Wheel

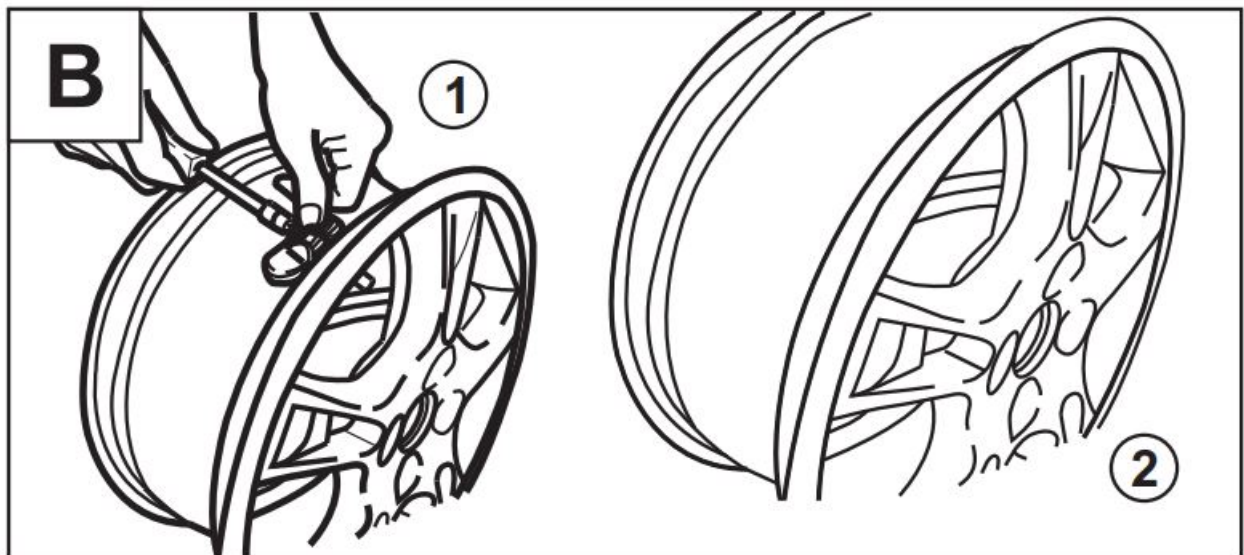

Assembly of RITE-SENSOR® with Rubber Valve Stem Fitted

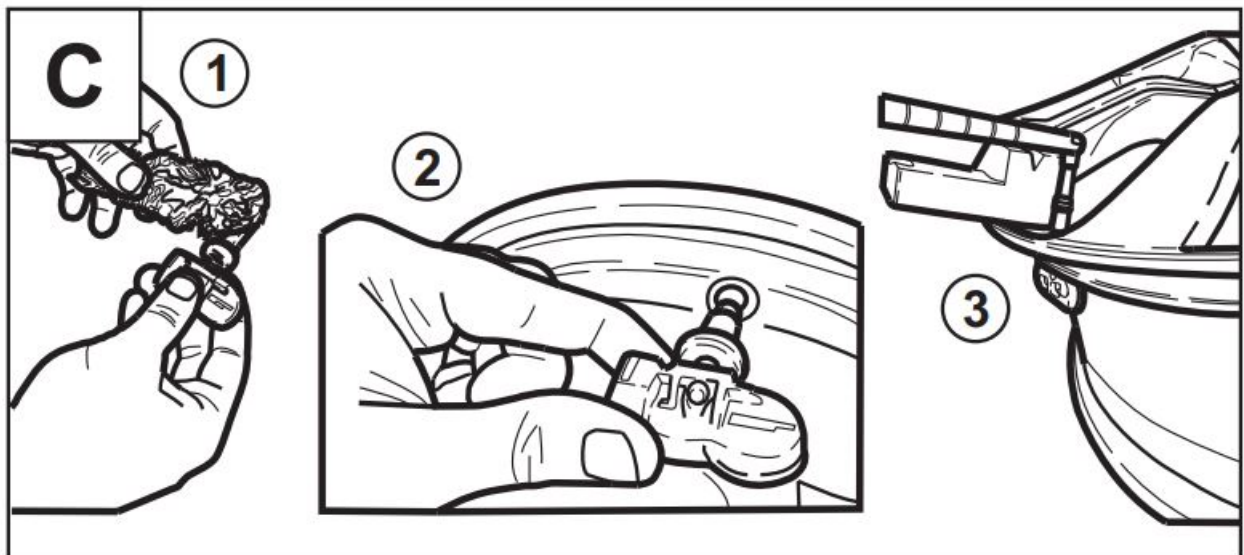

Assembly of RITE-SENSOR® with Aluminum Valve Stem Fitted

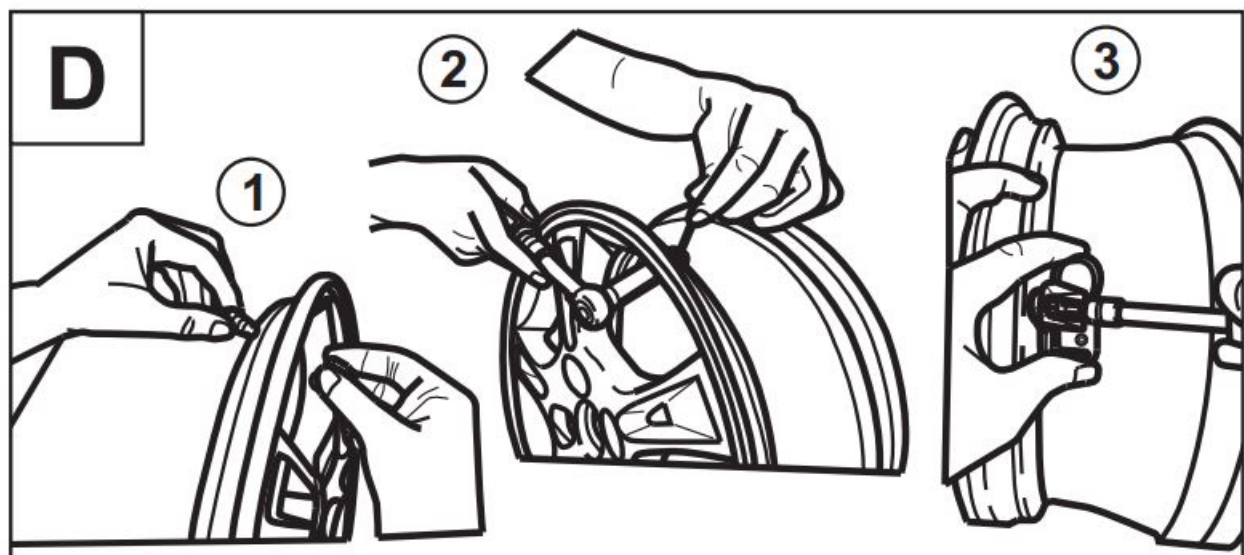

Mount the tire to the wheel

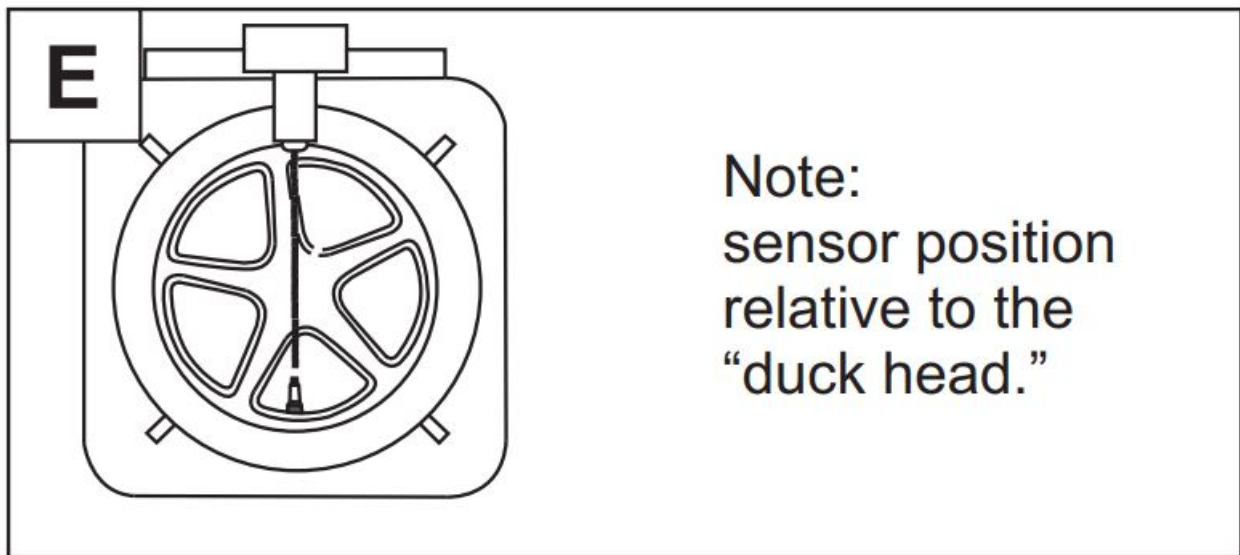

Perform RITE-SYNC® using Bartec TPMS Tool

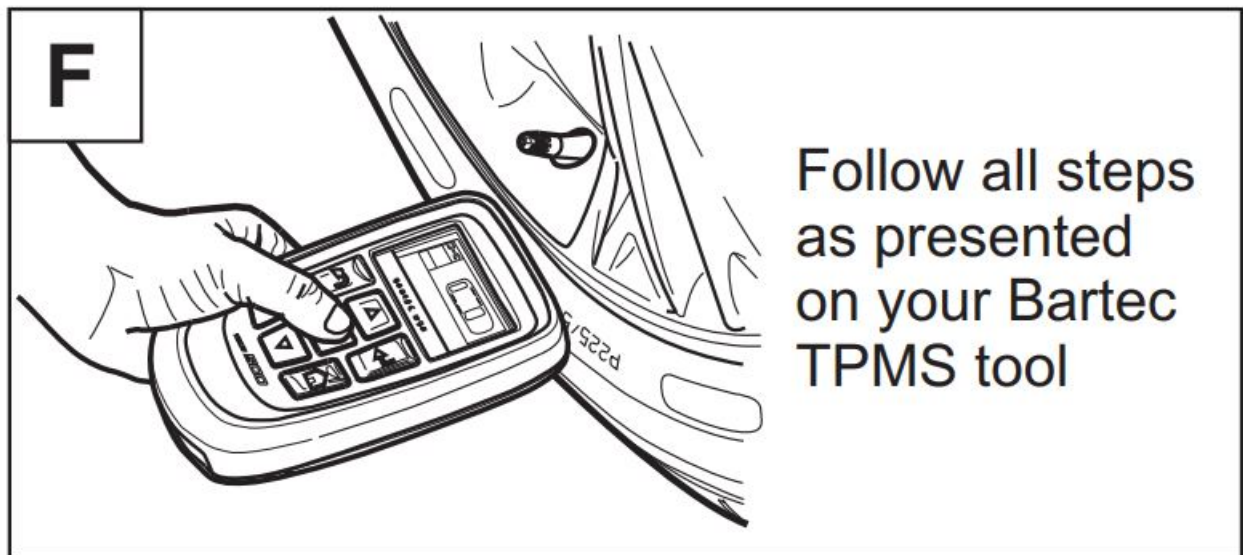

Print/Save Inspection Report

G

Audit Report - 4/2/2014 3:05:00 PM

Tech500
51.0
350007
Mitsubishi
Lancer
2008-2010
VIN: JA3AU86W29U022346
Qualifier: 00000C4
State: Relearn

Test Performed By: Jimmy Cross
Owners Name: Larry Smith
License Plate Number: 455 TPE
Mileage: 34000
Model and Year: Lancer 08
Comments:

Use this information
for customer's
warranty details

Sensors													
Wheel	SCMD (Hex)	SCMD (Dec)	Position	Type	Seals	ID (Hex)	ID (Dec)	Make	Battery	PSI	Temp (°F)	ODM #	Signal
LF	3320	13152	New	Commercial 1 (256) 315 315	1	6089006	254600076	Pass	Pass	27.1	60	4708015	No
RF	4C3712	1957288	New	Commercial 1 (256) 315 315	1	C425713	251103891	Pass	Pass	36.4	68	4708015	No
RR	4D18F	118231	New	Commercial 1 (256) 315 315	1	821D18F	258000255	Pass	Pass	36.6	64	4708015	No
LR	8440E4	1182288	New	Commercial 1 (256) 315 315	1	10B410E4	1564022724	Pass	Pass	40.0	62	4708015	No

DTCs		
Code	Description	Status
C1921	Transmitter 2 ID Reception Failure	Past
C1922	Low Tire Pressure Indicated At Transmitter 2	Past
C1942	Low Tire Pressure Indicated At Transmitter 4	Past

Program single RITE-SENSORS or sensors not being installed on a vehicle by using Bartec TPMS Tool



WARRANTY INFORMATION

To activate limited lifetime warranty, please complete the above section and send to: RITE-SENSOR Warranty, Bartec USA, LLC. 44231 Phoenix Drive, Sterling Heights, MI 48314. Attn: Customer Service. Or visit www.ritesensor.com to activate warranty

PROFESSIONAL INSTALLER INFORMATION:

Business Name: _____ Address: _____

Phone: _____ Installer/Technician Name: _____

Describe Issue or Problem: _____

CONSUMER INFORMATION:

Vehicle Owner Name: _____ Address: _____

Vehicle Make: _____ Model: _____ Year: _____ VIN: _____

Date of RITE-SENSOR® Installation: _____ Vehicle Mileage: _____

Sensor information [chip ID is found on the back of the sensor. This must be recorded.]

Sensor 1 Chip ID: _____ Sensor 2 Chip ID: _____ Sensor 3 Chip ID: _____

Sensor 4 Chip ID: _____ Sensor 5 Chip ID: _____

Contents

- 1 Documents / Resources
- 2 Related Posts

Documents / Resources

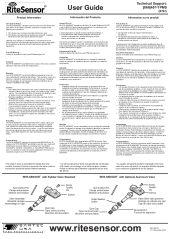
	<p>BARTEC RS1000 Programmable TPMS Rite Sensor [pdf] User Guide RS1000, Programmable TPMS Rite Sensor, RS1000 Programmable TPMS Rite Sensor</p>
---	---

Manuals+.