



BARTEC RS-2000 RiteSensor 315/433MHz Programmable TPMS Sensor User Guide

[Home](#) » [BARTEC](#) » BARTEC RS-2000 RiteSensor 315/433MHz Programmable TPMS Sensor User Guide 

Contents

- [1 BARTEC RS-2000 RiteSensor 315/433MHz Programmable TPMS Sensor](#)
- [2 Product Information](#)
- [3 Assembly](#)
- [4 RITE-SENSOR](#)
- [5 Installation](#)
- [6 WARRANTY INFORMATION](#)
- [7 Documents / Resources](#)
 - [7.1 References](#)
- [8 Related Posts](#)



BARTEC RS-2000 RiteSensor 315/433MHz Programmable TPMS Sensor



Product Information

Warning: Any changes or modifications in the construction of this device that are not expressly approved by the party responsible for compliance could void the user's authority to operate the equipment.

Prop 65 Warning Cancer & reproductive harm www.P65warnings.com Contents The RITE-SENSOR® is assembled with a rubber valve stem, an optional aluminum valve stem. Warranty The RITE-SENSOR® has a limited lifetime guarantee to be free from material and manufacturing defects. This warranty covers any defects in material or workmanship under normal use. Excluded from the warranty are normal wear and tear and defects due to improper installation and usage.* Caution experts. Failure to do so may result in the failure of the TPMS sensor. The manufacturer does not assume any liability in case of faulty or incorrect installation of the product.

Caution

1. Any maintenance and repair work must be carried out by trained experts. Failure to do so may result in the failure of the TPMS sensor. The manufacturer does not assume any liability in case of faulty or incorrect installation of the product.
2. Read the installation and safety instructions carefully, before installing the sensor.
3. When the tire bead is initially broken, ensure the valve is on the opposite side of the wheel from the bead breaker blade.
4. When a tire is removed or a sensor is serviced it is highly recommended to replace or service the sensor.
5. A Snap-In sensor always requires the valve stem to be replaced.
6. A Clamp-In sensor is properly serviced by replacing the valve nut/collar/core, rubber grommet and if necessary, the valve stem. It is very important to tighten the nut/collar to the correct torque of 35.5 in-lbs.

Assembly

The RITE-SENSOR comes assembled with a rubber valve stem. In some cases, the aluminum valve stem is required or needed. First, remove the rubber valve stem by unscrewing the fastener. Insert the aluminum stem into the sensor. Insert NEW fastener into stem and torque to 35.5 in-lbs (4Nm).

Programming

The RITE-SENSOR needs to be programmed for use. To program ® the RITE-SENSOR according to the specific

year, make and model being serviced, follow the instructions on your Bartec TPMS service tool. It is important to know the precise application information to ®. accurately program your RITE-SENSOR

RITE-SENSOR

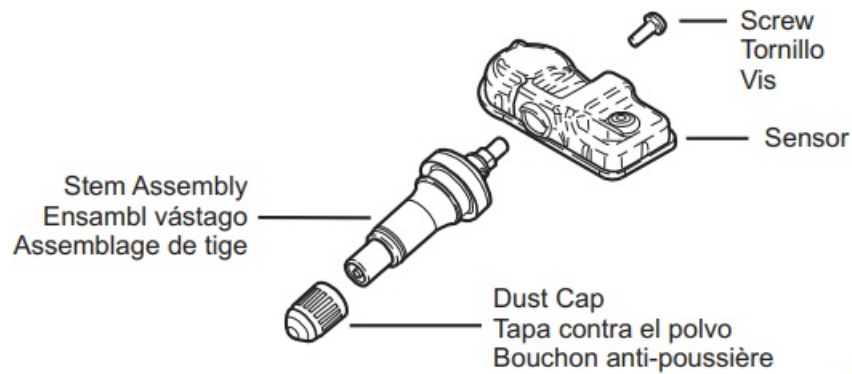

Installation

- Deflate and Disassemble Tire and Wheel
- Detach Sensor from Stem, Remove Stem and Inspect the Wheel
- Assembly of RITE-SENSOR with Rubber Valve Stem Fitted

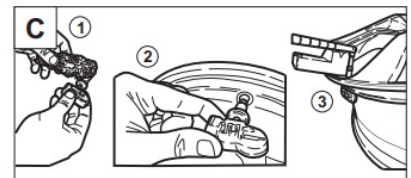
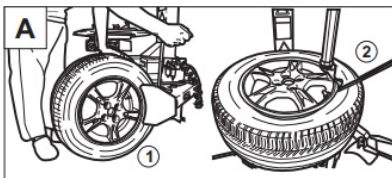

- Assembly of RITE-SENSOR with Aluminum Valve Stem Fitted
- Mount the tire to the wheel
- Perform RITE-SYNC using Bartec TPMS Tool

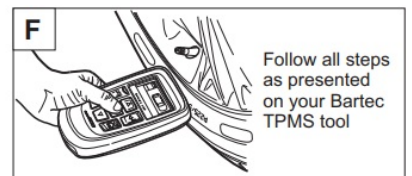
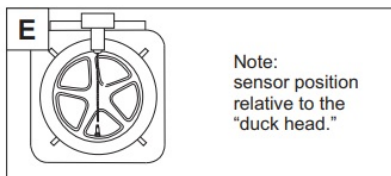
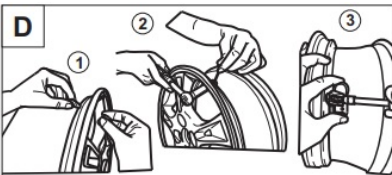

- Program single RITE-SENSORS or sensors not being installed on a vehicle by using Bartec TPMS Tool
- Print/Save Inspection Report

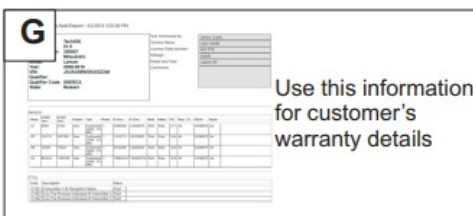

WARRANTY INFORMATION

To activate a limited lifetime warranty, please complete the above section and send to RITE-SENSOR Warranty, Bartec USA, LLC. 6475 19 ½ Mile Road, Sterling Heights, MI 48314. Attn: Customer Service. Or visit www.ritesensor.com to activate the warranty.

Note:

This equipment has been tested and found to comply with the limits for a Class B digital device, pursuant to part 15 of the FCC Rules. These limits are designed to provide reasonable protection against harmful interference in a

residential installation. This equipment generates, uses, and can radiate radio frequency energy and, if not installed and used in accordance with the instructions, may cause harmful interference to radio communications. However, there is no guarantee that interference will not occur in a particular installation. If this equipment does cause harmful interference to radio or television reception, which can be determined by turning the equipment off and on, the user is encouraged to try to correct the interference by one or more of the following measures:

- Reorient or relocate the receiving antenna.
- Increase the separation between the equipment and receiver.
- Connect the equipment into an outlet on a circuit different from that to which the receiver is connected.
- Consult the dealer or an experienced radio/TV technician for help.

Documents / Resources

	<p>BARTEC RS-2000 RiteSensor 315/433MHz Programmable TPMS Sensor [pdf] User Guide RS2000, SX8-RS2000, SX8RS2000, RS-2000, RiteSensor 315 433MHz Programmable TPMS Sensor, RS-2000 RiteSensor 315 433MHz Programmable TPMS Sensor</p>
---	--

References

-  [Bartec's Programmable Replacement TPMS Sensor | RITE-SENSOR® | Bartec USA LLC](#)